

PIT STATUS EVALUATION FORM

Facility ID: 115047

Pit Name: MCCCCOY AMOCO 12-5

☐ Duplicate Record(s) Pit #

115118

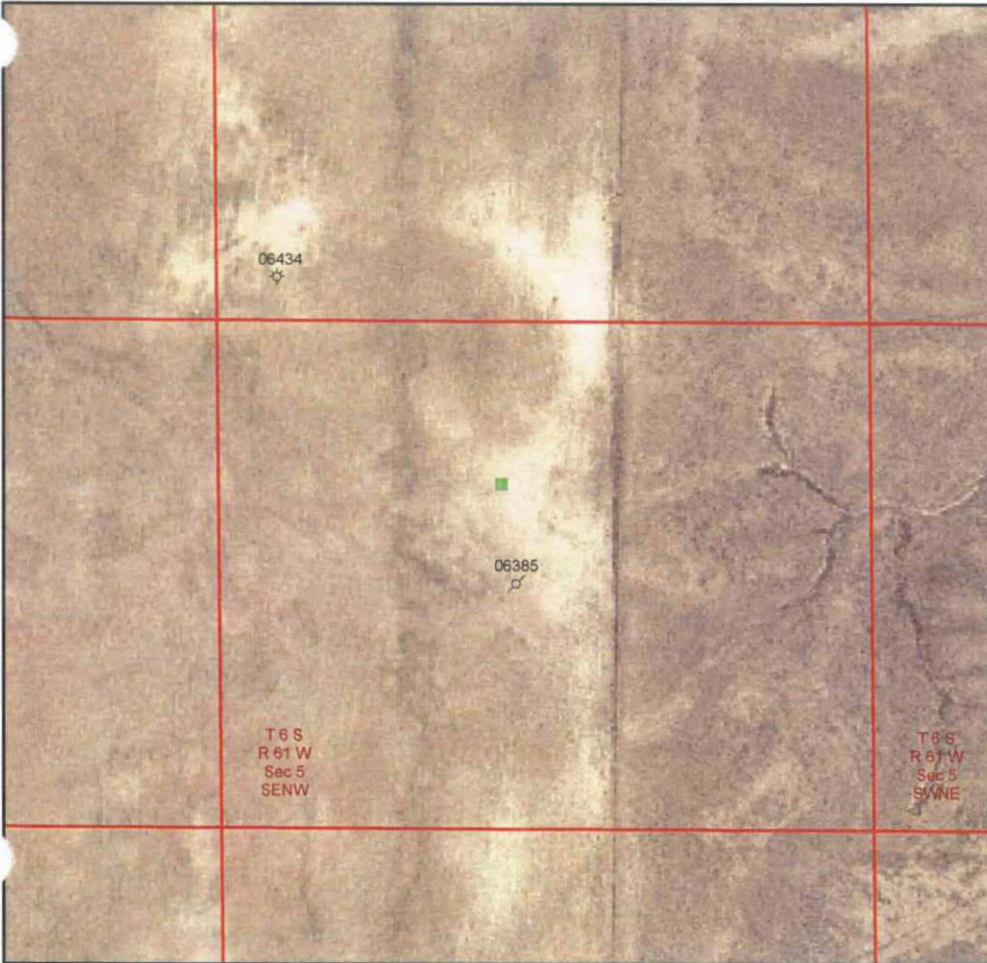

Legend

- ☐ Database Pit Location
- ☐ Producing Well
- ☐ Shut In Well
- ☐ Temp Aban Well
- ☐ Abandoned Well
- ☐ Dry & Aban Well
- ☐ Injection Well
- ☐ Other Well Status



1:6,000

0 250 500 750 Feet

Image Source:
USDA National Agricultural Imagery
Program (NAIP), 2006

 S.S. PAPADOPOULOS & ASSOCIATES, INC.

COGCC Database Information

Status: NR Owner: LATHAM EXPL CO INC
T: 6S R: 61W Sec: 5 QQ: SENW 6th Meridian
Latitude: 39.559017 Longitude: -104.247028 NAD83

County: Elbert, CO
County Code: 039

Pit Status Evaluation

- ☐ Active ☐ Form 15: Pit Permit #651728 (1982) new Assoc. Well Seq No(s) _____
☐ Other documentation _____
☐ Aerial photo verification _____
- ☒ Closed ☐ Form 27: Remediation Workplan _____
☐ Form 4: Sundry Notice _____
☐ Rule 903a.(2)B _____
☒ Evidence pit(s) existed, no closure docs & well not PR, AC or SI
Well API Seq #(s) 06385 PA (1-26-1993)
☒ Other documentation WSIF # 432237 (2-1992)
- ☐ Abandoned ☐ Possible un-reclaimed pit(s) or adverse conditions, no closure docs ☐ Site Visit
☐ Unknown ☐ No Site Visit
☐ Add'l Review

Notes: WSIF(1992) Pits backfilled & site clean