

# CCRP OPERATING INC.

Location: COLORADO Slot: SLOT#02 SALT RANCH FEE 502-1034H (357°FNL & 637°FEL, SEC.10)  
Field: WELD COUNTY (NAD 83/TN) Well: SALT RANCH FEE 502-1034H  
Facility: SEC.10-T11N-R64W Wellbore: SALT RANCH FEE 502-1034H PWB

Plot reference wellpath is SALT RANCH FEE 502-1034H (REV-A.0) PWP	Grid System: NAD83 / Lambert Colorado SP, Northern Zone (501), US feet
True vertical depths are referenced to RIG (23KB) (RKB)	* ~ Wellpath was transformed from a different geodetic datum
Measured depths are referenced to RIG (23KB) (RKB)	North Reference: True north
RIG (23KB) (RKB) to Mean Sea Level: 5456 feet	Scale: True distance
Mean Sea Level to Mud line (At Slot: SLOT#02 SALT RANCH FEE 502-1034H (357°FNL & 637°FEL, SEC.10)): 0 feet	Depths are in feet
Coordinates are in feet referenced to Slot	Created by: adamkat on 2019-02-12
	Database: Denver

## Location Information

Facility Name	Grid East (US ft)	Grid North (US ft)	Latitude	Longitude
SEC.10-T11N-R64W	3269150.078	1587572.090	40°56'31.888"N	104°31'32.869"W
Slot	Local N (ft)	Local E (ft)	Grid East (US ft)	Grid North (US ft)
SLOT#02 SALT RANCH FEE 502-1034H (357°FNL & 637°FEL, SEC.10)	0.30	-30.16	3269119.916	1587572.062
RIG (23KB) (RKB) to Mud line (At Slot: SLOT#02 SALT RANCH FEE 502-1034H (357°FNL & 637°FEL, SEC.10))			5456ft	
Mean Sea Level to Mud line (At Slot: SLOT#02 SALT RANCH FEE 502-1034H (357°FNL & 637°FEL, SEC.10))			0ft	
RIG (23KB) (RKB) to Mean Sea Level			5456ft	

## Well Profile Data

Design Comment	MD (ft)	Inc (°)	Az (°)	TVD (ft)	Local N (ft)	Local E (ft)	DLS (°/100ft)	VS (ft)
Tie On	23.00	0.000	289.896	23.00	0.00	0.00	0.00	0.00
End of Tangent	1200.00	0.000	289.896	1200.00	0.00	0.00	0.00	0.00
End of Build	2171.88	14.578	289.896	2161.43	41.85	-115.64	1.50	53.54
End of Tangent	5623.30	14.578	289.896	5501.73	337.49	-932.51	0.00	431.72
End of Drop	6352.21	0.000	359.679	6222.80	368.88	-1019.24	2.00	471.88
End of Tangent	7352.21	0.000	359.679	7222.80	368.88	-1019.24	0.00	471.88
End of Build	8477.21	90.000	359.679	7939.00	1085.07	-1023.25	8.00	1184.67
End of Tangent	17779.18	90.000	359.679	7939.00	10386.89	-1075.33	0.00	10442.40

## Survey Program

Start MD (ft)	End MD (ft)	Tool	Model	Log Name/Comment	Wellbore
23.00	17779.18	BHI Nav iTrak	BHI Nav iTrak (Rotating+Axial Corr)		SALT RANCH FEE 502-1034H PWB

## Bottom Hole Location

MD (ft)	Inc (°)	Az (°)	TVD (ft)	Local N (ft)	Local E (ft)	Grid East (US ft)	Grid North (US ft)	Latitude	Longitude
17779.18	90.000	359.679	7939.00	10386.89	-1075.33	3267930.52	1597946.80	40°58'14.520"N	104°31'47.280"W

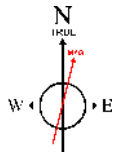

BGGM (1900.0 to 2020.0) Dip: 67.26° Field: 52517.2 nT  
Magnetic North is 8.12 degrees East of True North (at 2/8/2019)

To correct azimuth from Magnetic to True add 8.12 degrees



True Vertical Depth (ft)  
Scale 1 inch = 1500

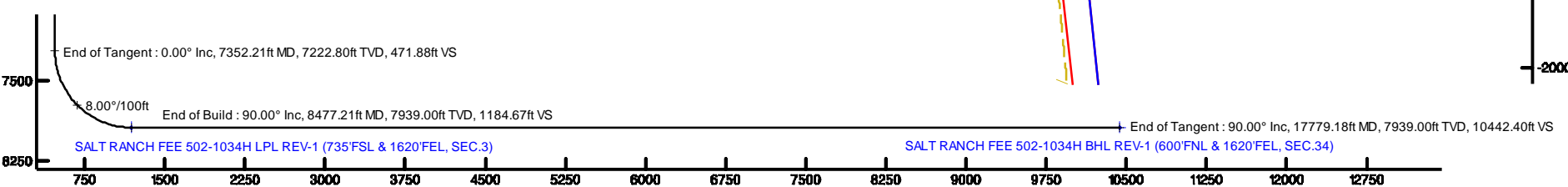

Vertical Section (ft)  
Azimuth 354.09° with reference 0.00 N, 0.00 E

Scale 1 inch = 1500

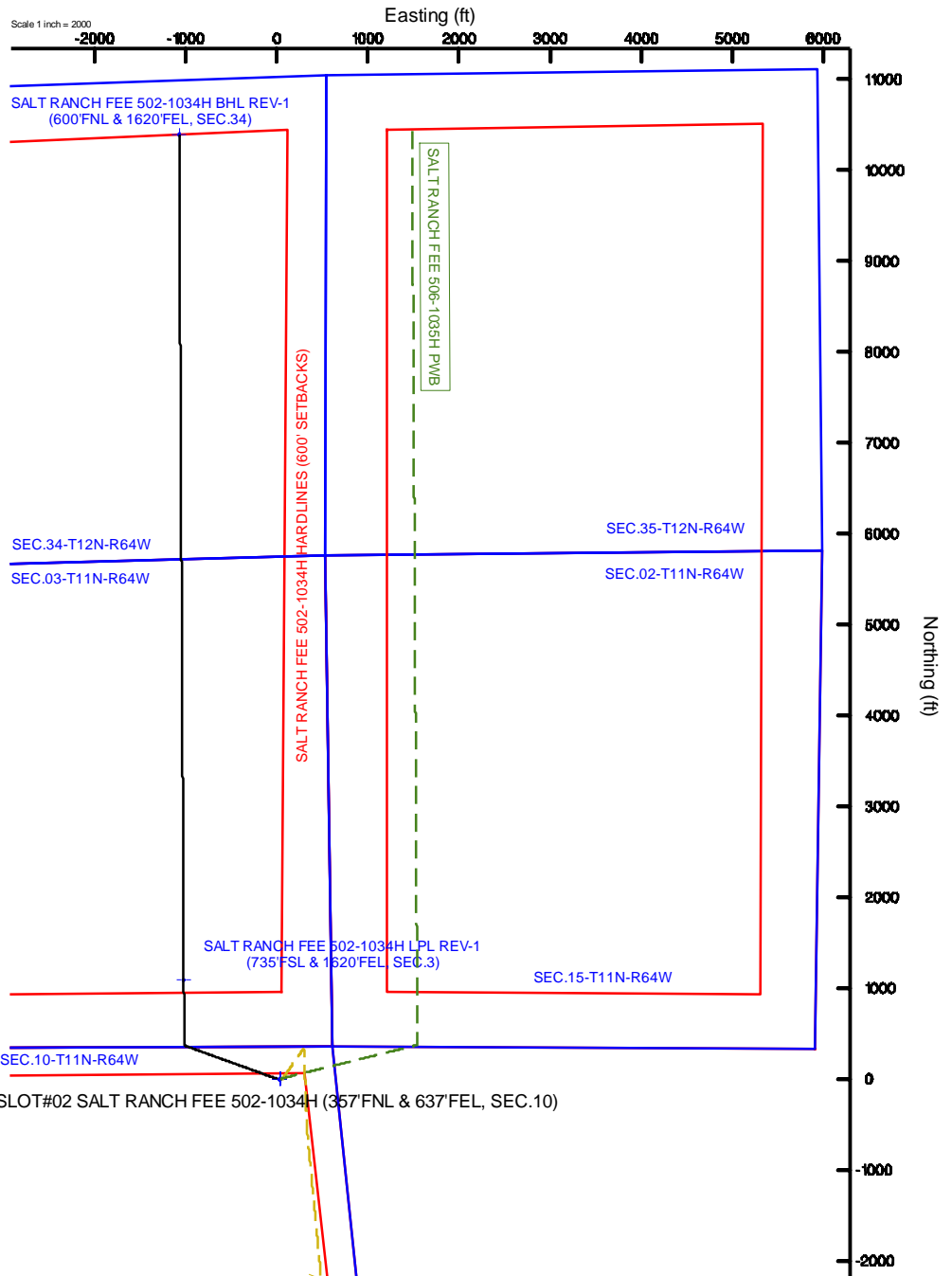

# Planned Wellpath Report

SALT RANCH FEE 502-1034H (REV-A.0) PWP

Page 1 of 7

REFERENCE WELLPATH IDENTIFICATION			
Operator	CCRP OPERATING INC.	Slot	SLOT#02 SALT RANCH FEE 502-1034H (357'FNL & 637'FEL, SEC.10)
Area	COLORADO	Well	SALT RANCH FEE 502-1034H
Field	WELD COUNTY (NAD 83/TN)	Wellbore	SALT RANCH FEE 502-1034H PWB
Facility	SEC.10-T11N-R64W		

REPORT SETUP INFORMATION			
Projection System	NAD83 / Lambert Colorado SP, Northern Zone (501), US feet	Software System	WellArchitect® 5.0
North Reference	True	User	Adamkat
Scale	1.000030	Report Generated	2/12/2019 at 7:30:59 AM
Convergence at slot	0.63° East	Database/Source file	Denver/SALT_RANCH_FEE_502-1034H_REV-A.0_PWP.xml

WELLPATH LOCATION						
	Local coordinates		Grid coordinates		Geographic coordinates	
	North[ft]	East[ft]	Easting[US ft]	Northing[US ft]	Latitude	Longitude
Slot Location	0.30	-30.16	3269119.92	1587572.06	40°56'31.891"N	104°31'33.262"W
Facility Reference Pt			3269150.08	1587572.09	40°56'31.888"N	104°31'32.869"W
Field Reference Pt			3242001.26	1607883.12	40°59'55.356"N	104°37'23.988"W

WELLPATH DATUM			
Calculation method	Minimum curvature	RIG (23'KB) (RKB) to Facility Vertical Datum	5456.00ft
Horizontal Reference Pt	Slot	RIG (23'KB) (RKB) to Mean Sea Level	5456.00ft
Vertical Reference Pt	RIG (23'KB) (RKB)	RIG (23'KB) (RKB) to Mud Line at Slot (SLOT#02 SALT RANCH FEE 502-1034H (357'FNL & 637'FEL, SEC.10))	5456.00ft
MD Reference Pt	RIG (23'KB) (RKB)	Section Origin	N 0.00, E 0.00 ft
Field Vertical Reference	Mean Sea Level	Section Azimuth	354.09°

# Planned Wellpath Report

SALT RANCH FEE 502-1034H (REV-A.0) PWP

Page 2 of 7

## REFERENCE WELLPATH IDENTIFICATION

Operator	CCRP OPERATING INC.	Slot	SLOT#02 SALT RANCH FEE 502-1034H (357'FNL & 637'FEL, SEC.10)
Area	COLORADO	Well	SALT RANCH FEE 502-1034H
Field	WELD COUNTY (NAD 83/TN)	Wellbore	SALT RANCH FEE 502-1034H PWB
Facility	SEC.10-T11N-R64W		

## WELLPATH DATA (186 stations) † = interpolated/extrapolated station

MD [ft]	Inclination [°]	Azimuth [°]	TVD [ft]	Vert Sect [ft]	North [ft]	East [ft]	Grid East [US ft]	Grid North [US ft]	DLS [°/100ft]	Comments
0.00†	0.000	289.896	0.00	0.00	0.00	0.00	3269119.92	1587572.06	0.00	
23.00	0.000	289.896	23.00	0.00	0.00	0.00	3269119.92	1587572.06	0.00	Tie On
123.00†	0.000	289.896	123.00	0.00	0.00	0.00	3269119.92	1587572.06	0.00	
223.00†	0.000	289.896	223.00	0.00	0.00	0.00	3269119.92	1587572.06	0.00	
323.00†	0.000	289.896	323.00	0.00	0.00	0.00	3269119.92	1587572.06	0.00	
423.00†	0.000	289.896	423.00	0.00	0.00	0.00	3269119.92	1587572.06	0.00	
523.00†	0.000	289.896	523.00	0.00	0.00	0.00	3269119.92	1587572.06	0.00	
623.00†	0.000	289.896	623.00	0.00	0.00	0.00	3269119.92	1587572.06	0.00	
723.00†	0.000	289.896	723.00	0.00	0.00	0.00	3269119.92	1587572.06	0.00	
823.00†	0.000	289.896	823.00	0.00	0.00	0.00	3269119.92	1587572.06	0.00	
923.00†	0.000	289.896	923.00	0.00	0.00	0.00	3269119.92	1587572.06	0.00	
1023.00†	0.000	289.896	1023.00	0.00	0.00	0.00	3269119.92	1587572.06	0.00	
1123.00†	0.000	289.896	1123.00	0.00	0.00	0.00	3269119.92	1587572.06	0.00	
1200.00	0.000	289.896	1200.00	0.00	0.00	0.00	3269119.92	1587572.06	0.00	End of Tangent
1223.00†	0.345	289.896	1223.00	0.03	0.02	-0.07	3269119.85	1587572.08	1.50	
1323.00†	1.845	289.896	1322.98	0.86	0.67	-1.86	3269118.05	1587572.72	1.50	
1423.00†	3.345	289.896	1422.87	2.83	2.21	-6.12	3269113.77	1587574.21	1.50	
1523.00†	4.845	289.896	1522.62	5.94	4.64	-12.83	3269107.03	1587576.57	1.50	
1623.00†	6.345	289.896	1622.14	10.19	7.96	-22.00	3269097.83	1587579.78	1.50	
1723.00†	7.845	289.896	1721.37	15.56	12.17	-33.62	3269086.17	1587583.86	1.50	
1823.00†	9.345	289.896	1820.24	22.07	17.25	-47.67	3269072.06	1587588.79	1.50	
1923.00†	10.845	289.896	1918.69	29.70	23.22	-64.15	3269055.51	1587594.57	1.50	
2023.00†	12.345	289.896	2016.65	38.45	30.06	-83.05	3269036.54	1587601.21	1.50	
2123.00†	13.845	289.896	2114.04	48.31	37.77	-104.35	3269015.15	1587608.68	1.50	
2171.88	14.578	289.896	2161.43	53.54	41.85	-115.64	3269003.82	1587612.64	1.50	End of Build
2223.00†	14.578	289.896	2210.90	59.14	46.23	-127.73	3268991.68	1587616.89	0.00	
2323.00†	14.578	289.896	2307.68	70.09	54.80	-151.40	3268967.92	1587625.19	0.00	
2423.00†	14.578	289.896	2404.46	81.05	63.36	-175.07	3268944.16	1587633.50	0.00	
2523.00†	14.578	289.896	2501.24	92.01	71.93	-198.74	3268920.39	1587641.80	0.00	
2623.00†	14.578	289.896	2598.02	102.97	80.49	-222.41	3268896.63	1587650.11	0.00	
2723.00†	14.578	289.896	2694.80	113.92	89.06	-246.07	3268872.87	1587658.41	0.00	
2823.00†	14.578	289.896	2791.58	124.88	97.62	-269.74	3268849.11	1587666.72	0.00	
2923.00†	14.578	289.896	2888.37	135.84	106.19	-293.41	3268825.35	1587675.03	0.00	
3023.00†	14.578	289.896	2985.15	146.80	114.76	-317.08	3268801.59	1587683.33	0.00	
3123.00†	14.578	289.896	3081.93	157.75	123.32	-340.74	3268777.83	1587691.64	0.00	
3223.00†	14.578	289.896	3178.71	168.71	131.89	-364.41	3268754.07	1587699.94	0.00	
3323.00†	14.578	289.896	3275.49	179.67	140.45	-388.08	3268730.31	1587708.25	0.00	
3423.00†	14.578	289.896	3372.27	190.63	149.02	-411.75	3268706.54	1587716.55	0.00	
3523.00†	14.578	289.896	3469.05	201.58	157.58	-435.42	3268682.78	1587724.86	0.00	
3623.00†	14.578	289.896	3565.83	212.54	166.15	-459.08	3268659.02	1587733.16	0.00	
3723.00†	14.578	289.896	3662.61	223.50	174.72	-482.75	3268635.26	1587741.47	0.00	
3823.00†	14.578	289.896	3759.39	234.46	183.28	-506.42	3268611.50	1587749.77	0.00	
3923.00†	14.578	289.896	3856.17	245.41	191.85	-530.09	3268587.74	1587758.08	0.00	
4023.00†	14.578	289.896	3952.95	256.37	200.41	-553.75	3268563.98	1587766.39	0.00	
4123.00†	14.578	289.896	4049.73	267.33	208.98	-577.42	3268540.22	1587774.69	0.00	

# Planned Wellpath Report

SALT RANCH FEE 502-1034H (REV-A.0) PWP  
Page 3 of 7

REFERENCE WELLPATH IDENTIFICATION			
Operator	CCRP OPERATING INC.	Slot	SLOT#02 SALT RANCH FEE 502-1034H (357'FNL & 637'FEL, SEC.10)
Area	COLORADO	Well	SALT RANCH FEE 502-1034H
Field	WELD COUNTY (NAD 83/TN)	Wellbore	SALT RANCH FEE 502-1034H PWB
Facility	SEC.10-T11N-R64W		

WELLPATH DATA (186 stations) † = interpolated/extrapolated station										
MD [ft]	Inclination [°]	Azimuth [°]	TVD [ft]	Vert Sect [ft]	North [ft]	East [ft]	Grid East [US ft]	Grid North [US ft]	DLS ["/100ft]	Comments
4223.00†	14.578	289.896	4146.51	278.29	217.55	-601.09	3268516.46	1587783.00	0.00	
4323.00†	14.578	289.896	4243.29	289.24	226.11	-624.76	3268492.69	1587791.30	0.00	
4423.00†	14.578	289.896	4340.07	300.20	234.68	-648.43	3268468.93	1587799.61	0.00	
4523.00†	14.578	289.896	4436.85	311.16	243.24	-672.09	3268445.17	1587807.91	0.00	
4623.00†	14.578	289.896	4533.63	322.12	251.81	-695.76	3268421.41	1587816.22	0.00	
4723.00†	14.578	289.896	4630.41	333.07	260.37	-719.43	3268397.65	1587824.52	0.00	
4823.00†	14.578	289.896	4727.19	344.03	268.94	-743.10	3268373.89	1587832.83	0.00	
4923.00†	14.578	289.896	4823.98	354.99	277.51	-766.76	3268350.13	1587841.14	0.00	
5023.00†	14.578	289.896	4920.76	365.95	286.07	-790.43	3268326.37	1587849.44	0.00	
5123.00†	14.578	289.896	5017.54	376.90	294.64	-814.10	3268302.61	1587857.75	0.00	
5223.00†	14.578	289.896	5114.32	387.86	303.20	-837.77	3268278.84	1587866.05	0.00	
5323.00†	14.578	289.896	5211.10	398.82	311.77	-861.44	3268255.08	1587874.36	0.00	
5423.00†	14.578	289.896	5307.88	409.78	320.33	-885.10	3268231.32	1587882.66	0.00	
5523.00†	14.578	289.896	5404.66	420.73	328.90	-908.77	3268207.56	1587890.97	0.00	
5623.00†	14.578	289.896	5501.44	431.69	337.47	-932.44	3268183.80	1587899.27	0.00	
5623.30	14.578	289.896	5501.73	431.72	337.49	-932.51	3268183.73	1587899.30	0.00	End of Tangent
5723.00†	12.584	289.896	5598.64	441.92	345.46	-954.52	3268161.63	1587907.02	2.00	
5823.00†	10.584	289.896	5696.59	450.66	352.29	-973.40	3268142.67	1587913.65	2.00	
5923.00†	8.584	289.896	5795.19	457.91	357.96	-989.06	3268126.96	1587919.14	2.00	
6023.00†	6.584	289.896	5894.31	463.65	362.45	-1001.47	3268114.50	1587923.50	2.00	
6123.00†	4.584	289.896	5993.83	467.89	365.76	-1010.62	3268105.31	1587926.71	2.00	
6223.00†	2.584	289.896	6093.63	470.61	367.89	-1016.50	3268099.41	1587928.77	2.00	
6323.00†	0.584	289.896	6193.59	471.81	368.83	-1019.10	3268096.80	1587929.68	2.00	
6352.21	0.000	359.679	6222.80	471.88	368.88	-1019.24	3268096.66	1587929.73	2.00	End of Drop
6423.00†	0.000	359.679	6293.59	471.88	368.88	-1019.24	3268096.66	1587929.73	0.00	
6523.00†	0.000	359.679	6393.59	471.88	368.88	-1019.24	3268096.66	1587929.73	0.00	
6623.00†	0.000	359.679	6493.59	471.88	368.88	-1019.24	3268096.66	1587929.73	0.00	
6723.00†	0.000	359.679	6593.59	471.88	368.88	-1019.24	3268096.66	1587929.73	0.00	
6823.00†	0.000	359.679	6693.59	471.88	368.88	-1019.24	3268096.66	1587929.73	0.00	
6923.00†	0.000	359.679	6793.59	471.88	368.88	-1019.24	3268096.66	1587929.73	0.00	
7023.00†	0.000	359.679	6893.59	471.88	368.88	-1019.24	3268096.66	1587929.73	0.00	
7123.00†	0.000	359.679	6993.59	471.88	368.88	-1019.24	3268096.66	1587929.73	0.00	
7223.00†	0.000	359.679	7093.59	471.88	368.88	-1019.24	3268096.66	1587929.73	0.00	
7323.00†	0.000	359.679	7193.59	471.88	368.88	-1019.24	3268096.66	1587929.73	0.00	
7352.21	0.000	359.679	7222.80	471.88	368.88	-1019.24	3268096.66	1587929.73	0.00	End of Tangent
7423.00†	5.663	359.679	7293.47	475.36	372.38	-1019.26	3268096.60	1587933.23	8.00	
7523.00†	13.663	359.679	7391.98	492.05	389.15	-1019.35	3268096.32	1587950.00	8.00	
7623.00†	21.663	359.679	7487.18	522.22	419.46	-1019.52	3268095.82	1587980.31	8.00	
7723.00†	29.663	359.679	7577.25	565.29	462.73	-1019.76	3268095.10	1588023.58	8.00	
7823.00†	37.663	359.679	7660.41	620.41	518.12	-1020.07	3268094.18	1588078.96	8.00	
7923.00†	45.663	359.679	7735.06	686.51	584.54	-1020.44	3268093.08	1588145.37	8.00	
8023.00†	53.663	359.679	7799.73	762.31	660.70	-1020.87	3268091.82	1588221.53	8.00	
8123.00†	61.663	359.679	7853.18	846.34	745.12	-1021.34	3268090.42	1588305.94	8.00	
8223.00†	69.663	359.679	7894.36	936.94	836.16	-1021.85	3268088.91	1588396.97	8.00	
8323.00†	77.663	359.679	7922.46	1032.37	932.04	-1022.39	3268087.32	1588492.84	8.00	

# Planned Wellpath Report

SALT RANCH FEE 502-1034H (REV-A.0) PWP

Page 4 of 7

REFERENCE WELLPATH IDENTIFICATION			
Operator	CCRP OPERATING INC.	Slot	SLOT#02 SALT RANCH FEE 502-1034H (357'FNL & 637'FEL, SEC.10)
Area	COLORADO	Well	SALT RANCH FEE 502-1034H
Field	WELD COUNTY (NAD 83/TN)	Wellbore	SALT RANCH FEE 502-1034H PWB
Facility	SEC.10-T11N-R64W		

WELLPATH DATA (186 stations) † = interpolated/extrapolated station										
MD [ft]	Inclination [°]	Azimuth [°]	TVD [ft]	Vert Sect [ft]	North [ft]	East [ft]	Grid East [US ft]	Grid North [US ft]	DLS [°/100ft]	Comments
8423.00†	85.663	359.679	7936.95	1130.76	1030.91	-1022.94	3268085.68	1588591.70	8.00	
8477.21	90.000	359.679	7939.00†	1184.67	1085.07	-1023.25	3268084.78	1588645.85	8.00	End of Build
8523.00†	90.000	359.679	7939.00	1230.24	1130.85	-1023.50	3268084.02	1588691.63	0.00	
8623.00†	90.000	359.679	7939.00	1329.76	1230.85	-1024.06	3268082.36	1588791.62	0.00	
8723.00†	90.000	359.679	7939.00	1429.29	1330.85	-1024.62	3268080.71	1588891.61	0.00	
8823.00†	90.000	359.679	7939.00	1528.81	1430.85	-1025.18	3268079.05	1588991.60	0.00	
8923.00†	90.000	359.679	7939.00	1628.34	1530.85	-1025.74	3268077.39	1589091.59	0.00	
9023.00†	90.000	359.679	7939.00	1727.86	1630.84	-1026.30	3268075.73	1589191.58	0.00	
9123.00†	90.000	359.679	7939.00	1827.38	1730.84	-1026.86	3268074.07	1589291.57	0.00	
9223.00†	90.000	359.679	7939.00	1926.91	1830.84	-1027.42	3268072.41	1589391.56	0.00	
9323.00†	90.000	359.679	7939.00	2026.43	1930.84	-1027.98	3268070.76	1589491.55	0.00	
9423.00†	90.000	359.679	7939.00	2125.96	2030.84	-1028.54	3268069.10	1589591.53	0.00	
9523.00†	90.000	359.679	7939.00	2225.48	2130.84	-1029.10	3268067.44	1589691.52	0.00	
9623.00†	90.000	359.679	7939.00	2325.01	2230.83	-1029.66	3268065.78	1589791.51	0.00	
9723.00†	90.000	359.679	7939.00	2424.53	2330.83	-1030.22	3268064.12	1589891.50	0.00	
9823.00†	90.000	359.679	7939.00	2524.06	2430.83	-1030.78	3268062.46	1589991.49	0.00	
9923.00†	90.000	359.679	7939.00	2623.58	2530.83	-1031.34	3268060.81	1590091.48	0.00	
10023.00†	90.000	359.679	7939.00	2723.10	2630.83	-1031.90	3268059.15	1590191.47	0.00	
10123.00†	90.000	359.679	7939.00	2822.63	2730.83	-1032.46	3268057.49	1590291.46	0.00	
10223.00†	90.000	359.679	7939.00	2922.15	2830.83	-1033.02	3268055.83	1590391.45	0.00	
10323.00†	90.000	359.679	7939.00	3021.68	2930.82	-1033.58	3268054.17	1590491.44	0.00	
10423.00†	90.000	359.679	7939.00	3121.20	3030.82	-1034.14	3268052.51	1590591.42	0.00	
10523.00†	90.000	359.679	7939.00	3220.73	3130.82	-1034.70	3268050.86	1590691.41	0.00	
10623.00†	90.000	359.679	7939.00	3320.25	3230.82	-1035.26	3268049.20	1590791.40	0.00	
10723.00†	90.000	359.679	7939.00	3419.78	3330.82	-1035.82	3268047.54	1590891.39	0.00	
10823.00†	90.000	359.679	7939.00	3519.30	3430.82	-1036.38	3268045.88	1590991.38	0.00	
10923.00†	90.000	359.679	7939.00	3618.82	3530.81	-1036.94	3268044.22	1591091.37	0.00	
11023.00†	90.000	359.679	7939.00	3718.35	3630.81	-1037.50	3268042.56	1591191.36	0.00	
11123.00†	90.000	359.679	7939.00	3817.87	3730.81	-1038.06	3268040.91	1591291.35	0.00	
11223.00†	90.000	359.679	7939.00	3917.40	3830.81	-1038.62	3268039.25	1591391.34	0.00	
11323.00†	90.000	359.679	7939.00	4016.92	3930.81	-1039.18	3268037.59	1591491.33	0.00	
11423.00†	90.000	359.679	7939.00	4116.45	4030.81	-1039.74	3268035.93	1591591.31	0.00	
11523.00†	90.000	359.679	7939.00	4215.97	4130.80	-1040.30	3268034.27	1591691.30	0.00	
11623.00†	90.000	359.679	7939.00	4315.50	4230.80	-1040.86	3268032.61	1591791.29	0.00	
11723.00†	90.000	359.679	7939.00	4415.02	4330.80	-1041.42	3268030.96	1591891.28	0.00	
11823.00†	90.000	359.679	7939.00	4514.54	4430.80	-1041.98	3268029.30	1591991.27	0.00	
11923.00†	90.000	359.679	7939.00	4614.07	4530.80	-1042.54	3268027.64	1592091.26	0.00	
12023.00†	90.000	359.679	7939.00	4713.59	4630.80	-1043.10	3268025.98	1592191.25	0.00	
12123.00†	90.000	359.679	7939.00	4813.12	4730.80	-1043.66	3268024.32	1592291.24	0.00	
12223.00†	90.000	359.679	7939.00	4912.64	4830.79	-1044.22	3268022.66	1592391.23	0.00	
12323.00†	90.000	359.679	7939.00	5012.17	4930.79	-1044.78	3268021.01	1592491.22	0.00	
12423.00†	90.000	359.679	7939.00	5111.69	5030.79	-1045.34	3268019.35	1592591.21	0.00	
12523.00†	90.000	359.679	7939.00	5211.22	5130.79	-1045.90	3268017.69	1592691.19	0.00	
12623.00†	90.000	359.679	7939.00	5310.74	5230.79	-1046.46	3268016.03	1592791.18	0.00	
12723.00†	90.000	359.679	7939.00	5410.27	5330.79	-1047.02	3268014.37	1592891.17	0.00	

# Planned Wellpath Report

SALT RANCH FEE 502-1034H (REV-A.0) PWP  
Page 5 of 7

REFERENCE WELLPATH IDENTIFICATION			
Operator	CCRP OPERATING INC.	Slot	SLOT#02 SALT RANCH FEE 502-1034H (357'FNL & 637'FEL, SEC.10)
Area	COLORADO	Well	SALT RANCH FEE 502-1034H
Field	WELD COUNTY (NAD 83/TN)	Wellbore	SALT RANCH FEE 502-1034H PWB
Facility	SEC.10-T11N-R64W		

WELLPATH DATA (186 stations) † = interpolated/extrapolated station										
MD [ft]	Inclination [°]	Azimuth [°]	TVD [ft]	Vert Sect [ft]	North [ft]	East [ft]	Grid East [US ft]	Grid North [US ft]	DLS [°/100ft]	Comments
12823.00†	90.000	359.679	7939.00	5509.79	5430.78	-1047.58	3268012.71	1592991.16	0.00	
12923.00†	90.000	359.679	7939.00	5609.31	5530.78	-1048.14	3268011.05	1593091.15	0.00	
13023.00†	90.000	359.679	7939.00	5708.84	5630.78	-1048.70	3268009.40	1593191.14	0.00	
13123.00†	90.000	359.679	7939.00	5808.36	5730.78	-1049.26	3268007.74	1593291.13	0.00	
13223.00†	90.000	359.679	7939.00	5907.89	5830.78	-1049.82	3268006.08	1593391.12	0.00	
13323.00†	90.000	359.679	7939.00	6007.41	5930.78	-1050.38	3268004.42	1593491.11	0.00	
13423.00†	90.000	359.679	7939.00	6106.94	6030.78	-1050.94	3268002.76	1593591.10	0.00	
13523.00†	90.000	359.679	7939.00	6206.46	6130.77	-1051.50	3268001.10	1593691.08	0.00	
13623.00†	90.000	359.679	7939.00	6305.99	6230.77	-1052.06	3267999.45	1593791.07	0.00	
13723.00†	90.000	359.679	7939.00	6405.51	6330.77	-1052.62	3267997.79	1593891.06	0.00	
13823.00†	90.000	359.679	7939.00	6505.03	6430.77	-1053.18	3267996.13	1593991.05	0.00	
13923.00†	90.000	359.679	7939.00	6604.56	6530.77	-1053.74	3267994.47	1594091.04	0.00	
14023.00†	90.000	359.679	7939.00	6704.08	6630.77	-1054.30	3267992.81	1594191.03	0.00	
14123.00†	90.000	359.679	7939.00	6803.61	6730.76	-1054.86	3267991.15	1594291.02	0.00	
14223.00†	90.000	359.679	7939.00	6903.13	6830.76	-1055.42	3267989.50	1594391.01	0.00	
14323.00†	90.000	359.679	7939.00	7002.66	6930.76	-1055.98	3267987.84	1594491.00	0.00	
14423.00†	90.000	359.679	7939.00	7102.18	7030.76	-1056.54	3267986.18	1594590.99	0.00	
14523.00†	90.000	359.679	7939.00	7201.71	7130.76	-1057.10	3267984.52	1594690.97	0.00	
14623.00†	90.000	359.679	7939.00	7301.23	7230.76	-1057.66	3267982.86	1594790.96	0.00	
14723.00†	90.000	359.679	7939.00	7400.75	7330.75	-1058.22	3267981.20	1594890.95	0.00	
14823.00†	90.000	359.679	7939.00	7500.28	7430.75	-1058.78	3267979.55	1594990.94	0.00	
14923.00†	90.000	359.679	7939.00	7599.80	7530.75	-1059.34	3267977.89	1595090.93	0.00	
15023.00†	90.000	359.679	7939.00	7699.33	7630.75	-1059.90	3267976.23	1595190.92	0.00	
15123.00†	90.000	359.679	7939.00	7798.85	7730.75	-1060.46	3267974.57	1595290.91	0.00	
15223.00†	90.000	359.679	7939.00	7898.38	7830.75	-1061.02	3267972.91	1595390.90	0.00	
15323.00†	90.000	359.679	7939.00	7997.90	7930.75	-1061.58	3267971.25	1595490.89	0.00	
15423.00†	90.000	359.679	7939.00	8097.43	8030.74	-1062.14	3267969.60	1595590.88	0.00	
15523.00†	90.000	359.679	7939.00	8196.95	8130.74	-1062.70	3267967.94	1595690.86	0.00	
15623.00†	90.000	359.679	7939.00	8296.47	8230.74	-1063.26	3267966.28	1595790.85	0.00	
15723.00†	90.000	359.679	7939.00	8396.00	8330.74	-1063.82	3267964.62	1595890.84	0.00	
15823.00†	90.000	359.679	7939.00	8495.52	8430.74	-1064.38	3267962.96	1595990.83	0.00	
15923.00†	90.000	359.679	7939.00	8595.05	8530.74	-1064.94	3267961.30	1596090.82	0.00	
16023.00†	90.000	359.679	7939.00	8694.57	8630.73	-1065.50	3267959.65	1596190.81	0.00	
16123.00†	90.000	359.679	7939.00	8794.10	8730.73	-1066.06	3267957.99	1596290.80	0.00	
16223.00†	90.000	359.679	7939.00	8893.62	8830.73	-1066.62	3267956.33	1596390.79	0.00	
16323.00†	90.000	359.679	7939.00	8993.15	8930.73	-1067.18	3267954.67	1596490.78	0.00	
16423.00†	90.000	359.679	7939.00	9092.67	9030.73	-1067.74	3267953.01	1596590.77	0.00	
16523.00†	90.000	359.679	7939.00	9192.19	9130.73	-1068.30	3267951.35	1596690.75	0.00	
16623.00†	90.000	359.679	7939.00	9291.72	9230.72	-1068.86	3267949.70	1596790.74	0.00	
16723.00†	90.000	359.679	7939.00	9391.24	9330.72	-1069.41	3267948.04	1596890.73	0.00	
16823.00†	90.000	359.679	7939.00	9490.77	9430.72	-1069.97	3267946.38	1596990.72	0.00	
16923.00†	90.000	359.679	7939.00	9590.29	9530.72	-1070.53	3267944.72	1597090.71	0.00	
17023.00†	90.000	359.679	7939.00	9689.82	9630.72	-1071.09	3267943.06	1597190.70	0.00	
17123.00†	90.000	359.679	7939.00	9789.34	9730.72	-1071.65	3267941.40	1597290.69	0.00	
17223.00†	90.000	359.679	7939.00	9888.87	9830.72	-1072.21	3267939.75	1597390.68	0.00	

# Planned Wellpath Report

SALT RANCH FEE 502-1034H (REV-A.0) PWP

Page 6 of 7

REFERENCE WELLPATH IDENTIFICATION			
Operator	CCRP OPERATING INC.	Slot	SLOT#02 SALT RANCH FEE 502-1034H (357'FNL & 637'FEL, SEC.10)
Area	COLORADO	Well	SALT RANCH FEE 502-1034H
Field	WELD COUNTY (NAD 83/TN)	Wellbore	SALT RANCH FEE 502-1034H PWB
Facility	SEC.10-T11N-R64W		

WELLPATH DATA (186 stations) † = interpolated/extrapolated station										
MD [ft]	Inclination [°]	Azimuth [°]	TVD [ft]	Vert Sect [ft]	North [ft]	East [ft]	Grid East [US ft]	Grid North [US ft]	DLS [°/100ft]	Comments
17323.00†	90.000	359.679	7939.00	9988.39	9930.71	-1072.77	3267938.09	1597490.67	0.00	
17423.00†	90.000	359.679	7939.00	10087.92	10030.71	-1073.33	3267936.43	1597590.66	0.00	
17523.00†	90.000	359.679	7939.00	10187.44	10130.71	-1073.89	3267934.77	1597690.64	0.00	
17623.00†	90.000	359.679	7939.00	10286.96	10230.71	-1074.45	3267933.11	1597790.63	0.00	
17723.00†	90.000	359.679	7939.00	10386.49	10330.71	-1075.01	3267931.45	1597890.62	0.00	
17779.18	90.000	359.679	7939.00 <sup>2</sup>	10442.40	10386.89	-1075.33	3267930.52	1597946.80	0.00	End of Tangent

TARGETS										
Name	MD [ft]	TVD [ft]	North [ft]	East [ft]	Grid East [US ft]	Grid North [US ft]	Latitude	Longitude	Shape	
SEC.02-T11N-R64W		0.00	-0.30	30.16	3269150.08	1587572.09	40°56'31.888"N	104°31'32.869"W	polygon	
SEC.03-T11N-R64W		0.00	-0.30	30.16	3269150.08	1587572.09	40°56'31.888"N	104°31'32.869"W	polygon	
SEC.10-T11N-R64W		0.00	-0.30	30.16	3269150.08	1587572.09	40°56'31.888"N	104°31'32.869"W	polygon	
SEC.15-T11N-R64W		0.00	-0.30	30.16	3269150.08	1587572.09	40°56'31.888"N	104°31'32.869"W	polygon	
SEC.34-T12N-R64W		0.00	-0.30	30.16	3269150.08	1587572.09	40°56'31.888"N	104°31'32.869"W	polygon	
SEC.35-T12N-R64W		0.00	-0.30	30.16	3269150.08	1587572.09	40°56'31.888"N	104°31'32.869"W	polygon	
SALT RANCH FEE 201-1015H HARDLINES (300' SETBACKS)		7905.00	-0.30	30.16	3269150.08	1587572.09	40°56'31.888"N	104°31'32.869"W	polygon	
SALT RANCH FEE 502-1034H HARDLINES (600' SETBACKS)		7905.00	-0.30	30.16	3269150.08	1587572.09	40°56'31.888"N	104°31'32.869"W	polygon	
SALT RANCH FEE 506-1035H HARDLINES (600' SETBACKS)		7905.00	-0.30	30.16	3269150.08	1587572.09	40°56'31.888"N	104°31'32.869"W	polygon	
2) SALT RANCH FEE 502-1034H BHL REV-1 (600'FNL & 1620'FEL, SEC.34)	17779.18	7939.00	10386.89	-1075.33	3267930.52	1597946.80	40°58'14.520"N	104°31'47.280"W	point	
1) SALT RANCH FEE 502-1034H LPL REV-1 (735'FSL & 1620'FEL, SEC.3)	8477.21	7939.00	1085.07	-1023.25	3268084.78	1588645.85	40°56'42.612"N	104°31'46.596"W	point	

SURVEY PROGRAM - Ref Wellbore: SALT RANCH FEE 502-1034H PWB Ref Wellpath: SALT RANCH FEE 502-1034H (REV-A.0) PWP				
Start MD [ft]	End MD [ft]	Positional Uncertainty Model	Log Name/Comment	Wellbore
23.00	17779.18	BHI NaviTrak (Rotating+Axial Corr)		SALT RANCH FEE 502-1034H PWB

# Planned Wellpath Report

SALT RANCH FEE 502-1034H (REV-A.0) PWP

Page 7 of 7

REFERENCE WELLPATH IDENTIFICATION			
Operator	CCRP OPERATING INC.	Slot	SLOT#02 SALT RANCH FEE 502-1034H (357'FNL & 637'FEL, SEC.10)
Area	COLORADO	Well	SALT RANCH FEE 502-1034H
Field	WELD COUNTY (NAD 83/TN)	Wellbore	SALT RANCH FEE 502-1034H PWB
Facility	SEC.10-T11N-R64W		

DESIGN COMMENTS				
MD [ft]	Inclination [°]	Azimuth [°]	TVD [ft]	Comment
23.00	0.000	289.896	23.00	Tie On
1200.00	0.000	289.896	1200.00	End of Tangent
2171.88	14.578	289.896	2161.43	End of Build
5623.30	14.578	289.896	5501.73	End of Tangent
6352.21	0.000	359.679	6222.80	End of Drop
7352.21	0.000	359.679	7222.80	End of Tangent
8477.21	90.000	359.679	7939.00	End of Build
17779.18	90.000	359.679	7939.00	End of Tangent