

SRC ENERGY

Location: COLORADO Slot: SLOT#08 BOST FARM 33C-11-L (2666'FSL & 1194'FWL, SEC.07)
Field: WELD COUNTY (NAD83, TRUE NORTH) Well: BOST FARM 33C-11-L
Facility: SEC-07-T05N-R66W Wellbore: BOST FARM 33C-11-L. PWB

Plot reference well/path is BOST FARM 33C-11-L (REV-C.0) PWP	Grid System: NAD83 / Lambert Colorado SP, Northern Zone (501), US feet
True vertical depths are referenced to IKON 12 (4) (RKB)	North Reference: True north
Measured depths are referenced to IKON 12 (4) (RKB)	Scale: True distance
IKON 12 (4) (RKB) to Mean Sea Level: 4878 feet	Depths are in feet
Mean Sea Level to Mud line (At Slot: SLOT#08 BOST FARM 33C-11-L (2666'FSL & 1194'FWL, SEC.07): 0 feet	Created by: hanisab on 2019-01-03
Coordinates are in feet referenced to Slot	Database: WA DENVER

Location Information

Facility Name				Grid East (US ft)	Grid North (US ft)	Latitude	Longitude
SEC.07-T05N-R66W				3187161.591	1394309.789	40°24'49.806"N	104°49'40.249"W
Slot	Local N (ft)	Local E (ft)	Grid East (US ft)	Grid North (US ft)	Latitude	Longitude	
SLOT#08 BOST FARM 33C-11-L (2666'FSL & 1194'FWL, SEC.07)	114.39	-64.34	3187096.388	1394423.688	40°24'50.936"N	104°49'41.081"W	
IKON 12 (4) (RKB) to Mud line (At Slot: SLOT#08 BOST FARM 33C-11-L (2666'FSL & 1194'FWL, SEC.07))						487ft	
Mean Sea Level to Mud line (At Slot: SLOT#08 BOST FARM 33C-11-L (2666'FSL & 1194'FWL, SEC.07))						0ft	
IKON 12 (4) (RKB) to Mean Sea Level						487ft	

Survey Program

Start MD (ft)	End MD (ft)	Tool	Model	Log Name/Comment	Wellbore
4.00	1750.00	BHI NavTrak	BHI NavTrak (Axial)		BOST FARM 33C-11-L. PWB
1750.00	18128.51	BHI AutoTrak Curve	BHI AutoTrak Curve (MagCAD+IFR1, Short spacing)		BOST FARM 33C-11-L. PWB

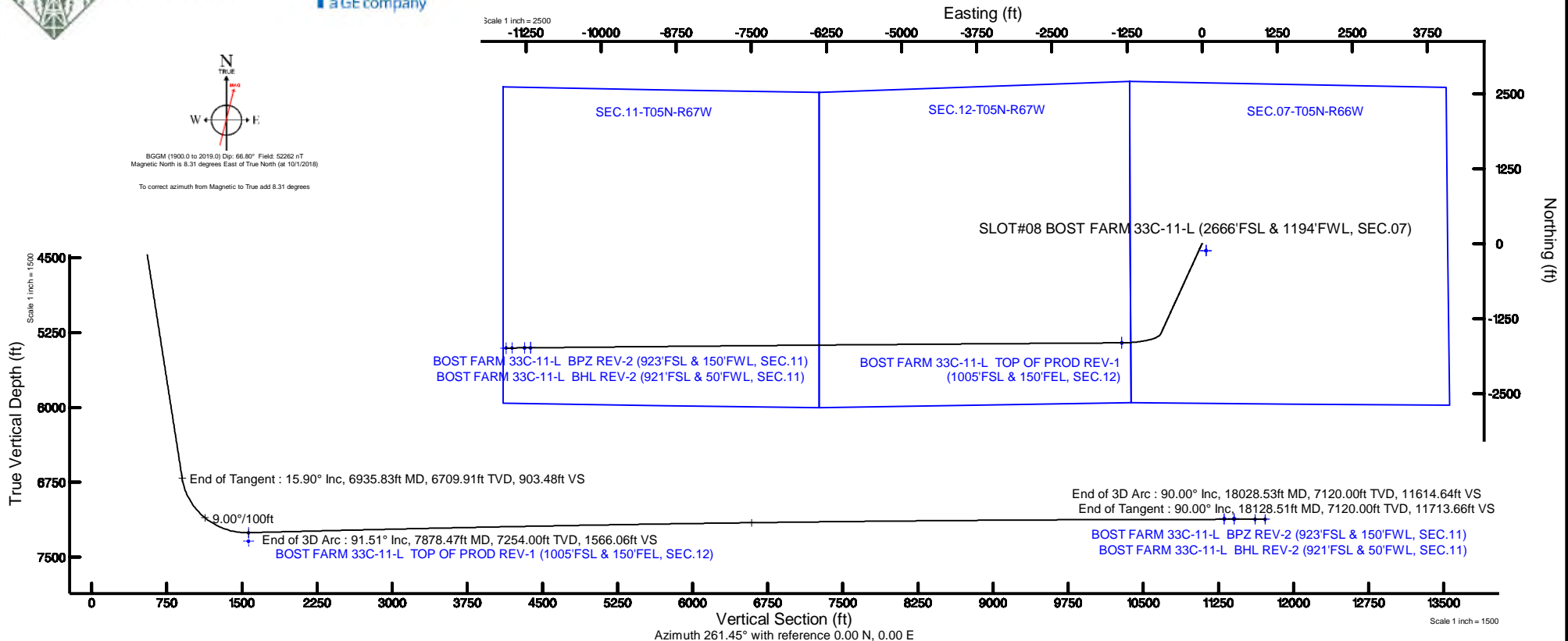
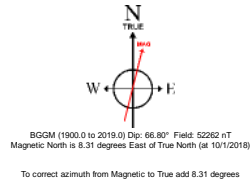

BOST FARM 33C-11-L (REV-C.0) LAS.las

~VERSION INFORMATION

VERS. 2.0 : CWLS LOG ASCII STANDARD-VERSION 2.0

WRAP. NO : ASCII DATA SECTION CONTAINS ONE ROW PER WELLPATH STATION

~WELL INFORMATION

#MNEM	.UNITS	DATA	:DESCRIPTION
#----	.-----	----	:-----
STRT	.ft	0.00	:START MD
STOP	.ft	18128.51	:STOP MD
STEP	.ft	0.0	:STEP (non-uniform increment)
NULL	.	-999.99	:NULL
COMP	.	SRC ENERGY	:OPERATOR
WELL	.	BOST FARM 33C-11-L	:WELL
FLD	.	WELD COUNTY (NAD83,TRUE NORTH)	:FIELD
LOC	.	COLORADO	:AREA (aka: Location)
CNTY	.	N/A	:COUNTY
STAT	.	N/A	:STATE
CTRY	.	N/A	:COUNTRY
SRVC	.	Baker Hughes	:CONTRACTOR
DATE	.	09/25/2018	:LOG REV DATE
API	.		:API NUMBER

~OTHER INFORMATION

#Software: WellArchitect(R) Version 5.1

#MNEM	.UNITS	DATA	:DESCRIPTION
#----	.-----	----	:-----
WPTYPE	.	PLANNED WELLPATH	:WELLPATH TYPE
FACILITY	.	SEC.07-T05N-R66W	:FACILITY
SLOT	.	SLOT#08 BOST FARM 33C-11-L (2666'FSL & 1194'FWL, SEC.07):SLOT	:SLOT
WELLBORE	.	BOST FARM 33C-11-L PWB	:WELLBORE
WELLPATH	.	BOST FARM 33C-11-L (REV-C.0) PWP	:WELLPATH
MDREFPT	.	IKON 12 (4') (RKB)	:MD REFERENCE POINT
TVDREFPT	.	IKON 12 (4') (RKB)	:TVD REFERENCE POINT
LCLREFPT	.	Slot	:LOCAL COORDINATE REFERENCE PT

BOST FARM 33C-11-L (REV-C.0) LAS.las

VSAZIMUTH.deg	261.45	:VERTICAL SECTION AZIMUTH
VSORIGN .ft	0.00	:VERTICAL SECTION ORIGIN NORTH
VSORIGE .ft	0.00	:VERTICAL SECTION ORIGIN EAST

~CURVE (WELLPATH) INFORMATION

#MNEM	.UNITS	:DESCRIPTION
#----	.-----	:-----
DEPT	.ft	:MEASURED DEPTH
INC	.deg	:INCLINATION
AZI	.deg	:AZIMUTH
TVD	.ft	:TRUE VERTICAL DEPTH
SECT	.ft	:CROSS SECTION (CURTAIN/VERTICAL)
LOCALN	.ft	:LOCAL NORTH
LOCALE	.ft	:LOCAL EAST
LAT	.deg	:LATITUDE
LONG	.deg	:LONGITUDE
DLS	.deg/100ft	:DOGLEG SEVERITY

~ASCII DATA

0.00	0.00	204.54	0.00	0.00	0.00	0.00	40.4141490	-104.8280780	0.00
4.00	0.00	204.54	4.00	0.00	0.00	0.00	40.4141490	-104.8280780	0.00
104.00	0.00	204.54	104.00	0.00	0.00	0.00	40.4141490	-104.8280780	0.00
204.00	0.00	204.54	204.00	0.00	0.00	0.00	40.4141490	-104.8280780	0.00
304.00	0.00	204.54	304.00	0.00	0.00	0.00	40.4141490	-104.8280780	0.00
404.00	0.00	204.54	404.00	0.00	0.00	0.00	40.4141490	-104.8280780	0.00
500.00	0.00	204.54	500.00	0.00	0.00	0.00	40.4141490	-104.8280780	0.00
504.00	0.08	204.54	504.00	0.00	0.00	0.00	40.4141490	-104.8280780	2.00
604.00	2.08	204.54	603.98	1.03	-1.72	-0.78	40.4141443	-104.8280808	2.00
704.00	4.08	204.54	703.83	3.96	-6.60	-3.02	40.4141309	-104.8280888	2.00
804.00	6.08	204.54	803.43	8.80	-14.66	-6.69	40.4141088	-104.8281020	2.00
904.00	8.08	204.54	902.66	15.53	-25.87	-11.81	40.4140780	-104.8281204	2.00
1004.00	10.08	204.54	1001.40	24.14	-40.22	-18.37	40.4140386	-104.8281440	2.00
1104.00	12.08	204.54	1099.54	34.64	-57.71	-26.35	40.4139906	-104.8281726	2.00
1204.00	14.08	204.54	1196.94	46.99	-78.29	-35.75	40.4139341	-104.8282064	2.00

BOST FARM 33C-11-L (REV-C.0) LAS.las

1294.89	15.90	204.54	1284.73	59.83	-99.67	-45.52	40.4138754	-104.8282414	2.00
1304.00	15.90	204.54	1293.49	61.19	-101.94	-46.55	40.4138692	-104.8282452	0.00
1404.00	15.90	204.54	1389.67	76.14	-126.86	-57.93	40.4138008	-104.8282860	0.00
1504.00	15.90	204.54	1485.84	91.10	-151.78	-69.31	40.4137324	-104.8283269	0.00
1604.00	15.90	204.54	1582.02	106.06	-176.69	-80.69	40.4136640	-104.8283678	0.00
1704.00	15.90	204.54	1678.19	121.01	-201.61	-92.06	40.4135956	-104.8284086	0.00
1804.00	15.90	204.54	1774.37	135.97	-226.53	-103.44	40.4135272	-104.8284495	0.00
1904.00	15.90	204.54	1870.54	150.92	-251.45	-114.82	40.4134588	-104.8284903	0.00
2004.00	15.90	204.54	1966.72	165.88	-276.36	-126.20	40.4133904	-104.8285312	0.00
2104.00	15.90	204.54	2062.89	180.83	-301.28	-137.58	40.4133220	-104.8285721	0.00
2204.00	15.90	204.54	2159.07	195.79	-326.20	-148.96	40.4132536	-104.8286129	0.00
2304.00	15.90	204.54	2255.24	210.75	-351.12	-160.33	40.4131852	-104.8286538	0.00
2404.00	15.90	204.54	2351.42	225.70	-376.03	-171.71	40.4131168	-104.8286946	0.00
2504.00	15.90	204.54	2447.59	240.66	-400.95	-183.09	40.4130484	-104.8287355	0.00
2604.00	15.90	204.54	2543.77	255.61	-425.87	-194.47	40.4129800	-104.8287764	0.00
2704.00	15.90	204.54	2639.94	270.57	-450.79	-205.85	40.4129116	-104.8288172	0.00
2804.00	15.90	204.54	2736.12	285.53	-475.70	-217.23	40.4128432	-104.8288581	0.00
2904.00	15.90	204.54	2832.29	300.48	-500.62	-228.60	40.4127748	-104.8288989	0.00
3004.00	15.90	204.54	2928.47	315.44	-525.54	-239.98	40.4127065	-104.8289398	0.00
3104.00	15.90	204.54	3024.64	330.39	-550.46	-251.36	40.4126381	-104.8289806	0.00
3204.00	15.90	204.54	3120.82	345.35	-575.37	-262.74	40.4125697	-104.8290215	0.00
3304.00	15.90	204.54	3216.99	360.31	-600.29	-274.12	40.4125013	-104.8290624	0.00
3404.00	15.90	204.54	3313.17	375.26	-625.21	-285.50	40.4124329	-104.8291032	0.00
3504.00	15.90	204.54	3409.34	390.22	-650.12	-296.87	40.4123645	-104.8291441	0.00
3604.00	15.90	204.54	3505.52	405.17	-675.04	-308.25	40.4122961	-104.8291849	0.00
3704.00	15.90	204.54	3601.69	420.13	-699.96	-319.63	40.4122277	-104.8292258	0.00
3804.00	15.90	204.54	3697.87	435.08	-724.88	-331.01	40.4121593	-104.8292667	0.00
3904.00	15.90	204.54	3794.04	450.04	-749.79	-342.39	40.4120909	-104.8293075	0.00
4004.00	15.90	204.54	3890.22	465.00	-774.71	-353.76	40.4120225	-104.8293484	0.00
4104.00	15.90	204.54	3986.40	479.95	-799.63	-365.14	40.4119541	-104.8293892	0.00
4204.00	15.90	204.54	4082.57	494.91	-824.55	-376.52	40.4118857	-104.8294301	0.00
4304.00	15.90	204.54	4178.75	509.86	-849.46	-387.90	40.4118173	-104.8294710	0.00
4404.00	15.90	204.54	4274.92	524.82	-874.38	-399.28	40.4117489	-104.8295118	0.00
4504.00	15.90	204.54	4371.10	539.78	-899.30	-410.66	40.4116805	-104.8295527	0.00

BOST FARM 33C-11-L (REV-C.0) LAS.las

4604.00	15.90	204.54	4467.27	554.73	-924.22	-422.03	40.4116121	-104.8295935	0.00
4704.00	15.90	204.54	4563.45	569.69	-949.13	-433.41	40.4115437	-104.8296344	0.00
4804.00	15.90	204.54	4659.62	584.64	-974.05	-444.79	40.4114753	-104.8296752	0.00
4904.00	15.90	204.54	4755.80	599.60	-998.97	-456.17	40.4114069	-104.8297161	0.00
5004.00	15.90	204.54	4851.97	614.56	-1023.89	-467.55	40.4113385	-104.8297570	0.00
5104.00	15.90	204.54	4948.15	629.51	-1048.80	-478.93	40.4112701	-104.8297978	0.00
5204.00	15.90	204.54	5044.32	644.47	-1073.72	-490.30	40.4112017	-104.8298387	0.00
5304.00	15.90	204.54	5140.50	659.42	-1098.64	-501.68	40.4111333	-104.8298795	0.00
5404.00	15.90	204.54	5236.67	674.38	-1123.56	-513.06	40.4110649	-104.8299204	0.00
5504.00	15.90	204.54	5332.85	689.33	-1148.47	-524.44	40.4109966	-104.8299612	0.00
5604.00	15.90	204.54	5429.02	704.29	-1173.39	-535.82	40.4109282	-104.8300021	0.00
5704.00	15.90	204.54	5525.20	719.25	-1198.31	-547.20	40.4108598	-104.8300430	0.00
5804.00	15.90	204.54	5621.37	734.20	-1223.22	-558.57	40.4107914	-104.8300838	0.00
5904.00	15.90	204.54	5717.55	749.16	-1248.14	-569.95	40.4107230	-104.8301247	0.00
6004.00	15.90	204.54	5813.72	764.11	-1273.06	-581.33	40.4106546	-104.8301655	0.00
6104.00	15.90	204.54	5909.90	779.07	-1297.98	-592.71	40.4105862	-104.8302064	0.00
6204.00	15.90	204.54	6006.07	794.03	-1322.89	-604.09	40.4105178	-104.8302472	0.00
6304.00	15.90	204.54	6102.25	808.98	-1347.81	-615.47	40.4104494	-104.8302881	0.00
6404.00	15.90	204.54	6198.42	823.94	-1372.73	-626.84	40.4103810	-104.8303290	0.00
6504.00	15.90	204.54	6294.60	838.89	-1397.65	-638.22	40.4103126	-104.8303698	0.00
6604.00	15.90	204.54	6390.77	853.85	-1422.56	-649.60	40.4102442	-104.8304107	0.00
6704.00	15.90	204.54	6486.95	868.80	-1447.48	-660.98	40.4101758	-104.8304515	0.00
6804.00	15.90	204.54	6583.12	883.76	-1472.40	-672.36	40.4101074	-104.8304924	0.00
6904.00	15.90	204.54	6679.30	898.72	-1497.32	-683.74	40.4100390	-104.8305332	0.00
6935.83	15.90	204.54	6709.91	903.48	-1505.25	-687.36	40.4100172	-104.8305462	0.00
7004.00	19.24	221.71	6774.94	917.23	-1522.14	-698.72	40.4099709	-104.8305870	9.00
7104.00	26.00	237.37	6867.27	949.98	-1546.31	-728.21	40.4099045	-104.8306929	9.00
7204.00	33.77	246.59	6953.95	996.95	-1569.22	-772.26	40.4098416	-104.8308511	9.00
7304.00	41.98	252.61	7032.85	1056.98	-1590.30	-829.80	40.4097837	-104.8310577	9.00
7404.00	50.42	256.95	7102.02	1128.59	-1609.04	-899.40	40.4097323	-104.8313077	9.00
7504.00	58.99	260.33	7159.75	1210.03	-1624.97	-979.35	40.4096886	-104.8315948	9.00
7604.00	67.63	263.15	7204.63	1299.27	-1637.71	-1067.69	40.4096536	-104.8319120	9.00
7704.00	76.32	265.64	7235.55	1394.14	-1646.93	-1162.23	40.4096283	-104.8322514	9.00
7804.00	85.02	267.95	7251.75	1492.28	-1652.41	-1260.65	40.4096132	-104.8326049	9.00

BOST FARM 33C-11-L (REV-C.0) LAS.las

7878.47	91.51	269.63	7254.00	1566.06	-1653.98	-1335.03	40.4096089	-104.8328719	9.00
7904.00	91.51	269.63	7253.33	1591.33	-1654.15	-1360.55	40.4096084	-104.8329636	0.02
8004.00	91.49	269.62	7250.71	1690.28	-1654.81	-1460.51	40.4096066	-104.8333225	0.02
8104.00	91.48	269.62	7248.11	1789.23	-1655.47	-1560.48	40.4096048	-104.8336815	0.02
8204.00	91.46	269.62	7245.54	1888.18	-1656.13	-1660.44	40.4096029	-104.8340405	0.02
8304.00	91.45	269.62	7243.00	1987.13	-1656.80	-1760.41	40.4096011	-104.8343994	0.02
8404.00	91.44	269.61	7240.48	2086.09	-1657.47	-1860.37	40.4095992	-104.8347584	0.02
8504.00	91.42	269.61	7237.99	2185.05	-1658.14	-1960.34	40.4095974	-104.8351174	0.02
8604.00	91.41	269.61	7235.53	2284.00	-1658.82	-2060.31	40.4095955	-104.8354763	0.02
8704.00	91.39	269.61	7233.09	2382.96	-1659.50	-2160.28	40.4095936	-104.8358353	0.02
8804.00	91.38	269.61	7230.68	2481.92	-1660.19	-2260.25	40.4095917	-104.8361943	0.02
8904.00	91.36	269.60	7228.29	2580.88	-1660.88	-2360.21	40.4095898	-104.8365533	0.02
9004.00	91.35	269.60	7225.93	2679.85	-1661.57	-2460.18	40.4095878	-104.8369123	0.02
9104.00	91.33	269.60	7223.60	2778.81	-1662.27	-2560.15	40.4095859	-104.8372712	0.02
9204.00	91.32	269.60	7221.29	2877.77	-1662.97	-2660.13	40.4095839	-104.8376302	0.02
9304.00	91.30	269.59	7219.01	2976.74	-1663.68	-2760.10	40.4095820	-104.8379892	0.02
9404.00	91.29	269.59	7216.75	3075.71	-1664.39	-2860.07	40.4095800	-104.8383482	0.02
9504.00	91.27	269.59	7214.52	3174.67	-1665.10	-2960.04	40.4095780	-104.8387072	0.02
9604.00	91.26	269.59	7212.31	3273.64	-1665.82	-3060.01	40.4095760	-104.8390662	0.02
9704.00	91.24	269.59	7210.14	3372.61	-1666.54	-3159.99	40.4095740	-104.8394252	0.02
9804.00	91.23	269.58	7207.98	3471.58	-1667.27	-3259.96	40.4095719	-104.8397842	0.02
9904.00	91.21	269.58	7205.86	3570.56	-1667.99	-3359.94	40.4095699	-104.8401432	0.02
10004.00	91.20	269.58	7203.76	3669.53	-1668.73	-3459.91	40.4095679	-104.8405022	0.02
10104.00	91.18	269.58	7201.68	3768.50	-1669.46	-3559.89	40.4095658	-104.8408612	0.02
10204.00	91.17	269.57	7199.63	3867.48	-1670.21	-3659.86	40.4095637	-104.8412202	0.02
10304.00	91.15	269.57	7197.61	3966.46	-1670.95	-3759.84	40.4095616	-104.8415792	0.02
10404.00	91.14	269.57	7195.61	4065.43	-1671.70	-3859.82	40.4095595	-104.8419382	0.02
10504.00	91.12	269.57	7193.64	4164.41	-1672.45	-3959.80	40.4095574	-104.8422972	0.02
10604.00	91.11	269.57	7191.70	4263.39	-1673.21	-4059.77	40.4095553	-104.8426562	0.02
10704.00	91.09	269.56	7189.78	4362.37	-1673.97	-4159.75	40.4095532	-104.8430152	0.02
10804.00	91.08	269.56	7187.89	4461.36	-1674.73	-4259.73	40.4095510	-104.8433742	0.02
10904.00	91.06	269.56	7186.02	4560.34	-1675.50	-4359.71	40.4095489	-104.8437332	0.02
11004.00	91.05	269.56	7184.18	4659.32	-1676.27	-4459.69	40.4095467	-104.8440923	0.02
11104.00	91.03	269.55	7182.37	4758.31	-1677.05	-4559.67	40.4095445	-104.8444513	0.02

BOST FARM 33C-11-L (REV-C.0) LAS.las

11204.00	91.02	269.55	7180.58	4857.29	-1677.83	-4659.65	40.4095423	-104.8448103	0.02
11304.00	91.00	269.55	7178.82	4956.28	-1678.61	-4759.63	40.4095401	-104.8451693	0.02
11404.00	90.99	269.55	7177.08	5055.27	-1679.40	-4859.62	40.4095379	-104.8455283	0.02
11504.00	90.97	269.55	7175.37	5154.26	-1680.19	-4959.60	40.4095357	-104.8458874	0.02
11604.00	90.96	269.54	7173.69	5253.25	-1680.98	-5059.58	40.4095335	-104.8462464	0.02
11704.00	90.94	269.54	7172.03	5352.24	-1681.78	-5159.56	40.4095312	-104.8466054	0.02
11804.00	90.93	269.54	7170.40	5451.23	-1682.59	-5259.55	40.4095289	-104.8469644	0.02
11904.00	90.91	269.54	7168.79	5550.22	-1683.39	-5359.53	40.4095267	-104.8473235	0.02
12004.00	90.90	269.53	7167.21	5649.22	-1684.20	-5459.52	40.4095244	-104.8476825	0.02
12104.00	90.88	269.53	7165.66	5748.21	-1685.02	-5559.50	40.4095221	-104.8480415	0.02
12204.00	90.87	269.53	7164.13	5847.21	-1685.84	-5659.49	40.4095198	-104.8484006	0.02
12304.00	90.85	269.53	7162.63	5946.21	-1686.66	-5759.47	40.4095175	-104.8487596	0.02
12404.00	90.84	269.52	7161.15	6045.20	-1687.48	-5859.46	40.4095151	-104.8491186	0.02
12504.00	90.82	269.52	7159.70	6144.20	-1688.31	-5959.44	40.4095128	-104.8494777	0.02
12604.00	90.81	269.52	7158.27	6243.20	-1689.15	-6059.43	40.4095104	-104.8498367	0.02
12704.00	90.79	269.52	7156.88	6342.20	-1689.99	-6159.42	40.4095081	-104.8501958	0.02
12804.00	90.78	269.52	7155.50	6441.20	-1690.83	-6259.40	40.4095057	-104.8505548	0.02
12904.00	90.76	269.51	7154.16	6540.20	-1691.67	-6359.39	40.4095033	-104.8509138	0.02
13004.00	90.75	269.51	7152.84	6639.21	-1692.52	-6459.38	40.4095009	-104.8512729	0.02
13104.00	90.73	269.51	7151.54	6738.21	-1693.38	-6559.37	40.4094985	-104.8516319	0.02
13204.00	90.72	269.51	7150.28	6837.22	-1694.23	-6659.35	40.4094960	-104.8519910	0.02
13304.00	90.70	269.51	7149.03	6936.22	-1695.09	-6759.34	40.4094936	-104.8523500	0.02
13404.00	90.69	269.50	7147.82	7035.23	-1695.96	-6859.33	40.4094912	-104.8527091	0.02
13504.00	90.67	269.50	7146.63	7134.24	-1696.83	-6959.32	40.4094887	-104.8530681	0.02
13604.00	90.66	269.50	7145.46	7233.24	-1697.70	-7059.31	40.4094862	-104.8534272	0.02
13704.00	90.65	269.50	7144.33	7332.25	-1698.58	-7159.30	40.4094837	-104.8537862	0.02
13804.00	90.63	269.49	7143.21	7431.26	-1699.46	-7259.29	40.4094812	-104.8541453	0.02
13904.00	90.62	269.49	7142.13	7530.27	-1700.34	-7359.28	40.4094787	-104.8545043	0.02
14004.00	90.60	269.49	7141.07	7629.29	-1701.23	-7459.27	40.4094762	-104.8548634	0.02
14104.00	90.59	269.49	7140.03	7728.30	-1702.12	-7559.26	40.4094737	-104.8552224	0.02
14204.00	90.57	269.49	7139.03	7827.31	-1703.02	-7659.25	40.4094711	-104.8555815	0.02
14304.00	90.56	269.48	7138.04	7926.33	-1703.92	-7759.24	40.4094686	-104.8559405	0.02
14404.00	90.54	269.48	7137.09	8025.34	-1704.82	-7859.23	40.4094660	-104.8562996	0.02
14504.00	90.53	269.48	7136.16	8124.36	-1705.73	-7959.23	40.4094634	-104.8566587	0.02

BOST FARM 33C-11-L (REV-C.0) LAS.las

14604.00	90.51	269.48	7135.25	8223.37	-1706.64	-8059.22	40.4094608	-104.8570177	0.02
14704.00	90.50	269.47	7134.38	8322.39	-1707.56	-8159.21	40.4094582	-104.8573768	0.02
14804.00	90.48	269.47	7133.52	8421.41	-1708.48	-8259.20	40.4094556	-104.8577358	0.02
14904.00	90.47	269.47	7132.70	8520.43	-1709.40	-8359.19	40.4094530	-104.8580949	0.02
15004.00	90.45	269.47	7131.90	8619.44	-1710.33	-8459.19	40.4094504	-104.8584540	0.02
15104.00	90.44	269.46	7131.13	8718.47	-1711.26	-8559.18	40.4094477	-104.8588130	0.02
15204.00	90.42	269.46	7130.38	8817.49	-1712.19	-8659.17	40.4094450	-104.8591721	0.02
15304.00	90.41	269.46	7129.66	8916.51	-1713.13	-8759.17	40.4094424	-104.8595311	0.02
15404.00	90.39	269.46	7128.96	9015.53	-1714.07	-8859.16	40.4094397	-104.8598902	0.02
15504.00	90.38	269.46	7128.29	9114.55	-1715.02	-8959.15	40.4094370	-104.8602493	0.02
15604.00	90.36	269.45	7127.65	9213.58	-1715.97	-9059.15	40.4094343	-104.8606083	0.02
15704.00	90.35	269.45	7127.03	9312.60	-1716.93	-9159.14	40.4094316	-104.8609674	0.02
15804.00	90.33	269.45	7126.44	9411.63	-1717.88	-9259.13	40.4094288	-104.8613265	0.02
15904.00	90.32	269.45	7125.87	9510.65	-1718.85	-9359.13	40.4094261	-104.8616855	0.02
16004.00	90.30	269.45	7125.33	9609.68	-1719.81	-9459.12	40.4094233	-104.8620446	0.02
16104.00	90.29	269.44	7124.82	9708.71	-1720.78	-9559.11	40.4094206	-104.8624037	0.02
16204.00	90.27	269.44	7124.33	9807.73	-1721.76	-9659.11	40.4094178	-104.8627627	0.02
16304.00	90.26	269.44	7123.87	9906.76	-1722.73	-9759.10	40.4094150	-104.8631218	0.02
16404.00	90.24	269.44	7123.43	10005.79	-1723.71	-9859.10	40.4094122	-104.8634809	0.02
16504.00	90.23	269.43	7123.02	10104.82	-1724.70	-9959.09	40.4094094	-104.8638399	0.02
16604.00	90.21	269.43	7122.64	10203.85	-1725.69	-10059.09	40.4094065	-104.8641990	0.02
16704.00	90.20	269.43	7122.28	10302.88	-1726.68	-10159.08	40.4094037	-104.8645581	0.02
16804.00	90.18	269.43	7121.95	10401.91	-1727.68	-10259.07	40.4094009	-104.8649171	0.02
16904.00	90.17	269.43	7121.64	10500.95	-1728.68	-10359.07	40.4093980	-104.8652762	0.02
17004.00	90.15	269.42	7121.37	10599.98	-1729.68	-10459.06	40.4093951	-104.8656353	0.02
17104.00	90.14	269.42	7121.11	10699.01	-1730.69	-10559.06	40.4093922	-104.8659943	0.02
17204.00	90.12	269.42	7120.88	10798.05	-1731.71	-10659.05	40.4093893	-104.8663534	0.02
17304.00	90.11	269.42	7120.68	10897.08	-1732.72	-10759.05	40.4093864	-104.8667125	0.02
17404.00	90.09	269.41	7120.51	10996.12	-1733.74	-10859.04	40.4093835	-104.8670715	0.02
17504.00	90.08	269.41	7120.36	11095.15	-1734.77	-10959.04	40.4093806	-104.8674306	0.02
17604.00	90.06	269.41	7120.23	11194.19	-1735.79	-11059.03	40.4093776	-104.8677897	0.02
17704.00	90.05	269.41	7120.14	11293.23	-1736.83	-11159.03	40.4093747	-104.8681487	0.02
17804.00	90.03	269.40	7120.07	11392.26	-1737.86	-11259.02	40.4093717	-104.8685078	0.02
17904.00	90.02	269.40	7120.02	11491.30	-1738.90	-11359.01	40.4093687	-104.8688669	0.02

BOST FARM 33C-11-L (REV-C.0) LAS.las									
18004.00	90.00	269.40	7120.00	11590.34	-1739.95	-11459.01	40.4093657	-104.8692259	0.02
18028.53	90.00	269.40	7120.00	11614.64	-1740.20	-11483.54	40.4093650	-104.8693140	0.02
18104.00	90.00	269.40	7120.00	11689.38	-1740.99	-11559.00	40.4093627	-104.8695850	0.00
18128.51	90.00	269.40	7120.00	11713.66	-1741.25	-11583.51	40.4093620	-104.8696730	0.00



Planned Wellpath Report

BOST FARM 33C-11-L (REV-C.0) PWP

Page 1 of 10



REFERENCE WELLPATH IDENTIFICATION

Operator	SRC ENERGY	Slot	SLOT#08 BOST FARM 33C-11-L (2666'FSL & 1194'FWL, SEC.07)
Area	COLORADO	Well	BOST FARM 33C-11-L
Field	WELD COUNTY (NAD83,TRUE NORTH)	Wellbore	BOST FARM 33C-11-L PWB
Facility	SEC.07-T05N-R66W		

REPORT SETUP INFORMATION

Projection System	NAD83 / Lambert Colorado SP, Northern Zone (501), US feet	Software System	WellArchitect® 5.1
North Reference	True	User	Bushjamh
Scale	0.999961	Report Generated	01/03/2019 at 14:05
Convergence at slot	0.43° East	Database/Source file	WA_DEN_Denver_Defn/BOST FARM 33C-11-L (REV-C.0) PWP PR.xml

WELLPATH LOCATION

	Local coordinates		Grid coordinates		Geographic coordinates	
	North[ft]	East[ft]	Easting[US ft]	Northing[US ft]	Latitude	Longitude
Slot Location	114.39	-64.34	3187096.39	1394423.69	40°24'50.936"N	104°49'41.081"W
Facility Reference Pt			3187161.59	1394309.79	40°24'49.806"N	104°49'40.249"W
Field Reference Pt			3171284.48	1426358.81	40°30'07.643"N	104°53'02.634"W

WELLPATH DATUM

Calculation method	Minimum curvature	IKON 12 (4') (RKB) to Facility Vertical Datum	4878.00ft
Horizontal Reference Pt	Slot	IKON 12 (4') (RKB) to Mean Sea Level	4878.00ft
Vertical Reference Pt	IKON 12 (4') (RKB)	IKON 12 (4') (RKB) to Mud Line at Slot (SLOT#08 BOST FARM 33C-11-L (2666'FSL & 1194'FWL, SEC.07))	4878.00ft
MD Reference Pt	IKON 12 (4') (RKB)	Section Origin	N 0.00, E 0.00 ft
Field Vertical Reference	Mean Sea Level	Section Azimuth	261.45°



Planned Wellpath Report

BOST FARM 33C-11-L (REV-C.0) PWP

Page 2 of 10



REFERENCE WELLPATH IDENTIFICATION

Operator	SRC ENERGY	Slot	SLOT#08 BOST FARM 33C-11-L (2666'FSL & 1194'FWL, SEC.07)
Area	COLORADO	Well	BOST FARM 33C-11-L
Field	WELD COUNTY (NAD83,TRUE NORTH)	Wellbore	BOST FARM 33C-11-L PWB
Facility	SEC.07-T05N-R66W		

WELLPATH DATA (189 stations) † = interpolated/extrapolated station

MD [ft]	Inclination [°]	Azimuth [°]	TVD [ft]	Vert Sect [ft]	North [ft]	East [ft]	Latitude	Longitude	DLS [°/100ft]	Comments
0.00†	0.000	204.543	0.00	0.00	0.00	0.00	40°24'50.936"N	104°49'41.081"W	0.00	
4.00	0.000	204.543	4.00	0.00	0.00	0.00	40°24'50.936"N	104°49'41.081"W	0.00	Tie On
104.00†	0.000	204.543	104.00	0.00	0.00	0.00	40°24'50.936"N	104°49'41.081"W	0.00	
204.00†	0.000	204.543	204.00	0.00	0.00	0.00	40°24'50.936"N	104°49'41.081"W	0.00	
304.00†	0.000	204.543	304.00	0.00	0.00	0.00	40°24'50.936"N	104°49'41.081"W	0.00	
404.00†	0.000	204.543	404.00	0.00	0.00	0.00	40°24'50.936"N	104°49'41.081"W	0.00	
500.00	0.000	204.543	500.00	0.00	0.00	0.00	40°24'50.936"N	104°49'41.081"W	0.00	End of Tangent
504.00†	0.080	204.543	504.00	0.00	0.00	0.00	40°24'50.936"N	104°49'41.081"W	2.00	
604.00†	2.080	204.543	603.98	1.03	-1.72	-0.78	40°24'50.919"N	104°49'41.091"W	2.00	
704.00†	4.080	204.543	703.83	3.96	-6.60	-3.02	40°24'50.871"N	104°49'41.120"W	2.00	
804.00†	6.080	204.543	803.43	8.80	-14.66	-6.69	40°24'50.792"N	104°49'41.167"W	2.00	
904.00†	8.080	204.543	902.66	15.53	-25.87	-11.81	40°24'50.681"N	104°49'41.234"W	2.00	
1004.00†	10.080	204.543	1001.40	24.14	-40.22	-18.37	40°24'50.539"N	104°49'41.318"W	2.00	
1104.00†	12.080	204.543	1099.54	34.64	-57.71	-26.35	40°24'50.366"N	104°49'41.421"W	2.00	
1204.00†	14.080	204.543	1196.94	46.99	-78.29	-35.75	40°24'50.163"N	104°49'41.543"W	2.00	
1294.89	15.898	204.543	1284.73	59.83	-99.67	-45.52	40°24'49.951"N	104°49'41.669"W	2.00	End of Build
1304.00†	15.898	204.543	1293.49	61.19	-101.94	-46.55	40°24'49.929"N	104°49'41.683"W	0.00	
1404.00†	15.898	204.543	1389.67	76.14	-126.86	-57.93	40°24'49.683"N	104°49'41.830"W	0.00	
1504.00†	15.898	204.543	1485.84	91.10	-151.78	-69.31	40°24'49.437"N	104°49'41.977"W	0.00	
1604.00†	15.898	204.543	1582.02	106.06	-176.69	-80.69	40°24'49.190"N	104°49'42.124"W	0.00	
1704.00†	15.898	204.543	1678.19	121.01	-201.61	-92.06	40°24'48.944"N	104°49'42.271"W	0.00	
1804.00†	15.898	204.543	1774.37	135.97	-226.53	-103.44	40°24'48.698"N	104°49'42.418"W	0.00	
1904.00†	15.898	204.543	1870.54	150.92	-251.45	-114.82	40°24'48.452"N	104°49'42.565"W	0.00	
2004.00†	15.898	204.543	1966.72	165.88	-276.36	-126.20	40°24'48.205"N	104°49'42.712"W	0.00	
2104.00†	15.898	204.543	2062.89	180.83	-301.28	-137.58	40°24'47.959"N	104°49'42.859"W	0.00	
2204.00†	15.898	204.543	2159.07	195.79	-326.20	-148.96	40°24'47.713"N	104°49'43.006"W	0.00	
2304.00†	15.898	204.543	2255.24	210.75	-351.12	-160.33	40°24'47.467"N	104°49'43.154"W	0.00	
2404.00†	15.898	204.543	2351.42	225.70	-376.03	-171.71	40°24'47.221"N	104°49'43.301"W	0.00	
2504.00†	15.898	204.543	2447.59	240.66	-400.95	-183.09	40°24'46.974"N	104°49'43.448"W	0.00	
2604.00†	15.898	204.543	2543.77	255.61	-425.87	-194.47	40°24'46.728"N	104°49'43.595"W	0.00	



Planned Wellpath Report

BOST FARM 33C-11-L (REV-C.0) PWP

Page 3 of 10



REFERENCE WELLPATH IDENTIFICATION

Operator	SRC ENERGY	Slot	SLOT#08 BOST FARM 33C-11-L (2666'FSL & 1194'FWL, SEC.07)
Area	COLORADO	Well	BOST FARM 33C-11-L
Field	WELD COUNTY (NAD83,TRUE NORTH)	Wellbore	BOST FARM 33C-11-L PWB
Facility	SEC.07-T05N-R66W		

WELLPATH DATA (189 stations) † = interpolated/extrapolated station

MD [ft]	Inclination [°]	Azimuth [°]	TVD [ft]	Vert Sect [ft]	North [ft]	East [ft]	Latitude	Longitude	DLS [°/100ft]	Comments
2704.00†	15.898	204.543	2639.94	270.57	-450.79	-205.85	40°24'46.482"N	104°49'43.742"W	0.00	
2804.00†	15.898	204.543	2736.12	285.53	-475.70	-217.23	40°24'46.236"N	104°49'43.889"W	0.00	
2904.00†	15.898	204.543	2832.29	300.48	-500.62	-228.60	40°24'45.989"N	104°49'44.036"W	0.00	
3004.00†	15.898	204.543	2928.47	315.44	-525.54	-239.98	40°24'45.743"N	104°49'44.183"W	0.00	
3104.00†	15.898	204.543	3024.64	330.39	-550.46	-251.36	40°24'45.497"N	104°49'44.330"W	0.00	
3204.00†	15.898	204.543	3120.82	345.35	-575.37	-262.74	40°24'45.251"N	104°49'44.477"W	0.00	
3304.00†	15.898	204.543	3216.99	360.31	-600.29	-274.12	40°24'45.005"N	104°49'44.625"W	0.00	
3404.00†	15.898	204.543	3313.17	375.26	-625.21	-285.50	40°24'44.758"N	104°49'44.772"W	0.00	
3504.00†	15.898	204.543	3409.34	390.22	-650.12	-296.87	40°24'44.512"N	104°49'44.919"W	0.00	
3604.00†	15.898	204.543	3505.52	405.17	-675.04	-308.25	40°24'44.266"N	104°49'45.066"W	0.00	
3704.00†	15.898	204.543	3601.69	420.13	-699.96	-319.63	40°24'44.020"N	104°49'45.213"W	0.00	
3804.00†	15.898	204.543	3697.87	435.08	-724.88	-331.01	40°24'43.773"N	104°49'45.360"W	0.00	
3904.00†	15.898	204.543	3794.04	450.04	-749.79	-342.39	40°24'43.527"N	104°49'45.507"W	0.00	
4004.00†	15.898	204.543	3890.22	465.00	-774.71	-353.76	40°24'43.281"N	104°49'45.654"W	0.00	
4104.00†	15.898	204.543	3986.40	479.95	-799.63	-365.14	40°24'43.035"N	104°49'45.801"W	0.00	
4204.00†	15.898	204.543	4082.57	494.91	-824.55	-376.52	40°24'42.789"N	104°49'45.948"W	0.00	
4304.00†	15.898	204.543	4178.75	509.86	-849.46	-387.90	40°24'42.542"N	104°49'46.095"W	0.00	
4404.00†	15.898	204.543	4274.92	524.82	-874.38	-399.28	40°24'42.296"N	104°49'46.243"W	0.00	
4504.00†	15.898	204.543	4371.10	539.78	-899.30	-410.66	40°24'42.050"N	104°49'46.390"W	0.00	
4604.00†	15.898	204.543	4467.27	554.73	-924.22	-422.03	40°24'41.804"N	104°49'46.537"W	0.00	
4704.00†	15.898	204.543	4563.45	569.69	-949.13	-433.41	40°24'41.557"N	104°49'46.684"W	0.00	
4804.00†	15.898	204.543	4659.62	584.64	-974.05	-444.79	40°24'41.311"N	104°49'46.831"W	0.00	
4904.00†	15.898	204.543	4755.80	599.60	-998.97	-456.17	40°24'41.065"N	104°49'46.978"W	0.00	
5004.00†	15.898	204.543	4851.97	614.56	-1023.89	-467.55	40°24'40.819"N	104°49'47.125"W	0.00	
5104.00†	15.898	204.543	4948.15	629.51	-1048.80	-478.93	40°24'40.572"N	104°49'47.272"W	0.00	
5204.00†	15.898	204.543	5044.32	644.47	-1073.72	-490.30	40°24'40.326"N	104°49'47.419"W	0.00	
5304.00†	15.898	204.543	5140.50	659.42	-1098.64	-501.68	40°24'40.080"N	104°49'47.566"W	0.00	
5404.00†	15.898	204.543	5236.67	674.38	-1123.56	-513.06	40°24'39.834"N	104°49'47.713"W	0.00	
5504.00†	15.898	204.543	5332.85	689.33	-1148.47	-524.44	40°24'39.588"N	104°49'47.860"W	0.00	
5604.00†	15.898	204.543	5429.02	704.29	-1173.39	-535.82	40°24'39.341"N	104°49'48.008"W	0.00	



Planned Wellpath Report

BOST FARM 33C-11-L (REV-C.0) PWP

Page 4 of 10



REFERENCE WELLPATH IDENTIFICATION

Operator	SRC ENERGY	Slot	SLOT#08 BOST FARM 33C-11-L (2666'FSL & 1194'FWL, SEC.07)
Area	COLORADO	Well	BOST FARM 33C-11-L
Field	WELD COUNTY (NAD83,TRUE NORTH)	Wellbore	BOST FARM 33C-11-L PWB
Facility	SEC.07-T05N-R66W		

WELLPATH DATA (189 stations) † = interpolated/extrapolated station

MD [ft]	Inclination [°]	Azimuth [°]	TVD [ft]	Vert Sect [ft]	North [ft]	East [ft]	Latitude	Longitude	DLS [°/100ft]	Comments
5704.00†	15.898	204.543	5525.20	719.25	-1198.31	-547.20	40°24'39.095"N	104°49'48.155"W	0.00	
5804.00†	15.898	204.543	5621.37	734.20	-1223.22	-558.57	40°24'38.849"N	104°49'48.302"W	0.00	
5904.00†	15.898	204.543	5717.55	749.16	-1248.14	-569.95	40°24'38.603"N	104°49'48.449"W	0.00	
6004.00†	15.898	204.543	5813.72	764.11	-1273.06	-581.33	40°24'38.356"N	104°49'48.596"W	0.00	
6104.00†	15.898	204.543	5909.90	779.07	-1297.98	-592.71	40°24'38.110"N	104°49'48.743"W	0.00	
6204.00†	15.898	204.543	6006.07	794.03	-1322.89	-604.09	40°24'37.864"N	104°49'48.890"W	0.00	
6304.00†	15.898	204.543	6102.25	808.98	-1347.81	-615.47	40°24'37.618"N	104°49'49.037"W	0.00	
6404.00†	15.898	204.543	6198.42	823.94	-1372.73	-626.84	40°24'37.372"N	104°49'49.184"W	0.00	
6504.00†	15.898	204.543	6294.60	838.89	-1397.65	-638.22	40°24'37.125"N	104°49'49.331"W	0.00	
6604.00†	15.898	204.543	6390.77	853.85	-1422.56	-649.60	40°24'36.879"N	104°49'49.478"W	0.00	
6704.00†	15.898	204.543	6486.95	868.80	-1447.48	-660.98	40°24'36.633"N	104°49'49.625"W	0.00	
6804.00†	15.898	204.543	6583.12	883.76	-1472.40	-672.36	40°24'36.387"N	104°49'49.773"W	0.00	
6904.00†	15.898	204.543	6679.30	898.72	-1497.32	-683.74	40°24'36.140"N	104°49'49.920"W	0.00	
6935.83	15.898	204.543	6709.91	903.48	-1505.25	-687.36	40°24'36.062"N	104°49'49.966"W	0.00	End of Tangent
7004.00†	19.244	221.713	6774.94	917.23	-1522.14	-698.72	40°24'35.895"N	104°49'50.113"W	9.00	
7104.00†	26.002	237.374	6867.27	949.98	-1546.31	-728.21	40°24'35.656"N	104°49'50.495"W	9.00	
7204.00†	33.767	246.586	6953.95	996.95	-1569.22	-772.26	40°24'35.430"N	104°49'51.064"W	9.00	
7304.00†	41.981	252.609	7032.85	1056.98	-1590.30	-829.80	40°24'35.221"N	104°49'51.808"W	9.00	
7404.00†	50.423	256.948	7102.02	1128.59	-1609.04	-899.40	40°24'35.036"N	104°49'52.708"W	9.00	
7504.00†	58.990	260.333	7159.75	1210.03	-1624.97	-979.35	40°24'34.879"N	104°49'53.741"W	9.00	
7604.00†	67.631	263.154	7204.63	1299.27	-1637.71	-1067.69	40°24'34.753"N	104°49'54.883"W	9.00	
7704.00†	76.316	265.642	7235.55	1394.14	-1646.93	-1162.23	40°24'34.662"N	104°49'56.105"W	9.00	
7804.00†	85.023	267.952	7251.75	1492.28	-1652.41	-1260.65	40°24'34.608"N	104°49'57.378"W	9.00	
7878.47	91.513	269.626	7254.00†	1566.06	-1653.98	-1335.03	40°24'34.592"N	104°49'58.339"W	9.00	End of 3D Arc
7904.00†	91.509	269.626	7253.33	1591.33	-1654.15	-1360.55	40°24'34.590"N	104°49'58.669"W	0.02	
8004.00†	91.494	269.623	7250.71	1690.28	-1654.81	-1460.51	40°24'34.584"N	104°49'59.961"W	0.02	
8104.00†	91.479	269.621	7248.11	1789.23	-1655.47	-1560.48	40°24'34.577"N	104°50'01.253"W	0.02	
8204.00†	91.464	269.619	7245.54	1888.18	-1656.13	-1660.44	40°24'34.571"N	104°50'02.546"W	0.02	
8304.00†	91.449	269.617	7243.00	1987.13	-1656.80	-1760.41	40°24'34.564"N	104°50'03.838"W	0.02	
8404.00†	91.435	269.614	7240.48	2086.09	-1657.47	-1860.37	40°24'34.557"N	104°50'05.130"W	0.02	



Planned Wellpath Report

BOST FARM 33C-11-L (REV-C.0) PWP

Page 5 of 10



REFERENCE WELLPATH IDENTIFICATION

Operator	SRC ENERGY	Slot	SLOT#08 BOST FARM 33C-11-L (2666'FSL & 1194'FWL, SEC.07)
Area	COLORADO	Well	BOST FARM 33C-11-L
Field	WELD COUNTY (NAD83,TRUE NORTH)	Wellbore	BOST FARM 33C-11-L PWB
Facility	SEC.07-T05N-R66W		

WELLPATH DATA (189 stations) † = interpolated/extrapolated station

MD [ft]	Inclination [°]	Azimuth [°]	TVD [ft]	Vert Sect [ft]	North [ft]	East [ft]	Latitude	Longitude	DLS [°/100ft]	Comments
8504.00†	91.420	269.612	7237.99	2185.05	-1658.14	-1960.34	40°24'34.551"N	104°50'06.423"W	0.02	
8604.00†	91.405	269.610	7235.53	2284.00	-1658.82	-2060.31	40°24'34.544"N	104°50'07.715"W	0.02	
8704.00†	91.390	269.608	7233.09	2382.96	-1659.50	-2160.28	40°24'34.537"N	104°50'09.007"W	0.02	
8804.00†	91.375	269.606	7230.68	2481.92	-1660.19	-2260.25	40°24'34.530"N	104°50'10.299"W	0.02	
8904.00†	91.360	269.603	7228.29	2580.88	-1660.88	-2360.21	40°24'34.523"N	104°50'11.592"W	0.02	
9004.00†	91.345	269.601	7225.93	2679.85	-1661.57	-2460.18	40°24'34.516"N	104°50'12.884"W	0.02	
9104.00†	91.330	269.599	7223.60	2778.81	-1662.27	-2560.15	40°24'34.509"N	104°50'14.176"W	0.02	
9204.00†	91.315	269.597	7221.29	2877.77	-1662.97	-2660.13	40°24'34.502"N	104°50'15.469"W	0.02	
9304.00†	91.300	269.594	7219.01	2976.74	-1663.68	-2760.10	40°24'34.495"N	104°50'16.761"W	0.02	
9404.00†	91.286	269.592	7216.75	3075.71	-1664.39	-2860.07	40°24'34.488"N	104°50'18.053"W	0.02	
9504.00†	91.271	269.590	7214.52	3174.67	-1665.10	-2960.04	40°24'34.481"N	104°50'19.346"W	0.02	
9604.00†	91.256	269.588	7212.31	3273.64	-1665.82	-3060.01	40°24'34.474"N	104°50'20.638"W	0.02	
9704.00†	91.241	269.586	7210.14	3372.61	-1666.54	-3159.99	40°24'34.466"N	104°50'21.931"W	0.02	
9804.00†	91.226	269.583	7207.98	3471.58	-1667.27	-3259.96	40°24'34.459"N	104°50'23.223"W	0.02	
9904.00†	91.211	269.581	7205.86	3570.56	-1667.99	-3359.94	40°24'34.452"N	104°50'24.515"W	0.02	
10004.00†	91.196	269.579	7203.76	3669.53	-1668.73	-3459.91	40°24'34.444"N	104°50'25.808"W	0.02	
10104.00†	91.181	269.577	7201.68	3768.50	-1669.46	-3559.89	40°24'34.437"N	104°50'27.100"W	0.02	
10204.00†	91.166	269.574	7199.63	3867.48	-1670.21	-3659.86	40°24'34.429"N	104°50'28.393"W	0.02	
10304.00†	91.151	269.572	7197.61	3966.46	-1670.95	-3759.84	40°24'34.422"N	104°50'29.685"W	0.02	
10404.00†	91.136	269.570	7195.61	4065.43	-1671.70	-3859.82	40°24'34.414"N	104°50'30.977"W	0.02	
10504.00†	91.122	269.568	7193.64	4164.41	-1672.45	-3959.80	40°24'34.407"N	104°50'32.270"W	0.02	
10604.00†	91.107	269.565	7191.70	4263.39	-1673.21	-4059.77	40°24'34.399"N	104°50'33.562"W	0.02	
10704.00†	91.092	269.563	7189.78	4362.37	-1673.97	-4159.75	40°24'34.391"N	104°50'34.855"W	0.02	
10804.00†	91.077	269.561	7187.89	4461.36	-1674.73	-4259.73	40°24'34.384"N	104°50'36.147"W	0.02	
10904.00†	91.062	269.559	7186.02	4560.34	-1675.50	-4359.71	40°24'34.376"N	104°50'37.440"W	0.02	
11004.00†	91.047	269.557	7184.18	4659.32	-1676.27	-4459.69	40°24'34.368"N	104°50'38.732"W	0.02	
11104.00†	91.032	269.554	7182.37	4758.31	-1677.05	-4559.67	40°24'34.360"N	104°50'40.025"W	0.02	
11204.00†	91.017	269.552	7180.58	4857.29	-1677.83	-4659.65	40°24'34.352"N	104°50'41.317"W	0.02	
11304.00†	91.002	269.550	7178.82	4956.28	-1678.61	-4759.63	40°24'34.344"N	104°50'42.610"W	0.02	
11404.00†	90.987	269.548	7177.08	5055.27	-1679.40	-4859.62	40°24'34.337"N	104°50'43.902"W	0.02	



Planned Wellpath Report

BOST FARM 33C-11-L (REV-C.0) PWP

Page 6 of 10

**BAKER
HUGHES**
a GE company



REFERENCE WELLPATH IDENTIFICATION

Operator	SRC ENERGY	Slot	SLOT#08 BOST FARM 33C-11-L (2666'FSL & 1194'FWL, SEC.07)
Area	COLORADO	Well	BOST FARM 33C-11-L
Field	WELD COUNTY (NAD83,TRUE NORTH)	Wellbore	BOST FARM 33C-11-L PWB
Facility	SEC.07-T05N-R66W		

WELLPATH DATA (189 stations) † = interpolated/extrapolated station

MD [ft]	Inclination [°]	Azimuth [°]	TVD [ft]	Vert Sect [ft]	North [ft]	East [ft]	Latitude	Longitude	DLS [°/100ft]	Comments
11504.00†	90.973	269.545	7175.37	5154.26	-1680.19	-4959.60	40°24'34.329"N	104°50'45.195"W	0.02	
11604.00†	90.958	269.543	7173.69	5253.25	-1680.98	-5059.58	40°24'34.320"N	104°50'46.487"W	0.02	
11704.00†	90.943	269.541	7172.03	5352.24	-1681.78	-5159.56	40°24'34.312"N	104°50'47.780"W	0.02	
11804.00†	90.928	269.539	7170.40	5451.23	-1682.59	-5259.55	40°24'34.304"N	104°50'49.072"W	0.02	
11904.00†	90.913	269.537	7168.79	5550.22	-1683.39	-5359.53	40°24'34.296"N	104°50'50.365"W	0.02	
12004.00†	90.898	269.534	7167.21	5649.22	-1684.20	-5459.52	40°24'34.288"N	104°50'51.657"W	0.02	
12104.00†	90.883	269.532	7165.66	5748.21	-1685.02	-5559.50	40°24'34.280"N	104°50'52.950"W	0.02	
12204.00†	90.868	269.530	7164.13	5847.21	-1685.84	-5659.49	40°24'34.271"N	104°50'54.242"W	0.02	
12304.00†	90.853	269.528	7162.63	5946.21	-1686.66	-5759.47	40°24'34.263"N	104°50'55.535"W	0.02	
12404.00†	90.838	269.525	7161.15	6045.20	-1687.48	-5859.46	40°24'34.254"N	104°50'56.827"W	0.02	
12504.00†	90.823	269.523	7159.70	6144.20	-1688.31	-5959.44	40°24'34.246"N	104°50'58.120"W	0.02	
12604.00†	90.809	269.521	7158.27	6243.20	-1689.15	-6059.43	40°24'34.238"N	104°50'59.412"W	0.02	
12704.00†	90.794	269.519	7156.88	6342.20	-1689.99	-6159.42	40°24'34.229"N	104°51'00.705"W	0.02	
12804.00†	90.779	269.517	7155.50	6441.20	-1690.83	-6259.40	40°24'34.220"N	104°51'01.997"W	0.02	
12904.00†	90.764	269.514	7154.16	6540.20	-1691.67	-6359.39	40°24'34.212"N	104°51'03.290"W	0.02	
13004.00†	90.749	269.512	7152.84	6639.21	-1692.52	-6459.38	40°24'34.203"N	104°51'04.582"W	0.02	
13104.00†	90.734	269.510	7151.54	6738.21	-1693.38	-6559.37	40°24'34.194"N	104°51'05.875"W	0.02	
13204.00†	90.719	269.508	7150.28	6837.22	-1694.23	-6659.35	40°24'34.186"N	104°51'07.168"W	0.02	
13304.00†	90.704	269.505	7149.03	6936.22	-1695.09	-6759.34	40°24'34.177"N	104°51'08.460"W	0.02	
13404.00†	90.689	269.503	7147.82	7035.23	-1695.96	-6859.33	40°24'34.168"N	104°51'09.753"W	0.02	
13504.00†	90.674	269.501	7146.63	7134.24	-1696.83	-6959.32	40°24'34.159"N	104°51'11.045"W	0.02	
13604.00†	90.659	269.499	7145.46	7233.24	-1697.70	-7059.31	40°24'34.150"N	104°51'12.338"W	0.02	
13704.00†	90.645	269.497	7144.33	7332.25	-1698.58	-7159.30	40°24'34.141"N	104°51'13.630"W	0.02	
13804.00†	90.630	269.494	7143.21	7431.26	-1699.46	-7259.29	40°24'34.132"N	104°51'14.923"W	0.02	
13904.00†	90.615	269.492	7142.13	7530.27	-1700.34	-7359.28	40°24'34.123"N	104°51'16.216"W	0.02	
14004.00†	90.600	269.490	7141.07	7629.29	-1701.23	-7459.27	40°24'34.114"N	104°51'17.508"W	0.02	
14104.00†	90.585	269.488	7140.03	7728.30	-1702.12	-7559.26	40°24'34.105"N	104°51'18.801"W	0.02	
14204.00†	90.570	269.485	7139.03	7827.31	-1703.02	-7659.25	40°24'34.096"N	104°51'20.093"W	0.02	
14304.00†	90.555	269.483	7138.04	7926.33	-1703.92	-7759.24	40°24'34.087"N	104°51'21.386"W	0.02	
14404.00†	90.540	269.481	7137.09	8025.34	-1704.82	-7859.23	40°24'34.078"N	104°51'22.679"W	0.02	



Planned Wellpath Report

BOST FARM 33C-11-L (REV-C.0) PWP

Page 7 of 10



REFERENCE WELLPATH IDENTIFICATION

Operator	SRC ENERGY	Slot	SLOT#08 BOST FARM 33C-11-L (2666'FSL & 1194'FWL, SEC.07)
Area	COLORADO	Well	BOST FARM 33C-11-L
Field	WELD COUNTY (NAD83,TRUE NORTH)	Wellbore	BOST FARM 33C-11-L PWB
Facility	SEC.07-T05N-R66W		

WELLPATH DATA (189 stations) † = interpolated/extrapolated station

MD [ft]	Inclination [°]	Azimuth [°]	TVD [ft]	Vert Sect [ft]	North [ft]	East [ft]	Latitude	Longitude	DLS [°/100ft]	Comments
14504.00†	90.525	269.479	7136.16	8124.36	-1705.73	-7959.23	40°24'34.068"N	104°51'23.971"W	0.02	
14604.00†	90.510	269.477	7135.25	8223.37	-1706.64	-8059.22	40°24'34.059"N	104°51'25.264"W	0.02	
14704.00†	90.496	269.474	7134.38	8322.39	-1707.56	-8159.21	40°24'34.050"N	104°51'26.556"W	0.02	
14804.00†	90.481	269.472	7133.52	8421.41	-1708.48	-8259.20	40°24'34.040"N	104°51'27.849"W	0.02	
14904.00†	90.466	269.470	7132.70	8520.43	-1709.40	-8359.19	40°24'34.031"N	104°51'29.142"W	0.02	
15004.00†	90.451	269.468	7131.90	8619.44	-1710.33	-8459.19	40°24'34.021"N	104°51'30.434"W	0.02	
15104.00†	90.436	269.465	7131.13	8718.47	-1711.26	-8559.18	40°24'34.012"N	104°51'31.727"W	0.02	
15204.00†	90.421	269.463	7130.38	8817.49	-1712.19	-8659.17	40°24'34.002"N	104°51'33.019"W	0.02	
15304.00†	90.406	269.461	7129.66	8916.51	-1713.13	-8759.17	40°24'33.993"N	104°51'34.312"W	0.02	
15404.00†	90.391	269.459	7128.96	9015.53	-1714.07	-8859.16	40°24'33.983"N	104°51'35.605"W	0.02	
15504.00†	90.376	269.457	7128.29	9114.55	-1715.02	-8959.15	40°24'33.973"N	104°51'36.897"W	0.02	
15604.00†	90.361	269.454	7127.65	9213.58	-1715.97	-9059.15	40°24'33.963"N	104°51'38.190"W	0.02	
15704.00†	90.346	269.452	7127.03	9312.60	-1716.93	-9159.14	40°24'33.954"N	104°51'39.483"W	0.02	
15804.00†	90.332	269.450	7126.44	9411.63	-1717.88	-9259.13	40°24'33.944"N	104°51'40.775"W	0.02	
15904.00†	90.317	269.448	7125.87	9510.65	-1718.85	-9359.13	40°24'33.934"N	104°51'42.068"W	0.02	
16004.00†	90.302	269.445	7125.33	9609.68	-1719.81	-9459.12	40°24'33.924"N	104°51'43.361"W	0.02	
16104.00†	90.287	269.443	7124.82	9708.71	-1720.78	-9559.11	40°24'33.914"N	104°51'44.653"W	0.02	
16204.00†	90.272	269.441	7124.33	9807.73	-1721.76	-9659.11	40°24'33.904"N	104°51'45.946"W	0.02	
16304.00†	90.257	269.439	7123.87	9906.76	-1722.73	-9759.10	40°24'33.894"N	104°51'47.238"W	0.02	
16404.00†	90.242	269.437	7123.43	10005.79	-1723.71	-9859.10	40°24'33.884"N	104°51'48.531"W	0.02	
16504.00†	90.227	269.434	7123.02	10104.82	-1724.70	-9959.09	40°24'33.874"N	104°51'49.824"W	0.02	
16604.00†	90.212	269.432	7122.64	10203.85	-1725.69	-10059.09	40°24'33.864"N	104°51'51.116"W	0.02	
16704.00†	90.197	269.430	7122.28	10302.88	-1726.68	-10159.08	40°24'33.853"N	104°51'52.409"W	0.02	
16804.00†	90.183	269.428	7121.95	10401.91	-1727.68	-10259.07	40°24'33.843"N	104°51'53.702"W	0.02	
16904.00†	90.168	269.425	7121.64	10500.95	-1728.68	-10359.07	40°24'33.833"N	104°51'54.994"W	0.02	
17004.00†	90.153	269.423	7121.37	10599.98	-1729.68	-10459.06	40°24'33.822"N	104°51'56.287"W	0.02	
17104.00†	90.138	269.421	7121.11	10699.01	-1730.69	-10559.06	40°24'33.812"N	104°51'57.580"W	0.02	
17204.00†	90.123	269.419	7120.88	10798.05	-1731.71	-10659.05	40°24'33.802"N	104°51'58.872"W	0.02	
17304.00†	90.108	269.417	7120.68	10897.08	-1732.72	-10759.05	40°24'33.791"N	104°52'00.165"W	0.02	
17404.00†	90.093	269.414	7120.51	10996.12	-1733.74	-10859.04	40°24'33.781"N	104°52'01.457"W	0.02	



Planned Wellpath Report

BOST FARM 33C-11-L (REV-C.0) PWP

Page 8 of 10



REFERENCE WELLPATH IDENTIFICATION

Operator	SRC ENERGY	Slot	SLOT#08 BOST FARM 33C-11-L (2666'FSL & 1194'FWL, SEC.07)
Area	COLORADO	Well	BOST FARM 33C-11-L
Field	WELD COUNTY (NAD83,TRUE NORTH)	Wellbore	BOST FARM 33C-11-L PWB
Facility	SEC.07-T05N-R66W		

WELLPATH DATA (189 stations) † = interpolated/extrapolated station

MD [ft]	Inclination [°]	Azimuth [°]	TVD [ft]	Vert Sect [ft]	North [ft]	East [ft]	Latitude	Longitude	DLS [°/100ft]	Comments
17504.00†	90.078	269.412	7120.36	11095.15	-1734.77	-10959.04	40°24'33.770"N	104°52'02.750"W	0.02	
17604.00†	90.063	269.410	7120.23	11194.19	-1735.79	-11059.03	40°24'33.759"N	104°52'04.043"W	0.02	
17704.00†	90.048	269.408	7120.14	11293.23	-1736.83	-11159.03	40°24'33.749"N	104°52'05.335"W	0.02	
17804.00†	90.033	269.405	7120.07	11392.26	-1737.86	-11259.02	40°24'33.738"N	104°52'06.628"W	0.02	
17904.00†	90.019	269.403	7120.02	11491.30	-1738.90	-11359.01	40°24'33.727"N	104°52'07.921"W	0.02	
18004.00†	90.004	269.401	7120.00	11590.34	-1739.95	-11459.01	40°24'33.717"N	104°52'09.213"W	0.02	
18028.53	90.000	269.400	7120.00 ²	11614.64	-1740.20	-11483.54	40°24'33.714"N	104°52'09.530"W	0.02	End of 3D Arc
18104.00†	90.000	269.400	7120.00	11689.38	-1740.99	-11559.00	40°24'33.706"N	104°52'10.506"W	0.00	
18128.51	90.000	269.400	7120.00 ³	11713.66	-1741.25	-11583.51	40°24'33.703"N	104°52'10.823"W	0.00	End of Tangent

HOLE & CASING SECTIONS - Ref Wellbore: BOST FARM 33C-11-L PWB Ref Wellpath: BOST FARM 33C-11-L (REV-C.0) PWP

String/Diameter	Start MD [ft]	End MD [ft]	Interval [ft]	Start TVD [ft]	End TVD [ft]	Start N/S [ft]	Start E/W [ft]	End N/S [ft]	End E/W [ft]
13.5in Open Hole	4.00	1750.00	1746.00	4.00	1722.43	0.00	0.00	-213.07	-97.30
9.625in Casing Surface	4.00	1750.00	1746.00	4.00	1722.43	0.00	0.00	-213.07	-97.30
8.5in Open Hole	1750.00	18128.51	16378.51	1722.43	7120.00	-213.07	-97.30	-1741.25	-11583.51



Planned Wellpath Report

BOST FARM 33C-11-L (REV-C.0) PWP

Page 9 of 10



REFERENCE WELLPATH IDENTIFICATION

Operator	SRC ENERGY	Slot	SLOT#08 BOST FARM 33C-11-L (2666'FSL & 1194'FWL, SEC.07)
Area	COLORADO	Well	BOST FARM 33C-11-L
Field	WELD COUNTY (NAD83,TRUE NORTH)	Wellbore	BOST FARM 33C-11-L PWB
Facility	SEC.07-T05N-R66W		

TARGETS

Name	MD [ft]	TVD [ft]	North [ft]	East [ft]	Grid East [US ft]	Grid North [US ft]	Latitude	Longitude	Shape
SEC.07-T05N-R66W		2.00	-114.39	64.34	3187161.59	1394309.79	40°24'49.806"N	104°49'40.249"W	polygon
SEC.11-T05N-R67W		2.00	-114.39	64.34	3187161.59	1394309.79	40°24'49.806"N	104°49'40.249"W	polygon
SEC.12-T05N-R67W		2.00	-114.39	64.34	3187161.59	1394309.79	40°24'49.806"N	104°49'40.249"W	polygon
BOST FARM 33C-11-L BHL ON PLAT (928'FSL & 360'FWL, SEC.11)		7113.00	-1738.48	-11273.56	3175836.79	1392599.91	40°24'33.732"N	104°52'06.816"W	point
BOST FARM 33C-11-L BPZ ON PLAT (930'FSL & 460'FWL, SEC.11)		7113.00	-1737.79	-11173.58	3175936.75	1392601.35	40°24'33.739"N	104°52'05.524"W	point
BOST FARM 33C-11-L BHL REV-1 (928'FSL & 360'FWL, SEC.11)		7120.00	-1738.48	-11273.56	3175836.79	1392599.91	40°24'33.732"N	104°52'06.816"W	point
3) BOST FARM 33C-11-L BHL REV-2 (921'FSL & 50'FWL, SEC.11)	18128.51	7120.00	-1741.25	-11583.51	3175526.88	1392594.79	40°24'33.703"N	104°52'10.823"W	point
BOST FARM 33C-11-L BPZ REV-1 (930'FSL & 460'FWL, SEC.11)		7120.00	-1737.81	-11173.62	3175936.72	1392601.33	40°24'33.739"N	104°52'05.524"W	point
2) BOST FARM 33C-11-L BPZ REV-2 (923'FSL & 150'FWL, SEC.11)	18028.53	7120.00	-1740.20	-11483.54	3175626.84	1392596.60	40°24'33.714"N	104°52'09.530"W	point
1) BOST FARM 33C-11-L TOP OF PROD REV-1 (1005'FSL & 150'FEL, SEC.12)	7878.47	7254.00	-1653.98	-1335.03	3185773.98	1392759.70	40°24'34.592"N	104°49'58.339"W	point
BOST FARM 33C-11-L TOP OF PROD ON PLAT (1005'FSL & 150'FEL, SEC.12)		7339.00	-1653.94	-1335.04	3185773.97	1392759.74	40°24'34.592"N	104°49'58.339"W	point



Planned Wellpath Report

BOST FARM 33C-11-L (REV-C.0) PWP

Page 10 of 10



REFERENCE WELLPATH IDENTIFICATION			
Operator	SRC ENERGY	Slot	SLOT#08 BOST FARM 33C-11-L (2666'FSL & 1194'FWL, SEC.07)
Area	COLORADO	Well	BOST FARM 33C-11-L
Field	WELD COUNTY (NAD83,TRUE NORTH)	Wellbore	BOST FARM 33C-11-L PWB
Facility	SEC.07-T05N-R66W		

SURVEY PROGRAM - Ref Wellbore: BOST FARM 33C-11-L PWB Ref Wellpath: BOST FARM 33C-11-L (REV-C.0) PWP				
Start MD [ft]	End MD [ft]	Positional Uncertainty Model	Log Name/Comment	Wellbore
4.00	1750.00	BHI NaviTrak (Axial)		BOST FARM 33C-11-L PWB
1750.00	18128.51	BHI AutoTrak Curve (MagCAD+IFR1, Short spacing)		BOST FARM 33C-11-L PWB