

Location:	COLORADO	Slot:	SLOT#02 BOST FARM 32C-11-L2 (2666'FSL & 1074'FWL, SEC.07)
Field:	WELD COUNTY (NAD83,TRUE NORTH)	Well:	BOST FARM 32C-11-L2
Facility:	SEC.07-T05N-R66W	Wellbore:	BOST FARM 32C-11-L2 PWB
Plot reference wellpath is BOST FARM 32C-11-L2 (REV-C.0) PWP		Grid System: NAD83 / Lambert Colorado SP, Northern Zone (501), US feet	
True vertical depths are referenced to IKON 12 (4) (RKB)		North Reference: True north	
Measured depths are referenced to IKON 12 (4) (RKB)		Scale: True distance	
IKON 12 (4) (RKB) to Mean Sea Level: 4861 feet		Depths are in feet	
Mean Sea Level to Mud line (At Slot: SLOT#02 BOST FARM 32C-11-L2 (2666'FSL & 1074'FWL, SEC.07): 0 feet		Created by: hanisab on 2019-01-03	
Coordinates are in feet referenced to Slot		Database: WA DENVER	

Facility Name			Grid East (US ft)	Grid North (US ft)	Latitude	Longitude
SEC.07-T05N-R66W			3187161.591	1394309.789	40°24'49.806"N	104°49'40.249"W
Spot	Local N (ft)	Local E (ft)	Grid East (US ft)	Grid North (US ft)	Latitude	Longitude
SLOT#02 BOST FARM 32C-11-L2 (2666FSL & 1074FWL, SEC.07)	115.12	-184.36	3186976.373	1394423.507	40°24'50.944"N	104°49'42.632"W
ICON 12 (4") (RKB) to Mud line (N Slot: SLOT#02 BOST FARM 32C-11-L2 (2666FSL & 1074FWL, SEC.07))					4881ft	
Mean Sea Level to Mud line (N Slot: SLOT#02 BOST FARM 32C-11-L2 (2666FSL & 1074FWL, SEC.07))					0ft	
ICON 12 (4") (RKB) to Mean Sea Level					4881ft	

Start MD (ft)	End MD (ft)	Tool	Model	Log Name/Comment	Wellbore
4.00	1750.00	BHI NavTrak	BHI NavTrak (Axial)		BOST FARM 32C-11-L2 PWB
1750.00	17835.94	BHI AutoTrak Curve	BHI AutoTrak Curve (MagCAD+IFR1, Short spacing)		BOST FARM 32C-11-L2 PWB

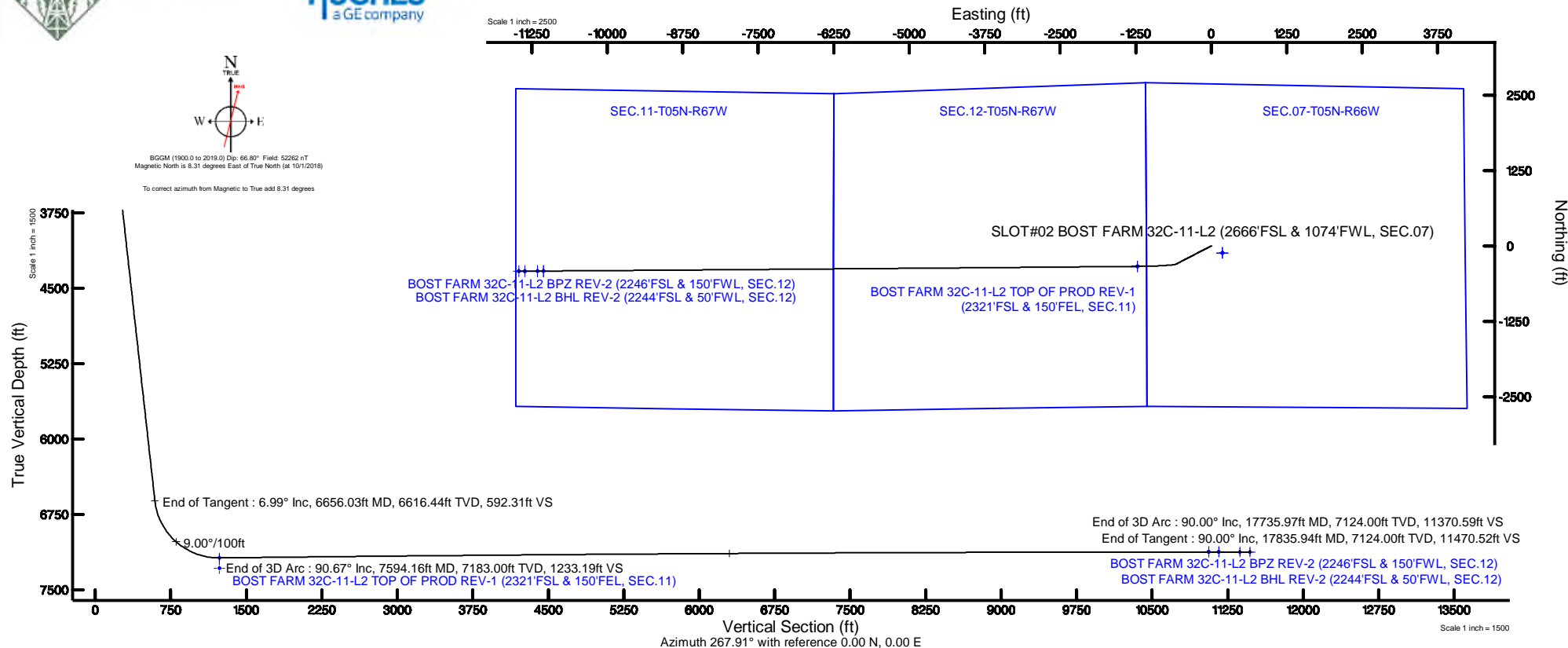
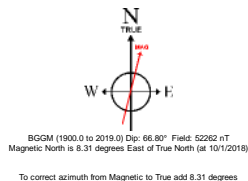

BOST FARM 32C-11-L2 (REV-C.0) LAS.las

~VERSION INFORMATION

VERS. 2.0 : CWLS LOG ASCII STANDARD-VERSION 2.0

WRAP. NO : ASCII DATA SECTION CONTAINS ONE ROW PER WELLPATH STATION

~WELL INFORMATION

#MNEM	.UNITS	DATA	:DESCRIPTION
#----	.-----	----	:-----
STRT	.ft	0.00	:START MD
STOP	.ft	17835.94	:STOP MD
STEP	.ft	0.0	:STEP (non-uniform increment)
NULL	.	-999.99	:NULL
COMP	.	SRC ENERGY	:OPERATOR
WELL	.	BOST FARM 32C-11-L2	:WELL
FLD	.	WELD COUNTY (NAD83,TRUE NORTH)	:FIELD
LOC	.	COLORADO	:AREA (aka: Location)
CNTY	.	N/A	:COUNTY
STAT	.	N/A	:STATE
CTRY	.	N/A	:COUNTRY
SRVC	.	Baker Hughes	:CONTRACTOR
DATE	.	09/24/2018	:LOG REV DATE
API	.		:API NUMBER

~OTHER INFORMATION

#Software: WellArchitect(R) Version 5.1

#MNEM	.UNITS	DATA	:DESCRIPTION
#----	.-----	----	:-----
WPTYPE	.	PLANNED WELLPATH	:WELLPATH TYPE
FACILITY	.	SEC.07-T05N-R66W	:FACILITY
SLOT	.	SLOT#02 BOST FARM 32C-11-L2 (2666'FSL & 1074'FWL, SEC.07):SLOT	:SLOT
WELLBORE	.	BOST FARM 32C-11-L2 PWB	:WELLBORE
WELLPATH	.	BOST FARM 32C-11-L2 (REV-C.0) PWP	:WELLPATH
MDREFPT	.	IKON 12 (4') (RKB)	:MD REFERENCE POINT
TVDREFPT	.	IKON 12 (4') (RKB)	:TVD REFERENCE POINT
LCLREFPT	.	Slot	:LOCAL COORDINATE REFERENCE PT

BOST FARM 32C-11-L2 (REV-C.0) LAS.las

VSAZIMUTH.deg	267.91	:VERTICAL SECTION AZIMUTH
VSORIGN .ft	0.00	:VERTICAL SECTION ORIGIN NORTH
VSORIGE .ft	0.00	:VERTICAL SECTION ORIGIN EAST

~CURVE (WELLPATH) INFORMATION

#MNEM	.UNITS	:DESCRIPTION
#----	.-----	:-----
DEPT	.ft	:MEASURED DEPTH
INC	.deg	:INCLINATION
AZI	.deg	:AZIMUTH
TVD	.ft	:TRUE VERTICAL DEPTH
SECT	.ft	:CROSS SECTION (CURTAIN/VERTICAL)
LOCALN	.ft	:LOCAL NORTH
LOCALE	.ft	:LOCAL EAST
LAT	.deg	:LATITUDE
LONG	.deg	:LONGITUDE
DLS	.deg/100ft	:DOGLEG SEVERITY

~ASCII DATA

0.00	0.00	242.61	0.00	0.00	0.00	0.00	40.4141510	-104.8285090	0.00
4.00	0.00	242.61	4.00	0.00	0.00	0.00	40.4141510	-104.8285090	0.00
104.00	0.00	242.61	104.00	0.00	0.00	0.00	40.4141510	-104.8285090	0.00
204.00	0.00	242.61	204.00	0.00	0.00	0.00	40.4141510	-104.8285090	0.00
304.00	0.00	242.61	304.00	0.00	0.00	0.00	40.4141510	-104.8285090	0.00
404.00	0.00	242.61	404.00	0.00	0.00	0.00	40.4141510	-104.8285090	0.00
504.00	0.00	242.61	504.00	0.00	0.00	0.00	40.4141510	-104.8285090	0.00
604.00	0.00	242.61	604.00	0.00	0.00	0.00	40.4141510	-104.8285090	0.00
704.00	0.00	242.61	704.00	0.00	0.00	0.00	40.4141510	-104.8285090	0.00
804.00	0.00	242.61	804.00	0.00	0.00	0.00	40.4141510	-104.8285090	0.00
904.00	0.00	242.61	904.00	0.00	0.00	0.00	40.4141510	-104.8285090	0.00
1004.00	0.00	242.61	1004.00	0.00	0.00	0.00	40.4141510	-104.8285090	0.00
1100.00	0.00	242.61	1100.00	0.00	0.00	0.00	40.4141510	-104.8285090	0.00
1104.00	0.08	242.61	1104.00	0.00	0.00	0.00	40.4141510	-104.8285090	2.00
1204.00	2.08	242.61	1203.98	1.71	-0.87	-1.68	40.4141486	-104.8285150	2.00

BOST FARM 32C-11-L2 (REV-C.0) LAS.las

1304.00	4.08	242.61	1303.83	6.56	-3.34	-6.45	40.4141418	-104.8285322	2.00
1404.00	6.08	242.61	1403.43	14.57	-7.41	-14.31	40.4141307	-104.8285604	2.00
1449.61	6.99	242.61	1448.75	19.26	-9.80	-18.92	40.4141241	-104.8285769	2.00
1504.00	6.99	242.61	1502.73	25.25	-12.85	-24.80	40.4141157	-104.8285981	0.00
1604.00	6.99	242.61	1601.98	36.26	-18.45	-35.61	40.4141004	-104.8286369	0.00
1704.00	6.99	242.61	1701.24	47.26	-24.05	-46.42	40.4140850	-104.8286757	0.00
1804.00	6.99	242.61	1800.50	58.27	-29.64	-57.23	40.4140696	-104.8287145	0.00
1904.00	6.99	242.61	1899.75	69.28	-35.24	-68.03	40.4140543	-104.8287533	0.00
2004.00	6.99	242.61	1999.01	80.28	-40.84	-78.84	40.4140389	-104.8287921	0.00
2104.00	6.99	242.61	2098.27	91.29	-46.44	-89.65	40.4140235	-104.8288310	0.00
2204.00	6.99	242.61	2197.52	102.30	-52.04	-100.46	40.4140081	-104.8288698	0.00
2304.00	6.99	242.61	2296.78	113.30	-57.64	-111.27	40.4139928	-104.8289086	0.00
2404.00	6.99	242.61	2396.03	124.31	-63.24	-122.08	40.4139774	-104.8289474	0.00
2504.00	6.99	242.61	2495.29	135.31	-68.84	-132.89	40.4139620	-104.8289862	0.00
2604.00	6.99	242.61	2594.55	146.32	-74.44	-143.70	40.4139467	-104.8290250	0.00
2704.00	6.99	242.61	2693.80	157.33	-80.04	-154.51	40.4139313	-104.8290639	0.00
2804.00	6.99	242.61	2793.06	168.33	-85.64	-165.32	40.4139159	-104.8291027	0.00
2904.00	6.99	242.61	2892.32	179.34	-91.24	-176.13	40.4139006	-104.8291415	0.00
3004.00	6.99	242.61	2991.57	190.35	-96.84	-186.94	40.4138852	-104.8291803	0.00
3104.00	6.99	242.61	3090.83	201.35	-102.44	-197.74	40.4138698	-104.8292191	0.00
3204.00	6.99	242.61	3190.08	212.36	-108.04	-208.55	40.4138544	-104.8292579	0.00
3304.00	6.99	242.61	3289.34	223.37	-113.64	-219.36	40.4138391	-104.8292968	0.00
3404.00	6.99	242.61	3388.60	234.37	-119.24	-230.17	40.4138237	-104.8293356	0.00
3504.00	6.99	242.61	3487.85	245.38	-124.84	-240.98	40.4138083	-104.8293744	0.00
3604.00	6.99	242.61	3587.11	256.39	-130.44	-251.79	40.4137930	-104.8294132	0.00
3704.00	6.99	242.61	3686.37	267.39	-136.04	-262.60	40.4137776	-104.8294520	0.00
3804.00	6.99	242.61	3785.62	278.40	-141.64	-273.41	40.4137622	-104.8294908	0.00
3904.00	6.99	242.61	3884.88	289.41	-147.24	-284.22	40.4137468	-104.8295297	0.00
4004.00	6.99	242.61	3984.13	300.41	-152.84	-295.03	40.4137315	-104.8295685	0.00
4104.00	6.99	242.61	4083.39	311.42	-158.44	-305.84	40.4137161	-104.8296073	0.00
4204.00	6.99	242.61	4182.65	322.42	-164.04	-316.65	40.4137007	-104.8296461	0.00
4304.00	6.99	242.61	4281.90	333.43	-169.64	-327.46	40.4136854	-104.8296849	0.00
4404.00	6.99	242.61	4381.16	344.44	-175.23	-338.26	40.4136700	-104.8297237	0.00
4504.00	6.99	242.61	4480.42	355.44	-180.83	-349.07	40.4136546	-104.8297626	0.00

BOST FARM 32C-11-L2 (REV-C.0) LAS.las

4604.00	6.99	242.61	4579.67	366.45	-186.43	-359.88	40.4136393	-104.8298014	0.00
4704.00	6.99	242.61	4678.93	377.46	-192.03	-370.69	40.4136239	-104.8298402	0.00
4804.00	6.99	242.61	4778.18	388.46	-197.63	-381.50	40.4136085	-104.8298790	0.00
4904.00	6.99	242.61	4877.44	399.47	-203.23	-392.31	40.4135931	-104.8299178	0.00
5004.00	6.99	242.61	4976.70	410.48	-208.83	-403.12	40.4135778	-104.8299566	0.00
5104.00	6.99	242.61	5075.95	421.48	-214.43	-413.93	40.4135624	-104.8299955	0.00
5204.00	6.99	242.61	5175.21	432.49	-220.03	-424.74	40.4135470	-104.8300343	0.00
5304.00	6.99	242.61	5274.47	443.50	-225.63	-435.55	40.4135317	-104.8300731	0.00
5404.00	6.99	242.61	5373.72	454.50	-231.23	-446.36	40.4135163	-104.8301119	0.00
5504.00	6.99	242.61	5472.98	465.51	-236.83	-457.17	40.4135009	-104.8301507	0.00
5604.00	6.99	242.61	5572.24	476.52	-242.43	-467.98	40.4134855	-104.8301895	0.00
5704.00	6.99	242.61	5671.49	487.52	-248.03	-478.78	40.4134702	-104.8302284	0.00
5804.00	6.99	242.61	5770.75	498.53	-253.63	-489.59	40.4134548	-104.8302672	0.00
5904.00	6.99	242.61	5870.00	509.53	-259.23	-500.40	40.4134394	-104.8303060	0.00
6004.00	6.99	242.61	5969.26	520.54	-264.83	-511.21	40.4134241	-104.8303448	0.00
6104.00	6.99	242.61	6068.52	531.55	-270.43	-522.02	40.4134087	-104.8303836	0.00
6204.00	6.99	242.61	6167.77	542.55	-276.03	-532.83	40.4133933	-104.8304224	0.00
6304.00	6.99	242.61	6267.03	553.56	-281.63	-543.64	40.4133779	-104.8304613	0.00
6404.00	6.99	242.61	6366.29	564.57	-287.23	-554.45	40.4133626	-104.8305001	0.00
6504.00	6.99	242.61	6465.54	575.57	-292.83	-565.26	40.4133472	-104.8305389	0.00
6604.00	6.99	242.61	6564.80	586.58	-298.43	-576.07	40.4133318	-104.8305777	0.00
6656.03	6.99	242.61	6616.44	592.31	-301.34	-581.69	40.4133238	-104.8305979	0.00
6704.00	11.01	252.93	6663.81	599.38	-304.03	-588.67	40.4133165	-104.8306230	9.00
6804.00	19.80	260.61	6760.13	625.46	-309.61	-614.56	40.4133011	-104.8307159	9.00
6904.00	28.71	263.65	6851.22	666.29	-315.04	-655.23	40.4132862	-104.8308620	9.00
7004.00	37.67	265.34	6934.82	720.88	-320.19	-709.67	40.4132721	-104.8310575	9.00
7104.00	46.64	266.46	7008.88	787.88	-324.92	-776.54	40.4132591	-104.8312976	9.00
7204.00	55.61	267.29	7071.58	865.64	-329.13	-854.19	40.4132475	-104.8315765	9.00
7304.00	64.60	267.95	7121.37	952.24	-332.71	-940.72	40.4132377	-104.8318872	9.00
7404.00	73.58	268.52	7157.03	1045.56	-335.56	-1034.00	40.4132299	-104.8322222	9.00
7504.00	82.56	269.04	7177.68	1143.29	-337.63	-1131.71	40.4132242	-104.8325731	9.00
7594.16	90.67	269.49	7183.00	1233.19	-338.78	-1221.64	40.4132210	-104.8328960	9.00
7604.00	90.67	269.49	7182.89	1243.03	-338.87	-1231.47	40.4132208	-104.8329313	0.01
7704.00	90.66	269.50	7181.73	1342.98	-339.75	-1331.46	40.4132183	-104.8332904	0.01

BOST FARM 32C-11-L2 (REV-C.0) LAS.las

7804.00	90.65	269.50	7180.58	1442.94	-340.63	-1431.45	40.4132159	-104.8336495	0.01
7904.00	90.65	269.50	7179.45	1542.89	-341.51	-1531.44	40.4132135	-104.8340085	0.01
8004.00	90.64	269.50	7178.33	1642.85	-342.38	-1631.43	40.4132110	-104.8343676	0.01
8104.00	90.63	269.50	7177.22	1742.80	-343.26	-1731.42	40.4132086	-104.8347267	0.01
8204.00	90.63	269.50	7176.12	1842.76	-344.13	-1831.41	40.4132062	-104.8350858	0.01
8304.00	90.62	269.50	7175.03	1942.71	-345.00	-1931.40	40.4132038	-104.8354448	0.01
8404.00	90.61	269.50	7173.95	2042.67	-345.87	-2031.39	40.4132014	-104.8358039	0.01
8504.00	90.61	269.50	7172.89	2142.62	-346.73	-2131.38	40.4131990	-104.8361630	0.01
8604.00	90.60	269.51	7171.84	2242.58	-347.60	-2231.37	40.4131966	-104.8365220	0.01
8704.00	90.59	269.51	7170.79	2342.53	-348.46	-2331.36	40.4131942	-104.8368811	0.01
8804.00	90.59	269.51	7169.76	2442.49	-349.32	-2431.36	40.4131918	-104.8372402	0.01
8904.00	90.58	269.51	7168.74	2542.45	-350.18	-2531.35	40.4131894	-104.8375993	0.01
9004.00	90.57	269.51	7167.74	2642.40	-351.03	-2631.34	40.4131871	-104.8379584	0.01
9104.00	90.57	269.51	7166.74	2742.36	-351.89	-2731.33	40.4131847	-104.8383174	0.01
9204.00	90.56	269.51	7165.76	2842.31	-352.74	-2831.32	40.4131823	-104.8386765	0.01
9304.00	90.55	269.51	7164.78	2942.27	-353.59	-2931.31	40.4131800	-104.8390356	0.01
9404.00	90.55	269.52	7163.82	3042.23	-354.44	-3031.30	40.4131776	-104.8393947	0.01
9504.00	90.54	269.52	7162.87	3142.18	-355.28	-3131.30	40.4131752	-104.8397537	0.01
9604.00	90.54	269.52	7161.93	3242.14	-356.13	-3231.29	40.4131729	-104.8401128	0.01
9704.00	90.53	269.52	7161.01	3342.09	-356.97	-3331.28	40.4131705	-104.8404719	0.01
9804.00	90.52	269.52	7160.09	3442.05	-357.81	-3431.27	40.4131682	-104.8408310	0.01
9904.00	90.52	269.52	7159.19	3542.01	-358.65	-3531.27	40.4131659	-104.8411901	0.01
10004.00	90.51	269.52	7158.29	3641.96	-359.48	-3631.26	40.4131635	-104.8415491	0.01
10104.00	90.50	269.52	7157.41	3741.92	-360.32	-3731.25	40.4131612	-104.8419082	0.01
10204.00	90.50	269.52	7156.54	3841.88	-361.15	-3831.24	40.4131589	-104.8422673	0.01
10304.00	90.49	269.52	7155.68	3941.83	-361.98	-3931.24	40.4131565	-104.8426264	0.01
10404.00	90.48	269.53	7154.84	4041.79	-362.81	-4031.23	40.4131542	-104.8429855	0.01
10504.00	90.48	269.53	7154.00	4141.75	-363.64	-4131.22	40.4131519	-104.8433445	0.01
10604.00	90.47	269.53	7153.18	4241.70	-364.46	-4231.22	40.4131496	-104.8437036	0.01
10704.00	90.46	269.53	7152.36	4341.66	-365.28	-4331.21	40.4131473	-104.8440627	0.01
10804.00	90.46	269.53	7151.56	4441.62	-366.10	-4431.20	40.4131450	-104.8444218	0.01
10904.00	90.45	269.53	7150.77	4541.57	-366.92	-4531.20	40.4131427	-104.8447809	0.01
11004.00	90.44	269.53	7150.00	4641.53	-367.74	-4631.19	40.4131404	-104.8451400	0.01
11104.00	90.44	269.53	7149.23	4741.49	-368.55	-4731.18	40.4131381	-104.8454991	0.01

BOST FARM 32C-11-L2 (REV-C.0) LAS.las

11204.00	90.43	269.54	7148.47	4841.44	-369.37	-4831.18	40.4131358	-104.8458581	0.01
11304.00	90.42	269.54	7147.73	4941.40	-370.18	-4931.17	40.4131336	-104.8462172	0.01
11404.00	90.42	269.54	7147.00	5041.36	-370.98	-5031.16	40.4131313	-104.8465763	0.01
11504.00	90.41	269.54	7146.28	5141.31	-371.79	-5131.16	40.4131290	-104.8469354	0.01
11604.00	90.40	269.54	7145.57	5241.27	-372.60	-5231.15	40.4131267	-104.8472945	0.01
11704.00	90.40	269.54	7144.87	5341.23	-373.40	-5331.15	40.4131245	-104.8476536	0.01
11804.00	90.39	269.54	7144.18	5441.18	-374.20	-5431.14	40.4131222	-104.8480127	0.01
11904.00	90.38	269.54	7143.51	5541.14	-375.00	-5531.14	40.4131200	-104.8483717	0.01
12004.00	90.38	269.54	7142.85	5641.10	-375.80	-5631.13	40.4131177	-104.8487308	0.01
12104.00	90.37	269.55	7142.19	5741.05	-376.59	-5731.13	40.4131155	-104.8490899	0.01
12204.00	90.36	269.55	7141.55	5841.01	-377.38	-5831.12	40.4131132	-104.8494490	0.01
12304.00	90.36	269.55	7140.93	5940.97	-378.17	-5931.12	40.4131110	-104.8498081	0.01
12404.00	90.35	269.55	7140.31	6040.93	-378.96	-6031.11	40.4131088	-104.8501672	0.01
12504.00	90.34	269.55	7139.70	6140.88	-379.75	-6131.11	40.4131065	-104.8505263	0.01
12604.00	90.34	269.55	7139.11	6240.84	-380.53	-6231.10	40.4131043	-104.8508854	0.01
12704.00	90.33	269.55	7138.52	6340.80	-381.32	-6331.10	40.4131021	-104.8512445	0.01
12804.00	90.32	269.55	7137.95	6440.75	-382.10	-6431.09	40.4130999	-104.8516035	0.01
12904.00	90.32	269.55	7137.39	6540.71	-382.88	-6531.09	40.4130977	-104.8519626	0.01
13004.00	90.31	269.56	7136.84	6640.67	-383.65	-6631.08	40.4130955	-104.8523217	0.01
13104.00	90.30	269.56	7136.31	6740.63	-384.43	-6731.08	40.4130933	-104.8526808	0.01
13204.00	90.30	269.56	7135.78	6840.58	-385.20	-6831.07	40.4130911	-104.8530399	0.01
13304.00	90.29	269.56	7135.27	6940.54	-385.97	-6931.07	40.4130889	-104.8533990	0.01
13404.00	90.29	269.56	7134.76	7040.50	-386.74	-7031.06	40.4130867	-104.8537581	0.01
13504.00	90.28	269.56	7134.27	7140.45	-387.51	-7131.06	40.4130845	-104.8541172	0.01
13604.00	90.27	269.56	7133.79	7240.41	-388.28	-7231.06	40.4130823	-104.8544763	0.01
13704.00	90.27	269.56	7133.33	7340.37	-389.04	-7331.05	40.4130801	-104.8548354	0.01
13804.00	90.26	269.56	7132.87	7440.33	-389.80	-7431.05	40.4130780	-104.8551945	0.01
13904.00	90.25	269.57	7132.42	7540.28	-390.56	-7531.04	40.4130758	-104.8555536	0.01
14004.00	90.25	269.57	7131.99	7640.24	-391.32	-7631.04	40.4130736	-104.8559126	0.01
14104.00	90.24	269.57	7131.57	7740.20	-392.07	-7731.04	40.4130715	-104.8562717	0.01
14204.00	90.23	269.57	7131.16	7840.16	-392.83	-7831.03	40.4130693	-104.8566308	0.01
14304.00	90.23	269.57	7130.76	7940.11	-393.58	-7931.03	40.4130672	-104.8569899	0.01
14404.00	90.22	269.57	7130.37	8040.07	-394.33	-8031.03	40.4130650	-104.8573490	0.01
14504.00	90.21	269.57	7129.99	8140.03	-395.07	-8131.02	40.4130629	-104.8577081	0.01

BOST FARM 32C-11-L2 (REV-C.0) LAS.las

14604.00	90.21	269.57	7129.63	8239.98	-395.82	-8231.02	40.4130608	-104.8580672	0.01
14704.00	90.20	269.58	7129.27	8339.94	-396.56	-8331.02	40.4130586	-104.8584263	0.01
14804.00	90.19	269.58	7128.93	8439.90	-397.30	-8431.01	40.4130565	-104.8587854	0.01
14904.00	90.19	269.58	7128.60	8539.85	-398.04	-8531.01	40.4130544	-104.8591445	0.01
15004.00	90.18	269.58	7128.28	8639.81	-398.78	-8631.01	40.4130522	-104.8595036	0.01
15104.00	90.17	269.58	7127.97	8739.77	-399.52	-8731.00	40.4130501	-104.8598627	0.01
15204.00	90.17	269.58	7127.68	8839.73	-400.25	-8831.00	40.4130480	-104.8602218	0.01
15304.00	90.16	269.58	7127.39	8939.68	-400.98	-8931.00	40.4130459	-104.8605809	0.01
15404.00	90.15	269.58	7127.12	9039.64	-401.71	-9030.99	40.4130438	-104.8609400	0.01
15504.00	90.15	269.58	7126.86	9139.60	-402.44	-9130.99	40.4130417	-104.8612991	0.01
15604.00	90.14	269.58	7126.61	9239.55	-403.17	-9230.99	40.4130396	-104.8616582	0.01
15704.00	90.13	269.59	7126.37	9339.51	-403.89	-9330.98	40.4130375	-104.8620173	0.01
15804.00	90.13	269.59	7126.14	9439.47	-404.61	-9430.98	40.4130354	-104.8623764	0.01
15904.00	90.12	269.59	7125.93	9539.42	-405.33	-9530.98	40.4130334	-104.8627354	0.01
16004.00	90.11	269.59	7125.72	9639.38	-406.05	-9630.98	40.4130313	-104.8630945	0.01
16104.00	90.11	269.59	7125.53	9739.34	-406.76	-9730.97	40.4130292	-104.8634536	0.01
16204.00	90.10	269.59	7125.35	9839.29	-407.48	-9830.97	40.4130271	-104.8638127	0.01
16304.00	90.09	269.59	7125.18	9939.25	-408.19	-9930.97	40.4130251	-104.8641718	0.01
16404.00	90.09	269.59	7125.02	10039.21	-408.90	-10030.97	40.4130230	-104.8645309	0.01
16504.00	90.08	269.60	7124.87	10139.16	-409.61	-10130.96	40.4130210	-104.8648900	0.01
16604.00	90.07	269.60	7124.74	10239.12	-410.31	-10230.96	40.4130189	-104.8652491	0.01
16704.00	90.07	269.60	7124.61	10339.08	-411.02	-10330.96	40.4130169	-104.8656082	0.01
16804.00	90.06	269.60	7124.50	10439.03	-411.72	-10430.96	40.4130148	-104.8659673	0.01
16904.00	90.06	269.60	7124.40	10538.99	-412.42	-10530.95	40.4130128	-104.8663264	0.01
17004.00	90.05	269.60	7124.31	10638.95	-413.12	-10630.95	40.4130108	-104.8666855	0.01
17104.00	90.04	269.60	7124.23	10738.90	-413.81	-10730.95	40.4130087	-104.8670446	0.01
17204.00	90.04	269.60	7124.16	10838.86	-414.51	-10830.95	40.4130067	-104.8674037	0.01
17304.00	90.03	269.60	7124.11	10938.81	-415.20	-10930.94	40.4130047	-104.8677628	0.01
17404.00	90.02	269.61	7124.06	11038.77	-415.89	-11030.94	40.4130027	-104.8681219	0.01
17504.00	90.02	269.61	7124.03	11138.73	-416.58	-11130.94	40.4130007	-104.8684810	0.01
17604.00	90.01	269.61	7124.01	11238.68	-417.26	-11230.94	40.4129986	-104.8688401	0.01
17704.00	90.00	269.61	7124.00	11338.64	-417.95	-11330.93	40.4129966	-104.8691992	0.01
17735.97	90.00	269.61	7124.00	11370.59	-418.17	-11362.90	40.4129960	-104.8693140	0.01
17804.00	90.00	269.61	7124.00	11438.59	-418.63	-11430.93	40.4129946	-104.8695583	0.00

BOST FARM 32C-11-L2 (REV-C.0) LAS.las

17835.94	90.00	269.61	7124.00	11470.52	-418.85	-11462.87	40.4129940	-104.8696730	0.00
----------	-------	--------	---------	----------	---------	-----------	------------	--------------	------



Planned Wellpath Report

BOST FARM 32C-11-L2 (REV-C.0) PWP

Page 1 of 10



REFERENCE WELLPATH IDENTIFICATION

Operator	SRC ENERGY	Slot	SLOT#02 BOST FARM 32C-11-L2 (2666'FSL & 1074'FWL, SEC.07)
Area	COLORADO	Well	BOST FARM 32C-11-L2
Field	WELD COUNTY (NAD83,TRUE NORTH)	Wellbore	BOST FARM 32C-11-L2 PWB
Facility	SEC.07-T05N-R66W		

REPORT SETUP INFORMATION

Projection System	NAD83 / Lambert Colorado SP, Northern Zone (501), US feet	Software System	WellArchitect® 5.1
North Reference	True	User	Bushjamh
Scale	0.999961	Report Generated	01/03/2019 at 14:04
Convergence at slot	0.43° East	Database/Source file	WA_DEN_Denver_Defn/BOST FARM 32C-11-L2 (REV-C.0) PWP PR.xml

WELLPATH LOCATION

	Local coordinates		Grid coordinates		Geographic coordinates	
	North[ft]	East[ft]	Easting[US ft]	Northing[US ft]	Latitude	Longitude
Slot Location	115.12	-184.36	3186976.37	1394423.51	40°24'50.944"N	104°49'42.632"W
Facility Reference Pt			3187161.59	1394309.79	40°24'49.806"N	104°49'40.249"W
Field Reference Pt			3171284.48	1426358.81	40°30'07.643"N	104°53'02.634"W

WELLPATH DATUM

Calculation method	Minimum curvature	IKON 12 (4') (RKB) to Facility Vertical Datum	4881.00ft
Horizontal Reference Pt	Slot	IKON 12 (4') (RKB) to Mean Sea Level	4881.00ft
Vertical Reference Pt	IKON 12 (4') (RKB)	IKON 12 (4') (RKB) to Mud Line at Slot (SLOT#02 BOST FARM 32C-11-L2 (2666'FSL & 1074'FWL, SEC.07))	4881.00ft
MD Reference Pt	IKON 12 (4') (RKB)	Section Origin	N 0.00, E 0.00 ft
Field Vertical Reference	Mean Sea Level	Section Azimuth	267.91°



Planned Wellpath Report

BOST FARM 32C-11-L2 (REV-C.0) PWP

Page 2 of 10

**BAKER
HUGHES**
a GE company



REFERENCE WELLPATH IDENTIFICATION

Operator	SRC ENERGY	Slot	SLOT#02 BOST FARM 32C-11-L2 (2666'FSL & 1074'FWL, SEC.07)
Area	COLORADO	Well	BOST FARM 32C-11-L2
Field	WELD COUNTY (NAD83,TRUE NORTH)	Wellbore	BOST FARM 32C-11-L2 PWB
Facility	SEC.07-T05N-R66W		

WELLPATH DATA (186 stations) † = interpolated/extrapolated station

MD [ft]	Inclination [°]	Azimuth [°]	TVD [ft]	Vert Sect [ft]	North [ft]	East [ft]	Latitude	Longitude	DLS [°/100ft]	Comments
0.00†	0.000	242.614	0.00	0.00	0.00	0.00	40°24'50.944"N	104°49'42.632"W	0.00	
4.00	0.000	242.614	4.00	0.00	0.00	0.00	40°24'50.944"N	104°49'42.632"W	0.00	Tie On
104.00†	0.000	242.614	104.00	0.00	0.00	0.00	40°24'50.944"N	104°49'42.632"W	0.00	
204.00†	0.000	242.614	204.00	0.00	0.00	0.00	40°24'50.944"N	104°49'42.632"W	0.00	
304.00†	0.000	242.614	304.00	0.00	0.00	0.00	40°24'50.944"N	104°49'42.632"W	0.00	
404.00†	0.000	242.614	404.00	0.00	0.00	0.00	40°24'50.944"N	104°49'42.632"W	0.00	
504.00†	0.000	242.614	504.00	0.00	0.00	0.00	40°24'50.944"N	104°49'42.632"W	0.00	
604.00†	0.000	242.614	604.00	0.00	0.00	0.00	40°24'50.944"N	104°49'42.632"W	0.00	
704.00†	0.000	242.614	704.00	0.00	0.00	0.00	40°24'50.944"N	104°49'42.632"W	0.00	
804.00†	0.000	242.614	804.00	0.00	0.00	0.00	40°24'50.944"N	104°49'42.632"W	0.00	
904.00†	0.000	242.614	904.00	0.00	0.00	0.00	40°24'50.944"N	104°49'42.632"W	0.00	
1004.00†	0.000	242.614	1004.00	0.00	0.00	0.00	40°24'50.944"N	104°49'42.632"W	0.00	
1100.00	0.000	242.614	1100.00	0.00	0.00	0.00	40°24'50.944"N	104°49'42.632"W	0.00	End of Tangent
1104.00†	0.080	242.614	1104.00	0.00	0.00	0.00	40°24'50.944"N	104°49'42.632"W	2.00	
1204.00†	2.080	242.614	1203.98	1.71	-0.87	-1.68	40°24'50.935"N	104°49'42.654"W	2.00	
1304.00†	4.080	242.614	1303.83	6.56	-3.34	-6.45	40°24'50.911"N	104°49'42.716"W	2.00	
1404.00†	6.080	242.614	1403.43	14.57	-7.41	-14.31	40°24'50.870"N	104°49'42.817"W	2.00	
1449.61	6.992	242.614	1448.75	19.26	-9.80	-18.92	40°24'50.847"N	104°49'42.877"W	2.00	End of Build
1504.00†	6.992	242.614	1502.73	25.25	-12.85	-24.80	40°24'50.817"N	104°49'42.953"W	0.00	
1604.00†	6.992	242.614	1601.98	36.26	-18.45	-35.61	40°24'50.761"N	104°49'43.093"W	0.00	
1704.00†	6.992	242.614	1701.24	47.26	-24.05	-46.42	40°24'50.706"N	104°49'43.232"W	0.00	
1804.00†	6.992	242.614	1800.50	58.27	-29.64	-57.23	40°24'50.651"N	104°49'43.372"W	0.00	
1904.00†	6.992	242.614	1899.75	69.28	-35.24	-68.03	40°24'50.595"N	104°49'43.512"W	0.00	
2004.00†	6.992	242.614	1999.01	80.28	-40.84	-78.84	40°24'50.540"N	104°49'43.652"W	0.00	
2104.00†	6.992	242.614	2098.27	91.29	-46.44	-89.65	40°24'50.485"N	104°49'43.791"W	0.00	
2204.00†	6.992	242.614	2197.52	102.30	-52.04	-100.46	40°24'50.429"N	104°49'43.931"W	0.00	
2304.00†	6.992	242.614	2296.78	113.30	-57.64	-111.27	40°24'50.374"N	104°49'44.071"W	0.00	
2404.00†	6.992	242.614	2396.03	124.31	-63.24	-122.08	40°24'50.319"N	104°49'44.211"W	0.00	
2504.00†	6.992	242.614	2495.29	135.31	-68.84	-132.89	40°24'50.263"N	104°49'44.350"W	0.00	
2604.00†	6.992	242.614	2594.55	146.32	-74.44	-143.70	40°24'50.208"N	104°49'44.490"W	0.00	



Planned Wellpath Report

BOST FARM 32C-11-L2 (REV-C.0) PWP

Page 3 of 10

**BAKER
HUGHES**
a GE company



REFERENCE WELLPATH IDENTIFICATION

Operator	SRC ENERGY	Slot	SLOT#02 BOST FARM 32C-11-L2 (2666'FSL & 1074'FWL, SEC.07)
Area	COLORADO	Well	BOST FARM 32C-11-L2
Field	WELD COUNTY (NAD83,TRUE NORTH)	Wellbore	BOST FARM 32C-11-L2 PWB
Facility	SEC.07-T05N-R66W		

WELLPATH DATA (186 stations) † = interpolated/extrapolated station

MD [ft]	Inclination [°]	Azimuth [°]	TVD [ft]	Vert Sect [ft]	North [ft]	East [ft]	Latitude	Longitude	DLS [°/100ft]	Comments
2704.00†	6.992	242.614	2693.80	157.33	-80.04	-154.51	40°24'50.153"N	104°49'44.630"W	0.00	
2804.00†	6.992	242.614	2793.06	168.33	-85.64	-165.32	40°24'50.097"N	104°49'44.770"W	0.00	
2904.00†	6.992	242.614	2892.32	179.34	-91.24	-176.13	40°24'50.042"N	104°49'44.909"W	0.00	
3004.00†	6.992	242.614	2991.57	190.35	-96.84	-186.94	40°24'49.987"N	104°49'45.049"W	0.00	
3104.00†	6.992	242.614	3090.83	201.35	-102.44	-197.74	40°24'49.931"N	104°49'45.189"W	0.00	
3204.00†	6.992	242.614	3190.08	212.36	-108.04	-208.55	40°24'49.876"N	104°49'45.329"W	0.00	
3304.00†	6.992	242.614	3289.34	223.37	-113.64	-219.36	40°24'49.821"N	104°49'45.468"W	0.00	
3404.00†	6.992	242.614	3388.60	234.37	-119.24	-230.17	40°24'49.765"N	104°49'45.608"W	0.00	
3504.00†	6.992	242.614	3487.85	245.38	-124.84	-240.98	40°24'49.710"N	104°49'45.748"W	0.00	
3604.00†	6.992	242.614	3587.11	256.39	-130.44	-251.79	40°24'49.655"N	104°49'45.888"W	0.00	
3704.00†	6.992	242.614	3686.37	267.39	-136.04	-262.60	40°24'49.599"N	104°49'46.027"W	0.00	
3804.00†	6.992	242.614	3785.62	278.40	-141.64	-273.41	40°24'49.544"N	104°49'46.167"W	0.00	
3904.00†	6.992	242.614	3884.88	289.41	-147.24	-284.22	40°24'49.489"N	104°49'46.307"W	0.00	
4004.00†	6.992	242.614	3984.13	300.41	-152.84	-295.03	40°24'49.433"N	104°49'46.447"W	0.00	
4104.00†	6.992	242.614	4083.39	311.42	-158.44	-305.84	40°24'49.378"N	104°49'46.586"W	0.00	
4204.00†	6.992	242.614	4182.65	322.42	-164.04	-316.65	40°24'49.323"N	104°49'46.726"W	0.00	
4304.00†	6.992	242.614	4281.90	333.43	-169.64	-327.46	40°24'49.267"N	104°49'46.866"W	0.00	
4404.00†	6.992	242.614	4381.16	344.44	-175.23	-338.26	40°24'49.212"N	104°49'47.005"W	0.00	
4504.00†	6.992	242.614	4480.42	355.44	-180.83	-349.07	40°24'49.157"N	104°49'47.145"W	0.00	
4604.00†	6.992	242.614	4579.67	366.45	-186.43	-359.88	40°24'49.101"N	104°49'47.285"W	0.00	
4704.00†	6.992	242.614	4678.93	377.46	-192.03	-370.69	40°24'49.046"N	104°49'47.425"W	0.00	
4804.00†	6.992	242.614	4778.18	388.46	-197.63	-381.50	40°24'48.991"N	104°49'47.564"W	0.00	
4904.00†	6.992	242.614	4877.44	399.47	-203.23	-392.31	40°24'48.935"N	104°49'47.704"W	0.00	
5004.00†	6.992	242.614	4976.70	410.48	-208.83	-403.12	40°24'48.880"N	104°49'47.844"W	0.00	
5104.00†	6.992	242.614	5075.95	421.48	-214.43	-413.93	40°24'48.825"N	104°49'47.984"W	0.00	
5204.00†	6.992	242.614	5175.21	432.49	-220.03	-424.74	40°24'48.769"N	104°49'48.123"W	0.00	
5304.00†	6.992	242.614	5274.47	443.50	-225.63	-435.55	40°24'48.714"N	104°49'48.263"W	0.00	
5404.00†	6.992	242.614	5373.72	454.50	-231.23	-446.36	40°24'48.659"N	104°49'48.403"W	0.00	
5504.00†	6.992	242.614	5472.98	465.51	-236.83	-457.17	40°24'48.603"N	104°49'48.543"W	0.00	
5604.00†	6.992	242.614	5572.24	476.52	-242.43	-467.98	40°24'48.548"N	104°49'48.682"W	0.00	



Planned Wellpath Report

BOST FARM 32C-11-L2 (REV-C.0) PWP

Page 4 of 10



REFERENCE WELLPATH IDENTIFICATION

Operator	SRC ENERGY	Slot	SLOT#02 BOST FARM 32C-11-L2 (2666'FSL & 1074'FWL, SEC.07)
Area	COLORADO	Well	BOST FARM 32C-11-L2
Field	WELD COUNTY (NAD83,TRUE NORTH)	Wellbore	BOST FARM 32C-11-L2 PWB
Facility	SEC.07-T05N-R66W		

WELLPATH DATA (186 stations) † = interpolated/extrapolated station

MD [ft]	Inclination [°]	Azimuth [°]	TVD [ft]	Vert Sect [ft]	North [ft]	East [ft]	Latitude	Longitude	DLS [°/100ft]	Comments
5704.00†	6.992	242.614	5671.49	487.52	-248.03	-478.78	40°24'48.493"N	104°49'48.822"W	0.00	
5804.00†	6.992	242.614	5770.75	498.53	-253.63	-489.59	40°24'48.437"N	104°49'48.962"W	0.00	
5904.00†	6.992	242.614	5870.00	509.53	-259.23	-500.40	40°24'48.382"N	104°49'49.102"W	0.00	
6004.00†	6.992	242.614	5969.26	520.54	-264.83	-511.21	40°24'48.327"N	104°49'49.241"W	0.00	
6104.00†	6.992	242.614	6068.52	531.55	-270.43	-522.02	40°24'48.271"N	104°49'49.381"W	0.00	
6204.00†	6.992	242.614	6167.77	542.55	-276.03	-532.83	40°24'48.216"N	104°49'49.521"W	0.00	
6304.00†	6.992	242.614	6267.03	553.56	-281.63	-543.64	40°24'48.161"N	104°49'49.661"W	0.00	
6404.00†	6.992	242.614	6366.29	564.57	-287.23	-554.45	40°24'48.105"N	104°49'49.800"W	0.00	
6504.00†	6.992	242.614	6465.54	575.57	-292.83	-565.26	40°24'48.050"N	104°49'49.940"W	0.00	
6604.00†	6.992	242.614	6564.80	586.58	-298.43	-576.07	40°24'47.995"N	104°49'50.080"W	0.00	
6656.03	6.992	242.614	6616.44	592.31	-301.34	-581.69	40°24'47.966"N	104°49'50.152"W	0.00	End of Tangent
6704.00†	11.014	252.925	6663.81	599.38	-304.03	-588.67	40°24'47.939"N	104°49'50.243"W	9.00	
6804.00†	19.798	260.608	6760.13	625.46	-309.61	-614.56	40°24'47.884"N	104°49'50.577"W	9.00	
6904.00†	28.714	263.655	6851.22	666.29	-315.04	-655.23	40°24'47.830"N	104°49'51.103"W	9.00	
7004.00†	37.667	265.343	6934.82	720.88	-320.19	-709.67	40°24'47.780"N	104°49'51.807"W	9.00	
7104.00†	46.636	266.459	7008.88	787.88	-324.92	-776.54	40°24'47.733"N	104°49'52.671"W	9.00	
7204.00†	55.613	267.285	7071.58	865.64	-329.13	-854.19	40°24'47.691"N	104°49'53.675"W	9.00	
7304.00†	64.595	267.950	7121.37	952.24	-332.71	-940.72	40°24'47.656"N	104°49'54.794"W	9.00	
7404.00†	73.579	268.522	7157.03	1045.56	-335.56	-1034.00	40°24'47.627"N	104°49'56.000"W	9.00	
7504.00†	82.564	269.043	7177.68	1143.29	-337.63	-1131.71	40°24'47.607"N	104°49'57.263"W	9.00	
7594.16	90.667	269.494	7183.00†	1233.19	-338.78	-1221.64	40°24'47.596"N	104°49'58.426"W	9.00	End of 3D Arc
7604.00†	90.666	269.494	7182.89	1243.03	-338.87	-1231.47	40°24'47.595"N	104°49'58.553"W	0.01	
7704.00†	90.659	269.495	7181.73	1342.98	-339.75	-1331.46	40°24'47.586"N	104°49'59.845"W	0.01	
7804.00†	90.653	269.496	7180.58	1442.94	-340.63	-1431.45	40°24'47.577"N	104°50'01.138"W	0.01	
7904.00†	90.646	269.498	7179.45	1542.89	-341.51	-1531.44	40°24'47.568"N	104°50'02.431"W	0.01	
8004.00†	90.640	269.499	7178.33	1642.85	-342.38	-1631.43	40°24'47.560"N	104°50'03.723"W	0.01	
8104.00†	90.633	269.500	7177.22	1742.80	-343.26	-1731.42	40°24'47.551"N	104°50'05.016"W	0.01	
8204.00†	90.627	269.501	7176.12	1842.76	-344.13	-1831.41	40°24'47.542"N	104°50'06.309"W	0.01	
8304.00†	90.620	269.502	7175.03	1942.71	-345.00	-1931.40	40°24'47.534"N	104°50'07.601"W	0.01	
8404.00†	90.613	269.503	7173.95	2042.67	-345.87	-2031.39	40°24'47.525"N	104°50'08.894"W	0.01	



Planned Wellpath Report

BOST FARM 32C-11-L2 (REV-C.0) PWP

Page 5 of 10



REFERENCE WELLPATH IDENTIFICATION

Operator	SRC ENERGY	Slot	SLOT#02 BOST FARM 32C-11-L2 (2666'FSL & 1074'FWL, SEC.07)
Area	COLORADO	Well	BOST FARM 32C-11-L2
Field	WELD COUNTY (NAD83,TRUE NORTH)	Wellbore	BOST FARM 32C-11-L2 PWB
Facility	SEC.07-T05N-R66W		

WELLPATH DATA (186 stations) † = interpolated/extrapolated station

MD [ft]	Inclination [°]	Azimuth [°]	TVD [ft]	Vert Sect [ft]	North [ft]	East [ft]	Latitude	Longitude	DLS [°/100ft]	Comments
8504.00†	90.607	269.504	7172.89	2142.62	-346.73	-2131.38	40°24'47.516"N	104°50'10.187"W	0.01	
8604.00†	90.600	269.506	7171.84	2242.58	-347.60	-2231.37	40°24'47.508"N	104°50'11.479"W	0.01	
8704.00†	90.594	269.507	7170.79	2342.53	-348.46	-2331.36	40°24'47.499"N	104°50'12.772"W	0.01	
8804.00†	90.587	269.508	7169.76	2442.49	-349.32	-2431.36	40°24'47.491"N	104°50'14.065"W	0.01	
8904.00†	90.581	269.509	7168.74	2542.45	-350.18	-2531.35	40°24'47.482"N	104°50'15.357"W	0.01	
9004.00†	90.574	269.510	7167.74	2642.40	-351.03	-2631.34	40°24'47.473"N	104°50'16.650"W	0.01	
9104.00†	90.567	269.511	7166.74	2742.36	-351.89	-2731.33	40°24'47.465"N	104°50'17.943"W	0.01	
9204.00†	90.561	269.512	7165.76	2842.31	-352.74	-2831.32	40°24'47.456"N	104°50'19.235"W	0.01	
9304.00†	90.554	269.513	7164.78	2942.27	-353.59	-2931.31	40°24'47.448"N	104°50'20.528"W	0.01	
9404.00†	90.548	269.515	7163.82	3042.23	-354.44	-3031.30	40°24'47.439"N	104°50'21.821"W	0.01	
9504.00†	90.541	269.516	7162.87	3142.18	-355.28	-3131.30	40°24'47.431"N	104°50'23.113"W	0.01	
9604.00†	90.535	269.517	7161.93	3242.14	-356.13	-3231.29	40°24'47.422"N	104°50'24.406"W	0.01	
9704.00†	90.528	269.518	7161.01	3342.09	-356.97	-3331.28	40°24'47.414"N	104°50'25.699"W	0.01	
9804.00†	90.521	269.519	7160.09	3442.05	-357.81	-3431.27	40°24'47.406"N	104°50'26.992"W	0.01	
9904.00†	90.515	269.520	7159.19	3542.01	-358.65	-3531.27	40°24'47.397"N	104°50'28.284"W	0.01	
10004.00†	90.508	269.521	7158.29	3641.96	-359.48	-3631.26	40°24'47.389"N	104°50'29.577"W	0.01	
10104.00†	90.502	269.523	7157.41	3741.92	-360.32	-3731.25	40°24'47.380"N	104°50'30.870"W	0.01	
10204.00†	90.495	269.524	7156.54	3841.88	-361.15	-3831.24	40°24'47.372"N	104°50'32.162"W	0.01	
10304.00†	90.489	269.525	7155.68	3941.83	-361.98	-3931.24	40°24'47.364"N	104°50'33.455"W	0.01	
10404.00†	90.482	269.526	7154.84	4041.79	-362.81	-4031.23	40°24'47.355"N	104°50'34.748"W	0.01	
10504.00†	90.475	269.527	7154.00	4141.75	-363.64	-4131.22	40°24'47.347"N	104°50'36.040"W	0.01	
10604.00†	90.469	269.528	7153.18	4241.70	-364.46	-4231.22	40°24'47.339"N	104°50'37.333"W	0.01	
10704.00†	90.462	269.529	7152.36	4341.66	-365.28	-4331.21	40°24'47.330"N	104°50'38.626"W	0.01	
10804.00†	90.456	269.530	7151.56	4441.62	-366.10	-4431.20	40°24'47.322"N	104°50'39.918"W	0.01	
10904.00†	90.449	269.532	7150.77	4541.57	-366.92	-4531.20	40°24'47.314"N	104°50'41.211"W	0.01	
11004.00†	90.443	269.533	7150.00	4641.53	-367.74	-4631.19	40°24'47.305"N	104°50'42.504"W	0.01	
11104.00†	90.436	269.534	7149.23	4741.49	-368.55	-4731.18	40°24'47.297"N	104°50'43.797"W	0.01	
11204.00†	90.429	269.535	7148.47	4841.44	-369.37	-4831.18	40°24'47.289"N	104°50'45.089"W	0.01	
11304.00†	90.423	269.536	7147.73	4941.40	-370.18	-4931.17	40°24'47.281"N	104°50'46.382"W	0.01	
11404.00†	90.416	269.537	7147.00	5041.36	-370.98	-5031.16	40°24'47.273"N	104°50'47.675"W	0.01	



Planned Wellpath Report

BOST FARM 32C-11-L2 (REV-C.0) PWP

Page 6 of 10



REFERENCE WELLPATH IDENTIFICATION

Operator	SRC ENERGY	Slot	SLOT#02 BOST FARM 32C-11-L2 (2666'FSL & 1074'FWL, SEC.07)
Area	COLORADO	Well	BOST FARM 32C-11-L2
Field	WELD COUNTY (NAD83,TRUE NORTH)	Wellbore	BOST FARM 32C-11-L2 PWB
Facility	SEC.07-T05N-R66W		

WELLPATH DATA (186 stations) † = interpolated/extrapolated station

MD [ft]	Inclination [°]	Azimuth [°]	TVD [ft]	Vert Sect [ft]	North [ft]	East [ft]	Latitude	Longitude	DLS [°/100ft]	Comments
11504.00†	90.410	269.538	7146.28	5141.31	-371.79	-5131.16	40°24'47.264"N	104°50'48.967"W	0.01	
11604.00†	90.403	269.539	7145.57	5241.27	-372.60	-5231.15	40°24'47.256"N	104°50'50.260"W	0.01	
11704.00†	90.396	269.541	7144.87	5341.23	-373.40	-5331.15	40°24'47.248"N	104°50'51.553"W	0.01	
11804.00†	90.390	269.542	7144.18	5441.18	-374.20	-5431.14	40°24'47.240"N	104°50'52.846"W	0.01	
11904.00†	90.383	269.543	7143.51	5541.14	-375.00	-5531.14	40°24'47.232"N	104°50'54.138"W	0.01	
12004.00†	90.377	269.544	7142.85	5641.10	-375.80	-5631.13	40°24'47.224"N	104°50'55.431"W	0.01	
12104.00†	90.370	269.545	7142.19	5741.05	-376.59	-5731.13	40°24'47.216"N	104°50'56.724"W	0.01	
12204.00†	90.364	269.546	7141.55	5841.01	-377.38	-5831.12	40°24'47.208"N	104°50'58.016"W	0.01	
12304.00†	90.357	269.547	7140.93	5940.97	-378.17	-5931.12	40°24'47.200"N	104°50'59.309"W	0.01	
12404.00†	90.350	269.549	7140.31	6040.93	-378.96	-6031.11	40°24'47.192"N	104°51'00.602"W	0.01	
12504.00†	90.344	269.550	7139.70	6140.88	-379.75	-6131.11	40°24'47.184"N	104°51'01.895"W	0.01	
12604.00†	90.337	269.551	7139.11	6240.84	-380.53	-6231.10	40°24'47.176"N	104°51'03.187"W	0.01	
12704.00†	90.331	269.552	7138.52	6340.80	-381.32	-6331.10	40°24'47.168"N	104°51'04.480"W	0.01	
12804.00†	90.324	269.553	7137.95	6440.75	-382.10	-6431.09	40°24'47.160"N	104°51'05.773"W	0.01	
12904.00†	90.318	269.554	7137.39	6540.71	-382.88	-6531.09	40°24'47.152"N	104°51'07.065"W	0.01	
13004.00†	90.311	269.555	7136.84	6640.67	-383.65	-6631.08	40°24'47.144"N	104°51'08.358"W	0.01	
13104.00†	90.304	269.556	7136.31	6740.63	-384.43	-6731.08	40°24'47.136"N	104°51'09.651"W	0.01	
13204.00†	90.298	269.558	7135.78	6840.58	-385.20	-6831.07	40°24'47.128"N	104°51'10.944"W	0.01	
13304.00†	90.291	269.559	7135.27	6940.54	-385.97	-6931.07	40°24'47.120"N	104°51'12.236"W	0.01	
13404.00†	90.285	269.560	7134.76	7040.50	-386.74	-7031.06	40°24'47.112"N	104°51'13.529"W	0.01	
13504.00†	90.278	269.561	7134.27	7140.45	-387.51	-7131.06	40°24'47.104"N	104°51'14.822"W	0.01	
13604.00†	90.272	269.562	7133.79	7240.41	-388.28	-7231.06	40°24'47.096"N	104°51'16.115"W	0.01	
13704.00†	90.265	269.563	7133.33	7340.37	-389.04	-7331.05	40°24'47.089"N	104°51'17.407"W	0.01	
13804.00†	90.258	269.564	7132.87	7440.33	-389.80	-7431.05	40°24'47.081"N	104°51'18.700"W	0.01	
13904.00†	90.252	269.566	7132.42	7540.28	-390.56	-7531.04	40°24'47.073"N	104°51'19.993"W	0.01	
14004.00†	90.245	269.567	7131.99	7640.24	-391.32	-7631.04	40°24'47.065"N	104°51'21.286"W	0.01	
14104.00†	90.239	269.568	7131.57	7740.20	-392.07	-7731.04	40°24'47.057"N	104°51'22.578"W	0.01	
14204.00†	90.232	269.569	7131.16	7840.16	-392.83	-7831.03	40°24'47.050"N	104°51'23.871"W	0.01	
14304.00†	90.226	269.570	7130.76	7940.11	-393.58	-7931.03	40°24'47.042"N	104°51'25.164"W	0.01	
14404.00†	90.219	269.571	7130.37	8040.07	-394.33	-8031.03	40°24'47.034"N	104°51'26.456"W	0.01	



Planned Wellpath Report

BOST FARM 32C-11-L2 (REV-C.0) PWP

Page 7 of 10



REFERENCE WELLPATH IDENTIFICATION

Operator	SRC ENERGY	Slot	SLOT#02 BOST FARM 32C-11-L2 (2666'FSL & 1074'FWL, SEC.07)
Area	COLORADO	Well	BOST FARM 32C-11-L2
Field	WELD COUNTY (NAD83,TRUE NORTH)	Wellbore	BOST FARM 32C-11-L2 PWB
Facility	SEC.07-T05N-R66W		

WELLPATH DATA (186 stations) † = interpolated/extrapolated station

MD [ft]	Inclination [°]	Azimuth [°]	TVD [ft]	Vert Sect [ft]	North [ft]	East [ft]	Latitude	Longitude	DLS [°/100ft]	Comments
14504.00†	90.212	269.572	7129.99	8140.03	-395.07	-8131.02	40°24'47.026"N	104°51'27.749"W	0.01	
14604.00†	90.206	269.573	7129.63	8239.98	-395.82	-8231.02	40°24'47.019"N	104°51'29.042"W	0.01	
14704.00†	90.199	269.575	7129.27	8339.94	-396.56	-8331.02	40°24'47.011"N	104°51'30.335"W	0.01	
14804.00†	90.193	269.576	7128.93	8439.90	-397.30	-8431.01	40°24'47.003"N	104°51'31.627"W	0.01	
14904.00†	90.186	269.577	7128.60	8539.85	-398.04	-8531.01	40°24'46.996"N	104°51'32.920"W	0.01	
15004.00†	90.180	269.578	7128.28	8639.81	-398.78	-8631.01	40°24'46.988"N	104°51'34.213"W	0.01	
15104.00†	90.173	269.579	7127.97	8739.77	-399.52	-8731.00	40°24'46.980"N	104°51'35.506"W	0.01	
15204.00†	90.166	269.580	7127.68	8839.73	-400.25	-8831.00	40°24'46.973"N	104°51'36.798"W	0.01	
15304.00†	90.160	269.581	7127.39	8939.68	-400.98	-8931.00	40°24'46.965"N	104°51'38.091"W	0.01	
15404.00†	90.153	269.582	7127.12	9039.64	-401.71	-9030.99	40°24'46.958"N	104°51'39.384"W	0.01	
15504.00†	90.147	269.584	7126.86	9139.60	-402.44	-9130.99	40°24'46.950"N	104°51'40.677"W	0.01	
15604.00†	90.140	269.585	7126.61	9239.55	-403.17	-9230.99	40°24'46.943"N	104°51'41.969"W	0.01	
15704.00†	90.134	269.586	7126.37	9339.51	-403.89	-9330.98	40°24'46.935"N	104°51'43.262"W	0.01	
15804.00†	90.127	269.587	7126.14	9439.47	-404.61	-9430.98	40°24'46.928"N	104°51'44.555"W	0.01	
15904.00†	90.120	269.588	7125.93	9539.42	-405.33	-9530.98	40°24'46.920"N	104°51'45.848"W	0.01	
16004.00†	90.114	269.589	7125.72	9639.38	-406.05	-9630.98	40°24'46.913"N	104°51'47.140"W	0.01	
16104.00†	90.107	269.590	7125.53	9739.34	-406.76	-9730.97	40°24'46.905"N	104°51'48.433"W	0.01	
16204.00†	90.101	269.592	7125.35	9839.29	-407.48	-9830.97	40°24'46.898"N	104°51'49.726"W	0.01	
16304.00†	90.094	269.593	7125.18	9939.25	-408.19	-9930.97	40°24'46.890"N	104°51'51.019"W	0.01	
16404.00†	90.088	269.594	7125.02	10039.21	-408.90	-10030.97	40°24'46.883"N	104°51'52.311"W	0.01	
16504.00†	90.081	269.595	7124.87	10139.16	-409.61	-10130.96	40°24'46.875"N	104°51'53.604"W	0.01	
16604.00†	90.074	269.596	7124.74	10239.12	-410.31	-10230.96	40°24'46.868"N	104°51'54.897"W	0.01	
16704.00†	90.068	269.597	7124.61	10339.08	-411.02	-10330.96	40°24'46.861"N	104°51'56.190"W	0.01	
16804.00†	90.061	269.598	7124.50	10439.03	-411.72	-10430.96	40°24'46.853"N	104°51'57.482"W	0.01	
16904.00†	90.055	269.599	7124.40	10538.99	-412.42	-10530.95	40°24'46.846"N	104°51'58.775"W	0.01	
17004.00†	90.048	269.601	7124.31	10638.95	-413.12	-10630.95	40°24'46.839"N	104°52'00.068"W	0.01	
17104.00†	90.042	269.602	7124.23	10738.90	-413.81	-10730.95	40°24'46.831"N	104°52'01.361"W	0.01	
17204.00†	90.035	269.603	7124.16	10838.86	-414.51	-10830.95	40°24'46.824"N	104°52'02.653"W	0.01	
17304.00†	90.028	269.604	7124.11	10938.81	-415.20	-10930.94	40°24'46.817"N	104°52'03.946"W	0.01	
17404.00†	90.022	269.605	7124.06	11038.77	-415.89	-11030.94	40°24'46.810"N	104°52'05.239"W	0.01	



Planned Wellpath Report

BOST FARM 32C-11-L2 (REV-C.0) PWP

Page 8 of 10



REFERENCE WELLPATH IDENTIFICATION

Operator	SRC ENERGY	Slot	SLOT#02 BOST FARM 32C-11-L2 (2666'FSL & 1074'FWL, SEC.07)
Area	COLORADO	Well	BOST FARM 32C-11-L2
Field	WELD COUNTY (NAD83,TRUE NORTH)	Wellbore	BOST FARM 32C-11-L2 PWB
Facility	SEC.07-T05N-R66W		

WELLPATH DATA (186 stations) † = interpolated/extrapolated station

MD [ft]	Inclination [°]	Azimuth [°]	TVD [ft]	Vert Sect [ft]	North [ft]	East [ft]	Latitude	Longitude	DLS [°/100ft]	Comments
17504.00†	90.015	269.606	7124.03	11138.73	-416.58	-11130.94	40°24'46.802"N	104°52'06.532"W	0.01	
17604.00†	90.009	269.607	7124.01	11238.68	-417.26	-11230.94	40°24'46.795"N	104°52'07.824"W	0.01	
17704.00†	90.002	269.609	7124.00	11338.64	-417.95	-11330.93	40°24'46.788"N	104°52'09.117"W	0.01	
17735.97	90.000	269.609	7124.00 ²	11370.59	-418.17	-11362.90	40°24'46.786"N	104°52'09.530"W	0.01	End of 3D Arc
17804.00†	90.000	269.609	7124.00	11438.59	-418.63	-11430.93	40°24'46.781"N	104°52'10.410"W	0.00	
17835.94	90.000	269.609	7124.00 ³	11470.52	-418.85	-11462.87	40°24'46.778"N	104°52'10.823"W	0.00	End of Tangent

HOLE & CASING SECTIONS - Ref Wellbore: BOST FARM 32C-11-L2 PWB Ref Wellpath: BOST FARM 32C-11-L2 (REV-C.0) PWP

String/Diameter	Start MD [ft]	End MD [ft]	Interval [ft]	Start TVD [ft]	End TVD [ft]	Start N/S [ft]	Start E/W [ft]	End N/S [ft]	End E/W [ft]
13.5in Open Hole	4.00	1750.00	1746.00	4.00	1746.90	0.00	0.00	-26.62	-51.39
9.625in Casing Surface	4.00	1750.00	1746.00	4.00	1746.90	0.00	0.00	-26.62	-51.39
8.5in Open Hole	1750.00	17835.94	16085.94	1746.90	7124.00	-26.62	-51.39	-418.85	-11462.87



Planned Wellpath Report

BOST FARM 32C-11-L2 (REV-C.0) PWP

Page 9 of 10



REFERENCE WELLPATH IDENTIFICATION

Operator	SRC ENERGY	Slot	SLOT#02 BOST FARM 32C-11-L2 (2666'FSL & 1074'FWL, SEC.07)
Area	COLORADO	Well	BOST FARM 32C-11-L2
Field	WELD COUNTY (NAD83,TRUE NORTH)	Wellbore	BOST FARM 32C-11-L2 PWB
Facility	SEC.07-T05N-R66W		

TARGETS

Name	MD [ft]	TVD [ft]	North [ft]	East [ft]	Grid East [US ft]	Grid North [US ft]	Latitude	Longitude	Shape
SEC.07-T05N-R66W		5.00	-115.12	184.36	3187161.59	1394309.79	40°24'49.806"N	104°49'40.249"W	polygon
SEC.11-T05N-R67W		5.00	-115.12	184.36	3187161.59	1394309.79	40°24'49.806"N	104°49'40.249"W	polygon
SEC.12-T05N-R67W		5.00	-115.12	184.36	3187161.59	1394309.79	40°24'49.806"N	104°49'40.249"W	polygon
BOST FARM 32C-11-L2 BHL ON PLAT (2251'FSL & 360'FWL, SEC.12)		7121.00	-416.44	-11152.94	3175827.37	1393922.64	40°24'46.804"N	104°52'06.816"W	point
BOST FARM 32C-11-L2 BPZ ON PLAT (2357'FSL & 460'FWL, SEC.12)		7121.00	-415.76	-11052.97	3175927.33	1393924.08	40°24'46.811"N	104°52'05.524"W	point
BOST FARM 32C-11-L2 BHL REV-1 (2251'FSL & 360'FWL, SEC.12)		7124.00	-416.40	-11152.94	3175827.37	1393922.68	40°24'46.804"N	104°52'06.816"W	point
3) BOST FARM 32C-11-L2 BHL REV-2 (2244'FSL & 50'FWL, SEC.12)	17835.94	7124.00	-418.85	-11462.87	3175517.47	1393917.89	40°24'46.778"N	104°52'10.823"W	point
BOST FARM 32C-11-L2 BPZ REV-1 (2353'FSL & 460'FWL, SEC.12)		7124.00	-415.74	-11053.00	3175927.29	1393924.10	40°24'46.811"N	104°52'05.524"W	point
2) BOST FARM 32C-11-L2 BPZ REV-2 (2246'FSL & 150'FWL, SEC.12)	17735.97	7124.00	-418.17	-11362.90	3175617.43	1393919.33	40°24'46.786"N	104°52'09.530"W	point
1) BOST FARM 32C-11-L2 TOP OF PROD REV-1 (2321'FSL & 150'FEL, SEC.11)	7594.16	7183.00	-338.78	-1221.64	3185757.39	1394075.50	40°24'47.596"N	104°49'58.426"W	point
BOST FARM 32C-11-L2 TOP OF PROD ON PLAT (2321'FSL & 150'FEL, SEC.11)		7285.00	-338.78	-1221.64	3185757.39	1394075.50	40°24'47.596"N	104°49'58.426"W	point



Planned Wellpath Report

BOST FARM 32C-11-L2 (REV-C.0) PWP

Page 10 of 10



REFERENCE WELLPATH IDENTIFICATION			
Operator	SRC ENERGY	Slot	SLOT#02 BOST FARM 32C-11-L2 (2666'FSL & 1074'FWL, SEC.07)
Area	COLORADO	Well	BOST FARM 32C-11-L2
Field	WELD COUNTY (NAD83,TRUE NORTH)	Wellbore	BOST FARM 32C-11-L2 PWB
Facility	SEC.07-T05N-R66W		

SURVEY PROGRAM - Ref Wellbore: BOST FARM 32C-11-L2 PWB Ref Wellpath: BOST FARM 32C-11-L2 (REV-C.0) PWP				
Start MD [ft]	End MD [ft]	Positional Uncertainty Model	Log Name/Comment	Wellbore
4.00	1750.00	BHI NaviTrak (Axial)		BOST FARM 32C-11-L2 PWB
1750.00	17835.94	BHI AutoTrak Curve (MagCAD+IFR1, Short spacing)		BOST FARM 32C-11-L2 PWB