



Lat40°, Inc. 6250 W. 10th Street, Unit 2, Greeley, CO 970-515-5294

# HYDROLOGY MAP

MTD 7N66W23 1-8 PAD

SECTION: 23  
TOWNSHIP: 7N  
RANGE: 66W  
6TH. P.M.  
WELD COUNTY, CO

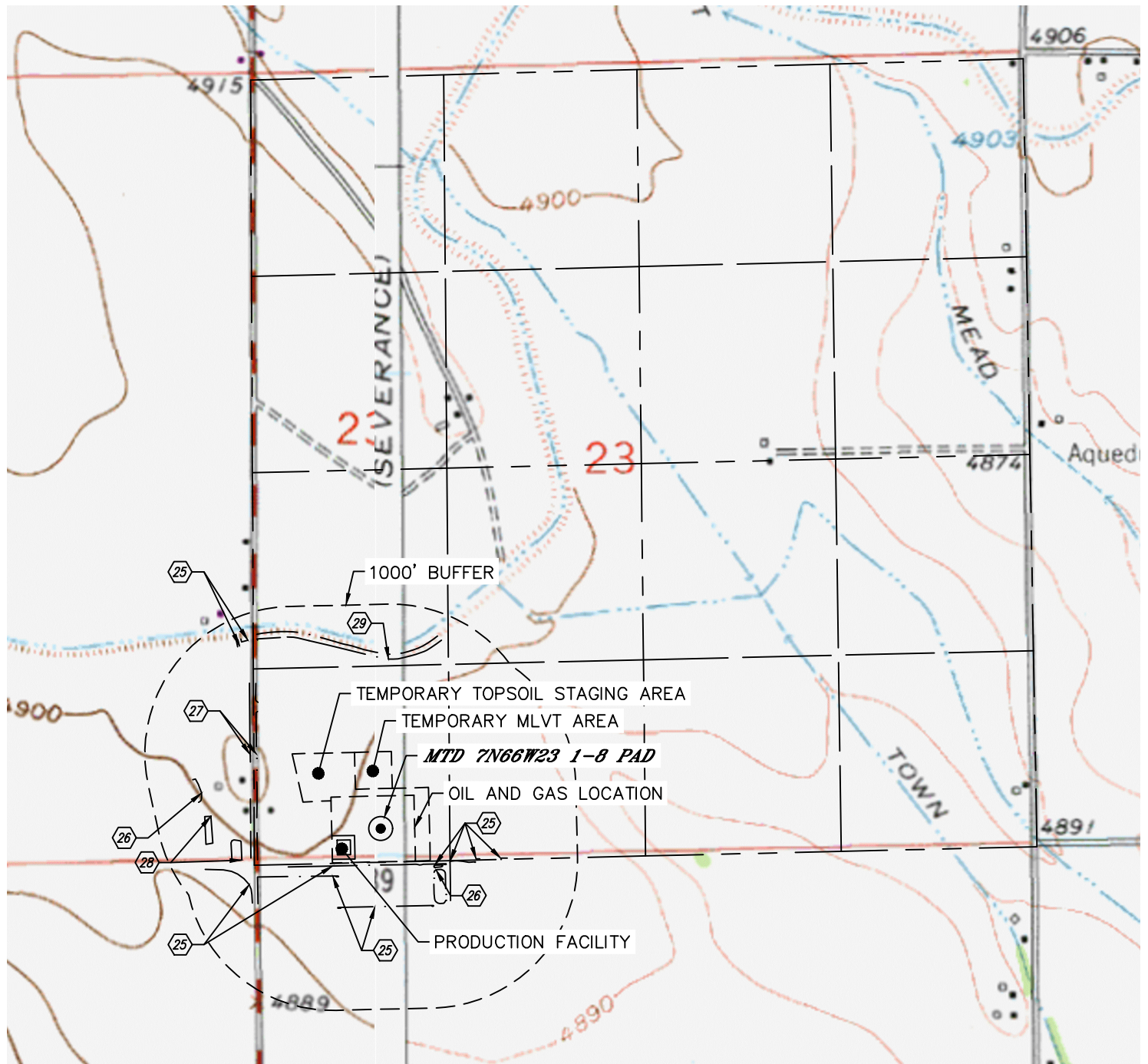

DISTANCES MEASURED FROM THE EDGE OF THE OIL AND GAS LOCATION.

- 25 DITCH 21', 89' & 304' S, 42' & 134' SE, 134', 311' & 480' E, 584' SW, 817' & 828' NW
- 26 POND 74' SE, 658' SW
- 27 BORROW DITCH 243' & 285' W
- 28 LOW AREA 615' W, 633' SW
- 29 EATON DITCH 628' N

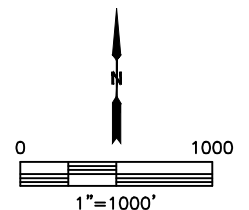

NEAREST DOWN GRADIENT SURFACE WATER: DITCH 134' E

DATE: 01/15/2019  
PROJECT#: 2018155-06