



Lat40°, Inc. 6250 W. 10th Street, Unit 2, Greeley, CO 970-515-5294

PROPOSED SCALED FACILITY DRAWING

ANTELOPE C-33 PAD

SECTION: 33
TOWNSHIP: 5N
RANGE: 62W
6TH. P.M.
WELD COUNTY, CO

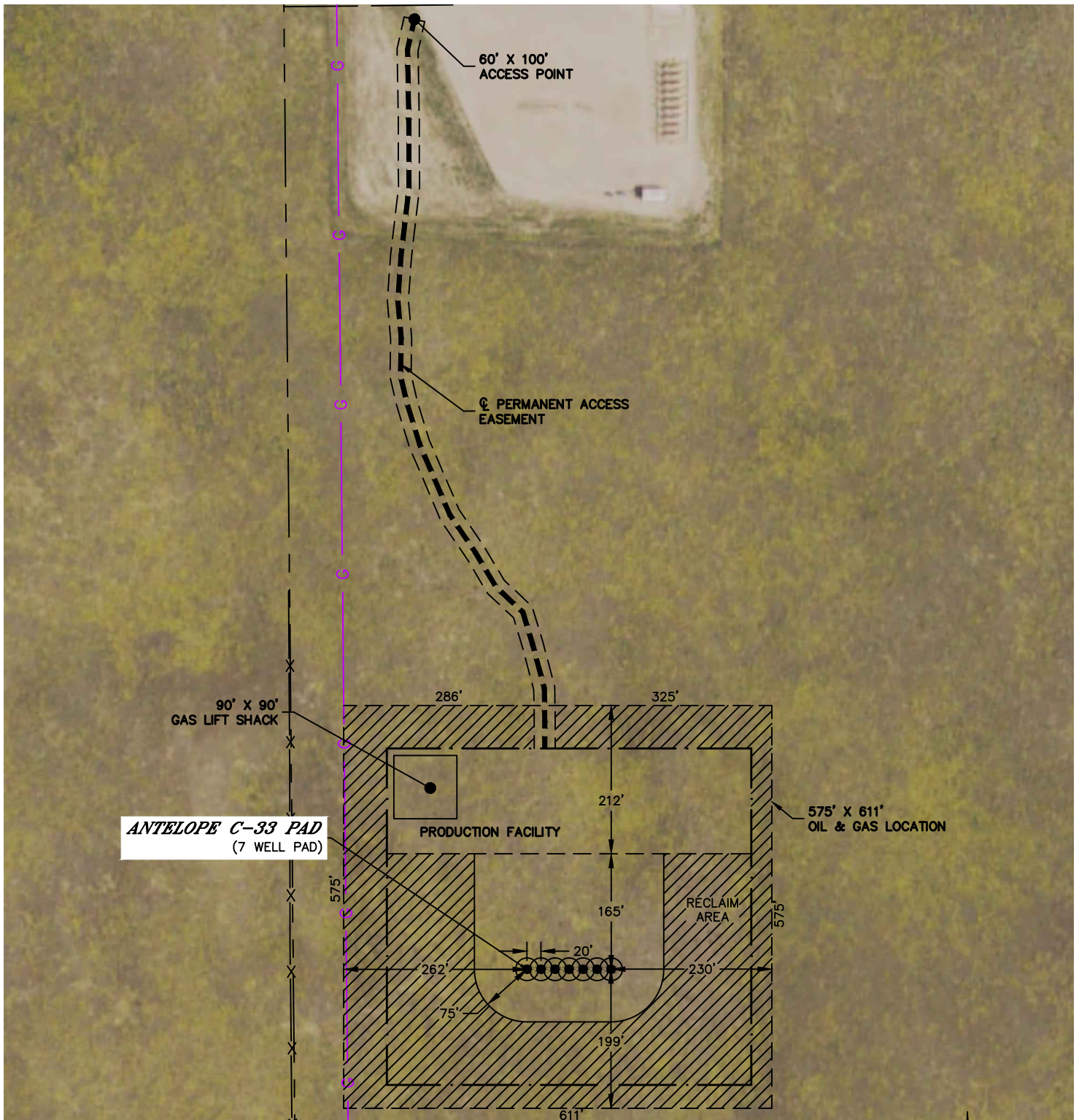

LEGEND

- PROPOSED WELL HEAD
- TANK BATTERY
- WATER TANK
- WATER VAULT
- SEPARATOR
- ECD
- METER
- VRU-

TOTAL DISTURBED AREA OF LOCATION: ±8.0 ACRES
TOTAL SIZE OF LOCATION AFTER RECLAMATION: ±3.3 ACRES

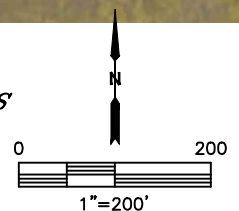

DATE: 10/17/2018
PROJECT#: 2018123