

PROCEED IN A SOUTHERLY, THEN WESTERLY, THEN SOUTHERLY DIRECTION FROM WALDEN, COLORADO ALONG COUNTY ROAD 125 APPROXIMATELY 1.3 MILES TO THE JUNCTION OF THIS ROAD AND STATE HIGHWAY 14 TO THE WEST; TURN RIGHT AND PROCEED IN A WESTERLY, THEN SOUTHWESTERLY DIRECTION APPROXIMATELY 4.2 MILES TO THE BEGINNING OF THE THE PROPOSED ACCESS ROAD TO THE SOUTHEAST; FOLLOW ROAD FLAGS IN A SOUTHEASTERLY, THEN SOUTHERLY, THEN EASTERLY DIRECTION APPROXIMATELY 702' TO THE PROPOSED LOCATION.

TOTAL DISTANCE FROM WALDEN, COLORADO TO THE PROPOSED WELL LOCATION IS APPROXIMATELY 5.6 MILES.

REV: 1 11-06-18 J.L.G. (ROAD, PAD & NAME CHANGE)

SandRidge Exploration & Production, LLC

**PRU ALCORN 0880 S10 PAD
NW 1/4 NE 1/4, SECTION 10, T8N, R80W, 6th P.M.
JACKSON COUNTY, COLORADO**



UELS, LLC
Corporate Office * 85 South 200 East
Vernal, UT 84078 * (435) 789-1017

SURVEYED BY	G.W.	09-14-17	
DRAWN BY	J.L.G.	10-05-17	
ROAD DESCRIPTION			

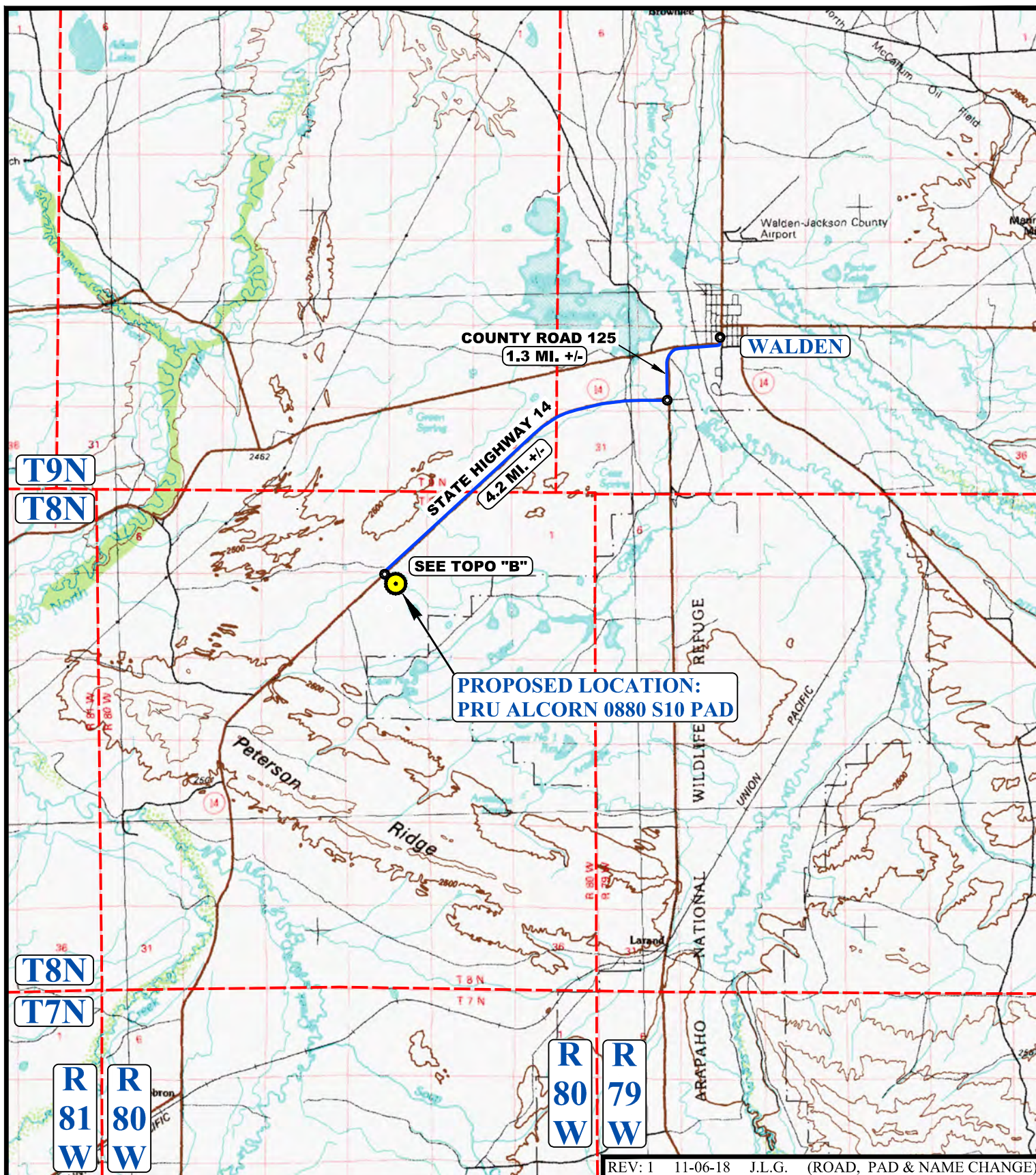

LEGEND:

 **PROPOSED LOCATION**



UELS, LLC
Corporate Office * 85 South 200 East
Vernal, UT 84078 * (435) 789-1017



SandRidge Exploration & Production, LLC

PRU ALCORN 0880 S10 PAD
NW 1/4 NE 1/4, SECTION 10, T8N, R80W, 6th P.M.
JACKSON COUNTY, COLORADO

SURVEYED BY	G.W.	09-14-17	SCALE
DRAWN BY	J.L.G.	10-05-17	1 : 100,000
ACCESS ROAD MAP			TOPO A

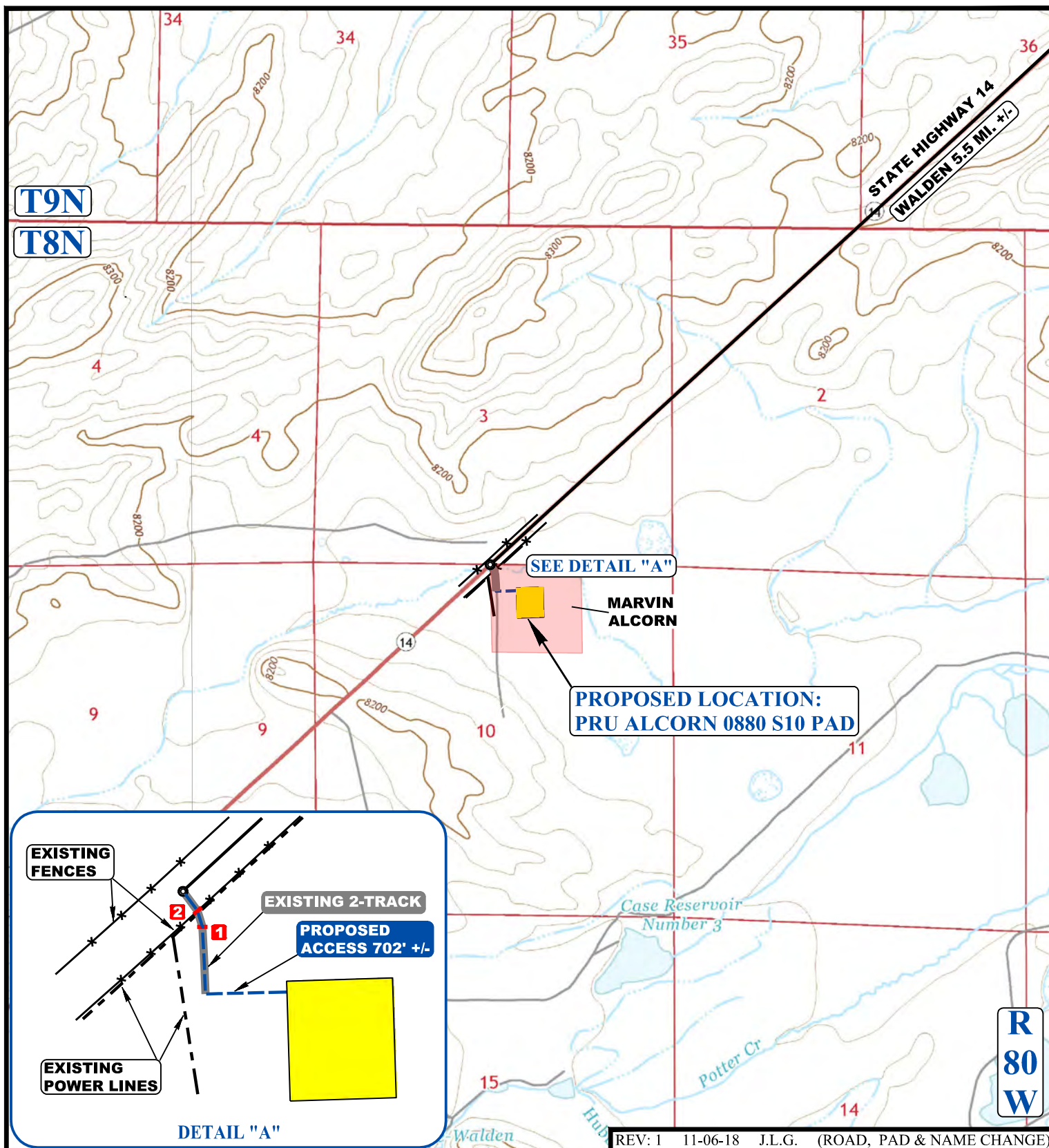

NOTE: PARCEL DATA SHOWN HAS BEEN OBTAINED FROM VARIOUS SOURCES AND SHOULD BE USED FOR MAPPING, GRAPHIC AND PLANNING PURPOSES ONLY. NO WARRANTY IS MADE BY UINTAH ENGINEERING AND LAND SURVEYING (UELS) FOR ACCURACY OF THE PARCEL DATA.

LEGEND:

- EXISTING ROAD
- - - PROPOSED ROAD
- * * * EXISTING FENCE
- - - - - EXISTING POWER LINE
- 1** INSTALL 36" CULVERT
- 2** INSTALL CATTLE GUARD



SandRidge Exploration & Production, LLC

PRU ALCORN 0880 S10 PAD
NW 1/4 NE 1/4, SECTION 10, T8N, R80W, 6th P.M.
JACKSON COUNTY, COLORADO

SURVEYED BY	G.W.	09-14-17	SCALE
DRAWN BY	J.L.G.	10-05-17	1 : 24,000
ACCESS ROAD MAP			TOPO B



UELS, LLC
Corporate Office * 85 South 200 East
Vernal, UT 84078 * (435) 789-1017