



Lat40°, Inc. 6250 W. 10th Street, Unit 2, Greeley, CO 970-515-5294

HYDROLOGY MAP

WAYNE 5N64W22 1-10 PAD

SECTION: 22
TOWNSHIP: 5N
RANGE: 64W
6TH. P.M.
WELD COUNTY, CO

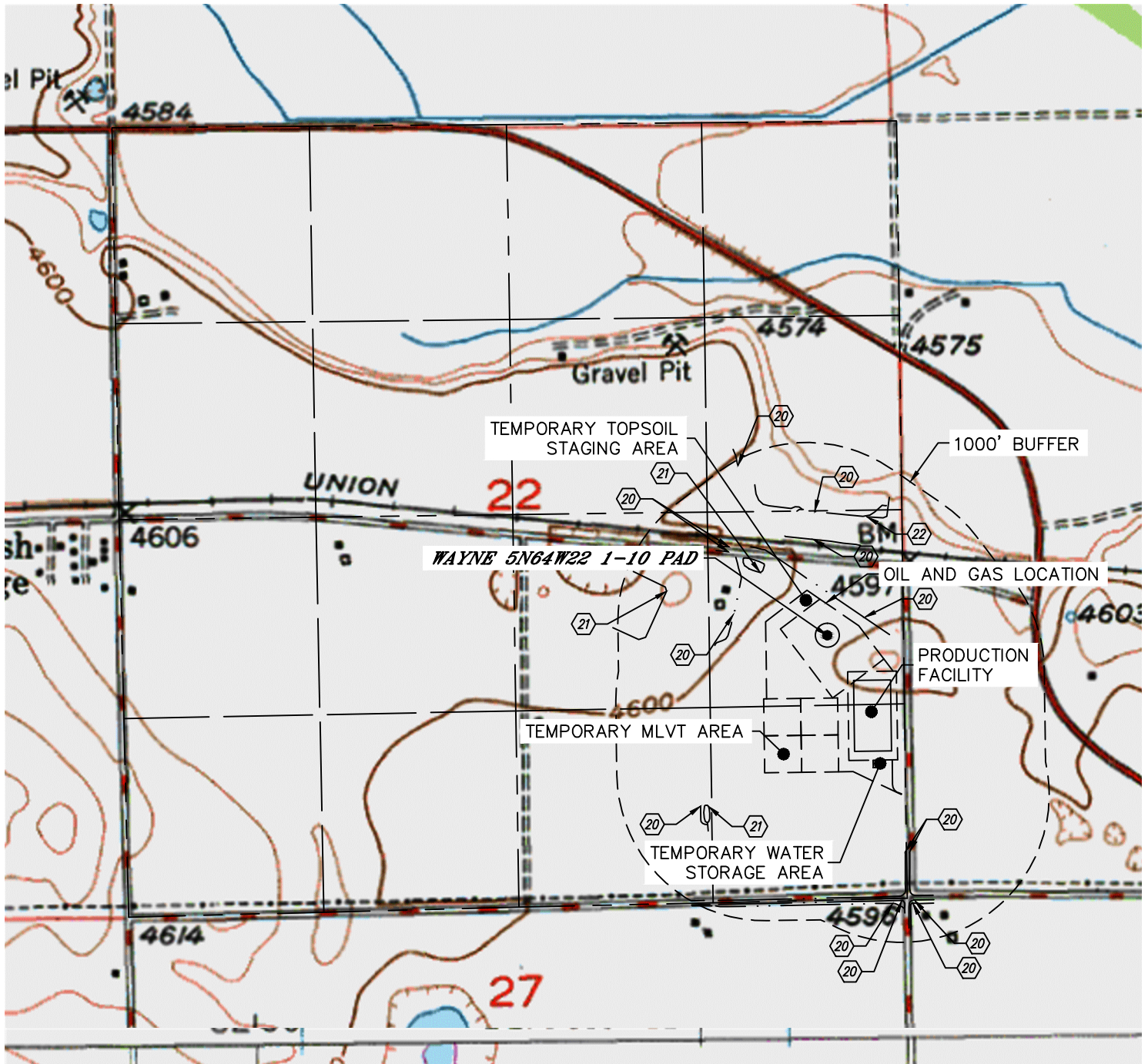

DISTANCES MEASURED FROM THE EDGE OF THE OIL AND GAS LOCATION.

- ②① DITCH 68', 348' & 534' NE, 223', 528', 553' & 964' NW, 388', 391', 718' & 737' SE, 488' & 738' SW, 716' S
- ②① POND 288' & 700' NW, 444' SW
- ②② LOW AREA 639' NE

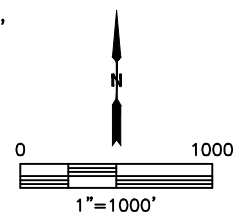

NEAREST DOWN GRADIENT SURFACE WATER: DITCH 388' SE

DATE: 10/9/2018
PROJECT#: 2018142