

BONANZA CREEK OIL COMPANY

Location: COLORADO Slot: SLOT#36 WETCO FARMS 21-4-9MRLNB (346'FNL & 232'FWL, SEC.04)
Field: WELD COUNTY Well: WETCO FARMS 21-4-9MRLNB
Facility: SEC.04-T04N-R63W Wellbore: WETCO FARMS 21-4-9MRLNB PWB

Plot reference wellpath is WETCO FARMS 21-4-9MRLNB PWB (REV-A.0)	Grid System: NAD83 / Lambert Colorado SP, Northern Zone (501), US feet
True vertical depths are referenced to AKITA 520 (4570'GL+17'KB@4587') (RKB)	North Reference: True north
Measured depths are referenced to AKITA 520 (4570'GL+17'KB@4587') (RKB)	Scale: True distance
AKITA 520 (4570'GL+17'KB@4587') (RKB) to Mean Sea Level: 4587 feet	Depths are in feet
Mean Sea Level to Ground level (At Slot: SLOT#36 WETCO FARMS 21-4-9MRLNB (346'FNL & 232'FWL, SEC.04)): 0 feet	Created by: bushjamh on 2019-01-24
Coordinates are in feet referenced to Slot	Database: Denver

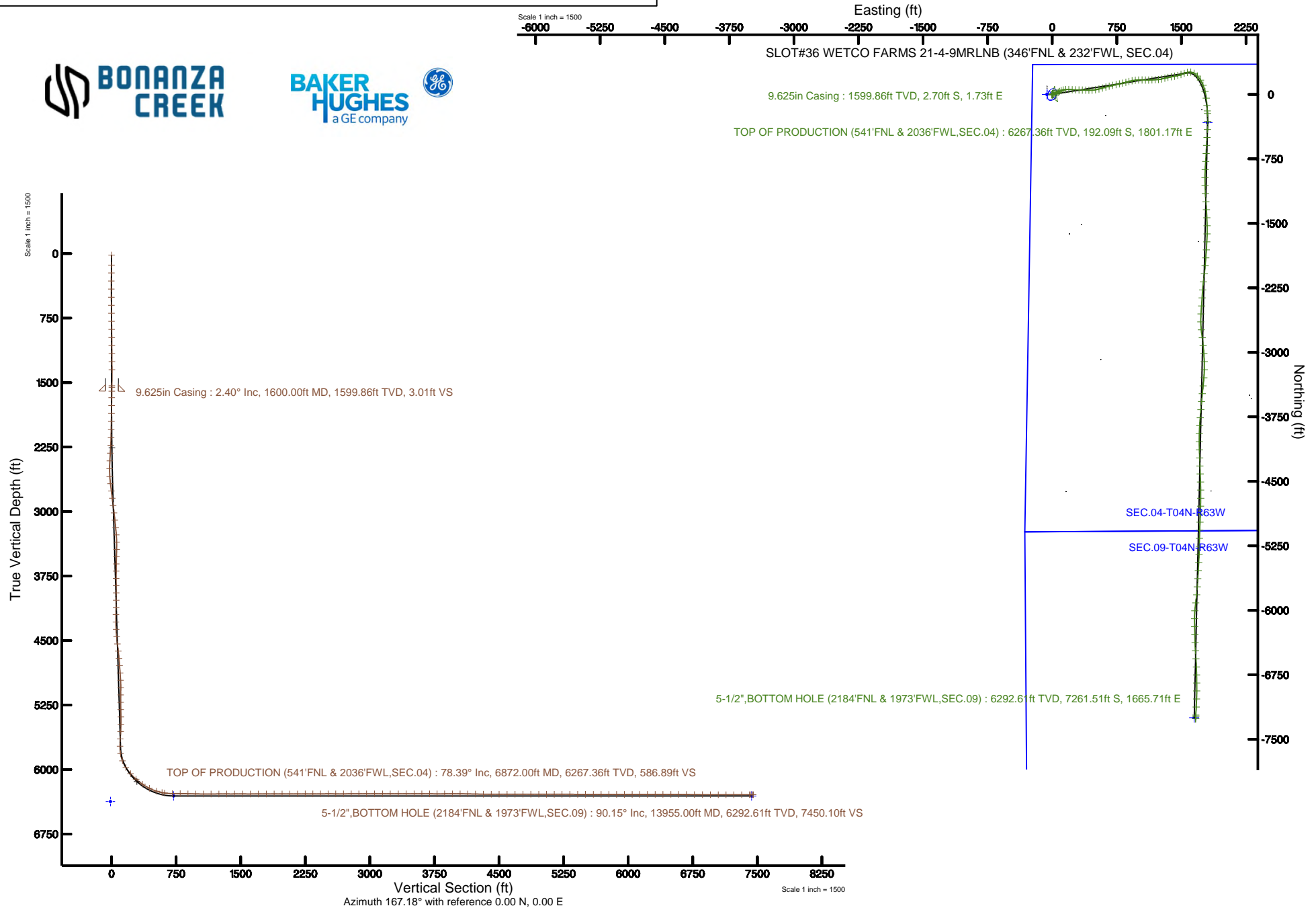



Actual Wellpath Report

WETCO FARMS 21-4-9MRLNB AWP

Page 1 of 9



REFERENCE WELLPATH IDENTIFICATION

Operator	BONANZA CREEK OIL COMPANY	Slot	SLOT#36 WETCO FARMS 21-4-9MRLNB (346'FNL & 232'FWL, SEC.04)
Area	COLORADO	Well	WETCO FARMS 21-4-9MRLNB
Field	WELD COUNTY	Wellbore	WETCO FARMS 21-4-9MRLNB AWB
Facility	SEC.04-T04N-R63W		

REPORT SETUP INFORMATION

Projection System	NAD83 / Lambert Colorado SP, Northern Zone (501), US feet	Software System	WellArchitect® 5.1
North Reference	True	User	Bushjamh
Scale	0.999958	Report Generated	1/24/2019 at 6:07:27 PM
Convergence at slot	0.68° East	Database/Source file	Denver/WETCO_FARMS_21-4-9MRLNB_AWP.xml

WELLPATH LOCATION

	Local coordinates		Grid coordinates		Geographic coordinates	
	North[ft]	East[ft]	Easting[US ft]	Northing[US ft]	Latitude	Longitude
Slot Location	-73.97	58.83	3292247.00	1371250.20	40°20'51.864"N	104°27'05.263"W
Facility Reference Pt			3292187.30	1371323.47	40°20'52.595"N	104°27'06.023"W
Field Reference Pt			3224525.77	1254425.87	40°01'44.400"N	104°41'53.556"W

WELLPATH DATUM

Calculation method	Minimum curvature	AKITA 520 (4570'GL+17'KB@4587') (RKB) to Facility Vertical Datum	4587.00ft
Horizontal Reference Pt	Slot	AKITA 520 (4570'GL+17'KB@4587') (RKB) to Mean Sea Level	4587.00ft
Vertical Reference Pt	AKITA 520 (4570'GL+17'KB@4587') (RKB)	AKITA 520 (4570'GL+17'KB@4587') (RKB) to Ground Level at Slot (SLOT#36 WETCO FARMS 21-4-9MRLNB (346'FNL & 232'FWL, SEC.04))	4587.00ft
MD Reference Pt	AKITA 520 (4570'GL+17'KB@4587') (RKB)	Section Origin	N 0.00, E 0.00 ft
Field Vertical Reference	Mean Sea Level	Section Azimuth	167.18°



Actual Wellpath Report

WETCO FARMS 21-4-9MRLNB AWP

Page 2 of 9



REFERENCE WELLPATH IDENTIFICATION

Operator	BONANZA CREEK OIL COMPANY	Slot	SLOT#36 WETCO FARMS 21-4-9MRLNB (346'FNL & 232'FWL, SEC.04)
Area	COLORADO	Well	WETCO FARMS 21-4-9MRLNB
Field	WELD COUNTY	Wellbore	WETCO FARMS 21-4-9MRLNB AWB
Facility	SEC.04-T04N-R63W		

WELLPATH DATA (153 stations) † = interpolated/extrapolated station

MD [ft]	Inclination [°]	Azimuth [°]	TVD [ft]	Vert Sect [ft]	North [ft]	East [ft]	Latitude	Longitude	DLS [°/100ft]	Comments
0.00†	0.000	13.170	0.00	0.00	0.00	0.00	40°20'51.864"N	104°27'05.263"W	0.00	
17.00	0.000	13.170	17.00	0.00	0.00	0.00	40°20'51.864"N	104°27'05.263"W	0.00	
133.00	0.660	13.170	133.00	-0.60	0.65	0.15	40°20'51.870"N	104°27'05.261"W	0.57	
225.00	0.830	33.250	224.99	-1.54	1.72	0.64	40°20'51.881"N	104°27'05.255"W	0.34	
319.00	1.030	43.660	318.98	-2.48	2.90	1.59	40°20'51.893"N	104°27'05.243"W	0.28	
413.00	0.290	205.230	412.97	-2.76	3.30	2.08	40°20'51.897"N	104°27'05.236"W	1.39	
507.00	0.470	186.630	506.97	-2.21	2.70	1.93	40°20'51.891"N	104°27'05.238"W	0.23	
601.00	0.790	218.750	600.97	-1.44	1.81	1.48	40°20'51.882"N	104°27'05.244"W	0.49	
694.00	0.540	214.300	693.96	-0.74	0.95	0.83	40°20'51.873"N	104°27'05.252"W	0.27	
788.00	0.830	199.790	787.95	0.13	-0.05	0.35	40°20'51.863"N	104°27'05.259"W	0.36	
882.00	0.680	185.360	881.94	1.24	-1.25	0.07	40°20'51.852"N	104°27'05.262"W	0.26	
976.00	0.620	198.290	975.94	2.20	-2.29	-0.14	40°20'51.841"N	104°27'05.265"W	0.17	
1069.00	0.480	217.780	1068.93	2.88	-3.07	-0.54	40°20'51.834"N	104°27'05.270"W	0.25	
1163.00	0.460	179.030	1162.93	3.50	-3.76	-0.77	40°20'51.827"N	104°27'05.273"W	0.33	
1257.00	0.450	216.160	1256.93	4.11	-4.44	-0.98	40°20'51.820"N	104°27'05.276"W	0.31	
1351.00	0.550	227.090	1350.93	4.58	-5.04	-1.53	40°20'51.814"N	104°27'05.283"W	0.15	
1537.00	1.650	51.540	1536.90	3.87	-3.99	-0.09	40°20'51.825"N	104°27'05.264"W	1.18	
1556.00	1.890	54.600	1555.90	3.63	-3.63	0.38	40°20'51.828"N	104°27'05.258"W	1.36	
1676.00	3.280	56.970	1675.77	1.68	-0.62	4.87	40°20'51.858"N	104°27'05.200"W	1.16	
1769.00	5.460	71.270	1768.50	0.31	2.25	11.29	40°20'51.886"N	104°27'05.117"W	2.60	
1861.00	7.350	70.260	1859.92	-0.85	5.65	20.98	40°20'51.920"N	104°27'04.992"W	2.06	
1954.00	8.600	71.590	1952.02	-2.25	9.85	33.17	40°20'51.961"N	104°27'04.835"W	1.36	
2048.00	7.230	70.260	2045.12	-3.65	14.07	45.41	40°20'52.003"N	104°27'04.677"W	1.47	
2141.00	8.190	67.140	2137.28	-5.51	18.62	57.02	40°20'52.048"N	104°27'04.527"W	1.13	
2234.00	9.920	61.800	2229.12	-8.79	24.98	70.19	40°20'52.111"N	104°27'04.357"W	2.07	
2328.00	12.080	57.970	2321.39	-14.17	34.02	85.67	40°20'52.200"N	104°27'04.157"W	2.42	
2420.00	14.290	65.130	2410.96	-19.71	43.91	104.13	40°20'52.298"N	104°27'03.918"W	2.98	
2514.00	16.620	75.720	2501.57	-22.48	52.11	127.69	40°20'52.379"N	104°27'03.614"W	3.88	
2607.00	20.540	86.000	2589.73	-20.32	56.53	156.88	40°20'52.423"N	104°27'03.237"W	5.48	
2700.00	24.870	93.150	2675.52	-12.43	56.59	192.70	40°20'52.423"N	104°27'02.774"W	5.51	



Actual Wellpath Report

WETCO FARMS 21-4-9MRLNB AWP

Page 3 of 9



REFERENCE WELLPATH IDENTIFICATION

Operator	BONANZA CREEK OIL COMPANY	Slot	SLOT#36 WETCO FARMS 21-4-9MRLNB (346'FNL & 232'FWL, SEC.04)
Area	COLORADO	Well	WETCO FARMS 21-4-9MRLNB
Field	WELD COUNTY	Wellbore	WETCO FARMS 21-4-9MRLNB AWB
Facility	SEC.04-T04N-R63W		

WELLPATH DATA (153 stations)

MD [ft]	Inclination [°]	Azimuth [°]	TVD [ft]	Vert Sect [ft]	North [ft]	East [ft]	Latitude	Longitude	DLS [°/100ft]	Comments
2794.00	25.030	93.120	2760.75	-1.53	54.42	232.29	40°20'52.402"N	104°27'02.263"W	0.17	
2887.00	24.950	91.620	2845.05	8.76	52.80	271.55	40°20'52.386"N	104°27'01.756"W	0.69	
2980.00	24.700	91.400	2929.45	18.42	51.77	310.58	40°20'52.376"N	104°27'01.252"W	0.29	
3074.00	24.650	92.680	3014.87	28.49	50.37	349.79	40°20'52.362"N	104°27'00.745"W	0.57	
3168.00	24.840	91.360	3100.24	38.56	48.99	389.11	40°20'52.348"N	104°27'00.238"W	0.62	
3261.00	21.760	91.320	3185.64	47.56	48.12	425.88	40°20'52.340"N	104°26'59.763"W	3.31	
3354.00	24.820	86.920	3271.06	55.07	48.78	462.62	40°20'52.346"N	104°26'59.288"W	3.78	
3448.00	26.210	78.930	3355.92	59.04	53.82	502.71	40°20'52.396"N	104°26'58.771"W	3.95	
3541.00	25.940	75.250	3439.46	58.98	62.95	542.54	40°20'52.486"N	104°26'58.256"W	1.76	
3636.00	26.230	73.590	3524.78	56.97	74.17	582.77	40°20'52.597"N	104°26'57.736"W	0.83	
3730.00	26.090	74.640	3609.15	54.75	85.51	622.63	40°20'52.709"N	104°26'57.222"W	0.51	
3823.00	25.860	75.620	3692.76	53.29	95.97	661.99	40°20'52.812"N	104°26'56.713"W	0.52	
3916.00	25.970	77.260	3776.41	52.76	105.49	701.50	40°20'52.906"N	104°26'56.203"W	0.78	
4010.00	26.020	78.490	3860.90	53.26	114.15	741.78	40°20'52.992"N	104°26'55.683"W	0.58	
4103.00	23.960	77.830	3945.19	53.94	122.20	780.23	40°20'53.071"N	104°26'55.186"W	2.24	
4197.00	24.450	76.970	4030.93	54.08	130.61	817.84	40°20'53.154"N	104°26'54.700"W	0.64	
4289.00	24.300	74.640	4114.73	53.17	139.92	854.65	40°20'53.246"N	104°26'54.225"W	1.06	
4382.00	24.060	74.430	4199.57	51.41	150.07	891.36	40°20'53.347"N	104°26'53.751"W	0.27	
4474.00	23.550	78.390	4283.75	50.90	158.81	927.43	40°20'53.433"N	104°26'53.285"W	1.82	
4568.00	24.390	84.550	4369.65	53.79	164.43	965.15	40°20'53.489"N	104°26'52.798"W	2.81	
4661.00	24.980	86.800	4454.15	59.53	167.35	1003.88	40°20'53.517"N	104°26'52.298"W	1.19	
4755.00	24.990	92.440	4539.37	68.07	167.61	1043.54	40°20'53.520"N	104°26'51.785"W	2.53	
4847.00	24.340	91.660	4622.98	77.93	166.24	1081.90	40°20'53.506"N	104°26'51.290"W	0.79	
4940.00	24.070	88.630	4707.80	86.48	166.13	1120.02	40°20'53.505"N	104°26'50.798"W	1.37	
5033.00	23.990	85.450	4792.75	92.96	168.09	1157.83	40°20'53.525"N	104°26'50.309"W	1.39	
5125.00	23.650	87.720	4876.91	99.03	170.30	1194.91	40°20'53.547"N	104°26'49.830"W	1.06	
5218.00	24.340	84.480	4961.88	104.88	172.89	1232.63	40°20'53.572"N	104°26'49.343"W	1.60	
5312.00	24.240	76.270	5047.58	107.03	179.34	1270.67	40°20'53.636"N	104°26'48.852"W	3.59	
5405.00	24.160	75.480	5132.41	106.16	188.64	1307.64	40°20'53.728"N	104°26'48.374"W	0.36	
5499.00	24.000	77.420	5218.23	105.67	197.63	1344.92	40°20'53.817"N	104°26'47.893"W	0.86	



Actual Wellpath Report

WETCO FARMS 21-4-9MRLNB AWP

Page 4 of 9



REFERENCE WELLPATH IDENTIFICATION			
Operator	BONANZA CREEK OIL COMPANY	Slot	SLOT#36 WETCO FARMS 21-4-9MRLNB (346'FNL & 232'FWL, SEC.04)
Area	COLORADO	Well	WETCO FARMS 21-4-9MRLNB
Field	WELD COUNTY	Wellbore	WETCO FARMS 21-4-9MRLNB AWB
Facility	SEC.04-T04N-R63W		

WELLPATH DATA (153 stations) † = interpolated/extrapolated station										
MD [ft]	Inclination [°]	Azimuth [°]	TVD [ft]	Vert Sect [ft]	North [ft]	East [ft]	Latitude	Longitude	DLS [°/100ft]	Comments
5591.00	24.030	81.070	5302.27	107.02	204.61	1381.68	40°20'53.886"N	104°26'47.418"W	1.61	
5685.00	24.980	79.520	5387.80	109.12	211.19	1420.11	40°20'53.951"N	104°26'46.922"W	1.22	
5779.00	24.640	74.310	5473.14	108.95	220.10	1458.50	40°20'54.039"N	104°26'46.426"W	2.35	
5872.00	24.470	70.480	5557.73	105.73	231.78	1495.32	40°20'54.154"N	104°26'45.950"W	1.72	
5966.00	24.780	70.490	5643.18	101.16	244.86	1532.23	40°20'54.283"N	104°26'45.474"W	0.33	
6060.00	24.730	76.750	5728.56	98.72	255.95	1569.95	40°20'54.393"N	104°26'44.987"W	2.79	
6154.00	24.890	95.000	5814.01	104.63	258.74	1608.85	40°20'54.420"N	104°26'44.484"W	8.12	
6248.00	29.060	121.370	5898.07	126.68	245.07	1648.21	40°20'54.285"N	104°26'43.976"W	13.36	
6340.00	36.490	136.850	5975.50	165.99	213.39	1686.11	40°20'53.972"N	104°26'43.486"W	12.12	
6434.00	42.660	148.400	6048.02	220.40	165.76	1722.00	40°20'53.501"N	104°26'43.023"W	10.19	
6527.00	49.240	158.070	6112.73	285.16	106.11	1751.73	40°20'52.912"N	104°26'42.639"W	10.28	
6622.00	55.330	166.370	6170.88	359.90	34.62	1774.42	40°20'52.205"N	104°26'42.346"W	9.42	
6715.00	63.330	173.400	6218.32	439.65	-44.02	1788.25	40°20'51.428"N	104°26'42.167"W	10.78	
6808.00	74.010	175.420	6252.10	525.45	-130.12	1796.62	40°20'50.578"N	104°26'42.059"W	11.66	
6872.00†	78.394	176.175	6267.36	586.89	-192.09	1801.17	40°20'49.965"N	104°26'42.001"W	6.95	TOP OF PRODUCTION (541'FNL & 2036'FWL, SEC.04)
6902.00	80.450	176.520	6272.87	616.00	-221.52	1803.04	40°20'49.674"N	104°26'41.976"W	6.95	
6995.00	90.490	180.070	6280.21	706.84	-314.05	1805.78	40°20'48.760"N	104°26'41.941"W	11.45	
7089.00	88.980	183.280	6280.64	797.83	-408.00	1803.03	40°20'47.832"N	104°26'41.977"W	3.77	
7182.00	89.140	183.370	6282.17	887.15	-500.83	1797.64	40°20'46.914"N	104°26'42.046"W	0.20	
7275.00	89.020	182.970	6283.66	976.54	-593.67	1792.50	40°20'45.997"N	104°26'42.113"W	0.45	
7370.00	90.000	183.200	6284.47	1067.90	-688.53	1787.38	40°20'45.059"N	104°26'42.179"W	1.06	
7462.00	90.060	183.280	6284.43	1156.31	-780.38	1782.18	40°20'44.152"N	104°26'42.246"W	0.11	
7556.00	90.180	183.350	6284.23	1246.61	-874.22	1776.75	40°20'43.225"N	104°26'42.317"W	0.15	
7650.00	89.820	180.290	6284.23	1337.55	-968.17	1773.76	40°20'42.296"N	104°26'42.355"W	3.28	
7743.00	90.120	177.990	6284.28	1428.52	-1061.15	1775.16	40°20'41.377"N	104°26'42.337"W	2.49	
7836.00	89.910	177.100	6284.25	1520.01	-1154.06	1779.14	40°20'40.459"N	104°26'42.286"W	0.98	
7930.00	90.030	176.020	6284.30	1612.75	-1247.89	1784.78	40°20'39.532"N	104°26'42.213"W	1.16	
8023.00	90.060	176.690	6284.23	1704.56	-1340.70	1790.70	40°20'38.615"N	104°26'42.137"W	0.72	
8117.00	90.180	177.630	6284.03	1797.14	-1434.59	1795.35	40°20'37.687"N	104°26'42.077"W	1.01	
8210.00	90.120	178.730	6283.79	1888.43	-1527.54	1798.31	40°20'36.769"N	104°26'42.039"W	1.18	



Actual Wellpath Report

WETCO FARMS 21-4-9MRLNB AWP

Page 5 of 9



REFERENCE WELLPATH IDENTIFICATION

Operator	BONANZA CREEK OIL COMPANY	Slot	SLOT#36 WETCO FARMS 21-4-9MRLNB (346'FNL & 232'FWL, SEC.04)
Area	COLORADO	Well	WETCO FARMS 21-4-9MRLNB
Field	WELD COUNTY	Wellbore	WETCO FARMS 21-4-9MRLNB AWB
Facility	SEC.04-T04N-R63W		

WELLPATH DATA (153 stations)

MD [ft]	Inclination [°]	Azimuth [°]	TVD [ft]	Vert Sect [ft]	North [ft]	East [ft]	Latitude	Longitude	DLS [°/100ft]	Comments
8305.00	90.000	181.220	6283.69	1981.06	-1622.53	1798.35	40°20'35.830"N	104°26'42.038"W	2.62	
8398.00	89.880	182.850	6283.79	2070.95	-1715.47	1795.05	40°20'34.912"N	104°26'42.081"W	1.76	
8491.00	90.220	183.700	6283.71	2160.30	-1808.32	1789.73	40°20'33.994"N	104°26'42.150"W	0.98	
8584.00	90.220	184.540	6283.35	2249.27	-1901.07	1783.05	40°20'33.077"N	104°26'42.236"W	0.90	
8677.00	89.910	184.970	6283.24	2337.93	-1993.75	1775.34	40°20'32.162"N	104°26'42.336"W	0.57	
8770.00	90.180	186.500	6283.17	2426.09	-2086.29	1766.05	40°20'31.247"N	104°26'42.456"W	1.67	
8864.00	90.000	186.160	6283.02	2514.89	-2179.71	1755.69	40°20'30.324"N	104°26'42.590"W	0.41	
8958.00	89.910	184.240	6283.10	2604.28	-2273.32	1747.17	40°20'29.399"N	104°26'42.700"W	2.04	
9051.00	90.060	183.670	6283.12	2693.32	-2366.10	1740.75	40°20'28.482"N	104°26'42.783"W	0.63	
9145.00	90.250	184.510	6282.87	2783.26	-2459.86	1734.05	40°20'27.556"N	104°26'42.870"W	0.92	
9238.00	90.060	183.350	6282.61	2872.31	-2552.64	1727.67	40°20'26.639"N	104°26'42.952"W	1.26	
9331.00	89.780	179.450	6282.74	2962.44	-2645.59	1725.40	40°20'25.720"N	104°26'42.981"W	4.20	
9424.00	90.060	173.420	6282.87	3054.19	-2738.37	1731.18	40°20'24.804"N	104°26'42.907"W	6.49	
9517.00	90.090	172.870	6282.75	3146.69	-2830.70	1742.28	40°20'23.891"N	104°26'42.764"W	0.59	
9608.00	90.280	174.130	6282.46	3237.13	-2921.12	1752.58	40°20'22.998"N	104°26'42.631"W	1.40	
9702.00	89.910	175.820	6282.30	3330.26	-3014.75	1760.82	40°20'22.072"N	104°26'42.524"W	1.84	
9795.00	89.820	178.140	6282.52	3421.90	-3107.62	1765.72	40°20'21.155"N	104°26'42.461"W	2.50	
9889.00	90.000	181.260	6282.67	3513.65	-3201.60	1766.21	40°20'20.226"N	104°26'42.455"W	3.32	
9983.00	89.910	184.660	6282.74	3604.10	-3295.46	1761.35	40°20'19.298"N	104°26'42.518"W	3.62	
10077.00	89.850	186.320	6282.94	3693.34	-3389.03	1752.36	40°20'18.374"N	104°26'42.634"W	1.77	
10169.00	89.940	185.880	6283.11	3780.37	-3480.51	1742.59	40°20'17.470"N	104°26'42.760"W	0.49	
10262.00	90.150	184.680	6283.04	3868.76	-3573.11	1734.03	40°20'16.555"N	104°26'42.871"W	1.31	
10356.00	90.000	184.560	6282.91	3958.44	-3666.80	1726.46	40°20'15.629"N	104°26'42.969"W	0.20	
10450.00	90.150	184.600	6282.79	4048.14	-3760.50	1718.95	40°20'14.703"N	104°26'43.066"W	0.17	
10542.00	88.980	183.460	6283.49	4136.19	-3852.27	1712.48	40°20'13.796"N	104°26'43.149"W	1.78	
10636.00	89.050	181.500	6285.10	4226.84	-3946.16	1708.42	40°20'12.868"N	104°26'43.202"W	2.09	
10729.00	88.950	179.650	6286.73	4317.29	-4039.14	1707.49	40°20'11.950"N	104°26'43.214"W	1.99	
10823.00	90.000	178.260	6287.59	4409.31	-4133.12	1709.20	40°20'11.021"N	104°26'43.192"W	1.85	
10917.00	90.000	178.370	6287.59	4501.54	-4227.08	1711.96	40°20'10.093"N	104°26'43.156"W	0.12	
11011.00	90.030	177.920	6287.56	4593.83	-4321.03	1715.01	40°20'09.164"N	104°26'43.117"W	0.48	



Actual Wellpath Report

WETCO FARMS 21-4-9MRLNB AWP

Page 6 of 9



REFERENCE WELLPATH IDENTIFICATION

Operator	BONANZA CREEK OIL COMPANY	Slot	SLOT#36 WETCO FARMS 21-4-9MRLNB (346'FNL & 232'FWL, SEC.04)
Area	COLORADO	Well	WETCO FARMS 21-4-9MRLNB
Field	WELD COUNTY	Wellbore	WETCO FARMS 21-4-9MRLNB AWB
Facility	SEC.04-T04N-R63W		

WELLPATH DATA (153 stations)

MD [ft]	Inclination [°]	Azimuth [°]	TVD [ft]	Vert Sect [ft]	North [ft]	East [ft]	Latitude	Longitude	DLS [°/100ft]	Comments
11104.00	90.180	177.890	6287.39	4685.20	-4413.97	1718.41	40°20'08.246"N	104°26'43.073"W	0.16	
11198.00	90.150	177.960	6287.12	4777.55	-4507.90	1721.81	40°20'07.317"N	104°26'43.029"W	0.08	
11291.00	89.850	179.350	6287.12	4868.69	-4600.88	1723.99	40°20'06.399"N	104°26'43.001"W	1.53	
11386.00	89.660	180.480	6287.53	4961.35	-4695.87	1724.13	40°20'05.460"N	104°26'43.000"W	1.21	
11479.00	89.940	181.560	6287.85	5051.65	-4788.86	1722.48	40°20'04.541"N	104°26'43.021"W	1.20	
11572.00	89.910	181.910	6287.98	5141.67	-4881.81	1719.66	40°20'03.623"N	104°26'43.057"W	0.38	
11665.00	90.120	182.190	6287.95	5231.56	-4974.75	1716.34	40°20'02.704"N	104°26'43.101"W	0.38	
11759.00	89.880	181.900	6287.95	5322.41	-5068.69	1712.98	40°20'01.776"N	104°26'43.144"W	0.40	
11853.00	89.880	182.020	6288.15	5413.30	-5162.64	1709.77	40°20'00.848"N	104°26'43.186"W	0.13	
11946.00	90.000	180.730	6288.25	5503.46	-5255.61	1707.53	40°19'59.929"N	104°26'43.214"W	1.39	
12041.00	89.750	182.300	6288.45	5595.50	-5350.57	1705.02	40°19'58.990"N	104°26'43.247"W	1.67	
12135.00	89.780	182.420	6288.84	5686.22	-5444.49	1701.15	40°19'58.062"N	104°26'43.297"W	0.13	
12228.00	89.940	183.840	6289.07	5775.64	-5537.35	1696.07	40°19'57.145"N	104°26'43.363"W	1.54	
12322.00	89.940	183.350	6289.16	5865.81	-5631.17	1690.18	40°19'56.218"N	104°26'43.439"W	0.52	
12417.00	89.970	183.700	6289.24	5956.97	-5725.99	1684.34	40°19'55.281"N	104°26'43.514"W	0.37	
12511.00	90.000	184.750	6289.26	6046.84	-5819.73	1677.41	40°19'54.354"N	104°26'43.604"W	1.12	
12605.00	90.180	188.490	6289.12	6135.47	-5913.09	1666.58	40°19'53.432"N	104°26'43.744"W	3.98	
12698.00	89.970	184.800	6288.99	6223.14	-6005.45	1655.82	40°19'52.519"N	104°26'43.883"W	3.97	
12791.00	90.090	179.410	6288.95	6312.97	-6098.35	1652.40	40°19'51.601"N	104°26'43.927"W	5.80	
12883.00	89.970	178.570	6288.90	6403.02	-6190.33	1654.03	40°19'50.692"N	104°26'43.906"W	0.92	
12977.00	90.250	178.540	6288.72	6495.17	-6284.30	1656.40	40°19'49.764"N	104°26'43.876"W	0.30	
13069.00	89.380	178.420	6289.01	6585.39	-6376.27	1658.84	40°19'48.855"N	104°26'43.844"W	0.95	
13162.00	89.320	176.340	6290.07	6676.91	-6469.16	1663.09	40°19'47.937"N	104°26'43.789"W	2.24	
13256.00	89.480	176.620	6291.05	6769.67	-6562.98	1668.86	40°19'47.010"N	104°26'43.715"W	0.34	
13351.00	89.450	177.630	6291.94	6863.24	-6657.85	1673.62	40°19'46.072"N	104°26'43.654"W	1.06	
13444.00	89.820	178.860	6292.53	6954.51	-6750.81	1676.47	40°19'45.154"N	104°26'43.617"W	1.38	
13538.00	89.820	179.160	6292.83	7046.51	-6844.79	1678.10	40°19'44.225"N	104°26'43.596"W	0.32	
13630.00	90.120	180.290	6292.88	7136.31	-6936.79	1678.54	40°19'43.316"N	104°26'43.590"W	1.27	
13724.00	90.030	182.300	6292.75	7227.47	-7030.76	1676.41	40°19'42.387"N	104°26'43.618"W	2.14	
13818.00	90.090	183.090	6292.65	7318.05	-7124.66	1671.99	40°19'41.459"N	104°26'43.675"W	0.84	



Actual Wellpath Report

WETCO FARMS 21-4-9MRLNB AWP

Page 7 of 9



REFERENCE WELLPATH IDENTIFICATION			
Operator	BONANZA CREEK OIL COMPANY	Slot	SLOT#36 WETCO FARMS 21-4-9MRLNB (346'FNL & 232'FWL, SEC.04)
Area	COLORADO	Well	WETCO FARMS 21-4-9MRLNB
Field	WELD COUNTY	Wellbore	WETCO FARMS 21-4-9MRLNB AWB
Facility	SEC.04-T04N-R63W		

WELLPATH DATA (153 stations)										
MD [ft]	Inclination [°]	Azimuth [°]	TVD [ft]	Vert Sect [ft]	North [ft]	East [ft]	Latitude	Longitude	DLS [°/100ft]	Comments
13912.00	89.880	182.380	6292.68	7408.60	-7218.55	1667.51	40°19'40.532"N	104°26'43.733"W	0.79	
13930.00	90.150	182.400	6292.67	7425.97	-7236.53	1666.76	40°19'40.354"N	104°26'43.743"W	1.50	
13955.00	90.150	182.400	6292.61	7450.10	-7261.51	1665.71	40°19'40.107"N	104°26'43.756"W	0.00	5-1/2",BOTTOM HOLE (2184'FNL & 1973'FWL,SEC.09)

HOLE & CASING SECTIONS - Ref Wellbore: WETCO FARMS 21-4-9MRLNB AWB Ref Wellpath: WETCO FARMS 21-4-9MRLNB AWP									
String/Diameter	Start MD [ft]	End MD [ft]	Interval [ft]	Start TVD [ft]	End TVD [ft]	Start N/S [ft]	Start E/W [ft]	End N/S [ft]	End E/W [ft]
9.625in Casing	17.00	1600.00	1583.00	17.00	1599.86	0.00	0.00	-2.70	1.73



Actual Wellpath Report

WETCO FARMS 21-4-9MRLNB AWP

Page 8 of 9



REFERENCE WELLPATH IDENTIFICATION			
Operator	BONANZA CREEK OIL COMPANY	Slot	SLOT#36 WETCO FARMS 21-4-9MRLNB (346'FNL & 232'FWL, SEC.04)
Area	COLORADO	Well	WETCO FARMS 21-4-9MRLNB
Field	WELD COUNTY	Wellbore	WETCO FARMS 21-4-9MRLNB AWB
Facility	SEC.04-T04N-R63W		

TARGETS								
Name	TVD [ft]	North [ft]	East [ft]	Grid East [US ft]	Grid North [US ft]	Latitude	Longitude	Shape
WETCO FARMS 21-4-9MRLNB BHL (2156'FNL & 1945'FWL, SEC.09)	6307.00	-7248.41	1648.53	3293981.04	1364022.11	40°19'40.237"N	104°26'43.978"W	point
WETCO FARMS 21-4-9MRLNB LP REV-1 (674'FNL & 2030'FWL, SEC.04)	6307.00	-328.40	1803.54	3294054.22	1370943.16	40°20'48.618"N	104°26'41.970"W	point
SEC.04/09-T04N-R63W (460'FNL/FSL/FWL SEC.04 & 460'FEL/FWL/FSL OF 1/2 SEC.09)	6372.00	-0.40	-60.46	3292186.55	1371249.08	40°20'51.860"N	104°27'06.044"W	polygon
SEC.04/09-T04N-R63W (460'FNL SEC.04 & 460'FSL OF 1/2 SEC.09)	11999.00	-0.40	-60.46	3292186.55	1371249.08	40°20'51.860"N	104°27'06.044"W	polygon
SEC.04/09-T04N-R63W (WESTERN HALF SECTION)	11999.00	-0.40	-60.46	3292186.55	1371249.08	40°20'51.860"N	104°27'06.044"W	polygon
*SEC.04-T04N-R63W	12000.00	-100.08	4817.71	3297065.35	1371207.10	40°20'50.870"N	104°26'03.041"W	polygon
SEC.09-T04N-R63W	12000.00	-100.08	4817.71	3297065.35	1371207.10	40°20'50.870"N	104°26'03.041"W	polygon

WELLPATH COMPOSITION - Ref Wellbore: WETCO FARMS 21-4-9MRLNB AWB Ref Wellpath: WETCO FARMS 21-4-9MRLNB AWP				
Start MD [ft]	End MD [ft]	Positional Uncertainty Model	Log Name/Comment	Wellbore
17.00	1556.00	BHI NaviTrak (Rotating+Axial Corr)	BHA NAVITRAK (ROTATING+AXIAL CORR) <133-1556>	WETCO FARMS 21-4-9MRLNB AWB
1556.00	13930.00	BHI AutoTrak Curve (Axial Corr, Short spacing)	BHI AUTOTRAK CURVE (AXIAL CORR, SHORT SPACING) <1676-13930>	WETCO FARMS 21-4-9MRLNB AWB
13930.00	13955.00	Blind Drilling (std)	Projection to bit	WETCO FARMS 21-4-9MRLNB AWB



Actual Wellpath Report
WETCO FARMS 21-4-9MRLNB AWP
Page 9 of 9



REFERENCE WELLPATH IDENTIFICATION			
Operator	BONANZA CREEK OIL COMPANY	Slot	SLOT#36 WETCO FARMS 21-4-9MRLNB (346'FNL & 232'FWL, SEC.04)
Area	COLORADO	Well	WETCO FARMS 21-4-9MRLNB
Field	WELD COUNTY	Wellbore	WETCO FARMS 21-4-9MRLNB AWP
Facility	SEC.04-T04N-R63W		

WELLPATH COMMENTS				
MD [ft]	Inclination [°]	Azimuth [°]	TVD [ft]	Comment
6872.00	78.394	176.175	6267.36	TOP OF PRODUCTION (541'FNL & 2036'FWL,SEC.04)
13955.00	90.150	182.400	6292.61	5-1/2",BOTTOM HOLE (2184'FNL & 1973'FWL,SEC.09)