



November 9, 2018

Ms. Julie Murphy, Director  
Colorado Oil and Gas Conservation Commission  
1120 Lincoln Street, Suite 801  
Denver, Colorado 80203

**RE: COGCC Rule 318A.e.: Proposed Spacing Unit**  
**Leffler 26-A Pad: NWNW Section 26, Township 7 North, Range 66 West**  
**Proposed Wells: Leffler K-26-28HC (Doc #401796692), Leffler KA-26-28HN (Doc #401796693),**  
**Leffler L-26-28HN (Doc #401796694)**

Dear Director Murphy,

Bayswater Exploration & Production, LLC (Bayswater) is planning to drill the above referenced wells in accordance with the provisions set out in Colorado Oil and Gas Conservation Commission (COGCC) Rule 318A.e. Bayswater's Proposed Spacing Unit consists of:

SWNW and NWSW of Section 26, Township 7 North, Range 66 West  
S2N2 and N2S2 of Section 27, Township 7 North, Range 66 West  
SENE and NESE of Section 29, Township 7 North, Range 66 West

Containing 800.00 acres, more or less

Bayswater is not the only owner within the Proposed Spacing Unit and has provided notice to the remaining owners, as required by COGCC Rule 318A.e.(6). Copies of the required notification letters are on file at Bayswater's office. The required thirty (30) day notice period has elapsed absent the receipt by Bayswater of any objection to their proposal by the owners within the Proposed Spacing Unit for the subject wells.

Enclosed is the Proposed Spacing Unit Exhibit to assist in your review and approval of Bayswater's proposed Applications for Permit to Drill for the subject wells. Many thanks for your attention to this matter.

Respectfully,

A handwritten signature in blue ink, appearing to read "Aaron Cross".

Aaron Cross  
Permitting Technician  
Agent for Bayswater Exploration & Production, LLC

:ac

Enclosure: Proposed Spacing Unit Exhibit

**LEFFLER 26-A PAD**  
**PROPOSED 318A.a.(4)D. SPACING UNIT**  
 SEC 26: SWNW & NWSW  
 SEC 27 & 28: S2N2 & N2S2  
 SEC 29: SENE & NESE

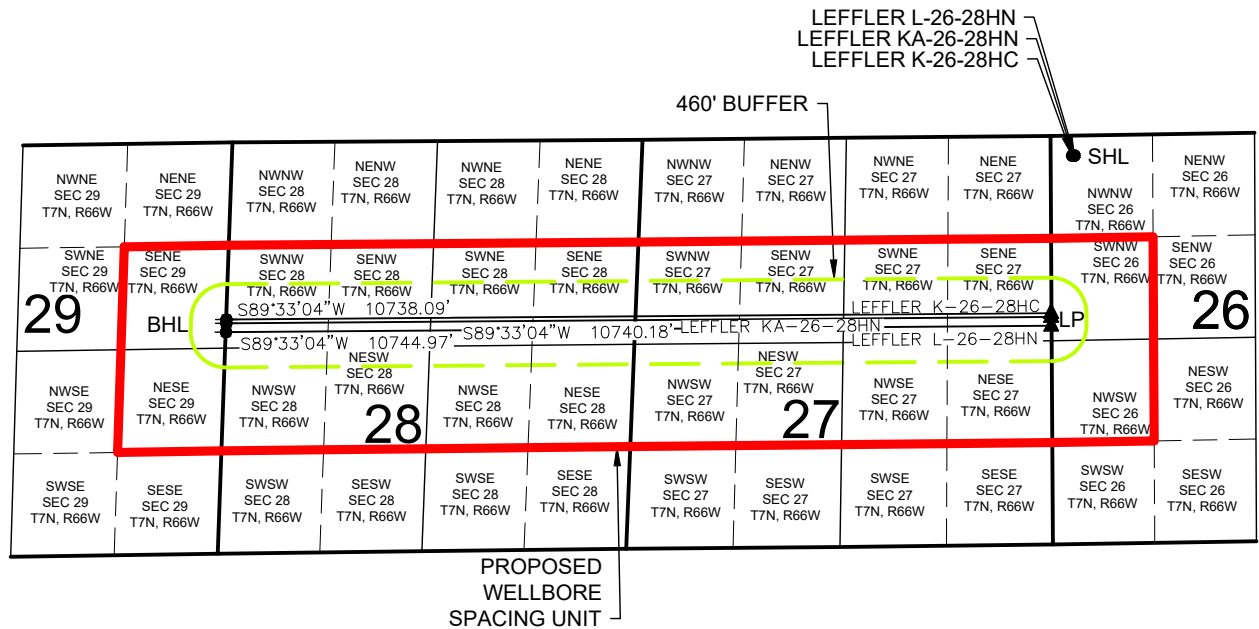

**LEFFLER K-26-28HC** WELL TO BE LOCATED **260' FNL** AND **280' FWL**, SEC 26, T7N, R66W  
**LEFFLER KA-26-28HN** WELL TO BE LOCATED **260' FNL** AND **295' FWL**, SEC 26, T7N, R66W  
**LEFFLER L-26-28HN** WELL TO BE LOCATED **260' FNL** AND **310' FWL**, SEC 26, T7N, R66W

**LEGEND**

- = PROPOSED WELL
- = BOTTOM HOLE
- ▲ = LANDING POINT

- SHL = SURFACE HOLE LOCATION
- BHL = BOTTOM HOLE LOCATION
- LP = LANDING POINT

DISCLAIMER:  
 THIS PLOT DOES NOT REPRESENT A MONUMENTED LAND SURVEY AND SHOULD NOT BE  
 RELIED UPON TO DETERMINE BOUNDARY LINES, PROPERTY OWNERSHIP OR OTHER  
 PROPERTY INTERESTS. PARCEL LINES, IF DEPICTED HAVE NOT BEEN FIELD VERIFIED AND  
 MAY BE BASED UPON PUBLICLY AVAILABLE DATA THAT ALSO HAS NOT BEEN  
 INDEPENDENTLY VERIFIED.

