

# DUMLER 1A AND 3A AS-BUILT FLOWLINE EXHIBIT

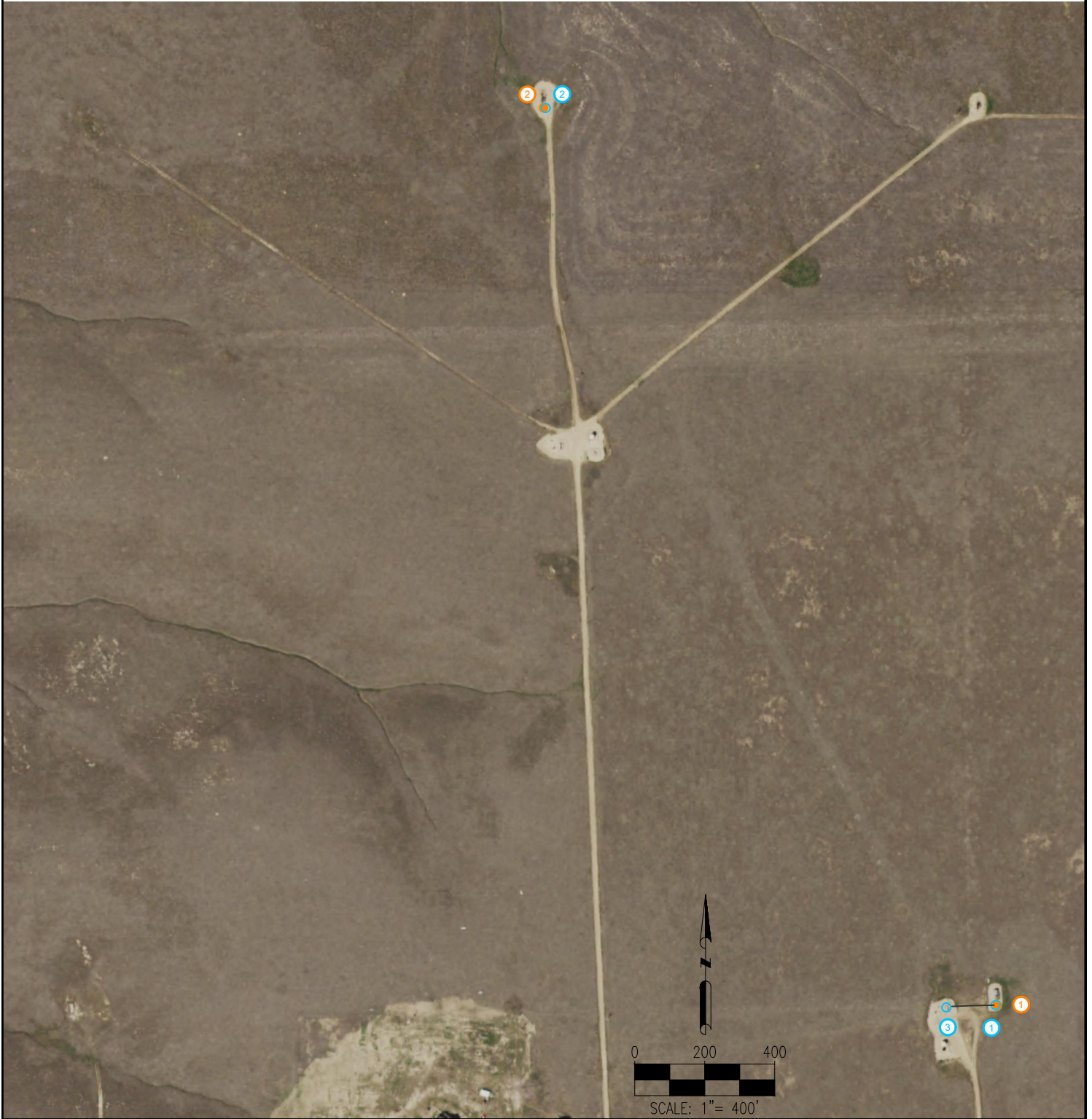

**LEGEND:**

- = WELL HEAD
- = RISER
- UGO — = FLOWLINE

- ① DUMLER 1A
- ② DUMLER 3A

- ① DUMLER 1A RISER AT WELLHEAD
- ② DUMLER 3A RISER AT WELLHEAD
- ③ DUMLER 1A RISER AT SEPARATOR

NOTE: LOCATES UNAVAILABLE FOR DUMLER 3A FLOWLINE AND RISER AT SEPARATOR.



7535 Hilltop Circle  
Denver, CO 80221  
(303) 928-7128  
www.ascentgeomatics.com

FIELD DATE: <b>08-09-18</b>	
DRAWING DATE: <b>08-22-18</b>	
BY: <b>SJH</b>	CHECKED: <b>IJM</b>

SURFACE LOCATION:  
SEC. 24, T2S, R62W, 6TH P.M.  
ADAMS COUNTY, COLORADO

PREPARED FOR:



**BAYSWATER**  
EXPLORATION AND PRODUCTION, LLC