



## **FIGURES**

**Figure 1: Topographic Site Location Map**

**Figure 2: Initial Assessment Soil Analytical Map**

**Figure 3: Pothole Assessment Map**

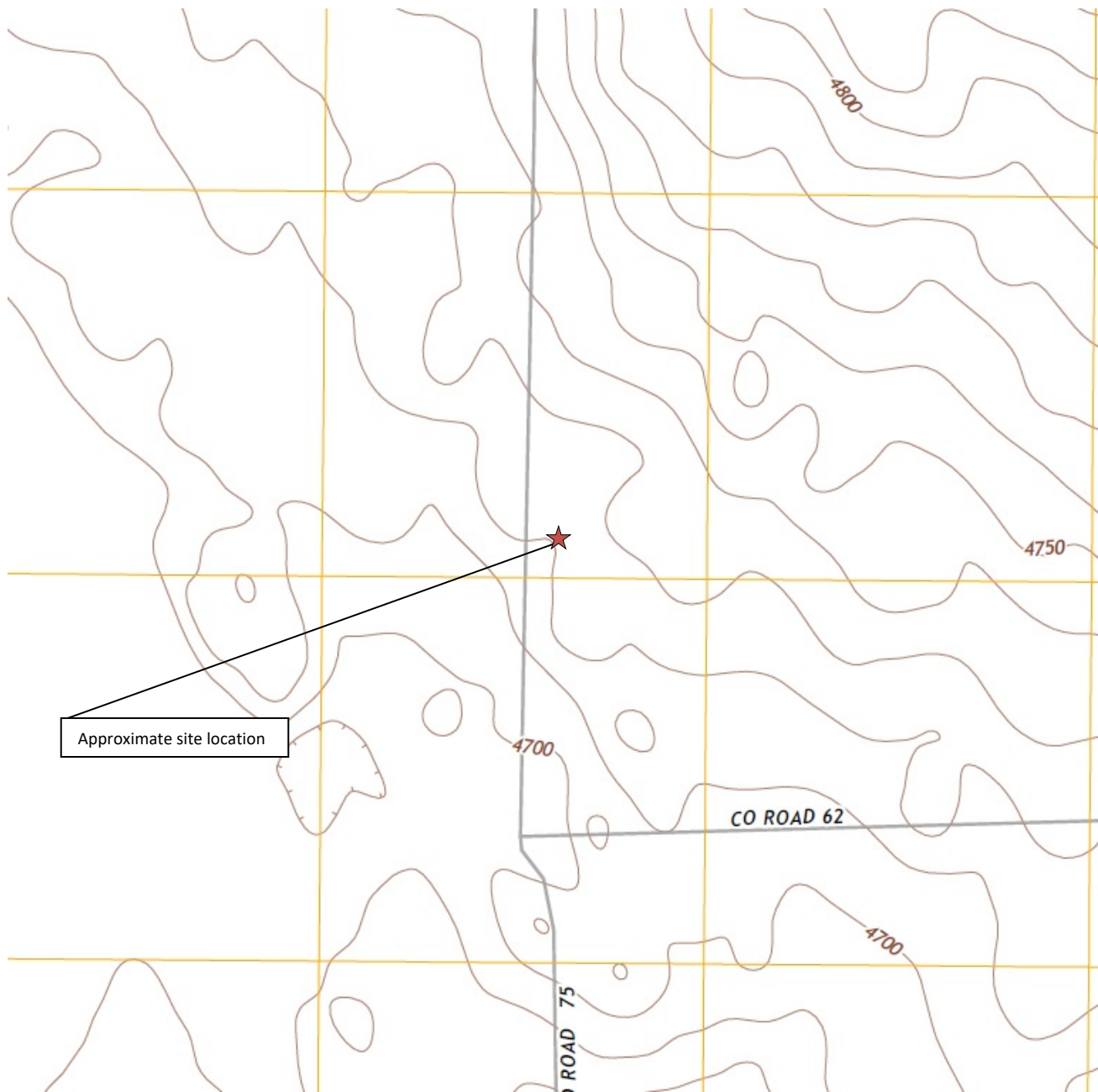

**Topographic Site Location Map**  
Wells Ranch AE32 Econode  
Flow Line Release  
40.4440 / -104.3552  
SW¼ NW¼ SEC.32 T6N R62W 6PM  
Weld County, Colorado  
Remediation # 12140



**EAGLE**  
ENVIRONMENTAL  
CONSULTING, INC.

Source: USGS 7.5 Minute Topographic  
Map, Point of Rocks, CO Quadrangle  
2013

**Figure 1**

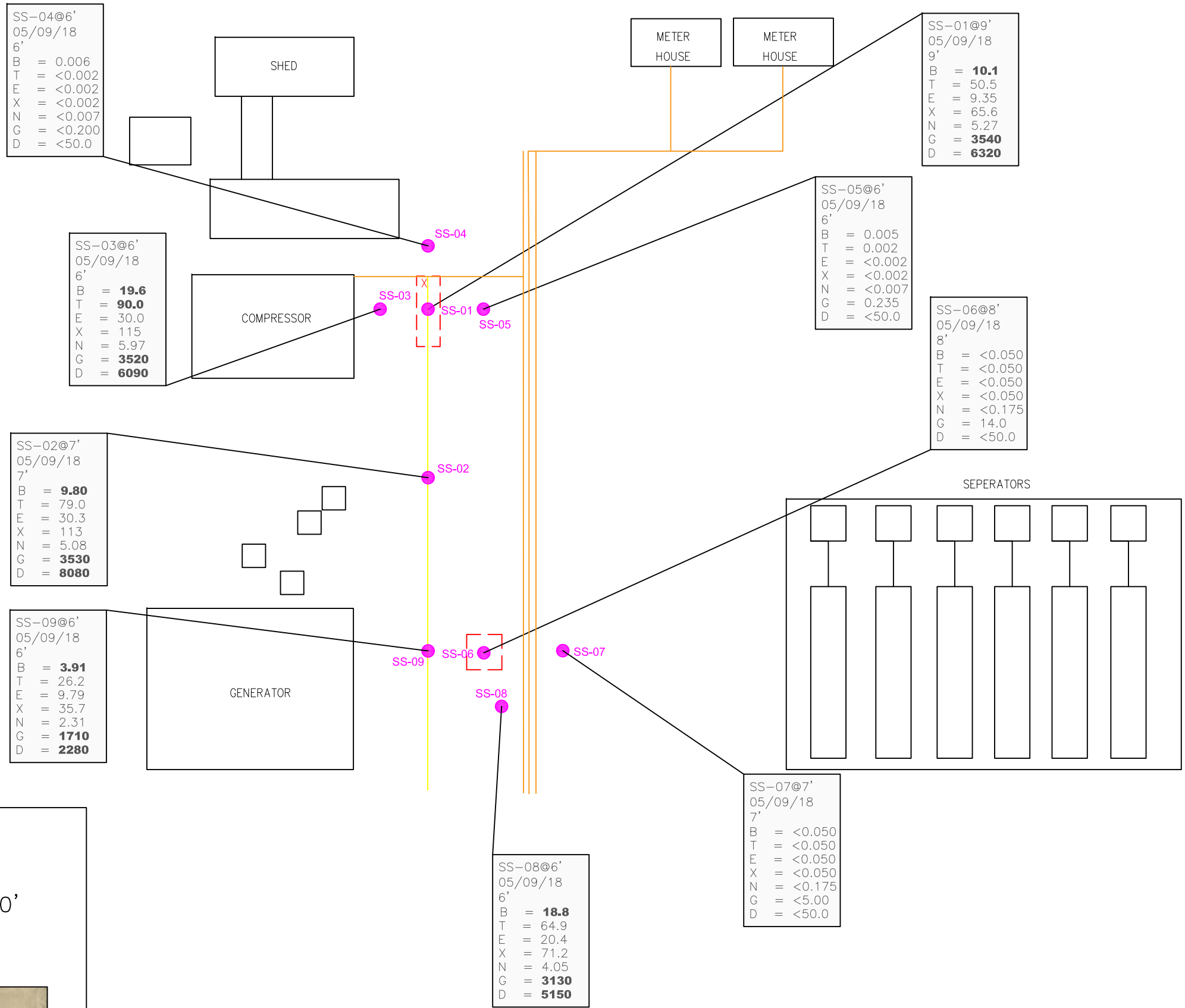

- LEGEND**
- X APPROXIMATE RELEASE LOCATION
  - ABOVEGROUND INFRASTRUCTURE
  - APPROXIMATE UNDERGROUND (ABANDONED) LINE
  - APPROXIMATE ABOVE GROUND FLOWLINE LOCATIONS
  - - - APPROXIMATE SURFACING/EXCAVATION BOUNDARIES 05/09/18
  - SS-02 APPROXIMATE LOCATION OF SOIL SAMPLES SUBMITTED FOR LABORATORY ANALYSIS

PARAMETERS

SOIL SAMPLE LOCATION  
DATE  
DEPTH (FEET)  
B = BENZENE (mg/kg)  
T = TOLUENE (mg/kg)  
E = ETHYLBENZENE (mg/kg)  
X = TOTAL XYLENES (mg/kg)  
N = NAPHTHALENE (mg/kg)  
G = TPH-GRO (mg/kg)  
D = TPH-DRO (mg/kg)

mg/kg = MILLIGRAMS PER KILOGRAM

TPH-GRO = TOTAL PETROLEUM HYDROCARBONS - GASOLINE RANGE ORGANICS

TPH-DRO = TOTAL PETROLEUM HYDROCARBONS - DIESEL RANGE ORGANICS

NOTE: VALUES PRESENTED WITH A LESS THAN SYMBOL (<) DID NOT CONTAIN CONCENTRATIONS AT OR ABOVE LABORATORY DETECTION LIMITS

VALUES IN **BOLD** EXCEED COGCC TABLE 910-1 REGULATORY LIMITS.

COGCC - COLORADO OIL AND GAS CONSERVATION COMMISSION

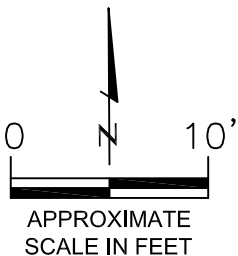
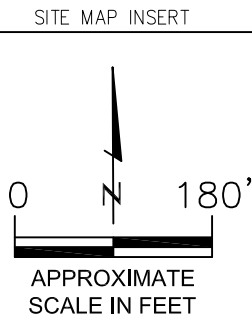

INITIAL ASSESSMENT SOIL ANALYTICAL MAP  
WELLS RANCH AE32 ECONODE  
FLOW LINE RELEASE  
40.4440 / -104.3552  
SW1/4 NW1/4 SEC.32 T6N R62W 6PM  
WELD COUNTY, COLORADO  
REMEDATION # 12140

NOTE: CLEAR AERIAL IMAGE NOT AVAILABLE FOR LOCATION.  
DRAWING BASED ON FIELD OBSERVATIONS AND MEASUREMENTS

DATE  
01/22/19

FIG. NO.  
2

DRAWN BY  
amn



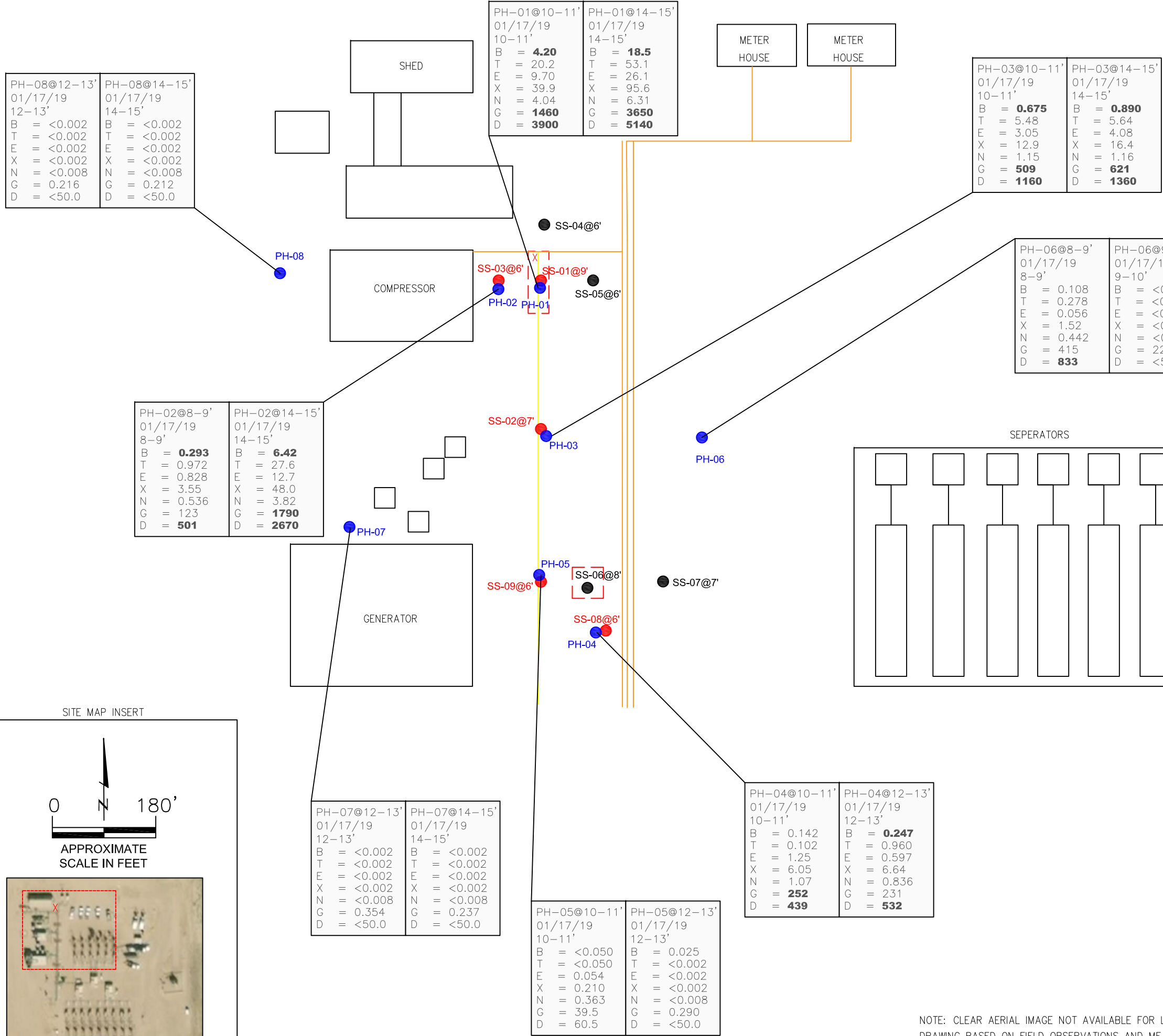

- LEGEND**
- X APPROXIMATE RELEASE LOCATION
  - ABOVEGROUND INFRASTRUCTURE
  - APPROXIMATE UNDERGROUND (ABANDONED) LINE
  - APPROXIMATE ABOVE GROUND FLOWLINE LOCATIONS
  - APPROXIMATE SURFACING/EXCAVATION BOUNDARIES 05/09/18
  - SS-02 APPROXIMATE LOCATION OF INITIAL SOIL SAMPLES BELOW COGCC TABLE 910-1 REGULATORY LIMITS
  - SS-02 APPROXIMATE LOCATION OF INITIAL SOIL SAMPLES **ABOVE** COGCC TABLE 910-1 REGULATORY LIMITS
  - APPROXIMATE POTHOLE ASSESSMENT LOCATIONS

PARAMETERS

SOIL SAMPLE LOCATION  
DATE  
DEPTH (FEET)  
B = BENZENE (mg/kg)  
T = TOLUENE (mg/kg)  
E = ETHYLBENZENE (mg/kg)  
X = TOTAL XYLENES (mg/kg)  
N = NAPHTHALENE (mg/kg)  
G = TPH-GRO (mg/kg)  
D = TPH-DRO (mg/kg)

mg/kg = MILLIGRAMS PER KILOGRAM

TPH-GRO = TOTAL PETROLEUM HYDROCARBONS - GASOLINE RANGE ORGANICS

TPH-DRO = TOTAL PETROLEUM HYDROCARBONS - DIESEL RANGE ORGANICS

NOTE: VALUES PRESENTED WITH A LESS THAN SYMBOL (<) DID NOT CONTAIN CONCENTRATIONS AT OR ABOVE LABORATORY DETECTION LIMITS

VALUES IN **BOLD** EXCEED COGCC TABLE 910-1 REGULATORY LIMITS.

COGCC - COLORADO OIL AND GAS CONSERVATION COMMISSION

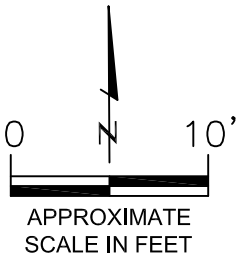

POTHOLE ASSESSMENT MAP  
WELLS RANCH AE32 ECONODE  
FLOW LINE RELEASE  
40.4440 / -104.3552  
SW1/4 NW1/4 SEC.32 T6N R62W 6PM  
WELD COUNTY, COLORADO  
REMEDATION # 12140

DATE  
01/22/19

FIG.  
NO.  
3

DRAWN BY  
amn



4101 INCA STREET, DENVER, CO 80211  
Ph: 303-433-0479 • F: 303-325-5449



## **TABLES**

### **Table 1: Soil Analytical Results Summary**

**TABLE 1**  
**SOIL ANALYTICAL RESULTS SUMMARY**  
**WELLS RANCH AE 32 ECOCODE**  
**FLOW LINE RELEASE**  
**40.4440 / -104.3552**  
**SW1/4 NW1/4 SEC.32 T6N R62W 6PM**  
**WELD COUNTY, COLORADO**  
**REMEDATION # 12140**

Sample Location (Latitude/Longitude)	Date	Approximate Depth (feet)	Benzene (mg/kg)	Toluene (mg/kg)	Ethylbenzene (mg/kg)	Total Xylenes (mg/kg)	Naphthalene (mg/kg)	TPH-GRO (mg/kg)	TPH-DRO (mg/kg)
<b>COGCC Table 910-1 Regulatory Limits (mg/kg)</b>			<b>0.17</b>	<b>85</b>	<b>100</b>	<b>175</b>	<b>23</b>	<b>500</b>	
SS-01 @ 9' (40.443805782 / -104.355188906)	05/09/18	9	10.1	50.5	9.35	65.6	5.27	3540	6320
SS-02 @ 7' (40.443773212 / -104.355184696)	05/09/18	7	9.80	79.0	30.3	113	5.08	3530	8080
SS-03 @ 6' (40.443814348 / -104.355200477)	05/09/18	6	19.6	90.0	30.0	115	5.97	3520	6090
SS-04 @ 6' (40.443824696 / -104.355188227)	05/09/18	6	0.006	<0.002	<0.002	<0.002	<0.007	<0.200	<50.0
SS-05 @ 6' (40.443805372 / -104.355171177)	05/09/18	6	0.005	0.002	<0.002	<0.002	<0.007	0.235	<50.0
SS-06 @ 8' (40.443726401 / -104.355189284)	05/09/18	8	<0.050	<0.050	<0.050	<0.050	<0.175	14.0	<50.0
SS-07 @ 7' (40.433725717 / -104.355170263)	05/09/18	7	<0.050	<0.050	<0.050	<0.050	<0.175	<5.00	<50.0
SS-08 @ 6' (40.44372107 / -104.355188625)	05/09/18	6	18.8	64.9	20.4	71.2	4.05	3130	5150
SS-09 @ 6' (40.443726389 / -104.35520129)	05/09/18	6	3.91	26.2	9.79	35.7	2.31	1710	2280
PH-01 @ 10-11' (40.443805782 / -104.355188906)	01/17/19	10-11.0	4.20	20.2	9.70	39.9	4.04	1460	3900
PH-01 @ 14-15' (40.443805782 / -104.355188906)	01/17/19	14-15.0	18.5	53.1	26.1	95.6	6.31	3650	5140
PH-02 @ 8-9' (40.443814348 / -104.355200477)	01/17/19	8-9.0	0.293	0.972	0.828	3.55	0.536	123	501
PH-02 @ 14-15' (40.443814348 / -104.355200477)	01/17/19	14-15.0	6.42	27.6	12.7	48.0	3.82	1790	2670
PH-03 @ 10-11' (40.443773212 / -104.355184696)	01/17/19	10-11.0	0.675	5.48	3.05	12.9	1.15	509	1160
PH-03 @ 14-15' (40.443773212 / -104.355184696)	01/17/19	14-15.0	0.890	5.64	4.08	16.4	1.16	621	1360

TABLE 1  
SOIL ANALYTICAL RESULTS SUMMARY  
WELLS RANCH AE 32 ECOCODE  
FLOW LINE RELEASE  
40.4440 / -104.3552  
SW1/4 NW1/4 SEC.32 T6N R62W 6PM  
WELD COUNTY, COLORADO  
REMEDATION # 12140

Sample Location (Latitude/Longitude)	Date	Approximate Depth (feet)	Benzene (mg/kg)	Toluene (mg/kg)	Ethylbenzene (mg/kg)	Total Xylenes (mg/kg)	Naphthalene (mg/kg)	TPH-GRO (mg/kg)	TPH-DRO (mg/kg)
<b>COGCC Table 910-1 Regulatory Limits (mg/kg)</b>			<b>0.17</b>	<b>85</b>	<b>100</b>	<b>175</b>	<b>23</b>	<b>500</b>	
PH-04 @ 10-11' (40.44372107 / -104.355188625)	01/17/19	10-11.0	0.142	0.102	1.25	6.05	1.07	<b>252</b>	<b>439</b>
PH-04 @ 12-13' (40.44372107 / -104.355188625)	01/17/19	12-13.0	<b>0.247</b>	0.960	0.597	6.64	0.836	231	<b>532</b>
PH-05 @ 10-11' (40.443726389 / -104.35520129)	01/17/19	10-11.0	<0.050	<0.050	0.054	0.210	0.363	39.5	60.5
PH-05 @ 12-13' (40.443726389 / -104.35520129)	01/17/19	12-13.0	0.025	<0.002	<0.002	<0.002	<0.008	0.290	<50.0
PH-06 @ 8-9' (40.443770362 / -104.355141909)	01/17/19	8-9.0	0.108	0.278	0.056	1.52	0.442	415	<b>833</b>
PH-06 @ 9-10' (40.443770362 / -104.355141909)	01/17/19	9-10.0	<0.050	<0.050	<0.050	<0.050	<0.200	22.0	<50.0
PH-07 @ 12-13' (40.443700479 / -104.355307349)	01/17/19	12-13.0	<0.002	<0.002	<0.002	<0.002	<0.008	0.354	<50.0
PH-07 @ 14-15' (40.443700479 / -104.355307349)	01/17/19	14-15.0	<0.002	<0.002	<0.002	<0.002	<0.008	0.237	<50.0
PH-08 @ 12-13' (40.443807778 / -104.355334288)	01/17/19	12-13.0	<0.002	<0.002	<0.002	<0.002	<0.008	0.216	<50.0
PH-08 @ 14-15' (40.443807778 / -104.355334288)	01/17/19	14-15.0	<0.002	<0.002	<0.002	<0.002	<0.008	0.212	<50.0

COGCC = Colorado Oil and Gas Conservation Commission  
mg/kg = milligrams per kilogram  
TPH-GRO = Total Petroleum Hydrocarbons - Gasoline Range Organics  
TPH-DRO = Total Petroleum Hydrocarbons - Diesel Range Organics  
Note: Values presented with a less than symbol (<) did not contain concentrations at or above the laboratory reporting limit.  
Note: Values presented in **BOLD** contained concentrations exceeding COGCC Table 910-1 Regulatory Limits





## **ATTACHMENT A**

### **Laboratory Analytical Reports**





May 10, 2018

Eagle Environmental Consulting, Inc.

Martin C Eckert III

4101 Inca Street

Denver

CO 80211

**Project Name - Noble - Wells Ranch AE32  
Econode**

**Project Number - [none]**

Attached are your analytical results for Noble - Wells Ranch AE32 Econode received by Origins Laboratory, Inc. May 09, 2018. This project is associated with Origins project number Y805148-01.

The analytical results in the following report were analyzed under the guidelines of EPA Methods. These methods are identified as follows; "SW" are defined in SW-846, "EPA" are defined in 40CFR part 136 and "SM" are defined in the most current revision of Standard Methods For the Examination of Water and Wastewater.

The analytical results apply specifically to the samples and analyses specified per the attached Chain of Custody. As such, this report shall not be reproduced except in full, without the written approval of Origin's laboratory.

Unless otherwise noted, the analytical results for all soil samples are reported on a wet weight basis. All analytical analyses were performed under NELAP guidelines unless noted by a data qualifier.

Any holding time exceedances, deviations from the method specifications or deviations from Origins Laboratory's Standard Operating Procedures are outlined in the case narrative.

Thank you for selecting Origins for your analytical needs. Please contact us with any questions concerning this report, or if we can help with anything at all.

Origins Laboratory, Inc.  
303.433.1322  
o-squad@oelabinc.com



1725 Elk Place, Denver, CO 80211 | Phone: 303.433.1322 | Fax: 303.265.9645

Eagle Environmental Consulting, Inc.

4101 Inca Street

Denver CO 80211

Martin C Eckert III

Project Number: [none]

Project: Noble - Wells Ranch AE32 Econode

## CROSS REFERENCE REPORT

Sample ID	Laboratory ID	Matrix	Date Sampled	Date Received
SS-01 @ 9'	Y805148-01	Soil	May 9, 2018 12:25	05/09/2018 15:16
SS-02 @ 7'	Y805148-02	Soil	May 9, 2018 10:58	05/09/2018 15:16
SS-03 @ 6'	Y805148-03	Soil	May 9, 2018 11:34	05/09/2018 15:16
SS-04 @ 6'	Y805148-04	Soil	May 9, 2018 11:18	05/09/2018 15:16
SS-05 @ 6'	Y805148-05	Soil	May 9, 2018 11:15	05/09/2018 15:16
SS-06 @ 8'	Y805148-06	Soil	May 9, 2018 11:45	05/09/2018 15:16
SS-07 @ 7'	Y805148-07	Soil	May 9, 2018 11:54	05/09/2018 15:16
SS-08 @ 6'	Y805148-08	Soil	May 9, 2018 12:09	05/09/2018 15:16
SS-09 @ 6'	Y805148-09	Soil	May 9, 2018 12:39	05/09/2018 15:16

Origins Laboratory, Inc.



*The results in this report apply to the samples analyzed in accordance with the chain of custody document. This analytical report must be reproduced in its entirety.*

Jen Pellegrini For Noelle Doyle Mathis, President

Martin C Eckert III  
Project Number: [none]  
Project: Noble - Wells Ranch AE32 Econode

# ORIGINS

LABORATORY, INC

www.originslaboratory.com

Y805148

page 1 of 1

Client: EGGLE ENV CONSULTING  
 Address: 4101 INLA ST,  
DENVER, CO  
 Telephone Number: 303-433-0474  
 Email Address: ML63@EGGLE-ENVIR.CO

Project Manager: MARTIN ELLERTZ III  
 Project Name: WELLS RAVEN AEST ELONDOE  
 Project Number: \_\_\_\_\_  
 Samples Collected By: KA

Sample ID Description	Date Sampled	Time Sampled	# of Containers	Preservative				Matrix		Analysis				Sample Instructions
				Unpreserved	HCl	HNO <sub>3</sub>	Other	Groundwater	Soil	Air Summa Continer #	Other	BTEX	VOC	
SS-01 @ 9'	5-9-18	1225	2	X				X		X	X	X	X	1
SS-02 @ 7'		1058												2
SS-03 @ 6'		1134												3
SS-04 @ 6'		1118												4
SS-05 @ 6'		1115												5
SS-06 @ 8'		1145												6
SS-07 @ 7'		1154												7
SS-08 @ 6'		1209												8
SS-09 @ 6'	✓	1234												9
														10
Relinquished By: <u>[Signature]</u>	Date: <u>5-9-18</u>	Time: <u>1516</u>	Received By: <u>[Signature]</u>	Date: <u>5/9/18</u>	Time: <u>1516</u>	Turnaround Time: Same Day <input checked="" type="checkbox"/> 24 Hr <input type="checkbox"/> 48 Hr <input type="checkbox"/> 72 Hr <input type="checkbox"/> Standard <input type="checkbox"/>								
Relinquished By: _____	Date: _____	Time: _____	Received By: _____	Date: _____	Time: _____									

REL: 81509726 \$ BUL TO  
 L006: 515315  
 HOWARD

Temp Received: 3.9

Date Results Needed

\$ 1000

Origins Laboratory, Inc.

Jeff Pellgrini

*The results in this report apply to the samples analyzed in accordance with the chain of custody document. This analytical report must be reproduced in its entirety.*

Eagle Environmental Consulting, Inc.

4101 Inca Street

Denver

CO

80211

Martin C Eckert III

Project Number: [none]

Project: Noble - Wells Ranch AE32 Econode

Origins Laboratory

F-012207-01-R1

Effective Date: 01/09/12

## Sample Receipt Checklist

Origins Work Order: Y805148

Client: Eagle

Client Project ID: Noble - Wells Ranch AE32 Econode

Checklist Completed by: JG

Shipped Via: HD

(UPS, FedEx, Hand Delivered, Pick-up, etc.)

Date/time completed: 5/9/2018

Airbill #: N/A

Matrix(s) Received: (Check all that apply): Soil/Solid Water Other:

Cooler Number/Temperature: 1 / 5 °C / 5 °C / 5 °C / 5 °C (Describe)

Thermometer ID: T003

Requirement Description	Yes	No	N/A	Comments (if any)
If samples require cooling, was the temperature between 0°C to ≤ 6°C <sup>(1)</sup> ?	<input checked="" type="checkbox"/>	<input type="checkbox"/>	<input type="checkbox"/>	
Is there ice present (document if blue ice is used)	<input checked="" type="checkbox"/>	<input type="checkbox"/>	<input type="checkbox"/>	
Are custody seals present on cooler? (if so, document in comments if they are signed and dated, broken or intact)	<input checked="" type="checkbox"/>	<input type="checkbox"/>	<input type="checkbox"/>	
Are custody seals present on each sample container? (if so, document in comments if they are signed and dated, broken or intact)	<input checked="" type="checkbox"/>	<input type="checkbox"/>	<input type="checkbox"/>	
Were all samples received intact <sup>(1)</sup> ?	<input checked="" type="checkbox"/>	<input type="checkbox"/>	<input type="checkbox"/>	
Was adequate sample volume provided <sup>(1)</sup> ?	<input checked="" type="checkbox"/>	<input type="checkbox"/>	<input type="checkbox"/>	
Are short holding time analytes or samples with HTs due within 48 hours present <sup>(1)</sup> ?	<input checked="" type="checkbox"/>	<input type="checkbox"/>	<input type="checkbox"/>	
Is a chain-of-custody (COC) present and filled out completely <sup>(1)</sup> ?	<input checked="" type="checkbox"/>	<input type="checkbox"/>	<input type="checkbox"/>	
Does the COC agree with the number and type of sample bottles received <sup>(1)</sup> ?	<input checked="" type="checkbox"/>	<input type="checkbox"/>	<input type="checkbox"/>	
Do the sample IDs on the bottle labels match the COC <sup>(1)</sup> ?	<input checked="" type="checkbox"/>	<input type="checkbox"/>	<input type="checkbox"/>	
Is the COC properly relinquished by the client with date and time recorded <sup>(1)</sup> ?	<input checked="" type="checkbox"/>	<input type="checkbox"/>	<input type="checkbox"/>	
For volatiles in water – is there headspace (> ¼ inch bubble) present? If yes, contact client and note in narrative.	<input checked="" type="checkbox"/>	<input type="checkbox"/>	<input type="checkbox"/>	
Are samples preserved that require preservation and was it checked <sup>(1)</sup> ? (note ID of confirmation instrument used in comments) / (preservation is not confirmed for subcontracted analyses in order to insure sample integrity)/pH <2 for samples preserved with HNO <sub>3</sub> , HCL, H <sub>2</sub> SO <sub>4</sub> / (pH >10 for samples preserved with NaAsO <sub>2</sub> +NaOH, ZnAc+NaOH)	<input checked="" type="checkbox"/>	<input type="checkbox"/>	<input type="checkbox"/>	
Additional Comments (if any):				

<sup>(1)</sup>If NO, then contact the client before proceeding with analysis and note date/time and person contacted as well as the corrective action to in the additional comments (above) and the case narrative.

Reviewed by (Project Manager)

Date/Time Reviewed

Origins Laboratory, Inc.

*Jefe Pellegrini*

The results in this report apply to the samples analyzed in accordance with the chain of custody document. This analytical report must be reproduced in its entirety.

Eagle Environmental Consulting, Inc.  
4101 Inca Street  
Denver CO 80211

Martin C Eckert III  
Project Number: [none]  
Project: Noble - Wells Ranch AE32 Econode

SS-01 @ 9'  
5/9/2018 12:25:00PM

Analyte	Result	Reporting Limit	Units	Dilution	Batch	Prepared	Analyzed	Notes
---------	--------	--------------------	-------	----------	-------	----------	----------	-------

Origins Laboratory, Inc.  
Y805148-01 (Soil)

## Diesel Range Organics (DRO/TEPH) by EPA 8015C

Diesel (C10-C28)	6320	50.0	mg/kg	1	B8E0903	05/09/2018	05/09/2018
------------------	------	------	-------	---	---------	------------	------------

Surrogate: o-Terphenyl	84.3 %	59-131			"	"	"
------------------------	--------	--------	--	--	---	---	---

## GBTEX + Napthalene by 8260C

Gasoline Range Hydrocarbons	3540	500	mg/kg	2500	B8E0907	05/09/2018	05/10/2018
Benzene	10.1	4.98	"	"	"	"	"
Toluene	50.5	4.98	"	"	"	"	"
Ethylbenzene	9.35	4.98	"	"	"	"	"
Xylenes, total	65.6	4.98	"	"	"	"	"
Naphthalene	5.27	0.175	"	25	"	"	05/09/2018

Surrogate: 1,2-Dichloroethane-d4	92.2 %	70-130			"	"	05/10/2018
Surrogate: Toluene-d8	83.8 %	70-130			"	"	05/09/2018
Surrogate: 4-Bromofluorobenzene	100 %	70-130			"	"	05/10/2018

Origins Laboratory, Inc.



The results in this report apply to the samples analyzed in accordance with the chain of custody document. This analytical report must be reproduced in its entirety.

Eagle Environmental Consulting, Inc.  
4101 Inca Street  
Denver CO 80211

Martin C Eckert III  
Project Number: [none]  
Project: Noble - Wells Ranch AE32 Econode

SS-02 @ 7'  
5/9/2018 10:58:00AM

Analyte	Result	Reporting Limit	Units	Dilution	Batch	Prepared	Analyzed	Notes
---------	--------	--------------------	-------	----------	-------	----------	----------	-------

Origins Laboratory, Inc.  
Y805148-02 (Soil)

## Diesel Range Organics (DRO/TEPH) by EPA 8015C

Diesel (C10-C28)	8080	50.0	mg/kg	1	B8E0903	05/09/2018	05/09/2018
------------------	------	------	-------	---	---------	------------	------------

Surrogate: o-Terphenyl	108 %	59-131			"	"	"
------------------------	-------	--------	--	--	---	---	---

## GBTEX + Napthalene by 8260C

Gasoline Range Hydrocarbons	3530	500	mg/kg	2500	B8E0907	05/09/2018	05/10/2018
Benzene	9.80	4.98	"	"	"	"	"
Toluene	79.0	4.98	"	"	"	"	"
Ethylbenzene	30.3	4.98	"	"	"	"	"
Xylenes, total	113	4.98	"	"	"	"	"
Naphthalene	5.08	0.175	"	25	"	"	05/09/2018

Surrogate: 1,2-Dichloroethane-d4	126 %	70-130			"	"	"
----------------------------------	-------	--------	--	--	---	---	---

Surrogate: Toluene-d8	96.8 %	70-130			"	"	"
-----------------------	--------	--------	--	--	---	---	---

Surrogate: 4-Bromofluorobenzene	99.0 %	70-130			"	"	05/10/2018
---------------------------------	--------	--------	--	--	---	---	------------

Origins Laboratory, Inc.



The results in this report apply to the samples analyzed in accordance with the chain of custody document. This analytical report must be reproduced in its entirety.



Eagle Environmental Consulting, Inc.  
4101 Inca Street  
Denver CO 80211

Martin C Eckert III  
Project Number: [none]  
Project: Noble - Wells Ranch AE32 Econode

SS-03 @ 6'  
5/9/2018 11:34:00AM

Analyte	Result	Reporting Limit	Units	Dilution	Batch	Prepared	Analyzed	Notes
---------	--------	--------------------	-------	----------	-------	----------	----------	-------

Origins Laboratory, Inc.  
Y805148-03 (Soil)

## Diesel Range Organics (DRO/TEPH) by EPA 8015C

Diesel (C10-C28)	6090	50.0	mg/kg	1	B8E0903	05/09/2018	05/09/2018
------------------	------	------	-------	---	---------	------------	------------

Surrogate: o-Terphenyl	88.8 %	59-131			"	"	"
------------------------	--------	--------	--	--	---	---	---

## GBTEX + Napthalene by 8260C

Gasoline Range Hydrocarbons	3520	500	mg/kg	2500	B8E0907	05/09/2018	05/10/2018
Benzene	19.6	4.98	"	"	"	"	"
Toluene	90.0	4.98	"	"	"	"	"
Ethylbenzene	30.0	4.98	"	"	"	"	"
Xylenes, total	115	4.98	"	"	"	"	"
Naphthalene	5.97	0.175	"	25	"	"	05/09/2018

Surrogate: 1,2-Dichloroethane-d4	99.8 %	70-130			"	"	05/10/2018
Surrogate: Toluene-d8	97.7 %	70-130			"	"	05/09/2018
Surrogate: 4-Bromofluorobenzene	97.6 %	70-130			"	"	05/10/2018

Origins Laboratory, Inc.



The results in this report apply to the samples analyzed in accordance with the chain of custody document. This analytical report must be reproduced in its entirety.

Eagle Environmental Consulting, Inc.  
4101 Inca Street  
Denver CO 80211

Martin C Eckert III  
Project Number: [none]  
Project: Noble - Wells Ranch AE32 Econode

SS-04 @ 6'  
5/9/2018 11:18:00AM

Analyte	Result	Reporting Limit	Units	Dilution	Batch	Prepared	Analyzed	Notes
---------	--------	--------------------	-------	----------	-------	----------	----------	-------

Origins Laboratory, Inc.  
Y805148-04 (Soil)

## Diesel Range Organics (DRO/TEPH) by EPA 8015C

Diesel (C10-C28)	ND	50.0	mg/kg	1	B8E0903	05/09/2018	05/09/2018	U
Surrogate: o-Terphenyl	94.4 %	59-131			"	"	"	

## GBTEX + Napthalene by 8260C

Gasoline Range Hydrocarbons	ND	0.200	mg/kg	1	B8E0907	05/09/2018	05/10/2018	U
Benzene	0.006	0.002	"	"	"	"	"	
Toluene	ND	0.002	"	"	"	"	"	U
Ethylbenzene	ND	0.002	"	"	"	"	"	U
Xylenes, total	ND	0.002	"	"	"	"	"	U
Napthalene	ND	0.007	"	"	"	"	"	U
Surrogate: 1,2-Dichloroethane-d4	105 %	70-130			"	"	"	
Surrogate: Toluene-d8	95.6 %	70-130			"	"	"	
Surrogate: 4-Bromofluorobenzene	102 %	70-130			"	"	"	

Origins Laboratory, Inc.



The results in this report apply to the samples analyzed in accordance with the chain of custody document. This analytical report must be reproduced in its entirety.



Eagle Environmental Consulting, Inc.  
4101 Inca Street  
Denver CO 80211

Martin C Eckert III  
Project Number: [none]  
Project: Noble - Wells Ranch AE32 Econode

SS-05 @ 6'  
5/9/2018 11:15:00AM

Analyte	Result	Reporting Limit	Units	Dilution	Batch	Prepared	Analyzed	Notes
---------	--------	-----------------	-------	----------	-------	----------	----------	-------

Origins Laboratory, Inc.  
Y805148-05 (Soil)

## Diesel Range Organics (DRO/TEPH) by EPA 8015C

Diesel (C10-C28)	ND	50.0	mg/kg	1	B8E0903	05/09/2018	05/09/2018	U
Surrogate: o-Terphenyl	97.1 %	59-131			"	"	"	

## GBTEX + Napthalene by 8260C

Gasoline Range Hydrocarbons	0.235	0.200	mg/kg	1	B8E0907	05/09/2018	05/10/2018	
Benzene	0.005	0.002	"	"	"	"	"	
Toluene	0.002	0.002	"	"	"	"	"	
Ethylbenzene	ND	0.002	"	"	"	"	"	U
Xylenes, total	ND	0.002	"	"	"	"	"	U
Naphthalene	ND	0.007	"	"	"	"	"	U
Surrogate: 1,2-Dichloroethane-d4	108 %	70-130			"	"	"	
Surrogate: Toluene-d8	96.0 %	70-130			"	"	"	
Surrogate: 4-Bromofluorobenzene	102 %	70-130			"	"	"	

Origins Laboratory, Inc.



The results in this report apply to the samples analyzed in accordance with the chain of custody document. This analytical report must be reproduced in its entirety.

Eagle Environmental Consulting, Inc.  
4101 Inca Street  
Denver CO 80211

Martin C Eckert III  
Project Number: [none]  
Project: Noble - Wells Ranch AE32 Econode

SS-06 @ 8'  
5/9/2018 11:45:00AM

Analyte	Result	Reporting Limit	Units	Dilution	Batch	Prepared	Analyzed	Notes
---------	--------	-----------------	-------	----------	-------	----------	----------	-------

Origins Laboratory, Inc.  
Y805148-06 (Soil)

## Diesel Range Organics (DRO/TEPH) by EPA 8015C

Diesel (C10-C28)	ND	50.0	mg/kg	1	B8E0903	05/09/2018	05/09/2018	U
------------------	----	------	-------	---	---------	------------	------------	---

Surrogate: o-Terphenyl	106 %	59-131			"	"	"	
------------------------	-------	--------	--	--	---	---	---	--

## GBTEX + Napthalene by 8260C

Gasoline Range Hydrocarbons	14.0	5.00	mg/kg	25	B8E0907	05/09/2018	05/09/2018	
Benzene	ND	0.050	"	"	"	"	"	U
Toluene	ND	0.050	"	"	"	"	"	U
Ethylbenzene	ND	0.050	"	"	"	"	"	U
Xylenes, total	ND	0.050	"	"	"	"	"	U
Napthalene	ND	0.175	"	"	"	"	"	U

Surrogate: 1,2-Dichloroethane-d4	82.4 %	70-130			"	"	"	
Surrogate: Toluene-d8	115 %	70-130			"	"	"	
Surrogate: 4-Bromofluorobenzene	100 %	70-130			"	"	"	

Origins Laboratory, Inc.



The results in this report apply to the samples analyzed in accordance with the chain of custody document. This analytical report must be reproduced in its entirety.

Eagle Environmental Consulting, Inc.  
4101 Inca Street  
Denver CO 80211

Martin C Eckert III  
Project Number: [none]  
Project: Noble - Wells Ranch AE32 Econode

SS-07 @ 7'  
5/9/2018 11:54:00AM

Analyte	Result	Reporting Limit	Units	Dilution	Batch	Prepared	Analyzed	Notes
---------	--------	-----------------	-------	----------	-------	----------	----------	-------

Origins Laboratory, Inc.  
Y805148-07 (Soil)

## Diesel Range Organics (DRO/TEPH) by EPA 8015C

Diesel (C10-C28)	ND	50.0	mg/kg	1	B8E0903	05/09/2018	05/09/2018	U
Surrogate: o-Terphenyl	96.2 %	59-131			"	"	"	

## GBTEX + Napthalene by 8260C

Gasoline Range Hydrocarbons	ND	5.00	mg/kg	25	B8E0907	05/09/2018	05/09/2018	U
Benzene	ND	0.050	"	"	"	"	"	U
Toluene	ND	0.050	"	"	"	"	"	U
Ethylbenzene	ND	0.050	"	"	"	"	"	U
Xylenes, total	ND	0.050	"	"	"	"	"	U
Napthalene	ND	0.175	"	"	"	"	"	U
Surrogate: 1,2-Dichloroethane-d4	86.2 %	70-130			"	"	"	
Surrogate: Toluene-d8	96.3 %	70-130			"	"	"	
Surrogate: 4-Bromofluorobenzene	96.6 %	70-130			"	"	"	

Origins Laboratory, Inc.



The results in this report apply to the samples analyzed in accordance with the chain of custody document. This analytical report must be reproduced in its entirety.

Eagle Environmental Consulting, Inc.  
4101 Inca Street  
Denver CO 80211

Martin C Eckert III  
Project Number: [none]  
Project: Noble - Wells Ranch AE32 Econode

SS-08 @ 6'  
5/9/2018 12:09:00PM

Analyte	Result	Reporting Limit	Units	Dilution	Batch	Prepared	Analyzed	Notes
---------	--------	--------------------	-------	----------	-------	----------	----------	-------

Origins Laboratory, Inc.  
Y805148-08 (Soil)

## Diesel Range Organics (DRO/TEPH) by EPA 8015C

Diesel (C10-C28)	5150	50.0	mg/kg	1	B8E0903	05/09/2018	05/09/2018
------------------	------	------	-------	---	---------	------------	------------

Surrogate: o-Terphenyl	62.5 %	59-131			"	"	"
------------------------	--------	--------	--	--	---	---	---

## GBTEX + Napthalene by 8260C

Gasoline Range Hydrocarbons	3130	50.0	mg/kg	250	B8E0907	05/09/2018	05/10/2018
Benzene	18.8	0.498	"	"	"	"	"
Toluene	64.9	0.498	"	"	"	"	"
Ethylbenzene	20.4	0.498	"	"	"	"	"
Xylenes, total	71.2	0.498	"	"	"	"	"
Naphthalene	4.05	0.175	"	25	"	"	05/09/2018

Surrogate: 1,2-Dichloroethane-d4	121 %	70-130			"	"	"
Surrogate: Toluene-d8	101 %	70-130			"	"	"
Surrogate: 4-Bromofluorobenzene	97.8 %	70-130			"	"	05/10/2018

Origins Laboratory, Inc.



The results in this report apply to the samples analyzed in accordance with the chain of custody document. This analytical report must be reproduced in its entirety.

Eagle Environmental Consulting, Inc.  
4101 Inca Street  
Denver CO 80211

Martin C Eckert III  
Project Number: [none]  
Project: Noble - Wells Ranch AE32 Econode

SS-09 @ 6'  
5/9/2018 12:39:00PM

Analyte	Result	Reporting Limit	Units	Dilution	Batch	Prepared	Analyzed	Notes
---------	--------	-----------------	-------	----------	-------	----------	----------	-------

Origins Laboratory, Inc.  
Y805148-09 (Soil)

## Diesel Range Organics (DRO/TEPH) by EPA 8015C

Diesel (C10-C28)	2280	50.0	mg/kg	1	B8E0903	05/09/2018	05/09/2018	
Surrogate: o-Terphenyl	184 %	59-131			"	"	"	S-DUP

## GBTEX + Napthalene by 8260C

Gasoline Range Hydrocarbons	1710	50.0	mg/kg	250	B8E0907	05/09/2018	05/10/2018	
Benzene	3.91	0.050	"	25	"	"	05/09/2018	
Toluene	26.2	0.498	"	250	"	"	05/10/2018	
Ethylbenzene	9.79	0.498	"	"	"	"	"	
Xylenes, total	35.7	0.498	"	"	"	"	"	
Naphthalene	2.31	0.175	"	25	"	"	05/09/2018	
Surrogate: 1,2-Dichloroethane-d4	102 %	70-130			"	"	"	
Surrogate: Toluene-d8	108 %	70-130			"	"	"	
Surrogate: 4-Bromofluorobenzene	104 %	70-130			"	"	05/10/2018	

Origins Laboratory, Inc.



The results in this report apply to the samples analyzed in accordance with the chain of custody document. This analytical report must be reproduced in its entirety.

Eagle Environmental Consulting, Inc.  
4101 Inca Street  
Denver CO 80211

Martin C Eckert III  
Project Number: [none]  
Project: Noble - Wells Ranch AE32 Econode

**Volatile Organic Compounds by GC/MS SW846 8260C - Quality Control**  
**Origins Laboratory, Inc.**

Analyte	Result	Reporting Limit	Units	Spike Level	Source Result	%REC	%REC Limits	RPD	RPD Limit	Notes
<b>Batch B8E0907 - EPA 5030 (soil)</b>										
<b>Blank (B8E0907-BLK1)</b>					Prepared: 05/09/2018 Analyzed: 05/09/2018					
Gasoline Range Hydrocarbons	ND	0.200	mg/kg							U
Benzene	ND	0.002	"							U
Toluene	ND	0.002	"							U
Ethylbenzene	ND	0.002	"							U
Xylenes, total	ND	0.002	"							U
Naphthalene	ND	0.007	"							U
Surrogate: 1,2-Dichloroethane-d4	66		ug/kg	62.5		105	70-130			
Surrogate: Toluene-d8	60		"	62.5		96.2	70-130			
Surrogate: 4-Bromofluorobenzene	63		"	62.5		100	70-130			

Origins Laboratory, Inc.



The results in this report apply to the samples analyzed in accordance with the chain of custody document. This analytical report must be reproduced in its entirety.

Eagle Environmental Consulting, Inc.  
4101 Inca Street  
Denver CO 80211

Martin C Eckert III  
Project Number: [none]  
Project: Noble - Wells Ranch AE32 Econode

**Volatile Organic Compounds by GC/MS SW846 8260C - Quality Control**  
**Origins Laboratory, Inc.**

Analyte	Result	Reporting Limit	Units	Spike Level	Source Result	%REC	%REC Limits	RPD	RPD Limit	Notes
<b>Batch B8E0907 - EPA 5030 (soil)</b>										
<b>Blank (B8E0907-BLK2)</b>					Prepared: 05/09/2018 Analyzed: 05/10/2018					
Gasoline Range Hydrocarbons	ND	0.200	mg/kg							U
Benzene	ND	0.002	"							U
Toluene	ND	0.002	"							U
Ethylbenzene	ND	0.002	"							U
Xylenes, total	ND	0.002	"							U
Naphthalene	ND	0.007	"							U
Surrogate: 1,2-Dichloroethane-d4	68		ug/kg	62.5		109	70-130			
Surrogate: Toluene-d8	60		"	62.5		95.5	70-130			
Surrogate: 4-Bromofluorobenzene	63		"	62.5		100	70-130			

Origins Laboratory, Inc.



The results in this report apply to the samples analyzed in accordance with the chain of custody document. This analytical report must be reproduced in its entirety.

Eagle Environmental Consulting, Inc.  
4101 Inca Street  
Denver CO 80211

Martin C Eckert III  
Project Number: [none]  
Project: Noble - Wells Ranch AE32 Econode

**Volatile Organic Compounds by GC/MS SW846 8260C - Quality Control**  
**Origins Laboratory, Inc.**

Analyte	Result	Reporting Limit	Units	Spike Level	Source Result	%REC	%REC Limits	RPD	RPD Limit	Notes
<b>Batch B8E0907 - EPA 5030 (soil)</b>										
<b>LCS (B8E0907-BS1)</b>					Prepared: 05/09/2018 Analyzed: 05/09/2018					
Benzene	0.109	0.002	mg/kg	0.100		109	70-130			
Toluene	0.108	0.002	"	0.100		108	70-130			
Ethylbenzene	0.110	0.002	"	0.100		110	70-130			
m,p-Xylene	0.206	0.004	"	0.200		103	70-130			
o-Xylene	0.105	0.002	"	0.100		105	70-130			
Naphthalene	0.098	0.007	"	0.100		97.8	70-130			
Surrogate: 1,2-Dichloroethane-d4	64		ug/kg	62.5		102	70-130			
Surrogate: Toluene-d8	60		"	62.5		96.4	70-130			
Surrogate: 4-Bromofluorobenzene	63		"	62.5		101	70-130			

Origins Laboratory, Inc.



The results in this report apply to the samples analyzed in accordance with the chain of custody document. This analytical report must be reproduced in its entirety.



Eagle Environmental Consulting, Inc.

4101 Inca Street

Denver CO 80211

Martin C Eckert III

Project Number: [none]

Project: Noble - Wells Ranch AE32 Econode

**Volatile Organic Compounds by GC/MS SW846 8260C - Quality Control**  
**Origins Laboratory, Inc.**

Analyte	Result	Reporting Limit	Units	Spike Level	Source Result	%REC	%REC Limits	RPD	RPD Limit	Notes
<b>Batch B8E0907 - EPA 5030 (soil)</b>										
<b>LCS (B8E0907-BS2)</b>					Prepared: 05/09/2018 Analyzed: 05/10/2018					
Benzene	0.114	0.002	mg/kg	0.100		114	70-130			
Toluene	0.112	0.002	"	0.100		112	70-130			
Ethylbenzene	0.115	0.002	"	0.100		115	70-130			
m,p-Xylene	0.215	0.004	"	0.200		108	70-130			
o-Xylene	0.110	0.002	"	0.100		110	70-130			
Naphthalene	0.094	0.007	"	0.100		94.2	70-130			
Surrogate: 1,2-Dichloroethane-d4	66		ug/kg	62.5		106	70-130			
Surrogate: Toluene-d8	60		"	62.5		96.2	70-130			
Surrogate: 4-Bromofluorobenzene	64		"	62.5		102	70-130			

Origins Laboratory, Inc.



The results in this report apply to the samples analyzed in accordance with the chain of custody document. This analytical report must be reproduced in its entirety.

Jen Pellegrini For Noelle Doyle Mathis, President

Eagle Environmental Consulting, Inc.  
4101 Inca Street  
Denver CO 80211

Martin C Eckert III  
Project Number: [none]  
Project: Noble - Wells Ranch AE32 Econode

**Volatile Organic Compounds by GC/MS SW846 8260C - Quality Control**  
**Origins Laboratory, Inc.**

Analyte	Result	Reporting Limit	Units	Spike Level	Source Result	%REC	%REC Limits	RPD	RPD Limit	Notes
<b>Batch B8E0907 - EPA 5030 (soil)</b>										
<b>Matrix Spike (B8E0907-MS1)</b>		<b>Source: Y805148-04</b>			Prepared: 05/09/2018 Analyzed: 05/09/2018					
Benzene	0.269	0.002	mg/kg	0.100	0.006	263	70-130			QM-07
Toluene	0.113	0.002	"	0.100	0.001	112	70-130			
Ethylbenzene	0.125	0.002	"	0.100	ND	125	70-130			
m,p-Xylene	0.232	0.004	"	0.200	0.002	115	70-130			
o-Xylene	0.110	0.002	"	0.100	ND	110	70-130			
Naphthalene	0.094	0.007	"	0.100	ND	93.8	70-130			
Surrogate: 1,2-Dichloroethane-d4	64		ug/kg	62.5		102	70-130			
Surrogate: Toluene-d8	59		"	62.5		94.8	70-130			
Surrogate: 4-Bromofluorobenzene	65		"	62.5		103	70-130			

Origins Laboratory, Inc.



The results in this report apply to the samples analyzed in accordance with the chain of custody document. This analytical report must be reproduced in its entirety.

Eagle Environmental Consulting, Inc.  
4101 Inca Street  
Denver CO 80211

Martin C Eckert III  
Project Number: [none]  
Project: Noble - Wells Ranch AE32 Econode

**Volatile Organic Compounds by GC/MS SW846 8260C - Quality Control**  
**Origins Laboratory, Inc.**

Analyte	Result	Reporting Limit	Units	Spike Level	Source Result	%REC	%REC Limits	RPD	RPD Limit	Notes
---------	--------	-----------------	-------	-------------	---------------	------	-------------	-----	-----------	-------

Batch B8E0907 - EPA 5030 (soil)

Matrix Spike (B8E0907-MS2)		Source: Y805151-01			Prepared: 05/09/2018 Analyzed: 05/09/2018					
Benzene	0.111	0.002	mg/kg	0.100	ND	111	70-130			
Toluene	0.108	0.002	"	0.100	ND	108	70-130			
Ethylbenzene	0.106	0.002	"	0.100	ND	106	70-130			
m,p-Xylene	0.196	0.004	"	0.200	ND	98.0	70-130			
o-Xylene	0.101	0.002	"	0.100	ND	101	70-130			
Naphthalene	0.096	0.007	"	0.100	ND	95.6	70-130			
Surrogate: 1,2-Dichloroethane-d4	63		ug/kg	62.5		100	70-130			
Surrogate: Toluene-d8	60		"	62.5		95.7	70-130			
Surrogate: 4-Bromofluorobenzene	63		"	62.5		100	70-130			

Origins Laboratory, Inc.



The results in this report apply to the samples analyzed in accordance with the chain of custody document. This analytical report must be reproduced in its entirety.

Jen Pellegrini For Noelle Doyle Mathis, President

Eagle Environmental Consulting, Inc.  
4101 Inca Street  
Denver CO 80211

Martin C Eckert III  
Project Number: [none]  
Project: Noble - Wells Ranch AE32 Econode

**Volatile Organic Compounds by GC/MS SW846 8260C - Quality Control**  
**Origins Laboratory, Inc.**

Analyte	Result	Reporting Limit	Units	Spike Level	Source Result	%REC	%REC Limits	RPD	RPD Limit	Notes
<b>Batch B8E0907 - EPA 5030 (soil)</b>										
<b>Matrix Spike Dup (B8E0907-MSD1)</b>		<b>Source: Y805148-04</b>			Prepared: 05/09/2018 Analyzed: 05/09/2018					
Benzene	0.243	0.002	mg/kg	0.100	0.006	237	70-130	10.2	20	QM-07
Toluene	0.114	0.002	"	0.100	0.001	113	70-130	0.968	20	
Ethylbenzene	0.121	0.002	"	0.100	ND	121	70-130	2.57	20	
m,p-Xylene	0.227	0.004	"	0.200	0.002	112	70-130	2.26	20	
o-Xylene	0.107	0.002	"	0.100	ND	107	70-130	2.10	20	
Naphthalene	0.093	0.007	"	0.100	ND	93.4	70-130	0.449	20	
Surrogate: 1,2-Dichloroethane-d4	63		ug/kg	62.5		100	70-130			
Surrogate: Toluene-d8	60		"	62.5		95.5	70-130			
Surrogate: 4-Bromofluorobenzene	64		"	62.5		102	70-130			

Origins Laboratory, Inc.



The results in this report apply to the samples analyzed in accordance with the chain of custody document. This analytical report must be reproduced in its entirety.

Eagle Environmental Consulting, Inc.  
4101 Inca Street  
Denver CO 80211

Martin C Eckert III  
Project Number: [none]  
Project: Noble - Wells Ranch AE32 Econode

**Volatile Organic Compounds by GC/MS SW846 8260C - Quality Control**  
**Origins Laboratory, Inc.**

Analyte	Result	Reporting Limit	Units	Spike Level	Source Result	%REC	%REC Limits	RPD	RPD Limit	Notes
<b>Batch B8E0907 - EPA 5030 (soil)</b>										
<b>Matrix Spike Dup (B8E0907-MSD2)</b>		<b>Source: Y805151-01</b>			Prepared: 05/09/2018 Analyzed: 05/09/2018					
Benzene	0.106	0.002	mg/kg	0.100	ND	106	70-130	4.63	20	
Toluene	0.104	0.002	"	0.100	ND	104	70-130	3.60	20	
Ethylbenzene	0.107	0.002	"	0.100	ND	107	70-130	1.13	20	
m,p-Xylene	0.197	0.004	"	0.200	ND	98.5	70-130	0.540	20	
o-Xylene	0.102	0.002	"	0.100	ND	102	70-130	0.907	20	
Naphthalene	0.095	0.007	"	0.100	ND	95.1	70-130	0.503	20	
Surrogate: 1,2-Dichloroethane-d4	63		ug/kg	62.5		100	70-130			
Surrogate: Toluene-d8	60		"	62.5		95.5	70-130			
Surrogate: 4-Bromofluorobenzene	65		"	62.5		103	70-130			

Origins Laboratory, Inc.



The results in this report apply to the samples analyzed in accordance with the chain of custody document. This analytical report must be reproduced in its entirety.

Eagle Environmental Consulting, Inc.  
4101 Inca Street  
Denver CO 80211

Martin C Eckert III  
Project Number: [none]  
Project: Noble - Wells Ranch AE32 Econode

## Volatile Organic Compounds by GC/MS SW846 8260C - Quality Control

### Origins Laboratory, Inc.

Analyte	Result	Reporting Limit	Units	Spike Level	Source Result	%REC	%REC Limits	RPD	RPD Limit	Notes
---------	--------	-----------------	-------	-------------	---------------	------	-------------	-----	-----------	-------

## Extractable Petroleum Hydrocarbons by 8015C - Quality Control

### Origins Laboratory, Inc.

Analyte	Result	Reporting Limit	Units	Spike Level	Source Result	%REC	%REC Limits	RPD	RPD Limit	Notes
---------	--------	-----------------	-------	-------------	---------------	------	-------------	-----	-----------	-------

#### Batch B8E0903 - EPA 3550B

<b>Blank (B8E0903-BLK1)</b>				Prepared: 05/09/2018 Analyzed: 05/09/2018						
Diesel (C10-C28)	ND	50.0	mg/kg							U
Surrogate: o-Terphenyl	47		"	50.0		95.0	59-131			
<b>Blank (B8E0903-BLK2)</b>				Prepared: 05/09/2018 Analyzed: 05/09/2018						
Diesel (C10-C28)	ND	50.0	mg/kg							U
Surrogate: o-Terphenyl	48		"	50.0		96.8	59-131			
<b>LCS (B8E0903-BS1)</b>				Prepared: 05/09/2018 Analyzed: 05/09/2018						
Diesel (C10-C28)	996	50.0	mg/kg	1000		99.6	64-121			
Surrogate: o-Terphenyl	55		"	50.0		109	59-131			
<b>LCS (B8E0903-BS2)</b>				Prepared: 05/09/2018 Analyzed: 05/09/2018						
Diesel (C10-C28)	975	50.0	mg/kg	1000		97.5	64-121			
Surrogate: o-Terphenyl	59		"	50.0		117	59-131			
<b>Matrix Spike (B8E0903-MS1)</b>				<b>Source: Y805128-02</b>		Prepared: 05/09/2018 Analyzed: 05/10/2018				
Diesel (C10-C28)	1070	50.0	mg/kg	1000	25.5	104	53-125			
Surrogate: o-Terphenyl	57		"	50.0		114	59-131			
<b>Matrix Spike (B8E0903-MS2)</b>				<b>Source: Y805148-04</b>		Prepared: 05/09/2018 Analyzed: 05/09/2018				
Diesel (C10-C28)	979	50.0	mg/kg	1000	ND	97.9	53-125			
Surrogate: o-Terphenyl	49		"	50.0		98.0	59-131			

Origins Laboratory, Inc.



The results in this report apply to the samples analyzed in accordance with the chain of custody document. This analytical report must be reproduced in its entirety.

Eagle Environmental Consulting, Inc.  
4101 Inca Street  
Denver CO 80211

Martin C Eckert III  
Project Number: [none]  
Project: Noble - Wells Ranch AE32 Econode

## Extractable Petroleum Hydrocarbons by 8015C - Quality Control Origins Laboratory, Inc.

Analyte	Result	Reporting Limit	Units	Spike Level	Source Result	%REC	%REC Limits	RPD	RPD Limit	Notes
<b>Batch B8E0903 - EPA 3550B</b>										
<b>Matrix Spike Dup (B8E0903-MSD1)</b>			<b>Source: Y805128-02</b>		Prepared: 05/09/2018 Analyzed: 05/10/2018					
Diesel (C10-C28)	974	50.0	mg/kg	1000	25.5	94.8	53-125	9.41	20	
Surrogate: o-Terphenyl	63		"	50.0		126	59-131			
<b>Matrix Spike Dup (B8E0903-MSD2)</b>			<b>Source: Y805148-04</b>		Prepared: 05/09/2018 Analyzed: 05/09/2018					
Diesel (C10-C28)	963	50.0	mg/kg	1000	ND	96.3	53-125	1.70	20	
Surrogate: o-Terphenyl	51		"	50.0		102	59-131			

Origins Laboratory, Inc.



The results in this report apply to the samples analyzed in accordance with the chain of custody document. This analytical report must be reproduced in its entirety.

Eagle Environmental Consulting, Inc.

4101 Inca Street

Denver CO 80211

Martin C Eckert III

Project Number: [none]

Project: Noble - Wells Ranch AE32 Econode

### Notes and Definitions

U Sample is Non-Detect.

S-DUP Duplicate analysis confirmed surrogate failure due to matrix effects.

QM-07 The spike recovery was outside acceptance limits for the MS and/or MSD. The batch was accepted based on acceptable LCS recovery.

ND Analyte NOT DETECTED at or above the reporting limit

RPD Relative Percent Difference

All soil results are reported at a wet weight basis.

Origins Laboratory, Inc.



*The results in this report apply to the samples analyzed in accordance with the chain of custody document. This analytical report must be reproduced in its entirety.*





January 21, 2019

Eagle Environmental Consulting, Inc.

Martin C Eckert III

4101 Inca Street

Denver

CO 80211

**Project Name - Noble - Wells Ranch AE32  
Econode**

**Project Number - [none]**

Attached are your analytical results for Noble - Wells Ranch AE32 Econode received by Origins Laboratory, Inc. January 18, 2019. This project is associated with Origins project number Y901219-01.

The analytical results in the following report were analyzed under the guidelines of EPA Methods. These methods are identified as follows; "SW" are defined in SW-846, "EPA" are defined in 40CFR part 136 and "SM" are defined in the most current revision of Standard Methods For the Examination of Water and Wastewater.

The analytical results apply specifically to the samples and analyses specified per the attached Chain of Custody. As such, this report shall not be reproduced except in full, without the written approval of Origin's laboratory.

Unless otherwise noted, the analytical results for all soil samples are reported on a wet weight basis. All analytical analyses were performed under NELAP guidelines unless noted by a data qualifier.

Any holding time exceedances, deviations from the method specifications or deviations from Origins Laboratory's Standard Operating Procedures are outlined in the case narrative.

Thank you for selecting Origins for your analytical needs. Please contact us with any questions concerning this report, or if we can help with anything at all.

Origins Laboratory, Inc.  
303.433.1322  
o-squad@oelabinc.com



1725 Elk Place, Denver, CO 80211 | Phone: 303.433.1322 | Fax: 303.265.9645

Eagle Environmental Consulting, Inc.

4101 Inca Street

Denver CO 80211

Martin C Eckert III

Project Number: [none]

Project: Noble - Wells Ranch AE32 Econode

## CROSS REFERENCE REPORT

Sample ID	Laboratory ID	Matrix	Date Sampled	Date Received
PH-01@10-11'	Y901219-01	Soil	January 17, 2019 11:51	01/18/2019 08:37
PH-01@14-15'	Y901219-02	Soil	January 17, 2019 11:55	01/18/2019 08:37
PH-02@8-9'	Y901219-03	Soil	January 17, 2019 11:22	01/18/2019 08:37
PH-02@14-15'	Y901219-04	Soil	January 17, 2019 11:28	01/18/2019 08:37
PH-03@10-11'	Y901219-05	Soil	January 17, 2019 12:06	01/18/2019 08:37
PH-03@14-15'	Y901219-06	Soil	January 17, 2019 12:10	01/18/2019 08:37
PH-04@10-11'	Y901219-07	Soil	January 17, 2019 14:52	01/18/2019 08:37
PH-04@12-13'	Y901219-08	Soil	January 17, 2019 14:54	01/18/2019 08:37
PH-05@10-11'	Y901219-09	Soil	January 17, 2019 14:24	01/18/2019 08:37
PH-05@12-13'	Y901219-10	Soil	January 17, 2019 14:26	01/18/2019 08:37
PH-06@8-9'	Y901219-11	Soil	January 17, 2019 13:54	01/18/2019 08:37
PH-06@9-10'	Y901219-12	Soil	January 17, 2019 13:56	01/18/2019 08:37
PH-07@12-13'	Y901219-13	Soil	January 17, 2019 13:24	01/18/2019 08:37
PH-07@14-15'	Y901219-14	Soil	January 17, 2019 13:31	01/18/2019 08:37

Origins Laboratory, Inc.



*The results in this report apply to the samples analyzed in accordance with the chain of custody document. This analytical report must be reproduced in its entirety.*

Eagle Environmental Consulting, Inc.

4101 Inca Street

Denver CO 80211

Martin C Eckert III

Project Number: [none]

Project: Noble - Wells Ranch AE32 Econode

## CROSS REFERENCE REPORT

Sample ID	Laboratory ID	Matrix	Date Sampled	Date Received
PH-08@12-13'	Y901219-15	Soil	January 17, 2019 13:00	01/18/2019 08:37
PH-08@14-15'	Y901219-16	Soil	January 17, 2019 13:02	01/18/2019 08:37

Origins Laboratory, Inc.



*The results in this report apply to the samples analyzed in accordance with the chain of custody document. This analytical report must be reproduced in its entirety.*

Jen Pellegrini For Noelle Doyle Mathis, President

Eagle Environmental Consulting, Inc.  
4101 Inca Street  
Denver CO 80211

Martin C Eckert III  
Project Number: [none]  
Project: Noble - Wells Ranch AE32 Econode

www.originslaboratory.com

990219

page 1 of 2

**ORIGINS**  
LABORATORY, INC

Client: EAGLE ENV. CONSULTING  
Address: 4101 INCA ST.  
DENVER, CO  
Telephone Number: 303-433-0479  
Email Address: MCE@EAGLE-ENVIRONMENTAL.COM

Project Manager: MARTIN ECKERT III  
Project Name: WELLS RANCH AE32 ECONODE  
Project Number:         
Samples Collected By: KE

Sample ID Description	Date Sampled	Time Sampled	# of Containers	Preservative				Matrix		Analysis				Sample Instructions
				Unpreserved	HCl	HNO <sub>3</sub>	Other	Groundwater	Soil	Air Summa Canister #	Other	7161	620	
PH-01 @ 10-11'	1-17-19	1151	2	X					X				X	1
PH-01 @ 14-15'		1155											X	2
PH-02 @ 8-9'		1122												3
PH-02 @ 14-15'		1128												4
PH-03 @ 10-11'		1206												5
PH-03 @ 14-15'		1210												6
PH-04 @ 10-11'		1452												7
PH-04 @ 12-13'		1454												8
PH-05 @ 10-11'		1424												9
PH-05 @ 12-13'		1426												10

Turnaround Time: Same Day ☐ 24 Hr ☐ 48 Hr ☐ 72 Hr ☒ Standard

Relinquished By:        Date: 1-18-19 Time: 0837  
Relinquished By:        Date:        Time:       

Received By:        Date: 01-18-19 Time: 0832

Date Results Needed: Noble

Temp Received: 1.3

Full to Howard

Origins Laboratory, Inc.

*Jefe Pellegrini*

The results in this report apply to the samples analyzed in accordance with the chain of custody document. This analytical report must be reproduced in its entirety.

Eagle Environmental Consulting, Inc.  
4101 Inca Street  
Denver CO 80211

Martin C Eckert III  
Project Number: [none]  
Project: Noble - Wells Ranch AE32 Econode

www.originslaboratory.com

page 2 of 2  
9901219

ORIGINS  
LABORATORY, INC

Client: EMBLE ENV. CONSULTING  
Address: 4101 INCA ST  
DENVER, CO  
Telephone Number: 303-433-0471  
Email Address: MYLES@EMBLE-ENVIRONMENT.COM

Project Manager: MARTIN ECKERT III  
Project Name: WELLS RANCH AE32 ECONODE  
Project Number: K-7  
Samples Collected By: K-7

1725 Elk Place | Denver, CO 80211 | Phone: 303.433.1322 | Fax: 303.265.9645

Sample ID Description	Date Sampled	Time Sampled	# of Containers	Preservative				Matrix			Analysis				Sample Instructions
				Unpreserved	HCl	HNO <sub>3</sub>	Other	Groundwater	Soil	Air Summ #	Other	BTEX	BP	DP	
PH-06 @ 8-11	1-17-14	1354	2	X					X				X	X	1
PH-06 @ 9-10	1-17-14	1356	1												2
PH-07 @ 12-13	1-17-14	1324	1												3
PH-07 @ 14-15	1-17-14	1331	1												4
PH-08 @ 12-13	1-17-14	1300	1												5
PH-08 @ 14-15	1-17-14	1302	1												6
															7
															8
															9
															10

Relinquished By: [Signature] Date: 1-18-14 Time: 0837  
Relinquished By: [Signature] Date: 01-18-14 Time: 0837

Received By: [Signature] Date: 01-18-14 Time: 0837  
Received By: [Signature] Date: 01-18-14 Time: 0837

Turnaround Time: Same Day ☐ 24 Hr ☐ 48 Hr ☐ 72 Hr ☒ Standard

Date Results Needed 1/23 Noble

Temp Received 13

Origins Laboratory, Inc.

*Jefe Pellegrini*

The results in this report apply to the samples analyzed in accordance with the chain of custody document. This analytical report must be reproduced in its entirety.



Eagle Environmental Consulting, Inc.  
4101 Inca Street  
Denver CO 80211

Martin C Eckert III  
Project Number: [none]  
Project: Noble - Wells Ranch AE32 Econode

Origins Laboratory

F-012207-01-R1  
Effective Date: 01/09/12

## Sample Receipt Checklist

Origins Work Order: 4901219 Client: Eagle Env  
Client Project ID: Noble - wells Ranch  
Checklist Completed by: JP Shipped Via: HD  
(UPS, FedEx, Hand Delivered, Pick-up, etc.)  
Date/time completed: 1/18/19 Airbill #: NA  
Matrix(s) Received: (Check all that apply): ☒ Soil/Solid ☐ Water ☐ Other: \_\_\_\_\_  
(Describe)  
Cooler Number/Temperature: 1 / 1.3 °C \_\_\_\_\_ / \_\_\_\_\_ °C \_\_\_\_\_ / \_\_\_\_\_ °C  
Thermometer ID: T003

Requirement Description	Yes	No	N/A	Comments (if any)
If samples require cooling, was the temperature between 0°C to ≤ 6°C <sup>(1)</sup> ?	<input checked="" type="checkbox"/>			
Is there ice present (document if blue ice is used)	<input checked="" type="checkbox"/>			
Are custody seals present on cooler? (if so, document in comments if they are signed and dated, broken or intact)		<input checked="" type="checkbox"/>		
Are custody seals present on each sample container? (if so, document in comments if they are signed and dated, broken or intact)		<input checked="" type="checkbox"/>		
Were all samples received intact <sup>(1)</sup> ?	<input checked="" type="checkbox"/>			
Was adequate sample volume provided <sup>(1)</sup> ?	<input checked="" type="checkbox"/>			
Are short holding time analytes or samples with HTs due within 48 hours present <sup>(1)</sup> ?		<input checked="" type="checkbox"/>		
Is a chain-of-custody (COC) present and filled out completely <sup>(1)</sup> ?	<input checked="" type="checkbox"/>			
Does the COC agree with the number and type of sample bottles received <sup>(1)</sup> ?	<input checked="" type="checkbox"/>			
Do the sample IDs on the bottle labels match the COC <sup>(1)</sup> ?	<input checked="" type="checkbox"/>			
Is the COC properly relinquished by the client with date and time recorded <sup>(1)</sup> ?	<input checked="" type="checkbox"/>			
For volatiles in water – is there headspace (> ¼ inch bubble) present? If yes, contact client and note in narrative.			<input checked="" type="checkbox"/>	
Are samples preserved that require preservation and was it checked <sup>(1)</sup> ? (note ID of confirmation instrument used in comments) / (preservation is not confirmed for subcontracted analyses in order to insure sample integrity) / (pH < 2 for samples preserved with HNO <sub>3</sub> , HCL, H <sub>2</sub> SO <sub>4</sub> ) / (pH > 10 for samples preserved with NaAsO <sub>2</sub> +NaOH, ZnAc+NaOH)			<input checked="" type="checkbox"/>	
Additional Comments (if any):				

<sup>(1)</sup> If NO, then contact the client before proceeding with analysis and note date/time and person contacted as well as the corrective action to in the additional comments (above) and the case narrative.

Reviewed by (Project Manager)

Date/Time Reviewed

Origins Laboratory, Inc.

*Jefe Pellegrini*

The results in this report apply to the samples analyzed in accordance with the chain of custody document. This analytical report must be reproduced in its entirety.

Eagle Environmental Consulting, Inc.  
4101 Inca Street  
Denver CO 80211

Martin C Eckert III  
Project Number: [none]  
Project: Noble - Wells Ranch AE32 Econode

PH-01@10-11'

1/17/2019 11:51:00AM

Analyte	Result	Reporting Limit	Units	Dilution	Batch	Analyst	Prepared	Analyzed	Notes
---------	--------	-----------------	-------	----------	-------	---------	----------	----------	-------

Origins Laboratory, Inc.  
Y901219-01 (Soil)

## Diesel Range Organics (DRO/TEPH) by EPA 8015C

Diesel (C10-C28)	3900	50.0	mg/kg	1	B9A1804	JTD	01/18/2019	01/18/2019
------------------	------	------	-------	---	---------	-----	------------	------------

Surrogate: o-Terphenyl	97.8 %	59-131			"	"	"
------------------------	--------	--------	--	--	---	---	---

## GBTEX + Napthalene by 8260C

Gasoline Range Hydrocarbons	1460	50.0	mg/kg	250	B9A1803	JTD	01/18/2019	01/18/2019
Benzene	4.20	0.498	"	"	"	JTD	"	"
Toluene	20.2	0.498	"	"	"	JTD	"	"
Ethylbenzene	9.70	0.498	"	"	"	JTD	"	"
Xylenes, total	39.9	0.498	"	"	"	JTD	"	"
Naphthalene	4.04	2.00	"	"	"	JTD	"	"

Surrogate: 1,2-Dichloroethane-d4	108 %	70-130			"	"	"
Surrogate: Toluene-d8	87.7 %	70-130			"	"	"
Surrogate: 4-Bromofluorobenzene	99.6 %	70-130			"	"	"

Origins Laboratory, Inc.



The results in this report apply to the samples analyzed in accordance with the chain of custody document. This analytical report must be reproduced in its entirety.

Eagle Environmental Consulting, Inc.  
4101 Inca Street  
Denver CO 80211

Martin C Eckert III  
Project Number: [none]  
Project: Noble - Wells Ranch AE32 Econode

PH-01@14-15'

1/17/2019 11:55:00AM

Analyte	Result	Reporting Limit	Units	Dilution	Batch	Analyst	Prepared	Analyzed	Notes
---------	--------	-----------------	-------	----------	-------	---------	----------	----------	-------

Origins Laboratory, Inc.  
Y901219-02 (Soil)

## Diesel Range Organics (DRO/TEPH) by EPA 8015C

Diesel (C10-C28)	5140	50.0	mg/kg	1	B9A1804	JTD	01/18/2019	01/18/2019
------------------	------	------	-------	---	---------	-----	------------	------------

Surrogate: o-Terphenyl	103 %	59-131			"	"	"
------------------------	-------	--------	--	--	---	---	---

## GBTEX + Napthalene by 8260C

Gasoline Range Hydrocarbons	3650	50.0	mg/kg	250	B9A1803	JTD	01/18/2019	01/18/2019
Benzene	18.5	0.498	"	"	"	JTD	"	"
Toluene	53.1	0.498	"	"	"	JTD	"	"
Ethylbenzene	26.1	0.498	"	"	"	JTD	"	"
Xylenes, total	95.6	0.498	"	"	"	JTD	"	"
Naphthalene	6.31	2.00	"	"	"	JTD	"	"

Surrogate: 1,2-Dichloroethane-d4	109 %	70-130			"	"	"
Surrogate: Toluene-d8	78.1 %	70-130			"	"	"
Surrogate: 4-Bromofluorobenzene	104 %	70-130			"	"	"

Origins Laboratory, Inc.



The results in this report apply to the samples analyzed in accordance with the chain of custody document. This analytical report must be reproduced in its entirety.



Eagle Environmental Consulting, Inc.  
4101 Inca Street  
Denver CO 80211

Martin C Eckert III  
Project Number: [none]  
Project: Noble - Wells Ranch AE32 Econode

PH-02@8-9'

1/17/2019 11:22:00AM

Analyte	Result	Reporting Limit	Units	Dilution	Batch	Analyst	Prepared	Analyzed	Notes
---------	--------	-----------------	-------	----------	-------	---------	----------	----------	-------

Origins Laboratory, Inc.  
Y901219-03 (Soil)

## Diesel Range Organics (DRO/TEPH) by EPA 8015C

Diesel (C10-C28)	501	50.0	mg/kg	1	B9A1804	JTD	01/18/2019	01/18/2019
------------------	-----	------	-------	---	---------	-----	------------	------------

Surrogate: o-Terphenyl	101 %	59-131			"	"	"
------------------------	-------	--------	--	--	---	---	---

## GBTEX + Napthalene by 8260C

Gasoline Range Hydrocarbons	123	5.00	mg/kg	25	B9A1803	JTD	01/18/2019	01/18/2019
Benzene	0.293	0.050	"	"	"	JTD	"	"
Toluene	0.972	0.050	"	"	"	JTD	"	"
Ethylbenzene	0.828	0.050	"	"	"	JTD	"	"
Xylenes, total	3.55	0.050	"	"	"	JTD	"	"
Naphthalene	0.536	0.200	"	"	"	JTD	"	"

Surrogate: 1,2-Dichloroethane-d4	105 %	70-130			"	"	"
Surrogate: Toluene-d8	88.1 %	70-130			"	"	"
Surrogate: 4-Bromofluorobenzene	99.4 %	70-130			"	"	"

Origins Laboratory, Inc.



The results in this report apply to the samples analyzed in accordance with the chain of custody document. This analytical report must be reproduced in its entirety.

Eagle Environmental Consulting, Inc.  
4101 Inca Street  
Denver CO 80211

Martin C Eckert III  
Project Number: [none]  
Project: Noble - Wells Ranch AE32 Econode

PH-02@14-15'

1/17/2019 11:28:00AM

Analyte	Result	Reporting Limit	Units	Dilution	Batch	Analyst	Prepared	Analyzed	Notes
---------	--------	-----------------	-------	----------	-------	---------	----------	----------	-------

Origins Laboratory, Inc.  
Y901219-04 (Soil)

## Diesel Range Organics (DRO/TEPH) by EPA 8015C

Diesel (C10-C28)	2670	50.0	mg/kg	1	B9A1804	JTD	01/18/2019	01/18/2019
------------------	------	------	-------	---	---------	-----	------------	------------

Surrogate: o-Terphenyl	96.9 %	59-131			"	"	"
------------------------	--------	--------	--	--	---	---	---

## GBTEX + Napthalene by 8260C

Gasoline Range Hydrocarbons	1790	50.0	mg/kg	250	B9A1803	JTD	01/18/2019	01/18/2019
Benzene	6.42	0.498	"	"	"	JTD	"	"
Toluene	27.6	0.498	"	"	"	JTD	"	"
Ethylbenzene	12.7	0.498	"	"	"	JTD	"	"
Xylenes, total	48.0	0.498	"	"	"	JTD	"	"
Naphthalene	3.82	2.00	"	"	"	JTD	"	"

Surrogate: 1,2-Dichloroethane-d4	108 %	70-130			"	"	"
Surrogate: Toluene-d8	85.3 %	70-130			"	"	"
Surrogate: 4-Bromofluorobenzene	101 %	70-130			"	"	"

Origins Laboratory, Inc.



The results in this report apply to the samples analyzed in accordance with the chain of custody document. This analytical report must be reproduced in its entirety.

Eagle Environmental Consulting, Inc.  
4101 Inca Street  
Denver CO 80211

Martin C Eckert III  
Project Number: [none]  
Project: Noble - Wells Ranch AE32 Econode

PH-03@10-11'

1/17/2019 12:06:00PM

Analyte	Result	Reporting Limit	Units	Dilution	Batch	Analyst	Prepared	Analyzed	Notes
---------	--------	-----------------	-------	----------	-------	---------	----------	----------	-------

Origins Laboratory, Inc.  
Y901219-05 (Soil)

## Diesel Range Organics (DRO/TEPH) by EPA 8015C

Diesel (C10-C28)	1160	50.0	mg/kg	1	B9A1804	JTD	01/18/2019	01/18/2019
------------------	------	------	-------	---	---------	-----	------------	------------

Surrogate: o-Terphenyl	113 %	59-131			"	"	"
------------------------	-------	--------	--	--	---	---	---

## GBTEX + Napthalene by 8260C

Gasoline Range Hydrocarbons	509	50.0	mg/kg	250	B9A1803	JTD	01/18/2019	01/18/2019
Benzene	0.675	0.498	"	"	"	JTD	"	"
Toluene	5.48	0.498	"	"	"	JTD	"	"
Ethylbenzene	3.05	0.498	"	"	"	JTD	"	"
Xylenes, total	12.9	0.498	"	"	"	JTD	"	"
Naphthalene	1.15	0.200	"	25	"	JTD	"	01/21/2019

Surrogate: 1,2-Dichloroethane-d4	106 %	70-130			"	"	01/18/2019
Surrogate: Toluene-d8	94.0 %	70-130			"	"	"
Surrogate: 4-Bromofluorobenzene	99.9 %	70-130			"	"	"

Origins Laboratory, Inc.



The results in this report apply to the samples analyzed in accordance with the chain of custody document. This analytical report must be reproduced in its entirety.

Eagle Environmental Consulting, Inc.  
4101 Inca Street  
Denver CO 80211

Martin C Eckert III  
Project Number: [none]  
Project: Noble - Wells Ranch AE32 Econode

PH-03@14-15'

1/17/2019 12:10:00PM

Analyte	Result	Reporting Limit	Units	Dilution	Batch	Analyst	Prepared	Analyzed	Notes
---------	--------	-----------------	-------	----------	-------	---------	----------	----------	-------

Origins Laboratory, Inc.  
Y901219-06 (Soil)

## Diesel Range Organics (DRO/TEPH) by EPA 8015C

Diesel (C10-C28)	1360	50.0	mg/kg	1	B9A1804	JTD	01/18/2019	01/18/2019
------------------	------	------	-------	---	---------	-----	------------	------------

Surrogate: o-Terphenyl	107 %	59-131			"	"	"
------------------------	-------	--------	--	--	---	---	---

## GBTEX + Napthalene by 8260C

Gasoline Range Hydrocarbons	621	50.0	mg/kg	250	B9A1803	JTD	01/18/2019	01/18/2019
Benzene	0.890	0.498	"	"	"	JTD	"	"
Toluene	5.64	0.498	"	"	"	JTD	"	"
Ethylbenzene	4.08	0.498	"	"	"	JTD	"	"
Xylenes, total	16.4	0.498	"	"	"	JTD	"	"
Naphthalene	1.16	0.200	"	25	"	JTD	"	01/21/2019

Surrogate: 1,2-Dichloroethane-d4	110 %	70-130			"	"	01/18/2019
Surrogate: Toluene-d8	92.2 %	70-130			"	"	"
Surrogate: 4-Bromofluorobenzene	99.4 %	70-130			"	"	"

Origins Laboratory, Inc.



The results in this report apply to the samples analyzed in accordance with the chain of custody document. This analytical report must be reproduced in its entirety.

Eagle Environmental Consulting, Inc.  
4101 Inca Street  
Denver CO 80211

Martin C Eckert III  
Project Number: [none]  
Project: Noble - Wells Ranch AE32 Econode

PH-04@10-11'  
1/17/2019 2:52:00PM

Analyte	Result	Reporting Limit	Units	Dilution	Batch	Analyst	Prepared	Analyzed	Notes
---------	--------	--------------------	-------	----------	-------	---------	----------	----------	-------

Origins Laboratory, Inc.  
Y901219-07 (Soil)

## Diesel Range Organics (DRO/TEPH) by EPA 8015C

Diesel (C10-C28)	439	50.0	mg/kg	1	B9A1804	JTD	01/18/2019	01/18/2019
------------------	-----	------	-------	---	---------	-----	------------	------------

Surrogate: o-Terphenyl	92.3 %	59-131			"	"	"
------------------------	--------	--------	--	--	---	---	---

## GBTEX + Napthalene by 8260C

Gasoline Range Hydrocarbons	252	5.00	mg/kg	25	B9A1803	JTD	01/18/2019	01/18/2019
Benzene	0.142	0.050	"	"	"	JTD	"	"
Toluene	0.102	0.050	"	"	"	JTD	"	"
Ethylbenzene	1.25	0.050	"	"	"	JTD	"	"
Xylenes, total	6.05	0.050	"	"	"	JTD	"	"
Naphthalene	1.07	0.200	"	"	"	JTD	"	"

Surrogate: 1,2-Dichloroethane-d4	105 %	70-130			"	"	"
Surrogate: Toluene-d8	78.2 %	70-130			"	"	"
Surrogate: 4-Bromofluorobenzene	105 %	70-130			"	"	"

Origins Laboratory, Inc.



The results in this report apply to the samples analyzed in accordance with the chain of custody document. This analytical report must be reproduced in its entirety.

Eagle Environmental Consulting, Inc.  
4101 Inca Street  
Denver CO 80211

Martin C Eckert III  
Project Number: [none]  
Project: Noble - Wells Ranch AE32 Econode

PH-04@12-13'  
1/17/2019 2:54:00PM

Analyte	Result	Reporting Limit	Units	Dilution	Batch	Analyst	Prepared	Analyzed	Notes
---------	--------	-----------------	-------	----------	-------	---------	----------	----------	-------

Origins Laboratory, Inc.  
Y901219-08 (Soil)

## Diesel Range Organics (DRO/TEPH) by EPA 8015C

Diesel (C10-C28)	532	50.0	mg/kg	1	B9A1804	JTD	01/18/2019	01/18/2019
------------------	-----	------	-------	---	---------	-----	------------	------------

Surrogate: o-Terphenyl	91.5 %	59-131			"	"	"
------------------------	--------	--------	--	--	---	---	---

## GBTEX + Napthalene by 8260C

Gasoline Range Hydrocarbons	231	5.00	mg/kg	25	B9A1803	JTD	01/18/2019	01/18/2019
Benzene	0.247	0.050	"	"	"	JTD	"	"
Toluene	0.960	0.050	"	"	"	JTD	"	"
Ethylbenzene	0.597	0.050	"	"	"	JTD	"	"
Xylenes, total	6.64	0.050	"	"	"	JTD	"	"
Naphthalene	0.836	0.200	"	"	"	JTD	"	"

Surrogate: 1,2-Dichloroethane-d4	103 %	70-130			"	"	"
Surrogate: Toluene-d8	80.8 %	70-130			"	"	"
Surrogate: 4-Bromofluorobenzene	103 %	70-130			"	"	"

Origins Laboratory, Inc.



The results in this report apply to the samples analyzed in accordance with the chain of custody document. This analytical report must be reproduced in its entirety.

Eagle Environmental Consulting, Inc.  
4101 Inca Street  
Denver CO 80211

Martin C Eckert III  
Project Number: [none]  
Project: Noble - Wells Ranch AE32 Econode

PH-05@10-11'  
1/17/2019 2:24:00PM

Analyte	Result	Reporting Limit	Units	Dilution	Batch	Analyst	Prepared	Analyzed	Notes
---------	--------	-----------------	-------	----------	-------	---------	----------	----------	-------

Origins Laboratory, Inc.  
Y901219-09 (Soil)

## Diesel Range Organics (DRO/TEPH) by EPA 8015C

Diesel (C10-C28)	60.5	50.0	mg/kg	1	B9A1804	JTD	01/18/2019	01/18/2019
------------------	------	------	-------	---	---------	-----	------------	------------

Surrogate: o-Terphenyl	87.9 %	59-131			"	"	"
------------------------	--------	--------	--	--	---	---	---

## GBTEX + Napthalene by 8260C

Gasoline Range Hydrocarbons	39.5	5.00	mg/kg	25	B9A1803	JTD	01/18/2019	01/18/2019	
Benzene	ND	0.050	"	"	"	JTD	"	"	U
Toluene	ND	0.050	"	"	"	JTD	"	"	U
Ethylbenzene	0.054	0.050	"	"	"	JTD	"	"	
Xylenes, total	0.210	0.050	"	"	"	JTD	"	"	
Napthalene	0.363	0.200	"	"	"	JTD	"	"	

Surrogate: 1,2-Dichloroethane-d4	108 %	70-130			"	"	"
Surrogate: Toluene-d8	93.8 %	70-130			"	"	"
Surrogate: 4-Bromofluorobenzene	98.7 %	70-130			"	"	"

Origins Laboratory, Inc.



The results in this report apply to the samples analyzed in accordance with the chain of custody document. This analytical report must be reproduced in its entirety.

Eagle Environmental Consulting, Inc.  
4101 Inca Street  
Denver CO 80211

Martin C Eckert III  
Project Number: [none]  
Project: Noble - Wells Ranch AE32 Econode

PH-05@12-13'  
1/17/2019 2:26:00PM

Analyte	Result	Limit	Units	Dilution	Batch	Analyst	Prepared	Analyzed	Notes
---------	--------	-------	-------	----------	-------	---------	----------	----------	-------

Origins Laboratory, Inc.  
Y901219-10 (Soil)

## Diesel Range Organics (DRO/TEPH) by EPA 8015C

Diesel (C10-C28)	ND	50.0	mg/kg	1	B9A1804	JTD	01/18/2019	01/18/2019	U
------------------	----	------	-------	---	---------	-----	------------	------------	---

Surrogate: o-Terphenyl	82.9 %	59-131			"	"	"		
------------------------	--------	--------	--	--	---	---	---	--	--

## GBTEX + Napthalene by 8260C

Gasoline Range Hydrocarbons	0.290	0.200	mg/kg	1	B9A1803	JTD	01/18/2019	01/18/2019	
Benzene	0.025	0.002	"	"	"	JTD	"	"	
Toluene	ND	0.002	"	"	"	JTD	"	"	U
Ethylbenzene	ND	0.002	"	"	"	JTD	"	"	U
Xylenes, total	ND	0.002	"	"	"	JTD	"	"	U
Naphthalene	ND	0.008	"	"	"	JTD	"	"	U

Surrogate: 1,2-Dichloroethane-d4	89.5 %	70-130			"	"	"		
Surrogate: Toluene-d8	104 %	70-130			"	"	"		
Surrogate: 4-Bromofluorobenzene	105 %	70-130			"	"	"		

Origins Laboratory, Inc.



The results in this report apply to the samples analyzed in accordance with the chain of custody document. This analytical report must be reproduced in its entirety.



Eagle Environmental Consulting, Inc.  
4101 Inca Street  
Denver CO 80211

Martin C Eckert III  
Project Number: [none]  
Project: Noble - Wells Ranch AE32 Econode

PH-06@8-9'

1/17/2019 1:54:00PM

Analyte	Result	Reporting Limit	Units	Dilution	Batch	Analyst	Prepared	Analyzed	Notes
---------	--------	-----------------	-------	----------	-------	---------	----------	----------	-------

Origins Laboratory, Inc.  
Y901219-11 (Soil)

## Diesel Range Organics (DRO/TEPH) by EPA 8015C

Diesel (C10-C28)	833	50.0	mg/kg	1	B9A1804	JTD	01/18/2019	01/18/2019
------------------	-----	------	-------	---	---------	-----	------------	------------

Surrogate: o-Terphenyl	105 %	59-131			"	"	"
------------------------	-------	--------	--	--	---	---	---

## GBTEX + Napthalene by 8260C

Gasoline Range Hydrocarbons	415	5.00	mg/kg	25	B9A1803	JTD	01/18/2019	01/20/2019
Benzene	0.108	0.050	"	"	"	JTD	"	"
Toluene	0.278	0.050	"	"	"	JTD	"	"
Ethylbenzene	0.056	0.050	"	"	"	JTD	"	"
Xylenes, total	1.52	0.050	"	"	"	JTD	"	"
Naphthalene	0.442	0.200	"	"	"	JTD	"	"

Surrogate: 1,2-Dichloroethane-d4	83.8 %	70-130			"	"	"
Surrogate: Toluene-d8	97.8 %	70-130			"	"	"
Surrogate: 4-Bromofluorobenzene	113 %	70-130			"	"	"

Origins Laboratory, Inc.



The results in this report apply to the samples analyzed in accordance with the chain of custody document. This analytical report must be reproduced in its entirety.

Eagle Environmental Consulting, Inc.  
4101 Inca Street  
Denver CO 80211

Martin C Eckert III  
Project Number: [none]  
Project: Noble - Wells Ranch AE32 Econode

PH-06@9-10'  
1/17/2019 1:56:00PM

Analyte	Result	Reporting Limit	Units	Dilution	Batch	Analyst	Prepared	Analyzed	Notes
---------	--------	-----------------	-------	----------	-------	---------	----------	----------	-------

Origins Laboratory, Inc.  
Y901219-12 (Soil)

## Diesel Range Organics (DRO/TEPH) by EPA 8015C

Diesel (C10-C28)	ND	50.0	mg/kg	1	B9A1804	JTD	01/18/2019	01/18/2019	U
------------------	----	------	-------	---	---------	-----	------------	------------	---

Surrogate: o-Terphenyl	77.7 %	59-131			"	"	"		
------------------------	--------	--------	--	--	---	---	---	--	--

## GBTEX + Napthalene by 8260C

Gasoline Range Hydrocarbons	22.0	5.00	mg/kg	25	B9A1803	JTD	01/18/2019	01/21/2019	
Benzene	ND	0.050	"	"	"	JTD	"	"	U
Toluene	ND	0.050	"	"	"	JTD	"	"	U
Ethylbenzene	ND	0.050	"	"	"	JTD	"	"	U
Xylenes, total	ND	0.050	"	"	"	JTD	"	"	U
Napthalene	ND	0.200	"	"	"	JTD	"	"	U

Surrogate: 1,2-Dichloroethane-d4	83.0 %	70-130			"	"	"		
Surrogate: Toluene-d8	99.1 %	70-130			"	"	"		
Surrogate: 4-Bromofluorobenzene	94.7 %	70-130			"	"	"		

Origins Laboratory, Inc.



The results in this report apply to the samples analyzed in accordance with the chain of custody document. This analytical report must be reproduced in its entirety.

Eagle Environmental Consulting, Inc.  
4101 Inca Street  
Denver CO 80211

Martin C Eckert III  
Project Number: [none]  
Project: Noble - Wells Ranch AE32 Econode

PH-07@12-13'  
1/17/2019 1:24:00PM

Analyte	Result	Reporting Limit	Units	Dilution	Batch	Analyst	Prepared	Analyzed	Notes
---------	--------	-----------------	-------	----------	-------	---------	----------	----------	-------

**Origins Laboratory, Inc.**  
**Y901219-13 (Soil)**

**Diesel Range Organics (DRO/TEPH) by EPA 8015C**

Diesel (C10-C28)	ND	50.0	mg/kg	1	B9A1804	JTD	01/18/2019	01/18/2019	U
------------------	----	------	-------	---	---------	-----	------------	------------	---

Surrogate: o-Terphenyl	84.9 %	59-131			"	"	"		
------------------------	--------	--------	--	--	---	---	---	--	--

**GBTEX + Napthalene by 8260C**

Gasoline Range Hydrocarbons	0.354	0.200	mg/kg	1	B9A1803	JTD	01/18/2019	01/21/2019	
Benzene	ND	0.002	"	"	"	JTD	"	"	U
Toluene	ND	0.002	"	"	"	JTD	"	"	U
Ethylbenzene	ND	0.002	"	"	"	JTD	"	"	U
Xylenes, total	ND	0.002	"	"	"	JTD	"	"	U
Napthalene	ND	0.008	"	"	"	JTD	"	"	U

Surrogate: 1,2-Dichloroethane-d4	88.0 %	70-130			"	"	"		
Surrogate: Toluene-d8	97.3 %	70-130			"	"	"		
Surrogate: 4-Bromofluorobenzene	95.9 %	70-130			"	"	"		

Origins Laboratory, Inc.



The results in this report apply to the samples analyzed in accordance with the chain of custody document. This analytical report must be reproduced in its entirety.

Eagle Environmental Consulting, Inc.  
4101 Inca Street  
Denver CO 80211

Martin C Eckert III  
Project Number: [none]  
Project: Noble - Wells Ranch AE32 Econode

PH-07@14-15'  
1/17/2019 1:31:00PM

Analyte	Result	Reporting Limit	Units	Dilution	Batch	Analyst	Prepared	Analyzed	Notes
---------	--------	-----------------	-------	----------	-------	---------	----------	----------	-------

**Origins Laboratory, Inc.**  
**Y901219-14 (Soil)**

**Diesel Range Organics (DRO/TEPH) by EPA 8015C**

Diesel (C10-C28)	ND	50.0	mg/kg	1	B9A1804	JTD	01/18/2019	01/18/2019	U
------------------	----	------	-------	---	---------	-----	------------	------------	---

Surrogate: o-Terphenyl	81.9 %	59-131			"	"	"		
------------------------	--------	--------	--	--	---	---	---	--	--

**GBTEX + Napthalene by 8260C**

Gasoline Range Hydrocarbons	0.237	0.200	mg/kg	1	B9A1803	JTD	01/18/2019	01/21/2019	
Benzene	ND	0.002	"	"	"	JTD	"	"	U
Toluene	ND	0.002	"	"	"	JTD	"	"	U
Ethylbenzene	ND	0.002	"	"	"	JTD	"	"	U
Xylenes, total	ND	0.002	"	"	"	JTD	"	"	U
Napthalene	ND	0.008	"	"	"	JTD	"	"	U

Surrogate: 1,2-Dichloroethane-d4	90.5 %	70-130			"	"	"		
Surrogate: Toluene-d8	97.2 %	70-130			"	"	"		
Surrogate: 4-Bromofluorobenzene	95.1 %	70-130			"	"	"		

Origins Laboratory, Inc.



The results in this report apply to the samples analyzed in accordance with the chain of custody document. This analytical report must be reproduced in its entirety.

Eagle Environmental Consulting, Inc.  
4101 Inca Street  
Denver CO 80211

Martin C Eckert III  
Project Number: [none]  
Project: Noble - Wells Ranch AE32 Econode

PH-08@12-13'  
1/17/2019 1:00:00PM

Analyte	Result	Reporting Limit	Units	Dilution	Batch	Analyst	Prepared	Analyzed	Notes
---------	--------	-----------------	-------	----------	-------	---------	----------	----------	-------

Origins Laboratory, Inc.  
Y901219-15 (Soil)

## Diesel Range Organics (DRO/TEPH) by EPA 8015C

Diesel (C10-C28)	ND	50.0	mg/kg	1	B9A1804	JTD	01/18/2019	01/18/2019	U
------------------	----	------	-------	---	---------	-----	------------	------------	---

Surrogate: o-Terphenyl	87.5 %	59-131			"	"	"		
------------------------	--------	--------	--	--	---	---	---	--	--

## GBTEX + Napthalene by 8260C

Gasoline Range Hydrocarbons	0.216	0.200	mg/kg	1	B9A1803	JTD	01/18/2019	01/21/2019	
Benzene	ND	0.002	"	"	"	JTD	"	"	U
Toluene	ND	0.002	"	"	"	JTD	"	"	U
Ethylbenzene	ND	0.002	"	"	"	JTD	"	"	U
Xylenes, total	ND	0.002	"	"	"	JTD	"	"	U
Napthalene	ND	0.008	"	"	"	JTD	"	"	U

Surrogate: 1,2-Dichloroethane-d4	90.6 %	70-130			"	"	"		
Surrogate: Toluene-d8	97.9 %	70-130			"	"	"		
Surrogate: 4-Bromofluorobenzene	96.8 %	70-130			"	"	"		

Origins Laboratory, Inc.



The results in this report apply to the samples analyzed in accordance with the chain of custody document. This analytical report must be reproduced in its entirety.

Eagle Environmental Consulting, Inc.  
4101 Inca Street  
Denver CO 80211

Martin C Eckert III  
Project Number: [none]  
Project: Noble - Wells Ranch AE32 Econode

PH-08@14-15'  
1/17/2019 1:02:00PM

Analyte	Result	Reporting Limit	Units	Dilution	Batch	Analyst	Prepared	Analyzed	Notes
---------	--------	-----------------	-------	----------	-------	---------	----------	----------	-------

**Origins Laboratory, Inc.**  
Y901219-16 (Soil)

**Diesel Range Organics (DRO/TEPH) by EPA 8015C**

Diesel (C10-C28)	ND	50.0	mg/kg	1	B9A1804	JTD	01/18/2019	01/18/2019	U
------------------	----	------	-------	---	---------	-----	------------	------------	---

Surrogate: o-Terphenyl	81.8 %	59-131			"	"	"		
------------------------	--------	--------	--	--	---	---	---	--	--

**GBTEX + Napthalene by 8260C**

Gasoline Range Hydrocarbons	0.212	0.200	mg/kg	1	B9A1803	JTD	01/18/2019	01/21/2019	
Benzene	ND	0.002	"	"	"	JTD	"	"	U
Toluene	ND	0.002	"	"	"	JTD	"	"	U
Ethylbenzene	ND	0.002	"	"	"	JTD	"	"	U
Xylenes, total	ND	0.002	"	"	"	JTD	"	"	U
Napthalene	ND	0.008	"	"	"	JTD	"	"	U

Surrogate: 1,2-Dichloroethane-d4	89.5 %	70-130			"	"	"		
Surrogate: Toluene-d8	98.0 %	70-130			"	"	"		
Surrogate: 4-Bromofluorobenzene	96.5 %	70-130			"	"	"		

Origins Laboratory, Inc.



The results in this report apply to the samples analyzed in accordance with the chain of custody document. This analytical report must be reproduced in its entirety.

Eagle Environmental Consulting, Inc.

4101 Inca Street

Denver CO 80211

Martin C Eckert III

Project Number: [none]

Project: Noble - Wells Ranch AE32 Econode

**Volatile Organic Compounds by GC/MS SW846 8260C - Quality Control**  
**Origins Laboratory, Inc.**

Analyte	Result	Reporting Limit	Units	Spike Level	Source Result	%REC	%REC Limits	RPD	RPD Limit	Notes
<b>Batch B9A1803 - EPA 5030 (soil)</b>										
<b>Blank (B9A1803-BLK1)</b>					Prepared: 01/18/2019 Analyzed: 01/18/2019					
Gasoline Range Hydrocarbons	ND	0.200	mg/kg							U
Benzene	ND	0.002	"							U
Toluene	ND	0.002	"							U
Ethylbenzene	ND	0.002	"							U
Xylenes, total	ND	0.002	"							U
Naphthalene	ND	0.008	"							U
Surrogate: 1,2-Dichloroethane-d4	0.14		"	0.125		113	70-130			
Surrogate: Toluene-d8	0.12		"	0.125		96.0	70-130			
Surrogate: 4-Bromofluorobenzene	0.12		"	0.125		98.3	70-130			

Origins Laboratory, Inc.



The results in this report apply to the samples analyzed in accordance with the chain of custody document. This analytical report must be reproduced in its entirety.

Eagle Environmental Consulting, Inc.  
4101 Inca Street  
Denver CO 80211

Martin C Eckert III  
Project Number: [none]  
Project: Noble - Wells Ranch AE32 Econode

## Volatile Organic Compounds by GC/MS SW846 8260C - Quality Control

### Origins Laboratory, Inc.

Analyte	Result	Reporting Limit	Units	Spike Level	Source Result	%REC	%REC Limits	RPD	RPD Limit	Notes
Batch B9A1803 - EPA 5030 (soil)										
Blank (B9A1803-BLK2)					Prepared: 01/18/2019 Analyzed: 01/18/2019					
Gasoline Range Hydrocarbons	ND	0.200	mg/kg							U
Benzene	ND	0.002	"							U
Toluene	ND	0.002	"							U
Ethylbenzene	ND	0.002	"							U
Xylenes, total	ND	0.002	"							U
Naphthalene	ND	0.008	"							U
Surrogate: 1,2-Dichloroethane-d4	0.12		"	0.125		95.2	70-130			
Surrogate: Toluene-d8	0.12		"	0.125		99.3	70-130			
Surrogate: 4-Bromofluorobenzene	0.12		"	0.125		97.6	70-130			

Origins Laboratory, Inc.



The results in this report apply to the samples analyzed in accordance with the chain of custody document. This analytical report must be reproduced in its entirety.



Eagle Environmental Consulting, Inc.  
4101 Inca Street  
Denver CO 80211

Martin C Eckert III  
Project Number: [none]  
Project: Noble - Wells Ranch AE32 Econode

**Volatile Organic Compounds by GC/MS SW846 8260C - Quality Control**  
**Origins Laboratory, Inc.**

Analyte	Result	Reporting Limit	Units	Spike Level	Source Result	%REC	%REC Limits	RPD	RPD Limit	Notes
<b>Batch B9A1803 - EPA 5030 (soil)</b>										
<b>Blank (B9A1803-BLK3)</b>					Prepared: 01/18/2019 Analyzed: 01/18/2019					
Gasoline Range Hydrocarbons	ND	0.200	mg/kg							U
Benzene	ND	0.002	"							U
Toluene	ND	0.002	"							U
Ethylbenzene	ND	0.002	"							U
Xylenes, total	ND	0.002	"							U
Naphthalene	ND	0.008	"							U
Surrogate: 1,2-Dichloroethane-d4	0.14		"	0.125		108	70-130			
Surrogate: Toluene-d8	0.12		"	0.125		97.5	70-130			
Surrogate: 4-Bromofluorobenzene	0.12		"	0.125		99.3	70-130			

Origins Laboratory, Inc.



The results in this report apply to the samples analyzed in accordance with the chain of custody document. This analytical report must be reproduced in its entirety.

Eagle Environmental Consulting, Inc.  
4101 Inca Street  
Denver CO 80211

Martin C Eckert III  
Project Number: [none]  
Project: Noble - Wells Ranch AE32 Econode

**Volatile Organic Compounds by GC/MS SW846 8260C - Quality Control**  
**Origins Laboratory, Inc.**

Analyte	Result	Reporting Limit	Units	Spike Level	Source Result	%REC	%REC Limits	RPD	RPD Limit	Notes
<b>Batch B9A1803 - EPA 5030 (soil)</b>										
<b>LCS (B9A1803-BS1)</b>					Prepared: 01/18/2019 Analyzed: 01/18/2019					
Benzene	0.108	0.002	mg/kg	0.100		108	70-130			
Toluene	0.102	0.002	"	0.100		102	70-130			
Ethylbenzene	0.094	0.002	"	0.100		94.3	70-130			
m,p-Xylene	0.197	0.004	"	0.200		98.4	70-130			
o-Xylene	0.097	0.002	"	0.100		96.7	70-130			
Naphthalene	0.112	0.008	"	0.100		112	70-130			
Surrogate: 1,2-Dichloroethane-d4	0.14		"	0.125		110	70-130			
Surrogate: Toluene-d8	0.12		"	0.125		94.9	70-130			
Surrogate: 4-Bromofluorobenzene	0.12		"	0.125		96.2	70-130			

Origins Laboratory, Inc.



*The results in this report apply to the samples analyzed in accordance with the chain of custody document. This analytical report must be reproduced in its entirety.*

Eagle Environmental Consulting, Inc.

4101 Inca Street

Denver CO 80211

Martin C Eckert III

Project Number: [none]

Project: Noble - Wells Ranch AE32 Econode

**Volatile Organic Compounds by GC/MS SW846 8260C - Quality Control**  
**Origins Laboratory, Inc.**

Analyte	Result	Reporting Limit	Units	Spike Level	Source Result	%REC	%REC Limits	RPD	RPD Limit	Notes
<b>Batch B9A1803 - EPA 5030 (soil)</b>										
<b>LCS (B9A1803-BS2)</b>					Prepared: 01/18/2019 Analyzed: 01/18/2019					
Benzene	0.109	0.002	mg/kg	0.100		109	70-130			
Toluene	0.110	0.002	"	0.100		110	70-130			
Ethylbenzene	0.114	0.002	"	0.100		114	70-130			
m,p-Xylene	0.229	0.004	"	0.200		115	70-130			
o-Xylene	0.115	0.002	"	0.100		115	70-130			
Naphthalene	0.096	0.008	"	0.100		95.8	70-130			
Surrogate: 1,2-Dichloroethane-d4	0.12		"	0.125		93.2	70-130			
Surrogate: Toluene-d8	0.12		"	0.125		99.5	70-130			
Surrogate: 4-Bromofluorobenzene	0.13		"	0.125		100	70-130			

Origins Laboratory, Inc.



*The results in this report apply to the samples analyzed in accordance with the chain of custody document. This analytical report must be reproduced in its entirety.*

Eagle Environmental Consulting, Inc.

4101 Inca Street

Denver CO 80211

Martin C Eckert III

Project Number: [none]

Project: Noble - Wells Ranch AE32 Econode

## Volatile Organic Compounds by GC/MS SW846 8260C - Quality Control

### Origins Laboratory, Inc.

Analyte	Result	Reporting Limit	Units	Spike Level	Source Result	%REC	%REC Limits	RPD	RPD Limit	Notes
Batch B9A1803 - EPA 5030 (soil)										
LCS (B9A1803-BS3)					Prepared: 01/18/2019 Analyzed: 01/18/2019					
Benzene	0.118	0.002	mg/kg	0.100		118	70-130			
Toluene	0.117	0.002	"	0.100		117	70-130			
Ethylbenzene	0.110	0.002	"	0.100		110	70-130			
m,p-Xylene	0.229	0.004	"	0.200		115	70-130			
o-Xylene	0.112	0.002	"	0.100		112	70-130			
Naphthalene	0.119	0.008	"	0.100		119	70-130			
Surrogate: 1,2-Dichloroethane-d4	0.13		"	0.125		105	70-130			
Surrogate: Toluene-d8	0.12		"	0.125		95.2	70-130			
Surrogate: 4-Bromofluorobenzene	0.12		"	0.125		96.3	70-130			

Origins Laboratory, Inc.



The results in this report apply to the samples analyzed in accordance with the chain of custody document. This analytical report must be reproduced in its entirety.

Eagle Environmental Consulting, Inc.  
4101 Inca Street  
Denver CO 80211

Martin C Eckert III  
Project Number: [none]  
Project: Noble - Wells Ranch AE32 Econode

**Volatile Organic Compounds by GC/MS SW846 8260C - Quality Control**  
**Origins Laboratory, Inc.**

Analyte	Result	Reporting Limit	Units	Spike Level	Source Result	%REC	%REC Limits	RPD	RPD Limit	Notes
<b>Batch B9A1803 - EPA 5030 (soil)</b>										
<b>Matrix Spike (B9A1803-MS1)</b>		<b>Source: Y901210-01</b>			Prepared: 01/18/2019 Analyzed: 01/18/2019					
Benzene	0.107	0.002	mg/kg	0.100	0.0009	106	70-130			
Toluene	0.103	0.002	"	0.100	ND	103	70-130			
Ethylbenzene	0.098	0.002	"	0.100	ND	98.1	70-130			
m,p-Xylene	0.203	0.004	"	0.200	ND	101	70-130			
o-Xylene	0.100	0.002	"	0.100	0.0004	99.4	70-130			
Naphthalene	0.105	0.008	"	0.100	0.009	96.4	70-130			
Surrogate: 1,2-Dichloroethane-d4	0.13		"	0.125		107	70-130			
Surrogate: Toluene-d8	0.12		"	0.125		96.2	70-130			
Surrogate: 4-Bromofluorobenzene	0.12		"	0.125		98.3	70-130			

Origins Laboratory, Inc.



The results in this report apply to the samples analyzed in accordance with the chain of custody document. This analytical report must be reproduced in its entirety.

Eagle Environmental Consulting, Inc.  
4101 Inca Street  
Denver CO 80211

Martin C Eckert III  
Project Number: [none]  
Project: Noble - Wells Ranch AE32 Econode

## Volatile Organic Compounds by GC/MS SW846 8260C - Quality Control

### Origins Laboratory, Inc.

Analyte	Result	Reporting Limit	Units	Spike Level	Source Result	%REC	%REC Limits	RPD	RPD Limit	Notes
Batch B9A1803 - EPA 5030 (soil)										
<b>Matrix Spike (B9A1803-MS2)</b>		<b>Source: Y901223-01</b>			Prepared: 01/18/2019 Analyzed: 01/18/2019					
Benzene	0.092	0.002	mg/kg	0.100	ND	92.5	70-130			
Toluene	0.092	0.002	"	0.100	ND	91.6	70-130			
Ethylbenzene	0.096	0.002	"	0.100	ND	95.7	70-130			
m,p-Xylene	0.195	0.004	"	0.200	0.0009	97.4	70-130			
o-Xylene	0.099	0.002	"	0.100	0.0004	98.5	70-130			
Naphthalene	0.096	0.008	"	0.100	0.009	86.7	70-130			
Surrogate: 1,2-Dichloroethane-d4	0.12		"	0.125		99.1	70-130			
Surrogate: Toluene-d8	0.12		"	0.125		98.2	70-130			
Surrogate: 4-Bromofluorobenzene	0.13		"	0.125		104	70-130			

Origins Laboratory, Inc.



The results in this report apply to the samples analyzed in accordance with the chain of custody document. This analytical report must be reproduced in its entirety.

Eagle Environmental Consulting, Inc.  
4101 Inca Street  
Denver CO 80211

Martin C Eckert III  
Project Number: [none]  
Project: Noble - Wells Ranch AE32 Econode

**Volatile Organic Compounds by GC/MS SW846 8260C - Quality Control**  
**Origins Laboratory, Inc.**

Analyte	Result	Reporting Limit	Units	Spike Level	Source Result	%REC	%REC Limits	RPD	RPD Limit	Notes
---------	--------	-----------------	-------	-------------	---------------	------	-------------	-----	-----------	-------

Batch B9A1803 - EPA 5030 (soil)

Matrix Spike (B9A1803-MS3)		Source: Y901220-04			Prepared: 01/18/2019 Analyzed: 01/18/2019					
Benzene	0.112	0.002	mg/kg	0.100	ND	112	70-130			
Toluene	0.110	0.002	"	0.100	ND	110	70-130			
Ethylbenzene	0.104	0.002	"	0.100	ND	104	70-130			
m,p-Xylene	0.215	0.004	"	0.200	ND	108	70-130			
o-Xylene	0.106	0.002	"	0.100	ND	106	70-130			
Naphthalene	0.104	0.008	"	0.100	ND	104	70-130			
Surrogate: 1,2-Dichloroethane-d4	0.13		"	0.125		105	70-130			
Surrogate: Toluene-d8	0.12		"	0.125		96.4	70-130			
Surrogate: 4-Bromofluorobenzene	0.12		"	0.125		97.7	70-130			

Origins Laboratory, Inc.



The results in this report apply to the samples analyzed in accordance with the chain of custody document. This analytical report must be reproduced in its entirety.

Jen Pellegrini For Noelle Doyle Mathis, President

Eagle Environmental Consulting, Inc.

4101 Inca Street

Denver CO 80211

Martin C Eckert III

Project Number: [none]

Project: Noble - Wells Ranch AE32 Econode

## Volatile Organic Compounds by GC/MS SW846 8260C - Quality Control

### Origins Laboratory, Inc.

Analyte	Result	Reporting Limit	Units	Spike Level	Source Result	%REC	%REC Limits	RPD	RPD Limit	Notes
---------	--------	-----------------	-------	-------------	---------------	------	-------------	-----	-----------	-------

#### Batch B9A1803 - EPA 5030 (soil)

Matrix Spike Dup (B9A1803-MSD1)		Source: Y901210-01			Prepared: 01/18/2019 Analyzed: 01/18/2019					
Benzene	0.116	0.002	mg/kg	0.100	0.0009	115	70-130	8.23	20	
Toluene	0.116	0.002	"	0.100	ND	116	70-130	11.6	20	
Ethylbenzene	0.115	0.002	"	0.100	ND	115	70-130	15.9	20	
m,p-Xylene	0.236	0.004	"	0.200	ND	118	70-130	15.2	20	
o-Xylene	0.114	0.002	"	0.100	0.0004	114	70-130	13.6	20	
Naphthalene	0.104	0.008	"	0.100	0.009	95.5	70-130	0.860	20	
Surrogate: 1,2-Dichloroethane-d4	0.12		"	0.125		98.8	70-130			
Surrogate: Toluene-d8	0.12		"	0.125		98.1	70-130			
Surrogate: 4-Bromofluorobenzene	0.13		"	0.125		101	70-130			

Origins Laboratory, Inc.



The results in this report apply to the samples analyzed in accordance with the chain of custody document. This analytical report must be reproduced in its entirety.



Eagle Environmental Consulting, Inc.  
4101 Inca Street  
Denver CO 80211

Martin C Eckert III  
Project Number: [none]  
Project: Noble - Wells Ranch AE32 Econode

## Volatile Organic Compounds by GC/MS SW846 8260C - Quality Control

### Origins Laboratory, Inc.

Analyte	Result	Reporting Limit	Units	Spike Level	Source Result	%REC	%REC Limits	RPD	RPD Limit	Notes
---------	--------	-----------------	-------	-------------	---------------	------	-------------	-----	-----------	-------

#### Batch B9A1803 - EPA 5030 (soil)

Matrix Spike Dup (B9A1803-MSD2)		Source: Y901223-01			Prepared: 01/18/2019 Analyzed: 01/18/2019					
Benzene	0.106	0.002	mg/kg	0.100	ND	106	70-130	13.3	20	
Toluene	0.104	0.002	"	0.100	ND	104	70-130	12.5	20	
Ethylbenzene	0.107	0.002	"	0.100	ND	107	70-130	11.2	20	
m,p-Xylene	0.217	0.004	"	0.200	0.0009	109	70-130	10.9	20	
o-Xylene	0.110	0.002	"	0.100	0.0004	110	70-130	10.6	20	
Naphthalene	0.108	0.008	"	0.100	0.009	98.9	70-130	12.0	20	
Surrogate: 1,2-Dichloroethane-d4	0.12		"	0.125		96.6	70-130			
Surrogate: Toluene-d8	0.12		"	0.125		97.2	70-130			
Surrogate: 4-Bromofluorobenzene	0.13		"	0.125		102	70-130			

Origins Laboratory, Inc.



The results in this report apply to the samples analyzed in accordance with the chain of custody document. This analytical report must be reproduced in its entirety.

Eagle Environmental Consulting, Inc.  
4101 Inca Street  
Denver CO 80211

Martin C Eckert III  
Project Number: [none]  
Project: Noble - Wells Ranch AE32 Econode

## Volatile Organic Compounds by GC/MS SW846 8260C - Quality Control

### Origins Laboratory, Inc.

Analyte	Result	Reporting Limit	Units	Spike Level	Source Result	%REC	%REC Limits	RPD	RPD Limit	Notes
Batch B9A1803 - EPA 5030 (soil)										
Matrix Spike Dup (B9A1803-MSD3)			Source: Y901220-04		Prepared: 01/18/2019 Analyzed: 01/18/2019					
Benzene	0.109	0.002	mg/kg	0.100	ND	109	70-130	2.05	20	
Toluene	0.114	0.002	"	0.100	ND	114	70-130	3.42	20	
Ethylbenzene	0.118	0.002	"	0.100	ND	118	70-130	12.6	20	
m,p-Xylene	0.244	0.004	"	0.200	ND	122	70-130	12.7	20	
o-Xylene	0.116	0.002	"	0.100	ND	116	70-130	9.47	20	
Naphthalene	0.080	0.008	"	0.100	ND	80.4	70-130	25.6	20	QR-02
Surrogate: 1,2-Dichloroethane-d4	0.11		"	0.125		87.3	70-130			
Surrogate: Toluene-d8	0.13		"	0.125		101	70-130			
Surrogate: 4-Bromofluorobenzene	0.13		"	0.125		103	70-130			

Origins Laboratory, Inc.



The results in this report apply to the samples analyzed in accordance with the chain of custody document. This analytical report must be reproduced in its entirety.

Eagle Environmental Consulting, Inc.  
4101 Inca Street  
Denver CO 80211

Martin C Eckert III  
Project Number: [none]  
Project: Noble - Wells Ranch AE32 Econode

## Volatile Organic Compounds by GC/MS SW846 8260C - Quality Control

### Origins Laboratory, Inc.

Analyte	Result	Reporting Limit	Units	Spike Level	Source Result	%REC	%REC Limits	RPD	RPD Limit	Notes
---------	--------	-----------------	-------	-------------	---------------	------	-------------	-----	-----------	-------

## Extractable Petroleum Hydrocarbons by 8015C - Quality Control

### Origins Laboratory, Inc.

Analyte	Result	Reporting Limit	Units	Spike Level	Source Result	%REC	%REC Limits	RPD	RPD Limit	Notes
---------	--------	-----------------	-------	-------------	---------------	------	-------------	-----	-----------	-------

#### Batch B9A1804 - EPA 3550B

<b>Blank (B9A1804-BLK1)</b>				Prepared: 01/18/2019 Analyzed: 01/18/2019						
Diesel (C10-C28)	ND	50.0	mg/kg							U
Surrogate: o-Terphenyl	38		"	50.0		75.3	59-131			
<b>Blank (B9A1804-BLK2)</b>				Prepared: 01/18/2019 Analyzed: 01/18/2019						
Diesel (C10-C28)	ND	50.0	mg/kg							U
Surrogate: o-Terphenyl	42		"	50.0		84.7	59-131			
<b>Blank (B9A1804-BLK3)</b>				Prepared: 01/18/2019 Analyzed: 01/18/2019						
Diesel (C10-C28)	ND	50.0	mg/kg							U
Surrogate: o-Terphenyl	40		"	50.0		79.4	59-131			
<b>LCS (B9A1804-BS1)</b>				Prepared: 01/18/2019 Analyzed: 01/18/2019						
Diesel (C10-C28)	983	50.0	mg/kg	1000		98.3	64-121			
Surrogate: o-Terphenyl	50		"	50.0		99.6	59-131			
<b>LCS (B9A1804-BS2)</b>				Prepared: 01/18/2019 Analyzed: 01/18/2019						
Diesel (C10-C28)	877	50.0	mg/kg	1000		87.7	64-121			
Surrogate: o-Terphenyl	44		"	50.0		88.3	59-131			
<b>LCS (B9A1804-BS3)</b>				Prepared: 01/18/2019 Analyzed: 01/18/2019						
Diesel (C10-C28)	914	50.0	mg/kg	1000		91.4	64-121			
Surrogate: o-Terphenyl	45		"	50.0		90.4	59-131			

Origins Laboratory, Inc.



The results in this report apply to the samples analyzed in accordance with the chain of custody document. This analytical report must be reproduced in its entirety.

Eagle Environmental Consulting, Inc.  
4101 Inca Street  
Denver CO 80211

Martin C Eckert III  
Project Number: [none]  
Project: Noble - Wells Ranch AE32 Econode

## Extractable Petroleum Hydrocarbons by 8015C - Quality Control Origins Laboratory, Inc.

Analyte	Result	Reporting Limit	Units	Spike Level	Source Result	%REC	%REC Limits	RPD	RPD Limit	Notes
<b>Batch B9A1804 - EPA 3550B</b>										
<b>Matrix Spike (B9A1804-MS1)</b>		<b>Source: Y901213-01</b>			Prepared: 01/18/2019 Analyzed: 01/18/2019					
Diesel (C10-C28)	1050	50.0	mg/kg	1000	172	87.9	53-125			
Surrogate: o-Terphenyl	45		"	50.0		90.8	59-131			
<b>Matrix Spike (B9A1804-MS2)</b>		<b>Source: Y901223-01</b>			Prepared: 01/18/2019 Analyzed: 01/18/2019					
Diesel (C10-C28)	1030	50.0	mg/kg	1000	ND	103	53-125			
Surrogate: o-Terphenyl	47		"	50.0		94.9	59-131			
<b>Matrix Spike (B9A1804-MS3)</b>		<b>Source: Y901220-04</b>			Prepared: 01/18/2019 Analyzed: 01/18/2019					
Diesel (C10-C28)	1060	50.0	mg/kg	1000	ND	106	53-125			
Surrogate: o-Terphenyl	47		"	50.0		94.0	59-131			
<b>Matrix Spike Dup (B9A1804-MSD1)</b>		<b>Source: Y901213-01</b>			Prepared: 01/18/2019 Analyzed: 01/18/2019					
Diesel (C10-C28)	1080	50.0	mg/kg	1000	172	91.0	53-125	2.85	20	
Surrogate: o-Terphenyl	46		"	50.0		92.5	59-131			
<b>Matrix Spike Dup (B9A1804-MSD2)</b>		<b>Source: Y901223-01</b>			Prepared: 01/18/2019 Analyzed: 01/18/2019					
Diesel (C10-C28)	954	50.0	mg/kg	1000	ND	95.4	53-125	7.93	20	
Surrogate: o-Terphenyl	45		"	50.0		89.3	59-131			
<b>Matrix Spike Dup (B9A1804-MSD3)</b>		<b>Source: Y901220-04</b>			Prepared: 01/18/2019 Analyzed: 01/18/2019					
Diesel (C10-C28)	936	50.0	mg/kg	1000	ND	93.6	53-125	12.5	20	
Surrogate: o-Terphenyl	42		"	50.0		83.2	59-131			

Origins Laboratory, Inc.



The results in this report apply to the samples analyzed in accordance with the chain of custody document. This analytical report must be reproduced in its entirety.

Eagle Environmental Consulting, Inc.

4101 Inca Street

Denver CO 80211

Martin C Eckert III

Project Number: [none]

Project: Noble - Wells Ranch AE32 Econode

## Notes and Definitions

U Sample is Non-Detect.

QR-02 The RPD result exceeded the QC control limits; however, both percent recoveries were acceptable. Sample results for the QC batch were accepted based on percent recoveries and completeness of QC data.

ND Analyte NOT DETECTED at or above the reporting limit

RPD Relative Percent Difference

All soil results are reported at a wet weight basis.

Origins Laboratory, Inc.



*The results in this report apply to the samples analyzed in accordance with the chain of custody document. This analytical report must be reproduced in its entirety.*

Jen Pellegrini For Noelle Doyle Mathis, President