

L:\Engineering\0126003.03 - James Survey\JAMMAS CONSTRUCTION - DRAWINGS\AS-BUILT\0126003.03-ASB.dwg, 1/24/2019 2:29:31 PM, JOSHUA J. MCCABE, LAMP RYNEARSON & ASSOCIATES

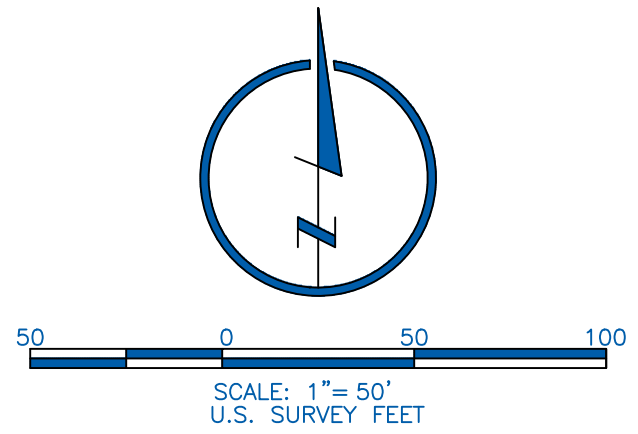
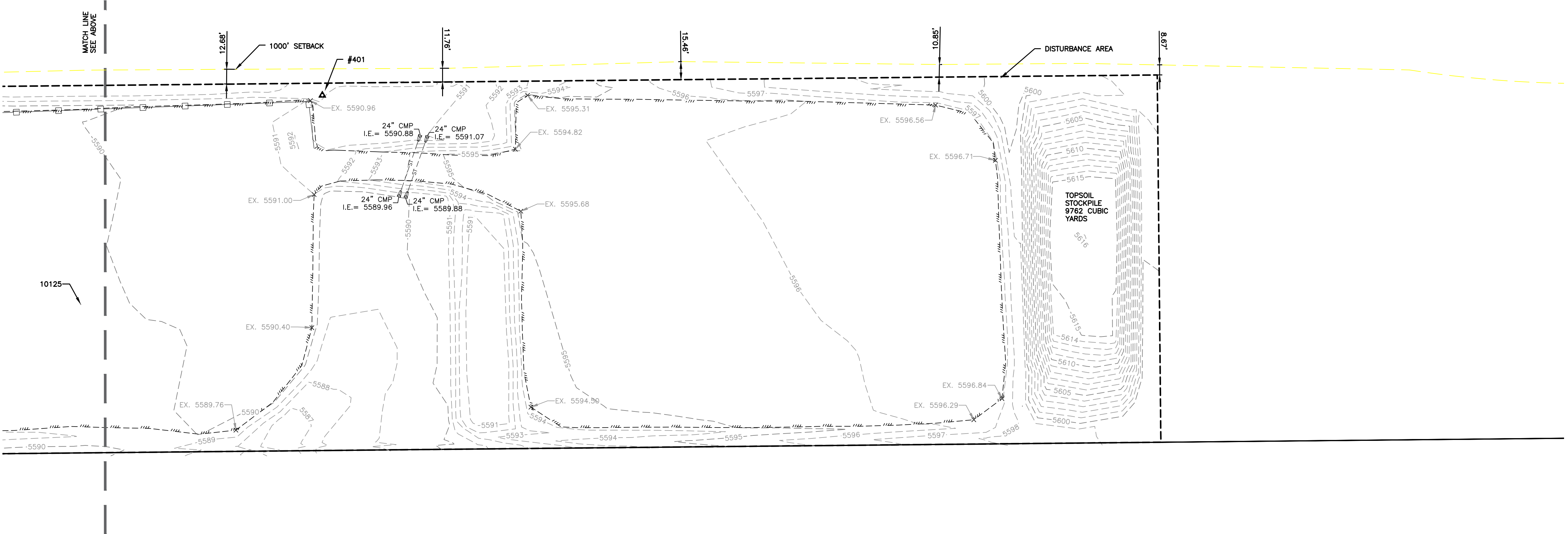
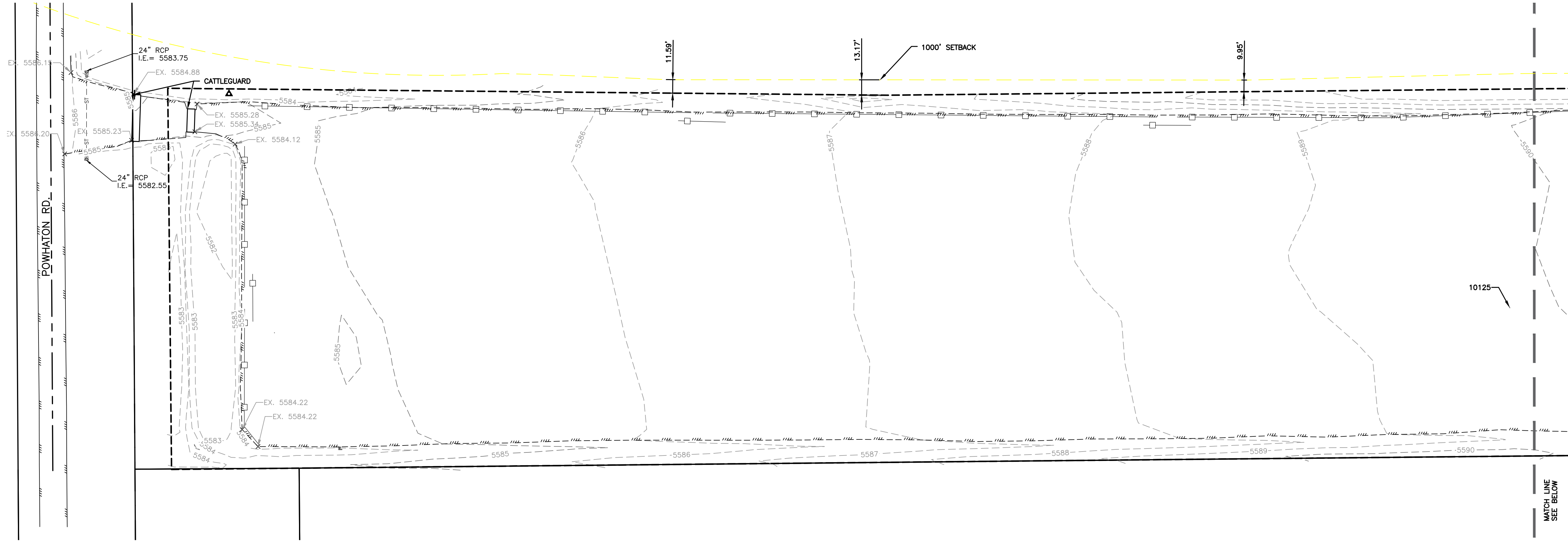

LEGEND

- 1000' SETBACK
- DISTURBANCE AREA (15.12 ACRES)
- EDGE OF GRAVEL
- SOUND WALL
- STORM LINE

HORIZONTAL DATUM

MODIFIED COLORADO STATE PLANE, CENTRAL TO ACHIEVE GRID COORDINATES SCALE BY .999745067 FROM:

E: 1711346.596 N: 3225700.741 LAT: N39.78371521 LON: W104.69691795

SITE CONTROL

#401
N: 1693181.779 E: 3232558.785 ELE: 5591.438
LAT: N39.73369494 LON: W104.67311153 HEIGHT: 5532.671

VERTICAL DATUM

NAVD88

BENCHMARK

CITY OF AURORA BM-21-100

NOTES

PDOP #10125: 1.472
OPERATOR: COREY WESTHOLMES
DATE OF FIELD WORK: 12/18/18

SURVEYOR'S CERTIFICATION

I, JOSHUA J. MCCABE, HEREBY STATE THAT THE ELEVATIONS AND LOCATIONS SHOWN HEREON WERE MADE BY ME OR UNDER MY DIRECT SUPERVISION ON THE DATES SHOWN HEREON, IS IN ACCORDANCE WITH APPLICABLE STANDARDS OF PRACTICE, AND IS NOT A GUARANTY OR WARRANTY, EITHER EXPRESSED OR IMPLIED.



JOSHUA J. MCCABE COLORADO CO PLS 38638
ON BEHALF OF LAMP, RYNEARSON & ASSOCIATES, INC.
EMAIL ADDRESS: JOSHUA.MCCABE@LRA-INC.COM



DRAWN BY JCF	DESIGNED BY JCF	DATE 1/24/19	JOB NUMBER 7486	SHEET 021803.03
REVISIONS				
4715 Innovation Drive 970.226.0342 P Fort Collins, CO 80525 970.226.0879 F www.LRA-Inc.com				
LAMP RYNEARSON & ASSOCIATES				
JAMASO MULTI-WELL PAD SW/4 NW/4 SEC 4 T4S R65W, CITY OF AURORA				
JAMASO AS-BUILT EXHIBIT				
LAMP RYNEARSON - ENGINEERS				
SHEET 1 OF 2				

1000' SETBACK

DISTURBANCE AREA (15.12 ACRES)

EDGE OF GRAVEL

SOUND WALL

STORM LINE

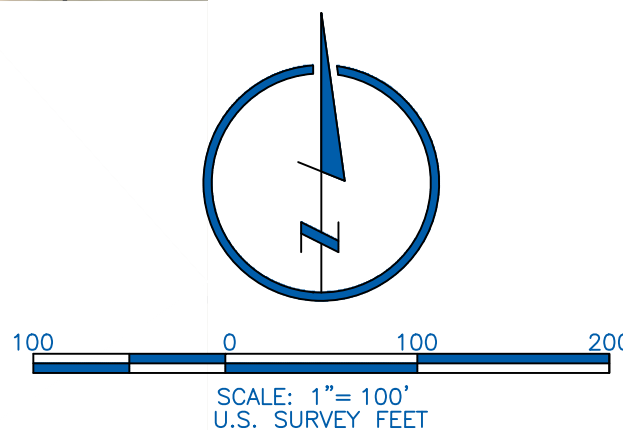

SHEET

2 OF 2

LAMP RYNEARSON - ENGINEERS

JAMASO AS--BUILT EXHIBIT



LAMP RYNEARSON
& ASSOCIATES

4715 Innovation Drive 970.226.0342 | P
Fort Collins, CO 80525 970.226.0879 | F
www.LRA-Inc.com

REVIEWS

DRAWN BY	CPP
DESIGNED BY	GLF
DATE	1/24/19
JOB NUMBER-TASK	0218003.03
BOOK AND PAGE	