



123-25086

RECEIVED

OCT -5 07

COGCC



1675 Broadway Suite 1500  
Denver, CO 80202  
303-534-3223 Fax 303-534-1822



**INTEQ**

**Report  
of  
Sub-Surface  
Directional  
Survey**

**Foundation Energy**  
Company

**Asbury V3-19**  
Well Name

**Weld, CO**  
Location

**5/19/2007**  
Date

**1434936**  
Job Number

**Denver**  
Office



1675 Broadway Suite 1500  
 Denver, CO 80202  
 303-534-3223 Fax 303-534-1822

**INTEQ**

**Survey Certification Sheet**

<u>Foundation Energy</u> Company	<u>1434936</u> Job Number	<u>05/19/07</u> Date
<u>Sec.3-T2N-R67W</u> Lease	<u>Asbury V3-19</u> Well Name	<u>Weld, CO</u> County & State

Surveyed from a measured depth of: 991 feet to 7772 feet

Type of Survey: MWD

Directional Surveyor: Barry Combs

The data and calculations for this survey have been checked by me and conform to the standards and procedures set forth by Baker Hughes INTEQ. This report represents a true and correct Directional Survey of this well based on the original data obtained at the well site. Wellbore Coordinates are calculated using minimum curvature.

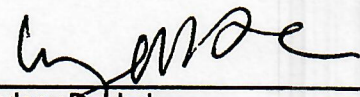
  
 Lindsey Doubek  
 Well Planner

This document has been subscribed and affirmed, or sworn to before me in the county of

Denver, state of Colorado, this 27<sup>th</sup> day of September, 20 07.

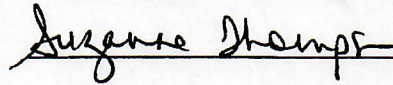
 My commission expires 02/10/2010

Certification Number: 8731  
 Certification Date: 9/27/07

# FOUNDATION ENERGY MANAGEMENT, LLC

Location: COLORADO  
 Field: WELD COUNTY  
 Facility: SEC.3-T2N-R67W  
 Slot: Asbury V3-19  
 Well: Asbury V3-19  
 Wellbore: Asbury V3-19 PWB



RECEIVED  
 OCT -5 07  
 COGCC

INTEQ

Plot reference wellpath is Asbury V3-19 PWB	Grid System: NAD83 / Lambert Colorado State Planes, Northern Zone (501), US feet
True vertical depths are referenced to Ensign 120 (RT)	North Reference: True north
Measured depths are referenced to Ensign 120 (RT)	Scale: True distance
Ensign 120 (RT) to Mean Sea Level: 4912 feet	Depths are in feet
Mean Sea Level to Mud line (Facility - SEC.3-T2N-R67W): 0 feet	Created by: Suzanne Thompson on 6/18/2007
Coordinates are in feet referenced to Slot	

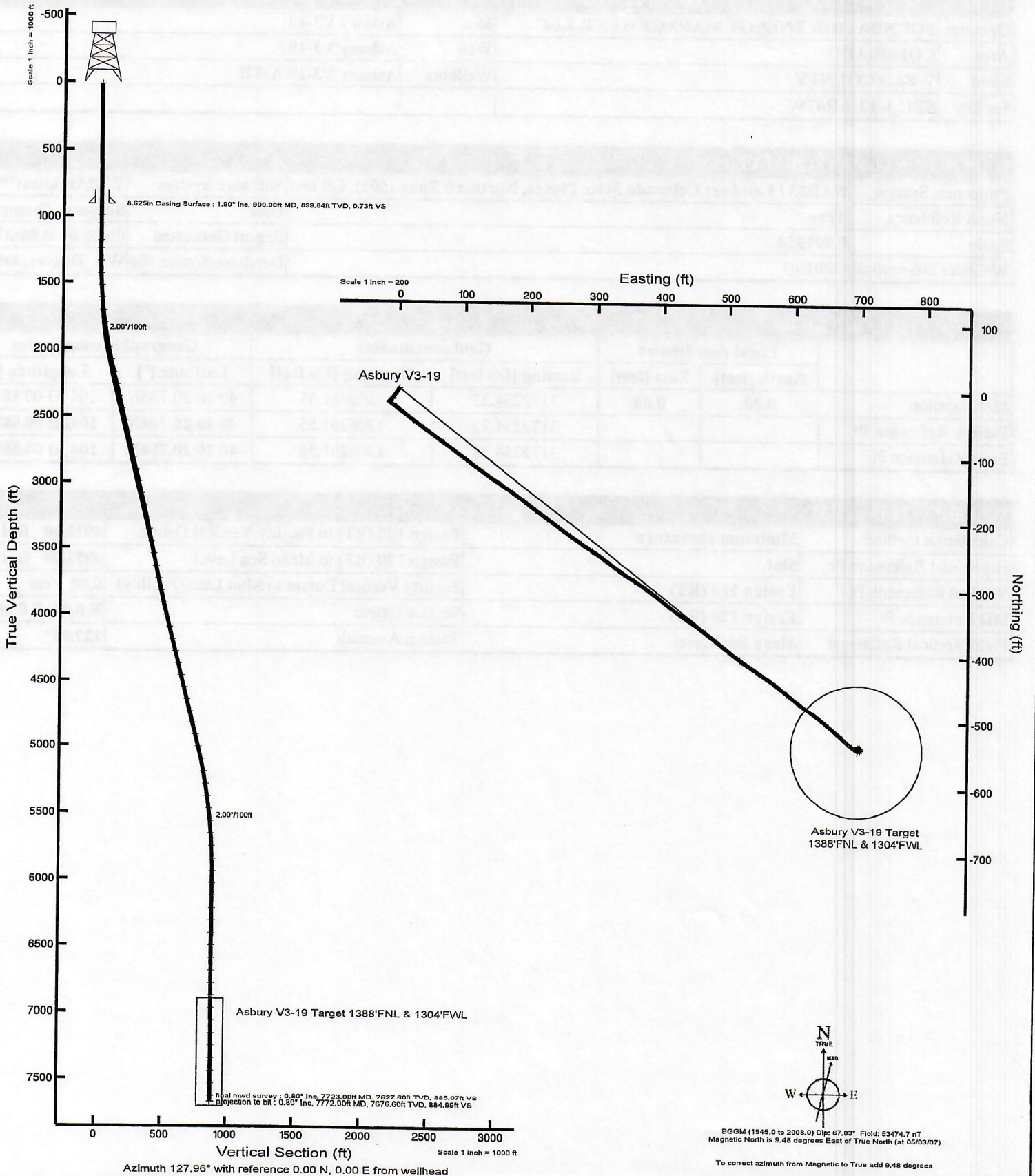

# Actual Wellpath Report

Asbury V3-19 AWP

Page 1 of 4



INTEQ

REFERENCE WELLPATH IDENTIFICATION			
Operator	FOUNDATION ENERGY MANAGEMENT, LLC	Slot	Asbury V3-19
Area	COLORADO	Well	Asbury V3-19
Field	WELD COUNTY	Wellbore	Asbury V3-19 AWB
Facility	SEC.3-T2N-R67W		

REPORT SETUP INFORMATION			
Projection System	NAD83 / Lambert Colorado State Planes, Northern Zone (501), US feet	Software System	WellArchitect™ 1.2
North Reference	True	User	Suzanne Thompson
Scale	0.999958	Report Generated	06/06/07 at 09:37:16
Wellbore last revised	06/01/07	Database/Source file	WA_Denver/Asbury

WELLPATH LOCATION						
	Local coordinates		Grid coordinates		Geographic coordinates	
	North [feet]	East [feet]	Easting [US feet]	Northing [US feet]	Latitude [°]	Longitude [°]
Slot Location	0.00	0.00	3172254.23	1306261.55	40 10 20.784N	104 53 00.888W
Facility Reference Pt			3172254.23	1306261.55	40 10 20.784N	104 53 00.888W
Field Reference Pt			3172254.23	1306261.55	40 10 20.784N	104 53 00.888W

WELLPATH DATUM			
Calculation method	Minimum curvature	Ensign 120 (RT) to Facility Vertical Datum	4912.00 feet
Horizontal Reference Pt	Slot	Ensign 120 (RT) to Mean Sea Level	4912.00 feet
Vertical Reference Pt	Ensign 120 (RT)	Facility Vertical Datum to Mud Line (Facility)	0.00 feet
MD Reference Pt	Ensign 120 (RT)	Section Origin	N 0.00, E 0.00 ft
Field Vertical Reference	Mean Sea Level	Section Azimuth	127.96°

# Actual Wellpath Report

Asbury V3-19 AWP

Page 2 of 4

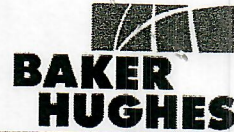

INTEQ

REFERENCE WELLPATH IDENTIFICATION			
Operator	FOUNDATION ENERGY MANAGEMENT, LLC	Slot	Asbury V3-19
Area	COLORADO	Well	Asbury V3-19
Field	WELD COUNTY	Wellbore	Asbury V3-19 AWB
Facility	SEC.3-T2N-R67W		

WELLPATH DATA (76 stations) † = interpolated/extrapolated station							
MD [feet]	Inclination [°]	Azimuth [°]	TVD [feet]	Vert Sect [feet]	North [feet]	East [feet]	DLS [°/100ft]
0.00†	0.000	0.000	0.00	0.00	0.00	0.00	0.00
14.00	0.000	0.000	14.00	0.00	0.00	0.00	0.00
991.00	2.100	215.100	990.78	0.89	-14.65	-10.29	0.21
1054.00	1.900	221.800	1053.74	0.88	-16.37	-11.65	0.49
1178.00	1.100	225.000	1177.70	0.60	-18.74	-13.87	0.65
1240.00	1.100	236.600	1239.69	0.33	-19.49	-14.78	0.36
1334.00	0.600	144.500	1333.68	0.52	-20.39	-15.25	1.35
1428.00	2.100	133.600	1427.65	2.70	-21.98	-13.72	1.61
1522.00	3.200	121.300	1521.55	7.02	-24.53	-10.23	1.31
1616.00	4.400	128.000	1615.34	13.23	-28.11	-5.15	1.36
1710.00	6.100	126.600	1708.95	21.83	-33.31	1.71	1.81
1803.00	8.000	129.000	1801.24	33.24	-40.33	10.70	2.07
1897.00	9.400	125.900	1894.15	47.46	-48.95	22.01	1.57
1991.00	11.100	126.200	1986.65	64.17	-58.79	35.53	1.81
2085.00	11.800	125.100	2078.78	82.82	-69.66	50.69	0.78
2179.00	12.900	125.500	2170.60	102.90	-81.28	67.10	1.17
2273.00	13.600	126.900	2262.10	124.43	-94.01	84.48	0.82
2367.00	13.000	126.200	2353.58	146.05	-106.89	101.85	0.66
2461.00	13.300	126.200	2445.11	167.43	-119.52	119.11	0.32
2555.00	13.600	125.100	2536.54	189.27	-132.26	136.87	0.42
2648.00	13.100	122.700	2627.02	210.69	-144.25	154.69	0.80
2742.00	14.200	125.500	2718.37	232.82	-156.70	173.04	1.36
2836.00	13.800	126.900	2809.58	255.54	-170.12	191.39	0.56
2930.00	13.400	128.300	2900.94	277.64	-183.61	208.90	0.55
3023.00	13.500	126.200	2991.39	299.27	-196.70	226.12	0.54
3117.00	12.800	125.900	3082.92	320.64	-209.28	243.41	0.75
3211.00	13.100	126.500	3174.53	341.70	-221.72	260.41	0.35
3305.00	12.500	123.400	3266.20	362.49	-233.66	277.46	0.97
3399.00	11.800	122.300	3358.09	382.19	-244.40	294.08	0.78
3493.00	12.500	125.600	3449.99	401.92	-255.45	310.48	1.05
3586.00	11.700	127.600	3540.92	421.41	-267.07	326.13	0.97
3681.00	11.200	123.700	3634.03	440.24	-278.06	341.44	0.97
3774.00	12.700	122.000	3725.01	459.42	-288.49	357.62	1.66
3868.00	12.100	123.300	3816.82	479.52	-299.38	374.62	0.70
3963.00	12.900	129.400	3909.57	500.04	-311.57	391.14	1.62
4057.00	14.200	126.600	4000.95	522.06	-325.11	408.50	1.55
4151.00	14.700	124.800	4091.98	545.49	-338.79	427.55	0.71
4245.00	14.200	123.700	4183.01	568.90	-351.99	446.94	0.61
4339.00	13.300	126.200	4274.31	591.21	-364.78	465.26	1.15
4433.00	13.400	129.000	4365.77	612.90	-378.02	482.45	0.70

# Actual Wellpath Report

Asbury V3-19 AWP

Page 3 of 4



INTEQ

REFERENCE WELLPATH IDENTIFICATION			
Operator	FOUNDATION ENERGY MANAGEMENT, LLC	Slot	Asbury V3-19
Area	COLORADO	Well	Asbury V3-19
Field	WELD COUNTY	Wellbore	Asbury V3-19 AWB
Facility	SEC.3-T2N-R67W		

WELLPATH DATA (76 stations) † = interpolated/extrapolated station								
MD [feet]	Inclination [°]	Azimuth [°]	TVD [feet]	Vert Sect [feet]	North [feet]	East [feet]	DLS [°/100ft]	
4528.00	14.100	128.000	4458.05	635.48	-392.07	500.12	0.78	
4622.00	13.600	125.500	4549.32	657.97	-405.54	518.14	0.83	
4716.00	13.900	124.100	4640.63	680.28	-418.29	536.49	0.48	
4810.00	13.600	125.100	4731.93	702.58	-430.97	554.88	0.41	
4904.00	13.300	126.600	4823.35	724.43	-443.77	572.60	0.49	
4998.00	13.300	130.100	4914.83	746.05	-457.18	589.55	0.86	
5092.00	14.300	126.600	5006.12	768.46	-471.07	607.14	1.39	
5186.00	12.900	126.900	5097.48	790.55	-484.29	624.86	1.49	
5280.00	10.800	129.700	5189.48	809.85	-496.22	640.02	2.32	
5374.00	9.600	130.400	5281.99	826.49	-506.93	652.77	1.28	
5467.00	8.300	129.700	5373.85	840.94	-516.24	663.84	1.40	
5561.00	7.100	132.900	5467.00	853.51	-524.53	673.32	1.36	
5656.00	5.700	131.500	5561.41	864.07	-531.65	681.15	1.48	
5750.00	4.500	121.600	5655.04	872.40	-536.68	687.79	1.58	
5845.00	3.300	120.900	5749.82	878.81	-540.03	693.31	1.26	
5939.00	2.100	99.100	5843.71	883.01	-541.70	697.33	1.66	
6033.00	1.200	99.800	5937.67	885.38	-542.14	700.00	0.96	
6127.00	0.600	323.100	6031.67	885.78	-541.91	700.68	1.80	
6221.00	0.600	308.000	6125.66	884.81	-541.21	699.99	0.17	
6315.00	0.600	321.700	6219.66	883.84	-540.52	699.30	0.15	
6408.00	0.600	319.600	6312.65	882.89	-539.77	698.68	0.02	
6502.00	0.500	330.500	6406.65	882.03	-539.04	698.16	0.15	
6596.00	0.700	330.800	6500.64	881.12	-538.18	697.68	0.21	
6690.00	0.500	123.400	6594.64	881.00	-537.91	697.74	1.24	
6784.00	0.600	94.900	6688.64	881.82	-538.17	698.57	0.31	
6878.00	0.800	97.000	6782.63	882.80	-538.29	699.72	0.21	
6971.00	0.400	169.800	6875.62	883.59	-538.69	700.42	0.84	
7066.00	0.500	168.000	6970.62	884.16	-539.43	700.56	0.11	
7159.00	0.600	188.100	7063.62	884.71	-540.30	700.58	0.23	
7253.00	0.400	197.200	7157.61	885.07	-541.11	700.41	0.23	
7347.00	0.500	197.200	7251.61	885.34	-541.81	700.19	0.11	
7441.00	0.100	150.110	7345.61	885.56	-542.27	700.11	0.47	
7535.00	0.200	340.700	7439.61	885.49	-542.19	700.10	0.32	
7629.00	0.500	23.900	7533.61	885.26	-541.66	700.21	0.40	
7723.00	0.800	30.600	7627.60	885.07	-540.72	700.71	0.33	
7772.00†	0.800	30.600	7676.60	884.99	-540.13	701.06	0.00	

HOLE & CASING SECTIONS Ref Wellbore: Asbury V3-19 AWB Ref Wellpath: Asbury V3-19 AWP									
String/Diameter	Start MD [feet]	End MD [feet]	Interval [feet]	Start TVD [feet]	End TVD [feet]	Start N/S [feet]	Start E/W [feet]	End N/S [feet]	End E/W [feet]
8.625in Casing Surface	14.00	900.00	886.00	14.00	899.84	0.00	0.00	-12.05	-8.47

# Actual Wellpath Report

Asbury V3-19 AWP

Page 4 of 4

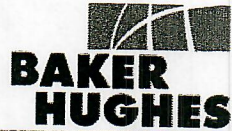

INTEQ

REFERENCE WELLPATH IDENTIFICATION			
Operator	FOUNDATION ENERGY MANAGEMENT, LLC	Slot	Asbury V3-19
Area	COLORADO	Well	Asbury V3-19
Field	WELD COUNTY	Wellbore	Asbury V3-19 AWB
Facility	SEC.3-T2N-R67W		

TARGETS									
Name	MD [feet]	TVD [feet]	North [feet]	East [feet]	Grid East [us survey feet]	Grid North [us survey feet]	Latitude [°]	Longitude [°]	Shape
Asbury #1 Existing Well		0.00	69.22	64.28	3172318.02	1306331.21	40 10 21.468N	104 53 00.060W	circle
Kugel GU #1 Existing Well		0.00	-928.95	561.73	3172822.38	1305336.56	40 10 11.604N	104 52 53.652W	circle
Asbury V3-19 Target 1388'FNL & 1304'FWL		6900.00	-542.79	695.86	3172953.82	1305723.63	40 10 15.420N	104 52 51.924W	circle

WELLPATH COMPOSITION Ref Wellbore: Asbury V3-19 AWB Ref Wellpath: Asbury V3-19 AWP				
Start MD [feet]	End MD [feet]	Positional Uncertainty Model	Log Name/Comment	Wellbore
14.00	7723.00	NaviTrak (Standard)	BHI MWD <991-7772>	Asbury V3-19 AWB
7723.00	7772.00	Blind Drilling (std)	Projection to bit	Asbury V3-19 AWB

WELLPATH COMMENTS				
MD [feet]	Inclination [degrees]	Azimuth [degrees]	TVD [feet]	Comment
7723.00	0.800	30.600	7627.60	final mwd survey
7772.00	0.800	30.600	7676.60	projection to bit