



FRANE SURVEYING INC.

Physical Address: 34834 Annie Cir.
Mail to: Box 2372, Elizabeth, CO 80107
Ph. 303-243-0037
www.franesurveying.com
Job # 18-275-Mammoth Cave 1-11

Frane Surveying, in accordance with a request from **Grand Mesa Operating** has determined the location of **Mammoth Cave 1-11** to be **2185 Feet FSL**, and **2381 Feet FWL**, (90° off Section lines) of Section **11**, Township **7s**, Range **55w** of the 6th Principal Meridian, **Lincoln County**, Colorado.

Date: Staked on 11/20/18 drawn on 11/21/18.

Re: Staked by Elijah Frane
Drawn: Drawn by Elijah Frane

REFERENCE AREA MAP

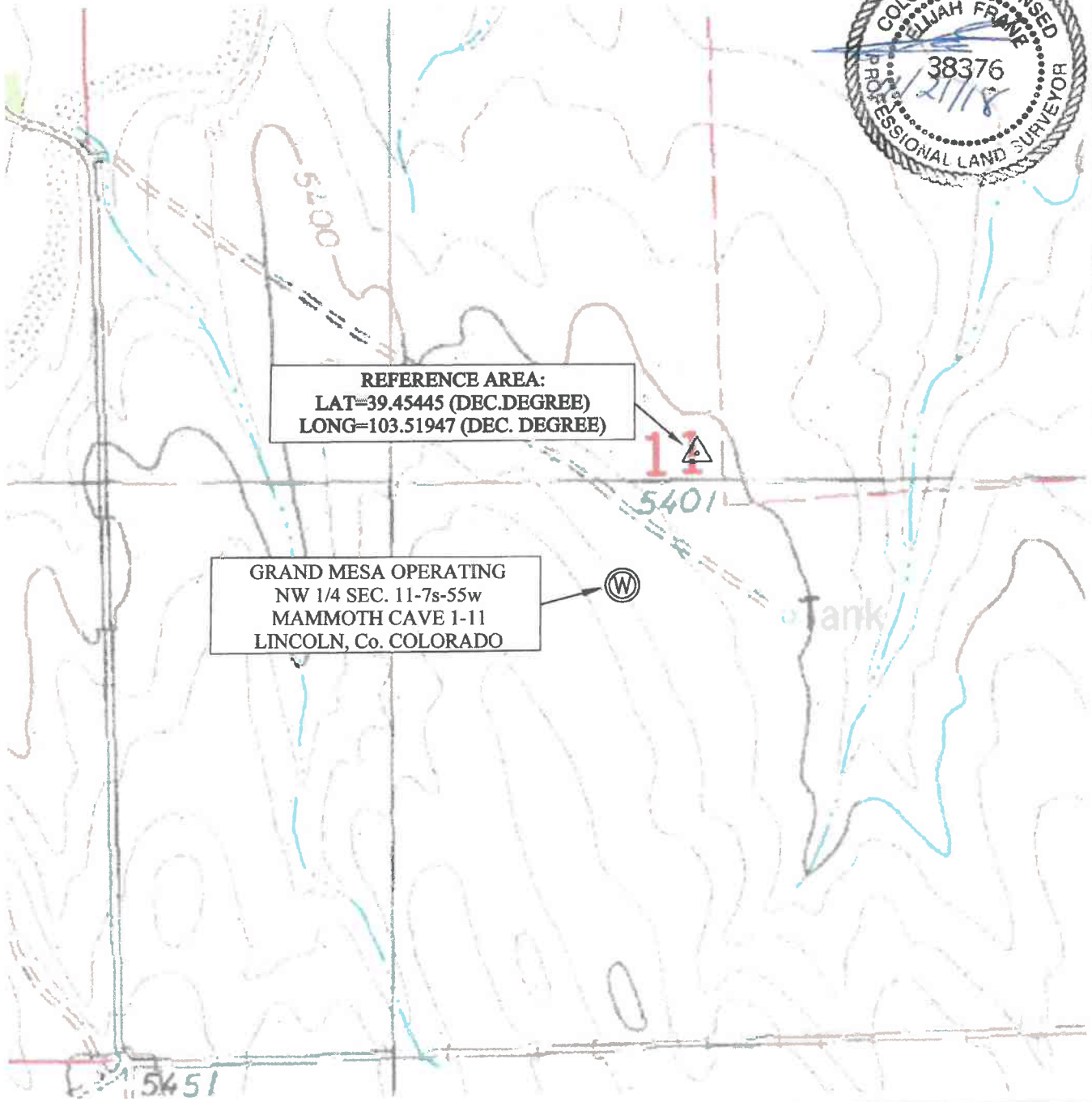

REFERENCE AREA:
LAT=39.45445 (DEC.DEGREE)
LONG=103.51947 (DEC. DEGREE)

GRAND MESA OPERATING
NW 1/4 SEC. 11-7s-55w
MAMMOTH CAVE 1-11
LINCOLN, Co. COLORADO