

C24-11 FACILITY, C24-11 PAD & C24-10 PAD  
LOCATION DRAWING

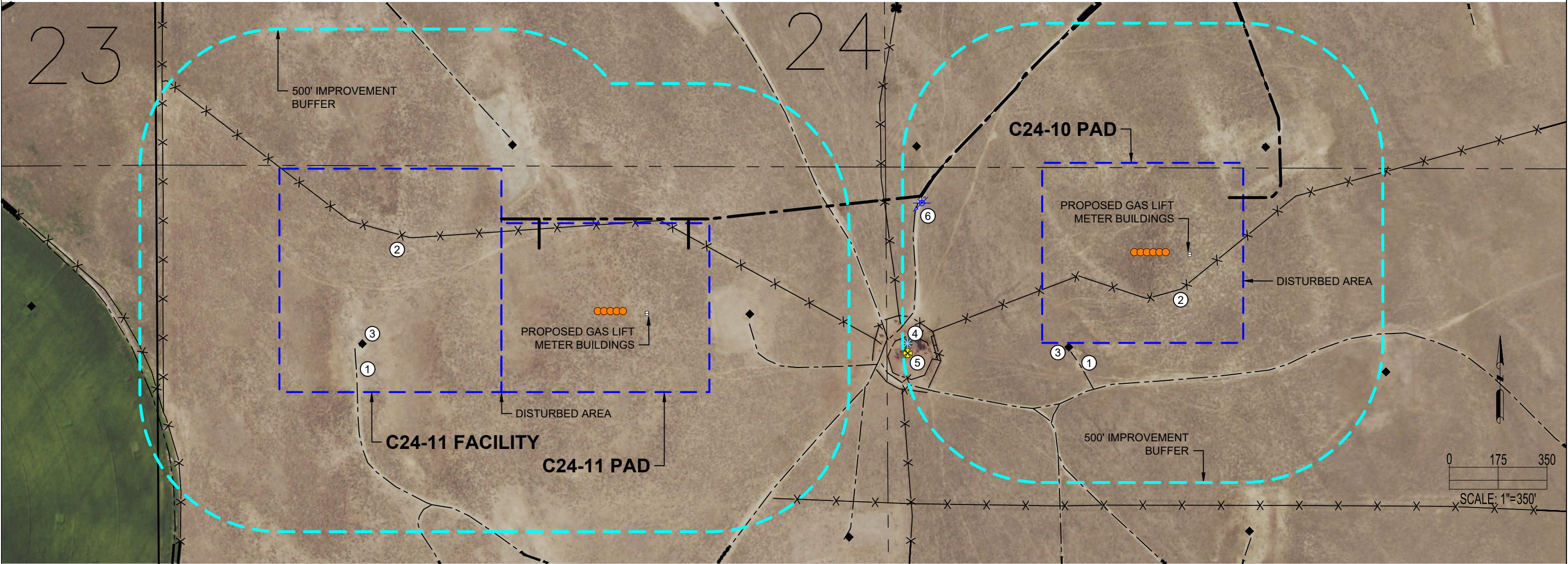

C24-11 FACILITY & C24-11 PAD

IMPROVEMENTS: (AS MEASURED FROM THE PROPOSED EDGE OF DISTURBANCE)	
1. PRIVATE ROAD:	0', ±116' NE, ±143' E, ±400' SE, ±403' S, ±405' NE, ±441' SW
2. FENCE:	0', 0', ±86' N, ±416' W, ±416' SW, ±444' SE
3. OIL/GAS WELL:	0', ±94' N, ±145' E
4. WATER TROUGH:	N/A
5. WINDMILL:	N/A
6. WATER WELL:	N/A
PROPERTY LINE:	±436' W, ±442' NW

C24-10 PAD

IMPROVEMENTS: (AS MEASURED FROM THE PROPOSED EDGE OF DISTURBANCE)	
1. PRIVATE ROAD:	±32' S, ±108' S, ±163' NE, ±218' S, ±253' NW, ±399' S
2. FENCE:	0', ±12' S, ±92' NE, ±369' SW, ±449' SW, ±449' NW, ±482' W
3. OIL/GAS WELL:	±15' S, ±98' NE, ±454' NW
4. WATER TROUGH:	±467' W
5. WINDMILL:	±477' W
6. WATER WELL:	±431' W
PROPERTY LINE:	N/A

DISCLAIMER:  
THIS PLOT DOES NOT REPRESENT A MONUMENTED LAND SURVEY AND SHOULD NOT BE RELIED UPON TO DETERMINE BOUNDARY LINES, PROPERTY OWNERSHIP OR OTHER PROPERTY INTERESTS. PARCEL LINES, IF DEPICTED HAVE NOT BEEN FIELD VERIFIED AND MAY BE BASED UPON PUBLICLY AVAILABLE DATA THAT ALSO HAS NOT BEEN INDEPENDENTLY VERIFIED.

CURRENT SURFACE USE: RANGELAND  
FUTURE SURFACE USE: RANGELAND