

Location:	COLORADO	Slot:	SLOT#08 KTC FARMS F-35-36HN (357°FNL & 475°FWL,SEC.35
Field:	WELD COUNTY (NAD83/TRUE NORTH)	Well:	KTC FARMS F-35-36HN
Facility:	SEC.35-T07N-R66W	Wellbore:	KTC FARMS F-35-36HN PWB

Plot reference wellpath is KTC FARMS F-35-36HN (REV-B.0) PWP		Grid System: NAD83 / Lambert Colorado SP, Northern Zone (501), US feet
True vertical depths are referenced to TRUE 38 (4861'GL+25KB@4886'RKB) (RKB)		North Reference: True north
Measured depths are referenced to TRUE 38 (4861'GL+25KB@4886'RKB) (RKB)		Scale: True distance
TRUE 38 (4861'GL+25KB@4886'RKB) (RKB) to Mean Sea Level: 4886 feet		Depths are in feet
Mean Sea Level to Ground level (At Slot: SLOTR08 KTC FARMS F-35-36HN (357'FNL & 475'FWL,SEC.35)): 0 feet		Created by: bushjanhm on 2018-11-28
Coordinates are in feet referenced to Slot		Database: Denver

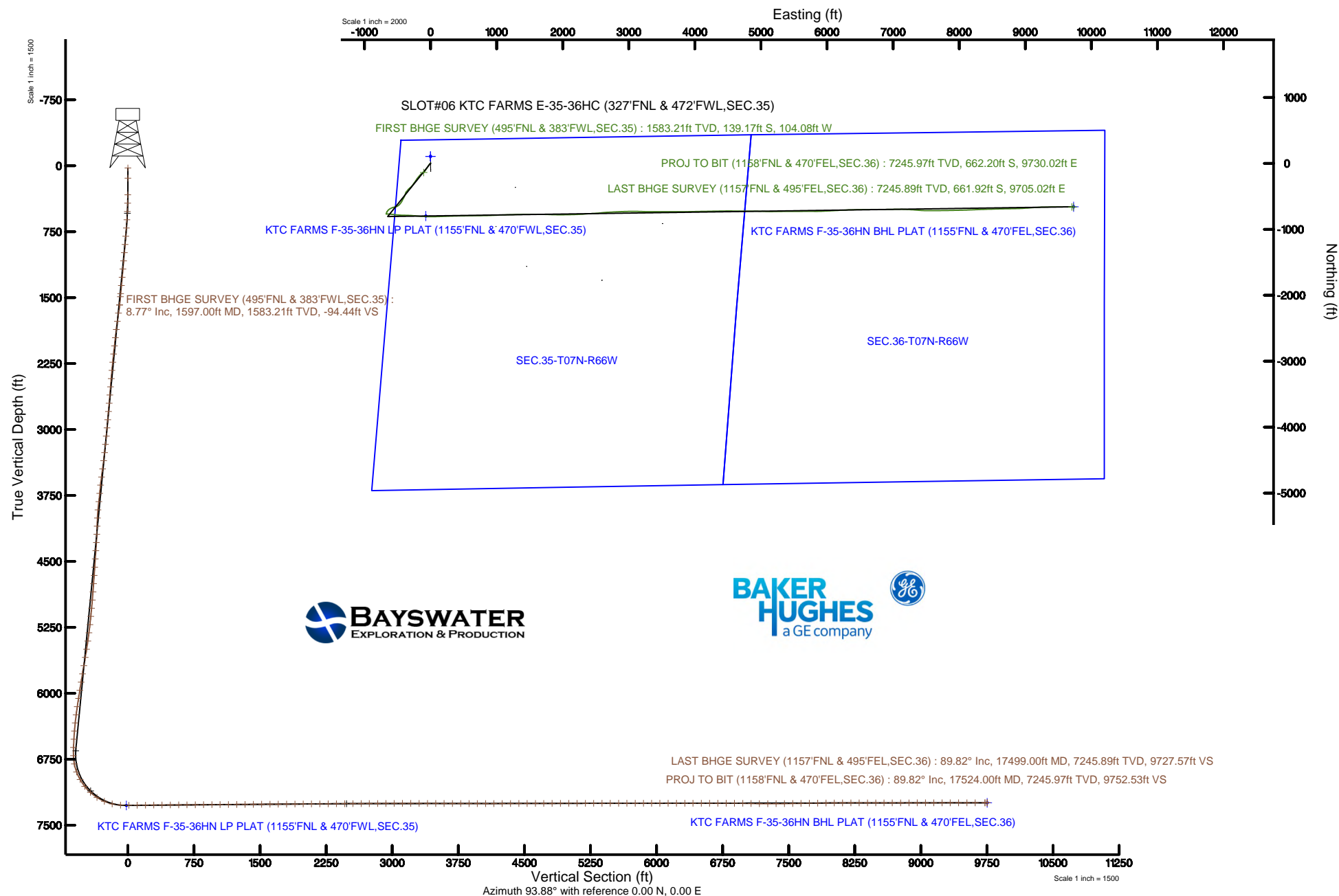

Actual Wellpath Report

KTC FARMS F-35-36HN AWP

Page 1 of 9

REFERENCE WELLPATH IDENTIFICATION

Operator	BAYSWATER E & P LLC	Slot	SLOT#08 KTC FARMS F-35-36HN (357'FNL & 475'FWL,SEC.35)
Area	COLORADO	Well	KTC FARMS F-35-36HN
Field	WELD COUNTY (NAD83/TRUE NORTH)	Wellbore	KTC FARMS F-35-36HN AWB
Facility	SEC.35-T07N-R66W		

REPORT SETUP INFORMATION

Projection System	NAD83 / Lambert Colorado SP, Northern Zone (501), US feet	Software System	WellArchitect® 5.1
North Reference	True	User	Bushjamh
Scale	0.999969	Report Generated	11/28/2018 at 4:03:14 AM
Convergence at slot	0.48° East	Database/Source file	Denver/KTC_FARMS_F-35-36HN_AWP.xml

WELLPATH LOCATION

	Local coordinates		Grid coordinates		Geographic coordinates	
	North[ft]	East[ft]	Easting[US ft]	Northing[US ft]	Latitude	Longitude
Slot Location	-104.92	1.39	3207745.54	1439640.14	40°32'16.112"N	104°45'09.198"W
Facility Reference Pt			3207743.27	1439745.05	40°32'17.149"N	104°45'09.216"W
Field Reference Pt			3174587.00	1430859.71	40°30'51.890"N	104°52'19.470"W

WELLPATH DATUM

Calculation method	Minimum curvature	TRUE 38 (4861'GL+25'KB@4886'RKB) (RKB) to Facility Vertical Datum	4886.00ft
Horizontal Reference Pt	Slot	TRUE 38 (4861'GL+25'KB@4886'RKB) (RKB) to Mean Sea Level	4886.00ft
Vertical Reference Pt	TRUE 38 (4861'GL+25'KB@4886'RKB) (RKB)	TRUE 38 (4861'GL+25'KB@4886'RKB) (RKB) to Ground Level at Slot (SLOT#08 KTC FARMS F-35-36HN (357'FNL & 475'FWL,SEC.35))	4886.00ft
MD Reference Pt	TRUE 38 (4861'GL+25'KB@4886'RKB) (RKB)	Section Origin	N 0.00, E 0.00 ft
Field Vertical Reference	Mean Sea Level	Section Azimuth	93.88°

Actual Wellpath Report

KTC FARMS F-35-36HN AWP

Page 2 of 9

REFERENCE WELLPATH IDENTIFICATION

Operator	BAYSWATER E & P LLC	Slot	SLOT#08 KTC FARMS F-35-36HN (357'FNL & 475'FWL,SEC.35)
Area	COLORADO	Well	KTC FARMS F-35-36HN
Field	WELD COUNTY (NAD83/TRUE NORTH)	Wellbore	KTC FARMS F-35-36HN AWB
Facility	SEC.35-T07N-R66W		

WELLPATH DATA (187 stations) † = interpolated/extrapolated station

MD [ft]	Inclination [°]	Azimuth [°]	TVD [ft]	Vert Sect [ft]	North [ft]	East [ft]	Latitude	Longitude	DLS [°/100ft]	Comments
0.00†	0.000	352.920	0.00	0.00	0.00	0.00	40°32'16.112"N	104°45'09.198"W	0.00	
25.00	0.000	352.920	25.00	0.00	0.00	0.00	40°32'16.112"N	104°45'09.198"W	0.00	
141.00	0.190	352.920	141.00	-0.04	0.19	-0.02	40°32'16.114"N	104°45'09.198"W	0.16	
330.00	0.760	238.670	329.99	-1.12	-0.15	-1.13	40°32'16.111"N	104°45'09.213"W	0.45	
425.00	1.980	231.810	424.97	-2.85	-1.49	-2.96	40°32'16.098"N	104°45'09.236"W	1.29	
520.00	3.400	231.460	519.86	-6.15	-4.26	-6.45	40°32'16.070"N	104°45'09.282"W	1.49	
614.00	5.050	226.570	613.60	-11.02	-8.84	-11.64	40°32'16.025"N	104°45'09.349"W	1.80	
709.00	7.070	218.530	708.07	-17.18	-16.29	-18.32	40°32'15.951"N	104°45'09.435"W	2.30	
804.00	9.550	214.510	802.06	-24.52	-27.36	-26.43	40°32'15.842"N	104°45'09.540"W	2.68	
898.00	10.370	212.810	894.64	-32.58	-40.90	-35.43	40°32'15.708"N	104°45'09.657"W	0.93	
993.00	10.560	212.280	988.06	-40.86	-55.44	-44.71	40°32'15.565"N	104°45'09.777"W	0.22	
1088.00	10.310	212.260	1081.49	-49.04	-69.99	-53.90	40°32'15.421"N	104°45'09.896"W	0.26	
1182.00	9.770	211.600	1174.05	-56.75	-83.90	-62.57	40°32'15.283"N	104°45'10.008"W	0.59	
1277.00	10.230	217.400	1267.61	-65.16	-97.47	-71.91	40°32'15.149"N	104°45'10.129"W	1.16	
1372.00	9.920	214.660	1361.15	-74.01	-110.90	-81.69	40°32'15.017"N	104°45'10.256"W	0.60	
1467.00	9.430	214.850	1454.80	-82.20	-124.02	-90.79	40°32'14.887"N	104°45'10.374"W	0.52	
1502.00	9.080	215.150	1489.34	-85.11	-128.63	-94.02	40°32'14.841"N	104°45'10.416"W	1.01	
1597.00	8.770	232.500	1583.21	-94.44	-139.17	-104.08	40°32'14.737"N	104°45'10.546"W	2.84	FIRST BHGE SURVEY (495'FNL & 383'FWL,SEC.35)
1691.00	9.360	248.010	1676.05	-106.70	-146.39	-116.86	40°32'14.666"N	104°45'10.712"W	2.67	
1785.00	9.320	236.620	1768.81	-119.63	-153.44	-130.30	40°32'14.596"N	104°45'10.886"W	1.96	
1880.00	9.850	227.090	1862.49	-131.32	-163.21	-142.68	40°32'14.500"N	104°45'11.046"W	1.76	
1974.00	10.010	225.020	1955.08	-142.20	-174.46	-154.35	40°32'14.389"N	104°45'11.197"W	0.42	
2069.00	9.760	220.730	2048.67	-152.46	-186.40	-165.44	40°32'14.271"N	104°45'11.341"W	0.82	
2163.00	9.840	220.510	2141.30	-162.03	-198.54	-175.86	40°32'14.151"N	104°45'11.476"W	0.09	
2257.00	9.620	221.030	2233.95	-171.57	-210.57	-186.23	40°32'14.032"N	104°45'11.610"W	0.25	
2352.00	9.770	217.890	2327.59	-180.87	-222.92	-196.39	40°32'13.910"N	104°45'11.742"W	0.58	
2447.00	9.680	213.630	2421.23	-189.35	-235.93	-205.77	40°32'13.781"N	104°45'11.863"W	0.76	
2542.00	9.480	211.750	2514.90	-196.97	-249.24	-214.31	40°32'13.650"N	104°45'11.974"W	0.39	
2636.00	9.380	214.400	2607.63	-204.48	-262.14	-222.71	40°32'13.522"N	104°45'12.082"W	0.47	
2731.00	9.570	214.990	2701.34	-212.49	-275.00	-231.61	40°32'13.395"N	104°45'12.198"W	0.22	

Actual Wellpath Report

KTC FARMS F-35-36HN AWP

Page 3 of 9

REFERENCE WELLPATH IDENTIFICATION

Operator	BAYSWATER E & P LLC	Slot	SLOT#08 KTC FARMS F-35-36HN (357'FNL & 475'FWL,SEC.35)
Area	COLORADO	Well	KTC FARMS F-35-36HN
Field	WELD COUNTY (NAD83/TRUE NORTH)	Wellbore	KTC FARMS F-35-36HN AWB
Facility	SEC.35-T07N-R66W		

WELLPATH DATA (187 stations)

MD [ft]	Inclination [°]	Azimuth [°]	TVD [ft]	Vert Sect [ft]	North [ft]	East [ft]	Latitude	Longitude	DLS [°/100ft]	Comments
2826.00	9.560	214.630	2795.02	-220.61	-287.96	-240.62	40°32'13.267"N	104°45'12.314"W	0.06	
2921.00	9.590	215.060	2888.69	-228.74	-300.93	-249.65	40°32'13.139"N	104°45'12.431"W	0.08	
3015.00	9.650	215.330	2981.37	-236.90	-313.76	-258.71	40°32'13.012"N	104°45'12.549"W	0.08	
3110.00	9.580	216.800	3075.04	-245.35	-326.59	-268.05	40°32'12.885"N	104°45'12.670"W	0.27	
3205.00	9.920	220.590	3168.66	-254.54	-339.13	-278.10	40°32'12.761"N	104°45'12.800"W	0.76	
3300.00	10.340	221.440	3262.18	-264.63	-351.74	-289.07	40°32'12.637"N	104°45'12.942"W	0.47	
3393.00	10.060	223.580	3353.71	-274.91	-363.88	-300.19	40°32'12.517"N	104°45'13.086"W	0.51	
3488.00	10.400	233.750	3447.21	-286.77	-374.96	-312.83	40°32'12.407"N	104°45'13.250"W	1.93	
3583.00	10.150	229.810	3540.69	-299.34	-385.43	-326.14	40°32'12.304"N	104°45'13.422"W	0.79	
3677.00	10.240	219.930	3633.21	-310.21	-397.19	-337.83	40°32'12.188"N	104°45'13.573"W	1.86	
3772.00	10.270	214.900	3726.70	-319.54	-410.61	-348.10	40°32'12.055"N	104°45'13.706"W	0.94	
3867.00	10.440	226.110	3820.16	-329.69	-423.52	-359.15	40°32'11.927"N	104°45'13.850"W	2.13	
3962.00	9.060	216.760	3913.79	-339.54	-435.48	-369.83	40°32'11.809"N	104°45'13.988"W	2.21	
4056.00	9.740	198.600	4006.55	-345.58	-448.95	-376.79	40°32'11.676"N	104°45'14.078"W	3.22	
4150.00	9.850	195.650	4099.18	-349.24	-464.23	-381.50	40°32'11.525"N	104°45'14.139"W	0.55	
4244.00	9.810	199.130	4191.80	-352.99	-479.54	-386.29	40°32'11.374"N	104°45'14.201"W	0.63	
4339.00	9.690	204.610	4285.43	-357.95	-494.45	-392.27	40°32'11.226"N	104°45'14.279"W	0.98	
4433.00	9.640	208.240	4378.10	-364.00	-508.58	-399.29	40°32'11.087"N	104°45'14.369"W	0.65	
4528.00	9.650	208.280	4471.75	-370.57	-522.60	-406.83	40°32'10.948"N	104°45'14.467"W	0.01	
4623.00	9.640	205.500	4565.41	-376.79	-536.79	-414.03	40°32'10.808"N	104°45'14.560"W	0.49	
4718.00	9.650	209.100	4659.07	-383.11	-550.93	-421.32	40°32'10.668"N	104°45'14.655"W	0.63	
4813.00	9.520	207.840	4752.74	-389.70	-564.83	-428.86	40°32'10.531"N	104°45'14.752"W	0.26	
4908.00	9.640	209.940	4846.42	-396.38	-578.67	-436.50	40°32'10.394"N	104°45'14.851"W	0.39	
5002.00	9.490	212.630	4939.11	-403.57	-592.02	-444.61	40°32'10.262"N	104°45'14.956"W	0.50	
5097.00	9.890	217.310	5032.76	-411.83	-605.10	-453.78	40°32'10.133"N	104°45'15.075"W	0.93	
5191.00	9.800	220.800	5125.37	-421.09	-617.58	-463.90	40°32'10.010"N	104°45'15.206"W	0.64	
5286.00	9.550	226.140	5219.02	-431.24	-629.16	-474.86	40°32'09.895"N	104°45'15.348"W	0.98	
5381.00	9.680	229.770	5312.69	-442.28	-639.78	-486.64	40°32'09.790"N	104°45'15.501"W	0.65	
5476.00	9.820	243.510	5406.33	-455.01	-648.55	-499.99	40°32'09.704"N	104°45'15.674"W	2.45	
5571.00	9.910	248.460	5499.93	-469.38	-655.17	-514.85	40°32'09.638"N	104°45'15.866"W	0.90	

Actual Wellpath Report

KTC FARMS F-35-36HN AWP

Page 4 of 9

REFERENCE WELLPATH IDENTIFICATION

Operator	BAYSWATER E & P LLC	Slot	SLOT#08 KTC FARMS F-35-36HN (357'FNL & 475'FWL,SEC.35)
Area	COLORADO	Well	KTC FARMS F-35-36HN
Field	WELD COUNTY (NAD83/TRUE NORTH)	Wellbore	KTC FARMS F-35-36HN AWB
Facility	SEC.35-T07N-R66W		

WELLPATH DATA (187 stations)

MD [ft]	Inclination [°]	Azimuth [°]	TVD [ft]	Vert Sect [ft]	North [ft]	East [ft]	Latitude	Longitude	DLS [°/100ft]	Comments
5665.00	9.910	256.660	5592.53	-484.41	-660.00	-530.24	40°32'09.591"N	104°45'16.065"W	1.50	
5760.00	9.890	256.590	5686.12	-500.01	-663.78	-546.13	40°32'09.553"N	104°45'16.271"W	0.02	
5855.00	9.940	253.980	5779.70	-515.51	-667.94	-561.95	40°32'09.512"N	104°45'16.476"W	0.48	
5950.00	9.810	250.000	5873.29	-530.62	-672.97	-577.44	40°32'09.462"N	104°45'16.677"W	0.73	
6044.00	10.430	245.790	5965.83	-545.45	-679.20	-592.72	40°32'09.401"N	104°45'16.875"W	1.03	
6139.00	10.660	241.470	6059.23	-560.46	-686.92	-608.28	40°32'09.325"N	104°45'17.076"W	0.87	
6234.00	10.480	236.210	6152.62	-574.71	-695.92	-623.19	40°32'09.236"N	104°45'17.269"W	1.03	
6328.00	10.590	226.880	6245.04	-587.37	-706.58	-636.60	40°32'09.130"N	104°45'17.443"W	1.82	
6422.00	10.440	217.350	6337.47	-597.96	-719.26	-648.07	40°32'09.005"N	104°45'17.591"W	1.85	
6516.00	10.280	210.340	6429.94	-606.40	-733.27	-657.47	40°32'08.867"N	104°45'17.713"W	1.35	
6610.00	10.440	201.920	6522.41	-612.77	-748.41	-664.89	40°32'08.717"N	104°45'17.809"W	1.62	
6705.00	8.750	198.650	6616.08	-617.28	-763.24	-670.41	40°32'08.570"N	104°45'17.881"W	1.87	
6799.00	1.340	74.870	6709.74	-618.07	-769.74	-671.64	40°32'08.506"N	104°45'17.897"W	10.17	
6894.00	11.120	87.650	6804.06	-607.89	-769.07	-661.39	40°32'08.513"N	104°45'17.764"W	10.33	
6989.00	20.500	91.090	6895.37	-582.11	-769.01	-635.55	40°32'08.513"N	104°45'17.429"W	9.92	
7084.00	29.460	97.160	6981.41	-542.08	-772.25	-595.65	40°32'08.481"N	104°45'16.912"W	9.80	
7178.00	38.460	97.370	7059.30	-489.72	-778.89	-543.62	40°32'08.416"N	104°45'16.239"W	9.58	
7272.00	47.690	93.300	7127.90	-425.63	-784.66	-479.77	40°32'08.359"N	104°45'15.412"W	10.25	
7366.00	57.390	91.340	7185.00	-351.14	-787.59	-405.31	40°32'08.330"N	104°45'14.447"W	10.45	
7461.00	67.330	92.150	7229.02	-267.15	-790.18	-321.30	40°32'08.304"N	104°45'13.359"W	10.49	
7555.00	76.180	94.930	7258.43	-177.97	-795.74	-232.30	40°32'08.249"N	104°45'12.207"W	9.82	
7650.00	87.170	94.950	7272.16	-84.13	-803.82	-138.79	40°32'08.170"N	104°45'10.996"W	11.57	
7745.00	90.340	90.880	7274.23	10.80	-808.65	-43.97	40°32'08.122"N	104°45'09.767"W	5.43	
7839.00	90.520	89.230	7273.52	104.58	-808.74	50.02	40°32'08.121"N	104°45'08.550"W	1.77	
7934.00	90.460	88.110	7272.71	199.19	-806.53	144.99	40°32'08.143"N	104°45'07.320"W	1.18	
8029.00	90.520	87.770	7271.90	293.67	-803.12	239.93	40°32'08.176"N	104°45'06.091"W	0.36	
8123.00	90.340	88.400	7271.19	387.19	-799.98	333.87	40°32'08.207"N	104°45'04.874"W	0.70	
8218.00	90.430	88.970	7270.55	481.80	-797.80	428.85	40°32'08.229"N	104°45'03.644"W	0.61	
8313.00	90.430	89.520	7269.84	576.48	-796.55	523.83	40°32'08.241"N	104°45'02.414"W	0.58	
8407.00	90.490	89.130	7269.08	670.18	-795.44	617.82	40°32'08.252"N	104°45'01.196"W	0.42	

Actual Wellpath Report

KTC FARMS F-35-36HN AWP

Page 5 of 9

REFERENCE WELLPATH IDENTIFICATION

Operator	BAYSWATER E & P LLC	Slot	SLOT#08 KTC FARMS F-35-36HN (357'FNL & 475'FWL,SEC.35)
Area	COLORADO	Well	KTC FARMS F-35-36HN
Field	WELD COUNTY (NAD83/TRUE NORTH)	Wellbore	KTC FARMS F-35-36HN AWB
Facility	SEC.35-T07N-R66W		

WELLPATH DATA (187 stations)

MD [ft]	Inclination [°]	Azimuth [°]	TVD [ft]	Vert Sect [ft]	North [ft]	East [ft]	Latitude	Longitude	DLS [°/100ft]	Comments
8502.00	90.550	89.090	7268.22	764.85	-793.96	712.81	40°32'08.267"N	104°44'59.966"W	0.08	
8596.00	90.550	89.240	7267.32	858.53	-792.59	806.79	40°32'08.280"N	104°44'58.749"W	0.16	
8691.00	90.220	88.170	7266.68	953.14	-790.45	901.77	40°32'08.302"N	104°44'57.519"W	1.18	
8785.00	90.340	87.640	7266.22	1046.63	-787.01	995.70	40°32'08.335"N	104°44'56.302"W	0.58	
8880.00	90.460	87.690	7265.56	1141.07	-783.14	1090.62	40°32'08.374"N	104°44'55.073"W	0.14	
8975.00	90.620	88.520	7264.66	1235.58	-780.00	1185.56	40°32'08.405"N	104°44'53.843"W	0.89	
9069.00	90.120	88.070	7264.06	1329.13	-777.20	1279.52	40°32'08.432"N	104°44'52.626"W	0.72	
9164.00	90.650	89.110	7263.42	1423.73	-774.86	1374.49	40°32'08.455"N	104°44'51.396"W	1.23	
9259.00	90.400	89.690	7262.55	1518.43	-773.87	1469.48	40°32'08.465"N	104°44'50.166"W	0.66	
9354.00	90.550	90.200	7261.76	1613.20	-773.78	1564.47	40°32'08.466"N	104°44'48.936"W	0.56	
9447.00	90.180	90.200	7261.17	1706.01	-774.10	1657.47	40°32'08.463"N	104°44'47.731"W	0.40	
9542.00	90.340	91.850	7260.74	1800.89	-775.80	1752.45	40°32'08.446"N	104°44'46.501"W	1.74	
9637.00	90.370	91.610	7260.15	1895.82	-778.67	1847.41	40°32'08.417"N	104°44'45.271"W	0.25	
9731.00	90.550	90.440	7259.39	1989.70	-780.35	1941.39	40°32'08.401"N	104°44'44.054"W	1.26	
9825.00	90.490	88.930	7258.54	2083.44	-779.84	2035.38	40°32'08.406"N	104°44'42.837"W	1.61	
9920.00	90.370	88.890	7257.83	2178.08	-778.03	2130.36	40°32'08.423"N	104°44'41.607"W	0.13	
10015.00	90.220	87.780	7257.34	2272.64	-775.27	2225.32	40°32'08.451"N	104°44'40.377"W	1.18	
10110.00	90.460	85.560	7256.77	2366.88	-769.75	2320.15	40°32'08.505"N	104°44'39.149"W	2.35	
10204.00	90.460	86.940	7256.02	2460.04	-763.60	2413.94	40°32'08.566"N	104°44'37.934"W	1.47	
10299.00	90.280	85.740	7255.41	2554.22	-757.54	2508.74	40°32'08.626"N	104°44'36.706"W	1.28	
10393.00	90.250	83.760	7254.97	2647.02	-748.94	2602.34	40°32'08.710"N	104°44'35.494"W	2.11	
10487.00	90.310	87.540	7254.51	2740.04	-741.81	2696.06	40°32'08.781"N	104°44'34.280"W	4.02	
10582.00	90.400	87.070	7253.92	2834.41	-737.34	2790.95	40°32'08.825"N	104°44'33.051"W	0.50	
10676.00	90.310	87.870	7253.34	2927.82	-733.19	2884.85	40°32'08.866"N	104°44'31.835"W	0.86	
10771.00	90.520	88.150	7252.65	3022.32	-729.89	2979.79	40°32'08.898"N	104°44'30.605"W	0.37	
10865.00	89.910	90.530	7252.30	3116.02	-728.81	3073.78	40°32'08.909"N	104°44'29.388"W	2.61	
10960.00	89.820	91.800	7252.52	3210.91	-730.74	3168.76	40°32'08.890"N	104°44'28.158"W	1.34	
11054.00	89.720	91.630	7252.90	3304.84	-733.56	3262.72	40°32'08.862"N	104°44'26.941"W	0.21	
11149.00	90.000	89.900	7253.13	3399.70	-734.83	3357.70	40°32'08.849"N	104°44'25.711"W	1.84	
11243.00	89.690	89.670	7253.39	3493.46	-734.47	3451.70	40°32'08.852"N	104°44'24.494"W	0.41	

Actual Wellpath Report

KTC FARMS F-35-36HN AWP

Page 6 of 9

REFERENCE WELLPATH IDENTIFICATION

Operator	BAYSWATER E & P LLC	Slot	SLOT#08 KTC FARMS F-35-36HN (357'FNL & 475'FWL,SEC.35)
Area	COLORADO	Well	KTC FARMS F-35-36HN
Field	WELD COUNTY (NAD83/TRUE NORTH)	Wellbore	KTC FARMS F-35-36HN AWB
Facility	SEC.35-T07N-R66W		

WELLPATH DATA (187 stations)

MD [ft]	Inclination [°]	Azimuth [°]	TVD [ft]	Vert Sect [ft]	North [ft]	East [ft]	Latitude	Longitude	DLS [°/100ft]	Comments
11338.00	89.910	90.370	7253.72	3588.24	-734.51	3546.70	40°32'08.852"N	104°44'23.263"W	0.77	
11433.00	89.780	89.690	7253.98	3683.03	-734.56	3641.70	40°32'08.851"N	104°44'22.033"W	0.73	
11528.00	89.780	89.690	7254.34	3777.77	-734.04	3736.70	40°32'08.856"N	104°44'20.802"W	0.00	
11623.00	89.850	89.830	7254.65	3872.53	-733.64	3831.70	40°32'08.860"N	104°44'19.572"W	0.16	
11717.00	90.060	89.190	7254.72	3966.25	-732.84	3925.69	40°32'08.868"N	104°44'18.355"W	0.72	
11811.00	89.820	88.820	7254.82	4059.91	-731.21	4019.68	40°32'08.884"N	104°44'17.137"W	0.47	
11906.00	90.280	88.930	7254.74	4154.55	-729.34	4114.66	40°32'08.902"N	104°44'15.907"W	0.50	
12000.00	90.250	88.860	7254.30	4248.20	-727.53	4208.64	40°32'08.920"N	104°44'14.690"W	0.08	
12095.00	90.090	89.120	7254.02	4342.85	-725.85	4303.62	40°32'08.936"N	104°44'13.460"W	0.32	
12190.00	90.310	88.860	7253.69	4437.50	-724.18	4398.61	40°32'08.953"N	104°44'12.230"W	0.36	
12284.00	90.150	89.690	7253.31	4531.20	-722.99	4492.60	40°32'08.964"N	104°44'11.012"W	0.90	
12379.00	90.220	90.950	7253.00	4626.01	-723.52	4587.60	40°32'08.959"N	104°44'09.782"W	1.33	
12473.00	90.030	90.740	7252.80	4719.88	-724.91	4681.59	40°32'08.945"N	104°44'08.565"W	0.30	
12568.00	90.310	90.130	7252.52	4814.71	-725.63	4776.58	40°32'08.938"N	104°44'07.334"W	0.71	
12663.00	90.120	90.120	7252.16	4909.51	-725.84	4871.58	40°32'08.935"N	104°44'06.104"W	0.20	
12758.00	90.220	90.870	7251.88	5004.34	-726.66	4966.58	40°32'08.927"N	104°44'04.874"W	0.80	
12851.00	90.220	92.780	7251.52	5097.27	-729.62	5059.52	40°32'08.898"N	104°44'03.670"W	2.05	
12946.00	89.940	89.720	7251.39	5192.16	-731.69	5154.49	40°32'08.877"N	104°44'02.440"W	3.23	
13041.00	90.060	89.110	7251.39	5286.87	-730.72	5249.48	40°32'08.886"N	104°44'01.210"W	0.65	
13135.00	90.120	89.680	7251.24	5380.59	-729.73	5343.48	40°32'08.896"N	104°43'59.992"W	0.61	
13230.00	89.970	89.840	7251.17	5475.34	-729.33	5438.48	40°32'08.900"N	104°43'58.762"W	0.23	
13324.00	90.090	89.850	7251.12	5569.11	-729.08	5532.48	40°32'08.902"N	104°43'57.544"W	0.13	
13418.00	89.970	89.190	7251.07	5662.84	-728.29	5626.47	40°32'08.910"N	104°43'56.327"W	0.71	
13513.00	89.940	90.240	7251.14	5757.58	-727.82	5721.47	40°32'08.914"N	104°43'55.097"W	1.11	
13607.00	90.150	90.340	7251.07	5851.40	-728.29	5815.47	40°32'08.909"N	104°43'53.879"W	0.25	
13700.00	90.000	88.440	7250.95	5944.11	-727.30	5908.46	40°32'08.919"N	104°43'52.675"W	2.05	
13794.00	89.940	86.730	7251.00	6037.54	-723.34	6002.37	40°32'08.958"N	104°43'51.459"W	1.82	
13889.00	89.910	86.950	7251.12	6131.83	-718.10	6097.23	40°32'09.009"N	104°43'50.230"W	0.23	
13984.00	89.970	87.060	7251.22	6226.14	-713.14	6192.10	40°32'09.058"N	104°43'49.001"W	0.13	
14079.00	89.970	87.210	7251.27	6320.49	-708.39	6286.98	40°32'09.105"N	104°43'47.773"W	0.16	

Actual Wellpath Report

KTC FARMS F-35-36HN AWP

Page 7 of 9

REFERENCE WELLPATH IDENTIFICATION

Operator	BAYSWATER E & P LLC	Slot	SLOT#08 KTC FARMS F-35-36HN (357'FNL & 475'FWL,SEC.35)
Area	COLORADO	Well	KTC FARMS F-35-36HN
Field	WELD COUNTY (NAD83/TRUE NORTH)	Wellbore	KTC FARMS F-35-36HN AWB
Facility	SEC.35-T07N-R66W		

WELLPATH DATA (187 stations)

MD [ft]	Inclination [°]	Azimuth [°]	TVD [ft]	Vert Sect [ft]	North [ft]	East [ft]	Latitude	Longitude	DLS [°/100ft]	Comments
14173.00	90.060	88.240	7251.25	6413.94	-704.66	6380.90	40°32'09.141"N	104°43'46.556"W	1.10	
14268.00	89.970	89.340	7251.22	6508.57	-702.65	6475.88	40°32'09.161"N	104°43'45.326"W	1.16	
14362.00	90.030	90.030	7251.22	6602.32	-702.14	6569.88	40°32'09.166"N	104°43'44.109"W	0.74	
14456.00	89.970	89.030	7251.22	6696.05	-701.37	6663.88	40°32'09.173"N	104°43'42.891"W	1.07	
14551.00	90.090	89.950	7251.17	6790.77	-700.52	6758.87	40°32'09.181"N	104°43'41.661"W	0.98	
14645.00	90.090	89.670	7251.02	6884.53	-700.21	6852.87	40°32'09.184"N	104°43'40.443"W	0.30	
14739.00	88.920	88.890	7251.84	6978.22	-699.03	6946.86	40°32'09.195"N	104°43'39.226"W	1.50	
14834.00	88.920	89.560	7253.63	7072.89	-697.74	7041.83	40°32'09.208"N	104°43'37.996"W	0.71	
14929.00	89.080	90.720	7255.28	7167.67	-697.98	7136.81	40°32'09.205"N	104°43'36.766"W	1.23	
15023.00	90.180	92.940	7255.89	7261.60	-700.98	7230.76	40°32'09.175"N	104°43'35.549"W	2.64	
15118.00	90.120	94.760	7255.64	7356.60	-707.36	7325.54	40°32'09.112"N	104°43'34.322"W	1.92	
15213.00	90.920	93.520	7254.78	7451.59	-714.21	7420.28	40°32'09.044"N	104°43'33.095"W	1.55	
15307.00	90.770	90.070	7253.39	7545.51	-717.16	7514.21	40°32'09.015"N	104°43'31.878"W	3.67	
15401.00	90.710	90.330	7252.18	7639.30	-717.49	7608.21	40°32'09.011"N	104°43'30.661"W	0.28	
15496.00	90.710	89.010	7251.00	7734.04	-716.94	7703.19	40°32'09.016"N	104°43'29.431"W	1.39	
15591.00	90.650	89.430	7249.87	7828.72	-715.65	7798.18	40°32'09.029"N	104°43'28.200"W	0.45	
15686.00	90.680	88.310	7248.77	7923.35	-713.77	7893.15	40°32'09.047"N	104°43'26.970"W	1.18	
15780.00	90.650	89.160	7247.68	8016.96	-711.70	7987.12	40°32'09.067"N	104°43'25.753"W	0.90	
15875.00	90.060	88.210	7247.09	8111.57	-709.52	8082.09	40°32'09.088"N	104°43'24.523"W	1.18	
15970.00	90.220	87.300	7246.86	8206.03	-705.80	8177.02	40°32'09.125"N	104°43'23.294"W	0.97	
16064.00	90.030	87.890	7246.65	8299.46	-701.85	8270.94	40°32'09.163"N	104°43'22.077"W	0.66	
16159.00	89.970	88.040	7246.65	8393.96	-698.48	8365.88	40°32'09.196"N	104°43'20.848"W	0.17	
16253.00	90.030	88.690	7246.65	8487.52	-695.80	8459.84	40°32'09.223"N	104°43'19.631"W	0.69	
16348.00	90.030	87.880	7246.61	8582.07	-692.95	8554.79	40°32'09.250"N	104°43'18.401"W	0.85	
16442.00	89.910	89.070	7246.65	8675.65	-690.45	8648.76	40°32'09.275"N	104°43'17.184"W	1.27	
16537.00	90.180	88.880	7246.58	8770.30	-688.75	8743.74	40°32'09.291"N	104°43'15.954"W	0.35	
16632.00	90.060	88.860	7246.38	8864.94	-686.88	8838.72	40°32'09.309"N	104°43'14.724"W	0.13	
16726.00	90.060	87.710	7246.28	8958.49	-684.06	8932.68	40°32'09.337"N	104°43'13.507"W	1.22	
16821.00	90.000	85.720	7246.23	9052.74	-678.62	9027.52	40°32'09.390"N	104°43'12.278"W	2.10	
16916.00	90.120	85.920	7246.13	9146.81	-671.70	9122.27	40°32'09.458"N	104°43'11.051"W	0.25	

Actual Wellpath Report

KTC FARMS F-35-36HN AWP

Page 8 of 9

REFERENCE WELLPATH IDENTIFICATION

Operator	BAYSWATER E & P LLC	Slot	SLOT#08 KTC FARMS F-35-36HN (357'FNL & 475'FWL,SEC.35)
Area	COLORADO	Well	KTC FARMS F-35-36HN
Field	WELD COUNTY (NAD83/TRUE NORTH)	Wellbore	KTC FARMS F-35-36HN AWB
Facility	SEC.35-T07N-R66W		

WELLPATH DATA (187 stations)

MD [ft]	Inclination [°]	Azimuth [°]	TVD [ft]	Vert Sect [ft]	North [ft]	East [ft]	Latitude	Longitude	DLS [°/100ft]	Comments
17010.00	90.090	87.400	7245.96	9240.06	-666.22	9216.10	40°32'09.512"N	104°43'09.836"W	1.57	
17104.00	90.030	88.520	7245.86	9333.56	-662.87	9310.04	40°32'09.545"N	104°43'08.619"W	1.19	
17199.00	89.820	89.530	7245.99	9428.22	-661.26	9405.03	40°32'09.561"N	104°43'07.389"W	1.09	
17294.00	90.220	89.940	7245.95	9522.97	-660.82	9500.03	40°32'09.564"N	104°43'06.159"W	0.60	
17388.00	90.030	90.290	7245.75	9616.76	-661.01	9594.03	40°32'09.562"N	104°43'04.941"W	0.42	
17499.00	89.820	90.650	7245.89	9727.57	-661.92	9705.02	40°32'09.553"N	104°43'03.504"W	0.38	LAST BHGE SURVEY (1157'FNL & 495'FEL,SEC.36)
17524.00	89.820	90.650	7245.97	9752.53	-662.20	9730.02	40°32'09.550"N	104°43'03.180"W	0.00	PROJ TO BIT (1158'FNL & 470'FEL,SEC.36)

TARGETS

Name	TVD [ft]	North [ft]	East [ft]	Grid East [US ft]	Grid North [US ft]	Latitude	Longitude	Shape
KTC FARMS F-35-36HN BHL PLAT (1155'FNL & 470'FEL,SEC.36)	7246.00	-659.32	9730.57	3217481.00	1439062.88	40°32'09.578"N	104°43'03.173"W	point
KTC FARMS F-35-36HN LP PLAT (1155'FNL & 470'FWL,SEC.35)	7276.00	-798.96	-71.16	3207681.12	1438840.64	40°32'08.218"N	104°45'10.120"W	point
SEC.35-T07N-R66W	12000.00	104.92	-1.39	3207743.27	1439745.05	40°32'17.149"N	104°45'09.216"W	polygon
SEC.36-T07N-R66W	12000.00	104.92	-1.39	3207743.27	1439745.05	40°32'17.149"N	104°45'09.216"W	polygon

WELLPATH COMPOSITION - Ref Wellbore: KTC FARMS F-35-36HN AWB Ref Wellpath: KTC FARMS F-35-36HN AWP

Start MD [ft]	End MD [ft]	Positional Uncertainty Model	Log Name/Comment	Wellbore
25.00	1502.00	BHI NaviTrak (Standard)	BHI NAVITRAK (STANDARD) <141-1502>	KTC FARMS F-35-36HN AWB
1502.00	17499.00	BHI AutoTrak Curve (Short)	BHI AUTOTRAK CURVE (SHORT) <1597-17524>	KTC FARMS F-35-36HN AWB
17499.00	17524.00	Blind Drilling (std)	Projection to bit	KTC FARMS F-35-36HN AWB

Actual Wellpath Report

KTC FARMS F-35-36HN AWP

Page 9 of 9

REFERENCE WELLPATH IDENTIFICATION

Operator	BAYSWATER E & P LLC	Slot	SLOT#08 KTC FARMS F-35-36HN (357'FNL & 475'FWL,SEC.35)
Area	COLORADO	Well	KTC FARMS F-35-36HN
Field	WELD COUNTY (NAD83/TRUE NORTH)	Wellbore	KTC FARMS F-35-36HN AWB
Facility	SEC.35-T07N-R66W		

WELLPATH COMMENTS

MD [ft]	Inclination [°]	Azimuth [°]	TVD [ft]	Comment
1597.00	8.770	232.500	1583.21	FIRST BHGE SURVEY (495'FNL & 383'FWL,SEC.35)
17499.00	89.820	90.650	7245.89	LAST BHGE SURVEY (1157'FNL & 495'FEL,SEC.36)
17524.00	89.820	90.650	7245.97	PROJ TO BIT (1158'FNL & 470'FEL,SEC.36)