

Location:	COLORADO	Slot:	SLOT#06 KTC FARMS E-35-36HC (327'FNL & 472'FWL,SEC.35)
Field:	WELD COUNTY (NAD83/TRUE NORTH)	Well:	KTC FARMS E-35-36HC
Facility:	SEC.35-T07N-R66W	Wellbore:	KTC FARMS E-35-36HC PWB

Plot reference wellpath is KTC FARMs E-35-36HC (REV-E.0) PWP	Grid System: NAD83 / Lambert Colorado SP, Northern Zone (501), US feet
True vertical depths are referenced to TRUE 38 (4861'GL+25'KB@4886'RKB) (RKB)	North Reference: True north
Measured depths are referenced to TRUE 38 (4861'GL+25'KB@4886'RKB) (RKB)	Scale: True distance
TRUE 38 (4861'GL+25'KB@4886'RKB) (RKB) to Mean Sea Level: 4886 feet	Depths are in feet
Mean Sea Level to Ground level (At Slot: SLOT#06 KTC FARMs E-35-36HC (327'FNL & 472'FWL,SEC.35)): 0 feet	Created by: bushjarnh on 2018-11-28
Coordinates are in feet referenced to Slot	Database: Denver

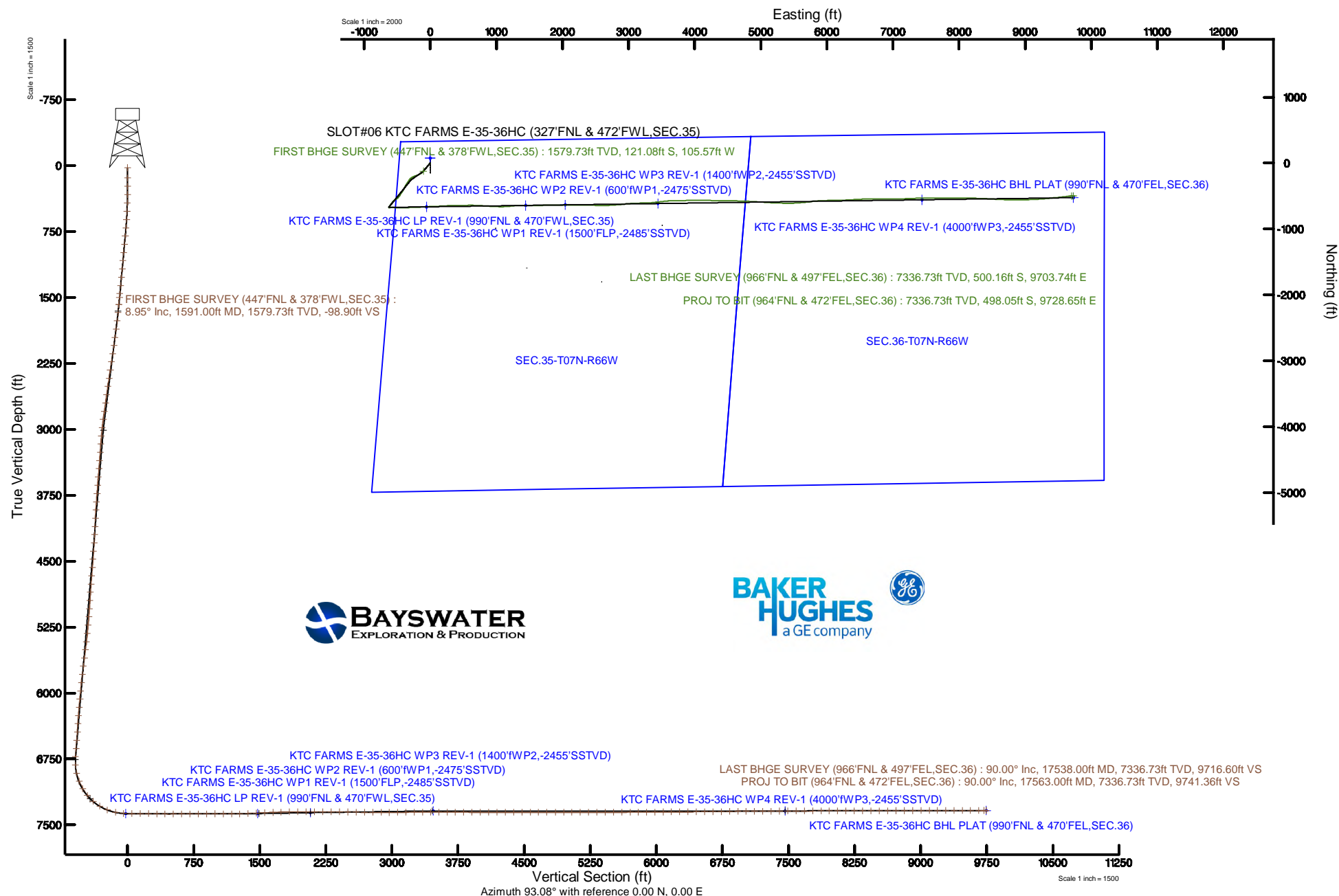

Actual Wellpath Report

KTC FARMS E-35-36HC AWP

Page 1 of 10

REFERENCE WELLPATH IDENTIFICATION

Operator	BAYSWATER E & P LLC	Slot	SLOT#06 KTC FARMS E-35-36HC (327'FNL & 472'FWL,SEC.35)
Area	COLORADO	Well	KTC FARMS E-35-36HC
Field	WELD COUNTY (NAD83/TRUE NORTH)	Wellbore	KTC FARMS E-35-36HC AWP
Facility	SEC.35-T07N-R66W		

REPORT SETUP INFORMATION

Projection System	NAD83 / Lambert Colorado SP, Northern Zone (501), US feet	Software System	WellArchitect® 5.1
North Reference	True	User	Bushjamh
Scale	0.999969	Report Generated	11/28/2018 at 4:03:33 AM
Convergence at slot	0.48° East	Database/Source file	Denver/KTC_FARMS_E-35-36HC_AWP.xml

WELLPATH LOCATION

	Local coordinates		Grid coordinates		Geographic coordinates	
	North[ft]	East[ft]	Easting[US ft]	Northing[US ft]	Latitude	Longitude
Slot Location	-75.05	1.11	3207745.01	1439670.01	40°32'16.408"N	104°45'09.202"W
Facility Reference Pt			3207743.27	1439745.05	40°32'17.149"N	104°45'09.216"W
Field Reference Pt			3174587.00	1430859.71	40°30'51.890"N	104°52'19.470"W

WELLPATH DATUM

Calculation method	Minimum curvature	TRUE 38 (4861'GL+25'KB@4886'RKB) (RKB) to Facility Vertical Datum	4886.00ft
Horizontal Reference Pt	Slot	TRUE 38 (4861'GL+25'KB@4886'RKB) (RKB) to Mean Sea Level	4886.00ft
Vertical Reference Pt	TRUE 38 (4861'GL+25'KB@4886'RKB) (RKB)	TRUE 38 (4861'GL+25'KB@4886'RKB) (RKB) to Ground Level at Slot (SLOT#06 KTC FARMS E-35-36HC (327'FNL & 472'FWL,SEC.35))	4886.00ft
MD Reference Pt	TRUE 38 (4861'GL+25'KB@4886'RKB) (RKB)	Section Origin	N 0.00, E 0.00 ft
Field Vertical Reference	Mean Sea Level	Section Azimuth	93.08°

Actual Wellpath Report

KTC FARMS E-35-36HC AWP

Page 2 of 10

REFERENCE WELLPATH IDENTIFICATION

Operator	BAYSWATER E & P LLC	Slot	SLOT#06 KTC FARMS E-35-36HC (327'FNL & 472'FWL,SEC.35)
Area	COLORADO	Well	KTC FARMS E-35-36HC
Field	WELD COUNTY (NAD83/TRUE NORTH)	Wellbore	KTC FARMS E-35-36HC AWB
Facility	SEC.35-T07N-R66W		

WELLPATH DATA (189 stations) † = interpolated/extrapolated station

MD [ft]	Inclination [°]	Azimuth [°]	TVD [ft]	Vert Sect [ft]	North [ft]	East [ft]	Latitude	Longitude	DLS [°/100ft]	Comments
0.00†	0.000	250.510	0.00	0.00	0.00	0.00	40°32'16.408"N	104°45'09.202"W	0.00	
25.00	0.000	250.510	25.00	0.00	0.00	0.00	40°32'16.408"N	104°45'09.202"W	0.00	
141.00	0.170	250.510	141.00	-0.16	-0.06	-0.16	40°32'16.407"N	104°45'09.204"W	0.15	
236.00	0.170	232.810	236.00	-0.40	-0.19	-0.41	40°32'16.406"N	104°45'09.207"W	0.06	
330.00	1.110	213.970	329.99	-0.97	-1.03	-1.03	40°32'16.397"N	104°45'09.215"W	1.01	
425.00	2.410	226.240	424.95	-2.81	-3.17	-2.98	40°32'16.376"N	104°45'09.240"W	1.42	
520.00	3.520	228.760	519.82	-6.26	-6.48	-6.62	40°32'16.344"N	104°45'09.287"W	1.18	
614.00	5.470	225.350	613.52	-11.34	-11.53	-11.98	40°32'16.294"N	104°45'09.357"W	2.09	
709.00	7.090	221.300	707.95	-18.01	-19.12	-19.07	40°32'16.219"N	104°45'09.449"W	1.77	
804.00	9.330	219.420	801.97	-26.20	-29.47	-27.83	40°32'16.116"N	104°45'09.562"W	2.37	
898.00	9.040	220.090	894.77	-35.16	-41.01	-37.42	40°32'16.002"N	104°45'09.686"W	0.33	
993.00	8.760	219.210	988.62	-43.92	-52.32	-46.80	40°32'15.891"N	104°45'09.808"W	0.33	
1088.00	8.130	218.450	1082.59	-52.07	-63.19	-55.55	40°32'15.783"N	104°45'09.921"W	0.67	
1182.00	9.190	222.540	1175.52	-60.69	-73.92	-64.76	40°32'15.677"N	104°45'10.040"W	1.30	
1277.00	8.710	222.090	1269.36	-70.04	-84.85	-74.71	40°32'15.569"N	104°45'10.169"W	0.51	
1372.00	8.250	219.840	1363.32	-78.65	-95.42	-83.90	40°32'15.465"N	104°45'10.288"W	0.60	
1467.00	9.040	219.060	1457.24	-87.11	-106.45	-92.97	40°32'15.356"N	104°45'10.406"W	0.84	
1512.00	8.930	221.870	1501.69	-91.37	-111.80	-97.53	40°32'15.303"N	104°45'10.465"W	1.01	
1591.00	8.950	219.940	1579.73	-98.90	-121.08	-105.57	40°32'15.211"N	104°45'10.569"W	0.38	FIRST BHGE SURVEY (447'FNL & 378'FWL,SEC.35)
1685.00	9.590	221.910	1672.50	-108.20	-132.51	-115.49	40°32'15.098"N	104°45'10.697"W	0.76	
1780.00	9.430	228.190	1766.20	-118.67	-143.59	-126.58	40°32'14.989"N	104°45'10.841"W	1.10	
1875.00	9.440	233.040	1859.92	-130.15	-153.46	-138.60	40°32'14.891"N	104°45'10.997"W	0.84	
1970.00	9.280	236.660	1953.65	-142.28	-162.35	-151.23	40°32'14.803"N	104°45'11.160"W	0.64	
2064.00	9.380	241.520	2046.41	-154.90	-170.17	-164.29	40°32'14.726"N	104°45'11.329"W	0.84	
2159.00	9.170	246.550	2140.17	-168.27	-176.88	-178.04	40°32'14.660"N	104°45'11.508"W	0.88	
2253.00	9.420	246.860	2232.94	-181.87	-182.88	-191.99	40°32'14.600"N	104°45'11.688"W	0.27	
2347.00	9.380	251.680	2325.68	-195.91	-188.31	-206.33	40°32'14.547"N	104°45'11.874"W	0.84	
2442.00	9.140	250.000	2419.44	-210.06	-193.33	-220.77	40°32'14.497"N	104°45'12.061"W	0.38	
2537.00	9.060	248.310	2513.24	-223.79	-198.67	-234.81	40°32'14.444"N	104°45'12.243"W	0.29	
2631.00	9.030	245.290	2606.07	-237.03	-204.49	-248.39	40°32'14.387"N	104°45'12.419"W	0.51	

Actual Wellpath Report

KTC FARMS E-35-36HC AWP

Page 3 of 10

REFERENCE WELLPATH IDENTIFICATION

Operator	BAYSWATER E & P LLC	Slot	SLOT#06 KTC FARMS E-35-36HC (327'FNL & 472'FWL,SEC.35)
Area	COLORADO	Well	KTC FARMS E-35-36HC
Field	WELD COUNTY (NAD83/TRUE NORTH)	Wellbore	KTC FARMS E-35-36HC AWB
Facility	SEC.35-T07N-R66W		

WELLPATH DATA (189 stations)

MD [ft]	Inclination [°]	Azimuth [°]	TVD [ft]	Vert Sect [ft]	North [ft]	East [ft]	Latitude	Longitude	DLS [°/100ft]	Comments
2726.00	9.090	245.310	2699.89	-250.27	-210.74	-261.98	40°32'14.325"N	104°45'12.595"W	0.06	
2821.00	9.140	243.910	2793.69	-263.50	-217.19	-275.58	40°32'14.261"N	104°45'12.771"W	0.24	
2915.00	9.180	237.430	2886.49	-276.11	-224.51	-288.60	40°32'14.189"N	104°45'12.939"W	1.10	
3010.00	9.110	227.490	2980.29	-287.53	-233.68	-300.53	40°32'14.099"N	104°45'13.094"W	1.66	
3105.00	9.000	215.530	3074.12	-296.78	-244.81	-310.40	40°32'13.989"N	104°45'13.222"W	1.98	
3200.00	8.380	209.480	3168.03	-303.85	-256.88	-318.12	40°32'13.869"N	104°45'13.322"W	1.16	
3293.00	8.360	210.930	3260.04	-310.02	-268.58	-324.93	40°32'13.754"N	104°45'13.410"W	0.23	
3388.00	8.350	212.140	3354.03	-316.59	-280.34	-332.15	40°32'13.637"N	104°45'13.504"W	0.19	
3483.00	8.290	218.480	3448.03	-323.91	-291.54	-340.08	40°32'13.527"N	104°45'13.606"W	0.97	
3578.00	8.170	217.260	3542.05	-331.67	-302.28	-348.43	40°32'13.421"N	104°45'13.714"W	0.22	
3673.00	8.140	212.950	3636.09	-338.81	-313.30	-356.18	40°32'13.312"N	104°45'13.815"W	0.64	
3767.00	8.250	213.980	3729.13	-345.59	-324.47	-363.56	40°32'13.201"N	104°45'13.910"W	0.20	
3863.00	8.400	215.130	3824.12	-352.84	-335.92	-371.45	40°32'13.088"N	104°45'14.012"W	0.23	
3957.00	8.490	208.490	3917.10	-359.46	-347.63	-378.71	40°32'12.972"N	104°45'14.107"W	1.04	
4052.00	8.360	203.320	4011.08	-364.86	-360.14	-384.79	40°32'12.849"N	104°45'14.185"W	0.81	
4147.00	8.200	200.810	4105.09	-369.31	-372.81	-389.93	40°32'12.724"N	104°45'14.252"W	0.42	
4241.00	8.280	207.940	4198.12	-374.20	-385.06	-395.48	40°32'12.603"N	104°45'14.324"W	1.09	
4335.00	8.250	211.680	4291.15	-380.27	-396.78	-402.20	40°32'12.487"N	104°45'14.411"W	0.57	
4430.00	8.140	210.510	4385.18	-386.63	-408.37	-409.19	40°32'12.372"N	104°45'14.501"W	0.21	
4525.00	8.250	212.830	4479.21	-393.11	-419.89	-416.30	40°32'12.258"N	104°45'14.593"W	0.37	
4620.00	8.330	217.380	4573.22	-400.37	-431.09	-424.17	40°32'12.148"N	104°45'14.695"W	0.70	
4715.00	8.040	217.250	4667.25	-407.98	-441.85	-432.37	40°32'12.041"N	104°45'14.802"W	0.31	
4809.00	8.170	214.990	4760.31	-415.20	-452.55	-440.18	40°32'11.936"N	104°45'14.903"W	0.37	
4903.00	7.950	209.150	4853.38	-421.59	-463.70	-447.18	40°32'11.826"N	104°45'14.993"W	0.90	
4998.00	8.980	206.350	4947.35	-427.41	-476.08	-453.67	40°32'11.703"N	104°45'15.077"W	1.17	
5093.00	8.850	208.960	5041.20	-433.52	-489.12	-460.50	40°32'11.574"N	104°45'15.166"W	0.45	
5187.00	8.830	212.060	5134.08	-440.18	-501.56	-467.83	40°32'11.451"N	104°45'15.261"W	0.51	
5282.00	8.840	221.850	5227.96	-448.28	-513.18	-476.57	40°32'11.337"N	104°45'15.374"W	1.58	
5376.00	8.840	221.850	5320.84	-457.32	-523.94	-486.21	40°32'11.230"N	104°45'15.499"W	0.00	
5471.00	8.680	233.380	5414.74	-467.41	-533.65	-496.83	40°32'11.134"N	104°45'15.636"W	1.85	

Actual Wellpath Report

KTC FARMS E-35-36HC AWP

Page 4 of 10

REFERENCE WELLPATH IDENTIFICATION

Operator	BAYSWATER E & P LLC	Slot	SLOT#06 KTC FARMS E-35-36HC (327'FNL & 472'FWL,SEC.35)
Area	COLORADO	Well	KTC FARMS E-35-36HC
Field	WELD COUNTY (NAD83/TRUE NORTH)	Wellbore	KTC FARMS E-35-36HC AWB
Facility	SEC.35-T07N-R66W		

WELLPATH DATA (189 stations)

MD [ft]	Inclination [°]	Azimuth [°]	TVD [ft]	Vert Sect [ft]	North [ft]	East [ft]	Latitude	Longitude	DLS [°/100ft]	Comments
5566.00	8.610	235.360	5508.66	-478.55	-541.97	-508.44	40°32'11.052"N	104°45'15.787"W	0.32	
5660.00	8.730	239.900	5601.59	-490.09	-549.55	-520.40	40°32'10.977"N	104°45'15.942"W	0.74	
5754.00	8.280	239.240	5694.56	-501.68	-556.59	-532.39	40°32'10.908"N	104°45'16.097"W	0.49	
5849.00	8.370	236.730	5788.56	-512.93	-563.88	-544.04	40°32'10.836"N	104°45'16.248"W	0.39	
5943.00	8.290	227.220	5881.57	-523.16	-572.24	-554.74	40°32'10.753"N	104°45'16.386"W	1.47	
6038.00	8.200	222.260	5975.59	-532.21	-581.90	-564.32	40°32'10.658"N	104°45'16.510"W	0.75	
6132.00	8.590	218.220	6068.58	-540.48	-592.38	-573.17	40°32'10.554"N	104°45'16.625"W	0.75	
6227.00	8.380	218.800	6162.54	-548.61	-603.35	-581.90	40°32'10.446"N	104°45'16.738"W	0.24	
6321.00	8.680	213.740	6255.50	-556.22	-614.58	-590.13	40°32'10.335"N	104°45'16.845"W	0.86	
6416.00	8.210	212.670	6349.47	-563.23	-626.26	-597.78	40°32'10.219"N	104°45'16.944"W	0.52	
6510.00	8.300	214.890	6442.50	-570.12	-637.47	-605.28	40°32'10.108"N	104°45'17.041"W	0.35	
6605.00	8.310	214.770	6536.50	-577.34	-648.73	-613.12	40°32'09.997"N	104°45'17.142"W	0.02	
6700.00	8.130	214.290	6630.53	-584.42	-659.92	-620.82	40°32'09.887"N	104°45'17.242"W	0.20	
6794.00	7.530	213.770	6723.65	-591.01	-670.54	-627.98	40°32'09.782"N	104°45'17.335"W	0.64	
6889.00	3.330	84.520	6818.40	-591.46	-675.46	-628.70	40°32'09.733"N	104°45'17.344"W	10.50	
6984.00	12.930	86.220	6912.34	-578.15	-674.49	-615.32	40°32'09.743"N	104°45'17.171"W	10.11	
7079.00	21.920	88.970	7002.88	-549.85	-673.47	-586.92	40°32'09.753"N	104°45'16.803"W	9.50	
7173.00	29.470	91.800	7087.53	-509.17	-673.88	-546.21	40°32'09.749"N	104°45'16.276"W	8.14	
7267.00	39.250	91.160	7165.04	-456.21	-675.21	-493.24	40°32'09.735"N	104°45'15.590"W	10.41	
7361.00	49.230	89.870	7232.30	-390.78	-675.74	-427.74	40°32'09.730"N	104°45'14.742"W	10.66	
7456.00	59.670	88.870	7287.45	-313.76	-674.84	-350.57	40°32'09.739"N	104°45'13.742"W	11.02	
7551.00	68.660	88.420	7328.81	-228.60	-672.81	-265.17	40°32'09.759"N	104°45'12.636"W	9.47	
7646.00	77.910	86.830	7356.11	-138.13	-669.01	-174.37	40°32'09.797"N	104°45'11.460"W	9.87	
7740.00	86.280	86.770	7369.02	-45.67	-663.82	-81.49	40°32'09.848"N	104°45'10.257"W	8.90	
7835.00	90.310	87.470	7371.85	48.76	-659.05	13.33	40°32'09.895"N	104°45'09.029"W	4.31	
7930.00	90.030	88.090	7371.57	143.35	-655.37	108.26	40°32'09.932"N	104°45'07.800"W	0.72	
8024.00	89.020	85.500	7372.35	236.77	-650.12	202.10	40°32'09.984"N	104°45'06.584"W	2.96	
8119.00	89.290	88.870	7373.75	331.24	-645.45	296.96	40°32'10.030"N	104°45'05.356"W	3.56	
8213.00	89.050	90.270	7375.11	425.05	-644.75	390.94	40°32'10.037"N	104°45'04.138"W	1.51	
8307.00	90.980	87.810	7375.08	518.81	-643.17	484.92	40°32'10.052"N	104°45'02.921"W	3.33	

Actual Wellpath Report

KTC FARMS E-35-36HC AWP

Page 5 of 10

REFERENCE WELLPATH IDENTIFICATION

Operator	BAYSWATER E & P LLC	Slot	SLOT#06 KTC FARMS E-35-36HC (327'FNL & 472'FWL,SEC.35)
Area	COLORADO	Well	KTC FARMS E-35-36HC
Field	WELD COUNTY (NAD83/TRUE NORTH)	Wellbore	KTC FARMS E-35-36HC AWB
Facility	SEC.35-T07N-R66W		

WELLPATH DATA (189 stations)

MD [ft]	Inclination [°]	Azimuth [°]	TVD [ft]	Vert Sect [ft]	North [ft]	East [ft]	Latitude	Longitude	DLS [°/100ft]	Comments
8402.00	90.220	88.880	7374.09	613.48	-640.43	579.87	40°32'10.079"N	104°45'01.691"W	1.38	
8496.00	90.090	91.930	7373.84	707.36	-641.09	673.86	40°32'10.073"N	104°45'00.474"W	3.25	
8591.00	90.090	93.700	7373.69	802.36	-645.76	768.74	40°32'10.026"N	104°44'59.245"W	1.86	
8686.00	90.120	93.700	7373.51	897.35	-651.89	863.54	40°32'09.966"N	104°44'58.017"W	0.03	
8780.00	90.580	93.360	7372.94	991.35	-657.68	957.36	40°32'09.909"N	104°44'56.802"W	0.61	
8875.00	88.150	90.740	7373.99	1086.31	-661.07	1052.28	40°32'09.875"N	104°44'55.573"W	3.76	
8969.00	90.490	86.510	7375.11	1179.99	-658.82	1146.22	40°32'09.897"N	104°44'54.356"W	5.14	
9063.00	91.660	83.940	7373.34	1273.08	-651.00	1239.86	40°32'09.975"N	104°44'53.144"W	3.00	
9158.00	92.340	87.650	7370.03	1367.24	-644.04	1334.53	40°32'10.043"N	104°44'51.917"W	3.97	
9252.00	92.370	90.030	7366.16	1460.90	-642.13	1428.43	40°32'10.062"N	104°44'50.701"W	2.53	
9346.00	92.430	90.130	7362.23	1554.69	-642.27	1522.35	40°32'10.061"N	104°44'49.485"W	0.12	
9441.00	92.460	89.880	7358.17	1649.46	-642.27	1617.26	40°32'10.061"N	104°44'48.256"W	0.26	
9535.00	92.400	88.070	7354.19	1743.13	-640.59	1711.16	40°32'10.077"N	104°44'47.040"W	1.92	
9630.00	90.030	87.840	7352.17	1837.72	-637.21	1806.07	40°32'10.110"N	104°44'45.810"W	2.51	
9724.00	90.000	90.210	7352.15	1931.48	-635.61	1900.05	40°32'10.126"N	104°44'44.593"W	2.52	
9819.00	89.880	90.420	7352.25	2026.37	-636.13	1995.05	40°32'10.121"N	104°44'43.363"W	0.25	
9913.00	89.970	89.560	7352.37	2120.23	-636.11	2089.04	40°32'10.121"N	104°44'42.145"W	0.92	
10008.00	89.970	89.410	7352.42	2215.05	-635.26	2184.04	40°32'10.129"N	104°44'40.915"W	0.16	
10103.00	89.910	90.660	7352.52	2309.91	-635.32	2279.04	40°32'10.129"N	104°44'39.685"W	1.32	
10198.00	90.030	91.740	7352.57	2404.86	-637.31	2374.02	40°32'10.109"N	104°44'38.455"W	1.14	
10292.00	89.170	91.690	7353.23	2498.83	-640.12	2467.97	40°32'10.081"N	104°44'37.238"W	0.92	
10387.00	89.050	92.110	7354.70	2593.80	-643.27	2562.91	40°32'10.050"N	104°44'36.008"W	0.46	
10481.00	88.980	88.160	7356.32	2687.64	-643.49	2656.87	40°32'10.048"N	104°44'34.791"W	4.20	
10577.00	90.000	85.580	7357.17	2783.06	-638.25	2752.72	40°32'10.099"N	104°44'33.550"W	2.89	
10672.00	89.940	85.290	7357.22	2877.22	-630.69	2847.42	40°32'10.174"N	104°44'32.323"W	0.31	
10766.00	89.290	84.200	7357.86	2970.22	-622.08	2941.02	40°32'10.259"N	104°44'31.111"W	1.35	
10860.00	91.080	85.700	7357.55	3063.27	-613.80	3034.65	40°32'10.341"N	104°44'29.898"W	2.48	
10954.00	90.890	87.940	7355.94	3156.69	-608.59	3128.48	40°32'10.392"N	104°44'28.683"W	2.39	
11049.00	91.850	90.180	7353.66	3251.42	-607.03	3223.43	40°32'10.407"N	104°44'27.453"W	2.56	
11144.00	88.220	84.670	7353.61	3345.90	-602.77	3318.29	40°32'10.449"N	104°44'26.225"W	6.94	

Actual Wellpath Report

KTC FARMS E-35-36HC AWP

Page 6 of 10

REFERENCE WELLPATH IDENTIFICATION

Operator	BAYSWATER E & P LLC	Slot	SLOT#06 KTC FARMS E-35-36HC (327'FNL & 472'FWL,SEC.35)
Area	COLORADO	Well	KTC FARMS E-35-36HC
Field	WELD COUNTY (NAD83/TRUE NORTH)	Wellbore	KTC FARMS E-35-36HC AWB
Facility	SEC.35-T07N-R66W		

WELLPATH DATA (189 stations)

MD [ft]	Inclination [°]	Azimuth [°]	TVD [ft]	Vert Sect [ft]	North [ft]	East [ft]	Latitude	Longitude	DLS [°/100ft]	Comments
11238.00	90.550	83.270	7354.62	3438.70	-592.89	3411.75	40°32'10.547"N	104°44'25.014"W	2.89	
11332.00	90.550	84.090	7353.71	3531.43	-582.55	3505.17	40°32'10.649"N	104°44'23.804"W	0.87	
11427.00	89.780	85.460	7353.44	3625.43	-573.90	3599.78	40°32'10.734"N	104°44'22.579"W	1.65	
11522.00	89.450	90.260	7354.08	3720.01	-570.35	3694.68	40°32'10.769"N	104°44'21.350"W	5.06	
11616.00	89.480	88.810	7354.96	3813.82	-569.59	3788.67	40°32'10.776"N	104°44'20.133"W	1.54	
11711.00	89.290	88.200	7355.98	3908.51	-567.11	3883.63	40°32'10.801"N	104°44'18.903"W	0.67	
11805.00	89.850	88.230	7356.68	4002.17	-564.18	3977.58	40°32'10.830"N	104°44'17.686"W	0.60	
11900.00	90.000	89.920	7356.81	4096.93	-562.65	4072.57	40°32'10.845"N	104°44'16.456"W	1.79	
11995.00	89.970	91.660	7356.83	4191.85	-563.96	4167.55	40°32'10.831"N	104°44'15.225"W	1.83	
12089.00	90.150	92.920	7356.73	4285.84	-567.71	4261.48	40°32'10.794"N	104°44'14.009"W	1.35	
12183.00	89.970	92.070	7356.63	4379.84	-571.80	4355.39	40°32'10.754"N	104°44'12.793"W	0.92	
12278.00	89.970	90.130	7356.68	4474.78	-573.63	4450.37	40°32'10.735"N	104°44'11.563"W	2.04	
12373.00	90.030	89.240	7356.68	4569.61	-573.11	4545.36	40°32'10.740"N	104°44'10.332"W	0.94	
12467.00	90.400	91.440	7356.33	4663.49	-573.66	4639.36	40°32'10.735"N	104°44'09.115"W	2.37	
12562.00	90.150	92.520	7355.87	4758.47	-576.95	4734.30	40°32'10.702"N	104°44'07.885"W	1.17	
12657.00	90.000	92.240	7355.75	4853.47	-580.89	4829.21	40°32'10.663"N	104°44'06.656"W	0.33	
12752.00	90.060	93.790	7355.70	4948.46	-585.89	4924.08	40°32'10.613"N	104°44'05.427"W	1.63	
12846.00	89.970	93.930	7355.68	5042.46	-592.21	5017.87	40°32'10.551"N	104°44'04.213"W	0.18	
12941.00	90.000	93.930	7355.70	5137.44	-598.73	5112.64	40°32'10.486"N	104°44'02.985"W	0.03	
13036.00	90.030	92.330	7355.68	5232.44	-603.91	5207.50	40°32'10.435"N	104°44'01.757"W	1.68	
13130.00	90.000	91.260	7355.65	5326.42	-606.86	5301.45	40°32'10.405"N	104°44'00.540"W	1.14	
13225.00	90.120	90.660	7355.55	5421.35	-608.45	5396.44	40°32'10.389"N	104°43'59.310"W	0.64	
13319.00	89.910	88.570	7355.53	5515.17	-607.82	5490.43	40°32'10.395"N	104°43'58.092"W	2.23	
13413.00	90.030	85.310	7355.58	5608.62	-602.80	5584.28	40°32'10.445"N	104°43'56.877"W	3.47	
13508.00	90.370	83.720	7355.24	5702.56	-593.72	5678.84	40°32'10.534"N	104°43'55.652"W	1.71	
13602.00	90.220	83.300	7354.76	5795.25	-583.10	5772.24	40°32'10.639"N	104°43'54.442"W	0.47	
13697.00	90.250	85.310	7354.37	5889.13	-573.67	5866.77	40°32'10.732"N	104°43'53.218"W	2.12	
13791.00	90.400	88.140	7353.84	5982.54	-568.30	5960.60	40°32'10.785"N	104°43'52.003"W	3.01	
13886.00	90.490	89.340	7353.10	6077.26	-566.21	6055.57	40°32'10.805"N	104°43'50.773"W	1.27	
13980.00	90.520	89.040	7352.27	6171.04	-564.88	6149.56	40°32'10.818"N	104°43'49.555"W	0.32	

Actual Wellpath Report

KTC FARMS E-35-36HC AWP

Page 7 of 10

REFERENCE WELLPATH IDENTIFICATION

Operator	BAYSWATER E & P LLC	Slot	SLOT#06 KTC FARMS E-35-36HC (327'FNL & 472'FWL,SEC.35)
Area	COLORADO	Well	KTC FARMS E-35-36HC
Field	WELD COUNTY (NAD83/TRUE NORTH)	Wellbore	KTC FARMS E-35-36HC AWB
Facility	SEC.35-T07N-R66W		

WELLPATH DATA (189 stations)

MD [ft]	Inclination [°]	Azimuth [°]	TVD [ft]	Vert Sect [ft]	North [ft]	East [ft]	Latitude	Longitude	DLS [°/100ft]	Comments
14075.00	90.310	87.770	7351.58	6265.72	-562.24	6244.52	40°32'10.844"N	104°43'48.325"W	1.35	
14170.00	90.430	86.670	7350.97	6360.22	-557.63	6339.40	40°32'10.889"N	104°43'47.097"W	1.16	
14265.00	90.370	87.210	7350.31	6454.67	-552.56	6434.27	40°32'10.939"N	104°43'45.868"W	0.57	
14359.00	90.310	86.620	7349.75	6548.12	-547.50	6528.13	40°32'10.989"N	104°43'44.652"W	0.63	
14453.00	90.280	88.010	7349.26	6641.65	-543.10	6622.02	40°32'11.032"N	104°43'43.436"W	1.48	
14548.00	90.310	90.220	7348.78	6736.41	-541.63	6717.00	40°32'11.046"N	104°43'42.206"W	2.33	
14642.00	91.750	90.940	7347.09	6830.30	-542.58	6810.98	40°32'11.037"N	104°43'40.989"W	1.71	
14737.00	90.370	90.220	7345.33	6925.19	-543.54	6905.95	40°32'11.027"N	104°43'39.759"W	1.64	
14831.00	90.250	89.780	7344.82	7019.06	-543.54	6999.95	40°32'11.027"N	104°43'38.541"W	0.49	
14926.00	90.340	89.410	7344.33	7113.88	-542.87	7094.95	40°32'11.033"N	104°43'37.311"W	0.40	
15021.00	90.180	87.150	7343.90	7208.54	-540.02	7189.90	40°32'11.061"N	104°43'36.081"W	2.38	
15115.00	90.460	87.890	7343.37	7302.09	-535.95	7283.81	40°32'11.101"N	104°43'34.865"W	0.84	
15210.00	90.370	88.650	7342.69	7396.75	-533.08	7378.76	40°32'11.129"N	104°43'33.635"W	0.81	
15305.00	90.340	88.920	7342.10	7491.48	-531.07	7473.74	40°32'11.149"N	104°43'32.405"W	0.29	
15400.00	90.280	89.930	7341.58	7586.29	-530.12	7568.73	40°32'11.158"N	104°43'31.175"W	1.07	
15494.00	90.370	90.310	7341.05	7680.16	-530.31	7662.73	40°32'11.156"N	104°43'29.957"W	0.42	
15589.00	90.340	90.210	7340.46	7775.04	-530.74	7757.73	40°32'11.151"N	104°43'28.727"W	0.11	
15684.00	90.370	90.210	7339.87	7869.92	-531.09	7852.72	40°32'11.147"N	104°43'27.497"W	0.03	
15777.00	90.060	90.120	7339.52	7962.80	-531.36	7945.72	40°32'11.144"N	104°43'26.292"W	0.35	
15872.00	89.940	90.110	7339.52	8057.67	-531.55	8040.72	40°32'11.142"N	104°43'25.062"W	0.13	
15967.00	90.000	90.270	7339.57	8152.55	-531.87	8135.72	40°32'11.139"N	104°43'23.831"W	0.18	
16062.00	90.150	91.270	7339.45	8247.47	-533.14	8230.71	40°32'11.126"N	104°43'22.601"W	1.06	
16157.00	90.000	92.130	7339.33	8342.45	-535.96	8325.67	40°32'11.098"N	104°43'21.371"W	0.92	
16251.00	90.030	92.960	7339.30	8436.44	-540.13	8419.58	40°32'11.056"N	104°43'20.155"W	0.88	
16345.00	90.220	93.170	7339.10	8530.44	-545.16	8513.44	40°32'11.006"N	104°43'18.939"W	0.30	
16440.00	90.490	93.470	7338.51	8625.44	-550.66	8608.28	40°32'10.951"N	104°43'17.711"W	0.42	
16534.00	90.060	91.350	7338.06	8719.42	-554.61	8702.19	40°32'10.912"N	104°43'16.495"W	2.30	
16629.00	90.030	90.540	7337.98	8814.36	-556.18	8797.18	40°32'10.896"N	104°43'15.265"W	0.85	
16724.00	90.430	89.820	7337.60	8909.23	-556.48	8892.17	40°32'10.893"N	104°43'14.034"W	0.87	
16819.00	90.000	89.390	7337.24	9004.06	-555.83	8987.17	40°32'10.899"N	104°43'12.804"W	0.64	

Actual Wellpath Report

KTC FARMS E-35-36HC AWP

Page 8 of 10

REFERENCE WELLPATH IDENTIFICATION

Operator	BAYSWATER E & P LLC	Slot	SLOT#06 KTC FARMS E-35-36HC (327'FNL & 472'FWL,SEC.35)
Area	COLORADO	Well	KTC FARMS E-35-36HC
Field	WELD COUNTY (NAD83/TRUE NORTH)	Wellbore	KTC FARMS E-35-36HC AWB
Facility	SEC.35-T07N-R66W		

WELLPATH DATA (189 stations)

MD [ft]	Inclination [°]	Azimuth [°]	TVD [ft]	Vert Sect [ft]	North [ft]	East [ft]	Latitude	Longitude	DLS [°/100ft]	Comments
16913.00	90.120	87.480	7337.14	9097.74	-553.26	9081.13	40°32'10.924"N	104°43'11.587"W	2.04	
17007.00	90.060	87.030	7337.00	9191.26	-548.76	9175.02	40°32'10.968"N	104°43'10.371"W	0.48	
17101.00	89.970	85.540	7336.97	9284.59	-542.67	9268.82	40°32'11.028"N	104°43'09.156"W	1.59	
17196.00	90.060	84.020	7336.95	9378.60	-534.02	9363.43	40°32'11.113"N	104°43'07.931"W	1.60	
17291.00	90.060	84.550	7336.85	9472.48	-524.56	9457.95	40°32'11.206"N	104°43'06.706"W	0.56	
17385.00	90.090	83.740	7336.73	9565.34	-514.97	9551.46	40°32'11.301"N	104°43'05.495"W	0.86	
17480.00	89.940	84.620	7336.70	9659.19	-505.34	9645.97	40°32'11.395"N	104°43'04.271"W	0.94	
17538.00	90.000	85.140	7336.73	9716.60	-500.16	9703.74	40°32'11.446"N	104°43'03.523"W	0.90	LAST BHGE SURVEY (966'FNL & 497'FEL,SEC.36)
17563.00	90.000	85.140	7336.73	9741.36	-498.05	9728.65	40°32'11.467"N	104°43'03.200"W	0.00	PROJ TO BIT (964'FNL & 472'FEL,SEC.36)

Actual Wellpath Report

KTC FARMS E-35-36HC AWP

Page 9 of 10

REFERENCE WELLPATH IDENTIFICATION			
Operator	BAYSWATER E & P LLC	Slot	SLOT#06 KTC FARMS E-35-36HC (327'FNL & 472'FWL,SEC.35)
Area	COLORADO	Well	KTC FARMS E-35-36HC
Field	WELD COUNTY (NAD83/TRUE NORTH)	Wellbore	KTC FARMS E-35-36HC AWB
Facility	SEC.35-T07N-R66W		

TARGETS								
Name	TVD [ft]	North [ft]	East [ft]	Grid East [US ft]	Grid North [US ft]	Latitude	Longitude	Shape
KTC FARMS E-35-36HC BHL PLAT (990'FNL & 470'FEL,SEC.36)	7336.00	-524.16	9731.34	3217480.10	1439227.91	40°32'11.209"N	104°43'03.166"W	point
KTC FARMS E-35-36HC WP3 REV-1 (1400'fWP2,-2455'SSTVD)	7341.00	-613.64	3442.30	3211192.25	1439085.43	40°32'10.342"N	104°44'24.619"W	point
KTC FARMS E-35-36HC WP4 REV-1 (4000'fWP3,-2455'SSTVD)	7341.00	-556.73	7441.89	3215191.08	1439176.04	40°32'10.895"N	104°43'32.818"W	point
KTC FARMS E-35-36HC WP2 REV-1 (600'fWP1,-2475'SSTVD)	7361.00	-633.55	2042.44	3209792.65	1439053.72	40°32'10.146"N	104°44'42.749"W	point
KTC FARMS E-35-36HC LP REV-1 (990'FNL & 470'FWL,SEC.35)	7371.00	-663.43	-56.98	3207693.62	1439006.15	40°32'09.852"N	104°45'09.940"W	point
KTC FARMS E-35-36HC WP1 REV-1 (1500'FLP,-2485'SSTVD)	7371.00	-642.09	1442.82	3209193.14	1439040.12	40°32'10.062"N	104°44'50.515"W	point
SEC.35-T07N-R66W	12000.00	75.05	-1.11	3207743.27	1439745.05	40°32'17.149"N	104°45'09.216"W	polygon
SEC.36-T07N-R66W	12000.00	75.05	-1.11	3207743.27	1439745.05	40°32'17.149"N	104°45'09.216"W	polygon

WELLPATH COMPOSITION - Ref Wellbore: KTC FARMS E-35-36HC AWB Ref Wellpath: KTC FARMS E-35-36HC AWP				
Start MD [ft]	End MD [ft]	Positional Uncertainty Model	Log Name/Comment	Wellbore
25.00	1512.00	BHI NaviTrak (Standard)	BHI NAVITRAK (STANDARD) <141-1512>	KTC FARMS E-35-36HC AWB
1512.00	17538.00	BHI AutoTrak Curve (Short)	BHI AUTOTRAK CURVE (SHORT) <1591-17538>	KTC FARMS E-35-36HC AWB
17538.00	17563.00	Blind Drilling (std)	Projection to bit	KTC FARMS E-35-36HC AWB

Actual Wellpath Report

KTC FARMS E-35-36HC AWP

Page 10 of 10

REFERENCE WELLPATH IDENTIFICATION

Operator	BAYSWATER E & P LLC	Slot	SLOT#06 KTC FARMS E-35-36HC (327'FNL & 472'FWL,SEC.35)
Area	COLORADO	Well	KTC FARMS E-35-36HC
Field	WELD COUNTY (NAD83/TRUE NORTH)	Wellbore	KTC FARMS E-35-36HC AWB
Facility	SEC.35-T07N-R66W		

WELLPATH COMMENTS

MD [ft]	Inclination [°]	Azimuth [°]	TVD [ft]	Comment
1591.00	8.950	219.940	1579.73	FIRST BHGE SURVEY (447'FNL & 378'FWL,SEC.35)
17538.00	90.000	85.140	7336.73	LAST BHGE SURVEY (966'FNL & 497'FEL,SEC.36)
17563.00	90.000	85.140	7336.73	PROJ TO BIT (964'FNL & 472'FEL,SEC.36)