

BAYSWATER E & P LLC

Location: COLORADO

Field: WELD COUNTY (NAD83/TRUE NORTH)

Facility: SEC.35-T07N-R66W

Slot: SLOT#05 KTC FARMS D-35-36HN (312'FNL & 470'FWL,SEC.35)

Well: KTC FARMS D-35-36HN

Wellbore: KTC FARMS D-35-36HN PWB

Plot reference wellpath is KTC FARMS D-35-36HN (REV-D.0) PWP

True vertical depths are referenced to TRUE 38 (4861'GL+25'KB@4886'RKB) (RKB)

Measured depths are referenced to TRUE 38 (4861'GL+25'KB@4886'RKB) (RKB)

TRUE 38 (4861'GL+25'KB@4886'RKB) (RKB) to Mean Sea Level: 4886 feet

Mean Sea Level to Ground level (At Slot: SLOT#05 KTC FARMS D-35-36HN (312'FNL & 470'FWL,SEC.35)): 0 feet

Coordinates are in feet referenced to Slot

Grid System: NAD83 / Lambert Colorado SP, Northern Zone (501), US feet

North Reference: True north

Scale: True distance

Depths are in feet

Created by: bushjamh on 2018-11-28

Database: Denver

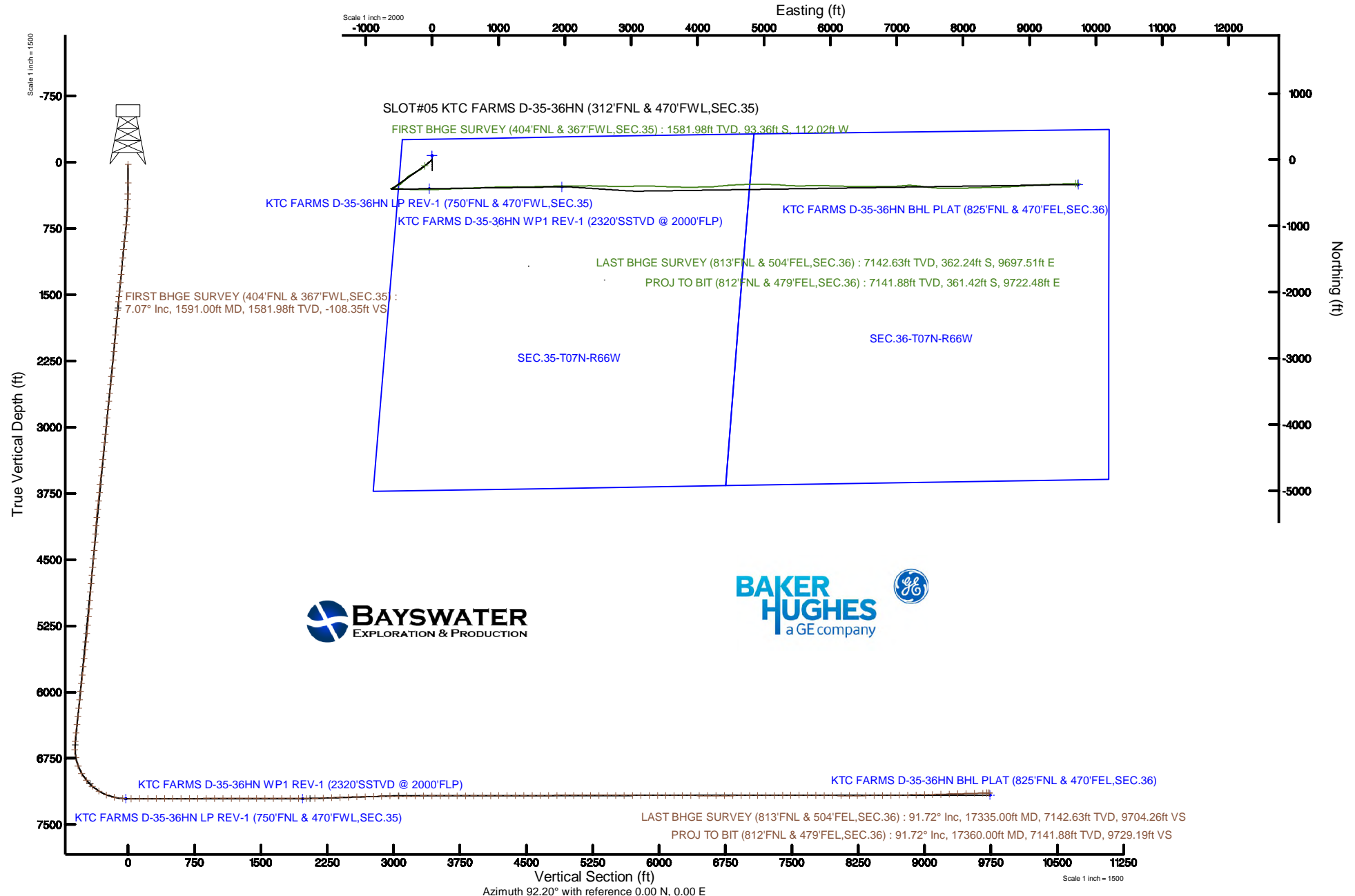

Actual Wellpath Report

KTC FARMS D-35-36HN AWP

Page 1 of 10

REFERENCE WELLPATH IDENTIFICATION			
Operator	BAYSWATER E & P LLC	Slot	SLOT#05 KTC FARMS D-35-36HN (312'FNL & 470'FWL,SEC.35)
Area	COLORADO	Well	KTC FARMS D-35-36HN
Field	WELD COUNTY (NAD83/TRUE NORTH)	Wellbore	KTC FARMS D-35-36HN AWB
Facility	SEC.35-T07N-R66W		

REPORT SETUP INFORMATION			
Projection System	NAD83 / Lambert Colorado SP, Northern Zone (501), US feet	Software System	WellArchitect® 5.1
North Reference	True	User	Bushjamh
Scale	0.999969	Report Generated	11/28/2018 at 4:03:23 AM
Convergence at slot	0.48° East	Database/Source file	Denver/KTC_FARMS_D-35-36HN_AWP.xml

WELLPATH LOCATION						
	Local coordinates		Grid coordinates		Geographic coordinates	
	North[ft]	East[ft]	Easting[US ft]	Northing[US ft]	Latitude	Longitude
Slot Location	-60.11	0.83	3207744.61	1439684.94	40°32'16.555"N	104°45'09.205"W
Facility Reference Pt			3207743.27	1439745.05	40°32'17.149"N	104°45'09.216"W
Field Reference Pt			3174587.00	1430859.71	40°30'51.890"N	104°52'19.470"W

WELLPATH DATUM			
Calculation method	Minimum curvature	TRUE 38 (4861'GL+25'KB@4886'RKB) (RKB) to Facility Vertical Datum	4886.00ft
Horizontal Reference Pt	Slot	TRUE 38 (4861'GL+25'KB@4886'RKB) (RKB) to Mean Sea Level	4886.00ft
Vertical Reference Pt	TRUE 38 (4861'GL+25'KB@4886'RKB) (RKB)	TRUE 38 (4861'GL+25'KB@4886'RKB) (RKB) to Ground Level at Slot (SLOT#05 KTC FARMS D-35-36HN (312'FNL & 470'FWL,SEC.35))	4886.00ft
MD Reference Pt	TRUE 38 (4861'GL+25'KB@4886'RKB) (RKB)	Section Origin	N 0.00, E 0.00 ft
Field Vertical Reference	Mean Sea Level	Section Azimuth	92.20°

Actual Wellpath Report

KTC FARMS D-35-36HN AWP

Page 2 of 10

REFERENCE WELLPATH IDENTIFICATION

Operator	BAYSWATER E & P LLC	Slot	SLOT#05 KTC FARMS D-35-36HN (312'FNL & 470'FWL,SEC.35)
Area	COLORADO	Well	KTC FARMS D-35-36HN
Field	WELD COUNTY (NAD83/TRUE NORTH)	Wellbore	KTC FARMS D-35-36HN AWB
Facility	SEC.35-T07N-R66W		

WELLPATH DATA (186 stations) † = interpolated/extrapolated station

MD [ft]	Inclination [°]	Azimuth [°]	TVD [ft]	Vert Sect [ft]	North [ft]	East [ft]	Latitude	Longitude	DLS [°/100ft]	Comments
0.00†	0.000	212.980	0.00	0.00	0.00	0.00	40°32'16.555"N	104°45'09.205"W	0.00	
25.00	0.000	212.980	25.00	0.00	0.00	0.00	40°32'16.555"N	104°45'09.205"W	0.00	
236.00	0.650	212.980	236.00	-0.61	-1.00	-0.65	40°32'16.545"N	104°45'09.214"W	0.31	
362.00	1.400	232.150	361.97	-2.16	-2.55	-2.26	40°32'16.530"N	104°45'09.234"W	0.65	
425.00	2.050	233.980	424.95	-3.63	-3.68	-3.78	40°32'16.519"N	104°45'09.254"W	1.04	
520.00	3.650	232.640	519.83	-7.30	-6.52	-7.55	40°32'16.491"N	104°45'09.303"W	1.69	
614.00	5.540	233.740	613.52	-13.16	-11.02	-13.59	40°32'16.446"N	104°45'09.381"W	2.01	
709.00	7.260	231.440	707.92	-21.30	-17.47	-21.98	40°32'16.383"N	104°45'09.490"W	1.83	
804.00	8.600	228.840	802.01	-31.01	-25.89	-32.02	40°32'16.299"N	104°45'09.620"W	1.46	
898.00	8.350	228.900	894.99	-41.08	-35.00	-42.46	40°32'16.209"N	104°45'09.755"W	0.27	
993.00	8.310	229.200	988.98	-51.12	-44.02	-52.85	40°32'16.120"N	104°45'09.890"W	0.06	
1088.00	7.770	228.700	1083.05	-60.80	-52.75	-62.88	40°32'16.034"N	104°45'10.020"W	0.57	
1182.00	7.380	227.870	1176.23	-69.73	-60.99	-72.13	40°32'15.953"N	104°45'10.139"W	0.43	
1277.00	6.690	227.820	1270.51	-78.05	-68.80	-80.75	40°32'15.875"N	104°45'10.251"W	0.73	
1372.00	7.500	233.100	1364.79	-86.82	-76.24	-89.81	40°32'15.802"N	104°45'10.368"W	1.09	
1467.00	7.530	232.800	1458.97	-96.44	-83.72	-99.73	40°32'15.728"N	104°45'10.497"W	0.05	
1527.00	7.180	231.640	1518.48	-102.32	-88.43	-105.80	40°32'15.681"N	104°45'10.575"W	0.63	
1591.00	7.070	231.530	1581.98	-108.35	-93.36	-112.02	40°32'15.633"N	104°45'10.656"W	0.17	FIRST BHGE SURVEY (404'FNL & 367'FWL,SEC.35)
1686.00	7.470	232.770	1676.22	-117.55	-100.73	-121.51	40°32'15.560"N	104°45'10.779"W	0.45	
1780.00	7.360	232.000	1769.43	-126.87	-108.14	-131.12	40°32'15.487"N	104°45'10.903"W	0.16	
1875.00	7.530	231.200	1863.63	-136.22	-115.78	-140.77	40°32'15.411"N	104°45'11.028"W	0.21	
1970.00	6.760	227.150	1957.89	-144.87	-123.49	-149.72	40°32'15.335"N	104°45'11.144"W	0.97	
2064.00	6.720	226.530	2051.24	-152.62	-131.03	-157.77	40°32'15.260"N	104°45'11.249"W	0.09	
2159.00	6.720	230.770	2145.59	-160.67	-138.37	-166.11	40°32'15.188"N	104°45'11.357"W	0.52	
2254.00	6.710	234.640	2239.94	-169.24	-145.10	-174.94	40°32'15.121"N	104°45'11.471"W	0.48	
2348.00	6.740	236.350	2333.29	-178.06	-151.33	-184.01	40°32'15.060"N	104°45'11.588"W	0.22	
2443.00	7.040	240.290	2427.61	-187.52	-157.31	-193.71	40°32'15.001"N	104°45'11.714"W	0.59	
2538.00	7.200	242.750	2521.88	-197.65	-162.92	-204.05	40°32'14.945"N	104°45'11.848"W	0.36	
2632.00	7.030	244.020	2615.15	-207.85	-168.14	-214.46	40°32'14.894"N	104°45'11.983"W	0.25	
2726.00	7.080	243.320	2708.44	-217.99	-173.26	-224.81	40°32'14.843"N	104°45'12.117"W	0.11	

Actual Wellpath Report

KTC FARMS D-35-36HN AWP

Page 3 of 10

REFERENCE WELLPATH IDENTIFICATION

Operator	BAYSWATER E & P LLC	Slot	SLOT#05 KTC FARMS D-35-36HN (312'FNL & 470'FWL,SEC.35)
Area	COLORADO	Well	KTC FARMS D-35-36HN
Field	WELD COUNTY (NAD83/TRUE NORTH)	Wellbore	KTC FARMS D-35-36HN AWB
Facility	SEC.35-T07N-R66W		

WELLPATH DATA (186 stations)

MD [ft]	Inclination [°]	Azimuth [°]	TVD [ft]	Vert Sect [ft]	North [ft]	East [ft]	Latitude	Longitude	DLS [°/100ft]	Comments
2821.00	7.100	242.310	2802.71	-228.21	-178.61	-235.24	40°32'14.790"N	104°45'12.252"W	0.13	
2915.00	6.970	239.910	2896.01	-238.06	-184.17	-245.32	40°32'14.735"N	104°45'12.383"W	0.34	
3010.00	7.000	235.420	2990.30	-247.57	-190.35	-255.07	40°32'14.674"N	104°45'12.509"W	0.58	
3104.00	6.970	234.530	3083.61	-256.68	-196.91	-264.43	40°32'14.609"N	104°45'12.630"W	0.12	
3199.00	7.060	239.480	3177.89	-266.15	-203.22	-274.16	40°32'14.547"N	104°45'12.756"W	0.64	
3293.00	7.120	239.970	3271.18	-275.94	-209.07	-284.18	40°32'14.489"N	104°45'12.886"W	0.09	
3387.00	6.890	240.410	3364.47	-285.66	-214.77	-294.12	40°32'14.433"N	104°45'13.015"W	0.25	
3482.00	6.840	242.990	3458.79	-295.44	-220.15	-304.12	40°32'14.380"N	104°45'13.144"W	0.33	
3577.00	7.030	245.050	3553.10	-305.55	-225.17	-314.43	40°32'14.330"N	104°45'13.278"W	0.33	
3672.00	7.190	238.660	3647.37	-315.68	-230.72	-324.78	40°32'14.275"N	104°45'13.412"W	0.85	
3767.00	7.330	234.250	3741.61	-325.41	-237.35	-334.77	40°32'14.210"N	104°45'13.541"W	0.60	
3861.00	7.230	243.100	3834.85	-335.31	-243.53	-344.92	40°32'14.149"N	104°45'13.672"W	1.20	
3956.00	7.330	236.540	3929.09	-345.46	-249.57	-355.30	40°32'14.089"N	104°45'13.807"W	0.88	
4050.00	7.420	224.900	4022.32	-354.44	-257.18	-364.59	40°32'14.014"N	104°45'13.927"W	1.59	
4145.00	7.250	218.500	4116.54	-362.15	-266.22	-372.65	40°32'13.925"N	104°45'14.032"W	0.88	
4239.00	7.190	215.890	4209.80	-368.93	-275.62	-379.79	40°32'13.832"N	104°45'14.124"W	0.35	
4334.00	7.340	220.700	4304.03	-376.00	-285.04	-387.24	40°32'13.739"N	104°45'14.221"W	0.66	
4428.00	7.300	223.640	4397.27	-383.69	-293.92	-395.27	40°32'13.651"N	104°45'14.325"W	0.40	
4523.00	7.250	226.920	4491.50	-391.91	-302.38	-403.82	40°32'13.567"N	104°45'14.435"W	0.44	
4618.00	7.400	230.510	4585.73	-400.69	-310.36	-412.92	40°32'13.488"N	104°45'14.553"W	0.51	
4712.00	7.030	231.960	4678.99	-409.60	-317.76	-422.12	40°32'13.415"N	104°45'14.672"W	0.44	
4807.00	7.160	228.090	4773.26	-418.29	-325.29	-431.10	40°32'13.341"N	104°45'14.789"W	0.52	
4902.00	6.930	221.390	4867.54	-426.16	-333.55	-439.30	40°32'13.259"N	104°45'14.895"W	0.90	
4996.00	7.020	219.230	4960.85	-433.21	-342.25	-446.68	40°32'13.173"N	104°45'14.990"W	0.29	
5091.00	6.880	222.850	5055.15	-440.41	-350.92	-454.22	40°32'13.088"N	104°45'15.088"W	0.48	
5186.00	6.960	230.510	5149.46	-448.41	-358.75	-462.53	40°32'13.010"N	104°45'15.196"W	0.97	
5281.00	7.030	234.700	5243.75	-457.32	-365.77	-471.72	40°32'12.941"N	104°45'15.315"W	0.54	
5375.00	7.080	241.120	5337.04	-466.85	-371.89	-481.49	40°32'12.880"N	104°45'15.441"W	0.84	
5469.00	6.710	245.220	5430.36	-476.71	-376.99	-491.55	40°32'12.830"N	104°45'15.572"W	0.65	
5564.00	7.050	241.980	5524.68	-486.69	-382.06	-501.73	40°32'12.780"N	104°45'15.703"W	0.54	

Actual Wellpath Report

KTC FARMS D-35-36HN AWP

Page 4 of 10

REFERENCE WELLPATH IDENTIFICATION

Operator	BAYSWATER E & P LLC	Slot	SLOT#05 KTC FARMS D-35-36HN (312'FNL & 470'FWL,SEC.35)
Area	COLORADO	Well	KTC FARMS D-35-36HN
Field	WELD COUNTY (NAD83/TRUE NORTH)	Wellbore	KTC FARMS D-35-36HN AWB
Facility	SEC.35-T07N-R66W		

WELLPATH DATA (186 stations)

MD [ft]	Inclination [°]	Azimuth [°]	TVD [ft]	Vert Sect [ft]	North [ft]	East [ft]	Latitude	Longitude	DLS [°/100ft]	Comments
5658.00	6.800	242.450	5617.99	-496.50	-387.34	-511.76	40°32'12.728"N	104°45'15.833"W	0.27	
5752.00	6.910	242.620	5711.32	-506.25	-392.52	-521.71	40°32'12.677"N	104°45'15.962"W	0.12	
5847.00	7.130	243.870	5805.61	-516.41	-397.74	-532.08	40°32'12.625"N	104°45'16.097"W	0.28	
5942.00	7.050	241.660	5899.88	-526.62	-403.11	-542.51	40°32'12.572"N	104°45'16.232"W	0.30	
6037.00	7.070	243.990	5994.16	-536.80	-408.44	-552.89	40°32'12.519"N	104°45'16.366"W	0.30	
6131.00	7.120	244.040	6087.44	-547.03	-413.52	-563.33	40°32'12.469"N	104°45'16.501"W	0.05	
6225.00	7.150	243.130	6180.72	-557.28	-418.72	-573.78	40°32'12.418"N	104°45'16.637"W	0.12	
6320.00	7.360	246.080	6274.96	-567.91	-423.86	-584.62	40°32'12.367"N	104°45'16.777"W	0.45	
6415.00	7.050	246.040	6369.21	-578.61	-428.69	-595.51	40°32'12.319"N	104°45'16.918"W	0.33	
6509.00	7.200	248.690	6462.48	-589.19	-433.18	-606.27	40°32'12.275"N	104°45'17.057"W	0.38	
6604.00	5.610	244.140	6556.88	-598.74	-437.37	-616.00	40°32'12.233"N	104°45'17.183"W	1.76	
6699.00	1.990	72.790	6651.77	-601.29	-438.91	-618.60	40°32'12.218"N	104°45'17.217"W	7.98	
6793.00	11.260	80.840	6745.04	-590.73	-436.96	-607.96	40°32'12.237"N	104°45'17.079"W	9.89	
6887.00	20.080	88.840	6835.46	-565.57	-435.17	-582.71	40°32'12.255"N	104°45'16.752"W	9.64	
6982.00	29.390	91.590	6921.66	-525.89	-435.48	-543.02	40°32'12.252"N	104°45'16.238"W	9.87	
7077.00	40.080	93.000	6999.62	-471.84	-437.74	-489.02	40°32'12.230"N	104°45'15.539"W	11.28	
7171.00	48.850	93.840	7066.64	-406.08	-441.70	-423.36	40°32'12.191"N	104°45'14.688"W	9.35	
7266.00	59.720	93.470	7122.01	-329.09	-446.59	-346.50	40°32'12.142"N	104°45'13.693"W	11.45	
7361.00	67.930	91.100	7163.88	-243.91	-449.93	-261.38	40°32'12.109"N	104°45'12.591"W	8.93	
7455.00	77.110	89.400	7192.09	-154.40	-450.28	-171.83	40°32'12.106"N	104°45'11.431"W	9.92	
7550.00	86.950	88.950	7205.25	-60.57	-448.93	-77.87	40°32'12.119"N	104°45'10.214"W	10.37	
7645.00	90.150	90.030	7207.65	34.28	-448.08	17.08	40°32'12.128"N	104°45'08.984"W	3.55	
7739.00	90.030	88.890	7207.50	128.17	-447.19	111.08	40°32'12.136"N	104°45'07.767"W	1.22	
7834.00	90.030	87.600	7207.45	222.94	-444.29	206.03	40°32'12.165"N	104°45'06.537"W	1.36	
7928.00	90.060	87.520	7207.38	316.63	-440.28	299.95	40°32'12.205"N	104°45'05.320"W	0.09	
8023.00	90.310	88.070	7207.07	411.35	-436.63	394.87	40°32'12.241"N	104°45'04.091"W	0.64	
8117.00	90.220	88.040	7206.64	505.11	-433.44	488.82	40°32'12.272"N	104°45'02.874"W	0.10	
8212.00	90.000	87.110	7206.46	599.79	-429.42	583.73	40°32'12.312"N	104°45'01.645"W	1.01	
8307.00	90.340	87.840	7206.17	694.47	-425.23	678.64	40°32'12.353"N	104°45'00.416"W	0.85	
8401.00	90.310	87.180	7205.64	788.15	-421.15	772.55	40°32'12.394"N	104°44'59.199"W	0.70	

Actual Wellpath Report

KTC FARMS D-35-36HN AWP

Page 5 of 10

REFERENCE WELLPATH IDENTIFICATION

Operator	BAYSWATER E & P LLC	Slot	SLOT#05 KTC FARMS D-35-36HN (312'FNL & 470'FWL,SEC.35)
Area	COLORADO	Well	KTC FARMS D-35-36HN
Field	WELD COUNTY (NAD83/TRUE NORTH)	Wellbore	KTC FARMS D-35-36HN AWB
Facility	SEC.35-T07N-R66W		

WELLPATH DATA (186 stations)

MD [ft]	Inclination [°]	Azimuth [°]	TVD [ft]	Vert Sect [ft]	North [ft]	East [ft]	Latitude	Longitude	DLS [°/100ft]	Comments
8496.00	90.340	87.730	7205.10	882.83	-416.93	867.45	40°32'12.435"N	104°44'57.970"W	0.58	
8591.00	90.220	88.280	7204.64	977.57	-413.62	962.39	40°32'12.468"N	104°44'56.741"W	0.59	
8686.00	89.910	89.270	7204.53	1072.40	-411.59	1057.37	40°32'12.488"N	104°44'55.511"W	1.09	
8780.00	90.280	90.070	7204.37	1166.31	-411.05	1151.37	40°32'12.493"N	104°44'54.293"W	0.94	
8875.00	90.150	90.130	7204.02	1261.24	-411.22	1246.37	40°32'12.491"N	104°44'53.063"W	0.15	
8970.00	90.090	89.640	7203.82	1356.16	-411.03	1341.37	40°32'12.493"N	104°44'51.832"W	0.52	
9064.00	90.120	89.090	7203.65	1450.05	-409.98	1435.36	40°32'12.504"N	104°44'50.615"W	0.59	
9159.00	90.060	88.150	7203.50	1544.86	-407.70	1530.33	40°32'12.526"N	104°44'49.385"W	0.99	
9254.00	89.720	87.490	7203.68	1639.58	-404.08	1625.26	40°32'12.562"N	104°44'48.155"W	0.78	
9348.00	89.910	89.260	7203.98	1733.37	-401.42	1719.22	40°32'12.588"N	104°44'46.939"W	1.89	
9443.00	90.090	89.770	7203.98	1828.26	-400.61	1814.22	40°32'12.596"N	104°44'45.708"W	0.57	
9538.00	89.940	89.750	7203.96	1923.18	-400.22	1909.22	40°32'12.600"N	104°44'44.478"W	0.16	
9632.00	89.850	89.390	7204.13	2017.08	-399.51	2003.21	40°32'12.607"N	104°44'43.260"W	0.39	
9727.00	92.090	89.660	7202.52	2111.95	-398.72	2098.19	40°32'12.614"N	104°44'42.030"W	2.37	
9821.00	91.850	88.820	7199.29	2205.77	-397.48	2192.12	40°32'12.627"N	104°44'40.814"W	0.93	
9916.00	91.880	88.260	7196.20	2300.53	-395.06	2287.04	40°32'12.650"N	104°44'39.584"W	0.59	
10009.00	91.880	90.110	7193.15	2393.35	-393.74	2379.98	40°32'12.663"N	104°44'38.381"W	1.99	
10104.00	91.750	91.370	7190.14	2488.27	-394.96	2474.92	40°32'12.651"N	104°44'37.151"W	1.33	
10199.00	92.000	92.160	7187.03	2583.21	-397.89	2569.83	40°32'12.622"N	104°44'35.922"W	0.87	
10293.00	91.450	92.200	7184.20	2677.17	-401.46	2663.71	40°32'12.587"N	104°44'34.706"W	0.59	
10388.00	91.510	90.610	7181.75	2772.12	-403.79	2758.65	40°32'12.564"N	104°44'33.476"W	1.67	
10482.00	91.570	89.460	7179.22	2866.02	-403.85	2852.62	40°32'12.563"N	104°44'32.259"W	1.22	
10577.00	91.570	89.010	7176.62	2960.86	-402.58	2947.57	40°32'12.575"N	104°44'31.029"W	0.47	
10671.00	89.820	88.510	7175.48	3054.68	-400.54	3041.54	40°32'12.595"N	104°44'29.812"W	1.94	
10766.00	89.780	89.620	7175.81	3149.53	-398.99	3136.52	40°32'12.611"N	104°44'28.582"W	1.17	
10861.00	90.430	89.620	7175.64	3244.44	-398.36	3231.52	40°32'12.617"N	104°44'27.352"W	0.68	
10955.00	90.430	91.810	7174.93	3338.40	-399.54	3325.50	40°32'12.605"N	104°44'26.134"W	2.33	
11050.00	89.970	92.330	7174.60	3433.39	-402.97	3420.44	40°32'12.571"N	104°44'24.905"W	0.73	
11144.00	89.910	92.480	7174.70	3527.39	-406.91	3514.36	40°32'12.532"N	104°44'23.689"W	0.17	
11238.00	90.340	91.440	7174.49	3621.39	-410.13	3608.30	40°32'12.500"N	104°44'22.472"W	1.20	

Actual Wellpath Report

KTC FARMS D-35-36HN AWP

Page 6 of 10

REFERENCE WELLPATH IDENTIFICATION

Operator	BAYSWATER E & P LLC	Slot	SLOT#05 KTC FARMS D-35-36HN (312'FNL & 470'FWL,SEC.35)
Area	COLORADO	Well	KTC FARMS D-35-36HN
Field	WELD COUNTY (NAD83/TRUE NORTH)	Wellbore	KTC FARMS D-35-36HN AWB
Facility	SEC.35-T07N-R66W		

WELLPATH DATA (186 stations)

MD [ft]	Inclination [°]	Azimuth [°]	TVD [ft]	Vert Sect [ft]	North [ft]	East [ft]	Latitude	Longitude	DLS [°/100ft]	Comments
11333.00	90.150	91.810	7174.09	3716.39	-412.82	3703.26	40°32'12.473"N	104°44'21.242"W	0.44	
11428.00	90.370	91.060	7173.65	3811.38	-415.20	3798.23	40°32'12.450"N	104°44'20.012"W	0.82	
11522.00	90.090	89.770	7173.28	3905.33	-415.88	3892.23	40°32'12.443"N	104°44'18.795"W	1.40	
11617.00	90.250	88.360	7173.00	4000.18	-414.33	3987.21	40°32'12.458"N	104°44'17.564"W	1.49	
11712.00	90.280	90.480	7172.56	4095.06	-413.37	4082.20	40°32'12.467"N	104°44'16.334"W	2.23	
11806.00	89.970	87.900	7172.35	4188.93	-412.04	4176.18	40°32'12.480"N	104°44'15.117"W	2.76	
11901.00	90.250	83.380	7172.17	4283.28	-404.82	4270.88	40°32'12.551"N	104°44'13.890"W	4.77	
11996.00	90.060	84.730	7171.91	4377.32	-394.98	4365.37	40°32'12.648"N	104°44'12.667"W	1.44	
12090.00	90.250	85.780	7171.66	4470.63	-387.21	4459.04	40°32'12.725"N	104°44'11.453"W	1.14	
12184.00	90.180	86.410	7171.30	4564.09	-380.80	4552.82	40°32'12.788"N	104°44'10.239"W	0.67	
12278.00	90.370	87.560	7170.85	4657.70	-375.86	4646.69	40°32'12.837"N	104°44'09.023"W	1.24	
12373.00	90.090	88.570	7170.47	4752.45	-372.65	4741.64	40°32'12.868"N	104°44'07.793"W	1.10	
12468.00	90.180	89.250	7170.25	4847.29	-370.85	4836.62	40°32'12.886"N	104°44'06.563"W	0.72	
12562.00	90.150	90.200	7169.98	4941.20	-370.39	4930.62	40°32'12.890"N	104°44'05.346"W	1.01	
12657.00	90.090	91.400	7169.78	5036.17	-371.72	5025.60	40°32'12.877"N	104°44'04.115"W	1.26	
12752.00	90.180	91.820	7169.55	5131.17	-374.39	5120.57	40°32'12.850"N	104°44'02.885"W	0.45	
12846.00	90.620	94.000	7168.90	5225.15	-379.16	5214.44	40°32'12.803"N	104°44'01.670"W	2.37	
12941.00	89.970	94.010	7168.41	5320.10	-385.80	5309.20	40°32'12.737"N	104°44'00.442"W	0.68	
13036.00	89.820	92.860	7168.58	5415.08	-391.49	5404.03	40°32'12.681"N	104°43'59.214"W	1.22	
13130.00	89.690	91.550	7168.98	5509.08	-395.10	5497.96	40°32'12.645"N	104°43'57.998"W	1.40	
13224.00	89.850	88.340	7169.36	5602.99	-395.01	5591.94	40°32'12.646"N	104°43'56.780"W	3.42	
13319.00	89.850	88.190	7169.61	5697.77	-392.14	5686.90	40°32'12.674"N	104°43'55.551"W	0.16	
13414.00	90.180	90.190	7169.59	5792.63	-390.80	5781.89	40°32'12.687"N	104°43'54.320"W	2.13	
13509.00	89.780	91.650	7169.62	5887.60	-392.32	5876.87	40°32'12.672"N	104°43'53.090"W	1.59	
13603.00	90.060	90.180	7169.75	5981.58	-393.82	5970.86	40°32'12.657"N	104°43'51.873"W	1.59	
13697.00	90.250	92.320	7169.50	6075.56	-395.87	6064.83	40°32'12.636"N	104°43'50.656"W	2.29	
13792.00	89.940	92.000	7169.34	6170.56	-399.45	6159.76	40°32'12.600"N	104°43'49.426"W	0.47	
13887.00	89.600	91.280	7169.72	6265.55	-402.17	6254.72	40°32'12.573"N	104°43'48.196"W	0.84	
13981.00	89.910	91.190	7170.12	6359.54	-404.20	6348.70	40°32'12.553"N	104°43'46.979"W	0.34	
14076.00	89.720	89.940	7170.43	6454.50	-405.13	6443.69	40°32'12.544"N	104°43'45.749"W	1.33	

Actual Wellpath Report

KTC FARMS D-35-36HN AWP

Page 7 of 10

REFERENCE WELLPATH IDENTIFICATION

Operator	BAYSWATER E & P LLC	Slot	SLOT#05 KTC FARMS D-35-36HN (312'FNL & 470'FWL,SEC.35)
Area	COLORADO	Well	KTC FARMS D-35-36HN
Field	WELD COUNTY (NAD83/TRUE NORTH)	Wellbore	KTC FARMS D-35-36HN AWB
Facility	SEC.35-T07N-R66W		

WELLPATH DATA (186 stations)

MD [ft]	Inclination [°]	Azimuth [°]	TVD [ft]	Vert Sect [ft]	North [ft]	East [ft]	Latitude	Longitude	DLS [°/100ft]	Comments
14170.00	89.820	89.890	7170.81	6548.42	-404.99	6537.69	40°32'12.545"N	104°43'44.531"W	0.12	
14265.00	89.690	88.790	7171.21	6643.30	-403.90	6632.68	40°32'12.555"N	104°43'43.301"W	1.17	
14359.00	90.490	90.200	7171.06	6737.19	-403.07	6726.67	40°32'12.563"N	104°43'42.084"W	1.72	
14454.00	90.340	92.880	7170.38	6832.17	-405.63	6821.63	40°32'12.538"N	104°43'40.854"W	2.83	
14548.00	89.910	88.020	7170.17	6926.10	-406.36	6915.60	40°32'12.530"N	104°43'39.637"W	5.19	
14643.00	90.340	84.370	7169.96	7020.56	-400.06	7010.37	40°32'12.592"N	104°43'38.409"W	3.87	
14737.00	90.400	84.640	7169.36	7113.72	-391.06	7103.94	40°32'12.681"N	104°43'37.198"W	0.29	
14831.00	90.370	90.410	7168.72	7207.36	-387.00	7197.81	40°32'12.721"N	104°43'35.982"W	6.14	
14926.00	90.220	97.040	7168.24	7302.27	-393.17	7292.55	40°32'12.659"N	104°43'34.755"W	6.98	
15019.00	90.180	96.870	7167.91	7394.95	-404.43	7384.87	40°32'12.548"N	104°43'33.559"W	0.19	
15113.00	90.250	96.480	7167.56	7488.66	-415.36	7478.23	40°32'12.440"N	104°43'32.350"W	0.42	
15207.00	90.150	95.100	7167.23	7582.48	-424.84	7571.75	40°32'12.346"N	104°43'31.139"W	1.47	
15302.00	89.570	91.650	7167.46	7677.44	-430.43	7666.57	40°32'12.290"N	104°43'29.911"W	3.68	
15396.00	89.540	90.680	7168.19	7771.42	-432.34	7760.54	40°32'12.271"N	104°43'28.694"W	1.03	
15491.00	89.510	90.440	7168.98	7866.38	-433.27	7855.54	40°32'12.262"N	104°43'27.463"W	0.25	
15585.00	89.450	88.810	7169.83	7960.28	-432.66	7949.53	40°32'12.267"N	104°43'26.246"W	1.74	
15679.00	89.570	86.780	7170.64	8053.99	-429.04	8043.45	40°32'12.303"N	104°43'25.030"W	2.16	
15774.00	90.220	88.510	7170.81	8148.69	-425.14	8138.36	40°32'12.341"N	104°43'23.800"W	1.95	
15868.00	90.090	88.390	7170.56	8242.49	-422.59	8232.33	40°32'12.366"N	104°43'22.583"W	0.19	
15963.00	90.150	86.700	7170.36	8337.17	-418.52	8327.24	40°32'12.406"N	104°43'21.354"W	1.78	
16057.00	90.220	88.920	7170.05	8430.89	-414.93	8421.16	40°32'12.441"N	104°43'20.137"W	2.36	
16152.00	90.220	90.440	7169.69	8525.79	-414.40	8516.16	40°32'12.446"N	104°43'18.907"W	1.60	
16247.00	90.920	87.710	7168.74	8620.64	-412.87	8611.13	40°32'12.461"N	104°43'17.677"W	2.97	
16341.00	91.080	86.600	7167.10	8714.26	-408.20	8705.00	40°32'12.506"N	104°43'16.461"W	1.19	
16436.00	90.830	86.360	7165.52	8808.77	-402.37	8799.81	40°32'12.564"N	104°43'15.233"W	0.36	
16530.00	90.770	86.840	7164.21	8902.31	-396.80	8893.63	40°32'12.618"N	104°43'14.018"W	0.51	
16625.00	90.920	86.330	7162.81	8996.84	-391.14	8988.45	40°32'12.674"N	104°43'12.790"W	0.56	
16719.00	91.630	86.560	7160.71	9090.35	-385.31	9082.25	40°32'12.731"N	104°43'11.575"W	0.79	
16814.00	91.660	87.290	7157.99	9184.90	-380.22	9177.07	40°32'12.781"N	104°43'10.347"W	0.77	
16909.00	91.750	86.980	7155.16	9279.49	-375.47	9271.91	40°32'12.828"N	104°43'09.119"W	0.34	

Actual Wellpath Report

KTC FARMS D-35-36HN AWP

Page 8 of 10

REFERENCE WELLPATH IDENTIFICATION

Operator	BAYSWATER E & P LLC	Slot	SLOT#05 KTC FARMS D-35-36HN (312'FNL & 470'FWL,SEC.35)
Area	COLORADO	Well	KTC FARMS D-35-36HN
Field	WELD COUNTY (NAD83/TRUE NORTH)	Wellbore	KTC FARMS D-35-36HN AWB
Facility	SEC.35-T07N-R66W		

WELLPATH DATA (186 stations)

MD [ft]	Inclination [°]	Azimuth [°]	TVD [ft]	Vert Sect [ft]	North [ft]	East [ft]	Latitude	Longitude	DLS [°/100ft]	Comments
17003.00	91.690	87.970	7152.34	9373.13	-371.33	9365.78	40°32'12.868"N	104°43'07.903"W	1.05	
17098.00	91.780	88.240	7149.46	9467.84	-368.19	9460.68	40°32'12.899"N	104°43'06.674"W	0.30	
17193.00	91.630	88.440	7146.64	9562.58	-365.44	9555.60	40°32'12.926"N	104°43'05.444"W	0.26	
17288.00	91.570	89.070	7143.98	9657.38	-363.38	9650.54	40°32'12.946"N	104°43'04.215"W	0.67	
17335.00	91.720	88.140	7142.63	9704.26	-362.24	9697.51	40°32'12.957"N	104°43'03.606"W	2.00	LAST BHGE SURVEY (813'FNL & 504'FEL,SEC.36)
17360.00	91.720	88.140	7141.88	9729.19	-361.42	9722.48	40°32'12.965"N	104°43'03.283"W	0.00	PROJ TO BIT (812'FNL & 479'FEL,SEC.36)

TARGETS

Name	TVD [ft]	North [ft]	East [ft]	Grid East [US ft]	Grid North [US ft]	Latitude	Longitude	Shape
KTC FARMS D-35-36HN BHL PLAT (825'FNL & 470'FEL,SEC.36)	7166.00	-374.06	9732.11	3217479.20	1439392.94	40°32'12.840"N	104°43'03.158"W	point
KTC FARMS D-35-36HN WP1 REV-1 (2320'SSTVD @ 2000'FLP)	7206.00	-409.84	1956.70	3209704.63	1439291.62	40°32'12.505"N	104°44'43.863"W	point
KTC FARMS D-35-36HN LP REV-1 (750'FNL & 470'FWL,SEC.35)	7206.00	-438.33	-43.08	3207705.22	1439246.28	40°32'12.224"N	104°45'09.763"W	point
SEC.35-T07N-R66W	12000.00	60.11	-0.83	3207743.27	1439745.05	40°32'17.149"N	104°45'09.216"W	polygon
SEC.36-T07N-R66W	12000.00	60.11	-0.83	3207743.27	1439745.05	40°32'17.149"N	104°45'09.216"W	polygon

Actual Wellpath Report

KTC FARMS D-35-36HN AWP

Page 9 of 10

REFERENCE WELLPATH IDENTIFICATION

Operator	BAYSWATER E & P LLC	Slot	SLOT#05 KTC FARMS D-35-36HN (312'FNL & 470'FWL,SEC.35)
Area	COLORADO	Well	KTC FARMS D-35-36HN
Field	WELD COUNTY (NAD83/TRUE NORTH)	Wellbore	KTC FARMS D-35-36HN AWB
Facility	SEC.35-T07N-R66W		

WELLPATH COMPOSITION - Ref Wellbore: KTC FARMS D-35-36HN AWB Ref Wellpath: KTC FARMS D-35-36HN AWP

Start MD [ft]	End MD [ft]	Positional Uncertainty Model	Log Name/Comment	Wellbore
25.00	1527.00	BHI NaviTrak (Standard)	BHI NAVITRAK (STANDARD) <236-1527>	KTC FARMS D-35-36HN AWB
1527.00	17335.00	BHI AutoTrak Curve (Short)	BHI AUTOTRAK CURVE (SHORT) <1591-17335>	KTC FARMS D-35-36HN AWB
17335.00	17360.00	Blind Drilling (std)	Projection to bit	KTC FARMS D-35-36HN AWB

Actual Wellpath Report

KTC FARMS D-35-36HN AWP

Page 10 of 10

REFERENCE WELLPATH IDENTIFICATION

Operator	BAYSWATER E & P LLC	Slot	SLOT#05 KTC FARMS D-35-36HN (312'FNL & 470'FWL,SEC.35)
Area	COLORADO	Well	KTC FARMS D-35-36HN
Field	WELD COUNTY (NAD83/TRUE NORTH)	Wellbore	KTC FARMS D-35-36HN AWB
Facility	SEC.35-T07N-R66W		

WELLPATH COMMENTS

MD [ft]	Inclination [°]	Azimuth [°]	TVD [ft]	Comment
1591.00	7.070	231.530	1581.98	FIRST BHGE SURVEY (404'FNL & 367'FWL,SEC.35)
17335.00	91.720	88.140	7142.63	LAST BHGE SURVEY (813'FNL & 504'FEL,SEC.36)
17360.00	91.720	88.140	7141.88	PROJ TO BIT (812'FNL & 479'FEL,SEC.36)