

Location:	COLORADO	Slot:	SLOT#04 KTC FARMS C-35-36HN (297'FNL & 469'FWL, SEC.35)
Field:	WELD COUNTY (NAD83/TRUE NORTH)	Well:	KTC FARMS C-35-36HN
Facility:	SEC.35-T07N-R66W	Wellbore:	KTC FARMS C-35-36HN PWB

Plot reference wellpath is KTC FARMS C-35-36HN (REV-E.0) PWP	Grid System: NAD83 / Lambert Colorado SP, Northern Zone (501), US feet
True vertical depths are referenced to TRUE 38 (4861'GL+25KB@4886'RKB) (RKB)	North Reference: True north
Measured depths are referenced to TRUE 38 (4861'GL+25KB@4886'RKB) (RKB)	Scale: True distance
TRUE 38 (4861'GL+25KB@4886'RKB) (RKB) to Mean Sea Level: 4886 feet	Depths are in feet
Mean Sea Level to Ground level (At Slot: SLOTH04 KTC FARMS C-35-36HN (297FNL & 469FWL,SEC.35)): 0 feet	Created by: bushjarnh on 2018-11-28
Coordinates are in feet referenced to Slot	Database: Denver

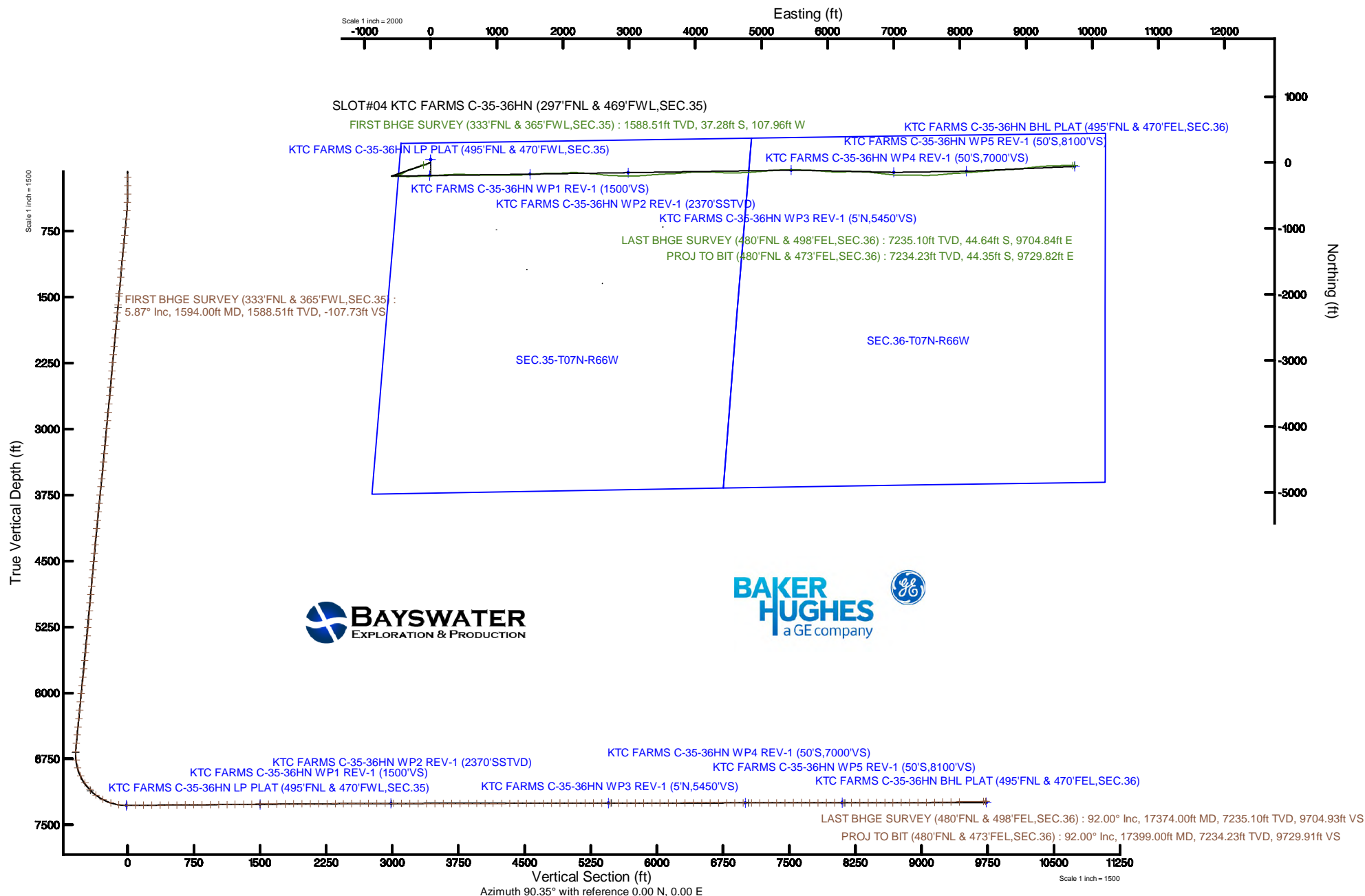

Actual Wellpath Report

KTC FARMS C-35-36HN AWP

Page 1 of 10

REFERENCE WELLPATH IDENTIFICATION

Operator	BAYSWATER E & P LLC	Slot	SLOT#04 KTC FARMS C-35-36HN (297'FNL & 469'FWL,SEC.35)
Area	COLORADO	Well	KTC FARMS C-35-36HN
Field	WELD COUNTY (NAD83/TRUE NORTH)	Wellbore	KTC FARMS C-35-36HN AWB
Facility	SEC.35-T07N-R66W		

REPORT SETUP INFORMATION

Projection System	NAD83 / Lambert Colorado SP, Northern Zone (501), US feet	Software System	WellArchitect® 5.1
North Reference	True	User	Bushjamh
Scale	0.999969	Report Generated	11/28/2018 at 4:03:45 AM
Convergence at slot	0.48° East	Database/Source file	Denver/KTC_FARMS_C-35-36HN_AWP.xml

WELLPATH LOCATION

	Local coordinates		Grid coordinates		Geographic coordinates	
	North[ft]	East[ft]	Easting[US ft]	Northing[US ft]	Latitude	Longitude
Slot Location	-45.18	0.56	3207744.20	1439699.88	40°32'16.703"N	104°45'09.209"W
Facility Reference Pt			3207743.27	1439745.05	40°32'17.149"N	104°45'09.216"W
Field Reference Pt			3174587.00	1430859.71	40°30'51.890"N	104°52'19.470"W

WELLPATH DATUM

Calculation method	Minimum curvature	TRUE 38 (4861'GL+25'KB@4886'RKB) (RKB) to Facility Vertical Datum	4886.00ft
Horizontal Reference Pt	Slot	TRUE 38 (4861'GL+25'KB@4886'RKB) (RKB) to Mean Sea Level	4886.00ft
Vertical Reference Pt	TRUE 38 (4861'GL+25'KB@4886'RKB) (RKB)	TRUE 38 (4861'GL+25'KB@4886'RKB) (RKB) to Ground Level at Slot (SLOT#04 KTC FARMS C-35-36HN (297'FNL & 469'FWL,SEC.35))	4886.00ft
MD Reference Pt	TRUE 38 (4861'GL+25'KB@4886'RKB) (RKB)	Section Origin	N 0.00, E 0.00 ft
Field Vertical Reference	Mean Sea Level	Section Azimuth	90.35°

Actual Wellpath Report

KTC FARMS C-35-36HN AWP

Page 2 of 10

REFERENCE WELLPATH IDENTIFICATION

Operator	BAYSWATER E & P LLC	Slot	SLOT#04 KTC FARMS C-35-36HN (297'FNL & 469'FWL,SEC.35)
Area	COLORADO	Well	KTC FARMS C-35-36HN
Field	WELD COUNTY (NAD83/TRUE NORTH)	Wellbore	KTC FARMS C-35-36HN AWB
Facility	SEC.35-T07N-R66W		

WELLPATH DATA (185 stations) † = interpolated/extrapolated station

MD [ft]	Inclination [°]	Azimuth [°]	TVD [ft]	Vert Sect [ft]	North [ft]	East [ft]	Latitude	Longitude	DLS [°/100ft]	Comments
0.00†	0.000	40.400	0.00	0.00	0.00	0.00	40°32'16.703"N	104°45'09.209"W	0.00	
25.00	0.000	40.400	25.00	0.00	0.00	0.00	40°32'16.703"N	104°45'09.209"W	0.00	
141.00	0.110	40.400	141.00	0.07	0.08	0.07	40°32'16.704"N	104°45'09.208"W	0.09	
236.00	0.090	46.570	236.00	0.18	0.21	0.19	40°32'16.705"N	104°45'09.206"W	0.02	
330.00	0.940	264.350	330.00	-0.53	0.18	-0.53	40°32'16.705"N	104°45'09.216"W	1.08	
425.00	2.590	259.600	424.95	-3.41	-0.28	-3.42	40°32'16.700"N	104°45'09.253"W	1.74	
520.00	4.100	252.870	519.78	-8.76	-1.67	-8.77	40°32'16.686"N	104°45'09.322"W	1.64	
614.00	5.540	247.550	613.45	-16.15	-4.39	-16.18	40°32'16.659"N	104°45'09.418"W	1.60	
709.00	6.460	246.010	707.93	-25.25	-8.32	-25.30	40°32'16.621"N	104°45'09.536"W	0.98	
804.00	6.350	244.520	802.33	-34.85	-12.75	-34.92	40°32'16.577"N	104°45'09.661"W	0.21	
898.00	6.270	244.270	895.77	-44.14	-17.22	-44.24	40°32'16.533"N	104°45'09.782"W	0.09	
993.00	6.270	244.560	990.20	-53.47	-21.70	-53.60	40°32'16.488"N	104°45'09.903"W	0.03	
1088.00	5.590	257.130	1084.69	-62.64	-24.96	-62.79	40°32'16.456"N	104°45'10.022"W	1.54	
1182.00	5.100	256.110	1178.28	-71.15	-26.98	-71.31	40°32'16.436"N	104°45'10.132"W	0.53	
1277.00	4.730	256.180	1272.93	-79.04	-28.93	-79.22	40°32'16.417"N	104°45'10.235"W	0.39	
1372.00	5.560	253.410	1367.55	-87.24	-31.18	-87.43	40°32'16.395"N	104°45'10.341"W	0.91	
1467.00	5.410	253.300	1462.12	-95.92	-33.78	-96.13	40°32'16.369"N	104°45'10.454"W	0.16	
1497.00	5.390	253.820	1491.98	-98.63	-34.58	-98.84	40°32'16.361"N	104°45'10.489"W	0.18	
1594.00	5.870	253.210	1588.51	-107.73	-37.28	-107.96	40°32'16.334"N	104°45'10.607"W	0.50	FIRST BHGE SURVEY (333'FNL & 365'FWL,SEC.35)
1688.00	5.980	252.990	1682.01	-117.00	-40.10	-117.25	40°32'16.307"N	104°45'10.727"W	0.12	
1783.00	5.990	249.340	1776.49	-126.35	-43.30	-126.62	40°32'16.275"N	104°45'10.849"W	0.40	
1878.00	6.140	248.570	1870.96	-135.70	-46.90	-135.98	40°32'16.239"N	104°45'10.970"W	0.18	
1973.00	5.890	248.860	1965.44	-144.95	-50.52	-145.26	40°32'16.204"N	104°45'11.090"W	0.27	
2068.00	6.090	247.870	2059.92	-154.14	-54.17	-154.47	40°32'16.167"N	104°45'11.210"W	0.24	
2162.00	5.850	247.690	2153.41	-163.17	-57.87	-163.52	40°32'16.131"N	104°45'11.327"W	0.26	
2256.00	5.070	242.940	2246.98	-171.28	-61.58	-171.66	40°32'16.094"N	104°45'11.432"W	0.96	
2349.00	4.860	240.870	2339.63	-178.36	-65.37	-178.76	40°32'16.057"N	104°45'11.524"W	0.30	
2443.00	4.680	244.830	2433.31	-185.28	-68.93	-185.71	40°32'16.022"N	104°45'11.614"W	0.40	
2538.00	5.860	250.880	2527.91	-193.35	-72.17	-193.80	40°32'15.990"N	104°45'11.719"W	1.37	
2632.00	5.880	252.950	2621.41	-202.47	-75.15	-202.93	40°32'15.960"N	104°45'11.837"W	0.23	

Actual Wellpath Report

KTC FARMS C-35-36HN AWP

Page 3 of 10

REFERENCE WELLPATH IDENTIFICATION

Operator	BAYSWATER E & P LLC	Slot	SLOT#04 KTC FARMS C-35-36HN (297'FNL & 469'FWL,SEC.35)
Area	COLORADO	Well	KTC FARMS C-35-36HN
Field	WELD COUNTY (NAD83/TRUE NORTH)	Wellbore	KTC FARMS C-35-36HN AWB
Facility	SEC.35-T07N-R66W		

WELLPATH DATA (185 stations)

MD [ft]	Inclination [°]	Azimuth [°]	TVD [ft]	Vert Sect [ft]	North [ft]	East [ft]	Latitude	Longitude	DLS [°/100ft]	Comments
2727.00	5.900	256.910	2715.91	-211.87	-77.69	-212.34	40°32'15.935"N	104°45'11.959"W	0.43	
2822.00	5.850	254.190	2810.41	-221.27	-80.11	-221.75	40°32'15.911"N	104°45'12.081"W	0.30	
2917.00	5.960	254.750	2904.91	-230.67	-82.73	-231.17	40°32'15.885"N	104°45'12.203"W	0.13	
3011.00	5.600	248.730	2998.43	-239.63	-85.68	-240.15	40°32'15.856"N	104°45'12.319"W	0.75	
3106.00	5.450	248.560	3092.99	-248.13	-89.01	-248.67	40°32'15.823"N	104°45'12.430"W	0.16	
3201.00	5.660	249.710	3187.55	-256.70	-92.28	-257.27	40°32'15.791"N	104°45'12.541"W	0.25	
3295.00	5.430	251.900	3281.11	-265.26	-95.27	-265.84	40°32'15.761"N	104°45'12.652"W	0.33	
3390.00	5.410	258.330	3375.68	-273.90	-97.57	-274.50	40°32'15.739"N	104°45'12.764"W	0.64	
3485.00	6.330	258.450	3470.18	-283.41	-99.53	-284.02	40°32'15.719"N	104°45'12.887"W	0.97	
3580.00	6.190	260.760	3564.62	-293.58	-101.40	-294.20	40°32'15.701"N	104°45'13.019"W	0.30	
3674.00	6.340	253.800	3658.06	-303.56	-103.66	-304.19	40°32'15.678"N	104°45'13.149"W	0.82	
3768.00	6.260	251.420	3751.49	-313.38	-106.74	-314.03	40°32'15.648"N	104°45'13.276"W	0.29	
3863.00	6.280	250.650	3845.92	-323.17	-110.11	-323.84	40°32'15.615"N	104°45'13.403"W	0.09	
3958.00	6.550	248.060	3940.33	-333.08	-113.86	-333.77	40°32'15.578"N	104°45'13.532"W	0.42	
4053.00	6.210	249.570	4034.74	-342.89	-117.68	-343.61	40°32'15.540"N	104°45'13.659"W	0.40	
4148.00	6.310	247.020	4129.17	-352.49	-121.51	-353.23	40°32'15.502"N	104°45'13.784"W	0.31	
4242.00	5.970	244.580	4222.63	-361.64	-125.62	-362.40	40°32'15.461"N	104°45'13.903"W	0.46	
4337.00	5.980	238.540	4317.12	-370.29	-130.33	-371.09	40°32'15.415"N	104°45'14.015"W	0.66	
4432.00	5.470	235.120	4411.64	-378.20	-135.50	-379.02	40°32'15.364"N	104°45'14.118"W	0.65	
4526.00	5.800	238.630	4505.19	-385.90	-140.53	-386.75	40°32'15.314"N	104°45'14.218"W	0.51	
4621.00	5.920	241.540	4599.69	-394.27	-145.37	-395.16	40°32'15.266"N	104°45'14.327"W	0.34	
4715.00	5.700	238.380	4693.21	-402.48	-150.12	-403.40	40°32'15.219"N	104°45'14.433"W	0.41	
4810.00	5.780	231.910	4787.73	-410.23	-155.55	-411.18	40°32'15.166"N	104°45'14.534"W	0.69	
4905.00	5.770	233.290	4882.25	-417.79	-161.35	-418.77	40°32'15.108"N	104°45'14.633"W	0.15	
4999.00	5.950	238.940	4975.76	-425.72	-166.69	-426.73	40°32'15.056"N	104°45'14.736"W	0.64	
5092.00	5.640	245.960	5068.29	-433.99	-171.04	-435.04	40°32'15.013"N	104°45'14.843"W	0.83	
5187.00	5.750	248.740	5162.82	-442.67	-174.67	-443.73	40°32'14.977"N	104°45'14.956"W	0.31	
5282.00	5.860	245.410	5257.33	-451.49	-178.41	-452.58	40°32'14.940"N	104°45'15.071"W	0.37	
5377.00	5.640	247.170	5351.85	-460.18	-182.24	-461.29	40°32'14.902"N	104°45'15.183"W	0.30	
5471.00	5.750	251.140	5445.39	-468.87	-185.56	-470.01	40°32'14.869"N	104°45'15.296"W	0.44	

Actual Wellpath Report

KTC FARMS C-35-36HN AWP

Page 4 of 10

REFERENCE WELLPATH IDENTIFICATION

Operator	BAYSWATER E & P LLC	Slot	SLOT#04 KTC FARMS C-35-36HN (297'FNL & 469'FWL,SEC.35)
Area	COLORADO	Well	KTC FARMS C-35-36HN
Field	WELD COUNTY (NAD83/TRUE NORTH)	Wellbore	KTC FARMS C-35-36HN AWB
Facility	SEC.35-T07N-R66W		

WELLPATH DATA (185 stations)

MD [ft]	Inclination [°]	Azimuth [°]	TVD [ft]	Vert Sect [ft]	North [ft]	East [ft]	Latitude	Longitude	DLS [°/100ft]	Comments
5566.00	6.040	252.860	5539.89	-478.13	-188.57	-479.29	40°32'14.839"N	104°45'15.416"W	0.36	
5661.00	5.870	256.270	5634.38	-487.61	-191.19	-488.78	40°32'14.813"N	104°45'15.539"W	0.41	
5755.00	5.860	263.590	5727.89	-497.04	-192.87	-498.22	40°32'14.797"N	104°45'15.662"W	0.80	
5850.00	5.930	269.170	5822.38	-506.76	-193.48	-507.94	40°32'14.791"N	104°45'15.788"W	0.61	
5944.00	6.110	266.390	5915.87	-516.61	-193.87	-517.79	40°32'14.787"N	104°45'15.915"W	0.36	
6038.00	5.920	263.460	6009.35	-526.41	-194.73	-527.60	40°32'14.778"N	104°45'16.042"W	0.38	
6132.00	5.800	260.460	6102.86	-535.90	-196.07	-537.10	40°32'14.765"N	104°45'16.165"W	0.35	
6227.00	5.860	259.870	6197.37	-545.40	-197.72	-546.61	40°32'14.749"N	104°45'16.288"W	0.09	
6321.00	5.750	259.390	6290.88	-554.74	-199.43	-555.96	40°32'14.732"N	104°45'16.409"W	0.13	
6416.00	5.700	258.300	6385.41	-564.03	-201.27	-565.26	40°32'14.714"N	104°45'16.530"W	0.13	
6511.00	5.590	256.950	6479.95	-573.14	-203.27	-574.39	40°32'14.694"N	104°45'16.648"W	0.18	
6605.00	5.800	256.110	6573.48	-582.20	-205.44	-583.46	40°32'14.673"N	104°45'16.766"W	0.24	
6699.00	2.580	242.210	6667.22	-588.67	-207.57	-589.94	40°32'14.652"N	104°45'16.850"W	3.57	
6794.00	6.410	87.210	6762.07	-585.26	-208.31	-586.53	40°32'14.644"N	104°45'16.805"W	9.28	
6889.00	16.420	87.130	6855.07	-566.51	-207.38	-567.77	40°32'14.654"N	104°45'16.562"W	10.54	
6983.00	25.210	91.350	6942.85	-533.16	-207.18	-534.42	40°32'14.655"N	104°45'16.131"W	9.48	
7078.00	34.480	92.980	7025.16	-485.97	-209.06	-487.24	40°32'14.637"N	104°45'15.519"W	9.79	
7172.00	43.040	92.850	7098.39	-427.23	-212.04	-428.52	40°32'14.607"N	104°45'14.759"W	9.11	
7265.00	52.380	90.550	7160.91	-358.53	-213.98	-359.84	40°32'14.588"N	104°45'13.869"W	10.21	
7360.00	61.810	87.650	7212.47	-278.90	-212.62	-280.19	40°32'14.602"N	104°45'12.838"W	10.25	
7455.00	72.010	87.440	7249.67	-191.73	-208.88	-193.00	40°32'14.639"N	104°45'11.708"W	10.74	
7549.00	81.600	88.420	7271.11	-100.40	-205.59	-101.65	40°32'14.671"N	104°45'10.525"W	10.25	
7643.00	90.150	87.430	7277.86	-6.82	-202.20	-8.04	40°32'14.705"N	104°45'09.313"W	9.16	
7736.00	90.400	86.110	7277.42	86.00	-196.96	84.81	40°32'14.757"N	104°45'08.110"W	1.44	
7831.00	90.370	85.200	7276.78	180.68	-189.76	179.53	40°32'14.828"N	104°45'06.884"W	0.96	
7925.00	90.220	86.800	7276.29	274.40	-183.20	273.30	40°32'14.892"N	104°45'05.669"W	1.71	
8020.00	90.400	89.030	7275.78	369.31	-179.75	368.23	40°32'14.927"N	104°45'04.440"W	2.35	
8114.00	90.680	90.620	7274.89	463.30	-179.46	462.22	40°32'14.929"N	104°45'03.222"W	1.72	
8209.00	90.580	91.350	7273.85	558.29	-181.09	557.20	40°32'14.913"N	104°45'01.992"W	0.78	
8303.00	90.550	92.140	7272.92	652.25	-183.95	651.15	40°32'14.885"N	104°45'00.775"W	0.84	

Actual Wellpath Report

KTC FARMS C-35-36HN AWP

Page 5 of 10

REFERENCE WELLPATH IDENTIFICATION

Operator	BAYSWATER E & P LLC	Slot	SLOT#04 KTC FARMS C-35-36HN (297'FNL & 469'FWL, SEC.35)
Area	COLORADO	Well	KTC FARMS C-35-36HN
Field	WELD COUNTY (NAD83/TRUE NORTH)	Wellbore	KTC FARMS C-35-36HN AWB
Facility	SEC.35-T07N-R66W		

WELLPATH DATA (185 stations)

MD [ft]	Inclination [°]	Azimuth [°]	TVD [ft]	Vert Sect [ft]	North [ft]	East [ft]	Latitude	Longitude	DLS [°/100ft]	Comments
8398.00	90.520	92.780	7272.03	747.18	-188.03	746.06	40°32'14.845"N	104°44'59.546"W	0.67	
8493.00	90.520	91.160	7271.17	842.14	-191.30	841.00	40°32'14.812"N	104°44'58.316"W	1.71	
8588.00	90.620	89.080	7270.23	937.13	-191.50	935.99	40°32'14.810"N	104°44'57.086"W	2.19	
8682.00	90.400	89.610	7269.39	1031.11	-190.42	1029.98	40°32'14.821"N	104°44'55.869"W	0.61	
8776.00	90.580	90.530	7268.59	1125.10	-190.54	1123.97	40°32'14.820"N	104°44'54.651"W	1.00	
8870.00	90.620	89.640	7267.60	1219.10	-190.68	1217.97	40°32'14.818"N	104°44'53.434"W	0.95	
8965.00	90.370	88.620	7266.78	1314.07	-189.23	1312.95	40°32'14.833"N	104°44'52.204"W	1.11	
9059.00	90.680	86.960	7265.92	1407.97	-185.61	1406.87	40°32'14.868"N	104°44'50.987"W	1.80	
9153.00	90.680	85.650	7264.80	1501.73	-179.55	1500.67	40°32'14.928"N	104°44'49.773"W	1.39	
9248.00	90.490	86.410	7263.83	1596.45	-172.97	1595.43	40°32'14.993"N	104°44'48.545"W	0.82	
9342.00	90.310	87.460	7263.18	1690.28	-167.95	1689.30	40°32'15.043"N	104°44'47.329"W	1.13	
9437.00	90.430	88.450	7262.56	1785.20	-164.56	1784.23	40°32'15.076"N	104°44'46.100"W	1.05	
9531.00	90.430	89.440	7261.86	1879.16	-162.83	1878.21	40°32'15.093"N	104°44'44.883"W	1.05	
9626.00	89.780	87.990	7261.68	1974.12	-160.70	1973.19	40°32'15.114"N	104°44'43.653"W	1.67	
9721.00	90.180	85.950	7261.72	2068.95	-155.68	2068.05	40°32'15.164"N	104°44'42.424"W	2.19	
9815.00	90.370	89.660	7261.27	2162.84	-152.08	2161.96	40°32'15.199"N	104°44'41.208"W	3.95	
9910.00	90.340	94.500	7260.68	2257.77	-155.52	2256.87	40°32'15.165"N	104°44'39.978"W	5.09	
10005.00	90.280	94.800	7260.16	2352.50	-163.22	2351.55	40°32'15.089"N	104°44'38.752"W	0.32	
10099.00	90.680	92.400	7259.38	2446.34	-169.13	2445.36	40°32'15.030"N	104°44'37.537"W	2.59	
10193.00	90.740	98.360	7258.21	2539.93	-177.94	2538.90	40°32'14.943"N	104°44'36.326"W	6.34	
10288.00	90.250	96.160	7257.39	2634.23	-189.94	2633.12	40°32'14.825"N	104°44'35.105"W	2.37	
10383.00	90.060	92.180	7257.13	2728.99	-196.85	2727.85	40°32'14.756"N	104°44'33.878"W	4.19	
10478.00	89.880	91.980	7257.18	2823.95	-200.29	2822.79	40°32'14.722"N	104°44'32.649"W	0.28	
10572.00	90.060	91.540	7257.23	2917.92	-203.18	2916.75	40°32'14.693"N	104°44'31.432"W	0.51	
10667.00	90.060	90.020	7257.13	3012.92	-204.47	3011.73	40°32'14.680"N	104°44'30.202"W	1.60	
10760.00	89.690	87.970	7257.33	3105.89	-202.84	3104.71	40°32'14.696"N	104°44'28.997"W	2.24	
10855.00	89.970	85.830	7257.62	3200.71	-197.71	3199.57	40°32'14.747"N	104°44'27.769"W	2.27	
10948.00	89.910	85.740	7257.71	3293.41	-190.87	3292.32	40°32'14.815"N	104°44'26.568"W	0.12	
11043.00	89.820	85.630	7257.94	3388.10	-183.72	3387.05	40°32'14.885"N	104°44'25.341"W	0.15	
11138.00	90.060	86.500	7258.04	3482.83	-177.20	3481.82	40°32'14.949"N	104°44'24.113"W	0.95	

Actual Wellpath Report

KTC FARMS C-35-36HN AWP

Page 6 of 10

REFERENCE WELLPATH IDENTIFICATION

Operator	BAYSWATER E & P LLC	Slot	SLOT#04 KTC FARMS C-35-36HN (297'FNL & 469'FWL,SEC.35)
Area	COLORADO	Well	KTC FARMS C-35-36HN
Field	WELD COUNTY (NAD83/TRUE NORTH)	Wellbore	KTC FARMS C-35-36HN AWB
Facility	SEC.35-T07N-R66W		

WELLPATH DATA (185 stations)

MD [ft]	Inclination [°]	Azimuth [°]	TVD [ft]	Vert Sect [ft]	North [ft]	East [ft]	Latitude	Longitude	DLS [°/100ft]	Comments
11233.00	90.000	87.640	7257.99	3577.68	-172.35	3576.70	40°32'14.997"N	104°44'22.884"W	1.20	
11327.00	90.220	87.540	7257.81	3671.57	-168.39	3670.61	40°32'15.036"N	104°44'21.668"W	0.26	
11422.00	89.970	85.070	7257.65	3766.32	-162.27	3765.41	40°32'15.096"N	104°44'20.440"W	2.61	
11517.00	90.180	84.790	7257.53	3860.90	-153.88	3860.04	40°32'15.179"N	104°44'19.214"W	0.37	
11612.00	90.250	86.460	7257.17	3955.57	-146.63	3954.76	40°32'15.251"N	104°44'17.988"W	1.76	
11707.00	90.430	89.050	7256.60	4050.46	-142.91	4049.67	40°32'15.287"N	104°44'16.758"W	2.73	
11801.00	90.120	90.750	7256.15	4144.46	-142.75	4143.67	40°32'15.289"N	104°44'15.541"W	1.84	
11896.00	90.340	91.600	7255.77	4239.45	-144.69	4238.65	40°32'15.269"N	104°44'14.311"W	0.92	
11990.00	90.520	93.170	7255.07	4333.38	-148.61	4332.56	40°32'15.231"N	104°44'13.094"W	1.68	
12085.00	90.370	93.120	7254.33	4428.26	-153.82	4427.41	40°32'15.179"N	104°44'11.866"W	0.17	
12180.00	90.150	90.410	7253.90	4523.23	-156.74	4522.36	40°32'15.150"N	104°44'10.636"W	2.86	
12275.00	90.220	88.570	7253.59	4618.21	-155.90	4617.35	40°32'15.158"N	104°44'09.406"W	1.94	
12370.00	90.120	88.380	7253.31	4713.16	-153.37	4712.32	40°32'15.183"N	104°44'08.176"W	0.23	
12464.00	90.150	86.260	7253.09	4807.02	-148.97	4806.21	40°32'15.226"N	104°44'06.960"W	2.26	
12559.00	89.850	85.210	7253.09	4901.71	-141.91	4900.94	40°32'15.296"N	104°44'05.733"W	1.15	
12654.00	90.060	85.170	7253.16	4996.33	-133.94	4995.61	40°32'15.374"N	104°44'04.507"W	0.23	
12748.00	89.880	86.030	7253.21	5090.01	-126.73	5089.33	40°32'15.445"N	104°44'03.293"W	0.93	
12844.00	90.120	85.850	7253.21	5185.72	-119.93	5185.09	40°32'15.512"N	104°44'02.053"W	0.31	
12939.00	89.850	86.550	7253.24	5280.47	-113.64	5279.88	40°32'15.574"N	104°44'00.825"W	0.79	
13033.00	90.250	88.110	7253.15	5374.34	-109.26	5373.78	40°32'15.617"N	104°43'59.609"W	1.71	
13128.00	90.030	92.260	7252.92	5469.32	-109.57	5468.75	40°32'15.614"N	104°43'58.379"W	4.37	
13222.00	90.060	91.710	7252.85	5563.28	-112.82	5562.70	40°32'15.582"N	104°43'57.162"W	0.59	
13316.00	90.000	91.520	7252.80	5657.26	-115.47	5656.66	40°32'15.555"N	104°43'55.945"W	0.21	
13411.00	90.000	91.600	7252.80	5752.23	-118.06	5751.62	40°32'15.530"N	104°43'54.715"W	0.08	
13506.00	90.180	94.620	7252.65	5847.11	-123.21	5846.47	40°32'15.478"N	104°43'53.487"W	3.18	
13601.00	90.340	95.620	7252.22	5941.78	-131.69	5941.09	40°32'15.394"N	104°43'52.261"W	1.07	
13695.00	90.310	94.090	7251.69	6035.49	-139.64	6034.75	40°32'15.316"N	104°43'51.048"W	1.63	
13790.00	90.400	90.490	7251.10	6130.41	-143.44	6129.66	40°32'15.278"N	104°43'49.819"W	3.79	
13884.00	90.220	87.780	7250.59	6224.38	-142.02	6223.64	40°32'15.292"N	104°43'48.602"W	2.89	
13979.00	90.060	88.800	7250.36	6319.32	-139.19	6318.59	40°32'15.319"N	104°43'47.372"W	1.09	

Actual Wellpath Report

KTC FARMS C-35-36HN AWP

Page 7 of 10

REFERENCE WELLPATH IDENTIFICATION

Operator	BAYSWATER E & P LLC	Slot	SLOT#04 KTC FARMS C-35-36HN (297'FNL & 469'FWL,SEC.35)
Area	COLORADO	Well	KTC FARMS C-35-36HN
Field	WELD COUNTY (NAD83/TRUE NORTH)	Wellbore	KTC FARMS C-35-36HN AWB
Facility	SEC.35-T07N-R66W		

WELLPATH DATA (185 stations)

MD [ft]	Inclination [°]	Azimuth [°]	TVD [ft]	Vert Sect [ft]	North [ft]	East [ft]	Latitude	Longitude	DLS [°/100ft]	Comments
14073.00	90.090	90.170	7250.23	6413.31	-138.34	6412.59	40°32'15.328"N	104°43'46.154"W	1.46	
14168.00	90.340	91.770	7249.88	6508.30	-139.95	6507.57	40°32'15.311"N	104°43'44.924"W	1.70	
14262.00	89.970	94.410	7249.62	6602.18	-145.02	6601.42	40°32'15.261"N	104°43'43.709"W	2.84	
14357.00	90.180	96.070	7249.50	6696.83	-153.69	6696.02	40°32'15.175"N	104°43'42.483"W	1.76	
14451.00	90.090	96.770	7249.28	6790.30	-164.20	6789.43	40°32'15.071"N	104°43'41.274"W	0.75	
14545.00	90.180	97.030	7249.05	6883.69	-175.50	6882.75	40°32'14.959"N	104°43'40.065"W	0.29	
14640.00	90.030	94.780	7248.88	6978.23	-185.27	6977.24	40°32'14.862"N	104°43'38.841"W	2.37	
14734.00	89.910	91.920	7248.93	7072.10	-190.76	7071.07	40°32'14.808"N	104°43'37.626"W	3.05	
14828.00	90.180	89.710	7248.86	7166.09	-192.10	7165.06	40°32'14.794"N	104°43'36.409"W	2.37	
14923.00	90.180	89.550	7248.56	7261.08	-191.48	7260.05	40°32'14.800"N	104°43'35.178"W	0.17	
15018.00	90.030	91.140	7248.38	7356.08	-192.06	7355.05	40°32'14.794"N	104°43'33.948"W	1.68	
15113.00	90.120	91.400	7248.26	7451.06	-194.16	7450.02	40°32'14.773"N	104°43'32.718"W	0.29	
15207.00	89.940	88.120	7248.21	7545.05	-193.77	7544.01	40°32'14.777"N	104°43'31.501"W	3.49	
15302.00	90.060	86.170	7248.21	7639.89	-189.04	7638.89	40°32'14.823"N	104°43'30.272"W	2.06	
15396.00	89.880	84.590	7248.26	7733.54	-181.47	7732.58	40°32'14.898"N	104°43'29.058"W	1.69	
15491.00	89.940	84.960	7248.41	7828.09	-172.81	7827.18	40°32'14.983"N	104°43'27.833"W	0.39	
15585.00	90.250	86.240	7248.25	7921.76	-165.60	7920.91	40°32'15.054"N	104°43'26.619"W	1.40	
15680.00	89.820	86.960	7248.19	8016.56	-159.97	8015.74	40°32'15.109"N	104°43'25.391"W	0.88	
15774.00	90.090	85.060	7248.27	8110.29	-153.43	8109.51	40°32'15.174"N	104°43'24.176"W	2.04	
15869.00	90.120	85.220	7248.09	8204.89	-145.38	8204.16	40°32'15.253"N	104°43'22.950"W	0.17	
15964.00	90.120	85.730	7247.90	8299.55	-137.88	8298.87	40°32'15.327"N	104°43'21.724"W	0.54	
16058.00	89.850	85.820	7247.92	8393.25	-130.96	8392.61	40°32'15.395"N	104°43'20.510"W	0.30	
16153.00	90.120	85.200	7247.94	8487.91	-123.52	8487.32	40°32'15.468"N	104°43'19.283"W	0.71	
16248.00	90.090	85.380	7247.77	8582.54	-115.72	8582.00	40°32'15.545"N	104°43'18.057"W	0.19	
16342.00	90.120	85.530	7247.60	8676.20	-108.27	8675.70	40°32'15.618"N	104°43'16.843"W	0.16	
16437.00	90.120	87.750	7247.40	8770.99	-102.71	8770.53	40°32'15.673"N	104°43'15.615"W	2.34	
16532.00	89.880	86.210	7247.40	8865.83	-97.70	8865.40	40°32'15.722"N	104°43'14.386"W	1.64	
16627.00	90.090	83.220	7247.42	8960.36	-88.95	8959.98	40°32'15.808"N	104°43'13.161"W	3.16	
16721.00	91.110	82.620	7246.44	9053.56	-77.37	9053.26	40°32'15.922"N	104°43'11.953"W	1.26	
16815.00	91.080	83.940	7244.64	9146.83	-66.37	9146.60	40°32'16.030"N	104°43'10.744"W	1.40	

Actual Wellpath Report

KTC FARMS C-35-36HN AWP

Page 8 of 10

REFERENCE WELLPATH IDENTIFICATION

Operator	BAYSWATER E & P LLC	Slot	SLOT#04 KTC FARMS C-35-36HN (297'FNL & 469'FWL,SEC.35)
Area	COLORADO	Well	KTC FARMS C-35-36HN
Field	WELD COUNTY (NAD83/TRUE NORTH)	Wellbore	KTC FARMS C-35-36HN AWB
Facility	SEC.35-T07N-R66W		

WELLPATH DATA (185 stations)

MD [ft]	Inclination [°]	Azimuth [°]	TVD [ft]	Vert Sect [ft]	North [ft]	East [ft]	Latitude	Longitude	DLS [°/100ft]	Comments
16909.00	91.020	85.740	7242.92	9240.38	-57.92	9240.19	40°32'16.113"N	104°43'09.531"W	1.92	
17004.00	91.020	87.130	7241.23	9335.14	-52.01	9334.99	40°32'16.171"N	104°43'08.304"W	1.46	
17099.00	90.150	88.960	7240.26	9430.05	-48.77	9429.93	40°32'16.203"N	104°43'07.074"W	2.13	
17374.00	92.000	89.320	7235.10	9704.93	-44.64	9704.84	40°32'16.243"N	104°43'03.513"W	0.69	LAST BHGE SURVEY (480'FNL & 498'FEL,SEC.36)
17399.00	92.000	89.320	7234.23	9729.91	-44.35	9729.82	40°32'16.246"N	104°43'03.190"W	0.00	PROJ TO BIT (480'FNL & 473'FEL,SEC.36)

Actual Wellpath Report

KTC FARMS C-35-36HN AWP

Page 9 of 10

REFERENCE WELLPATH IDENTIFICATION			
Operator	BAYSWATER E & P LLC	Slot	SLOT#04 KTC FARMS C-35-36HN (297'FNL & 469'FWL,SEC.35)
Area	COLORADO	Well	KTC FARMS C-35-36HN
Field	WELD COUNTY (NAD83/TRUE NORTH)	Wellbore	KTC FARMS C-35-36HN AWB
Facility	SEC.35-T07N-R66W		

TARGETS								
Name	TVD [ft]	North [ft]	East [ft]	Grid East [US ft]	Grid North [US ft]	Latitude	Longitude	Shape
KTC FARMS C-35-36HN BHL PLAT (495'FNL & 470'FEL,SEC.36)	7246.00	-58.92	9733.37	3217477.40	1439723.00	40°32'16.102"N	104°43'03.144"W	point
KTC FARMS C-35-36HN WP5 REV-1 (50'S,8100'VS)	7248.42	-132.20	8099.65	3215844.41	1439635.96	40°32'15.383"N	104°43'24.304"W	point
KTC FARMS C-35-36HN WP4 REV-1 (50'S,7000'VS)	7250.04	-147.87	6999.54	3214744.51	1439611.01	40°32'15.232"N	104°43'38.552"W	point
KTC FARMS C-35-36HN WP3 REV-1 (5'N,5450'VS)	7252.33	-114.96	5449.37	3213194.17	1439630.86	40°32'15.561"N	104°43'58.630"W	point
KTC FARMS C-35-36HN WP2 REV-1 (2370'SSTVD)	7256.00	-153.20	2984.38	3210729.67	1439571.84	40°32'15.187"N	104°44'30.556"W	point
KTC FARMS C-35-36HN WP1 REV-1 (1500'VS)	7266.93	-176.25	1498.96	3209244.55	1439536.27	40°32'14.961"N	104°44'49.795"W	point
KTC FARMS C-35-36HN LP PLAT (495'FNL & 470'FWL,SEC.35)	7278.00	-197.83	-15.29	3207730.58	1439501.94	40°32'14.748"N	104°45'09.407"W	point
SEC.35-T07N-R66W	12000.00	45.18	-0.56	3207743.27	1439745.05	40°32'17.149"N	104°45'09.216"W	polygon
SEC.36-T07N-R66W	12000.00	45.18	-0.56	3207743.27	1439745.05	40°32'17.149"N	104°45'09.216"W	polygon

WELLPATH COMPOSITION - Ref Wellbore: KTC FARMS C-35-36HN AWB Ref Wellpath: KTC FARMS C-35-36HN AWP				
Start MD [ft]	End MD [ft]	Positional Uncertainty Model	Log Name/Comment	Wellbore
25.00	1497.00	BHI NaviTrak (Standard)	BHI NAVITRAK (STANDARD) <141-1497>	KTC FARMS C-35-36HN AWB
1497.00	17374.00	BHI AutoTrak Curve (Short)	BHI AUTOTRAK CURVE (SHORT) <1594-17374>	KTC FARMS C-35-36HN AWB
17374.00	17399.00	Blind Drilling (std)	Projection to bit	KTC FARMS C-35-36HN AWB

Actual Wellpath Report

KTC FARMS C-35-36HN AWP

Page 10 of 10

REFERENCE WELLPATH IDENTIFICATION

Operator	BAYSWATER E & P LLC	Slot	SLOT#04 KTC FARMS C-35-36HN (297'FNL & 469'FWL,SEC.35)
Area	COLORADO	Well	KTC FARMS C-35-36HN
Field	WELD COUNTY (NAD83/TRUE NORTH)	Wellbore	KTC FARMS C-35-36HN AWB
Facility	SEC.35-T07N-R66W		

WELLPATH COMMENTS

MD [ft]	Inclination [°]	Azimuth [°]	TVD [ft]	Comment
1594.00	5.870	253.210	1588.51	FIRST BHGE SURVEY (333'FNL & 365'FWL,SEC.35)
17374.00	92.000	89.320	7235.10	LAST BHGE SURVEY (480'FNL & 498'FEL,SEC.36)
17399.00	92.000	89.320	7234.23	PROJ TO BIT (480'FNL & 473'FEL,SEC.36)