

BAYSWATER E & P LLC

Location: COLORADO

Field: WELD COUNTY (NAD83/TRUE NORTH)

Facility: SEC.35-T07N-R66W

Slot: SLOT#02 KTC FARMS B-35-36HC (267'FNL & 466'FWL,SEC.35)

Well: KTC FARMS B-35-36HC

Wellbore: KTC FARMS B-35-36HC PWB

Plot reference wellpath is KTC FARMS B-35-36HC (REV-D.0) PWP

True vertical depths are referenced to TRUE 38 (4861'GL+25'KB@4886'RKB) (RKB)

Measured depths are referenced to TRUE 38 (4861'GL+25'KB@4886'RKB) (RKB)

TRUE 38 (4861'GL+25'KB@4886'RKB) (RKB) to Mean Sea Level: 4886 feet

Mean Sea Level to Ground level (At Slot: SLOT#02 KTC FARMS B-35-36HC (267'FNL & 466'FWL,SEC.35)): 0 feet

Coordinates are in feet referenced to Slot

Grid System: NAD83 / Lambert Colorado SP, Northern Zone (501), US feet

North Reference: True north

Scale: True distance

Depths are in feet

Created by: bushjamh on 2018-11-28

Database: Denver

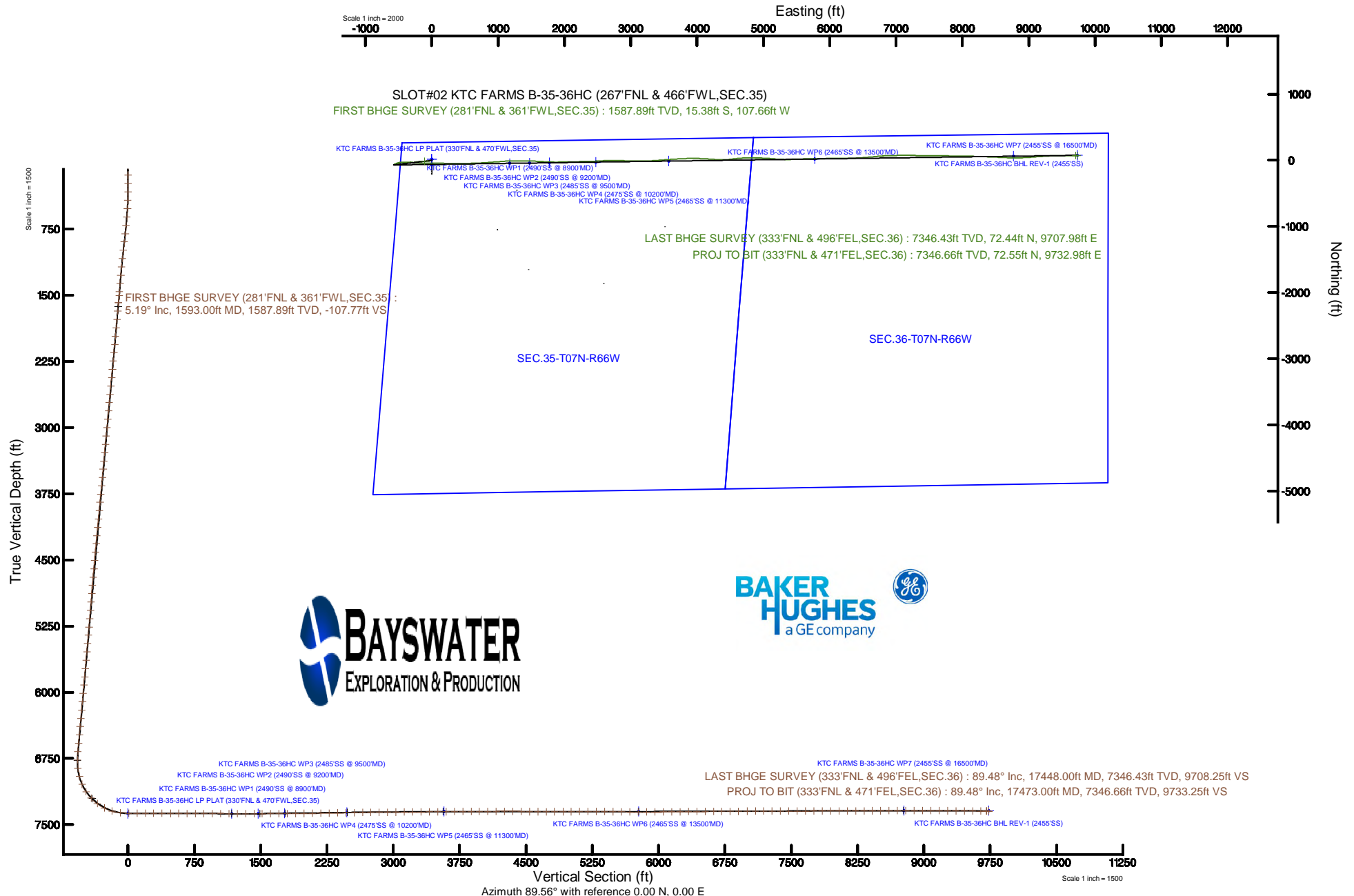

Actual Wellpath Report

KTC FARMS B-35-36HC AWP

Page 1 of 11

REFERENCE WELLPATH IDENTIFICATION			
Operator	BAYSWATER E & P LLC	Slot	SLOT#02 KTC FARMS B-35-36HC (267'FNL & 466'FWL,SEC.35)
Area	COLORADO	Well	KTC FARMS B-35-36HC
Field	WELD COUNTY (NAD83/TRUE NORTH)	Wellbore	KTC FARMS B-35-36HC AWB
Facility	SEC.35-T07N-R66W		

REPORT SETUP INFORMATION			
Projection System	NAD83 / Lambert Colorado SP, Northern Zone (501), US feet	Software System	WellArchitect® 5.1
North Reference	True	User	Bushjamh
Scale	0.999969	Report Generated	11/28/2018 at 4:06:16 AM
Convergence at slot	0.48° East	Database/Source file	Denver/KTC_FARMS_B-35-36HC_AWP.xml

WELLPATH LOCATION						
	Local coordinates		Grid coordinates		Geographic coordinates	
	North[ft]	East[ft]	Easting[US ft]	Northing[US ft]	Latitude	Longitude
Slot Location	-14.94	0.28	3207743.67	1439730.11	40°32'17.002"N	104°45'09.212"W
Facility Reference Pt			3207743.27	1439745.05	40°32'17.149"N	104°45'09.216"W
Field Reference Pt			3174587.00	1430859.71	40°30'51.890"N	104°52'19.470"W

WELLPATH DATUM			
Calculation method	Minimum curvature	TRUE 38 (4861'GL+25'KB@4886'RKB) (RKB) to Facility Vertical Datum	4886.00ft
Horizontal Reference Pt	Slot	TRUE 38 (4861'GL+25'KB@4886'RKB) (RKB) to Mean Sea Level	4886.00ft
Vertical Reference Pt	TRUE 38 (4861'GL+25'KB@4886'RKB) (RKB)	TRUE 38 (4861'GL+25'KB@4886'RKB) (RKB) to Ground Level at Slot (SLOT#02 KTC FARMS B-35-36HC (267'FNL & 466'FWL,SEC.35))	4886.00ft
MD Reference Pt	TRUE 38 (4861'GL+25'KB@4886'RKB) (RKB)	Section Origin	N 0.00, E 0.00 ft
Field Vertical Reference	Mean Sea Level	Section Azimuth	89.56°

Actual Wellpath Report

KTC FARMS B-35-36HC AWP

Page 2 of 11

REFERENCE WELLPATH IDENTIFICATION

Operator	BAYSWATER E & P LLC	Slot	SLOT#02 KTC FARMS B-35-36HC (267'FNL & 466'FWL,SEC.35)
Area	COLORADO	Well	KTC FARMS B-35-36HC
Field	WELD COUNTY (NAD83/TRUE NORTH)	Wellbore	KTC FARMS B-35-36HC AWB
Facility	SEC.35-T07N-R66W		

WELLPATH DATA (188 stations) † = interpolated/extrapolated station

MD [ft]	Inclination [°]	Azimuth [°]	TVD [ft]	Vert Sect [ft]	North [ft]	East [ft]	Latitude	Longitude	DLS [°/100ft]	Comments
0.00†	0.000	326.910	0.00	0.00	0.00	0.00	40°32'17.002"N	104°45'09.212"W	0.00	
25.00	0.000	326.910	25.00	0.00	0.00	0.00	40°32'17.002"N	104°45'09.212"W	0.00	
141.00	0.180	326.910	141.00	-0.10	0.15	-0.10	40°32'17.003"N	104°45'09.214"W	0.16	
236.00	0.060	245.410	236.00	-0.22	0.26	-0.23	40°32'17.004"N	104°45'09.215"W	0.19	
330.00	0.560	231.610	330.00	-0.63	-0.05	-0.63	40°32'17.001"N	104°45'09.221"W	0.53	
425.00	1.740	260.770	424.98	-2.42	-0.57	-2.42	40°32'16.996"N	104°45'09.244"W	1.35	
520.00	3.360	263.910	519.88	-6.62	-1.10	-6.61	40°32'16.991"N	104°45'09.298"W	1.71	
614.00	5.120	260.480	613.62	-13.50	-2.08	-13.49	40°32'16.981"N	104°45'09.387"W	1.89	
709.00	5.100	254.140	708.24	-21.76	-3.94	-21.73	40°32'16.963"N	104°45'09.494"W	0.59	
804.00	6.630	258.130	802.74	-31.21	-6.22	-31.16	40°32'16.940"N	104°45'09.616"W	1.67	
898.00	6.680	256.960	896.11	-41.86	-8.57	-41.80	40°32'16.917"N	104°45'09.754"W	0.15	
993.00	6.480	257.830	990.48	-52.50	-10.94	-52.42	40°32'16.893"N	104°45'09.891"W	0.24	
1088.00	5.990	268.490	1084.93	-62.71	-12.21	-62.61	40°32'16.881"N	104°45'10.023"W	1.32	
1182.00	5.520	267.520	1178.45	-72.13	-12.53	-72.03	40°32'16.878"N	104°45'10.145"W	0.51	
1277.00	5.240	265.870	1273.03	-81.02	-13.04	-80.93	40°32'16.873"N	104°45'10.261"W	0.34	
1372.00	4.880	263.800	1367.66	-89.37	-13.79	-89.27	40°32'16.865"N	104°45'10.369"W	0.42	
1467.00	4.350	264.330	1462.35	-96.98	-14.58	-96.87	40°32'16.858"N	104°45'10.467"W	0.56	
1509.00	4.940	264.990	1504.22	-100.37	-14.90	-100.26	40°32'16.854"N	104°45'10.511"W	1.41	
1593.00	5.190	267.500	1587.89	-107.77	-15.38	-107.66	40°32'16.850"N	104°45'10.607"W	0.40	FIRST BHGE SURVEY (281'FNL & 361'FWL,SEC.35)
1688.00	5.350	264.530	1682.49	-116.48	-15.99	-116.36	40°32'16.844"N	104°45'10.719"W	0.33	
1783.00	5.090	263.200	1777.09	-125.08	-16.91	-124.95	40°32'16.835"N	104°45'10.831"W	0.30	
1877.00	5.090	264.310	1870.72	-133.38	-17.82	-133.24	40°32'16.826"N	104°45'10.938"W	0.10	
1971.00	5.100	270.240	1964.35	-141.71	-18.21	-141.57	40°32'16.822"N	104°45'11.046"W	0.56	
2066.00	5.300	271.860	2058.96	-150.31	-18.05	-150.18	40°32'16.823"N	104°45'11.157"W	0.26	
2160.00	5.130	268.930	2152.57	-158.85	-17.99	-158.72	40°32'16.824"N	104°45'11.268"W	0.34	
2255.00	5.410	266.750	2247.17	-167.57	-18.32	-167.44	40°32'16.821"N	104°45'11.381"W	0.36	
2349.00	5.460	261.970	2340.75	-176.43	-19.20	-176.29	40°32'16.812"N	104°45'11.496"W	0.48	
2443.00	5.370	267.540	2434.33	-185.26	-20.01	-185.11	40°32'16.804"N	104°45'11.610"W	0.57	
2538.00	5.180	264.660	2528.93	-193.98	-20.60	-193.82	40°32'16.798"N	104°45'11.723"W	0.34	
2633.00	5.620	261.890	2623.50	-202.86	-21.66	-202.70	40°32'16.788"N	104°45'11.838"W	0.54	

Actual Wellpath Report

KTC FARMS B-35-36HC AWP

Page 3 of 11

REFERENCE WELLPATH IDENTIFICATION

Operator	BAYSWATER E & P LLC	Slot	SLOT#02 KTC FARMS B-35-36HC (267'FNL & 466'FWL,SEC.35)
Area	COLORADO	Well	KTC FARMS B-35-36HC
Field	WELD COUNTY (NAD83/TRUE NORTH)	Wellbore	KTC FARMS B-35-36HC AWB
Facility	SEC.35-T07N-R66W		

WELLPATH DATA (188 stations)

MD [ft]	Inclination [°]	Azimuth [°]	TVD [ft]	Vert Sect [ft]	North [ft]	East [ft]	Latitude	Longitude	DLS [°/100ft]	Comments
2728.00	5.200	257.950	2718.08	-211.69	-23.21	-211.51	40°32'16.772"N	104°45'11.952"W	0.59	
2823.00	5.350	261.310	2812.68	-220.29	-24.78	-220.10	40°32'16.757"N	104°45'12.063"W	0.36	
2918.00	5.410	261.340	2907.26	-229.10	-26.12	-228.91	40°32'16.743"N	104°45'12.177"W	0.06	
3013.00	5.500	261.200	3001.83	-238.04	-27.50	-237.83	40°32'16.730"N	104°45'12.293"W	0.10	
3107.00	5.390	255.850	3095.41	-246.79	-29.26	-246.57	40°32'16.712"N	104°45'12.406"W	0.55	
3202.00	5.330	259.340	3189.99	-255.46	-31.17	-255.23	40°32'16.694"N	104°45'12.518"W	0.35	
3297.00	5.250	260.000	3284.59	-264.09	-32.74	-263.84	40°32'16.678"N	104°45'12.630"W	0.11	
3392.00	5.290	264.150	3379.19	-272.74	-33.94	-272.48	40°32'16.666"N	104°45'12.742"W	0.40	
3487.00	5.100	271.640	3473.80	-281.32	-34.27	-281.06	40°32'16.663"N	104°45'12.853"W	0.74	
3581.00	5.320	277.440	3567.41	-289.81	-33.58	-289.56	40°32'16.670"N	104°45'12.963"W	0.61	
3674.00	5.300	272.400	3660.01	-298.37	-32.85	-298.12	40°32'16.677"N	104°45'13.074"W	0.50	
3769.00	5.320	268.210	3754.60	-307.15	-32.80	-306.91	40°32'16.677"N	104°45'13.187"W	0.41	
3863.00	5.370	263.860	3848.19	-315.89	-33.41	-315.64	40°32'16.671"N	104°45'13.300"W	0.43	
3957.00	5.390	269.370	3941.78	-324.68	-33.93	-324.43	40°32'16.666"N	104°45'13.414"W	0.55	
4052.00	5.530	264.980	4036.35	-333.70	-34.38	-333.45	40°32'16.662"N	104°45'13.531"W	0.46	
4147.00	5.270	262.180	4130.93	-342.59	-35.37	-342.33	40°32'16.652"N	104°45'13.646"W	0.39	
4242.00	5.300	263.170	4225.53	-351.28	-36.48	-351.01	40°32'16.641"N	104°45'13.759"W	0.10	
4336.00	5.200	264.420	4319.13	-359.84	-37.42	-359.56	40°32'16.632"N	104°45'13.869"W	0.16	
4430.00	5.500	270.200	4412.72	-368.59	-37.81	-368.30	40°32'16.628"N	104°45'13.983"W	0.66	
4525.00	4.840	270.800	4507.34	-377.14	-37.74	-376.86	40°32'16.629"N	104°45'14.093"W	0.70	
4619.00	4.920	271.460	4600.99	-385.14	-37.58	-384.86	40°32'16.630"N	104°45'14.197"W	0.10	
4714.00	5.270	275.070	4695.62	-393.55	-37.09	-393.28	40°32'16.635"N	104°45'14.306"W	0.50	
4808.00	5.230	251.840	4789.24	-401.93	-38.05	-401.65	40°32'16.626"N	104°45'14.414"W	2.25	
4903.00	5.110	243.520	4883.85	-409.86	-41.28	-409.55	40°32'16.594"N	104°45'14.517"W	0.80	
4998.00	5.230	242.040	4978.46	-417.50	-45.20	-417.16	40°32'16.555"N	104°45'14.615"W	0.19	
5092.00	5.060	249.760	5072.09	-425.20	-48.64	-424.83	40°32'16.521"N	104°45'14.715"W	0.76	
5186.00	4.980	253.390	5165.73	-433.02	-51.24	-432.63	40°32'16.495"N	104°45'14.816"W	0.35	
5281.00	4.900	258.580	5260.37	-440.96	-53.23	-440.56	40°32'16.476"N	104°45'14.918"W	0.48	
5375.00	4.810	259.790	5354.04	-448.79	-54.72	-448.38	40°32'16.461"N	104°45'15.020"W	0.15	
5470.00	4.940	259.760	5448.69	-456.74	-56.15	-456.32	40°32'16.447"N	104°45'15.123"W	0.14	

Actual Wellpath Report

KTC FARMS B-35-36HC AWP

Page 4 of 11

REFERENCE WELLPATH IDENTIFICATION

Operator	BAYSWATER E & P LLC	Slot	SLOT#02 KTC FARMS B-35-36HC (267'FNL & 466'FWL,SEC.35)
Area	COLORADO	Well	KTC FARMS B-35-36HC
Field	WELD COUNTY (NAD83/TRUE NORTH)	Wellbore	KTC FARMS B-35-36HC AWB
Facility	SEC.35-T07N-R66W		

WELLPATH DATA (188 stations)

MD [ft]	Inclination [°]	Azimuth [°]	TVD [ft]	Vert Sect [ft]	North [ft]	East [ft]	Latitude	Longitude	DLS [°/100ft]	Comments
5564.00	5.220	261.450	5542.32	-464.96	-57.51	-464.53	40°32'16.433"N	104°45'15.229"W	0.34	
5659.00	5.140	259.470	5636.94	-473.43	-58.93	-472.99	40°32'16.419"N	104°45'15.338"W	0.21	
5753.00	5.100	266.190	5730.56	-481.75	-59.98	-481.30	40°32'16.409"N	104°45'15.446"W	0.64	
5848.00	4.970	274.550	5825.20	-490.06	-59.93	-489.61	40°32'16.409"N	104°45'15.554"W	0.78	
5942.00	5.060	274.710	5918.84	-498.25	-59.27	-497.80	40°32'16.416"N	104°45'15.660"W	0.10	
6037.00	5.270	273.090	6013.45	-506.78	-58.69	-506.34	40°32'16.422"N	104°45'15.770"W	0.27	
6131.00	5.330	273.030	6107.05	-515.44	-58.22	-515.01	40°32'16.426"N	104°45'15.883"W	0.06	
6226.00	5.090	264.320	6201.66	-524.04	-58.41	-523.61	40°32'16.424"N	104°45'15.994"W	0.87	
6320.00	5.250	257.860	6295.28	-532.41	-59.72	-531.96	40°32'16.411"N	104°45'16.102"W	0.64	
6414.00	5.290	258.190	6388.88	-540.87	-61.52	-540.41	40°32'16.394"N	104°45'16.212"W	0.05	
6509.00	5.230	268.200	6483.48	-549.49	-62.55	-549.02	40°32'16.383"N	104°45'16.323"W	0.97	
6603.00	5.300	265.440	6577.08	-558.10	-63.03	-557.63	40°32'16.379"N	104°45'16.435"W	0.28	
6698.00	5.210	266.920	6671.68	-566.79	-63.61	-566.31	40°32'16.373"N	104°45'16.547"W	0.17	
6793.00	0.030	192.750	6766.55	-571.10	-63.86	-570.63	40°32'16.370"N	104°45'16.603"W	5.48	
6887.00	6.420	74.860	6860.36	-566.02	-62.51	-565.55	40°32'16.384"N	104°45'16.537"W	6.84	
6982.00	15.460	59.950	6953.55	-549.84	-54.77	-549.43	40°32'16.460"N	104°45'16.329"W	9.89	
7077.00	24.490	70.780	7042.77	-520.12	-41.92	-519.81	40°32'16.587"N	104°45'15.945"W	10.23	
7172.00	33.930	83.500	7125.68	-474.96	-32.40	-474.73	40°32'16.681"N	104°45'15.361"W	11.84	
7266.00	43.320	89.340	7199.06	-416.48	-29.05	-416.27	40°32'16.714"N	104°45'14.604"W	10.71	
7360.00	52.840	94.320	7261.81	-346.72	-31.51	-346.49	40°32'16.690"N	104°45'13.700"W	10.86	
7454.00	63.740	93.740	7311.14	-267.12	-37.10	-266.84	40°32'16.635"N	104°45'12.668"W	11.61	
7549.00	72.920	91.270	7346.19	-179.05	-40.89	-178.74	40°32'16.598"N	104°45'11.527"W	9.96	
7644.00	83.680	89.160	7365.43	-86.17	-41.21	-85.85	40°32'16.594"N	104°45'10.324"W	11.53	
7738.00	89.820	90.730	7370.75	7.63	-41.12	7.95	40°32'16.595"N	104°45'09.109"W	6.74	
7833.00	89.850	92.120	7371.03	102.58	-43.48	102.92	40°32'16.572"N	104°45'07.879"W	1.46	
7927.00	89.750	92.420	7371.35	196.47	-47.20	196.84	40°32'16.535"N	104°45'06.663"W	0.34	
8021.00	89.720	91.040	7371.79	290.40	-50.04	290.80	40°32'16.507"N	104°45'05.446"W	1.47	
8116.00	89.780	89.110	7372.20	385.39	-50.17	385.79	40°32'16.506"N	104°45'04.216"W	2.03	
8211.00	89.690	89.340	7372.64	480.39	-48.88	480.78	40°32'16.519"N	104°45'02.985"W	0.26	
8305.00	89.820	88.690	7373.05	574.38	-47.27	574.77	40°32'16.534"N	104°45'01.768"W	0.71	

Actual Wellpath Report

KTC FARMS B-35-36HC AWP

Page 5 of 11

REFERENCE WELLPATH IDENTIFICATION

Operator	BAYSWATER E & P LLC	Slot	SLOT#02 KTC FARMS B-35-36HC (267'FNL & 466'FWL,SEC.35)
Area	COLORADO	Well	KTC FARMS B-35-36HC
Field	WELD COUNTY (NAD83/TRUE NORTH)	Wellbore	KTC FARMS B-35-36HC AWB
Facility	SEC.35-T07N-R66W		

WELLPATH DATA (188 stations)

MD [ft]	Inclination [°]	Azimuth [°]	TVD [ft]	Vert Sect [ft]	North [ft]	East [ft]	Latitude	Longitude	DLS [°/100ft]	Comments
8400.00	89.630	87.780	7373.50	669.35	-44.34	669.72	40°32'16.563"N	104°45'00.538"W	0.98	
8495.00	89.720	85.910	7374.04	764.24	-39.11	764.57	40°32'16.615"N	104°44'59.310"W	1.97	
8589.00	90.310	85.490	7374.02	858.03	-32.06	858.30	40°32'16.685"N	104°44'58.096"W	0.77	
8684.00	89.720	86.250	7373.99	952.83	-25.22	953.06	40°32'16.752"N	104°44'56.869"W	1.01	
8778.00	89.170	85.530	7374.90	1046.63	-18.49	1046.81	40°32'16.819"N	104°44'55.654"W	0.96	
8871.00	89.600	86.530	7375.90	1139.45	-12.05	1139.58	40°32'16.882"N	104°44'54.453"W	1.17	
8966.00	89.540	89.620	7376.61	1234.40	-8.86	1234.51	40°32'16.914"N	104°44'53.223"W	3.25	
9061.00	89.720	91.600	7377.23	1329.38	-9.87	1329.50	40°32'16.904"N	104°44'51.993"W	2.09	
9156.00	89.970	89.960	7377.48	1424.36	-11.16	1424.49	40°32'16.891"N	104°44'50.763"W	1.75	
9250.00	91.420	91.430	7376.34	1518.33	-12.30	1518.47	40°32'16.880"N	104°44'49.545"W	2.20	
9345.00	90.120	93.470	7375.07	1613.19	-16.36	1613.36	40°32'16.839"N	104°44'48.316"W	2.55	
9439.00	90.060	93.210	7374.92	1706.98	-21.84	1707.20	40°32'16.785"N	104°44'47.101"W	0.28	
9533.00	90.060	92.000	7374.82	1800.85	-26.11	1801.11	40°32'16.743"N	104°44'45.885"W	1.29	
9628.00	90.990	89.400	7373.95	1895.82	-27.27	1896.09	40°32'16.731"N	104°44'44.655"W	2.91	
9722.00	90.520	88.220	7372.71	1989.80	-25.32	1990.06	40°32'16.751"N	104°44'43.437"W	1.35	
9817.00	90.950	88.330	7371.49	2084.77	-22.46	2085.00	40°32'16.779"N	104°44'42.208"W	0.47	
9912.00	90.920	89.540	7369.94	2179.75	-20.69	2179.97	40°32'16.796"N	104°44'40.978"W	1.27	
10006.00	90.980	89.630	7368.38	2273.73	-20.01	2273.96	40°32'16.803"N	104°44'39.760"W	0.12	
10101.00	90.980	88.160	7366.76	2368.71	-18.18	2368.92	40°32'16.821"N	104°44'38.530"W	1.55	
10195.00	90.920	86.440	7365.20	2462.62	-13.75	2462.80	40°32'16.864"N	104°44'37.315"W	1.83	
10290.00	90.920	86.840	7363.67	2557.49	-8.19	2557.63	40°32'16.919"N	104°44'36.086"W	0.42	
10385.00	90.890	88.140	7362.17	2652.41	-4.03	2652.52	40°32'16.960"N	104°44'34.857"W	1.37	
10479.00	91.230	91.060	7360.43	2746.38	-3.37	2746.49	40°32'16.967"N	104°44'33.640"W	3.13	
10574.00	90.400	91.590	7359.08	2841.33	-5.57	2841.46	40°32'16.945"N	104°44'32.410"W	1.04	
10668.00	90.310	91.730	7358.50	2935.26	-8.29	2935.42	40°32'16.918"N	104°44'31.193"W	0.18	
10763.00	90.340	91.420	7357.96	3030.20	-10.90	3030.38	40°32'16.892"N	104°44'29.963"W	0.33	
10857.00	90.280	90.680	7357.45	3124.17	-12.62	3124.36	40°32'16.875"N	104°44'28.746"W	0.79	
10952.00	90.310	88.400	7356.96	3219.16	-11.86	3219.35	40°32'16.882"N	104°44'27.516"W	2.40	
11046.00	90.650	87.020	7356.18	3313.11	-8.11	3313.27	40°32'16.919"N	104°44'26.299"W	1.51	
11141.00	90.620	85.350	7355.12	3407.93	-1.79	3408.05	40°32'16.982"N	104°44'25.072"W	1.76	

Actual Wellpath Report

KTC FARMS B-35-36HC AWP

Page 6 of 11

REFERENCE WELLPATH IDENTIFICATION

Operator	BAYSWATER E & P LLC	Slot	SLOT#02 KTC FARMS B-35-36HC (267'FNL & 466'FWL,SEC.35)
Area	COLORADO	Well	KTC FARMS B-35-36HC
Field	WELD COUNTY (NAD83/TRUE NORTH)	Wellbore	KTC FARMS B-35-36HC AWB
Facility	SEC.35-T07N-R66W		

WELLPATH DATA (188 stations)

MD [ft]	Inclination [°]	Azimuth [°]	TVD [ft]	Vert Sect [ft]	North [ft]	East [ft]	Latitude	Longitude	DLS [°/100ft]	Comments
11236.00	90.740	85.230	7354.00	3502.66	6.01	3502.72	40°32'17.059"N	104°44'23.846"W	0.18	
11330.00	90.680	85.950	7352.83	3596.43	13.24	3596.44	40°32'17.130"N	104°44'22.632"W	0.77	
11425.00	90.740	86.710	7351.65	3691.27	19.32	3691.23	40°32'17.190"N	104°44'21.404"W	0.80	
11519.00	90.060	87.530	7351.00	3785.18	24.05	3785.11	40°32'17.236"N	104°44'20.188"W	1.13	
11614.00	90.030	88.090	7350.92	3880.14	27.68	3880.04	40°32'17.272"N	104°44'18.959"W	0.59	
11708.00	90.060	91.100	7350.85	3974.13	28.34	3974.03	40°32'17.278"N	104°44'17.741"W	3.20	
11802.00	90.090	92.330	7350.73	4068.06	25.53	4067.98	40°32'17.251"N	104°44'16.524"W	1.31	
11897.00	90.220	94.450	7350.47	4162.84	19.91	4162.81	40°32'17.195"N	104°44'15.296"W	2.24	
11992.00	90.340	93.670	7350.01	4257.55	13.18	4257.57	40°32'17.128"N	104°44'14.069"W	0.83	
12086.00	90.650	90.990	7349.19	4351.42	9.36	4351.48	40°32'17.090"N	104°44'12.853"W	2.87	
12181.00	87.660	87.100	7350.59	4446.38	10.94	4446.43	40°32'17.106"N	104°44'11.623"W	5.16	
12276.00	89.630	82.290	7352.84	4540.98	19.72	4540.96	40°32'17.192"N	104°44'10.398"W	5.47	
12370.00	89.880	85.340	7353.24	4634.50	29.85	4634.40	40°32'17.292"N	104°44'09.188"W	3.26	
12465.00	90.000	87.910	7353.34	4729.36	35.44	4729.23	40°32'17.347"N	104°44'07.960"W	2.71	
12559.00	90.150	90.550	7353.22	4823.35	36.71	4823.21	40°32'17.360"N	104°44'06.743"W	2.81	
12654.00	90.060	91.580	7353.05	4918.32	34.94	4918.20	40°32'17.342"N	104°44'05.512"W	1.09	
12748.00	90.280	92.850	7352.77	5012.22	31.31	5012.12	40°32'17.306"N	104°44'04.296"W	1.37	
12843.00	90.400	94.250	7352.20	5106.98	25.42	5106.94	40°32'17.248"N	104°44'03.068"W	1.48	
12937.00	90.280	93.970	7351.65	5200.68	18.69	5200.69	40°32'17.181"N	104°44'01.854"W	0.32	
13032.00	90.340	92.030	7351.13	5295.50	13.72	5295.56	40°32'17.132"N	104°44'00.625"W	2.04	
13126.00	89.260	89.440	7351.46	5389.48	12.51	5389.54	40°32'17.119"N	104°43'59.408"W	2.99	
13221.00	88.980	87.470	7352.92	5484.44	15.07	5484.49	40°32'17.144"N	104°43'58.178"W	2.09	
13316.00	89.110	87.690	7354.50	5579.37	19.08	5579.39	40°32'17.184"N	104°43'56.949"W	0.27	
13411.00	89.140	89.150	7355.95	5674.34	21.70	5674.34	40°32'17.210"N	104°43'55.719"W	1.54	
13505.00	90.150	89.870	7356.54	5768.34	22.50	5768.33	40°32'17.217"N	104°43'54.502"W	1.32	
13600.00	90.120	88.320	7356.31	5863.33	24.00	5863.32	40°32'17.232"N	104°43'53.271"W	1.63	
13694.00	90.090	88.240	7356.14	5957.31	26.83	5957.28	40°32'17.260"N	104°43'52.054"W	0.09	
13791.00	91.020	89.980	7355.20	6054.29	28.33	6054.26	40°32'17.274"N	104°43'50.798"W	2.03	
13885.00	90.370	89.980	7354.06	6148.28	28.37	6148.25	40°32'17.274"N	104°43'49.581"W	0.69	
13980.00	90.520	89.770	7353.32	6243.28	28.57	6243.25	40°32'17.276"N	104°43'48.351"W	0.27	

Actual Wellpath Report

KTC FARMS B-35-36HC AWP

Page 7 of 11

REFERENCE WELLPATH IDENTIFICATION

Operator	BAYSWATER E & P LLC	Slot	SLOT#02 KTC FARMS B-35-36HC (267'FNL & 466'FWL,SEC.35)
Area	COLORADO	Well	KTC FARMS B-35-36HC
Field	WELD COUNTY (NAD83/TRUE NORTH)	Wellbore	KTC FARMS B-35-36HC AWB
Facility	SEC.35-T07N-R66W		

WELLPATH DATA (188 stations)

MD [ft]	Inclination [°]	Azimuth [°]	TVD [ft]	Vert Sect [ft]	North [ft]	East [ft]	Latitude	Longitude	DLS [°/100ft]	Comments
14074.00	90.550	88.390	7352.44	6337.27	30.08	6337.23	40°32'17.291"N	104°43'47.133"W	1.47	
14169.00	90.580	86.310	7351.51	6432.19	34.47	6432.12	40°32'17.334"N	104°43'45.904"W	2.19	
14264.00	90.650	85.390	7350.49	6526.98	41.35	6526.86	40°32'17.402"N	104°43'44.677"W	0.97	
14359.00	90.550	84.400	7349.49	6621.66	49.80	6621.48	40°32'17.485"N	104°43'43.452"W	1.05	
14453.00	90.120	84.530	7348.94	6715.29	58.87	6715.04	40°32'17.574"N	104°43'42.240"W	0.48	
14548.00	90.120	86.420	7348.74	6810.05	66.36	6809.74	40°32'17.648"N	104°43'41.013"W	1.99	
14643.00	90.340	88.490	7348.36	6904.98	70.58	6904.64	40°32'17.689"N	104°43'39.784"W	2.19	
14738.00	90.220	89.050	7347.90	6999.97	72.62	6999.61	40°32'17.709"N	104°43'38.554"W	0.60	
14833.00	90.180	89.780	7347.57	7094.96	73.59	7094.61	40°32'17.719"N	104°43'37.324"W	0.77	
14927.00	90.090	90.320	7347.35	7188.96	73.51	7188.61	40°32'17.718"N	104°43'36.106"W	0.58	
15021.00	90.150	90.250	7347.15	7282.95	73.04	7282.60	40°32'17.713"N	104°43'34.889"W	0.10	
15116.00	90.150	90.320	7346.90	7377.94	72.57	7377.60	40°32'17.708"N	104°43'33.658"W	0.07	
15211.00	90.220	90.270	7346.59	7472.94	72.08	7472.60	40°32'17.703"N	104°43'32.428"W	0.09	
15306.00	90.430	91.300	7346.05	7567.91	70.78	7567.59	40°32'17.689"N	104°43'31.198"W	1.11	
15400.00	90.060	91.060	7345.65	7661.87	68.84	7661.57	40°32'17.670"N	104°43'29.981"W	0.47	
15494.00	90.250	91.240	7345.40	7755.84	66.95	7755.55	40°32'17.651"N	104°43'28.763"W	0.28	
15589.00	90.120	90.650	7345.09	7850.81	65.39	7850.54	40°32'17.635"N	104°43'27.533"W	0.64	
15684.00	90.150	90.740	7344.87	7945.79	64.24	7945.53	40°32'17.624"N	104°43'26.303"W	0.10	
15779.00	90.250	91.140	7344.54	8040.76	62.68	8040.51	40°32'17.608"N	104°43'25.072"W	0.43	
15873.00	90.120	91.130	7344.23	8134.72	60.81	8134.50	40°32'17.589"N	104°43'23.855"W	0.14	
15967.00	90.180	92.110	7343.99	8228.66	58.16	8228.46	40°32'17.563"N	104°43'22.638"W	1.04	
16062.00	90.250	91.960	7343.63	8323.57	54.78	8323.40	40°32'17.529"N	104°43'21.409"W	0.17	
16156.00	90.180	92.020	7343.28	8417.49	51.52	8417.34	40°32'17.496"N	104°43'20.192"W	0.10	
16251.00	90.220	92.770	7342.95	8512.37	47.55	8512.25	40°32'17.457"N	104°43'18.963"W	0.79	
16345.00	90.280	93.030	7342.54	8606.21	42.79	8606.13	40°32'17.410"N	104°43'17.747"W	0.28	
16440.00	90.430	91.620	7341.95	8701.09	38.94	8701.05	40°32'17.371"N	104°43'16.517"W	1.49	
16535.00	90.340	90.050	7341.31	8796.06	37.56	8796.04	40°32'17.357"N	104°43'15.287"W	1.66	
16629.00	90.030	88.250	7341.01	8890.06	38.95	8890.02	40°32'17.371"N	104°43'14.070"W	1.94	
16724.00	90.030	86.390	7340.96	8984.98	43.39	8984.91	40°32'17.414"N	104°43'12.841"W	1.96	
16818.00	89.540	86.020	7341.31	9078.82	49.61	9078.71	40°32'17.475"N	104°43'11.626"W	0.65	

Actual Wellpath Report

KTC FARMS B-35-36HC AWP

Page 8 of 11

REFERENCE WELLPATH IDENTIFICATION			
Operator	BAYSWATER E & P LLC	Slot	SLOT#02 KTC FARMS B-35-36HC (267'FNL & 466'FWL,SEC.35)
Area	COLORADO	Well	KTC FARMS B-35-36HC
Field	WELD COUNTY (NAD83/TRUE NORTH)	Wellbore	KTC FARMS B-35-36HC AWB
Facility	SEC.35-T07N-R66W		

WELLPATH DATA (188 stations)										
MD [ft]	Inclination [°]	Azimuth [°]	TVD [ft]	Vert Sect [ft]	North [ft]	East [ft]	Latitude	Longitude	DLS [°/100ft]	Comments
16912.00	89.540	85.340	7342.06	9172.60	56.69	9172.43	40°32'17.545"N	104°43'10.412"W	0.72	
17006.00	89.570	86.430	7342.79	9266.40	63.44	9266.19	40°32'17.611"N	104°43'09.198"W	1.16	
17101.00	89.540	87.410	7343.53	9361.30	68.54	9361.05	40°32'17.661"N	104°43'07.969"W	1.03	
17196.00	89.510	89.030	7344.32	9456.26	71.49	9455.99	40°32'17.690"N	104°43'06.739"W	1.71	
17291.00	89.570	90.190	7345.08	9551.26	72.14	9550.99	40°32'17.696"N	104°43'05.509"W	1.22	
17385.00	89.480	89.770	7345.86	9645.25	72.17	9644.98	40°32'17.696"N	104°43'04.292"W	0.46	
17448.00	89.480	89.750	7346.43	9708.25	72.44	9707.98	40°32'17.698"N	104°43'03.476"W	0.03	LAST BHGE SURVEY (333'FNL & 496'FEL,SEC.36)
17473.00	89.480	89.750	7346.66	9733.25	72.55	9732.98	40°32'17.699"N	104°43'03.152"W	0.00	PROJ TO BIT (333'FNL & 471'FEL,SEC.36)

Actual Wellpath Report

KTC FARMS B-35-36HC AWP

Page 9 of 11

REFERENCE WELLPATH IDENTIFICATION			
Operator	BAYSWATER E & P LLC	Slot	SLOT#02 KTC FARMS B-35-36HC (267'FNL & 466'FWL,SEC.35)
Area	COLORADO	Well	KTC FARMS B-35-36HC
Field	WELD COUNTY (NAD83/TRUE NORTH)	Wellbore	KTC FARMS B-35-36HC AWB
Facility	SEC.35-T07N-R66W		

TARGETS								
Name	TVD [ft]	North [ft]	East [ft]	Grid East [US ft]	Grid North [US ft]	Latitude	Longitude	Shape
KTC FARMS B-35-36HC BHL REV-1 (2455'SS)	7341.00	75.52	9734.14	3217476.51	1439887.67	40°32'17.729"N	104°43'03.137"W	point
KTC FARMS B-35-36HC WP7 (2455'SS @ 16500'MD)	7341.00	61.83	8772.51	3216515.06	1439865.88	40°32'17.597"N	104°43'15.592"W	point
KTC FARMS B-35-36HC WP5 (2465'SS @ 11300'MD)	7351.00	-12.16	3573.08	3211316.61	1439748.07	40°32'16.879"N	104°44'22.934"W	point
KTC FARMS B-35-36HC WP6 (2465'SS @ 13500'MD)	7351.00	19.14	5772.84	3213515.95	1439797.91	40°32'17.184"N	104°43'54.443"W	point
KTC FARMS B-35-36HC WP4 (2475'SS @ 10200'MD)	7361.00	-27.82	2473.23	3210216.96	1439723.14	40°32'16.726"N	104°44'37.179"W	point
KTC FARMS B-35-36HC WP3 (2485'SS @ 9500'MD)	7371.00	-37.78	1773.35	3209517.21	1439707.29	40°32'16.628"N	104°44'46.244"W	point
KTC FARMS B-35-36HC LP PLAT (330'FNL & 470'FWL,SEC.35)	7372.00	-63.03	-1.11	3207743.09	1439667.08	40°32'16.379"N	104°45'09.227"W	point
KTC FARMS B-35-36HC WP1 (2490'SS @ 8900'MD)	7376.00	-46.31	1173.42	3208917.40	1439693.69	40°32'16.544"N	104°44'54.014"W	point
KTC FARMS B-35-36HC WP2 (2490'SS @ 9200'MD)	7376.00	-42.04	1473.39	3209217.31	1439700.49	40°32'16.586"N	104°44'50.129"W	point
SEC.35-T07N-R66W	12000.00	14.94	-0.28	3207743.27	1439745.05	40°32'17.149"N	104°45'09.216"W	polygon
SEC.36-T07N-R66W	12000.00	14.94	-0.28	3207743.27	1439745.05	40°32'17.149"N	104°45'09.216"W	polygon

Actual Wellpath Report

KTC FARMS B-35-36HC AWP

Page 10 of 11

REFERENCE WELLPATH IDENTIFICATION

Operator	BAYSWATER E & P LLC	Slot	SLOT#02 KTC FARMS B-35-36HC (267'FNL & 466'FWL,SEC.35)
Area	COLORADO	Well	KTC FARMS B-35-36HC
Field	WELD COUNTY (NAD83/TRUE NORTH)	Wellbore	KTC FARMS B-35-36HC AWB
Facility	SEC.35-T07N-R66W		

WELLPATH COMPOSITION - Ref Wellbore: KTC FARMS B-35-36HC AWB Ref Wellpath: KTC FARMS B-35-36HC AWP

Start MD [ft]	End MD [ft]	Positional Uncertainty Model	Log Name/Comment	Wellbore
25.00	1509.00	BHI NaviTrak (Standard)	BHI NAVITRAK (STANDARD) <141-1509>	KTC FARMS B-35-36HC AWB
1509.00	17448.00	BHI AutoTrak Curve (Short)	BHI AUTOTRAK CURVE (SHORT) <1593-17448>	KTC FARMS B-35-36HC AWB
17448.00	17473.00	Blind Drilling (std)	Projection to bit	KTC FARMS B-35-36HC AWB

Actual Wellpath Report

KTC FARMS B-35-36HC AWP

Page 11 of 11

REFERENCE WELLPATH IDENTIFICATION			
Operator	BAYSWATER E & P LLC	Slot	SLOT#02 KTC FARMS B-35-36HC (267'FNL & 466'FWL,SEC.35)
Area	COLORADO	Well	KTC FARMS B-35-36HC
Field	WELD COUNTY (NAD83/TRUE NORTH)	Wellbore	KTC FARMS B-35-36HC AWB
Facility	SEC.35-T07N-R66W		

WELLPATH COMMENTS				
MD [ft]	Inclination [°]	Azimuth [°]	TVD [ft]	Comment
1593.00	5.190	267.500	1587.89	FIRST BHGE SURVEY (281'FNL & 361'FWL,SEC.35)
17448.00	89.480	89.750	7346.43	LAST BHGE SURVEY (333'FNL & 496'FEL,SEC.36)
17473.00	89.480	89.750	7346.66	PROJ TO BIT (333'FNL & 471'FEL,SEC.36)