

BAYSWATER E & P LLC

Location: COLORADO
 Field: WELD COUNTY (NAD83/TRUE NORTH)
 Facility: SEC.35-T07N-R66W

Slot: SLOT#01 KTC FARMS A-35-36HN (252'FNL & 465'FWL, SEC.35)
 Well: KTC FARMS A-35-36HN
 Wellbore: KTC FARMS A-35-36HN PWB

Plot reference wellpath is KTC FARMS A-35-36HN (REV-D.0) PWP		Grid System: NAD83 / Lambert Colorado SP, Northern Zone (501), US feet
True vertical depths are referenced to TRUE 38 (4861'GL+25'KB@4886'RKB) (RKB)		North Reference: True north
Measured depths are referenced to TRUE 38 (4861'GL+25'KB@4886'RKB) (RKB)		Scale: True distance
TRUE 38 (4861'GL+25'KB@4886'RKB) (RKB) to Mean Sea Level: 4886 feet		Depths are in feet
Mean Sea Level to Ground level (At Slot: SLOT#01 KTC FARMS A-35-36HN (252'FNL & 465'FWL, SEC.35)): 0 feet		Created by: bushjamm on 2018-11-28
Coordinates are in feet referenced to Slot		Database: Denver

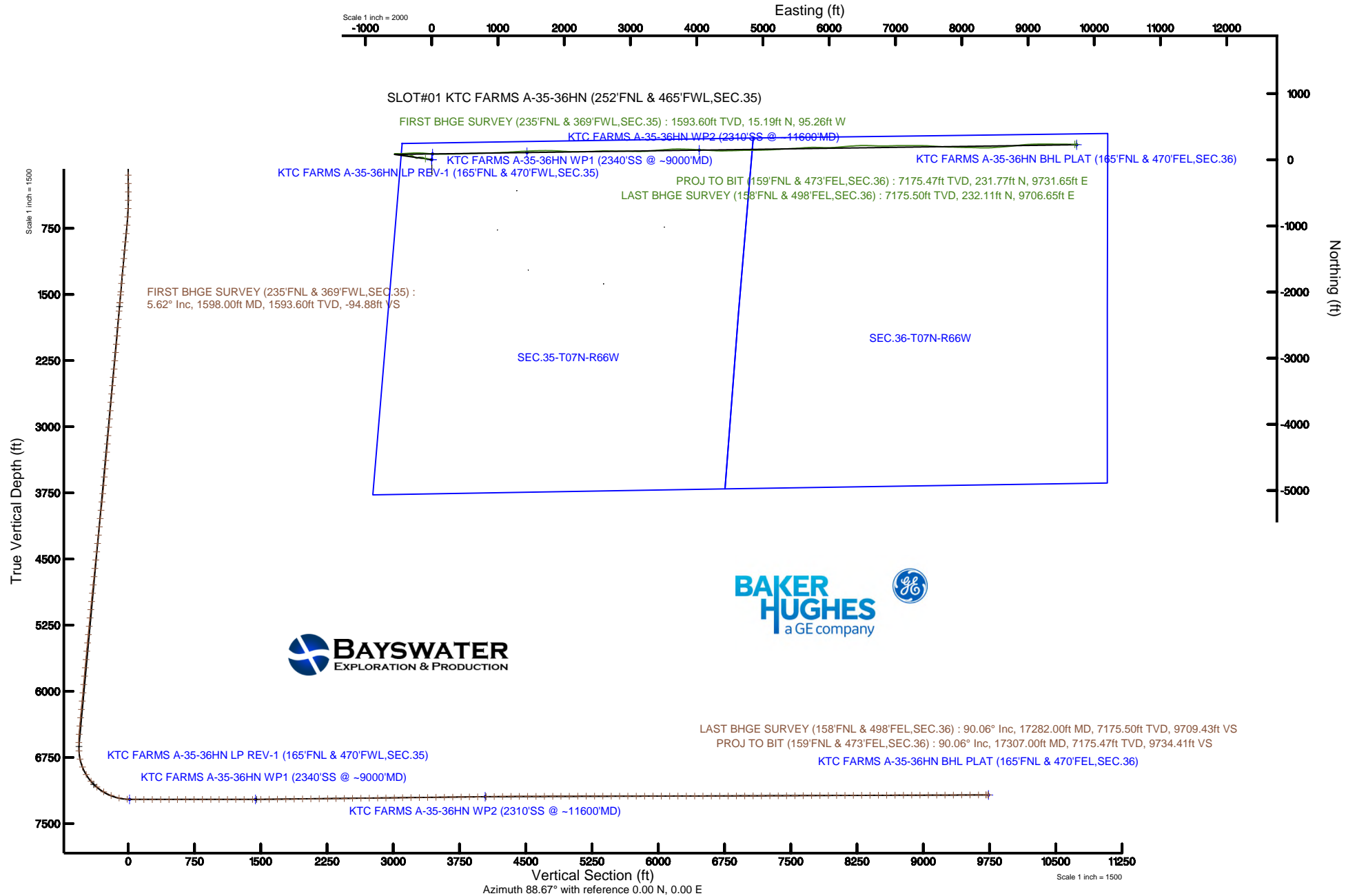

Actual Wellpath Report

KTC FARMS A-35-36HN AWP

Page 1 of 10

REFERENCE WELLPATH IDENTIFICATION			
Operator	BAYSWATER E & P LLC	Slot	SLOT#01 KTC FARMS A-35-36HN (252'FNL & 465'FWL,SEC.35)
Area	COLORADO	Well	KTC FARMS A-35-36HN
Field	WELD COUNTY (NAD83/TRUE NORTH)	Wellbore	KTC FARMS A-35-36HN AWB
Facility	SEC.35-T07N-R66W		

REPORT SETUP INFORMATION			
Projection System	NAD83 / Lambert Colorado SP, Northern Zone (501), US feet	Software System	WellArchitect® 5.1
North Reference	True	User	Bushjamh
Scale	0.999969	Report Generated	11/28/2018 at 4:03:03 AM
Convergence at slot	0.48° East	Database/Source file	Denver/KTC_FARMS_A-35-36HN_AWP.xml

WELLPATH LOCATION						
	Local coordinates		Grid coordinates		Geographic coordinates	
	North[ft]	East[ft]	Easting[US ft]	Northing[US ft]	Latitude	Longitude
Slot Location	0.00	0.00	3207743.27	1439745.05	40°32'17.149"N	104°45'09.216"W
Facility Reference Pt			3207743.27	1439745.05	40°32'17.149"N	104°45'09.216"W
Field Reference Pt			3174587.00	1430859.71	40°30'51.890"N	104°52'19.470"W

WELLPATH DATUM			
Calculation method	Minimum curvature	TRUE 38 (4861'GL+25'KB@4886'RKB) (RKB) to Facility Vertical Datum	4886.00ft
Horizontal Reference Pt	Slot	TRUE 38 (4861'GL+25'KB@4886'RKB) (RKB) to Mean Sea Level	4886.00ft
Vertical Reference Pt	TRUE 38 (4861'GL+25'KB@4886'RKB) (RKB)	TRUE 38 (4861'GL+25'KB@4886'RKB) (RKB) to Ground Level at Slot (SLOT#01 KTC FARMS A-35-36HN (252'FNL & 465'FWL,SEC.35))	4886.00ft
MD Reference Pt	TRUE 38 (4861'GL+25'KB@4886'RKB) (RKB)	Section Origin	N 0.00, E 0.00 ft
Field Vertical Reference	Mean Sea Level	Section Azimuth	88.67°

Actual Wellpath Report

KTC FARMS A-35-36HN AWP

Page 2 of 10

REFERENCE WELLPATH IDENTIFICATION

Operator	BAYSWATER E & P LLC	Slot	SLOT#01 KTC FARMS A-35-36HN (252'FNL & 465'FWL,SEC.35)
Area	COLORADO	Well	KTC FARMS A-35-36HN
Field	WELD COUNTY (NAD83/TRUE NORTH)	Wellbore	KTC FARMS A-35-36HN AWB
Facility	SEC.35-T07N-R66W		

WELLPATH DATA (186 stations) † = interpolated/extrapolated station

MD [ft]	Inclination [°]	Azimuth [°]	TVD [ft]	Vert Sect [ft]	North [ft]	East [ft]	Latitude	Longitude	DLS [°/100ft]	Comments
0.00†	0.000	90.790	0.00	0.00	0.00	0.00	40°32'17.149"N	104°45'09.216"W	0.00	
25.00	0.000	90.790	25.00	0.00	0.00	0.00	40°32'17.149"N	104°45'09.216"W	0.00	
148.00	0.200	90.790	148.00	0.21	0.00	0.21	40°32'17.149"N	104°45'09.213"W	0.16	
243.00	0.470	127.340	243.00	0.68	-0.24	0.69	40°32'17.147"N	104°45'09.207"W	0.35	
337.00	0.560	111.720	336.99	1.41	-0.65	1.42	40°32'17.143"N	104°45'09.198"W	0.18	
432.00	1.030	251.490	431.99	1.02	-1.09	1.05	40°32'17.138"N	104°45'09.202"W	1.58	
527.00	2.270	279.340	526.95	-1.65	-1.05	-1.62	40°32'17.139"N	104°45'09.237"W	1.52	
621.00	3.590	270.670	620.83	-6.42	-0.72	-6.40	40°32'17.142"N	104°45'09.299"W	1.48	
716.00	5.420	279.930	715.53	-13.79	0.09	-13.80	40°32'17.150"N	104°45'09.395"W	2.07	
811.00	5.960	282.850	810.06	-22.97	1.96	-23.02	40°32'17.169"N	104°45'09.514"W	0.64	
905.00	5.910	283.620	903.56	-32.38	4.19	-32.48	40°32'17.191"N	104°45'09.637"W	0.10	
1000.00	5.440	284.110	998.09	-41.45	6.44	-41.61	40°32'17.213"N	104°45'09.755"W	0.50	
1095.00	5.440	285.020	1092.66	-50.11	8.70	-50.32	40°32'17.235"N	104°45'09.868"W	0.09	
1189.00	5.520	277.680	1186.23	-58.85	10.46	-59.11	40°32'17.253"N	104°45'09.982"W	0.75	
1284.00	5.070	278.250	1280.83	-67.50	11.67	-67.79	40°32'17.265"N	104°45'10.094"W	0.48	
1379.00	4.630	279.680	1375.49	-75.40	12.92	-75.72	40°32'17.277"N	104°45'10.197"W	0.48	
1474.00	5.220	272.320	1470.14	-83.48	13.74	-83.82	40°32'17.285"N	104°45'10.302"W	0.91	
1509.00	5.250	271.400	1504.99	-86.67	13.84	-87.01	40°32'17.286"N	104°45'10.343"W	0.25	
1598.00	5.620	286.610	1593.60	-94.88	15.19	-95.26	40°32'17.299"N	104°45'10.450"W	1.67	FIRST BHGE SURVEY (235'FNL & 369'FWL,SEC.35)
1693.00	5.320	293.200	1688.17	-103.31	18.25	-103.76	40°32'17.330"N	104°45'10.560"W	0.73	
1787.00	5.410	292.520	1781.75	-111.33	21.67	-111.86	40°32'17.363"N	104°45'10.665"W	0.12	
1882.00	5.230	300.500	1876.35	-119.11	25.58	-119.73	40°32'17.402"N	104°45'10.767"W	0.80	
1976.00	5.500	302.520	1969.93	-126.49	30.18	-127.22	40°32'17.447"N	104°45'10.864"W	0.35	
2071.00	5.480	285.160	2064.50	-134.62	33.81	-135.44	40°32'17.483"N	104°45'10.970"W	1.74	
2165.00	5.400	265.800	2158.09	-143.34	34.66	-144.18	40°32'17.492"N	104°45'11.083"W	1.95	
2260.00	5.190	270.530	2252.68	-152.10	34.37	-152.94	40°32'17.489"N	104°45'11.197"W	0.51	
2354.00	5.220	277.240	2346.30	-160.58	34.95	-161.43	40°32'17.495"N	104°45'11.307"W	0.65	
2448.00	5.460	270.710	2439.89	-169.28	35.54	-170.15	40°32'17.500"N	104°45'11.420"W	0.69	
2543.00	5.340	269.790	2534.47	-178.21	35.58	-179.09	40°32'17.501"N	104°45'11.535"W	0.16	
2638.00	5.590	270.390	2629.04	-187.26	35.60	-188.13	40°32'17.501"N	104°45'11.653"W	0.27	

Actual Wellpath Report

KTC FARMS A-35-36HN AWP

Page 3 of 10



REFERENCE WELLPATH IDENTIFICATION

Operator	BAYSWATER E & P LLC	Slot	SLOT#01 KTC FARMS A-35-36HN (252'FNL & 465'FWL,SEC.35)
Area	COLORADO	Well	KTC FARMS A-35-36HN
Field	WELD COUNTY (NAD83/TRUE NORTH)	Wellbore	KTC FARMS A-35-36HN AWB
Facility	SEC.35-T07N-R66W		

WELLPATH DATA (186 stations)

MD [ft]	Inclination [°]	Azimuth [°]	TVD [ft]	Vert Sect [ft]	North [ft]	East [ft]	Latitude	Longitude	DLS [°/100ft]	Comments
2733.00	5.530	244.100	2723.61	-196.05	33.63	-196.88	40°32'17.482"N	104°45'11.766"W	2.66	
2828.00	5.440	237.460	2818.17	-204.06	29.21	-204.79	40°32'17.438"N	104°45'11.868"W	0.67	
2923.00	5.410	251.750	2912.75	-212.20	25.39	-212.84	40°32'17.400"N	104°45'11.973"W	1.42	
3017.00	5.440	261.900	3006.33	-220.86	23.37	-221.46	40°32'17.380"N	104°45'12.084"W	1.02	
3112.00	5.200	289.030	3100.94	-229.37	24.14	-229.99	40°32'17.388"N	104°45'12.195"W	2.63	
3206.00	5.490	301.310	3194.53	-237.15	27.86	-237.86	40°32'17.425"N	104°45'12.297"W	1.25	
3301.00	5.540	290.220	3289.09	-245.24	31.81	-246.05	40°32'17.464"N	104°45'12.403"W	1.12	
3395.00	6.030	292.000	3382.61	-254.00	35.23	-254.88	40°32'17.497"N	104°45'12.517"W	0.56	
3490.00	6.180	303.310	3477.08	-262.79	39.91	-263.78	40°32'17.544"N	104°45'12.632"W	1.27	
3584.00	6.230	304.220	3570.53	-271.10	45.55	-272.23	40°32'17.599"N	104°45'12.742"W	0.12	
3679.00	6.170	302.340	3664.97	-279.54	51.18	-280.80	40°32'17.655"N	104°45'12.853"W	0.22	
3773.00	6.300	299.940	3758.42	-288.16	56.46	-289.54	40°32'17.707"N	104°45'12.966"W	0.31	
3868.00	6.280	281.500	3852.86	-297.68	60.10	-299.15	40°32'17.743"N	104°45'13.091"W	2.12	
3963.00	6.230	263.010	3947.30	-307.87	60.51	-309.36	40°32'17.747"N	104°45'13.223"W	2.11	
4058.00	6.040	259.910	4041.76	-317.94	59.00	-319.40	40°32'17.732"N	104°45'13.353"W	0.40	
4152.00	6.200	258.770	4135.22	-327.83	57.15	-329.24	40°32'17.714"N	104°45'13.480"W	0.21	
4247.00	6.080	263.500	4229.68	-337.90	55.58	-339.27	40°32'17.698"N	104°45'13.610"W	0.55	
4342.00	5.960	281.830	4324.16	-347.71	56.02	-349.10	40°32'17.703"N	104°45'13.738"W	2.02	
4437.00	6.180	283.260	4418.63	-357.46	58.21	-358.91	40°32'17.724"N	104°45'13.865"W	0.28	
4531.00	6.220	278.220	4512.08	-367.38	60.09	-368.87	40°32'17.743"N	104°45'13.994"W	0.58	
4626.00	6.270	289.120	4606.52	-377.32	62.53	-378.87	40°32'17.767"N	104°45'14.123"W	1.25	
4721.00	5.910	289.680	4700.98	-386.74	65.88	-388.37	40°32'17.800"N	104°45'14.246"W	0.38	
4815.00	6.020	281.270	4794.47	-396.07	68.47	-397.76	40°32'17.826"N	104°45'14.368"W	0.94	
4909.00	6.110	284.620	4887.95	-405.69	70.69	-407.44	40°32'17.848"N	104°45'14.493"W	0.39	
5003.00	5.600	283.980	4981.46	-414.93	73.07	-416.73	40°32'17.871"N	104°45'14.613"W	0.55	
5097.00	5.710	286.600	5075.00	-423.80	75.51	-425.66	40°32'17.895"N	104°45'14.729"W	0.30	
5191.00	5.510	274.740	5168.55	-432.74	77.22	-434.64	40°32'17.912"N	104°45'14.845"W	1.25	
5286.00	5.610	272.510	5263.11	-441.90	77.80	-443.83	40°32'17.918"N	104°45'14.964"W	0.25	
5381.00	5.330	271.920	5357.67	-450.94	78.15	-452.87	40°32'17.921"N	104°45'15.082"W	0.30	
5476.00	5.470	272.340	5452.25	-459.87	78.48	-461.81	40°32'17.925"N	104°45'15.197"W	0.15	

Actual Wellpath Report

KTC FARMS A-35-36HN AWP

Page 4 of 10



REFERENCE WELLPATH IDENTIFICATION

Operator	BAYSWATER E & P LLC	Slot	SLOT#01 KTC FARMS A-35-36HN (252'FNL & 465'FWL,SEC.35)
Area	COLORADO	Well	KTC FARMS A-35-36HN
Field	WELD COUNTY (NAD83/TRUE NORTH)	Wellbore	KTC FARMS A-35-36HN AWB
Facility	SEC.35-T07N-R66W		

WELLPATH DATA (186 stations)

MD [ft]	Inclination [°]	Azimuth [°]	TVD [ft]	Vert Sect [ft]	North [ft]	East [ft]	Latitude	Longitude	DLS [°/100ft]	Comments
5570.00	5.390	271.350	5545.83	-468.75	78.77	-470.70	40°32'17.928"N	104°45'15.312"W	0.13	
5665.00	5.460	264.390	5640.41	-477.71	78.43	-479.66	40°32'17.924"N	104°45'15.428"W	0.70	
5759.00	5.330	280.170	5734.00	-486.45	78.77	-488.41	40°32'17.927"N	104°45'15.542"W	1.58	
5854.00	5.350	281.520	5828.58	-495.09	80.43	-497.09	40°32'17.944"N	104°45'15.654"W	0.13	
5949.00	5.320	285.620	5923.17	-503.62	82.50	-505.67	40°32'17.964"N	104°45'15.765"W	0.40	
6044.00	5.340	284.850	6017.76	-512.08	84.82	-514.18	40°32'17.987"N	104°45'15.876"W	0.08	
6138.00	5.710	284.540	6111.32	-520.78	87.11	-522.94	40°32'18.010"N	104°45'15.989"W	0.39	
6233.00	5.570	276.230	6205.87	-529.90	88.80	-532.10	40°32'18.027"N	104°45'16.108"W	0.87	
6327.00	5.270	266.130	6299.45	-538.73	89.00	-540.94	40°32'18.029"N	104°45'16.222"W	1.06	
6422.00	5.450	260.550	6394.03	-547.56	87.97	-549.74	40°32'18.018"N	104°45'16.336"W	0.58	
6516.00	4.450	256.310	6487.68	-555.54	86.37	-557.69	40°32'18.003"N	104°45'16.439"W	1.13	
6610.00	0.180	9.810	6581.59	-559.07	85.66	-561.21	40°32'17.995"N	104°45'16.485"W	4.81	
6705.00	2.370	96.110	6676.56	-557.10	85.59	-559.23	40°32'17.995"N	104°45'16.459"W	2.49	
6798.00	11.970	85.540	6768.73	-545.53	86.14	-547.68	40°32'18.000"N	104°45'16.309"W	10.38	
6893.00	21.890	85.600	6859.50	-517.94	88.27	-520.13	40°32'18.021"N	104°45'15.953"W	10.44	
6987.00	31.240	88.110	6943.48	-475.98	90.42	-478.20	40°32'18.043"N	104°45'15.410"W	10.02	
7081.00	40.650	87.710	7019.50	-420.87	92.46	-423.12	40°32'18.063"N	104°45'14.696"W	10.01	
7175.00	49.600	86.180	7085.76	-354.36	96.07	-356.68	40°32'18.098"N	104°45'13.836"W	9.59	
7270.00	59.760	87.050	7140.61	-276.99	100.60	-279.40	40°32'18.143"N	104°45'12.835"W	10.72	
7364.00	67.660	91.450	7182.23	-192.82	101.60	-195.22	40°32'18.153"N	104°45'11.745"W	9.39	
7458.00	77.160	94.420	7210.61	-103.58	96.95	-105.85	40°32'18.107"N	104°45'10.587"W	10.54	
7552.00	86.520	94.700	7223.93	-11.13	89.56	-13.20	40°32'18.034"N	104°45'09.387"W	9.96	
7647.00	89.970	90.850	7226.84	83.55	84.97	81.61	40°32'17.989"N	104°45'08.159"W	5.44	
7741.00	89.750	89.490	7227.07	177.52	84.69	175.61	40°32'17.986"N	104°45'06.942"W	1.47	
7836.00	90.060	89.550	7227.23	272.51	85.48	270.60	40°32'17.994"N	104°45'05.711"W	0.33	
7931.00	89.850	88.350	7227.30	367.51	87.23	365.58	40°32'18.011"N	104°45'04.481"W	1.28	
8026.00	90.090	88.270	7227.35	462.50	90.03	460.54	40°32'18.039"N	104°45'03.251"W	0.27	
8120.00	90.250	88.470	7227.08	556.50	92.70	554.50	40°32'18.065"N	104°45'02.034"W	0.27	
8214.00	90.060	88.330	7226.82	650.50	95.33	648.47	40°32'18.091"N	104°45'00.817"W	0.25	
8309.00	90.180	88.460	7226.62	745.50	97.99	743.43	40°32'18.117"N	104°44'59.587"W	0.19	

Actual Wellpath Report

KTC FARMS A-35-36HN AWP

Page 5 of 10



REFERENCE WELLPATH IDENTIFICATION

Operator	BAYSWATER E & P LLC	Slot	SLOT#01 KTC FARMS A-35-36HN (252'FNL & 465'FWL,SEC.35)
Area	COLORADO	Well	KTC FARMS A-35-36HN
Field	WELD COUNTY (NAD83/TRUE NORTH)	Wellbore	KTC FARMS A-35-36HN AWB
Facility	SEC.35-T07N-R66W		

WELLPATH DATA (186 stations)

MD [ft]	Inclination [°]	Azimuth [°]	TVD [ft]	Vert Sect [ft]	North [ft]	East [ft]	Latitude	Longitude	DLS [°/100ft]	Comments
8404.00	90.150	88.600	7226.35	840.50	100.42	838.40	40°32'18.141"N	104°44'58.357"W	0.15	
8498.00	89.970	87.930	7226.25	934.50	103.27	932.35	40°32'18.169"N	104°44'57.140"W	0.74	
8592.00	89.850	87.860	7226.40	1028.49	106.72	1026.29	40°32'18.204"N	104°44'55.924"W	0.15	
8687.00	89.910	86.860	7226.60	1123.46	111.10	1121.19	40°32'18.247"N	104°44'54.694"W	1.05	
8781.00	90.180	86.350	7226.52	1217.40	116.66	1215.02	40°32'18.302"N	104°44'53.479"W	0.61	
8876.00	89.880	86.240	7226.47	1312.32	122.80	1309.82	40°32'18.362"N	104°44'52.251"W	0.34	
8970.00	90.150	87.540	7226.45	1406.27	127.90	1403.68	40°32'18.413"N	104°44'51.036"W	1.41	
9064.00	90.580	87.740	7225.85	1500.25	131.77	1497.60	40°32'18.451"N	104°44'49.819"W	0.50	
9159.00	90.340	88.150	7225.09	1595.24	135.18	1592.54	40°32'18.484"N	104°44'48.590"W	0.50	
9253.00	90.620	89.550	7224.30	1689.24	137.07	1686.51	40°32'18.503"N	104°44'47.372"W	1.52	
9348.00	90.680	91.090	7223.22	1784.19	136.54	1781.50	40°32'18.498"N	104°44'46.142"W	1.62	
9443.00	90.620	92.280	7222.14	1879.05	133.74	1876.45	40°32'18.470"N	104°44'44.912"W	1.25	
9538.00	90.770	94.010	7220.99	1973.75	128.53	1971.30	40°32'18.418"N	104°44'43.684"W	1.83	
9632.00	90.680	92.460	7219.80	2067.44	123.23	2065.14	40°32'18.366"N	104°44'42.468"W	1.65	
9727.00	90.520	90.570	7218.81	2162.31	120.72	2160.10	40°32'18.341"N	104°44'41.239"W	2.00	
9821.00	90.770	89.150	7217.75	2256.28	120.95	2254.09	40°32'18.343"N	104°44'40.021"W	1.53	
9916.00	90.460	88.380	7216.73	2351.28	122.99	2349.06	40°32'18.363"N	104°44'38.791"W	0.87	
10010.00	90.800	87.620	7215.70	2445.27	126.27	2443.00	40°32'18.396"N	104°44'37.574"W	0.89	
10104.00	90.800	86.530	7214.38	2539.22	131.07	2536.86	40°32'18.443"N	104°44'36.359"W	1.16	
10199.00	91.020	91.350	7212.87	2634.18	132.83	2631.81	40°32'18.460"N	104°44'35.129"W	5.08	
10294.00	90.520	90.980	7211.60	2729.08	130.90	2726.78	40°32'18.441"N	104°44'33.899"W	0.65	
10388.00	90.680	90.040	7210.61	2823.02	130.06	2820.77	40°32'18.433"N	104°44'32.682"W	1.01	
10482.00	90.580	90.160	7209.58	2916.99	129.89	2914.76	40°32'18.431"N	104°44'31.464"W	0.17	
10577.00	90.830	92.490	7208.41	3011.87	127.70	3009.72	40°32'18.409"N	104°44'30.234"W	2.47	
10671.00	90.770	90.470	7207.10	3105.75	125.27	3103.68	40°32'18.385"N	104°44'29.017"W	2.15	
10766.00	90.520	88.670	7206.03	3200.72	125.98	3198.66	40°32'18.392"N	104°44'27.787"W	1.91	
10861.00	90.580	84.350	7205.12	3295.63	131.77	3293.46	40°32'18.449"N	104°44'26.559"W	4.55	
10955.00	90.920	84.730	7203.89	3389.38	140.71	3387.03	40°32'18.537"N	104°44'25.347"W	0.54	
11050.00	90.620	86.160	7202.61	3484.22	148.25	3481.72	40°32'18.612"N	104°44'24.121"W	1.54	
11145.00	90.740	85.540	7201.48	3579.09	155.13	3576.46	40°32'18.680"N	104°44'22.894"W	0.66	

Actual Wellpath Report

KTC FARMS A-35-36HN AWP

Page 6 of 10



REFERENCE WELLPATH IDENTIFICATION

Operator	BAYSWATER E & P LLC	Slot	SLOT#01 KTC FARMS A-35-36HN (252'FNL & 465'FWL,SEC.35)
Area	COLORADO	Well	KTC FARMS A-35-36HN
Field	WELD COUNTY (NAD83/TRUE NORTH)	Wellbore	KTC FARMS A-35-36HN AWB
Facility	SEC.35-T07N-R66W		

WELLPATH DATA (186 stations)

MD [ft]	Inclination [°]	Azimuth [°]	TVD [ft]	Vert Sect [ft]	North [ft]	East [ft]	Latitude	Longitude	DLS [°/100ft]	Comments
11240.00	90.710	88.420	7200.28	3674.03	160.13	3671.31	40°32'18.729"N	104°44'21.665"W	3.03	
11334.00	90.490	91.290	7199.29	3768.00	160.37	3765.29	40°32'18.731"N	104°44'20.448"W	3.06	
11428.00	90.920	91.730	7198.14	3861.88	157.89	3859.25	40°32'18.706"N	104°44'19.231"W	0.65	
11522.00	90.550	92.830	7196.93	3955.68	154.15	3953.17	40°32'18.669"N	104°44'18.015"W	1.23	
11616.00	90.800	92.650	7195.82	4049.44	149.66	4047.06	40°32'18.625"N	104°44'16.799"W	0.33	
11710.00	90.980	93.660	7194.36	4143.14	144.49	4140.90	40°32'18.573"N	104°44'15.583"W	1.09	
11805.00	90.740	93.610	7192.94	4237.77	138.46	4235.70	40°32'18.514"N	104°44'14.355"W	0.26	
11900.00	90.280	91.470	7192.09	4332.54	134.25	4330.60	40°32'18.472"N	104°44'13.126"W	2.30	
11994.00	90.150	88.500	7191.74	4426.51	134.28	4424.59	40°32'18.472"N	104°44'11.909"W	3.16	
12089.00	90.000	88.750	7191.62	4521.51	136.56	4519.56	40°32'18.494"N	104°44'10.679"W	0.31	
12183.00	90.180	88.130	7191.47	4615.51	139.12	4613.52	40°32'18.520"N	104°44'09.462"W	0.69	
12278.00	90.250	87.910	7191.11	4710.50	142.40	4708.46	40°32'18.552"N	104°44'08.232"W	0.24	
12373.00	90.280	90.500	7190.67	4805.49	143.72	4803.45	40°32'18.565"N	104°44'07.002"W	2.73	
12466.00	90.060	89.380	7190.40	4898.46	143.82	4896.44	40°32'18.565"N	104°44'05.798"W	1.23	
12561.00	90.250	88.160	7190.14	4993.46	145.85	4991.42	40°32'18.585"N	104°44'04.567"W	1.30	
12656.00	90.280	88.210	7189.70	5088.46	148.86	5086.37	40°32'18.615"N	104°44'03.338"W	0.06	
12751.00	90.180	86.230	7189.32	5183.42	153.47	5181.25	40°32'18.660"N	104°44'02.109"W	2.09	
12846.00	89.940	86.740	7189.22	5278.35	159.30	5276.08	40°32'18.718"N	104°44'00.881"W	0.59	
12940.00	90.090	86.950	7189.19	5372.30	164.47	5369.93	40°32'18.769"N	104°43'59.665"W	0.27	
13035.00	89.970	87.080	7189.14	5467.26	169.42	5464.80	40°32'18.817"N	104°43'58.436"W	0.19	
13130.00	89.850	85.960	7189.29	5562.19	175.18	5559.63	40°32'18.874"N	104°43'57.208"W	1.19	
13224.00	90.090	85.870	7189.34	5656.08	181.88	5653.39	40°32'18.940"N	104°43'55.993"W	0.27	
13319.00	90.180	89.400	7189.12	5751.05	185.80	5748.29	40°32'18.979"N	104°43'54.764"W	3.72	
13413.00	90.090	92.330	7188.90	5844.97	184.38	5842.27	40°32'18.964"N	104°43'53.547"W	3.12	
13508.00	90.120	91.200	7188.72	5939.83	181.45	5937.22	40°32'18.935"N	104°43'52.317"W	1.19	
13602.00	90.250	87.290	7188.42	6033.81	182.69	6031.20	40°32'18.947"N	104°43'51.100"W	4.16	
13697.00	90.000	85.290	7188.21	6128.72	188.84	6125.99	40°32'19.008"N	104°43'49.872"W	2.12	
13791.00	89.940	84.890	7188.26	6222.54	196.88	6219.65	40°32'19.087"N	104°43'48.659"W	0.43	
13886.00	90.120	86.120	7188.21	6317.39	204.33	6314.35	40°32'19.160"N	104°43'47.433"W	1.31	
13981.00	90.030	86.190	7188.09	6412.30	210.70	6409.14	40°32'19.223"N	104°43'46.205"W	0.12	

Actual Wellpath Report

KTC FARMS A-35-36HN AWP

Page 7 of 10



REFERENCE WELLPATH IDENTIFICATION

Operator	BAYSWATER E & P LLC	Slot	SLOT#01 KTC FARMS A-35-36HN (252'FNL & 465'FWL,SEC.35)
Area	COLORADO	Well	KTC FARMS A-35-36HN
Field	WELD COUNTY (NAD83/TRUE NORTH)	Wellbore	KTC FARMS A-35-36HN AWB
Facility	SEC.35-T07N-R66W		

WELLPATH DATA (186 stations)

MD [ft]	Inclination [°]	Azimuth [°]	TVD [ft]	Vert Sect [ft]	North [ft]	East [ft]	Latitude	Longitude	DLS [°/100ft]	Comments
14075.00	90.060	89.060	7188.01	6506.28	214.59	6503.05	40°32'19.261"N	104°43'44.989"W	3.05	
14170.00	90.220	92.180	7187.78	6601.21	213.57	6598.03	40°32'19.251"N	104°43'43.758"W	3.29	
14265.00	90.220	92.440	7187.42	6696.02	209.74	6692.95	40°32'19.213"N	104°43'42.529"W	0.27	
14359.00	90.180	90.320	7187.09	6789.91	207.47	6786.92	40°32'19.190"N	104°43'41.312"W	2.26	
14453.00	90.150	88.740	7186.82	6883.89	208.24	6880.91	40°32'19.197"N	104°43'40.095"W	1.68	
14548.00	90.180	87.860	7186.54	6978.89	211.06	6975.87	40°32'19.225"N	104°43'38.865"W	0.93	
14643.00	90.120	89.630	7186.30	7073.88	213.14	7070.84	40°32'19.245"N	104°43'37.635"W	1.86	
14737.00	90.370	90.240	7185.89	7167.86	213.25	7164.84	40°32'19.246"N	104°43'36.417"W	0.70	
14832.00	90.180	90.470	7185.44	7262.82	212.66	7259.84	40°32'19.240"N	104°43'35.187"W	0.31	
14927.00	90.150	89.460	7185.16	7357.79	212.72	7354.84	40°32'19.240"N	104°43'33.956"W	1.06	
15021.00	90.370	91.950	7184.74	7451.72	211.56	7448.82	40°32'19.229"N	104°43'32.739"W	2.66	
15116.00	90.490	94.510	7184.02	7546.41	206.21	7543.66	40°32'19.175"N	104°43'31.511"W	2.70	
15211.00	90.250	93.650	7183.41	7640.99	199.45	7638.42	40°32'19.108"N	104°43'30.283"W	0.94	
15305.00	90.580	92.670	7182.73	7734.70	194.27	7732.27	40°32'19.057"N	104°43'29.068"W	1.10	
15400.00	90.280	90.720	7182.02	7829.56	191.46	7827.22	40°32'19.029"N	104°43'27.838"W	2.08	
15495.00	90.220	92.260	7181.60	7924.44	188.99	7922.19	40°32'19.004"N	104°43'26.608"W	1.62	
15589.00	90.220	91.370	7181.24	8018.29	186.01	8016.14	40°32'18.974"N	104°43'25.391"W	0.95	
15684.00	90.250	90.170	7180.85	8113.23	184.74	8111.13	40°32'18.961"N	104°43'24.161"W	1.26	
15779.00	90.280	92.350	7180.41	8208.12	182.65	8206.10	40°32'18.941"N	104°43'22.931"W	2.29	
15873.00	90.220	91.210	7180.00	8301.98	179.73	8300.05	40°32'18.911"N	104°43'21.714"W	1.21	
15968.00	90.370	88.640	7179.51	8396.95	179.85	8395.04	40°32'18.912"N	104°43'20.484"W	2.71	
16063.00	90.400	85.930	7178.87	8491.91	184.35	8489.92	40°32'18.956"N	104°43'19.255"W	2.85	
16157.00	90.030	85.610	7178.52	8585.79	191.29	8583.66	40°32'19.025"N	104°43'18.041"W	0.52	
16252.00	90.150	85.380	7178.37	8680.65	198.75	8678.37	40°32'19.098"N	104°43'16.814"W	0.27	
16347.00	90.090	83.970	7178.17	8775.41	207.56	8772.96	40°32'19.185"N	104°43'15.589"W	1.49	
16441.00	90.150	83.230	7177.98	8869.04	218.04	8866.37	40°32'19.288"N	104°43'14.379"W	0.79	
16535.00	90.030	85.390	7177.83	8962.76	227.36	8959.90	40°32'19.380"N	104°43'13.167"W	2.30	
16630.00	90.090	87.990	7177.73	9057.70	232.85	9054.74	40°32'19.434"N	104°43'11.939"W	2.74	
16724.00	90.060	88.570	7177.61	9151.70	235.67	9148.69	40°32'19.461"N	104°43'10.722"W	0.62	
16818.00	90.120	90.390	7177.46	9245.68	236.52	9242.68	40°32'19.469"N	104°43'09.505"W	1.94	

Actual Wellpath Report

KTC FARMS A-35-36HN AWP

Page 8 of 10

REFERENCE WELLPATH IDENTIFICATION

Operator	BAYSWATER E & P LLC	Slot	SLOT#01 KTC FARMS A-35-36HN (252'FNL & 465'FWL,SEC.35)
Area	COLORADO	Well	KTC FARMS A-35-36HN
Field	WELD COUNTY (NAD83/TRUE NORTH)	Wellbore	KTC FARMS A-35-36HN AWB
Facility	SEC.35-T07N-R66W		

WELLPATH DATA (186 stations)

MD [ft]	Inclination [°]	Azimuth [°]	TVD [ft]	Vert Sect [ft]	North [ft]	East [ft]	Latitude	Longitude	DLS [°/100ft]	Comments
16913.00	90.340	90.440	7177.08	9340.64	235.83	9337.68	40°32'19.462"N	104°43'08.274"W	0.24	
17007.00	90.250	90.160	7176.59	9434.60	235.34	9431.68	40°32'19.457"N	104°43'07.057"W	0.31	
17102.00	90.340	90.520	7176.10	9529.56	234.78	9526.68	40°32'19.451"N	104°43'05.827"W	0.39	
17197.00	90.180	91.060	7175.67	9624.49	233.47	9621.67	40°32'19.438"N	104°43'04.596"W	0.59	
17282.00	90.060	90.770	7175.50	9709.43	232.11	9706.65	40°32'19.424"N	104°43'03.495"W	0.37	LAST BHGE SURVEY (158'FNL & 498'FEL,SEC.36)
17307.00	90.060	90.770	7175.47	9734.41	231.77	9731.65	40°32'19.420"N	104°43'03.172"W	0.00	PROJ TO BIT (159'FNL & 473'FEL,SEC.36)

TARGETS

Name	TVD [ft]	North [ft]	East [ft]	Grid East [US ft]	Grid North [US ft]	Latitude	Longitude	Shape
KTC FARMS A-35-36HN BHL PLAT (165'FNL & 470'FEL,SEC.36)	7176.00	225.62	9734.90	3217475.61	1440052.70	40°32'19.360"N	104°43'03.130"W	point
KTC FARMS A-35-36HN WP2 (2310'SS @ ~11600'MD)	7196.00	144.65	4038.38	3211780.15	1439923.73	40°32'18.575"N	104°44'16.911"W	point
KTC FARMS A-35-36HN LP REV-1 (165'FNL & 470'FWL,SEC.35)	7226.00	87.44	12.79	3207755.31	1439832.58	40°32'18.013"N	104°45'09.050"W	point
KTC FARMS A-35-36HN WP1 (2340'SS @ ~9000'MD)	7226.00	107.71	1439.00	3209181.26	1439864.87	40°32'18.213"N	104°44'50.578"W	point
SEC.35-T07N-R66W	12000.00	0.00	0.00	3207743.27	1439745.05	40°32'17.149"N	104°45'09.216"W	polygon
SEC.36-T07N-R66W	12000.00	0.00	0.00	3207743.27	1439745.05	40°32'17.149"N	104°45'09.216"W	polygon

Actual Wellpath Report

KTC FARMS A-35-36HN AWP

Page 9 of 10

REFERENCE WELLPATH IDENTIFICATION

Operator	BAYSWATER E & P LLC	Slot	SLOT#01 KTC FARMS A-35-36HN (252'FNL & 465'FWL,SEC.35)
Area	COLORADO	Well	KTC FARMS A-35-36HN
Field	WELD COUNTY (NAD83/TRUE NORTH)	Wellbore	KTC FARMS A-35-36HN AWB
Facility	SEC.35-T07N-R66W		

WELLPATH COMPOSITION - Ref Wellbore: KTC FARMS A-35-36HN AWB Ref Wellpath: KTC FARMS A-35-36HN AWP

Start MD [ft]	End MD [ft]	Positional Uncertainty Model	Log Name/Comment	Wellbore
25.00	1509.00	BHI NaviTrak (Standard)	BHI NAVITRAK (STANDARD) <148-1509>	KTC FARMS A-35-36HN AWB
1509.00	17282.00	BHI AutoTrak Curve (Short)	BHI AUTOTRAK CURVE (SHORT) <1598-17282>	KTC FARMS A-35-36HN AWB
17282.00	17307.00	Blind Drilling (std)	Projection to bit	KTC FARMS A-35-36HN AWB

Actual Wellpath Report

KTC FARMS A-35-36HN AWP

Page 10 of 10

REFERENCE WELLPATH IDENTIFICATION

Operator	BAYSWATER E & P LLC	Slot	SLOT#01 KTC FARMS A-35-36HN (252'FNL & 465'FWL,SEC.35)
Area	COLORADO	Well	KTC FARMS A-35-36HN
Field	WELD COUNTY (NAD83/TRUE NORTH)	Wellbore	KTC FARMS A-35-36HN AWB
Facility	SEC.35-T07N-R66W		

WELLPATH COMMENTS

MD [ft]	Inclination [°]	Azimuth [°]	TVD [ft]	Comment
1598.00	5.620	286.610	1593.60	FIRST BHGE SURVEY (235'FNL & 369'FWL,SEC.35)
17282.00	90.060	90.770	7175.50	LAST BHGE SURVEY (158'FNL & 498'FEL,SEC.36)
17307.00	90.060	90.770	7175.47	PROJ TO BIT (159'FNL & 473'FEL,SEC.36)