

# SRC ENERGY

Location: COLORADO Slot: SLOT#11 TROUDT 40C-23-M ( 760'FNL & 1745'FWL, SEC.27)  
Field: WELD COUNTY (NAD83,TRUE NORTH) Well: TROUDT 40C-23-M  
Facility: SEC.27-T06N-R66W Wellbore: TROUDT 40C-23-M PWB

Plot reference wellpath is TROUDT 40C-23-M PWP (REV-B.0)	Grid System: NAD83 / Lambert Colorado SP, Northern Zone (501), US feet
True vertical depths are referenced to PD 562 (25) (RKB)	North Reference: True north
Measured depths are referenced to PD 562 (25) (RKB)	Scale: True distance
PD 562 (25) (RKB) to Mean Sea Level: 4744 feet	Depths are in feet
Mean Sea Level to Mud line (At Slot: SLOT#11 TROUDT 40C-23-M ( 760'FNL & 1745'FWL, SEC.27)): 0 feet	Created by: robale01 on 2018-10-26
Coordinates are in feet referenced to Slot	Database: WA DENVER

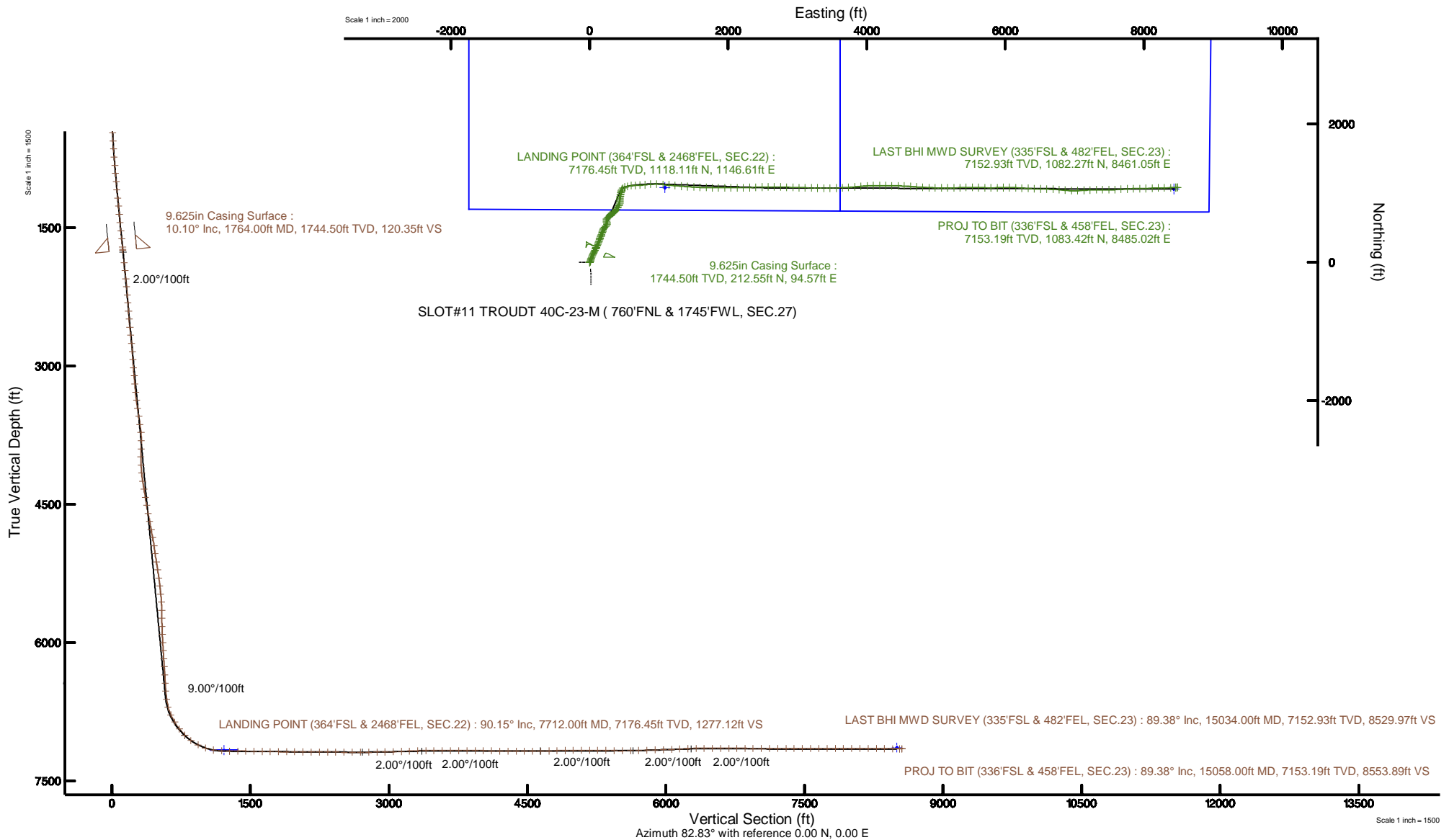



# Actual Wellpath Report

TROUDT 40C-23-M AWP

Page 1 of 9



REFERENCE WELLPATH IDENTIFICATION			
Operator	SRC ENERGY	Slot	SLOT#11 TROUDT 40C-23-M ( 760'FNL & 1745'FWL, SEC.27)
Area	COLORADO	Well	TROUDT 40C-23-M
Field	WELD COUNTY (NAD83,TRUE NORTH)	Wellbore	TROUDT 40C-23-M AWB
Facility	SEC.27-T06N-R66W		

REPORT SETUP INFORMATION			
Projection System	NAD83 / Lambert Colorado SP, Northern Zone (501), US feet	Software System	WellArchitect® 5.0
North Reference	True	User	Guenaler
Scale	0.999964	Report Generated	10/26/2018 at 10:46:40 AM
Convergence at slot	0.48° East	Database/Source file	WA_DEN_Denver_Defn/TROUDT_40C-23-M_AWP.xml

WELLPATH LOCATION						
	Local coordinates		Grid coordinates		Geographic coordinates	
	North[ft]	East[ft]	Easting[US ft]	Northing[US ft]	Latitude	Longitude
Slot Location	-0.02	150.01	3203923.74	1412933.93	40°27'52.531"N	104°46'01.556"W
Facility Reference Pt			3203773.74	1412932.71	40°27'52.531"N	104°46'03.497"W
Field Reference Pt			3171284.48	1426358.81	40°30'07.643"N	104°53'02.634"W

WELLPATH DATUM			
Calculation method	Minimum curvature	PD 562 (25') (RKB) to Facility Vertical Datum	4744.00ft
Horizontal Reference Pt	Slot	PD 562 (25') (RKB) to Mean Sea Level	4744.00ft
Vertical Reference Pt	PD 562 (25') (RKB)	PD 562 (25') (RKB) to Mud Line at Slot (SLOT#11 TROUDT 40C-23-M ( 760'FNL & 1745'FWL, SEC.27))	4744.00ft
MD Reference Pt	PD 562 (25') (RKB)	Section Origin	N 0.00, E 0.00 ft
Field Vertical Reference	Mean Sea Level	Section Azimuth	82.83°



Actual Wellpath Report  
TROUDT 40C-23-M AWP  
Page 2 of 9



REFERENCE WELLPATH IDENTIFICATION			
Operator	SRC ENERGY	Slot	SLOT#11 TROUDT 40C-23-M ( 760'FNL & 1745'FWL, SEC.27)
Area	COLORADO	Well	TROUDT 40C-23-M
Field	WELD COUNTY (NAD83,TRUE NORTH)	Wellbore	TROUDT 40C-23-M AWB
Facility	SEC.27-T06N-R66W		

WELLPATH DATA (171 stations) † = interpolated/extrapolated station										
MD [ft]	Inclination [°]	Azimuth [°]	TVD [ft]	Vert Sect [ft]	North [ft]	East [ft]	Latitude	Longitude	DLS [°/100ft]	Comments
0.00†	0.000	81.180	0.00	0.00	0.00	0.00	40°27'52.531"N	104°46'01.556"W	0.00	
25.00	0.000	81.180	25.00	0.00	0.00	0.00	40°27'52.531"N	104°46'01.556"W	0.00	
109.00	0.670	81.180	109.00	0.49	0.08	0.49	40°27'52.532"N	104°46'01.550"W	0.80	
197.00	1.220	59.730	196.99	1.87	0.63	1.80	40°27'52.537"N	104°46'01.533"W	0.73	
287.00	1.660	53.240	286.96	3.88	1.89	3.67	40°27'52.550"N	104°46'01.508"W	0.52	
377.00	2.790	29.660	376.89	6.33	4.57	5.80	40°27'52.576"N	104°46'01.481"W	1.59	
467.00	4.910	17.590	466.68	9.25	10.15	8.05	40°27'52.631"N	104°46'01.452"W	2.51	
557.00	7.170	18.920	556.18	13.34	19.13	11.04	40°27'52.720"N	104°46'01.413"W	2.52	
647.00	9.610	17.940	645.21	19.00	31.60	15.17	40°27'52.843"N	104°46'01.360"W	2.72	
737.00	10.850	18.930	733.78	25.91	46.76	20.23	40°27'52.993"N	104°46'01.294"W	1.39	
827.00	10.310	18.550	822.25	33.13	62.41	25.54	40°27'53.148"N	104°46'01.226"W	0.60	
917.00	10.710	21.280	910.74	40.61	77.83	31.14	40°27'53.300"N	104°46'01.153"W	0.71	
1007.00	10.310	21.450	999.23	48.45	93.12	37.12	40°27'53.451"N	104°46'01.076"W	0.45	
1097.00	10.150	25.250	1087.80	56.56	107.79	43.45	40°27'53.596"N	104°46'00.994"W	0.77	
1187.00	9.630	26.250	1176.46	64.95	121.71	50.16	40°27'53.734"N	104°46'00.907"W	0.61	
1277.00	9.220	27.780	1265.24	73.23	134.85	56.85	40°27'53.863"N	104°46'00.820"W	0.53	
1367.00	10.020	26.520	1353.98	81.70	148.23	63.71	40°27'53.996"N	104°46'00.732"W	0.92	
1457.00	9.870	23.260	1442.63	89.95	162.32	70.25	40°27'54.135"N	104°46'00.647"W	0.65	
1547.00	11.150	26.500	1531.11	98.68	177.20	77.18	40°27'54.282"N	104°46'00.557"W	1.57	
1637.00	10.630	25.260	1619.49	107.96	192.49	84.61	40°27'54.433"N	104°46'00.461"W	0.63	
1727.00	9.840	26.630	1708.06	116.68	206.88	91.60	40°27'54.575"N	104°46'00.371"W	0.92	
1755.00	10.060	28.330	1735.64	119.44	211.17	93.83	40°27'54.618"N	104°46'00.342"W	1.31	
1898.00	10.750	25.730	1876.29	133.93	234.18	105.55	40°27'54.845"N	104°46'00.190"W	0.58	
1988.00	10.650	25.310	1964.72	142.95	249.25	112.74	40°27'54.994"N	104°46'00.097"W	0.14	
2077.00	10.780	24.220	2052.17	151.70	264.28	119.68	40°27'55.142"N	104°46'00.008"W	0.27	
2166.00	10.750	22.330	2139.61	160.13	279.55	126.24	40°27'55.293"N	104°45'59.923"W	0.40	
2255.00	10.680	19.300	2227.05	167.89	295.01	132.12	40°27'55.446"N	104°45'59.847"W	0.64	
2345.00	10.600	16.400	2315.51	174.91	310.82	137.22	40°27'55.602"N	104°45'59.781"W	0.60	
2434.00	10.630	16.840	2402.98	181.53	326.53	141.91	40°27'55.758"N	104°45'59.720"W	0.10	
2523.00	10.650	20.170	2490.45	188.64	342.11	147.12	40°27'55.912"N	104°45'59.653"W	0.69	



Actual Wellpath Report  
TROUDT 40C-23-M AWP  
Page 3 of 9



REFERENCE WELLPATH IDENTIFICATION			
Operator	SRC ENERGY	Slot	SLOT#11 TROUDT 40C-23-M ( 760'FNL & 1745'FWL, SEC.27)
Area	COLORADO	Well	TROUDT 40C-23-M
Field	WELD COUNTY (NAD83,TRUE NORTH)	Wellbore	TROUDT 40C-23-M AWB
Facility	SEC.27-T06N-R66W		

WELLPATH DATA (171 stations)											
MD [ft]	Inclination [°]	Azimuth [°]	TVD [ft]	Vert Sect [ft]	North [ft]	East [ft]	Latitude	Longitude	DLS [°/100ft]	Comments	
2613.00	10.520	25.230	2578.93	196.86	357.35	153.49	40°27'56.062"N	104°45'59.570"W	1.04		
2702.00	10.570	26.150	2666.42	205.70	372.02	160.55	40°27'56.207"N	104°45'59.479"W	0.20		
2792.00	11.010	23.890	2754.83	214.67	387.29	167.67	40°27'56.358"N	104°45'59.387"W	0.68		
2881.00	10.630	17.180	2842.25	222.44	402.91	173.54	40°27'56.512"N	104°45'59.311"W	1.48		
2971.00	10.570	15.920	2930.72	229.09	418.77	178.25	40°27'56.669"N	104°45'59.250"W	0.27		
3060.00	10.560	16.840	3018.21	235.61	434.43	182.85	40°27'56.824"N	104°45'59.190"W	0.19		
3149.00	10.620	17.310	3105.69	242.33	450.06	187.66	40°27'56.978"N	104°45'59.128"W	0.12		
3239.00	10.250	18.630	3194.20	249.25	465.57	192.68	40°27'57.132"N	104°45'59.063"W	0.49		
3328.00	10.350	28.080	3281.78	257.31	480.13	198.97	40°27'57.275"N	104°45'58.982"W	1.90		
3418.00	10.830	33.050	3370.24	267.43	494.35	207.39	40°27'57.416"N	104°45'58.873"W	1.15		
3508.00	10.760	44.490	3458.66	279.48	507.43	217.89	40°27'57.545"N	104°45'58.737"W	2.38		
3597.00	10.300	46.940	3546.16	292.44	518.79	229.53	40°27'57.657"N	104°45'58.586"W	0.72		
3686.00	10.960	42.140	3633.64	305.31	530.50	241.02	40°27'57.773"N	104°45'58.438"W	1.24		
3776.00	12.390	21.060	3721.81	316.36	545.86	250.23	40°27'57.925"N	104°45'58.318"W	4.97		
3865.00	11.950	349.650	3808.91	320.37	563.85	252.01	40°27'58.103"N	104°45'58.295"W	7.37		
3955.00	10.570	340.850	3897.18	318.14	580.82	247.63	40°27'58.270"N	104°45'58.352"W	2.44		
4044.00	10.660	350.410	3984.66	316.10	596.65	243.58	40°27'58.427"N	104°45'58.405"W	1.98		
4134.00	10.830	5.900	4073.10	317.66	613.27	243.06	40°27'58.591"N	104°45'58.411"W	3.20		
4223.00	10.680	25.360	4160.57	323.98	629.04	247.45	40°27'58.747"N	104°45'58.354"W	4.06		
4313.00	12.090	38.680	4248.81	335.23	643.94	256.92	40°27'58.894"N	104°45'58.232"W	3.30		
4402.00	11.960	45.740	4335.86	349.28	657.65	269.35	40°27'59.030"N	104°45'58.071"W	1.66		
4492.00	11.620	44.900	4423.96	363.86	670.58	282.42	40°27'59.157"N	104°45'57.902"W	0.42		
4581.00	11.870	45.380	4511.10	378.20	683.36	295.27	40°27'59.284"N	104°45'57.736"W	0.30		
4670.00	11.920	53.700	4598.20	393.49	695.23	309.19	40°27'59.401"N	104°45'57.556"W	1.93		
4760.00	12.160	56.290	4686.22	410.09	706.00	324.57	40°27'59.507"N	104°45'57.357"W	0.66		
4849.00	11.750	57.640	4773.29	426.68	716.05	340.02	40°27'59.607"N	104°45'57.157"W	0.56		
4939.00	11.950	52.470	4861.37	443.01	726.63	355.15	40°27'59.711"N	104°45'56.961"W	1.20		
5028.00	11.930	37.010	4948.47	457.37	739.59	368.00	40°27'59.839"N	104°45'56.795"W	3.58		
5117.00	12.350	32.760	5035.48	469.89	754.94	378.68	40°27'59.991"N	104°45'56.657"W	1.11		
5207.00	12.370	39.790	5123.40	483.12	770.44	390.06	40°28'00.144"N	104°45'56.509"W	1.67		



Actual Wellpath Report

TROUDT 40C-23-M AWP



REFERENCE WELLPATH IDENTIFICATION

Operator	SRC ENERGY	Slot	SLOT#11 TROUDT 40C-23-M ( 760'FNL & 1745'FWL, SEC.27)
Area	COLORADO	Well	TROUDT 40C-23-M
Field	WELD COUNTY (NAD83,TRUE NORTH)	Wellbore	TROUDT 40C-23-M AWB
Facility	SEC.27-T06N-R66W		

WELLPATH DATA (171 stations)

MD [ft]	Inclination [°]	Azimuth [°]	TVD [ft]	Vert Sect [ft]	North [ft]	East [ft]	Latitude	Longitude	DLS [°/100ft]	Comments
5296.00	12.560	37.370	5210.30	496.87	785.46	402.04	40°28'00.293"N	104°45'56.354"W	0.62	
5386.00	12.460	28.670	5298.17	509.42	801.76	412.64	40°28'00.454"N	104°45'56.217"W	2.09	
5476.00	12.660	26.560	5386.02	520.58	819.10	421.70	40°28'00.625"N	104°45'56.100"W	0.56	
5565.00	12.660	19.110	5472.86	530.31	837.04	429.26	40°28'00.802"N	104°45'56.002"W	1.83	
5655.00	12.540	10.450	5560.70	537.63	855.97	434.26	40°28'00.989"N	104°45'55.937"W	2.10	
5744.00	10.410	355.920	5647.94	540.99	873.49	435.44	40°28'01.162"N	104°45'55.922"W	4.02	
5833.00	10.830	359.810	5735.41	542.44	889.88	434.84	40°28'01.324"N	104°45'55.930"W	0.93	
5923.00	10.820	1.340	5823.81	544.72	906.78	435.01	40°28'01.491"N	104°45'55.928"W	0.32	
6012.00	10.840	4.930	5911.23	547.71	923.47	435.92	40°28'01.656"N	104°45'55.916"W	0.76	
6102.00	10.930	8.540	5999.61	551.79	940.34	437.92	40°28'01.823"N	104°45'55.890"W	0.76	
6191.00	10.580	14.000	6087.05	557.02	956.61	441.15	40°28'01.984"N	104°45'55.848"W	1.21	
6280.00	10.930	12.820	6174.48	562.86	972.76	445.00	40°28'02.143"N	104°45'55.799"W	0.46	
6370.00	10.990	12.120	6262.84	568.61	989.47	448.69	40°28'02.308"N	104°45'55.751"W	0.16	
6459.00	10.860	12.790	6350.23	574.27	1005.94	452.33	40°28'02.471"N	104°45'55.704"W	0.20	
6549.00	10.820	11.170	6438.62	579.82	1022.50	455.84	40°28'02.635"N	104°45'55.658"W	0.34	
6638.00	10.590	16.740	6526.08	585.76	1038.53	459.82	40°28'02.793"N	104°45'55.607"W	1.19	
6728.00	11.960	24.550	6614.34	594.02	1054.93	466.07	40°28'02.955"N	104°45'55.526"W	2.28	
6817.00	17.680	46.880	6700.41	609.83	1072.58	479.79	40°28'03.130"N	104°45'55.348"W	8.97	
6906.00	25.410	68.680	6783.26	639.38	1088.81	507.53	40°28'03.290"N	104°45'54.989"W	12.37	
6996.00	31.350	76.540	6862.44	681.42	1101.30	548.34	40°28'03.413"N	104°45'54.461"W	7.78	
7086.00	37.960	83.970	6936.46	732.45	1109.67	598.71	40°28'03.496"N	104°45'53.810"W	8.71	
7175.00	44.120	88.120	7003.57	790.73	1113.57	656.96	40°28'03.535"N	104°45'53.056"W	7.57	
7264.00	53.370	87.090	7062.20	857.34	1116.40	723.74	40°28'03.563"N	104°45'52.192"W	10.43	
7354.00	63.070	84.720	7109.55	933.64	1121.94	799.94	40°28'03.617"N	104°45'51.206"W	11.01	
7443.00	71.460	85.180	7143.91	1015.59	1129.15	881.64	40°28'03.689"N	104°45'50.149"W	9.44	
7533.00	80.540	90.740	7165.68	1102.43	1132.17	968.78	40°28'03.718"N	104°45'49.022"W	11.73	
7622.00	87.720	95.700	7174.78	1189.43	1127.18	1057.09	40°28'03.669"N	104°45'47.879"W	9.79	
7712.00	90.150	95.870	7176.45	1277.12	1118.11	1146.61	40°28'03.579"N	104°45'46.721"W	2.71	LANDING POINT (364'FSL & 2468'FEL, SEC.22)
7801.00	89.080	95.150	7177.05	1363.94	1109.56	1235.19	40°28'03.495"N	104°45'45.575"W	1.45	
7891.00	89.230	94.540	7178.38	1451.96	1101.96	1324.86	40°28'03.420"N	104°45'44.415"W	0.70	



Actual Wellpath Report  
TROUDT 40C-23-M AWP  
Page 5 of 9



REFERENCE WELLPATH IDENTIFICATION			
Operator	SRC ENERGY	Slot	SLOT#11 TROUDT 40C-23-M ( 760'FNL & 1745'FWL, SEC.27)
Area	COLORADO	Well	TROUDT 40C-23-M
Field	WELD COUNTY (NAD83,TRUE NORTH)	Wellbore	TROUDT 40C-23-M AWB
Facility	SEC.27-T06N-R66W		

WELLPATH DATA (171 stations)											
MD [ft]	Inclination [°]	Azimuth [°]	TVD [ft]	Vert Sect [ft]	North [ft]	East [ft]	Latitude	Longitude	DLS [°/100ft]	Comments	
7980.00	89.290	94.150	7179.53	1539.17	1095.22	1413.60	40°28'03.353"N	104°45'43.266"W	0.44		
8070.00	89.110	93.150	7180.78	1627.56	1089.49	1503.40	40°28'03.296"N	104°45'42.104"W	1.13		
8159.00	89.170	92.390	7182.12	1715.21	1085.19	1592.29	40°28'03.254"N	104°45'40.954"W	0.86		
8249.00	89.260	90.710	7183.35	1804.16	1082.75	1682.24	40°28'03.230"N	104°45'39.791"W	1.87		
8338.00	89.540	91.100	7184.28	1892.28	1081.35	1771.23	40°28'03.216"N	104°45'38.639"W	0.54		
8428.00	89.630	90.160	7184.94	1981.44	1080.36	1861.22	40°28'03.206"N	104°45'37.475"W	1.05		
8517.00	89.510	89.790	7185.60	2069.75	1080.40	1950.22	40°28'03.206"N	104°45'36.323"W	0.44		
8607.00	89.600	89.890	7186.30	2159.07	1080.65	2040.21	40°28'03.209"N	104°45'35.159"W	0.15		
8696.00	89.720	90.310	7186.83	2247.36	1080.49	2129.21	40°28'03.207"N	104°45'34.008"W	0.49		
8786.00	89.600	89.730	7187.36	2336.65	1080.46	2219.21	40°28'03.207"N	104°45'32.843"W	0.66		
8875.00	89.660	88.300	7187.94	2425.13	1081.99	2308.19	40°28'03.222"N	104°45'31.692"W	1.61		
8965.00	89.570	87.200	7188.54	2514.79	1085.53	2398.12	40°28'03.257"N	104°45'30.528"W	1.23		
9054.00	89.570	88.680	7189.21	2603.43	1088.73	2487.06	40°28'03.288"N	104°45'29.378"W	1.66		
9144.00	89.540	89.400	7189.91	2692.90	1090.23	2577.04	40°28'03.303"N	104°45'28.213"W	0.80		
9233.00	91.140	90.260	7189.38	2781.24	1090.50	2666.04	40°28'03.305"N	104°45'27.062"W	2.04		
9323.00	91.260	91.160	7187.50	2870.37	1089.38	2756.01	40°28'03.294"N	104°45'25.898"W	1.01		
9412.00	91.170	91.940	7185.61	2958.32	1086.98	2844.95	40°28'03.270"N	104°45'24.747"W	0.88		
9502.00	91.230	91.800	7183.73	3047.18	1084.04	2934.89	40°28'03.241"N	104°45'23.584"W	0.17		
9591.00	92.430	91.850	7180.88	3135.04	1081.21	3023.80	40°28'03.213"N	104°45'22.433"W	1.35		
9680.00	92.370	91.260	7177.16	3222.94	1078.79	3112.68	40°28'03.189"N	104°45'21.283"W	0.67		
9770.00	92.250	91.540	7173.53	3311.86	1076.60	3202.58	40°28'03.167"N	104°45'20.120"W	0.34		
9859.00	89.940	90.840	7171.83	3399.89	1074.75	3291.54	40°28'03.149"N	104°45'18.969"W	2.71		
9949.00	89.850	90.510	7171.99	3489.05	1073.69	3381.54	40°28'03.138"N	104°45'17.805"W	0.38		
10038.00	90.030	89.410	7172.09	3577.36	1073.75	3470.53	40°28'03.139"N	104°45'16.653"W	1.25		
10127.00	90.000	88.360	7172.06	3665.86	1075.48	3559.52	40°28'03.156"N	104°45'15.502"W	1.18		
10217.00	90.000	86.890	7172.06	3755.55	1079.21	3649.44	40°28'03.193"N	104°45'14.338"W	1.63		
10306.00	89.850	85.960	7172.18	3844.37	1084.76	3738.26	40°28'03.247"N	104°45'13.189"W	1.06		
10396.00	90.000	85.350	7172.30	3934.26	1091.58	3828.00	40°28'03.315"N	104°45'12.028"W	0.70		
10485.00	88.860	85.140	7173.18	4023.18	1098.96	3916.69	40°28'03.387"N	104°45'10.881"W	1.30		
10575.00	88.680	86.840	7175.12	4113.02	1105.25	4006.45	40°28'03.449"N	104°45'09.719"W	1.90		





Actual Wellpath Report  
TROUDT 40C-23-M AWP  
Page 6 of 9



REFERENCE WELLPATH IDENTIFICATION			
Operator	SRC ENERGY	Slot	SLOT#11 TROUDT 40C-23-M ( 760'FNL & 1745'FWL, SEC.27)
Area	COLORADO	Well	TROUDT 40C-23-M
Field	WELD COUNTY (NAD83,TRUE NORTH)	Wellbore	TROUDT 40C-23-M AWB
Facility	SEC.27-T06N-R66W		

WELLPATH DATA (171 stations)										
MD [ft]	Inclination [°]	Azimuth [°]	TVD [ft]	Vert Sect [ft]	North [ft]	East [ft]	Latitude	Longitude	DLS [°/100ft]	Comments
10664.00	88.770	88.930	7177.10	4201.65	1108.53	4095.36	40°28'03.482"N	104°45'08.569"W	2.35	
10754.00	90.310	90.140	7177.82	4291.02	1109.26	4185.35	40°28'03.489"N	104°45'07.405"W	2.18	
10843.00	90.120	90.640	7177.48	4379.25	1108.66	4274.34	40°28'03.483"N	104°45'06.253"W	0.60	
10932.00	89.910	90.170	7177.46	4467.47	1108.03	4363.34	40°28'03.476"N	104°45'05.102"W	0.58	
11022.00	90.340	91.330	7177.27	4556.61	1106.85	4453.33	40°28'03.464"N	104°45'03.937"W	1.37	
11111.00	90.220	92.900	7176.83	4644.45	1103.57	4542.27	40°28'03.432"N	104°45'02.787"W	1.77	
11201.00	91.420	94.310	7175.54	4732.85	1097.91	4632.08	40°28'03.376"N	104°45'01.625"W	2.06	
11290.00	91.660	93.640	7173.15	4820.14	1091.74	4720.83	40°28'03.315"N	104°45'00.476"W	0.80	
11379.00	91.630	93.950	7170.60	4907.48	1085.85	4809.60	40°28'03.256"N	104°44'59.328"W	0.35	
11469.00	89.940	92.660	7169.36	4995.97	1080.66	4899.44	40°28'03.205"N	104°44'58.166"W	2.36	
11559.00	90.120	90.310	7169.32	5084.94	1078.33	4989.40	40°28'03.182"N	104°44'57.002"W	2.62	
11648.00	90.000	90.930	7169.22	5173.12	1077.37	5078.39	40°28'03.172"N	104°44'55.850"W	0.71	
11737.00	89.970	90.980	7169.25	5261.22	1075.89	5167.38	40°28'03.157"N	104°44'54.699"W	0.07	
11827.00	88.580	88.680	7170.38	5350.54	1076.15	5257.36	40°28'03.159"N	104°44'53.535"W	2.99	
11916.00	88.400	87.010	7172.73	5439.16	1079.50	5346.27	40°28'03.192"N	104°44'52.384"W	1.89	
12005.00	90.580	88.300	7173.52	5527.84	1083.14	5435.18	40°28'03.228"N	104°44'51.234"W	2.85	
12095.00	90.520	90.640	7172.66	5617.23	1083.97	5525.17	40°28'03.236"N	104°44'50.070"W	2.60	
12184.00	91.820	92.100	7170.84	5705.22	1081.84	5614.12	40°28'03.215"N	104°44'48.919"W	2.20	
12274.00	91.630	91.870	7168.13	5794.03	1078.73	5704.03	40°28'03.184"N	104°44'47.756"W	0.33	
12363.00	91.780	89.980	7165.48	5882.10	1077.29	5792.97	40°28'03.170"N	104°44'46.605"W	2.13	
12453.00	91.600	87.500	7162.83	5971.58	1079.27	5882.90	40°28'03.189"N	104°44'45.441"W	2.76	
12542.00	92.680	88.750	7159.50	6060.13	1082.18	5971.79	40°28'03.217"N	104°44'44.291"W	1.86	
12631.00	92.770	91.020	7155.27	6148.36	1082.36	6060.68	40°28'03.219"N	104°44'43.141"W	2.55	
12721.00	92.740	92.580	7150.95	6237.15	1079.54	6150.53	40°28'03.191"N	104°44'41.979"W	1.73	
12810.00	91.540	93.810	7147.62	6324.64	1074.58	6239.33	40°28'03.142"N	104°44'40.830"W	1.93	
12900.00	90.060	93.060	7146.37	6413.09	1069.19	6329.15	40°28'03.088"N	104°44'39.667"W	1.84	
12990.00	89.780	92.430	7146.49	6501.74	1064.88	6419.05	40°28'03.045"N	104°44'38.504"W	0.77	
13080.00	89.720	91.210	7146.89	6590.64	1062.02	6509.00	40°28'03.017"N	104°44'37.341"W	1.36	
13170.00	89.660	91.990	7147.37	6679.58	1059.51	6598.97	40°28'02.992"N	104°44'36.177"W	0.87	
13259.00	89.750	92.350	7147.83	6767.40	1056.14	6687.90	40°28'02.958"N	104°44'35.026"W	0.42	



Actual Wellpath Report

TROUDT 40C-23-M AWP



REFERENCE WELLPATH IDENTIFICATION

Operator	SRC ENERGY	Slot	SLOT#11 TROUDT 40C-23-M ( 760'FNL & 1745'FWL, SEC.27)
Area	COLORADO	Well	TROUDT 40C-23-M
Field	WELD COUNTY (NAD83,TRUE NORTH)	Wellbore	TROUDT 40C-23-M AWB
Facility	SEC.27-T06N-R66W		

WELLPATH DATA (171 stations)

MD [ft]	Inclination [°]	Azimuth [°]	TVD [ft]	Vert Sect [ft]	North [ft]	East [ft]	Latitude	Longitude	DLS [°/100ft]	Comments
13349.00	89.720	95.120	7148.25	6855.77	1050.27	6777.70	40°28'02.900"N	104°44'33.864"W	3.08	
13438.00	90.060	94.890	7148.42	6942.77	1042.51	6866.36	40°28'02.823"N	104°44'32.717"W	0.46	
13528.00	89.940	91.740	7148.42	7031.26	1037.30	6956.20	40°28'02.771"N	104°44'31.555"W	3.50	
13617.00	90.000	88.010	7148.46	7119.57	1037.50	7045.18	40°28'02.773"N	104°44'30.403"W	4.19	
13707.00	89.910	86.010	7148.53	7209.33	1042.19	7135.05	40°28'02.819"N	104°44'29.241"W	2.22	
13796.00	89.910	86.590	7148.67	7298.16	1047.94	7223.87	40°28'02.876"N	104°44'28.091"W	0.65	
13886.00	90.120	89.220	7148.65	7387.80	1051.23	7313.80	40°28'02.908"N	104°44'26.928"W	2.93	
13975.00	89.820	91.550	7148.70	7476.03	1050.63	7402.79	40°28'02.902"N	104°44'25.776"W	2.64	
14065.00	90.000	89.900	7148.84	7565.17	1049.49	7492.78	40°28'02.890"N	104°44'24.612"W	1.84	
14154.00	89.690	87.500	7149.08	7653.70	1051.51	7581.75	40°28'02.910"N	104°44'23.461"W	2.72	
14244.00	89.780	85.970	7149.50	7743.49	1056.63	7671.60	40°28'02.960"N	104°44'22.299"W	1.70	
14333.00	90.030	86.930	7149.64	7832.31	1062.15	7760.43	40°28'03.015"N	104°44'21.149"W	1.11	
14422.00	89.820	88.240	7149.76	7921.00	1065.90	7849.35	40°28'03.051"N	104°44'19.999"W	1.49	
14512.00	89.970	89.350	7149.93	8010.51	1067.79	7939.33	40°28'03.070"N	104°44'18.835"W	1.24	
14601.00	89.970	89.170	7149.97	8098.95	1068.94	8028.32	40°28'03.081"N	104°44'17.683"W	0.20	
14691.00	90.030	86.780	7149.97	8188.58	1072.12	8118.26	40°28'03.112"N	104°44'16.520"W	2.66	
14780.00	89.480	88.180	7150.35	8277.29	1076.03	8207.17	40°28'03.150"N	104°44'15.369"W	1.69	
14869.00	90.060	89.840	7150.71	8365.77	1077.57	8296.15	40°28'03.165"N	104°44'14.218"W	1.98	
14959.00	88.710	88.060	7151.68	8455.25	1079.22	8386.12	40°28'03.181"N	104°44'13.054"W	2.48	
15034.00	89.380	87.270	7152.93	8529.97	1082.27	8461.05	40°28'03.211"N	104°44'12.084"W	1.38	LAST BHI MWD SURVEY (335'FSL & 482'FEL, SEC.23)
15058.00	89.380	87.270	7153.19	8553.89	1083.42	8485.02	40°28'03.222"N	104°44'11.774"W	0.00	PROJ TO BIT (336'FSL & 458'FEL, SEC.23)

HOLE & CASING SECTIONS - Ref Wellbore: TROUDT 40C-23-M AWB      Ref Wellpath: TROUDT 40C-23-M AWP

String/Diameter	Start MD [ft]	End MD [ft]	Interval [ft]	Start TVD [ft]	End TVD [ft]	Start N/S [ft]	Start E/W [ft]	End N/S [ft]	End E/W [ft]
9.625in Open Hole	25.00	1764.00	1739.00	25.00	1744.50	0.00	0.00	212.55	94.57





Actual Wellpath Report

TROUDT 40C-23-M AWP



REFERENCE WELLPATH IDENTIFICATION

Operator	SRC ENERGY	Slot	SLOT#11 TROUDT 40C-23-M ( 760'FNL & 1745'FWL, SEC.27)
Area	COLORADO	Well	TROUDT 40C-23-M
Field	WELD COUNTY (NAD83,TRUE NORTH)	Wellbore	TROUDT 40C-23-M AWB
Facility	SEC.27-T06N-R66W		

TARGETS

Name	TVD [ft]	North [ft]	East [ft]	Grid East [US ft]	Grid North [US ft]	Latitude	Longitude	Shape
SEC.23-T06N-R66W	-8.00	4231.32	-2017.32	3201871.60	1417148.27	40°28'34.342"N	104°46'27.660"W	polygon
SEC.22-T06N-R66W	6.00	1412.77	-8159.15	3195753.51	1414279.17	40°28'06.478"N	104°47'47.123"W	polygon
TROUDT 40C-23-M BHL ON PLAT (323'FSL & 510'FEL, SEC.23)	7139.00	1060.16	8433.26	3212347.63	1414063.72	40°28'02.993"N	104°44'12.444"W	circle
TROUDT 40C-23-M TOP OF PROD ON PLAT (328'FSL & 2528'FEL, SEC.22)	7167.00	1081.70	1087.07	3205001.79	1414024.53	40°28'03.220"N	104°45'47.491"W	circle

WELLPATH COMPOSITION - Ref Wellbore: TROUDT 40C-23-M AWB    Ref Wellpath: TROUDT 40C-23-M AWP

Start MD [ft]	End MD [ft]	Positional Uncertainty Model	Log Name/Comment	Wellbore
25.00	1755.00	BHI NaviTrak (Standard)	13 1/2" SURFACE SURVEYS <88-1734>	TROUDT 40C-23-M AWB
1755.00	15034.00	BHI AutoTrak Curve (MagCAD+IFR1, Short spacing)	8 1/2" MONOBORE SURVEYS <1898-15034>	TROUDT 40C-23-M AWB
15034.00	15058.00	Blind Drilling (std)	Projection to bit	TROUDT 40C-23-M AWB



Actual Wellpath Report  
TROUDT 40C-23-M AWP  
Page 9 of 9



REFERENCE WELLPATH IDENTIFICATION			
Operator	SRC ENERGY	Slot	SLOT#11 TROUDT 40C-23-M ( 760'FNL & 1745'FWL, SEC.27)
Area	COLORADO	Well	TROUDT 40C-23-M
Field	WELD COUNTY (NAD83,TRUE NORTH)	Wellbore	TROUDT 40C-23-M AWB
Facility	SEC.27-T06N-R66W		

WELLPATH COMMENTS				
MD [ft]	Inclination [°]	Azimuth [°]	TVD [ft]	Comment
7712.00	90.150	95.870	7176.45	LANDING POINT (364'FSL & 2468'FEL, SEC.22)
15034.00	89.380	87.270	7152.93	LAST BHI MWD SURVEY (335'FSL & 482'FEL, SEC.23)
15058.00	89.380	87.270	7153.19	PROJ TO BIT (336'FSL & 458'FEL, SEC.23)