

Location:	COLORADO	Slot:	SLOT#08 TROUDT 41N-23A-M (760'FNL & 1700'FWL, SEC.27)
Field:	WELD COUNTY (NAD83,TRUE NORTH)	Well:	TROUDT 41N-23A-M
Facility:	SEC.27-T06N-R66W	Wellbore:	TROUDT 41N-23A-M PWB

Plot reference wellpath is TROUTD 41N-23A-M PWP (REV-B.0)	Grid System: NAD83 / Lambert Colorado SP, Northern Zone (501), US feet
True vertical depths are referenced to PD 562 (25) (RKB)	North Reference: True north
Measured depths are referenced to PD 562 (25) (RKB)	Scale: True distance
PD 562 (25) (RKB) to Mean Sea Level: 4744 feet	Depths are in feet
Mean Sea Level to Mud line (At Slot: SLOT#08 TROUTD 41N-23A-M (760FNL & 1700FWL, SEC.27)): 0 feet	Created by: robale01 on 2018-10-26
Coordinates are in feet referenced to Slot	Database: W\A DENVER

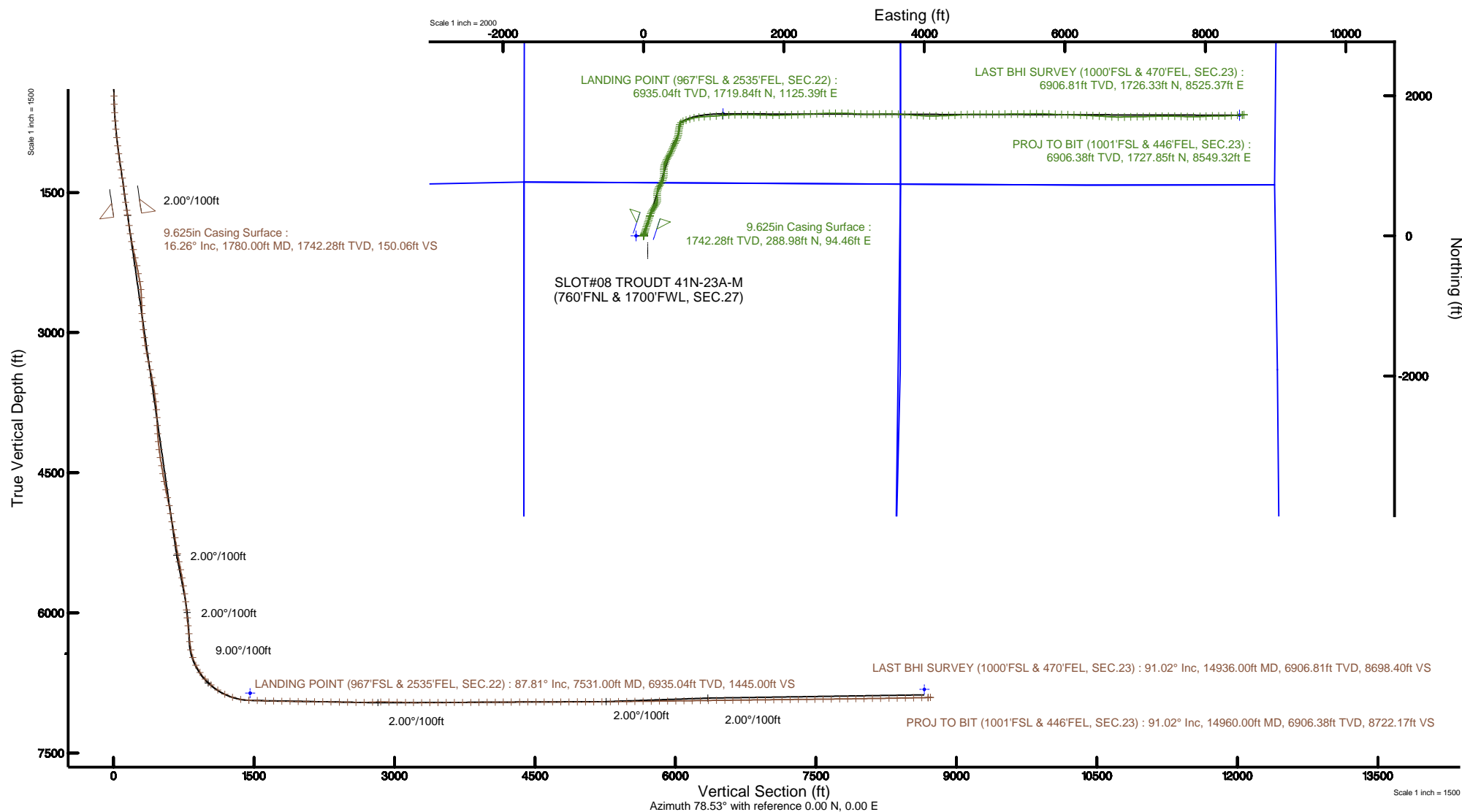



Actual Wellpath Report

TROUDT 41N-23A-M AWP

Page 1 of 9



REFERENCE WELLPATH IDENTIFICATION			
Operator	SRC ENERGY	Slot	SLOT#08 TROUDT 41N-23A-M (760'FNL & 1700'FWL, SEC.27)
Area	COLORADO	Well	TROUDT 41N-23A-M
Field	WELD COUNTY (NAD83,TRUE NORTH)	Wellbore	TROUDT 41N-23A-M AWB
Facility	SEC.27-T06N-R66W		

REPORT SETUP INFORMATION			
Projection System	NAD83 / Lambert Colorado SP, Northern Zone (501), US feet	Software System	WellArchitect® 5.0
North Reference	True	User	Guenaler
Scale	0.999964	Report Generated	10/26/2018 at 10:37:02 AM
Convergence at slot	0.48° East	Database/Source file	WA_DEN_Denver_Defn/TROUDT_41N-23A-M_AWP.xml

WELLPATH LOCATION						
	Local coordinates		Grid coordinates		Geographic coordinates	
	North[ft]	East[ft]	Easting[US ft]	Northing[US ft]	Latitude	Longitude
Slot Location	-0.02	104.87	3203878.61	1412933.56	40°27'52.531"N	104°46'02.140"W
Facility Reference Pt			3203773.74	1412932.71	40°27'52.531"N	104°46'03.497"W
Field Reference Pt			3171284.48	1426358.81	40°30'07.643"N	104°53'02.634"W

WELLPATH DATUM			
Calculation method	Minimum curvature	PD 562 (25') (RKB) to Facility Vertical Datum	4744.00ft
Horizontal Reference Pt	Slot	PD 562 (25') (RKB) to Mean Sea Level	4744.00ft
Vertical Reference Pt	PD 562 (25') (RKB)	PD 562 (25') (RKB) to Mud Line at Slot (SLOT#08 TROUDT 41N-23A-M (760'FNL & 1700'FWL, SEC.27))	4744.00ft
MD Reference Pt	PD 562 (25') (RKB)	Section Origin	N 0.00, E 0.00 ft
Field Vertical Reference	Mean Sea Level	Section Azimuth	78.53°



Actual Wellpath Report
TROUDT 41N-23A-M AWP
Page 2 of 9



REFERENCE WELLPATH IDENTIFICATION			
Operator	SRC ENERGY	Slot	SLOT#08 TROUDT 41N-23A-M (760'FNL & 1700'FWL, SEC.27)
Area	COLORADO	Well	TROUDT 41N-23A-M
Field	WELD COUNTY (NAD83,TRUE NORTH)	Wellbore	TROUDT 41N-23A-M AWB
Facility	SEC.27-T06N-R66W		

WELLPATH DATA (170 stations) † = interpolated/extrapolated station											
MD [ft]	Inclination [°]	Azimuth [°]	TVD [ft]	Vert Sect [ft]	North [ft]	East [ft]	Latitude		Longitude	DLS [°/100ft]	Comments
0.00†	0.000	46.160	0.00	0.00	0.00	0.00	40°27'52.531"N		104°46'02.140"W	0.00	
25.00	0.000	46.160	25.00	0.00	0.00	0.00	40°27'52.531"N		104°46'02.140"W	0.00	
109.00	0.540	46.160	109.00	0.33	0.27	0.29	40°27'52.534"N		104°46'02.136"W	0.64	
197.00	0.760	6.190	196.99	0.86	1.14	0.65	40°27'52.542"N		104°46'02.132"W	0.56	
287.00	1.330	20.060	286.98	1.59	2.72	1.07	40°27'52.558"N		104°46'02.126"W	0.69	
377.00	1.990	15.780	376.94	2.85	5.20	1.85	40°27'52.582"N		104°46'02.116"W	0.75	
467.00	2.470	16.810	466.87	4.49	8.56	2.84	40°27'52.616"N		104°46'02.103"W	0.54	
557.00	4.710	22.570	556.69	7.47	13.83	4.82	40°27'52.668"N		104°46'02.078"W	2.52	
647.00	6.530	20.500	646.25	12.25	22.04	8.03	40°27'52.749"N		104°46'02.036"W	2.03	
737.00	7.720	19.210	735.56	18.05	32.54	11.81	40°27'52.853"N		104°46'01.987"W	1.33	
827.00	10.940	17.380	824.35	25.25	46.40	16.35	40°27'52.990"N		104°46'01.928"W	3.59	
917.00	12.990	16.920	912.39	34.19	64.23	21.85	40°27'53.166"N		104°46'01.857"W	2.28	
1007.00	13.720	16.930	999.96	44.07	84.12	27.90	40°27'53.362"N		104°46'01.779"W	0.81	
1097.00	15.830	18.840	1086.98	55.35	105.95	34.97	40°27'53.578"N		104°46'01.688"W	2.41	
1187.00	17.280	17.400	1173.25	68.00	130.32	42.93	40°27'53.819"N		104°46'01.585"W	1.67	
1277.00	16.440	18.570	1259.38	80.83	155.15	50.99	40°27'54.064"N		104°46'01.480"W	1.01	
1367.00	15.840	19.380	1345.83	93.50	178.81	59.12	40°27'54.298"N		104°46'01.375"W	0.71	
1457.00	16.400	16.990	1432.29	105.86	202.55	66.91	40°27'54.532"N		104°46'01.274"W	0.96	
1547.00	15.520	16.450	1518.82	117.55	226.25	74.03	40°27'54.767"N		104°46'01.182"W	0.99	
1637.00	16.610	18.590	1605.31	129.64	249.99	81.54	40°27'55.001"N		104°46'01.085"W	1.38	
1727.00	16.910	18.450	1691.48	142.61	274.60	89.78	40°27'55.244"N		104°46'00.978"W	0.34	
1780.00	16.260	17.580	1742.28	150.06	288.98	94.46	40°27'55.387"N		104°46'00.918"W	1.31	
1897.00	15.180	18.410	1854.90	165.65	319.13	104.25	40°27'55.685"N		104°46'00.791"W	0.94	
1986.00	16.500	25.420	1940.53	179.04	341.61	113.36	40°27'55.907"N		104°46'00.673"W	2.61	
2076.00	16.270	26.840	2026.87	194.53	364.40	124.53	40°27'56.132"N		104°46'00.529"W	0.51	
2165.00	15.830	35.970	2112.42	211.20	385.35	137.30	40°27'56.339"N		104°46'00.364"W	2.88	
2254.00	17.290	35.930	2197.72	229.88	405.89	152.19	40°27'56.542"N		104°46'00.171"W	1.64	
2343.00	16.870	28.650	2282.81	247.94	427.93	166.14	40°27'56.760"N		104°45'59.990"W	2.45	
2433.00	16.410	29.910	2369.04	264.76	450.41	178.74	40°27'56.982"N		104°45'59.827"W	0.65	
2522.00	17.040	23.820	2454.28	280.61	473.24	190.28	40°27'57.207"N		104°45'59.678"W	2.09	



Actual Wellpath Report
TROUDT 41N-23A-M AWP
Page 3 of 9



REFERENCE WELLPATH IDENTIFICATION			
Operator	SRC ENERGY	Slot	SLOT#08 TROUDT 41N-23A-M (760'FNL & 1700'FWL, SEC.27)
Area	COLORADO	Well	TROUDT 41N-23A-M
Field	WELD COUNTY (NAD83,TRUE NORTH)	Wellbore	TROUDT 41N-23A-M AWB
Facility	SEC.27-T06N-R66W		

WELLPATH DATA (170 stations)										
MD [ft]	Inclination [°]	Azimuth [°]	TVD [ft]	Vert Sect [ft]	North [ft]	East [ft]	Latitude	Longitude	DLS [°/100ft]	Comments
2611.00	17.640	5.710	2539.30	292.14	498.61	196.89	40°27'57.458"N	104°45'59.593"W	6.08	
2701.00	16.600	354.070	2625.33	297.41	524.97	196.92	40°27'57.719"N	104°45'59.592"W	3.97	
2790.00	17.000	357.770	2710.54	300.73	550.62	195.10	40°27'57.972"N	104°45'59.616"W	1.28	
2880.00	16.980	358.910	2796.61	305.21	576.91	194.34	40°27'58.232"N	104°45'59.626"W	0.37	
2969.00	16.730	2.700	2881.79	310.69	602.70	194.69	40°27'58.487"N	104°45'59.621"W	1.27	
3059.00	16.960	9.810	2967.94	318.62	628.57	197.54	40°27'58.742"N	104°45'59.584"W	2.30	
3148.00	16.840	15.580	3053.10	329.20	653.78	203.22	40°27'58.991"N	104°45'59.511"W	1.89	
3238.00	16.450	19.820	3139.33	341.75	678.33	211.04	40°27'59.234"N	104°45'59.410"W	1.42	
3327.00	16.530	28.500	3224.68	356.43	701.31	221.35	40°27'59.461"N	104°45'59.276"W	2.77	
3417.00	16.350	32.960	3311.01	373.52	723.20	234.36	40°27'59.677"N	104°45'59.108"W	1.42	
3506.00	16.820	34.040	3396.31	391.48	744.38	248.38	40°27'59.887"N	104°45'58.926"W	0.63	
3596.00	17.020	30.950	3482.41	409.66	766.46	262.44	40°28'00.105"N	104°45'58.744"W	1.02	
3685.00	16.880	19.620	3567.57	425.12	789.81	273.48	40°28'00.336"N	104°45'58.602"W	3.71	
3775.00	16.990	17.280	3653.67	438.19	814.68	281.78	40°28'00.581"N	104°45'58.494"W	0.77	
3864.00	17.170	11.500	3738.75	449.58	839.97	288.26	40°28'00.831"N	104°45'58.410"W	1.92	
3954.00	17.150	2.450	3824.76	457.96	866.25	291.47	40°28'01.091"N	104°45'58.369"W	2.96	
4043.00	16.850	357.050	3909.87	463.03	892.24	291.37	40°28'01.348"N	104°45'58.370"W	1.81	
4132.00	16.980	357.540	3995.02	466.97	918.11	290.15	40°28'01.603"N	104°45'58.386"W	0.22	
4222.00	16.440	359.720	4081.22	471.51	943.97	289.52	40°28'01.859"N	104°45'58.394"W	0.92	
4312.00	16.880	8.230	4167.46	478.38	969.64	291.33	40°28'02.113"N	104°45'58.371"W	2.75	
4401.00	15.950	12.840	4252.83	487.78	994.36	295.90	40°28'02.357"N	104°45'58.312"W	1.80	
4490.00	16.650	20.630	4338.27	499.59	1018.21	303.11	40°28'02.592"N	104°45'58.218"W	2.58	
4580.00	16.700	22.500	4424.48	513.67	1042.23	312.60	40°28'02.830"N	104°45'58.095"W	0.60	
4669.00	16.760	20.870	4509.71	527.68	1066.03	322.07	40°28'03.065"N	104°45'57.973"W	0.53	
4758.00	16.540	24.920	4594.99	542.06	1089.51	331.98	40°28'03.297"N	104°45'57.845"W	1.33	
4848.00	16.840	31.410	4681.20	558.53	1112.26	344.17	40°28'03.522"N	104°45'57.687"W	2.10	
4937.00	16.900	32.980	4766.37	576.37	1134.11	357.93	40°28'03.738"N	104°45'57.509"W	0.52	
5027.00	16.790	29.090	4852.51	593.98	1156.45	371.37	40°28'03.958"N	104°45'57.335"W	1.26	
5116.00	16.800	24.100	4937.72	609.82	1179.42	382.87	40°28'04.185"N	104°45'57.186"W	1.62	
5206.00	16.470	21.920	5023.96	624.41	1203.13	392.95	40°28'04.420"N	104°45'57.056"W	0.78	



Actual Wellpath Report

TROUDT 41N-23A-M AWP



REFERENCE WELLPATH IDENTIFICATION			
Operator	SRC ENERGY	Slot	SLOT#08 TROUDT 41N-23A-M (760'FNL & 1700'FWL, SEC.27)
Area	COLORADO	Well	TROUDT 41N-23A-M
Field	WELD COUNTY (NAD83,TRUE NORTH)	Wellbore	TROUDT 41N-23A-M AWB
Facility	SEC.27-T06N-R66W		

WELLPATH DATA (170 stations)										
MD [ft]	Inclination [°]	Azimuth [°]	TVD [ft]	Vert Sect [ft]	North [ft]	East [ft]	Latitude	Longitude	DLS [°/100ft]	Comments
5295.00	16.760	27.650	5109.25	639.45	1226.20	403.61	40°28'04.648"N	104°45'56.918"W	1.87	
5385.00	16.680	24.140	5195.44	655.16	1249.49	414.92	40°28'04.878"N	104°45'56.772"W	1.13	
5474.00	16.800	20.460	5280.67	669.41	1273.19	424.64	40°28'05.112"N	104°45'56.646"W	1.20	
5564.00	15.770	27.010	5367.07	683.90	1296.28	434.74	40°28'05.340"N	104°45'56.515"W	2.34	
5653.00	16.460	29.130	5452.57	699.63	1318.07	446.37	40°28'05.555"N	104°45'56.365"W	1.02	
5742.00	16.700	26.430	5537.87	715.69	1340.53	458.20	40°28'05.777"N	104°45'56.212"W	0.91	
5832.00	16.480	25.360	5624.13	731.29	1363.65	469.42	40°28'06.006"N	104°45'56.066"W	0.42	
5921.00	16.850	19.680	5709.39	745.53	1387.20	479.17	40°28'06.239"N	104°45'55.940"W	1.88	
6011.00	16.960	18.500	5795.50	758.84	1411.93	487.73	40°28'06.483"N	104°45'55.829"W	0.40	
6100.00	16.890	12.690	5880.66	770.62	1436.86	494.69	40°28'06.729"N	104°45'55.739"W	1.90	
6190.00	16.860	5.730	5966.79	779.83	1462.60	498.87	40°28'06.984"N	104°45'55.685"W	2.24	
6279.00	16.170	4.960	6052.12	787.15	1487.79	501.23	40°28'07.233"N	104°45'55.655"W	0.81	
6369.00	16.290	10.340	6138.54	795.39	1512.69	504.58	40°28'07.479"N	104°45'55.612"W	1.68	
6458.00	16.790	9.760	6223.85	804.68	1537.64	509.00	40°28'07.725"N	104°45'55.554"W	0.59	
6547.00	16.900	8.250	6309.03	813.70	1563.11	513.03	40°28'07.977"N	104°45'55.502"W	0.51	
6637.00	17.750	18.560	6394.97	824.99	1589.07	519.28	40°28'08.233"N	104°45'55.421"W	3.53	
6726.00	22.290	41.360	6478.70	845.27	1614.65	534.78	40°28'08.486"N	104°45'55.221"W	10.06	
6816.00	27.290	66.230	6560.60	879.14	1635.85	565.04	40°28'08.696"N	104°45'54.829"W	12.73	
6905.00	33.780	72.140	6637.23	923.72	1651.68	607.32	40°28'08.852"N	104°45'54.282"W	8.03	
6995.00	42.430	72.530	6707.99	978.89	1668.50	660.19	40°28'09.018"N	104°45'53.598"W	9.61	
7084.00	47.380	78.020	6771.03	1041.55	1684.33	720.93	40°28'09.175"N	104°45'52.812"W	7.06	
7174.00	56.810	83.000	6826.28	1112.40	1695.82	790.88	40°28'09.288"N	104°45'51.907"W	11.35	
7263.00	64.000	86.660	6870.21	1189.24	1702.70	867.89	40°28'09.356"N	104°45'50.911"W	8.83	
7352.00	72.040	87.270	6903.50	1270.81	1707.06	950.24	40°28'09.399"N	104°45'49.845"W	9.06	
7442.00	79.760	85.120	6925.41	1357.25	1712.87	1037.26	40°28'09.457"N	104°45'48.719"W	8.88	
7531.00	87.810	85.830	6935.04	1445.00	1719.84	1125.39	40°28'09.525"N	104°45'47.579"W	9.08	LANDING POINT (967'FSL & 2535'FEL, SEC.22)
7621.00	87.840	87.060	6938.45	1534.08	1725.42	1215.15	40°28'09.580"N	104°45'46.418"W	1.37	
7710.00	87.810	88.610	6941.83	1621.84	1728.78	1304.02	40°28'09.614"N	104°45'45.268"W	1.74	
7800.00	89.320	89.530	6944.08	1710.29	1730.24	1393.98	40°28'09.628"N	104°45'44.104"W	1.96	
7889.00	89.170	91.290	6945.26	1797.37	1729.60	1482.97	40°28'09.622"N	104°45'42.952"W	1.98	



Actual Wellpath Report
TROUDT 41N-23A-M AWP
Page 5 of 9



REFERENCE WELLPATH IDENTIFICATION			
Operator	SRC ENERGY	Slot	SLOT#08 TROUDT 41N-23A-M (760'FNL & 1700'FWL, SEC.27)
Area	COLORADO	Well	TROUDT 41N-23A-M
Field	WELD COUNTY (NAD83,TRUE NORTH)	Wellbore	TROUDT 41N-23A-M AWB
Facility	SEC.27-T06N-R66W		

WELLPATH DATA (170 stations)											
MD [ft]	Inclination [°]	Azimuth [°]	TVD [ft]	Vert Sect [ft]	North [ft]	East [ft]	Latitude	Longitude	DLS [°/100ft]	Comments	
7979.00	89.170	91.120	6946.56	1885.17	1727.71	1572.94	40°28'09.603"N	104°45'41.788"W	0.19		
8068.00	89.170	91.050	6947.85	1972.03	1726.02	1661.91	40°28'09.586"N	104°45'40.637"W	0.08		
8158.00	89.260	91.050	6949.08	2059.88	1724.37	1751.89	40°28'09.570"N	104°45'39.473"W	0.10		
8247.00	89.260	90.210	6950.23	2146.89	1723.40	1840.87	40°28'09.560"N	104°45'38.322"W	0.94		
8337.00	89.320	89.280	6951.35	2235.17	1723.80	1930.87	40°28'09.564"N	104°45'37.157"W	1.04		
8426.00	88.830	88.730	6952.78	2322.67	1725.34	2019.84	40°28'09.579"N	104°45'36.006"W	0.83		
8516.00	88.860	88.430	6954.60	2411.27	1727.57	2109.79	40°28'09.601"N	104°45'34.842"W	0.33		
8605.00	88.950	87.800	6956.30	2499.01	1730.50	2198.73	40°28'09.630"N	104°45'33.691"W	0.71		
8695.00	89.420	87.750	6957.58	2587.83	1733.99	2288.65	40°28'09.664"N	104°45'32.528"W	0.53		
8784.00	90.430	86.940	6957.70	2675.78	1738.11	2377.55	40°28'09.705"N	104°45'31.378"W	1.45		
8874.00	92.160	87.160	6955.66	2764.76	1742.74	2467.41	40°28'09.751"N	104°45'30.215"W	1.94		
8963.00	90.180	87.810	6953.84	2852.65	1746.65	2556.30	40°28'09.789"N	104°45'29.065"W	2.34		
9053.00	88.800	89.270	6954.65	2941.27	1748.94	2646.26	40°28'09.812"N	104°45'27.901"W	2.23		
9142.00	89.080	89.740	6956.29	3028.62	1749.71	2735.24	40°28'09.819"N	104°45'26.750"W	0.61		
9232.00	88.800	90.480	6957.96	3116.78	1749.54	2825.23	40°28'09.817"N	104°45'25.585"W	0.88		
9321.00	88.950	92.350	6959.71	3203.51	1747.34	2914.18	40°28'09.796"N	104°45'24.434"W	2.11		
9411.00	90.280	93.310	6960.31	3290.72	1742.90	3004.06	40°28'09.752"N	104°45'23.271"W	1.82		
9500.00	90.280	93.080	6959.87	3376.82	1737.94	3092.92	40°28'09.703"N	104°45'22.122"W	0.26		
9590.00	90.000	90.600	6959.65	3464.39	1735.05	3182.87	40°28'09.674"N	104°45'20.958"W	2.77		
9679.00	90.150	89.260	6959.54	3551.63	1735.16	3271.87	40°28'09.675"N	104°45'19.806"W	1.52		
9768.00	90.400	88.370	6959.11	3639.20	1737.00	3360.85	40°28'09.693"N	104°45'18.655"W	1.04		
9858.00	90.430	89.660	6958.46	3727.69	1738.54	3450.83	40°28'09.708"N	104°45'17.491"W	1.43		
9947.00	90.430	90.540	6957.79	3814.88	1738.39	3539.83	40°28'09.706"N	104°45'16.339"W	0.99		
10037.00	90.400	92.070	6957.14	3902.64	1736.34	3629.80	40°28'09.686"N	104°45'15.175"W	1.70		
10126.00	90.680	92.780	6956.30	3989.03	1732.57	3718.71	40°28'09.649"N	104°45'14.025"W	0.86		
10216.00	90.490	94.400	6955.38	4075.93	1726.94	3808.53	40°28'09.593"N	104°45'12.863"W	1.81		
10305.00	90.220	94.330	6954.83	4161.55	1720.16	3897.27	40°28'09.526"N	104°45'11.715"W	0.31		
10394.00	89.970	92.840	6954.68	4247.49	1714.60	3986.09	40°28'09.471"N	104°45'10.565"W	1.70		
10484.00	90.340	90.270	6954.44	4335.17	1712.16	4076.05	40°28'09.446"N	104°45'09.401"W	2.88		
10573.00	90.150	88.940	6954.06	4422.51	1712.77	4165.05	40°28'09.452"N	104°45'08.250"W	1.51		



Actual Wellpath Report
TROUDT 41N-23A-M AWP
Page 6 of 9



REFERENCE WELLPATH IDENTIFICATION			
Operator	SRC ENERGY	Slot	SLOT#08 TROUDT 41N-23A-M (760'FNL & 1700'FWL, SEC.27)
Area	COLORADO	Well	TROUDT 41N-23A-M
Field	WELD COUNTY (NAD83,TRUE NORTH)	Wellbore	TROUDT 41N-23A-M AWB
Facility	SEC.27-T06N-R66W		

WELLPATH DATA (170 stations)										
MD [ft]	Inclination [°]	Azimuth [°]	TVD [ft]	Vert Sect [ft]	North [ft]	East [ft]	Latitude	Longitude	DLS [°/100ft]	Comments
10663.00	90.180	88.130	6953.80	4511.14	1715.07	4255.02	40°28'09.475"N	104°45'07.086"W	0.90	
10752.00	90.280	88.000	6953.44	4598.91	1718.08	4343.96	40°28'09.504"N	104°45'05.935"W	0.18	
10842.00	90.180	86.510	6953.08	4687.86	1722.39	4433.86	40°28'09.547"N	104°45'04.772"W	1.66	
10931.00	90.120	86.350	6952.85	4776.02	1727.93	4522.68	40°28'09.601"N	104°45'03.623"W	0.19	
11020.00	90.280	87.900	6952.54	4864.01	1732.39	4611.57	40°28'09.645"N	104°45'02.473"W	1.75	
11110.00	90.120	88.830	6952.22	4952.69	1734.96	4701.53	40°28'09.671"N	104°45'01.309"W	1.05	
11199.00	89.910	89.350	6952.20	5040.18	1736.37	4790.52	40°28'09.684"N	104°45'00.157"W	0.63	
11289.00	90.150	90.050	6952.15	5128.47	1736.85	4880.52	40°28'09.689"N	104°44'58.993"W	0.82	
11378.00	90.800	90.210	6951.41	5215.65	1736.64	4969.51	40°28'09.687"N	104°44'57.841"W	0.75	
11468.00	90.830	90.130	6950.13	5303.79	1736.38	5059.50	40°28'09.684"N	104°44'56.677"W	0.09	
11557.00	90.920	89.270	6948.78	5391.09	1736.84	5148.49	40°28'09.688"N	104°44'55.525"W	0.97	
11647.00	90.580	89.200	6947.60	5479.52	1738.04	5238.48	40°28'09.700"N	104°44'54.361"W	0.39	
11736.00	90.430	89.950	6946.81	5566.86	1738.70	5327.47	40°28'09.706"N	104°44'53.210"W	0.86	
11825.00	90.550	89.430	6946.05	5654.17	1739.19	5416.46	40°28'09.711"N	104°44'52.058"W	0.60	
11914.00	90.770	89.060	6945.03	5741.62	1740.36	5505.45	40°28'09.722"N	104°44'50.907"W	0.48	
12004.00	90.490	89.330	6944.04	5830.05	1741.62	5595.44	40°28'09.735"N	104°44'49.743"W	0.43	
12093.00	90.740	91.310	6943.08	5917.17	1741.13	5684.43	40°28'09.730"N	104°44'48.591"W	2.24	
12183.00	90.770	92.050	6941.90	6004.80	1738.49	5774.38	40°28'09.703"N	104°44'47.427"W	0.82	
12272.00	90.710	93.070	6940.75	6091.13	1734.51	5863.28	40°28'09.664"N	104°44'46.277"W	1.15	
12362.00	90.740	92.590	6939.61	6178.34	1730.07	5953.16	40°28'09.620"N	104°44'45.114"W	0.53	
12451.00	90.650	90.510	6938.53	6265.03	1727.66	6042.12	40°28'09.596"N	104°44'43.963"W	2.34	
12540.00	90.680	91.940	6937.49	6351.85	1725.76	6131.09	40°28'09.577"N	104°44'42.812"W	1.61	
12630.00	90.680	92.030	6936.43	6439.37	1722.64	6221.03	40°28'09.546"N	104°44'41.648"W	0.10	
12720.00	90.550	92.310	6935.46	6526.83	1719.24	6310.96	40°28'09.512"N	104°44'40.485"W	0.34	
12809.00	90.740	92.600	6934.46	6613.20	1715.42	6399.87	40°28'09.474"N	104°44'39.334"W	0.39	
12898.00	90.490	93.590	6933.50	6699.34	1710.62	6488.74	40°28'09.426"N	104°44'38.185"W	1.15	
12989.00	90.890	93.830	6932.41	6787.15	1704.73	6579.54	40°28'09.368"N	104°44'37.010"W	0.51	
13079.00	90.680	93.150	6931.17	6874.09	1699.25	6669.36	40°28'09.313"N	104°44'35.848"W	0.79	
13168.00	90.580	90.170	6930.20	6960.75	1696.67	6758.31	40°28'09.288"N	104°44'34.697"W	3.35	
13258.00	90.580	88.620	6929.28	7049.13	1697.62	6848.30	40°28'09.297"N	104°44'33.532"W	1.72	



Actual Wellpath Report
TROUDT 41N-23A-M AWP
Page 7 of 9



REFERENCE WELLPATH IDENTIFICATION

Operator	SRC ENERGY	Slot	SLOT#08 TROUDT 41N-23A-M (760'FNL & 1700'FWL, SEC.27)
Area	COLORADO	Well	TROUDT 41N-23A-M
Field	WELD COUNTY (NAD83,TRUE NORTH)	Wellbore	TROUDT 41N-23A-M AWB
Facility	SEC.27-T06N-R66W		

WELLPATH DATA (170 stations)

MD [ft]	Inclination [°]	Azimuth [°]	TVD [ft]	Vert Sect [ft]	North [ft]	East [ft]	Latitude	Longitude	DLS [°/100ft]	Comments
13347.00	90.650	88.630	6928.33	7136.75	1699.76	6937.27	40°28'09.318"N	104°44'32.381"W	0.08	
13437.00	90.580	89.200	6927.36	7225.26	1701.46	7027.25	40°28'09.334"N	104°44'31.217"W	0.64	
13526.00	90.490	88.940	6926.53	7312.76	1702.91	7116.23	40°28'09.348"N	104°44'30.066"W	0.31	
13616.00	90.680	88.650	6925.61	7401.31	1704.80	7206.21	40°28'09.367"N	104°44'28.902"W	0.39	
13705.00	90.800	88.120	6924.46	7488.99	1707.31	7295.16	40°28'09.391"N	104°44'27.751"W	0.61	
13795.00	90.740	89.130	6923.25	7577.59	1709.47	7385.13	40°28'09.412"N	104°44'26.586"W	1.12	
13884.00	90.550	90.730	6922.25	7664.82	1709.58	7474.12	40°28'09.413"N	104°44'25.435"W	1.81	
13974.00	90.520	91.680	6921.41	7752.62	1707.69	7564.09	40°28'09.394"N	104°44'24.271"W	1.06	
14063.00	90.950	91.380	6920.27	7839.33	1705.31	7653.05	40°28'09.370"N	104°44'23.120"W	0.59	
14153.00	90.950	91.300	6918.78	7927.08	1703.20	7743.02	40°28'09.349"N	104°44'21.956"W	0.09	
14242.00	90.710	90.090	6917.49	8014.07	1702.13	7832.00	40°28'09.338"N	104°44'20.805"W	1.39	
14332.00	90.770	87.870	6916.33	8102.56	1703.73	7921.97	40°28'09.354"N	104°44'19.640"W	2.47	
14421.00	90.740	87.150	6915.15	8190.46	1707.59	8010.88	40°28'09.392"N	104°44'18.490"W	0.81	
14511.00	90.890	88.450	6913.87	8279.28	1711.05	8100.80	40°28'09.426"N	104°44'17.327"W	1.45	
14600.00	90.980	89.680	6912.42	8366.76	1712.50	8189.78	40°28'09.440"N	104°44'16.175"W	1.39	
14689.00	90.990	88.870	6910.89	8454.19	1713.63	8278.76	40°28'09.451"N	104°44'15.024"W	0.91	
14779.00	90.860	87.220	6909.44	8542.93	1716.70	8368.69	40°28'09.481"N	104°44'13.861"W	1.84	
14868.00	90.990	86.110	6908.00	8631.02	1721.87	8457.53	40°28'09.531"N	104°44'12.711"W	1.26	
14936.00	91.020	86.370	6906.81	8698.40	1726.33	8525.37	40°28'09.575"N	104°44'11.833"W	0.38	LAST BHI SURVEY (1000'FSL & 470'FEL, SEC.23)
14960.00	91.020	86.370	6906.38	8722.17	1727.85	8549.32	40°28'09.590"N	104°44'11.523"W	0.00	PROJ TO BIT (1001'FSL & 446'FEL, SEC.23)

HOLE & CASING SECTIONS - Ref Wellbore: TROUDT 41N-23A-M AWB Ref Wellpath: TROUDT 41N-23A-M AWP

String/Diameter	Start MD [ft]	End MD [ft]	Interval [ft]	Start TVD [ft]	End TVD [ft]	Start N/S [ft]	Start E/W [ft]	End N/S [ft]	End E/W [ft]
9.625in Casing Surface	25.00	1780.00	1755.00	25.00	1742.28	0.00	0.00	288.98	94.46



Actual Wellpath Report
TROUDT 41N-23A-M AWP
Page 8 of 9



REFERENCE WELLPATH IDENTIFICATION			
Operator	SRC ENERGY	Slot	SLOT#08 TROUDT 41N-23A-M (760'FNL & 1700'FWL, SEC.27)
Area	COLORADO	Well	TROUDT 41N-23A-M
Field	WELD COUNTY (NAD83,TRUE NORTH)	Wellbore	TROUDT 41N-23A-M AWB
Facility	SEC.27-T06N-R66W		

TARGETS								
Name	TVD [ft]	North [ft]	East [ft]	Grid East [US ft]	Grid North [US ft]	Latitude	Longitude	Shape
SEC.23-T06N-R66W	-8.00	4231.31	-1972.18	3201871.60	1417148.27	40°28'34.342"N	104°46'27.660"W	polygon
SEC.22-T06N-R66W	6.00	1412.76	-8114.01	3195753.51	1414279.17	40°28'06.478"N	104°47'47.123"W	polygon
SEC.27-T06N-R66W	19.00	-4766.34	970.53	3204888.45	1408175.58	40°27'05.432"N	104°45'49.586"W	polygon
SEC.28-T06N-R66W	19.00	-4766.34	970.53	3204888.45	1408175.58	40°27'05.432"N	104°45'49.586"W	polygon
SEC.26-T06N-R66W	38.00	-4763.02	570.30	3204488.23	1408175.60	40°27'05.465"N	104°45'54.763"W	polygon
SEC.29-T06N-R66W EAST HALF	50.00	0.02	-104.87	3203773.74	1412932.71	40°27'52.531"N	104°46'03.497"W	polygon
TROUDT 41N-23A-M BHL ON PLAT (995'FSL & 510'FEL, SEC.23)	6819.00	1722.15	8484.84	3212348.61	1414725.69	40°28'09.534"N	104°44'12.358"W	circle
TROUDT 41N-23A-M TOP OF PROD ON PLAT (989'FSL & 2525'FEL, SEC.22)	6859.00	1742.21	1134.68	3204998.81	1414685.01	40°28'09.746"N	104°45'47.459"W	circle

WELLPATH COMPOSITION - Ref Wellbore: TROUDT 41N-23A-M AWB Ref Wellpath: TROUDT 41N-23A-M AWP				
Start MD [ft]	End MD [ft]	Positional Uncertainty Model	Log Name/Comment	Wellbore
25.00	1780.00	BHI NaviTrak (Standard)	13 1/2" SURFACE SURVEYS <88-1759>	TROUDT 41N-23A-M AWB
1780.00	14936.00	BHI AutoTrak Curve (MagCAD+IFR1, Short spacing)	8 1/2 MONOBORE SURVEYS <1897-14936>	TROUDT 41N-23A-M AWB
14936.00	14960.00	Blind Drilling (std)	Projection to bit	TROUDT 41N-23A-M AWB



Actual Wellpath Report
TROUDT 41N-23A-M AWP
Page 9 of 9



REFERENCE WELLPATH IDENTIFICATION			
Operator	SRC ENERGY	Slot	SLOT#08 TROUDT 41N-23A-M (760'FNL & 1700'FWL, SEC.27)
Area	COLORADO	Well	TROUDT 41N-23A-M
Field	WELD COUNTY (NAD83,TRUE NORTH)	Wellbore	TROUDT 41N-23A-M AWB
Facility	SEC.27-T06N-R66W		

WELLPATH COMMENTS				
MD [ft]	Inclination [°]	Azimuth [°]	TVD [ft]	Comment
7531.00	87.810	85.830	6935.04	LANDING POINT (967'FSL & 2535'FEL, SEC.22)
14936.00	91.020	86.370	6906.81	LAST BHI SURVEY (1000'FSL & 470'FEL, SEC.23)
14960.00	91.020	86.370	6906.38	PROJ TO BIT (1001'FSL & 446'FEL, SEC.23)