

SRC ENERGY

Location: COLORADO Slot: SLOT#09 TROUDT 8C-23-M (760'FNL & 1715'FWL, SEC.27)
 Field: WELD COUNTY (NAD83,TRUE NORTH) Well: TROUDT 8C-23-M
 Facility: SEC.27-T06N-R66W Wellbore: TROUDT 8C-23-M PWB

Plot reference wellpath is TROUDT 8C-23-M PWP (REV-B.0)	Grid System: NAD83 / Lambert Colorado SP, Northern Zone (501), US feet
True vertical depths are referenced to PD 562 (25) (RKB)	North Reference: True north
Measured depths are referenced to PD 562 (25) (RKB)	Scale: True distance
PD 562 (25) (RKB) to Mean Sea Level: 4744 feet	Depths are in feet
Mean Sea Level to Mud line (At Slot: SLOT#09 TROUDT 8C-23-M (760'FNL & 1715'FWL, SEC.27): 0 feet	Created by: robale01 on 2018-10-24
Coordinates are in feet referenced to Slot	Database: WA DENVER



SRC ENERGY

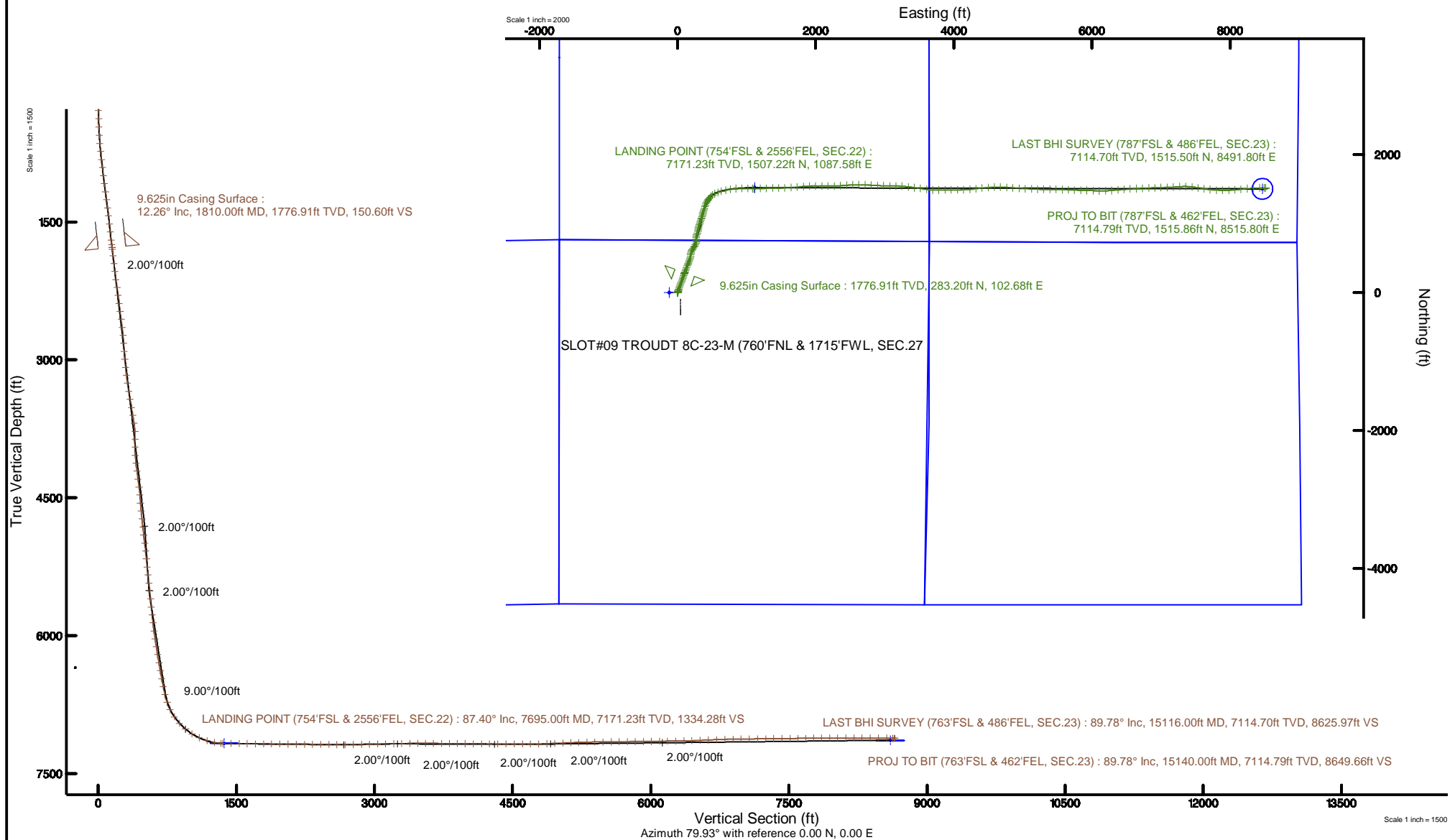



Actual Wellpath Report

TROUDT 8C-23-M AWP

Page 1 of 10



REFERENCE WELLPATH IDENTIFICATION

Operator	SRC ENERGY	Slot	SLOT#09 TROUDT 8C-23-M (760'FNL & 1715'FWL, SEC.27
Area	COLORADO	Well	TROUDT 8C-23-M
Field	WELD COUNTY (NAD83,TRUE NORTH)	Wellbore	TROUDT 8C-23-M AWB
Facility	SEC.27-T06N-R66W		

REPORT SETUP INFORMATION

Projection System	NAD83 / Lambert Colorado SP, Northern Zone (501), US feet	Software System	WellArchitect® 5.1
North Reference	True	User	Hanisab
Scale	0.999964	Report Generated	10/29/2018 at 11:25:11 PM
Convergence at slot	0.47° East	Database/Source file	WA DENVER/TROUDT_8C-23-M_AWP.xml

WELLPATH LOCATION

	Local coordinates		Grid coordinates		Geographic coordinates	
	North[ft]	East[ft]	Easting[US ft]	Northing[US ft]	Latitude	Longitude
Slot Location	-0.02	119.94	3203893.68	1412933.68	40°27'52.531"N	104°46'01.945"W
Facility Reference Pt			3203773.74	1412932.71	40°27'52.531"N	104°46'03.497"W
Field Reference Pt			3171284.48	1426358.81	40°30'07.643"N	104°53'02.634"W

WELLPATH DATUM

Calculation method	Minimum curvature	PD 562 (25') (RKB) to Facility Vertical Datum	4744.00ft
Horizontal Reference Pt	Slot	PD 562 (25') (RKB) to Mean Sea Level	4744.00ft
Vertical Reference Pt	PD 562 (25') (RKB)	PD 562 (25') (RKB) to Mud Line at Slot (SLOT#09 TROUDT 8C-23-M (760'FNL & 1715'FWL, SEC.27)	4744.00ft
MD Reference Pt	PD 562 (25') (RKB)	Section Origin	N 0.00, E 0.00 ft
Field Vertical Reference	Mean Sea Level	Section Azimuth	79.93°



Actual Wellpath Report

TROUDT 8C-23-M AWP

Page 2 of 10



REFERENCE WELLPATH IDENTIFICATION

Operator	SRC ENERGY	Slot	SLOT#09 TROUDT 8C-23-M (760'FNL & 1715'FWL, SEC.27
Area	COLORADO	Well	TROUDT 8C-23-M
Field	WELD COUNTY (NAD83,TRUE NORTH)	Wellbore	TROUDT 8C-23-M AWP
Facility	SEC.27-T06N-R66W		

WELLPATH DATA (174 stations) † = interpolated/extrapolated station

MD [ft]	Inclination [°]	Azimuth [°]	TVD [ft]	Vert Sect [ft]	North [ft]	East [ft]	Latitude	Longitude	DLS [°/100ft]	Comments
0.00†	0.000	134.700	0.00	0.00	0.00	0.00	40°27'52.531"N	104°46'01.945"W	0.00	
25.00	0.000	134.700	25.00	0.00	0.00	0.00	40°27'52.531"N	104°46'01.945"W	0.00	
109.00	0.160	134.700	109.00	0.07	-0.08	0.08	40°27'52.530"N	104°46'01.944"W	0.19	
197.00	0.900	86.220	197.00	0.83	-0.12	0.86	40°27'52.530"N	104°46'01.934"W	0.91	
287.00	1.500	49.860	286.98	2.55	0.68	2.47	40°27'52.538"N	104°46'01.913"W	1.05	
377.00	2.740	31.970	376.91	5.01	3.27	4.51	40°27'52.563"N	104°46'01.887"W	1.55	
467.00	6.360	13.280	466.62	8.42	9.95	6.79	40°27'52.629"N	104°46'01.857"W	4.29	
557.00	7.380	14.350	555.97	12.79	20.40	9.37	40°27'52.733"N	104°46'01.824"W	1.14	
647.00	8.850	20.720	645.07	18.72	32.47	13.25	40°27'52.852"N	104°46'01.774"W	1.91	
737.00	11.070	19.400	733.71	26.52	47.10	18.57	40°27'52.996"N	104°46'01.705"W	2.48	
827.00	13.690	19.180	821.61	35.97	65.31	24.94	40°27'53.176"N	104°46'01.622"W	2.91	
917.00	13.410	19.360	909.10	46.30	85.22	31.90	40°27'53.373"N	104°46'01.532"W	0.31	
1007.00	13.220	19.050	996.68	56.44	104.79	38.72	40°27'53.567"N	104°46'01.444"W	0.23	
1097.00	15.400	19.370	1083.89	67.32	125.80	46.04	40°27'53.774"N	104°46'01.349"W	2.42	
1187.00	14.990	19.580	1170.74	78.95	148.04	53.91	40°27'53.994"N	104°46'01.248"W	0.46	
1277.00	14.000	20.260	1257.87	90.21	169.21	61.58	40°27'54.203"N	104°46'01.148"W	1.12	
1367.00	13.360	21.400	1345.32	101.13	189.11	69.14	40°27'54.400"N	104°46'01.050"W	0.77	
1457.00	12.820	19.520	1432.98	111.49	208.20	76.27	40°27'54.588"N	104°46'00.958"W	0.76	
1547.00	13.180	19.100	1520.68	121.42	227.31	82.96	40°27'54.777"N	104°46'00.872"W	0.41	
1637.00	13.100	18.010	1608.32	131.22	246.70	89.48	40°27'54.969"N	104°46'00.787"W	0.29	
1727.00	13.270	19.770	1695.95	141.16	266.12	96.12	40°27'55.161"N	104°46'00.701"W	0.48	
1780.00	12.560	22.180	1747.61	147.26	277.18	100.36	40°27'55.270"N	104°46'00.647"W	1.68	
1831.00	12.060	18.670	1797.43	152.78	287.37	104.15	40°27'55.371"N	104°46'00.597"W	1.76	
1900.00	13.980	21.750	1864.66	160.64	301.94	109.55	40°27'55.515"N	104°46'00.528"W	2.96	
1990.00	14.050	18.970	1951.98	171.67	322.37	117.13	40°27'55.716"N	104°46'00.430"W	0.75	
2079.00	14.130	19.920	2038.30	182.35	342.80	124.34	40°27'55.918"N	104°46'00.336"W	0.27	
2169.00	14.040	22.450	2125.60	193.71	363.22	132.26	40°27'56.120"N	104°46'00.234"W	0.69	
2258.00	14.180	20.870	2211.91	205.11	383.38	140.26	40°27'56.319"N	104°46'00.130"W	0.46	
2347.00	13.960	23.450	2298.24	216.65	403.41	148.42	40°27'56.517"N	104°46'00.025"W	0.75	
2437.00	13.520	21.030	2385.67	228.07	423.19	156.51	40°27'56.713"N	104°45'59.920"W	0.80	



Actual Wellpath Report

TROUDT 8C-23-M AWP

Page 3 of 10



REFERENCE WELLPATH IDENTIFICATION

Operator	SRC ENERGY	Slot	SLOT#09 TROUDT 8C-23-M (760'FNL & 1715'FWL, SEC.27
Area	COLORADO	Well	TROUDT 8C-23-M
Field	WELD COUNTY (NAD83,TRUE NORTH)	Wellbore	TROUDT 8C-23-M AWP
Facility	SEC.27-T06N-R66W		

WELLPATH DATA (174 stations)

MD [ft]	Inclination [°]	Azimuth [°]	TVD [ft]	Vert Sect [ft]	North [ft]	East [ft]	Latitude	Longitude	DLS [°/100ft]	Comments
2526.00	13.460	22.290	2472.21	238.99	442.49	164.18	40°27'56.903"N	104°45'59.821"W	0.34	
2615.00	13.630	21.550	2558.74	250.03	461.83	171.96	40°27'57.095"N	104°45'59.720"W	0.27	
2705.00	13.800	19.630	2646.17	260.91	481.80	179.46	40°27'57.292"N	104°45'59.623"W	0.54	
2794.00	13.970	11.400	2732.58	270.10	502.33	185.15	40°27'57.495"N	104°45'59.550"W	2.23	
2883.00	13.600	4.450	2819.02	276.65	523.29	188.08	40°27'57.702"N	104°45'59.512"W	1.91	
2973.00	13.110	7.680	2906.59	282.42	543.96	190.27	40°27'57.906"N	104°45'59.483"W	0.99	
3062.00	13.350	11.460	2993.23	289.26	564.03	193.66	40°27'58.105"N	104°45'59.439"W	1.01	
3152.00	13.390	15.170	3080.79	297.52	584.28	198.45	40°27'58.305"N	104°45'59.377"W	0.95	
3241.00	13.280	19.970	3167.39	307.03	603.83	204.64	40°27'58.498"N	104°45'59.297"W	1.25	
3331.00	13.200	27.840	3255.01	318.52	622.63	212.97	40°27'58.684"N	104°45'59.190"W	2.00	
3420.00	13.790	33.780	3341.56	332.11	640.44	223.61	40°27'58.859"N	104°45'59.052"W	1.69	
3510.00	13.630	34.890	3428.99	347.03	658.05	235.64	40°27'59.034"N	104°45'58.896"W	0.34	
3599.00	13.620	33.670	3515.49	361.69	675.37	247.45	40°27'59.205"N	104°45'58.743"W	0.32	
3689.00	13.700	33.560	3602.94	376.37	693.07	259.22	40°27'59.380"N	104°45'58.591"W	0.09	
3778.00	14.920	25.880	3689.19	390.37	712.17	270.04	40°27'59.568"N	104°45'58.451"W	2.53	
3868.00	14.320	1.980	3776.35	399.50	733.73	275.49	40°27'59.781"N	104°45'58.381"W	6.69	
3957.00	13.840	344.450	3862.72	400.78	755.00	273.02	40°27'59.992"N	104°45'58.413"W	4.80	
4046.00	14.400	348.520	3949.03	399.49	776.10	267.96	40°28'00.200"N	104°45'58.478"W	1.28	
4136.00	14.120	9.690	4036.32	402.93	797.90	267.58	40°28'00.415"N	104°45'58.483"W	5.77	
4225.00	13.390	16.970	4122.77	411.28	818.46	272.42	40°28'00.619"N	104°45'58.420"W	2.11	
4315.00	15.600	17.270	4209.90	421.58	839.99	279.05	40°28'00.831"N	104°45'58.335"W	2.46	
4404.00	14.880	18.650	4295.77	432.56	862.24	286.26	40°28'01.051"N	104°45'58.241"W	0.91	
4494.00	15.610	19.040	4382.60	444.00	884.64	293.90	40°28'01.273"N	104°45'58.142"W	0.82	
4583.00	12.390	6.150	4468.97	452.50	905.46	298.84	40°28'01.478"N	104°45'58.079"W	5.02	
4673.00	14.080	9.750	4556.58	458.91	925.85	301.72	40°28'01.680"N	104°45'58.041"W	2.09	
4762.00	13.320	11.300	4643.04	466.31	946.58	305.57	40°28'01.885"N	104°45'57.992"W	0.95	
4852.00	14.920	14.580	4730.32	474.92	967.96	310.51	40°28'02.096"N	104°45'57.927"W	1.99	
4941.00	13.220	17.890	4816.65	484.47	988.73	316.53	40°28'02.301"N	104°45'57.850"W	2.11	
5030.00	12.460	18.690	4903.42	493.86	1007.51	322.73	40°28'02.487"N	104°45'57.769"W	0.88	
5120.00	14.580	19.550	4990.93	504.13	1027.39	329.63	40°28'02.683"N	104°45'57.680"W	2.37	



Actual Wellpath Report

TROUDT 8C-23-M AWP

Page 4 of 10



REFERENCE WELLPATH IDENTIFICATION

Operator	SRC ENERGY	Slot	SLOT#09 TROUDT 8C-23-M (760'FNL & 1715'FWL, SEC.27
Area	COLORADO	Well	TROUDT 8C-23-M
Field	WELD COUNTY (NAD83,TRUE NORTH)	Wellbore	TROUDT 8C-23-M AWB
Facility	SEC.27-T06N-R66W		

WELLPATH DATA (174 stations) † = interpolated/extrapolated station

MD [ft]	Inclination [°]	Azimuth [°]	TVD [ft]	Vert Sect [ft]	North [ft]	East [ft]	Latitude	Longitude	DLS [°/100ft]	Comments
5209.00	12.130	19.680	5077.51	514.31	1046.75	336.53	40°28'02.874"N	104°45'57.591"W	2.75	
5299.00	12.080	19.530	5165.51	523.65	1064.53	342.86	40°28'03.050"N	104°45'57.509"W	0.07	
5388.00	10.500	17.840	5252.79	532.05	1081.03	348.46	40°28'03.213"N	104°45'57.437"W	1.81	
5478.00	13.320	17.930	5340.84	540.76	1098.70	354.17	40°28'03.388"N	104°45'57.363"W	3.13	
5567.00	14.740	16.190	5427.18	550.58	1119.33	360.48	40°28'03.592"N	104°45'57.281"W	1.66	
5657.00	14.190	13.870	5514.33	560.12	1141.04	366.32	40°28'03.806"N	104°45'57.205"W	0.89	
5746.00	15.010	13.740	5600.46	569.20	1162.82	371.67	40°28'04.021"N	104°45'57.136"W	0.92	
5836.00	12.330	14.010	5687.90	577.82	1183.47	376.76	40°28'04.225"N	104°45'57.070"W	2.98	
5925.00	13.000	14.780	5774.73	585.91	1202.37	381.62	40°28'04.412"N	104°45'57.007"W	0.78	
6014.00	14.830	15.740	5861.12	595.07	1223.01	387.26	40°28'04.616"N	104°45'56.934"W	2.07	
6104.00	16.180	18.140	5947.84	606.01	1246.02	394.29	40°28'04.844"N	104°45'56.844"W	1.66	
6193.00	16.170	19.530	6033.32	617.99	1269.48	402.29	40°28'05.075"N	104°45'56.740"W	0.44	
6283.00	16.260	23.270	6119.74	631.11	1292.87	411.46	40°28'05.306"N	104°45'56.621"W	1.16	
6372.00	14.380	31.080	6205.58	645.23	1313.78	422.09	40°28'05.513"N	104°45'56.484"W	3.13	
6462.00	12.180	37.650	6293.18	659.61	1330.87	433.66	40°28'05.682"N	104°45'56.334"W	2.96	
6551.00	13.080	39.650	6380.02	674.24	1346.06	445.82	40°28'05.832"N	104°45'56.177"W	1.12	
6640.00	13.890	37.720	6466.57	689.83	1362.27	458.79	40°28'05.992"N	104°45'56.009"W	1.04	
6730.00	14.740	37.410	6553.77	706.27	1379.91	472.35	40°28'06.167"N	104°45'55.833"W	0.95	
6819.00	16.140	40.180	6639.56	724.13	1398.35	487.21	40°28'06.349"N	104°45'55.641"W	1.78	
6909.00	20.530	56.650	6725.03	748.27	1416.61	508.49	40°28'06.529"N	104°45'55.366"W	7.50	
6998.00	27.600	65.500	6806.27	782.63	1433.76	540.34	40°28'06.699"N	104°45'54.954"W	8.90	
7088.00	34.400	69.610	6883.37	827.89	1451.29	583.19	40°28'06.872"N	104°45'54.399"W	7.91	
7177.00	42.250	74.150	6953.15	882.49	1468.25	635.64	40°28'07.039"N	104°45'53.721"W	9.37	
7267.00	49.930	75.840	7015.53	947.04	1484.96	698.23	40°28'07.205"N	104°45'52.911"W	8.64	
7356.00	58.130	80.830	7067.78	1018.94	1499.35	768.71	40°28'07.347"N	104°45'51.999"W	10.27	
7445.00	66.590	87.350	7109.07	1097.43	1507.28	847.02	40°28'07.425"N	104°45'50.986"W	11.50	
7535.00	71.180	90.110	7141.48	1180.37	1509.11	930.92	40°28'07.443"N	104°45'49.900"W	5.85	
7624.00	80.120	91.100	7163.52	1265.01	1508.18	1017.05	40°28'07.434"N	104°45'48.786"W	10.10	
7695.00†	87.401	90.467	7171.23	1334.28	1507.22	1087.58	40°28'07.424"N	104°45'47.873"W	10.29	LANDING POINT (754'FSL & 2556'FEL, SEC.22)
7714.00	89.350	90.300	7171.77	1352.96	1507.09	1106.57	40°28'07.423"N	104°45'47.628"W	10.29	



Actual Wellpath Report

TROUDT 8C-23-M AWP

Page 5 of 10



REFERENCE WELLPATH IDENTIFICATION

Operator	SRC ENERGY	Slot	SLOT#09 TROUDT 8C-23-M (760'FNL & 1715'FWL, SEC.27
Area	COLORADO	Well	TROUDT 8C-23-M
Field	WELD COUNTY (NAD83,TRUE NORTH)	Wellbore	TROUDT 8C-23-M AWP
Facility	SEC.27-T06N-R66W		

WELLPATH DATA (174 stations)

MD [ft]	Inclination [°]	Azimuth [°]	TVD [ft]	Vert Sect [ft]	North [ft]	East [ft]	Latitude	Longitude	DLS [°/100ft]	Comments
7803.00	89.450	88.600	7172.70	1440.72	1507.95	1195.55	40°28'07.432"N	104°45'46.476"W	1.91	
7893.00	89.480	86.510	7173.54	1529.92	1511.79	1285.46	40°28'07.469"N	104°45'45.313"W	2.32	
7983.00	89.540	88.620	7174.31	1619.11	1515.61	1375.37	40°28'07.507"N	104°45'44.150"W	2.35	
8072.00	89.540	90.230	7175.03	1706.89	1516.50	1464.36	40°28'07.516"N	104°45'42.998"W	1.81	
8162.00	89.290	88.190	7175.95	1795.70	1517.75	1554.35	40°28'07.528"N	104°45'41.834"W	2.28	
8251.00	89.320	86.790	7177.03	1883.92	1521.64	1643.25	40°28'07.567"N	104°45'40.684"W	1.57	
8340.00	89.170	83.180	7178.20	1972.55	1529.42	1731.89	40°28'07.643"N	104°45'39.537"W	4.06	
8430.00	89.450	84.560	7179.28	2062.33	1539.03	1821.36	40°28'07.738"N	104°45'38.379"W	1.56	
8519.00	89.510	89.500	7180.09	2150.62	1543.64	1910.21	40°28'07.784"N	104°45'37.230"W	5.55	
8609.00	89.320	90.270	7181.01	2239.26	1543.82	2000.21	40°28'07.785"N	104°45'36.065"W	0.88	
8698.00	89.410	89.480	7182.00	2326.92	1544.01	2089.20	40°28'07.787"N	104°45'34.914"W	0.89	
8788.00	89.480	89.500	7182.87	2415.66	1544.82	2179.19	40°28'07.795"N	104°45'33.749"W	0.08	
8878.00	89.410	88.970	7183.74	2504.48	1546.02	2269.18	40°28'07.807"N	104°45'32.585"W	0.59	
8967.00	89.510	86.080	7184.58	2592.68	1549.86	2358.09	40°28'07.845"N	104°45'31.435"W	3.25	
9057.00	89.630	85.890	7185.25	2682.18	1556.16	2447.86	40°28'07.907"N	104°45'30.273"W	0.25	
9146.00	91.260	87.320	7184.56	2770.57	1561.43	2536.70	40°28'07.959"N	104°45'29.124"W	2.44	
9235.00	91.230	90.050	7182.63	2858.50	1563.47	2625.64	40°28'07.979"N	104°45'27.973"W	3.07	
9325.00	91.290	92.620	7180.65	2946.70	1561.38	2715.59	40°28'07.958"N	104°45'26.809"W	2.86	
9414.00	91.390	93.200	7178.57	3033.40	1556.86	2804.45	40°28'07.914"N	104°45'25.659"W	0.66	
9504.00	91.360	93.430	7176.41	3120.93	1551.66	2894.27	40°28'07.862"N	104°45'24.497"W	0.26	
9593.00	91.200	91.720	7174.42	3207.75	1547.66	2983.16	40°28'07.822"N	104°45'23.347"W	1.93	
9683.00	90.890	90.710	7172.78	3296.00	1545.75	3073.12	40°28'07.803"N	104°45'22.183"W	1.17	
9772.00	90.990	90.790	7171.32	3383.40	1544.59	3162.10	40°28'07.792"N	104°45'21.032"W	0.14	
9861.00	89.940	93.810	7170.60	3470.32	1541.02	3251.02	40°28'07.756"N	104°45'19.882"W	3.59	
9951.00	89.820	97.600	7170.79	3556.92	1532.07	3340.55	40°28'07.668"N	104°45'18.723"W	4.21	
10040.00	89.480	97.760	7171.33	3641.68	1520.18	3428.75	40°28'07.550"N	104°45'17.582"W	0.42	
10130.00	89.450	98.060	7172.17	3727.29	1507.79	3517.89	40°28'07.428"N	104°45'16.429"W	0.33	
10219.00	89.540	97.930	7172.95	3811.90	1495.41	3606.03	40°28'07.305"N	104°45'15.288"W	0.18	
10309.00	89.450	92.340	7173.75	3898.71	1487.36	3695.63	40°28'07.226"N	104°45'14.129"W	6.21	
10398.00	89.510	87.870	7174.56	3986.29	1487.20	3784.60	40°28'07.224"N	104°45'12.978"W	5.02	



Actual Wellpath Report

TROUDT 8C-23-M AWP

Page 6 of 10



REFERENCE WELLPATH IDENTIFICATION

Operator	SRC ENERGY	Slot	SLOT#09 TROUDT 8C-23-M (760'FNL & 1715'FWL, SEC.27
Area	COLORADO	Well	TROUDT 8C-23-M
Field	WELD COUNTY (NAD83,TRUE NORTH)	Wellbore	TROUDT 8C-23-M AWB
Facility	SEC.27-T06N-R66W		

WELLPATH DATA (174 stations)

MD [ft]	Inclination [°]	Azimuth [°]	TVD [ft]	Vert Sect [ft]	North [ft]	East [ft]	Latitude	Longitude	DLS [°/100ft]	Comments
10487.00	89.480	89.060	7175.34	4074.30	1489.58	3873.56	40°28'07.247"N	104°45'11.827"W	1.34	
10577.00	89.290	90.870	7176.31	4162.91	1489.64	3963.55	40°28'07.248"N	104°45'10.662"W	2.02	
10666.00	90.120	89.420	7176.76	4250.50	1489.41	4052.55	40°28'07.245"N	104°45'09.511"W	1.88	
10756.00	89.570	88.310	7177.01	4339.40	1491.20	4142.53	40°28'07.263"N	104°45'08.347"W	1.38	
10845.00	89.480	85.470	7177.75	4427.74	1496.02	4231.39	40°28'07.310"N	104°45'07.197"W	3.19	
10935.00	89.720	82.540	7178.37	4517.50	1505.42	4320.88	40°28'07.403"N	104°45'06.039"W	3.27	
11024.00	90.550	84.880	7178.16	4606.30	1515.17	4409.34	40°28'07.499"N	104°45'04.895"W	2.79	
11113.00	88.920	85.270	7178.58	4694.93	1522.81	4498.01	40°28'07.575"N	104°45'03.747"W	1.88	
11203.00	92.220	87.530	7177.68	4784.34	1528.46	4587.81	40°28'07.630"N	104°45'02.585"W	4.44	
11292.00	92.280	92.050	7174.19	4871.94	1528.79	4676.71	40°28'07.633"N	104°45'01.435"W	5.08	
11382.00	92.400	94.070	7170.51	4959.51	1523.99	4766.51	40°28'07.586"N	104°45'00.273"W	2.25	
11471.00	92.340	93.890	7166.83	5045.77	1517.82	4855.21	40°28'07.525"N	104°44'59.126"W	0.21	
11561.00	92.400	94.070	7163.11	5133.01	1511.58	4944.92	40°28'07.463"N	104°44'57.965"W	0.21	
11650.00	91.360	92.550	7160.19	5219.54	1506.44	5033.72	40°28'07.412"N	104°44'56.816"W	2.07	
11740.00	91.450	92.250	7157.98	5307.39	1502.67	5123.61	40°28'07.374"N	104°44'55.653"W	0.35	
11829.00	90.920	92.920	7156.14	5394.21	1498.66	5212.50	40°28'07.335"N	104°44'54.503"W	0.96	
11918.00	90.550	91.090	7155.00	5481.23	1495.55	5301.44	40°28'07.304"N	104°44'53.352"W	2.10	
12008.00	90.830	89.300	7153.91	5569.78	1495.24	5391.43	40°28'07.300"N	104°44'52.188"W	2.01	
12097.00	90.590	90.360	7152.81	5657.45	1495.50	5480.42	40°28'07.303"N	104°44'51.036"W	1.22	
12186.00	90.490	91.940	7151.97	5744.74	1493.72	5569.39	40°28'07.285"N	104°44'49.885"W	1.78	
12276.00	90.550	92.510	7151.16	5832.68	1490.22	5659.32	40°28'07.250"N	104°44'48.722"W	0.64	
12365.00	90.620	92.620	7150.25	5919.52	1486.24	5748.23	40°28'07.211"N	104°44'47.571"W	0.15	
12455.00	90.740	91.930	7149.18	6007.43	1482.67	5838.15	40°28'07.175"N	104°44'46.408"W	0.78	
12544.00	90.920	91.000	7147.89	6094.63	1480.39	5927.11	40°28'07.153"N	104°44'45.257"W	1.06	
12634.00	90.680	93.180	7146.63	6182.59	1477.11	6017.04	40°28'07.120"N	104°44'44.093"W	2.44	
12723.00	90.710	91.120	7145.55	6269.57	1473.77	6105.96	40°28'07.087"N	104°44'42.943"W	2.31	
12813.00	90.650	87.010	7144.49	6358.40	1475.24	6195.93	40°28'07.101"N	104°44'41.779"W	4.57	
12902.00	92.430	85.810	7142.09	6446.80	1480.81	6284.71	40°28'07.156"N	104°44'40.630"W	2.41	
12993.00	92.560	85.440	7138.13	6537.26	1487.75	6375.36	40°28'07.224"N	104°44'39.457"W	0.43	
13082.00	92.620	85.690	7134.11	6625.74	1494.62	6464.01	40°28'07.292"N	104°44'38.310"W	0.29	



Actual Wellpath Report

TROUDT 8C-23-M AWP

Page 7 of 10



REFERENCE WELLPATH IDENTIFICATION

Operator	SRC ENERGY	Slot	SLOT#09 TROUDT 8C-23-M (760'FNL & 1715'FWL, SEC.27
Area	COLORADO	Well	TROUDT 8C-23-M
Field	WELD COUNTY (NAD83,TRUE NORTH)	Wellbore	TROUDT 8C-23-M AWP
Facility	SEC.27-T06N-R66W		

WELLPATH DATA (174 stations)

MD [ft]	Inclination [°]	Azimuth [°]	TVD [ft]	Vert Sect [ft]	North [ft]	East [ft]	Latitude	Longitude	DLS [°/100ft]	Comments
13172.00	92.340	85.870	7130.22	6715.19	1501.24	6553.68	40°28'07.357"N	104°44'37.150"W	0.37	
13261.00	91.600	86.270	7127.16	6803.63	1507.33	6642.41	40°28'07.417"N	104°44'36.002"W	0.95	
13351.00	90.860	87.300	7125.22	6892.96	1512.38	6732.25	40°28'07.467"N	104°44'34.840"W	1.41	
13440.00	90.800	88.020	7123.94	6981.14	1516.01	6821.17	40°28'07.502"N	104°44'33.689"W	0.81	
13530.00	90.770	88.230	7122.70	7070.22	1518.96	6911.11	40°28'07.531"N	104°44'32.525"W	0.24	
13619.00	90.740	88.230	7121.53	7158.28	1521.71	7000.06	40°28'07.558"N	104°44'31.374"W	0.03	
13709.00	90.680	87.610	7120.41	7247.40	1524.97	7089.99	40°28'07.590"N	104°44'30.211"W	0.69	
13798.00	90.590	86.640	7119.43	7335.69	1529.44	7178.87	40°28'07.634"N	104°44'29.061"W	1.09	
13888.00	90.490	86.170	7118.58	7425.11	1535.08	7268.69	40°28'07.689"N	104°44'27.899"W	0.53	
13978.00	90.680	90.780	7117.66	7514.09	1537.47	7358.63	40°28'07.713"N	104°44'26.735"W	5.13	
14067.00	90.680	97.090	7116.60	7600.39	1531.37	7447.37	40°28'07.652"N	104°44'25.587"W	7.09	
14157.00	90.800	99.420	7115.44	7685.82	1518.45	7536.42	40°28'07.524"N	104°44'24.435"W	2.59	
14246.00	90.490	98.160	7114.44	7770.03	1504.85	7624.37	40°28'07.390"N	104°44'23.297"W	1.46	
14335.00	90.550	96.420	7113.63	7854.97	1493.56	7712.65	40°28'07.278"N	104°44'22.155"W	1.96	
14425.00	90.490	94.030	7112.81	7941.78	1485.36	7802.26	40°28'07.196"N	104°44'20.995"W	2.66	
14514.00	89.750	90.880	7112.63	8028.65	1481.55	7891.17	40°28'07.159"N	104°44'19.845"W	3.64	
14604.00	89.780	87.430	7113.00	8117.47	1482.88	7981.14	40°28'07.171"N	104°44'18.681"W	3.83	
14693.00	89.720	84.320	7113.38	8205.98	1489.28	8069.90	40°28'07.234"N	104°44'17.532"W	3.49	
14782.00	89.750	83.670	7113.80	8294.76	1498.59	8158.41	40°28'07.326"N	104°44'16.387"W	0.73	
14872.00	89.880	85.160	7114.09	8384.48	1507.35	8247.98	40°28'07.412"N	104°44'15.228"W	1.66	
14961.00	89.850	88.570	7114.30	8472.82	1512.22	8336.83	40°28'07.460"N	104°44'14.079"W	3.83	
15051.00	89.880	88.770	7114.51	8561.77	1514.30	8426.81	40°28'07.480"N	104°44'12.914"W	0.22	
15116.00	89.780	89.130	7114.70	8625.97	1515.50	8491.80	40°28'07.492"N	104°44'12.074"W	0.57	LAST BHI SURVEY (787'FSL & 486'FEL, SEC.23)
15140.00	89.780	89.130	7114.79	8649.66	1515.86	8515.80	40°28'07.495"N	104°44'11.763"W	0.00	PROJ TO BIT (787'FSL & 462'FEL, SEC.23)



Actual Wellpath Report

TROUDT 8C-23-M AWP

Page 8 of 10



REFERENCE WELLPATH IDENTIFICATION

Operator	SRC ENERGY	Slot	SLOT#09 TROUDT 8C-23-M (760'FNL & 1715'FWL, SEC.27
Area	COLORADO	Well	TROUDT 8C-23-M
Field	WELD COUNTY (NAD83,TRUE NORTH)	Wellbore	TROUDT 8C-23-M AWP
Facility	SEC.27-T06N-R66W		

HOLE & CASING SECTIONS - Ref Wellbore: TROUDT 8C-23-M AWP Ref Wellpath: TROUDT 8C-23-M AWP

String/Diameter	Start MD [ft]	End MD [ft]	Interval [ft]	Start TVD [ft]	End TVD [ft]	Start N/S [ft]	Start E/W [ft]	End N/S [ft]	End E/W [ft]
9.625in Casing Surface	25.00	1810.00	1785.00	25.00	1776.91	0.00	0.00	283.20	102.68

TARGETS

Name	TVD [ft]	North [ft]	East [ft]	Grid East [US ft]	Grid North [US ft]	Latitude	Longitude	Shape
SEC.23-T06N-R66W	-8.00	4231.31	-1987.25	3201871.60	1417148.27	40°28'34.342"N	104°46'27.660"W	polygon
SEC.22-T06N-R66W	6.00	1412.76	-8129.08	3195753.51	1414279.17	40°28'06.478"N	104°47'47.123"W	polygon
SEC.27-T06N-R66W	19.00	-4766.34	955.45	3204888.45	1408175.58	40°27'05.432"N	104°45'49.586"W	polygon
SEC.28-T06N-R66W	19.00	-4766.34	955.45	3204888.45	1408175.58	40°27'05.432"N	104°45'49.586"W	polygon
SEC.26-T06N-R66W	38.00	-4763.02	555.23	3204488.23	1408175.60	40°27'05.465"N	104°45'54.763"W	polygon
SEC.29-T06N-R66W EAST HALF	50.00	0.02	-119.94	3203773.74	1412932.71	40°27'52.531"N	104°46'03.497"W	polygon
TROUDT 8C-23-M BHL ON PLAT (775'FSL & 510'FEL, SEC.23)	7137.00	1503.19	8467.62	3212348.27	1414506.73	40°28'07.370"N	104°44'12.386"W	circle
TROUDT 8C-23-M TOP OF PROD ON PLAT (767'FSL & 2526'FEL, SEC.22)	7170.00	1520.70	1118.78	3204999.81	1414463.52	40°28'07.558"N	104°45'47.470"W	circle



Actual Wellpath Report

TROUDT 8C-23-M AWP

Page 9 of 10



REFERENCE WELLPATH IDENTIFICATION

Operator	SRC ENERGY	Slot	SLOT#09 TROUDT 8C-23-M (760'FNL & 1715'FWL, SEC.27
Area	COLORADO	Well	TROUDT 8C-23-M
Field	WELD COUNTY (NAD83,TRUE NORTH)	Wellbore	TROUDT 8C-23-M AWB
Facility	SEC.27-T06N-R66W		

WELLPATH COMPOSITION - Ref Wellbore: TROUDT 8C-23-M AWB Ref Wellpath: TROUDT 8C-23-M AWP

Start MD [ft]	End MD [ft]	Positional Uncertainty Model	Log Name/Comment	Wellbore
25.00	1780.00	BHI NaviTrak (Standard)	13 1/2" SURFACE SURVEYS <88-1759>	TROUDT 8C-23-M AWB
1780.00	15116.00	BHI AutoTrak Curve (MagCAD+IFR1, Short spacing)	8 1/2" MONOBORE SURVEYS <1831-15116>	TROUDT 8C-23-M AWB
15116.00	15140.00	Blind Drilling (std)	Projection to bit	TROUDT 8C-23-M AWB



Actual Wellpath Report

TROUDT 8C-23-M AWP

Page 10 of 10



REFERENCE WELLPATH IDENTIFICATION

Operator	SRC ENERGY	Slot	SLOT#09 TROUDT 8C-23-M (760'FNL & 1715'FWL, SEC.27
Area	COLORADO	Well	TROUDT 8C-23-M
Field	WELD COUNTY (NAD83,TRUE NORTH)	Wellbore	TROUDT 8C-23-M AWB
Facility	SEC.27-T06N-R66W		

WELLPATH COMMENTS

MD [ft]	Inclination [°]	Azimuth [°]	TVD [ft]	Comment
7695.00	87.401	90.467	7171.23	LANDING POINT (754'FSL & 2556'FEL, SEC.22)
15116.00	89.780	89.130	7114.70	LAST BHI SURVEY (787'FSL & 486'FEL, SEC.23)
15140.00	89.780	89.130	7114.79	PROJ TO BIT (787'FSL & 462'FEL, SEC.23)