

SRC ENERGY

Location: COLORADO Slot: SLOT#07 TROUDT 41C-23-M (760'FNL & 1684'FWL, SEC.27)
 Field: WELD COUNTY (NAD83,TRUE NORTH) Well: TROUDT 41C-23-M
 Facility: SEC.27-T06N-R66W Wellbore: TROUDT 41C-23-M PWB

Plot reference wellpath is TROUDT 41C-23-M PWP (REV-B.0)	Grid System: NAD83 / Lambert Colorado SP, Northern Zone (501), US feet
True vertical depths are referenced to PD 562 (25) (RKB)	* = Wellpath was transformed from a different geodetic datum
Measured depths are referenced to PD 562 (25) (RKB)	North Reference: True north
PD 562 (25) (RKB) to Mean Sea Level: 4744 feet	Scale: True distance
Mean Sea Level to Mud line (At Slot: SLOT#07 TROUDT 41C-23-M (760'FNL & 1684'FWL, SEC.27)): 0 feet	Depths are in feet
Coordinates are in feet referenced to Slot	Created by: guenaler on 2018-10-26
	Database: WA_DEN_Denver_Defn

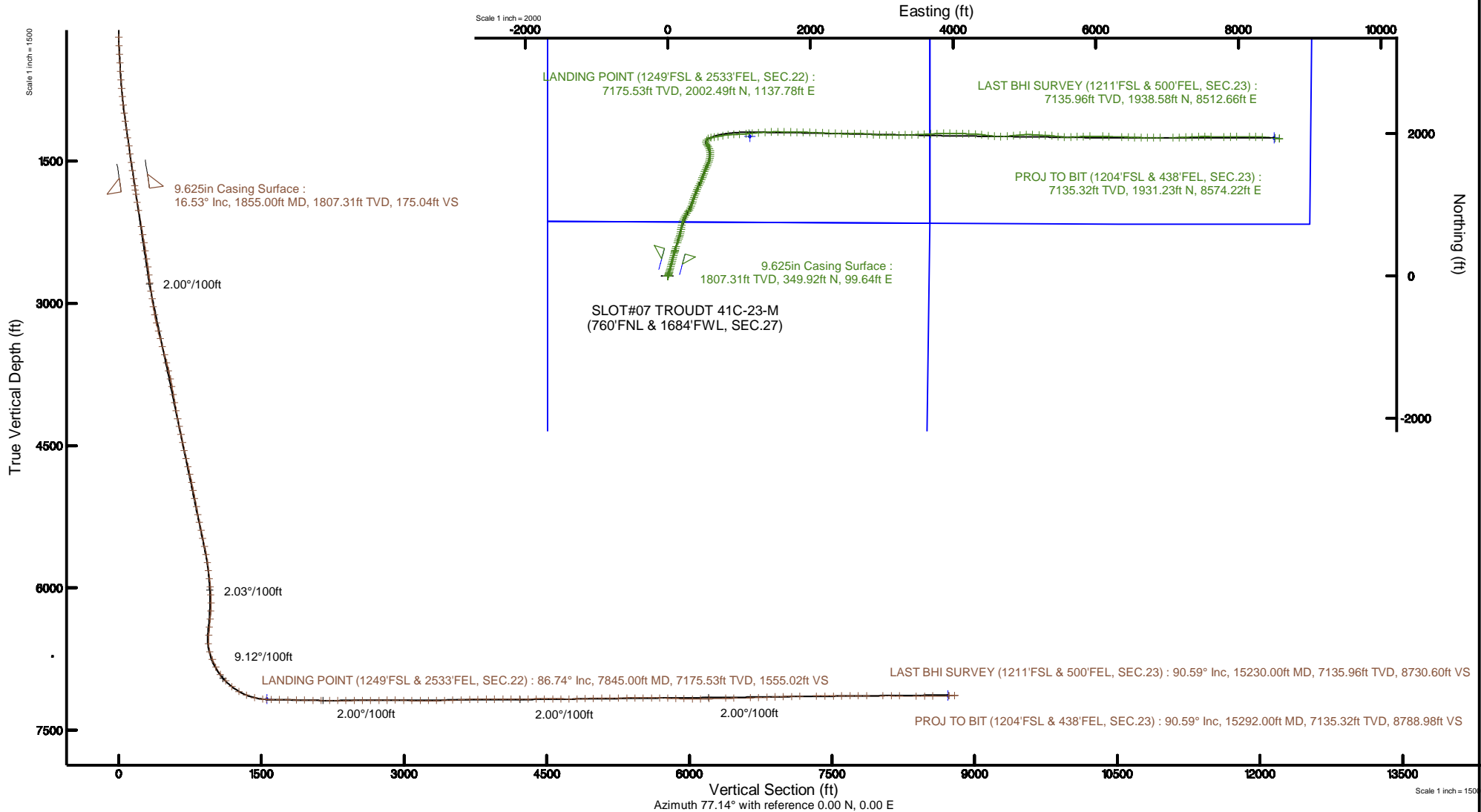



Actual Wellpath Report

TROUDT 41C-23-M AWP

Page 1 of 9



REFERENCE WELLPATH IDENTIFICATION			
Operator	SRC ENERGY	Slot	SLOT#07 TROUDT 41C-23-M (760'FNL & 1684'FWL, SEC.27)
Area	COLORADO	Well	TROUDT 41C-23-M
Field	WELD COUNTY (NAD83,TRUE NORTH)	Wellbore	TROUDT 41C-23-M AWB
Facility	SEC.27-T06N-R66W		

REPORT SETUP INFORMATION			
Projection System	NAD83 / Lambert Colorado SP, Northern Zone (501), US feet	Software System	WellArchitect® 5.0
North Reference	True	User	Guenaler
Scale	0.999964	Report Generated	10/26/2018 at 11:46:33 AM
Convergence at slot	0.48° East	Database/Source file	WA_DEN_Denver_Defn/TROUDT_41C-23-M_AWP.xml

WELLPATH LOCATION						
	Local coordinates		Grid coordinates		Geographic coordinates	
	North[ft]	East[ft]	Easting[US ft]	Northing[US ft]	Latitude	Longitude
Slot Location	-0.02	89.88	3203863.62	1412933.43	40°27'52.531"N	104°46'02.334"W
Facility Reference Pt			3203773.74	1412932.71	40°27'52.531"N	104°46'03.497"W
Field Reference Pt			3171284.48	1426358.81	40°30'07.643"N	104°53'02.634"W

WELLPATH DATUM			
Calculation method	Minimum curvature	PD 562 (25') (RKB) to Facility Vertical Datum	4744.00ft
Horizontal Reference Pt	Slot	PD 562 (25') (RKB) to Mean Sea Level	4744.00ft
Vertical Reference Pt	PD 562 (25') (RKB)	PD 562 (25') (RKB) to Mud Line at Slot (SLOT#07 TROUDT 41C-23-M (760'FNL & 1684'FWL, SEC.27))	4744.00ft
MD Reference Pt	PD 562 (25') (RKB)	Section Origin	N 0.00, E 0.00 ft
Field Vertical Reference	Mean Sea Level	Section Azimuth	77.14°



Actual Wellpath Report

TROUDT 41C-23-M AWP

Page 2 of 9



REFERENCE WELLPATH IDENTIFICATION			
Operator	SRC ENERGY	Slot	SLOT#07 TROUDT 41C-23-M (760'FNL & 1684'FWL, SEC.27)
Area	COLORADO	Well	TROUDT 41C-23-M
Field	WELD COUNTY (NAD83,TRUE NORTH)	Wellbore	TROUDT 41C-23-M AWP
Facility	SEC.27-T06N-R66W		

WELLPATH DATA (167 stations) † = interpolated/extrapolated station

MD [ft]	Inclination [°]	Azimuth [°]	TVD [ft]	Vert Sect [ft]	North [ft]	East [ft]	Latitude	Longitude	DLS [°/100ft]	Comments
0.00†	0.000	138.990	0.00	0.00	0.00	0.00	40°27'52.531"N	104°46'02.334"W	0.00	
25.00	0.000	138.990	25.00	0.00	0.00	0.00	40°27'52.531"N	104°46'02.334"W	0.00	
109.00	0.350	138.990	109.00	0.12	-0.19	0.17	40°27'52.529"N	104°46'02.332"W	0.42	
197.00	0.730	77.800	197.00	0.81	-0.28	0.89	40°27'52.528"N	104°46'02.322"W	0.73	
287.00	3.750	23.370	286.92	3.12	2.55	2.62	40°27'52.556"N	104°46'02.300"W	3.75	
377.00	4.690	27.430	376.68	7.24	8.51	5.48	40°27'52.615"N	104°46'02.263"W	1.10	
467.00	5.770	22.570	466.30	12.24	15.96	8.91	40°27'52.689"N	104°46'02.219"W	1.30	
557.00	6.700	17.110	555.77	17.49	25.15	12.20	40°27'52.780"N	104°46'02.176"W	1.22	
647.00	8.250	17.190	645.00	23.35	36.34	15.65	40°27'52.890"N	104°46'02.132"W	1.72	
737.00	10.700	15.060	733.77	30.49	50.58	19.73	40°27'53.031"N	104°46'02.079"W	2.75	
827.00	12.200	13.560	821.97	38.64	67.89	24.13	40°27'53.202"N	104°46'02.022"W	1.70	
917.00	13.580	13.890	909.70	47.63	87.40	28.90	40°27'53.395"N	104°46'01.960"W	1.54	
1007.00	15.790	15.660	996.76	58.23	109.45	34.74	40°27'53.612"N	104°46'01.885"W	2.51	
1097.00	16.580	15.350	1083.19	70.15	133.62	41.44	40°27'53.851"N	104°46'01.798"W	0.88	
1187.00	17.370	14.290	1169.27	82.35	159.02	48.16	40°27'54.102"N	104°46'01.711"W	0.94	
1277.00	16.870	15.450	1255.28	94.68	184.63	54.95	40°27'54.355"N	104°46'01.623"W	0.67	
1368.00	16.460	14.340	1342.46	106.83	209.85	61.66	40°27'54.605"N	104°46'01.536"W	0.57	
1457.00	16.670	14.440	1427.77	118.45	234.42	67.97	40°27'54.847"N	104°46'01.455"W	0.24	
1547.00	17.970	15.580	1513.68	130.99	260.30	74.92	40°27'55.103"N	104°46'01.365"W	1.49	
1637.00	18.170	15.680	1599.24	144.30	287.18	82.44	40°27'55.369"N	104°46'01.267"W	0.22	
1727.00	17.180	15.050	1684.99	157.23	313.53	89.68	40°27'55.629"N	104°46'01.174"W	1.12	
1805.00	17.360	15.370	1759.48	168.13	335.87	95.76	40°27'55.850"N	104°46'01.095"W	0.26	
1900.00	15.780	15.620	1850.53	181.00	361.98	102.99	40°27'56.108"N	104°46'01.001"W	1.66	
1990.00	18.290	17.630	1936.58	194.00	387.23	110.57	40°27'56.357"N	104°46'00.903"W	2.86	
2079.00	18.340	17.390	2021.07	208.14	413.90	118.98	40°27'56.621"N	104°46'00.795"W	0.10	
2258.00	18.270	18.120	2191.01	236.77	467.44	136.13	40°27'57.150"N	104°46'00.573"W	0.13	
2347.00	17.700	18.540	2275.66	251.01	493.53	144.77	40°27'57.408"N	104°46'00.461"W	0.66	
2436.00	18.250	18.680	2360.32	265.35	519.56	153.53	40°27'57.665"N	104°46'00.348"W	0.62	
2526.00	17.450	16.670	2445.98	279.37	545.84	161.92	40°27'57.925"N	104°46'00.239"W	1.12	
2615.00	17.670	16.300	2530.84	292.53	571.58	169.54	40°27'58.179"N	104°46'00.141"W	0.28	



Actual Wellpath Report

TROUDT 41C-23-M AWP

Page 3 of 9



REFERENCE WELLPATH IDENTIFICATION			
Operator	SRC ENERGY	Slot	SLOT#07 TROUDT 41C-23-M (760'FNL & 1684'FWL, SEC.27)
Area	COLORADO	Well	TROUDT 41C-23-M
Field	WELD COUNTY (NAD83,TRUE NORTH)	Wellbore	TROUDT 41C-23-M AWP
Facility	SEC.27-T06N-R66W		

WELLPATH DATA (167 stations)										
MD [ft]	Inclination [°]	Azimuth [°]	TVD [ft]	Vert Sect [ft]	North [ft]	East [ft]	Latitude	Longitude	DLS [°/100ft]	Comments
2705.00	17.630	14.280	2616.60	305.40	597.90	176.73	40°27'58.439"N	104°46'00.047"W	0.68	
2794.00	17.930	9.390	2701.35	316.74	624.48	182.29	40°27'58.702"N	104°45'59.976"W	1.71	
2883.00	20.460	8.930	2785.40	327.71	653.37	186.94	40°27'58.987"N	104°45'59.915"W	2.85	
2973.00	20.310	8.630	2869.76	339.27	684.35	191.73	40°27'59.293"N	104°45'59.853"W	0.20	
3062.00	20.390	10.540	2953.21	351.09	714.86	196.88	40°27'59.595"N	104°45'59.787"W	0.75	
3152.00	20.510	13.680	3037.54	364.36	745.60	203.48	40°27'59.899"N	104°45'59.701"W	1.23	
3241.00	19.700	18.580	3121.12	379.15	774.97	211.95	40°28'00.189"N	104°45'59.592"W	2.10	
3331.00	20.230	26.350	3205.73	396.91	803.30	223.69	40°28'00.469"N	104°45'59.440"W	3.00	
3420.00	19.790	29.890	3289.36	416.86	830.15	238.03	40°28'00.734"N	104°45'59.254"W	1.45	
3510.00	19.800	31.310	3374.04	437.83	856.38	253.54	40°28'00.993"N	104°45'59.054"W	0.53	
3599.00	18.780	34.410	3458.04	458.86	881.08	269.47	40°28'01.237"N	104°45'58.848"W	1.62	
3689.00	19.720	34.340	3543.01	480.64	905.57	286.22	40°28'01.479"N	104°45'58.631"W	1.04	
3778.00	19.700	33.730	3626.80	502.56	930.45	303.02	40°28'01.725"N	104°45'58.413"W	0.23	
3868.00	20.310	29.650	3711.37	524.13	956.64	319.17	40°28'01.984"N	104°45'58.204"W	1.69	
3957.00	20.340	20.540	3794.85	543.09	984.55	332.25	40°28'02.260"N	104°45'58.035"W	3.55	
4046.00	20.000	13.980	3878.40	558.48	1013.81	341.35	40°28'02.549"N	104°45'57.918"W	2.57	
4136.00	19.990	15.950	3962.98	572.85	1043.54	349.30	40°28'02.843"N	104°45'57.815"W	0.75	
4225.00	19.870	17.480	4046.65	587.82	1072.59	358.02	40°28'03.130"N	104°45'57.702"W	0.60	
4315.00	19.630	18.350	4131.36	603.38	1101.53	367.37	40°28'03.416"N	104°45'57.581"W	0.42	
4404.00	19.870	20.970	4215.12	619.55	1129.84	377.49	40°28'03.696"N	104°45'57.450"W	1.03	
4494.00	19.860	23.210	4299.77	637.07	1158.17	388.99	40°28'03.975"N	104°45'57.301"W	0.85	
4583.00	20.140	22.410	4383.40	654.82	1186.23	400.79	40°28'04.253"N	104°45'57.148"W	0.44	
4673.00	19.940	20.490	4467.95	672.20	1214.93	412.07	40°28'04.536"N	104°45'57.002"W	0.76	
4762.00	19.670	22.810	4551.69	689.28	1242.96	423.19	40°28'04.813"N	104°45'56.859"W	0.93	
4852.00	19.950	27.340	4636.37	708.03	1270.56	436.11	40°28'05.086"N	104°45'56.691"W	1.73	
4941.00	20.030	27.180	4720.01	727.63	1297.61	450.05	40°28'05.353"N	104°45'56.511"W	0.11	
5030.00	19.950	25.740	4803.64	746.91	1324.84	463.61	40°28'05.622"N	104°45'56.336"W	0.56	
5120.00	19.770	21.580	4888.30	765.10	1352.83	475.87	40°28'05.899"N	104°45'56.177"W	1.58	
5209.00	19.910	19.970	4972.01	781.83	1381.07	486.58	40°28'06.178"N	104°45'56.038"W	0.63	
5299.00	19.470	21.210	5056.75	798.54	1409.45	497.24	40°28'06.458"N	104°45'55.900"W	0.67	



Actual Wellpath Report

TROUDT 41C-23-M AWP

Page 4 of 9



REFERENCE WELLPATH IDENTIFICATION			
Operator	SRC ENERGY	Slot	SLOT#07 TROUDT 41C-23-M (760'FNL & 1684'FWL, SEC.27)
Area	COLORADO	Well	TROUDT 41C-23-M
Field	WELD COUNTY (NAD83, TRUE NORTH)	Wellbore	TROUDT 41C-23-M AWP
Facility	SEC.27-T06N-R66W		

WELLPATH DATA (167 stations) † = interpolated/extrapolated station										
MD [ft]	Inclination [°]	Azimuth [°]	TVD [ft]	Vert Sect [ft]	North [ft]	East [ft]	Latitude	Longitude	DLS [°/100ft]	Comments
5388.00	19.800	21.010	5140.58	815.26	1437.35	508.02	40°28'06.734"N	104°45'55.761"W	0.38	
5478.00	19.440	20.740	5225.35	832.04	1465.59	518.78	40°28'07.013"N	104°45'55.622"W	0.41	
5567.00	19.720	20.790	5309.20	848.56	1493.48	529.36	40°28'07.289"N	104°45'55.485"W	0.32	
5657.00	19.490	22.570	5393.99	865.68	1521.54	540.51	40°28'07.566"N	104°45'55.341"W	0.71	
5746.00	19.360	24.800	5477.92	883.30	1548.64	552.40	40°28'07.834"N	104°45'55.187"W	0.85	
5836.00	19.840	24.180	5562.71	901.61	1576.11	564.91	40°28'08.105"N	104°45'55.025"W	0.58	
5925.00	19.440	18.960	5646.54	918.52	1603.90	575.91	40°28'08.380"N	104°45'54.883"W	2.02	
6014.00	17.000	13.660	5731.07	932.15	1630.56	583.80	40°28'08.643"N	104°45'54.780"W	3.31	
6104.00	17.090	11.350	5817.12	943.45	1656.31	589.51	40°28'08.898"N	104°45'54.707"W	0.76	
6193.00	17.710	8.140	5902.05	953.66	1682.53	594.00	40°28'09.157"N	104°45'54.649"W	1.28	
6283.00	17.730	2.260	5987.79	962.14	1709.78	596.47	40°28'09.426"N	104°45'54.616"W	1.99	
6372.00	17.750	356.310	6072.56	967.84	1736.86	596.14	40°28'09.694"N	104°45'54.621"W	2.04	
6462.00	17.670	347.150	6158.31	970.03	1763.87	592.21	40°28'09.961"N	104°45'54.672"W	3.09	
6551.00	17.690	334.790	6243.14	967.14	1789.28	583.45	40°28'10.212"N	104°45'54.785"W	4.21	
6640.00	17.140	329.140	6328.07	960.20	1812.78	570.96	40°28'10.444"N	104°45'54.947"W	2.00	
6730.00	17.030	330.900	6414.10	952.42	1835.68	557.75	40°28'10.670"N	104°45'55.117"W	0.59	
6819.00	16.130	328.560	6499.40	944.83	1857.61	544.96	40°28'10.887"N	104°45'55.283"W	1.26	
6909.00	15.480	359.390	6586.14	943.40	1880.33	538.30	40°28'11.111"N	104°45'55.369"W	9.25	
6998.00	20.520	30.540	6670.95	956.68	1905.71	546.12	40°28'11.362"N	104°45'55.268"W	12.01	
7088.00	23.630	54.190	6754.51	984.19	1929.91	568.82	40°28'11.601"N	104°45'54.974"W	10.38	
7177.00	27.980	75.820	6834.79	1021.58	1945.50	603.62	40°28'11.755"N	104°45'54.524"W	11.58	
7267.00	35.280	84.450	6911.41	1068.56	1953.20	650.04	40°28'11.832"N	104°45'53.923"W	9.53	
7356.00	43.070	78.570	6980.38	1124.54	1961.72	705.51	40°28'11.916"N	104°45'53.206"W	9.69	
7445.00	51.460	79.240	7040.72	1189.82	1974.27	769.61	40°28'12.040"N	104°45'52.376"W	9.44	
7535.00	59.740	84.530	7091.55	1263.70	1984.57	843.04	40°28'12.141"N	104°45'51.426"W	10.40	
7624.00	68.840	88.260	7130.13	1342.72	1989.50	922.98	40°28'12.190"N	104°45'50.392"W	10.90	
7714.00	75.940	87.390	7157.34	1426.97	1992.77	1008.64	40°28'12.222"N	104°45'49.283"W	7.94	
7803.00	84.610	84.890	7172.36	1513.52	1998.69	1096.07	40°28'12.281"N	104°45'48.152"W	10.13	
7845.00†	86.738	84.708	7175.53	1555.02	2002.49	1137.78	40°28'12.318"N	104°45'47.613"W	5.09	LANDING POINT (1249'FSL & 2533'FEL, SEC.22)
7893.00	89.170	84.500	7177.24	1602.58	2007.00	1185.53	40°28'12.363"N	104°45'46.995"W	5.09	



Actual Wellpath Report

TROUDT 41C-23-M AWP

Page 5 of 9



REFERENCE WELLPATH IDENTIFICATION			
Operator	SRC ENERGY	Slot	SLOT#07 TROUDT 41C-23-M (760'FNL & 1684'FWL, SEC.27)
Area	COLORADO	Well	TROUDT 41C-23-M
Field	WELD COUNTY (NAD83,TRUE NORTH)	Wellbore	TROUDT 41C-23-M AWB
Facility	SEC.27-T06N-R66W		

WELLPATH DATA (167 stations)													
MD [ft]	Inclination [°]		Azimuth [°]		TVD [ft]	Vert Sect [ft]		North [ft]	East [ft]	Latitude	Longitude	DLS [°/100ft]	Comments
7982.00	89.110	85.130	7178.58	1690.78	2015.04	1274.15	2015.04	1274.15	40°28'12.442"N	104°45'45.848"W	0.71		
8072.00	89.230	86.540	7179.88	1779.73	2021.58	1363.91	2021.58	1363.91	40°28'12.507"N	104°45'44.687"W	1.57		
8162.00	89.050	88.580	7181.23	1868.23	2025.41	1453.81	2025.41	1453.81	40°28'12.545"N	104°45'43.523"W	2.28		
8251.00	88.890	90.620	7182.83	1955.11	2026.03	1542.79	2026.03	1542.79	40°28'12.551"N	104°45'42.372"W	2.30		
8340.00	88.830	91.740	7184.60	2041.43	2024.20	1631.75	2024.20	1631.75	40°28'12.533"N	104°45'41.221"W	1.26		
8430.00	88.950	90.810	7186.35	2128.69	2022.20	1721.71	2022.20	1721.71	40°28'12.513"N	104°45'40.057"W	1.04		
8519.00	90.090	90.350	7187.09	2215.25	2021.29	1810.70	2021.29	1810.70	40°28'12.504"N	104°45'38.906"W	1.38		
8609.00	90.220	90.630	7186.85	2302.81	2020.53	1900.70	2020.53	1900.70	40°28'12.496"N	104°45'37.741"W	0.34		
8698.00	90.310	92.400	7186.44	2389.02	2018.17	1989.66	2018.17	1989.66	40°28'12.473"N	104°45'36.590"W	1.99		
8788.00	90.400	92.910	7185.88	2475.74	2014.00	2079.56	2014.00	2079.56	40°28'12.432"N	104°45'35.427"W	0.58		
8878.00	90.460	92.590	7185.20	2562.42	2009.69	2169.46	2009.69	2169.46	40°28'12.389"N	104°45'34.264"W	0.36		
8967.00	90.280	91.990	7184.63	2648.32	2006.13	2258.38	2006.13	2258.38	40°28'12.354"N	104°45'33.113"W	0.70		
9057.00	90.400	92.650	7184.10	2735.18	2002.49	2348.31	2002.49	2348.31	40°28'12.318"N	104°45'31.950"W	0.75		
9146.00	90.310	91.500	7183.54	2821.16	1999.26	2437.24	1999.26	2437.24	40°28'12.286"N	104°45'30.799"W	1.30		
9235.00	90.310	89.080	7183.06	2907.82	1998.81	2526.24	1998.81	2526.24	40°28'12.281"N	104°45'29.648"W	2.72		
9325.00	88.650	89.080	7183.88	2995.87	2000.26	2616.22	2000.26	2616.22	40°28'12.295"N	104°45'28.483"W	1.84		
9414.00	88.240	90.990	7186.29	3082.59	2000.20	2705.18	2000.20	2705.18	40°28'12.295"N	104°45'27.332"W	2.19		
9504.00	89.850	94.340	7187.79	3169.27	1996.02	2795.05	1996.02	2795.05	40°28'12.253"N	104°45'26.169"W	4.13		
9593.00	89.970	94.600	7187.93	3254.23	1989.08	2883.78	1989.08	2883.78	40°28'12.185"N	104°45'25.021"W	0.32		
9682.00	91.230	92.740	7187.00	3339.54	1983.39	2972.59	1983.39	2972.59	40°28'12.128"N	104°45'23.872"W	2.52		
9772.00	91.420	90.930	7184.92	3426.57	1980.51	3062.52	1980.51	3062.52	40°28'12.100"N	104°45'22.709"W	2.02		
9861.00	92.160	89.460	7182.14	3513.22	1980.20	3151.47	1980.20	3151.47	40°28'12.096"N	104°45'21.558"W	1.85		
9951.00	91.910	89.170	7178.95	3601.14	1981.28	3241.41	1981.28	3241.41	40°28'12.107"N	104°45'20.394"W	0.43		
10040.00	91.970	89.340	7175.93	3688.11	1982.44	3330.35	1982.44	3330.35	40°28'12.118"N	104°45'19.243"W	0.20		
10130.00	90.280	88.540	7174.17	3776.18	1984.10	3420.31	1984.10	3420.31	40°28'12.135"N	104°45'18.079"W	2.08		
10219.00	90.280	86.770	7173.73	3863.68	1987.74	3509.23	1987.74	3509.23	40°28'12.170"N	104°45'16.929"W	1.99		
10308.00	90.370	87.420	7173.23	3951.34	1992.25	3598.12	1992.25	3598.12	40°28'12.215"N	104°45'15.779"W	0.74		
10398.00	90.250	87.790	7172.74	4039.84	1996.01	3688.04	1996.01	3688.04	40°28'12.252"N	104°45'14.615"W	0.43		
10487.00	90.280	86.720	7172.33	4127.46	2000.27	3776.93	2000.27	3776.93	40°28'12.294"N	104°45'13.465"W	1.20		
10577.00	90.090	87.930	7172.04	4216.03	2004.48	3866.83	2004.48	3866.83	40°28'12.335"N	104°45'12.302"W	1.36		



Actual Wellpath Report

TROUDT 41C-23-M AWP

Page 6 of 9



REFERENCE WELLPATH IDENTIFICATION			
Operator	SRC ENERGY	Slot	SLOT#07 TROUDT 41C-23-M (760'FNL & 1684'FWL, SEC.27)
Area	COLORADO	Well	TROUDT 41C-23-M
Field	WELD COUNTY (NAD83,TRUE NORTH)	Wellbore	TROUDT 41C-23-M AWB
Facility	SEC.27-T06N-R66W		

WELLPATH DATA (167 stations)										
MD [ft]	Inclination [°]	Azimuth [°]	TVD [ft]	Vert Sect [ft]	North [ft]	East [ft]	Latitude	Longitude	DLS [°/100ft]	Comments
10666.00	90.490	91.810	7171.59	4302.83	2004.68	3955.81	40°28'12.337"N	104°45'11.151"W	4.38	
10756.00	90.430	92.530	7170.86	4389.74	2001.27	4045.74	40°28'12.303"N	104°45'09.987"W	0.80	
10845.00	90.890	90.180	7169.84	4476.01	1999.16	4134.71	40°28'12.282"N	104°45'08.836"W	2.69	
10934.00	89.380	90.660	7169.63	4562.62	1998.51	4223.70	40°28'12.276"N	104°45'07.684"W	1.78	
11024.00	89.290	93.870	7170.67	4649.49	1994.96	4313.61	40°28'12.240"N	104°45'06.521"W	3.57	
11113.00	89.880	97.910	7171.32	4733.74	1985.83	4402.12	40°28'12.150"N	104°45'05.376"W	4.59	
11203.00	91.970	98.110	7169.87	4817.82	1973.29	4491.23	40°28'12.026"N	104°45'04.223"W	2.33	
11292.00	91.720	93.490	7167.00	4902.07	1964.30	4579.70	40°28'11.937"N	104°45'03.078"W	5.20	
11382.00	91.720	90.120	7164.30	4989.09	1961.47	4669.60	40°28'11.909"N	104°45'01.915"W	3.74	
11471.00	90.000	85.930	7162.96	5076.45	1964.53	4758.52	40°28'11.939"N	104°45'00.765"W	5.09	
11561.00	90.490	83.970	7162.57	5165.61	1972.46	4848.16	40°28'12.017"N	104°44'59.605"W	2.24	
11650.00	90.520	84.960	7161.79	5253.88	1981.04	4936.74	40°28'12.102"N	104°44'58.459"W	1.11	
11740.00	90.650	88.340	7160.87	5342.62	1986.30	5026.57	40°28'12.154"N	104°44'57.296"W	3.76	
11829.00	90.580	93.780	7159.92	5428.97	1984.65	5115.52	40°28'12.137"N	104°44'56.145"W	6.11	
11918.00	90.550	93.460	7159.04	5514.31	1979.03	5204.34	40°28'12.081"N	104°44'54.996"W	0.36	
12008.00	89.630	90.990	7158.90	5601.20	1975.54	5294.26	40°28'12.047"N	104°44'53.833"W	2.93	
12097.00	89.380	96.450	7159.67	5686.46	1969.77	5383.04	40°28'11.989"N	104°44'52.684"W	6.14	
12186.00	88.460	97.190	7161.34	5770.25	1959.20	5471.39	40°28'11.885"N	104°44'51.541"W	1.33	
12276.00	87.510	91.860	7164.51	5856.05	1952.11	5561.02	40°28'11.815"N	104°44'50.381"W	6.01	
12365.00	89.350	87.950	7166.95	5942.79	1952.25	5649.96	40°28'11.816"N	104°44'49.230"W	4.85	
12455.00	88.250	86.860	7168.83	6031.33	1956.33	5739.85	40°28'11.856"N	104°44'48.067"W	1.72	
12544.00	91.200	87.290	7169.26	6118.98	1960.87	5828.72	40°28'11.901"N	104°44'46.917"W	3.35	
12634.00	91.450	88.830	7167.18	6207.33	1963.92	5918.64	40°28'11.930"N	104°44'45.754"W	1.73	
12813.00	91.230	91.940	7162.99	6381.49	1962.71	6097.57	40°28'11.918"N	104°44'43.439"W	1.74	
12902.00	91.390	92.850	7160.96	6467.33	1958.99	6186.47	40°28'11.881"N	104°44'42.289"W	1.04	
13082.00	91.320	90.430	7156.70	6641.54	1953.84	6366.33	40°28'11.830"N	104°44'39.962"W	1.34	
13172.00	91.970	91.690	7154.12	6728.85	1952.18	6456.28	40°28'11.813"N	104°44'38.798"W	1.57	
13261.00	91.630	92.360	7151.32	6814.82	1949.04	6545.17	40°28'11.782"N	104°44'37.648"W	0.84	
13351.00	91.790	92.070	7148.64	6901.68	1945.56	6635.07	40°28'11.747"N	104°44'36.484"W	0.37	
13440.00	91.600	90.170	7146.00	6988.01	1943.82	6724.01	40°28'11.730"N	104°44'35.334"W	2.14	



Actual Wellpath Report

TROUDT 41C-23-M AWP

Page 7 of 9



REFERENCE WELLPATH IDENTIFICATION			
Operator	SRC ENERGY	Slot	SLOT#07 TROUDT 41C-23-M (760'FNL & 1684'FWL, SEC.27)
Area	COLORADO	Well	TROUDT 41C-23-M
Field	WELD COUNTY (NAD83,TRUE NORTH)	Wellbore	TROUDT 41C-23-M AWP
Facility	SEC.27-T06N-R66W		

WELLPATH DATA (167 stations)										
MD [ft]	Inclination [°]	Azimuth [°]	TVD [ft]	Vert Sect [ft]	North [ft]	East [ft]	Latitude	Longitude	DLS [°/100ft]	Comments
13530.00	90.650	89.860	7144.24	7075.72	1943.80	6813.99	40°28'11.729"N	104°44'34.169"W	1.11	
13619.00	90.860	90.450	7143.06	7162.43	1943.56	6902.98	40°28'11.727"N	104°44'33.018"W	0.70	
13798.00	90.800	89.250	7140.47	7337.02	1944.03	7081.96	40°28'11.731"N	104°44'30.702"W	0.67	
13888.00	90.490	88.140	7139.46	7425.19	1946.08	7171.93	40°28'11.751"N	104°44'29.538"W	1.28	
13978.00	90.310	87.660	7138.83	7513.60	1949.37	7261.86	40°28'11.783"N	104°44'28.374"W	0.57	
14067.00	90.280	87.210	7138.37	7601.17	1953.36	7350.77	40°28'11.822"N	104°44'27.224"W	0.51	
14157.00	90.370	87.020	7137.86	7689.80	1957.89	7440.66	40°28'11.867"N	104°44'26.061"W	0.23	
14246.00	90.150	89.560	7137.46	7777.11	1960.54	7529.61	40°28'11.893"N	104°44'24.910"W	2.86	
14335.00	90.180	94.310	7137.20	7863.14	1957.54	7618.53	40°28'11.863"N	104°44'23.760"W	5.34	
14514.00	90.550	88.290	7136.06	8036.61	1953.48	7797.40	40°28'11.822"N	104°44'21.445"W	3.37	
14604.00	89.380	89.460	7136.11	8124.73	1955.25	7887.38	40°28'11.839"N	104°44'20.281"W	1.84	
14693.00	89.290	89.180	7137.15	8211.72	1956.30	7976.37	40°28'11.849"N	104°44'19.130"W	0.33	
14872.00	89.230	90.470	7139.46	8386.33	1956.85	8155.35	40°28'11.854"N	104°44'16.814"W	0.72	
14961.00	90.740	91.160	7139.48	8472.80	1955.58	8244.34	40°28'11.842"N	104°44'15.662"W	1.87	
15051.00	90.860	92.330	7138.22	8559.88	1952.84	8334.28	40°28'11.814"N	104°44'14.499"W	1.31	
15230.00	90.590	96.810	7135.96	8730.60	1938.58	8512.66	40°28'11.673"N	104°44'12.191"W	2.51	LAST BHI SURVEY (121'FSL & 500'FEL, SEC.23)
15292.00	90.590	96.810	7135.32	8788.98	1931.23	8574.22	40°28'11.600"N	104°44'11.394"W	0.00	PROJ TO BIT (1204'FSL & 438'FEL, SEC.23)

HOLE & CASING SECTIONS - Ref Wellbore: TROUDT 41C-23-M AWP Ref Wellpath: TROUDT 41C-23-M AWP									
String/Diameter	Start MD [ft]	End MD [ft]	Interval [ft]	Start TVD [ft]	End TVD [ft]	Start N/S [ft]	Start E/W [ft]	End N/S [ft]	End E/W [ft]
9.625in Casing Surface	25.00	1855.00	1830.00	25.00	1807.31	0.00	0.00	349.92	99.64



Actual Wellpath Report

TROUDT 41C-23-M AWP

Page 8 of 9



REFERENCE WELLPATH IDENTIFICATION			
Operator	SRC ENERGY	Slot	SLOT#07 TROUDT 41C-23-M (760'FNL & 1684'FWL, SEC.27)
Area	COLORADO	Well	TROUDT 41C-23-M
Field	WELD COUNTY (NAD83,TRUE NORTH)	Wellbore	TROUDT 41C-23-M AWB
Facility	SEC.27-T06N-R66W		

TARGETS								
Name	TVD [ft]	North [ft]	East [ft]	Grid East [US ft]	Grid North [US ft]	Latitude	Longitude	Shape
SEC.23-T06N-R66W	-8.00	4231.31	-1957.19	3201871.60	1417148.27	40°28'34.342"N	104°46'27.660"W	polygon
SEC.22-T06N-R66W	6.00	1412.75	-8099.02	3195753.51	1414279.17	40°28'06.478"N	104°47'47.123"W	polygon
SEC.27-T06N-R66W	19.00	-4766.34	985.52	3204888.45	1408175.58	40°27'05.432"N	104°45'49.586"W	polygon
TROUDT 41C-23-M BHL ON PLAT (1214'FSL & 510'FEL, SEC.23)	7135.00	1941.47	8501.99	3212348.95	1414945.01	40°28'11.701"N	104°44'12.329"W	circle
TROUDT 41C-23-M TOP OF PROD ON PLAT (1208'FSL & 2524'FEL, SEC.22)	7171.00	1961.53	1150.22	3204997.54	1414904.32	40°28'11.914"N	104°45'47.452"W	circle

WELLPATH COMPOSITION - Ref Wellbore: TROUDT 41C-23-M AWB Ref Wellpath: TROUDT 41C-23-M AWP				
Start MD [ft]	End MD [ft]	Positional Uncertainty Model	Log Name/Comment	Wellbore
25.00	1805.00	BHI NaviTrak (Standard)	13 1/2" SURFACE SURVEYS <88-1784>	TROUDT 41C-23-M AWB
1805.00	15230.00	BHI AutoTrak Curve (MagCAD+IFR1, Short spacing)	8 1/2" ATC MONOBORE SURVEYS <1900-15230>	TROUDT 41C-23-M AWB
15230.00	15292.00	Blind Drilling (std)	Projection to bit	TROUDT 41C-23-M AWB



Actual Wellpath Report

TROUDT 41C-23-M AWP

Page 9 of 9



REFERENCE WELLPATH IDENTIFICATION			
Operator	SRC ENERGY	Slot	SLOT#07 TROUDT 41C-23-M (760'FNL & 1684'FWL, SEC.27)
Area	COLORADO	Well	TROUDT 41C-23-M
Field	WELD COUNTY (NAD83,TRUE NORTH)	Wellbore	TROUDT 41C-23-M AWP
Facility	SEC.27-T06N-R66W		

WELLPATH COMMENTS				
MD [ft]	Inclination [°]	Azimuth [°]	TVD [ft]	Comment
7845.00	86.738	84.708	7175.53	LANDING POINT (1249'FSL & 2533'FEL, SEC.22)
15230.00	90.590	96.810	7135.96	LAST BHI SURVEY (1211'FSL & 500'FEL, SEC.23)
15292.00	90.590	96.810	7135.32	PROJ TO BIT (1204'FSL & 438'FEL, SEC.23)