

SRC ENERGY

Location: COLORADO Slot: SLOT#05 TROUDT 1C-23-M (760'FNL & 1654'FWL, SEC.27)
 Field: WELD COUNTY (NAD83, TRUE NORTH) Well: TROUDT 1C-23-M
 Facility: SEC.27-T06N-R66W Wellbore: TROUDT 1C-23-M PWB

Plot reference wellpath is TROUDT 1C-23-M (REV-C.0) PWB	Grid System: NAD83 / Lambert Colorado SP, Northern Zone (501), US feet
True vertical depths are referenced to PD 562 (25) (RKB)	North Reference: True north
Measured depths are referenced to PD 562 (25) (RKB)	Scale: True distance
PD 562 (25) (RKB) to Mean Sea Level: 4744 feet	Depths are in feet
Mean Sea Level to Mud line (At Slot: SLOT#05 TROUDT 1C-23-M (760'FNL & 1654'FWL, SEC.27)): 0 feet	Created by: robale01 on 2018-10-25
Coordinates are in feet referenced to Slot	Database: WA DENVER

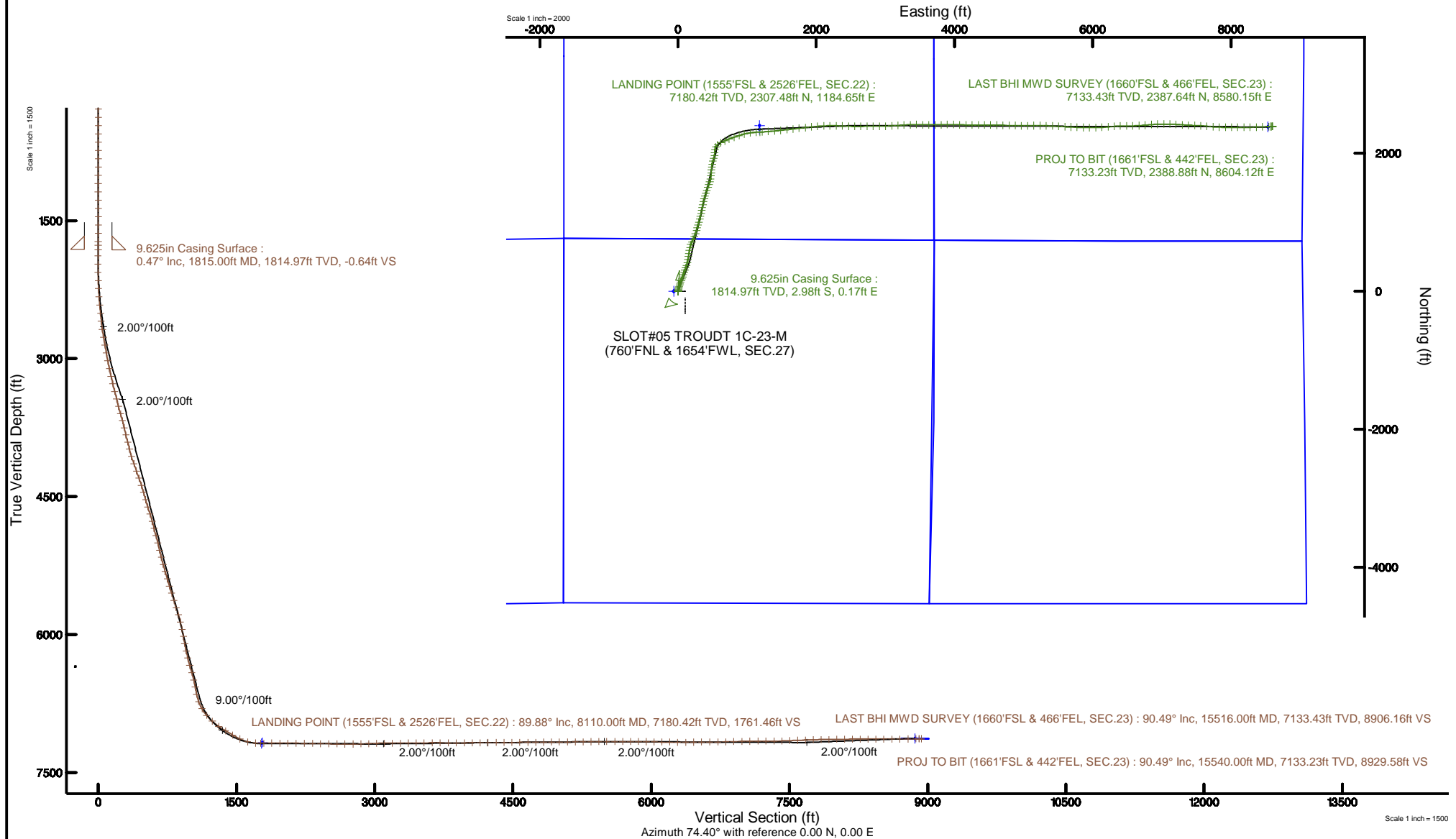



Actual Wellpath Report

TROUDT 1C-23-M AWP

Page 1 of 10



REFERENCE WELLPATH IDENTIFICATION

Operator	SRC ENERGY	Slot	SLOT#05 TROUDT 1C-23-M (760'FNL & 1654'FWL, SEC.27)
Area	COLORADO	Well	TROUDT 1C-23-M
Field	WELD COUNTY (NAD83,TRUE NORTH)	Wellbore	TROUDT 1C-23-M AWB
Facility	SEC.27-T06N-R66W		

REPORT SETUP INFORMATION

Projection System	NAD83 / Lambert Colorado SP, Northern Zone (501), US feet	Software System	WellArchitect® 5.1
North Reference	True	User	Hanisab
Scale	0.999964	Report Generated	10/29/2018 at 10:46:32 PM
Convergence at slot	0.47° East	Database/Source file	WA DENVER/TROUDT_1C-23-M_AWP.xml

WELLPATH LOCATION

	Local coordinates		Grid coordinates		Geographic coordinates	
	North[ft]	East[ft]	Easting[US ft]	Northing[US ft]	Latitude	Longitude
Slot Location	-0.02	59.81	3203833.55	1412933.18	40°27'52.531"N	104°46'02.723"W
Facility Reference Pt			3203773.74	1412932.71	40°27'52.531"N	104°46'03.497"W
Field Reference Pt			3171284.48	1426358.81	40°30'07.643"N	104°53'02.634"W

WELLPATH DATUM

Calculation method	Minimum curvature	PD 562 (25') (RKB) to Facility Vertical Datum	4744.00ft
Horizontal Reference Pt	Slot	PD 562 (25') (RKB) to Mean Sea Level	4744.00ft
Vertical Reference Pt	PD 562 (25') (RKB)	PD 562 (25') (RKB) to Mud Line at Slot (SLOT#05 TROUDT 1C-23-M (760'FNL & 1654'FWL, SEC.27))	4744.00ft
MD Reference Pt	PD 562 (25') (RKB)	Section Origin	N 0.00, E 0.00 ft
Field Vertical Reference	Mean Sea Level	Section Azimuth	74.40°



Actual Wellpath Report

TROUDT 1C-23-M AWP

Page 2 of 10



REFERENCE WELLPATH IDENTIFICATION

Operator	SRC ENERGY	Slot	SLOT#05 TROUDT 1C-23-M (760'FNL & 1654'FWL, SEC.27)
Area	COLORADO	Well	TROUDT 1C-23-M
Field	WELD COUNTY (NAD83,TRUE NORTH)	Wellbore	TROUDT 1C-23-M AWP
Facility	SEC.27-T06N-R66W		

WELLPATH DATA (178 stations) † = interpolated/extrapolated station

MD [ft]	Inclination [°]	Azimuth [°]	TVD [ft]	Vert Sect [ft]	North [ft]	East [ft]	Latitude	Longitude	DLS [°/100ft]	Comments
0.00†	0.000	69.700	0.00	0.00	0.00	0.00	40°27'52.531"N	104°46'02.723"W	0.00	
25.00	0.000	69.700	25.00	0.00	0.00	0.00	40°27'52.531"N	104°46'02.723"W	0.00	
109.00	0.480	69.700	109.00	0.35	0.12	0.33	40°27'52.532"N	104°46'02.719"W	0.57	
197.00	0.380	52.060	197.00	0.99	0.43	0.91	40°27'52.535"N	104°46'02.711"W	0.19	
287.00	0.330	14.650	286.99	1.39	0.86	1.21	40°27'52.540"N	104°46'02.707"W	0.26	
377.00	0.240	206.450	376.99	1.40	0.95	1.19	40°27'52.540"N	104°46'02.708"W	0.63	
467.00	0.130	186.850	466.99	1.23	0.68	1.09	40°27'52.538"N	104°46'02.709"W	0.14	
557.00	0.240	211.980	556.99	1.06	0.41	0.98	40°27'52.535"N	104°46'02.710"W	0.15	
647.00	0.360	231.640	646.99	0.66	0.08	0.66	40°27'52.532"N	104°46'02.714"W	0.17	
737.00	0.300	254.870	736.99	0.16	-0.16	0.21	40°27'52.529"N	104°46'02.720"W	0.16	
827.00	0.240	184.290	826.99	-0.14	-0.41	-0.03	40°27'52.527"N	104°46'02.723"W	0.35	
917.00	0.060	179.300	916.99	-0.22	-0.64	-0.05	40°27'52.525"N	104°46'02.724"W	0.20	
1007.00	0.200	227.030	1006.99	-0.37	-0.80	-0.16	40°27'52.523"N	104°46'02.725"W	0.18	
1097.00	0.690	202.520	1096.99	-0.84	-1.40	-0.48	40°27'52.517"N	104°46'02.729"W	0.57	
1187.00	1.130	131.840	1186.98	-0.70	-2.50	-0.03	40°27'52.506"N	104°46'02.723"W	1.24	
1277.00	0.060	53.360	1276.97	-0.18	-3.06	0.67	40°27'52.501"N	104°46'02.714"W	1.24	
1367.00	0.060	140.370	1366.97	-0.11	-3.07	0.74	40°27'52.501"N	104°46'02.713"W	0.09	
1457.00	0.060	212.850	1456.97	-0.13	-3.15	0.74	40°27'52.500"N	104°46'02.713"W	0.08	
1547.00	0.100	149.350	1546.97	-0.15	-3.25	0.76	40°27'52.499"N	104°46'02.713"W	0.10	
1637.00	0.160	280.180	1636.97	-0.24	-3.30	0.67	40°27'52.498"N	104°46'02.714"W	0.26	
1727.00	0.060	308.290	1726.97	-0.38	-3.25	0.51	40°27'52.499"N	104°46'02.716"W	0.12	
1765.00	0.270	306.980	1764.97	-0.45	-3.18	0.43	40°27'52.500"N	104°46'02.717"W	0.55	
1883.00	0.740	309.900	1882.97	-1.05	-2.52	-0.38	40°27'52.506"N	104°46'02.728"W	0.40	
1973.00	0.070	111.270	1972.96	-1.33	-2.17	-0.78	40°27'52.510"N	104°46'02.733"W	0.90	
2062.00	0.940	9.640	2061.96	-0.98	-1.47	-0.60	40°27'52.516"N	104°46'02.731"W	1.07	
2151.00	3.600	6.170	2150.88	0.37	2.03	-0.18	40°27'52.551"N	104°46'02.725"W	2.99	
2240.00	6.200	10.520	2239.55	3.52	9.53	1.00	40°27'52.625"N	104°46'02.710"W	2.95	
2330.00	8.640	13.830	2328.79	8.99	20.88	3.50	40°27'52.737"N	104°46'02.678"W	2.75	
2419.00	10.130	16.020	2416.60	16.37	34.89	7.26	40°27'52.876"N	104°46'02.629"W	1.72	
2509.00	10.940	14.950	2505.08	24.86	50.75	11.65	40°27'53.032"N	104°46'02.572"W	0.93	



Actual Wellpath Report

TROUDT 1C-23-M AWP

Page 3 of 10



REFERENCE WELLPATH IDENTIFICATION

Operator	SRC ENERGY	Slot	SLOT#05 TROUDT 1C-23-M (760'FNL & 1654'FWL, SEC.27)
Area	COLORADO	Well	TROUDT 1C-23-M
Field	WELD COUNTY (NAD83,TRUE NORTH)	Wellbore	TROUDT 1C-23-M AWP
Facility	SEC.27-T06N-R66W		

WELLPATH DATA (178 stations)

MD [ft]	Inclination [°]	Azimuth [°]	TVD [ft]	Vert Sect [ft]	North [ft]	East [ft]	Latitude	Longitude	DLS [°/100ft]	Comments
2598.00	11.910	14.900	2592.31	33.82	67.78	16.19	40°27'53.201"N	104°46'02.514"W	1.09	
2688.00	13.460	18.440	2680.12	44.39	86.70	21.89	40°27'53.388"N	104°46'02.440"W	1.93	
2777.00	16.200	22.510	2766.15	57.86	108.00	29.92	40°27'53.598"N	104°46'02.336"W	3.29	
2867.00	15.690	20.320	2852.68	72.74	131.01	38.95	40°27'53.826"N	104°46'02.219"W	0.88	
2956.00	17.220	21.610	2938.04	87.77	154.54	47.98	40°27'54.058"N	104°46'02.102"W	1.77	
3046.00	18.710	19.720	3023.65	104.17	180.52	57.76	40°27'54.315"N	104°46'01.976"W	1.78	
3135.00	21.170	17.660	3107.30	121.24	209.27	67.46	40°27'54.599"N	104°46'01.850"W	2.87	
3225.00	21.810	18.010	3191.05	139.41	240.66	77.55	40°27'54.909"N	104°46'01.720"W	0.73	
3314.00	22.630	19.110	3273.44	158.31	272.56	88.27	40°27'55.224"N	104°46'01.581"W	1.03	
3404.00	23.800	19.500	3356.15	178.61	306.04	100.00	40°27'55.555"N	104°46'01.429"W	1.31	
3493.00	23.950	19.590	3437.53	199.34	339.99	112.05	40°27'55.891"N	104°46'01.273"W	0.17	
3583.00	25.550	18.190	3519.26	220.66	375.64	124.24	40°27'56.243"N	104°46'01.116"W	1.89	
3672.00	28.380	13.350	3598.59	241.58	414.47	135.12	40°27'56.627"N	104°46'00.975"W	4.02	
3761.00	33.560	8.840	3674.89	262.01	459.39	143.79	40°27'57.070"N	104°46'00.863"W	6.37	
3851.00	29.770	9.110	3751.48	281.65	506.05	151.15	40°27'57.532"N	104°46'00.767"W	4.21	
3940.00	29.540	9.620	3828.82	300.23	549.50	158.32	40°27'57.961"N	104°46'00.675"W	0.38	
4030.00	29.670	10.520	3907.07	319.49	593.27	166.09	40°27'58.393"N	104°46'00.574"W	0.51	
4119.00	28.860	11.900	3984.71	339.11	635.95	174.54	40°27'58.815"N	104°46'00.465"W	1.18	
4209.00	27.920	18.520	4063.90	360.96	677.19	185.72	40°27'59.223"N	104°46'00.320"W	3.65	
4298.00	28.750	25.460	4142.26	386.71	716.29	201.54	40°27'59.609"N	104°46'00.115"W	3.81	
4388.00	28.840	24.410	4221.13	414.88	755.60	219.82	40°27'59.997"N	104°45'59.879"W	0.57	
4477.00	28.720	23.280	4299.14	442.11	794.79	237.14	40°28'00.385"N	104°45'59.655"W	0.63	
4566.00	29.560	20.820	4376.88	468.56	834.95	253.39	40°28'00.782"N	104°45'59.445"W	1.64	
4656.00	29.350	16.070	4455.26	493.32	876.90	267.39	40°28'01.196"N	104°45'59.263"W	2.61	
4745.00	29.260	14.210	4532.87	515.59	918.95	278.77	40°28'01.612"N	104°45'59.116"W	1.03	
4835.00	29.180	16.110	4611.42	538.05	961.35	290.26	40°28'02.031"N	104°45'58.968"W	1.03	
4924.00	28.970	17.640	4689.20	561.27	1002.73	302.81	40°28'02.440"N	104°45'58.805"W	0.87	
5014.00	29.040	15.140	4767.92	584.38	1044.59	315.12	40°28'02.853"N	104°45'58.646"W	1.35	
5103.00	28.920	13.250	4845.78	605.81	1086.39	325.69	40°28'03.266"N	104°45'58.509"W	1.04	
5193.00	29.180	11.880	4924.45	626.43	1129.04	335.20	40°28'03.688"N	104°45'58.386"W	0.79	



Actual Wellpath Report

TROUDT 1C-23-M AWP

Page 4 of 10



REFERENCE WELLPATH IDENTIFICATION

Operator	SRC ENERGY	Slot	SLOT#05 TROUDT 1C-23-M (760'FNL & 1654'FWL, SEC.27)
Area	COLORADO	Well	TROUDT 1C-23-M
Field	WELD COUNTY (NAD83,TRUE NORTH)	Wellbore	TROUDT 1C-23-M AWB
Facility	SEC.27-T06N-R66W		

WELLPATH DATA (178 stations)

MD [ft]	Inclination [°]	Azimuth [°]	TVD [ft]	Vert Sect [ft]	North [ft]	East [ft]	Latitude	Longitude	DLS [°/100ft]	Comments
5282.00	28.970	11.160	5002.24	646.14	1171.42	343.84	40°28'04.106"N	104°45'58.274"W	0.46	
5372.00	28.400	10.630	5081.19	665.41	1213.84	352.00	40°28'04.526"N	104°45'58.169"W	0.69	
5461.00	29.040	10.230	5159.24	684.18	1255.90	359.74	40°28'04.941"N	104°45'58.068"W	0.75	
5550.00	29.030	12.990	5237.06	703.92	1298.20	368.43	40°28'05.359"N	104°45'57.956"W	1.51	
5640.00	29.200	15.740	5315.69	725.79	1340.61	379.30	40°28'05.778"N	104°45'57.815"W	1.50	
5729.00	28.550	17.900	5393.63	748.82	1381.75	391.73	40°28'06.185"N	104°45'57.655"W	1.38	
5819.00	28.800	18.530	5472.59	772.85	1422.77	405.23	40°28'06.590"N	104°45'57.480"W	0.44	
5908.00	29.000	18.360	5550.51	796.93	1463.57	418.83	40°28'06.993"N	104°45'57.304"W	0.24	
5998.00	29.220	18.210	5629.14	821.34	1505.14	432.57	40°28'07.404"N	104°45'57.126"W	0.26	
6087.00	29.050	18.820	5706.88	845.64	1546.23	446.33	40°28'07.810"N	104°45'56.948"W	0.38	
6177.00	29.020	16.520	5785.57	869.60	1587.85	459.59	40°28'08.221"N	104°45'56.777"W	1.24	
6266.00	28.630	11.790	5863.56	890.89	1629.42	470.08	40°28'08.632"N	104°45'56.641"W	2.60	
6355.00	28.910	6.110	5941.58	908.66	1671.69	476.73	40°28'09.050"N	104°45'56.555"W	3.09	
6445.00	29.000	3.810	6020.34	923.95	1715.09	480.50	40°28'09.479"N	104°45'56.506"W	1.24	
6534.00	29.000	4.190	6098.18	938.42	1758.13	483.51	40°28'09.904"N	104°45'56.467"W	0.21	
6624.00	28.790	6.570	6176.98	953.99	1801.42	487.58	40°28'10.332"N	104°45'56.414"W	1.30	
6713.00	27.460	11.990	6255.48	971.58	1842.80	494.30	40°28'10.741"N	104°45'56.327"W	3.24	
6803.00	28.990	16.960	6334.79	992.93	1883.96	504.97	40°28'11.147"N	104°45'56.189"W	3.11	
6892.00	28.590	16.950	6412.78	1015.99	1924.96	517.47	40°28'11.552"N	104°45'56.028"W	0.45	
6982.00	28.900	9.720	6491.72	1036.89	1967.01	527.42	40°28'11.968"N	104°45'55.899"W	3.88	
7071.00	28.840	2.690	6569.68	1052.82	2009.66	532.06	40°28'12.389"N	104°45'55.839"W	3.81	
7160.00	28.340	5.640	6647.83	1067.21	2052.13	535.15	40°28'12.809"N	104°45'55.799"W	1.68	
7250.00	27.470	27.990	6727.58	1089.32	2091.82	547.02	40°28'13.201"N	104°45'55.645"W	11.60	
7339.00	31.850	52.210	6805.18	1125.36	2124.47	575.33	40°28'13.524"N	104°45'55.279"W	14.23	
7429.00	40.910	61.910	6877.63	1176.27	2152.98	620.22	40°28'13.806"N	104°45'54.698"W	11.90	
7518.00	48.400	65.740	6940.90	1237.72	2180.42	676.36	40°28'14.077"N	104°45'53.972"W	8.94	
7608.00	54.690	69.020	6996.86	1307.63	2207.43	741.40	40°28'14.344"N	104°45'53.130"W	7.55	
7697.00	58.990	71.140	7045.53	1381.90	2232.77	811.44	40°28'14.594"N	104°45'52.224"W	5.23	
7787.00	58.950	71.840	7091.92	1458.92	2257.26	884.57	40°28'14.836"N	104°45'51.278"W	0.67	
7876.00	64.680	75.500	7133.95	1537.31	2279.23	959.82	40°28'15.053"N	104°45'50.304"W	7.39	



Actual Wellpath Report

TROUDT 1C-23-M AWP

Page 5 of 10



REFERENCE WELLPATH IDENTIFICATION

Operator	SRC ENERGY	Slot	SLOT#05 TROUDT 1C-23-M (760'FNL & 1654'FWL, SEC.27)
Area	COLORADO	Well	TROUDT 1C-23-M
Field	WELD COUNTY (NAD83,TRUE NORTH)	Wellbore	TROUDT 1C-23-M AWP
Facility	SEC.27-T06N-R66W		

WELLPATH DATA (178 stations) † = interpolated/extrapolated station

MD [ft]	Inclination [°]	Azimuth [°]	TVD [ft]	Vert Sect [ft]	North [ft]	East [ft]	Latitude	Longitude	DLS [°/100ft]	Comments
7966.00	74.770	82.060	7165.13	1621.31	2295.47	1042.50	40°28'15.214"N	104°45'49.234"W	13.12	
8055.00	87.230	86.470	7179.03	1707.71	2304.18	1129.77	40°28'15.300"N	104°45'48.105"W	14.83	
8110.00†	89.882	86.653	7180.42	1761.46	2307.48	1184.65	40°28'15.332"N	104°45'47.395"W	4.83	LANDING POINT (1555'FSL & 2526'FEL, SEC.22)
8145.00	91.570	86.770	7179.98	1795.65	2309.48	1219.59	40°28'15.352"N	104°45'46.943"W	4.83	
8234.00	89.660	85.410	7179.02	1882.79	2315.55	1308.37	40°28'15.412"N	104°45'45.794"W	2.63	
8324.00	89.540	84.580	7179.65	1971.26	2323.40	1398.03	40°28'15.489"N	104°45'44.634"W	0.93	
8413.00	89.450	84.150	7180.43	2058.91	2332.14	1486.59	40°28'15.576"N	104°45'43.488"W	0.49	
8503.00	89.380	83.700	7181.35	2147.66	2341.67	1576.08	40°28'15.670"N	104°45'42.330"W	0.51	
8592.00	89.380	83.430	7182.31	2235.52	2351.64	1664.52	40°28'15.768"N	104°45'41.186"W	0.30	
8682.00	88.980	83.690	7183.60	2324.37	2361.74	1753.94	40°28'15.868"N	104°45'40.029"W	0.53	
8772.00	89.350	83.530	7184.91	2413.20	2371.75	1843.37	40°28'15.967"N	104°45'38.872"W	0.45	
8861.00	88.580	83.760	7186.52	2501.03	2381.60	1931.81	40°28'16.064"N	104°45'37.727"W	0.90	
8950.00	88.860	85.210	7188.51	2588.63	2390.15	2020.37	40°28'16.149"N	104°45'36.581"W	1.66	
9040.00	90.030	87.340	7189.38	2676.69	2396.00	2110.17	40°28'16.206"N	104°45'35.419"W	2.70	
9129.00	90.090	88.970	7189.29	2763.14	2398.86	2199.12	40°28'16.234"N	104°45'34.269"W	1.83	
9219.00	91.200	91.890	7188.28	2849.62	2398.19	2289.10	40°28'16.228"N	104°45'33.104"W	3.47	
9308.00	92.190	92.680	7185.64	2934.29	2394.64	2377.99	40°28'16.193"N	104°45'31.954"W	1.42	
9397.00	92.400	91.430	7182.08	3019.02	2391.45	2466.86	40°28'16.161"N	104°45'30.804"W	1.42	
9487.00	90.120	90.660	7180.10	3105.23	2389.81	2556.82	40°28'16.145"N	104°45'29.640"W	2.67	
9576.00	90.030	88.950	7179.98	3191.03	2390.11	2645.81	40°28'16.148"N	104°45'28.489"W	1.92	
9666.00	90.430	89.770	7179.62	3277.98	2391.12	2735.81	40°28'16.157"N	104°45'27.324"W	1.01	
9755.00	90.430	89.360	7178.95	3363.88	2391.80	2824.80	40°28'16.164"N	104°45'26.173"W	0.46	
9844.00	90.620	90.130	7178.14	3449.70	2392.19	2913.80	40°28'16.168"N	104°45'25.021"W	0.89	
9934.00	90.520	88.010	7177.24	3536.76	2393.65	3003.77	40°28'16.182"N	104°45'23.857"W	2.36	
10023.00	90.220	87.030	7176.67	3623.43	2397.50	3092.69	40°28'16.220"N	104°45'22.707"W	1.15	
10113.00	89.720	86.120	7176.72	3711.41	2402.88	3182.53	40°28'16.273"N	104°45'21.544"W	1.15	
10202.00	89.880	86.310	7177.03	3798.52	2408.76	3271.33	40°28'16.331"N	104°45'20.395"W	0.28	
10292.00	90.030	87.560	7177.10	3886.38	2413.57	3361.20	40°28'16.378"N	104°45'19.232"W	1.40	
10381.00	90.370	90.290	7176.79	3972.52	2415.24	3450.18	40°28'16.395"N	104°45'18.081"W	3.09	
10471.00	90.580	92.350	7176.04	4058.62	2413.16	3540.14	40°28'16.374"N	104°45'16.917"W	2.30	



Actual Wellpath Report

TROUDT 1C-23-M AWP

Page 6 of 10



REFERENCE WELLPATH IDENTIFICATION

Operator	SRC ENERGY	Slot	SLOT#05 TROUDT 1C-23-M (760'FNL & 1654'FWL, SEC.27)
Area	COLORADO	Well	TROUDT 1C-23-M
Field	WELD COUNTY (NAD83,TRUE NORTH)	Wellbore	TROUDT 1C-23-M AWB
Facility	SEC.27-T06N-R66W		

WELLPATH DATA (178 stations)

MD [ft]	Inclination [°]	Azimuth [°]	TVD [ft]	Vert Sect [ft]	North [ft]	East [ft]	Latitude	Longitude	DLS [°/100ft]	Comments
10560.00	90.920	90.430	7174.87	4143.73	2411.01	3629.11	40°28'16.353"N	104°45'15.766"W	2.19	
10650.00	90.150	89.370	7174.03	4230.45	2411.16	3719.10	40°28'16.354"N	104°45'14.602"W	1.46	
10739.00	90.090	88.210	7173.85	4316.66	2413.04	3808.08	40°28'16.373"N	104°45'13.450"W	1.31	
10828.00	90.740	88.850	7173.20	4402.96	2415.32	3897.05	40°28'16.395"N	104°45'12.299"W	1.02	
10918.00	90.250	90.520	7172.43	4489.77	2415.82	3987.04	40°28'16.400"N	104°45'11.135"W	1.93	
11007.00	90.620	92.680	7171.75	4574.78	2413.33	4075.99	40°28'16.375"N	104°45'09.984"W	2.46	
11097.00	90.520	91.450	7170.85	4660.54	2410.09	4165.93	40°28'16.343"N	104°45'08.820"W	1.37	
11186.00	90.430	90.470	7170.12	4745.84	2408.60	4254.91	40°28'16.328"N	104°45'07.669"W	1.11	
11276.00	90.400	89.170	7169.46	4832.60	2408.88	4344.91	40°28'16.331"N	104°45'06.504"W	1.44	
11365.00	90.400	88.920	7168.84	4918.71	2410.37	4433.89	40°28'16.345"N	104°45'05.353"W	0.28	
11454.00	90.520	90.960	7168.13	5004.45	2410.46	4522.89	40°28'16.346"N	104°45'04.201"W	2.30	
11544.00	90.370	92.450	7167.43	5090.37	2407.78	4612.84	40°28'16.319"N	104°45'03.037"W	1.66	
11633.00	90.890	91.690	7166.45	5175.17	2404.57	4701.78	40°28'16.287"N	104°45'01.887"W	1.03	
11722.00	90.980	90.920	7165.00	5260.31	2402.54	4790.74	40°28'16.267"N	104°45'00.736"W	0.87	
11812.00	90.400	90.610	7163.92	5346.66	2401.34	4880.73	40°28'16.255"N	104°44'59.571"W	0.73	
11901.00	90.680	91.150	7163.08	5432.00	2399.97	4969.71	40°28'16.241"N	104°44'58.420"W	0.68	
11991.00	90.150	88.930	7162.42	5518.66	2399.91	5059.70	40°28'16.241"N	104°44'57.255"W	2.54	
12080.00	90.030	89.610	7162.28	5604.68	2401.04	5148.69	40°28'16.252"N	104°44'56.104"W	0.78	
12170.00	89.880	90.390	7162.36	5691.36	2401.04	5238.69	40°28'16.251"N	104°44'54.940"W	0.88	
12259.00	89.780	92.220	7162.62	5776.51	2399.02	5327.67	40°28'16.231"N	104°44'53.788"W	2.06	
12348.00	89.320	92.750	7163.32	5861.12	2395.16	5416.58	40°28'16.193"N	104°44'52.638"W	0.79	
12438.00	89.110	93.420	7164.55	5946.36	2390.32	5506.44	40°28'16.145"N	104°44'51.475"W	0.78	
12528.00	89.380	93.310	7165.74	6031.47	2385.03	5596.28	40°28'16.092"N	104°44'50.313"W	0.32	
12617.00	88.980	92.440	7167.01	6115.88	2380.57	5685.16	40°28'16.048"N	104°44'49.163"W	1.08	
12706.00	88.920	91.920	7168.64	6200.61	2377.18	5774.08	40°28'16.015"N	104°44'48.012"W	0.59	
12797.00	89.820	91.740	7169.64	6287.43	2374.28	5865.02	40°28'15.986"N	104°44'46.836"W	1.01	
12887.00	90.120	90.700	7169.69	6373.58	2372.36	5955.00	40°28'15.966"N	104°44'45.671"W	1.20	
12976.00	90.490	88.990	7169.22	6459.36	2372.60	6044.00	40°28'15.969"N	104°44'44.520"W	1.97	
13066.00	90.430	86.880	7168.49	6546.86	2375.85	6133.93	40°28'16.000"N	104°44'43.356"W	2.35	
13155.00	90.430	84.630	7167.83	6634.11	2382.43	6222.68	40°28'16.065"N	104°44'42.208"W	2.53	



Actual Wellpath Report

TROUDT 1C-23-M AWP

Page 7 of 10



REFERENCE WELLPATH IDENTIFICATION

Operator	SRC ENERGY	Slot	SLOT#05 TROUDT 1C-23-M (760'FNL & 1654'FWL, SEC.27)
Area	COLORADO	Well	TROUDT 1C-23-M
Field	WELD COUNTY (NAD83,TRUE NORTH)	Wellbore	TROUDT 1C-23-M AWP
Facility	SEC.27-T06N-R66W		

WELLPATH DATA (178 stations)

MD [ft]	Inclination [°]	Azimuth [°]	TVD [ft]	Vert Sect [ft]	North [ft]	East [ft]	Latitude	Longitude	DLS [°/100ft]	Comments
13245.00	90.000	85.330	7167.49	6722.58	2390.31	6312.33	40°28'16.143"N	104°44'41.048"W	0.91	
13334.00	91.510	88.280	7166.31	6809.48	2395.27	6401.17	40°28'16.192"N	104°44'39.898"W	3.72	
13424.00	91.850	90.130	7163.68	6896.45	2396.52	6491.12	40°28'16.204"N	104°44'38.734"W	2.09	
13513.00	91.720	88.980	7160.90	6982.31	2397.21	6580.07	40°28'16.210"N	104°44'37.583"W	1.30	
13603.00	90.370	86.700	7159.26	7069.83	2400.60	6669.99	40°28'16.244"N	104°44'36.420"W	2.94	
13692.00	90.250	85.000	7158.78	7157.05	2407.04	6758.75	40°28'16.307"N	104°44'35.272"W	1.91	
13782.00	89.780	84.760	7158.76	7245.55	2415.07	6848.39	40°28'16.386"N	104°44'34.112"W	0.59	
13871.00	90.370	88.170	7158.64	7332.57	2420.56	6937.21	40°28'16.440"N	104°44'32.962"W	3.89	
13961.00	93.020	89.300	7155.98	7419.72	2422.54	7027.14	40°28'16.460"N	104°44'31.799"W	3.20	
14050.00	91.790	91.800	7152.24	7505.13	2421.69	7116.04	40°28'16.451"N	104°44'30.648"W	3.13	
14140.00	91.660	93.300	7149.53	7590.61	2417.69	7205.91	40°28'16.411"N	104°44'29.486"W	1.67	
14229.00	92.340	94.110	7146.43	7674.56	2411.94	7294.67	40°28'16.354"N	104°44'28.337"W	1.19	
14319.00	91.750	92.600	7143.22	7759.62	2406.68	7384.46	40°28'16.302"N	104°44'27.175"W	1.80	
14408.00	90.770	91.730	7141.26	7844.35	2403.32	7473.37	40°28'16.268"N	104°44'26.025"W	1.47	
14497.00	90.740	94.030	7140.09	7928.75	2398.84	7562.24	40°28'16.224"N	104°44'24.875"W	2.58	
14587.00	90.830	95.830	7138.85	8013.03	2391.11	7651.90	40°28'16.147"N	104°44'23.715"W	2.00	
14676.00	90.890	93.910	7137.52	8096.40	2383.56	7740.56	40°28'16.072"N	104°44'22.568"W	2.16	
14766.00	90.710	92.440	7136.26	8181.60	2378.57	7830.41	40°28'16.023"N	104°44'21.405"W	1.65	
14855.00	89.970	90.810	7135.73	8266.60	2376.05	7919.37	40°28'15.997"N	104°44'20.254"W	2.01	
14945.00	89.600	89.830	7136.07	8353.15	2375.55	8009.37	40°28'15.992"N	104°44'19.090"W	1.16	
15034.00	90.520	88.980	7135.98	8439.11	2376.47	8098.36	40°28'16.001"N	104°44'17.938"W	1.41	
15123.00	90.180	90.140	7135.43	8525.01	2377.15	8187.36	40°28'16.007"N	104°44'16.787"W	1.36	
15213.00	90.220	89.810	7135.12	8611.71	2377.19	8277.36	40°28'16.008"N	104°44'15.622"W	0.37	
15302.00	90.280	88.060	7134.73	8697.86	2378.85	8366.34	40°28'16.024"N	104°44'14.471"W	1.97	
15392.00	90.400	87.490	7134.20	8785.42	2382.34	8456.27	40°28'16.058"N	104°44'13.307"W	0.65	
15481.00	90.280	87.740	7133.67	8872.06	2386.05	8545.19	40°28'16.094"N	104°44'12.157"W	0.31	
15516.00	90.490	87.040	7133.43	8906.16	2387.64	8580.15	40°28'16.110"N	104°44'11.704"W	2.09	LAST BHI MWD SURVEY (1660'FSL & 466'FEL, SEC.23)
15540.00	90.490	87.040	7133.23	8929.58	2388.88	8604.12	40°28'16.122"N	104°44'11.394"W	0.00	PROJ TO BIT (1661'FSL & 442'FEL, SEC.23)



Actual Wellpath Report

TROUDT 1C-23-M AWP

Page 8 of 10



REFERENCE WELLPATH IDENTIFICATION

Operator	SRC ENERGY	Slot	SLOT#05 TROUDT 1C-23-M (760'FNL & 1654'FWL, SEC.27)
Area	COLORADO	Well	TROUDT 1C-23-M
Field	WELD COUNTY (NAD83,TRUE NORTH)	Wellbore	TROUDT 1C-23-M AWB
Facility	SEC.27-T06N-R66W		

HOLE & CASING SECTIONS - Ref Wellbore: TROUDT 1C-23-M AWB Ref Wellpath: TROUDT 1C-23-M AWP

String/Diameter	Start MD [ft]	End MD [ft]	Interval [ft]	Start TVD [ft]	End TVD [ft]	Start N/S [ft]	Start E/W [ft]	End N/S [ft]	End E/W [ft]
9.625in Casing Surface	25.00	1815.00	1790.00	25.00	1814.97	0.00	0.00	-2.98	0.17

TARGETS

Name	TVD [ft]	North [ft]	East [ft]	Grid East [US ft]	Grid North [US ft]	Latitude	Longitude	Shape
SEC.23-T06N-R66W	-8.00	4231.31	-1927.13	3201871.60	1417148.27	40°28'34.342"N	104°46'27.660"W	polygon
SEC.22-T06N-R66W	6.00	1412.74	-8068.95	3195753.51	1414279.17	40°28'06.478"N	104°47'47.123"W	polygon
SEC.27-T06N-R66W	19.00	-4766.34	1015.60	3204888.45	1408175.58	40°27'05.432"N	104°45'49.586"W	polygon
SEC.28-T06N-R66W	19.00	-4766.34	1015.60	3204888.45	1408175.58	40°27'05.432"N	104°45'49.586"W	polygon
SEC.26-T06N-R66W	38.00	-4763.01	615.37	3204488.23	1408175.60	40°27'05.465"N	104°45'54.763"W	polygon
SEC.29-T06N-R66W EAST HALF	50.00	0.02	-59.81	3203773.74	1412932.71	40°27'52.531"N	104°46'03.497"W	polygon
TROUDT 1C-23-M BHL REV-2 (1655'FSL & 510'FEL, SEC.23)	7126.84	2382.99	8536.37	3212349.61	1415386.52	40°28'16.064"N	104°44'12.271"W	circle
TROUDT 1C-23-M BHL ON PLAT (1655'FSL & 510'FEL, SEC.23)	7132.00	2383.03	8536.35	3212349.60	1415386.56	40°28'16.064"N	104°44'12.271"W	circle
TROUDT 1C-23-M TOP OF PROD (1649'FSL & 2523'FEL, SEC.22)	7172.00	2402.35	1181.93	3204995.55	1415345.13	40°28'16.270"N	104°45'47.430"W	circle
TROUDT 1C-23-M TOP OF PROD REV-2 (1596'FSL & 2523'FEL, SEC.22)	7183.54	2349.09	1181.93	3204995.99	1415291.87	40°28'15.743"N	104°45'47.430"W	circle



Actual Wellpath Report

TROUDT 1C-23-M AWP

Page 9 of 10



REFERENCE WELLPATH IDENTIFICATION

Operator	SRC ENERGY	Slot	SLOT#05 TROUDT 1C-23-M (760'FNL & 1654'FWL, SEC.27)
Area	COLORADO	Well	TROUDT 1C-23-M
Field	WELD COUNTY (NAD83,TRUE NORTH)	Wellbore	TROUDT 1C-23-M AWB
Facility	SEC.27-T06N-R66W		

WELLPATH COMPOSITION - Ref Wellbore: TROUDT 1C-23-M AWB Ref Wellpath: TROUDT 1C-23-M AWP

Start MD [ft]	End MD [ft]	Positional Uncertainty Model	Log Name/Comment	Wellbore
25.00	1765.00	BHI NaviTrak (Standard)	13 1/2" SURFACE SURVEYS <88-1744>	TROUDT 1C-23-M AWB
1765.00	15516.00	BHI AutoTrak Curve (IFR1, Short)	8 1/2" ATC SURVEYS <1883-15516>	TROUDT 1C-23-M AWB
15516.00	15540.00	Blind Drilling (std)	Projection to bit	TROUDT 1C-23-M AWB



Actual Wellpath Report

TROUDT 1C-23-M AWP

Page 10 of 10



REFERENCE WELLPATH IDENTIFICATION			
Operator	SRC ENERGY	Slot	SLOT#05 TROUDT 1C-23-M (760'FNL & 1654'FWL, SEC.27)
Area	COLORADO	Well	TROUDT 1C-23-M
Field	WELD COUNTY (NAD83,TRUE NORTH)	Wellbore	TROUDT 1C-23-M AWB
Facility	SEC.27-T06N-R66W		

WELLPATH COMMENTS				
MD [ft]	Inclination [°]	Azimuth [°]	TVD [ft]	Comment
8110.00	89.882	86.653	7180.42	LANDING POINT (1555'FSL & 2526'FEL, SEC.22)
15516.00	90.490	87.040	7133.43	LAST BHI MWD SURVEY (1660'FSL & 466'FEL, SEC.23)
15540.00	90.490	87.040	7133.23	PROJ TO BIT (1661'FSL & 442'FEL, SEC.23)