

# SRC ENERGY

Location: COLORADO Slot: SLOT#06 TROUDT 41N-23C-M (760'FNL & 1669'FWL, SEC.27)  
 Field: WELD COUNTY (NAD83, TRUE NORTH) Well: TROUDT 41N-23C-M  
 Facility: SEC.27-T06N-R66W Wellbore: TROUDT 41N-23C-M PWB

Plot reference wellpath is TROUDT 41N-23C-M (REV-C.0) PWP	Grid System: NAD83 / Lambert Colorado SP, Northern Zone (501), US feet
True vertical depths are referenced to PD 562 (25) (RKB)	North Reference: True north
Measured depths are referenced to PD 562 (25) (RKB)	Scale: True distance
PD 562 (25) (RKB) to Mean Sea Level: 4744 feet	Depths are in feet
Mean Sea Level to Mud line (At Slot: SLOT#06 TROUDT 41N-23C-M (760'FNL & 1669'FWL, SEC.27)): 0 feet	Created by: robale01 on 2018-10-25
Coordinates are in feet referenced to Slot	Database: WADENVER



SRC ENERGY

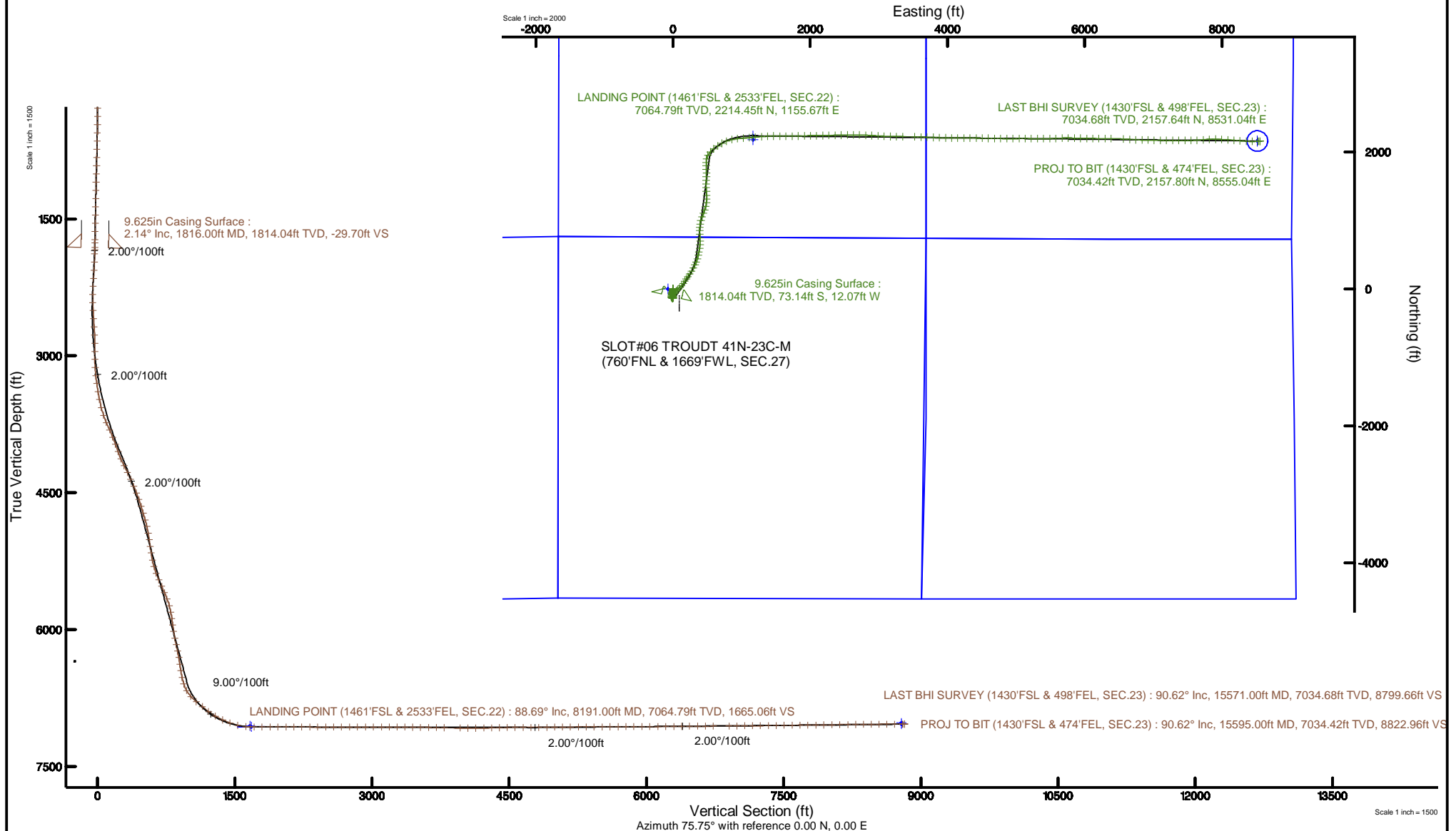



# Actual Wellpath Report

TROUDT 41N-23C-M AWP

Page 1 of 10



## REFERENCE WELLPATH IDENTIFICATION

Operator	SRC ENERGY	Slot	SLOT#06 TROUDT 41N-23C-M (760'FNL & 1669'FWL, SEC.27)
Area	COLORADO	Well	TROUDT 41N-23C-M
Field	WELD COUNTY (NAD83,TRUE NORTH)	Wellbore	TROUDT 41N-23C-M AWB
Facility	SEC.27-T06N-R66W		

## REPORT SETUP INFORMATION

Projection System	NAD83 / Lambert Colorado SP, Northern Zone (501), US feet	Software System	WellArchitect® 5.1
North Reference	True	User	Hanisab
Scale	0.999964	Report Generated	10/29/2018 at 10:54:14 PM
Convergence at slot	0.47° East	Database/Source file	WA DENVER/TROUDT_41N-23C-M_AWP.xml

## WELLPATH LOCATION

	Local coordinates		Grid coordinates		Geographic coordinates	
	North[ft]	East[ft]	Easting[US ft]	Northing[US ft]	Latitude	Longitude
Slot Location	-0.02	74.88	3203848.62	1412933.31	40°27'52.531"N	104°46'02.528"W
Facility Reference Pt			3203773.74	1412932.71	40°27'52.531"N	104°46'03.497"W
Field Reference Pt			3171284.48	1426358.81	40°30'07.643"N	104°53'02.634"W

## WELLPATH DATUM

Calculation method	Minimum curvature	PD 562 (25') (RKB) to Facility Vertical Datum	4744.00ft
Horizontal Reference Pt	Slot	PD 562 (25') (RKB) to Mean Sea Level	4744.00ft
Vertical Reference Pt	PD 562 (25') (RKB)	PD 562 (25') (RKB) to Mud Line at Slot (SLOT#06 TROUDT 41N-23C-M (760'FNL & 1669'FWL, SEC.27))	4744.00ft
MD Reference Pt	PD 562 (25') (RKB)	Section Origin	N 0.00, E 0.00 ft
Field Vertical Reference	Mean Sea Level	Section Azimuth	75.75°



# Actual Wellpath Report

TROUDT 41N-23C-M AWP

Page 2 of 10



## REFERENCE WELLPATH IDENTIFICATION

Operator	SRC ENERGY	Slot	SLOT#06 TROUDT 41N-23C-M (760'FNL & 1669'FWL, SEC.27)
Area	COLORADO	Well	TROUDT 41N-23C-M
Field	WELD COUNTY (NAD83,TRUE NORTH)	Wellbore	TROUDT 41N-23C-M AWB
Facility	SEC.27-T06N-R66W		

## WELLPATH DATA (177 stations) † = interpolated/extrapolated station

MD [ft]	Inclination [°]	Azimuth [°]	TVD [ft]	Vert Sect [ft]	North [ft]	East [ft]	Latitude	Longitude	DLS [°/100ft]	Comments
0.00†	0.000	106.380	0.00	0.00	0.00	0.00	40°27'52.531"N	104°46'02.528"W	0.00	
25.00	0.000	106.380	25.00	0.00	0.00	0.00	40°27'52.531"N	104°46'02.528"W	0.00	
109.00	0.690	106.380	109.00	0.44	-0.14	0.49	40°27'52.530"N	104°46'02.522"W	0.82	
197.00	0.420	110.220	196.99	1.16	-0.40	1.30	40°27'52.527"N	104°46'02.511"W	0.31	
287.00	0.100	24.100	286.99	1.48	-0.45	1.64	40°27'52.527"N	104°46'02.507"W	0.47	
377.00	1.970	191.890	376.98	0.85	-1.89	1.35	40°27'52.512"N	104°46'02.511"W	2.30	
467.00	2.260	196.780	466.91	-0.75	-5.10	0.52	40°27'52.481"N	104°46'02.521"W	0.38	
557.00	4.590	185.450	556.75	-2.88	-10.39	-0.33	40°27'52.428"N	104°46'02.532"W	2.68	
647.00	4.280	181.410	646.48	-5.00	-17.33	-0.76	40°27'52.360"N	104°46'02.538"W	0.49	
737.00	3.530	184.010	736.27	-6.77	-23.45	-1.04	40°27'52.299"N	104°46'02.541"W	0.86	
827.00	3.200	185.570	826.11	-8.49	-28.71	-1.47	40°27'52.247"N	104°46'02.547"W	0.38	
917.00	2.700	203.720	916.00	-10.65	-33.15	-2.57	40°27'52.203"N	104°46'02.561"W	1.17	
1007.00	2.460	206.800	1005.91	-13.22	-36.82	-4.29	40°27'52.167"N	104°46'02.584"W	0.31	
1097.00	2.630	197.600	1095.82	-15.58	-40.51	-5.79	40°27'52.131"N	104°46'02.603"W	0.49	
1187.00	2.210	187.430	1185.74	-17.31	-44.20	-6.64	40°27'52.094"N	104°46'02.614"W	0.67	
1277.00	2.490	196.850	1275.66	-18.96	-47.79	-7.43	40°27'52.059"N	104°46'02.624"W	0.53	
1367.00	2.590	195.000	1365.57	-20.96	-51.63	-8.52	40°27'52.021"N	104°46'02.638"W	0.14	
1457.00	3.000	182.390	1455.47	-22.63	-55.94	-9.15	40°27'51.978"N	104°46'02.646"W	0.82	
1547.00	3.060	189.660	1545.34	-24.28	-60.67	-9.65	40°27'51.932"N	104°46'02.653"W	0.43	
1637.00	2.520	190.610	1635.23	-26.08	-64.98	-10.41	40°27'51.889"N	104°46'02.663"W	0.60	
1727.00	2.890	191.510	1725.13	-27.90	-69.15	-11.23	40°27'51.848"N	104°46'02.673"W	0.41	
1765.00	2.800	190.050	1763.09	-28.70	-71.00	-11.58	40°27'51.829"N	104°46'02.678"W	0.30	
1840.00	1.850	200.980	1838.02	-30.15	-73.93	-12.34	40°27'51.800"N	104°46'02.688"W	1.39	
1885.00	2.000	198.350	1883.00	-30.99	-75.36	-12.84	40°27'51.786"N	104°46'02.694"W	0.39	
1974.00	3.510	204.690	1971.89	-33.54	-79.31	-14.47	40°27'51.747"N	104°46'02.715"W	1.73	
2063.00	5.410	208.270	2060.62	-38.09	-85.48	-17.60	40°27'51.686"N	104°46'02.756"W	2.16	
2153.00	7.890	202.040	2150.01	-44.61	-94.94	-21.93	40°27'51.593"N	104°46'02.812"W	2.87	
2242.00	8.030	183.740	2238.17	-50.15	-106.81	-24.62	40°27'51.476"N	104°46'02.847"W	2.84	
2331.00	7.960	171.950	2326.31	-52.73	-119.11	-24.17	40°27'51.354"N	104°46'02.841"W	1.84	
2421.00	7.080	152.040	2415.55	-52.09	-130.19	-20.69	40°27'51.245"N	104°46'02.796"W	3.04	



# Actual Wellpath Report

TROUDT 41N-23C-M AWP

Page 3 of 10



## REFERENCE WELLPATH IDENTIFICATION

Operator	SRC ENERGY	Slot	SLOT#06 TROUDT 41N-23C-M (760'FNL & 1669'FWL, SEC.27)
Area	COLORADO	Well	TROUDT 41N-23C-M
Field	WELD COUNTY (NAD83,TRUE NORTH)	Wellbore	TROUDT 41N-23C-M AWB
Facility	SEC.27-T06N-R66W		

## WELLPATH DATA (177 stations)

MD [ft]	Inclination [°]	Azimuth [°]	TVD [ft]	Vert Sect [ft]	North [ft]	East [ft]	Latitude	Longitude	DLS [°/100ft]	Comments
2510.00	4.320	106.170	2504.14	-47.90	-135.97	-14.90	40°27'51.187"N	104°46'02.721"W	5.75	
2600.00	3.660	87.820	2593.93	-42.16	-136.80	-8.77	40°27'51.179"N	104°46'02.641"W	1.59	
2689.00	3.470	92.990	2682.75	-36.81	-136.83	-3.24	40°27'51.179"N	104°46'02.570"W	0.42	
2779.00	3.800	63.510	2772.58	-31.30	-135.65	2.15	40°27'51.191"N	104°46'02.500"W	2.08	
2868.00	4.890	343.230	2861.39	-28.58	-130.70	3.69	40°27'51.240"N	104°46'02.480"W	6.36	
2957.00	3.860	324.620	2950.14	-29.83	-124.62	0.86	40°27'51.300"N	104°46'02.517"W	1.96	
3047.00	5.470	2.160	3039.86	-29.71	-117.86	-0.73	40°27'51.366"N	104°46'02.537"W	3.74	
3136.00	6.570	20.240	3128.37	-25.63	-108.84	1.19	40°27'51.455"N	104°46'02.513"W	2.45	
3226.00	9.180	25.050	3217.52	-18.16	-97.51	6.01	40°27'51.567"N	104°46'02.450"W	2.99	
3315.00	11.660	25.780	3305.04	-7.88	-82.98	12.93	40°27'51.711"N	104°46'02.361"W	2.79	
3405.00	13.380	31.180	3392.90	5.39	-65.88	22.28	40°27'51.880"N	104°46'02.240"W	2.31	
3494.00	14.260	38.330	3479.33	21.43	-48.46	34.41	40°27'52.052"N	104°46'02.083"W	2.16	
3584.00	16.820	41.720	3566.03	41.02	-30.05	49.95	40°27'52.234"N	104°46'01.882"W	3.02	
3673.00	20.540	43.400	3650.33	64.89	-9.08	69.26	40°27'52.441"N	104°46'01.632"W	4.22	
3763.00	27.620	46.470	3732.45	96.47	16.79	95.27	40°27'52.697"N	104°46'01.295"W	7.99	
3852.00	28.040	42.700	3811.16	132.00	46.38	124.41	40°27'52.989"N	104°46'00.918"W	2.03	
3942.00	27.940	34.370	3890.67	165.56	79.34	150.67	40°27'53.315"N	104°46'00.579"W	4.34	
4031.00	27.830	29.760	3969.34	195.64	114.59	172.76	40°27'53.663"N	104°46'00.293"W	2.43	
4121.00	26.130	32.140	4049.55	224.59	149.61	193.73	40°27'54.009"N	104°46'00.022"W	2.24	
4210.00	28.330	37.590	4128.69	255.39	182.95	217.04	40°27'54.339"N	104°45'59.720"W	3.73	
4299.00	33.450	36.980	4205.04	291.14	219.30	244.70	40°27'54.698"N	104°45'59.362"W	5.76	
4389.00	34.970	30.150	4279.49	328.54	261.44	272.59	40°27'55.114"N	104°45'59.001"W	4.59	
4478.00	33.830	28.260	4352.93	363.12	305.31	297.13	40°27'55.548"N	104°45'58.684"W	1.75	
4569.00	33.780	25.260	4428.55	396.33	350.51	319.92	40°27'55.995"N	104°45'58.389"W	1.83	
4657.00	33.910	20.200	4501.65	425.79	395.68	338.84	40°27'56.441"N	104°45'58.144"W	3.21	
4746.00	33.730	16.410	4575.60	452.43	442.69	354.39	40°27'56.905"N	104°45'57.943"W	2.38	
4836.00	33.800	14.140	4650.42	477.07	490.93	367.57	40°27'57.382"N	104°45'57.772"W	1.40	
4925.00	35.860	10.680	4723.48	499.83	540.57	378.45	40°27'57.873"N	104°45'57.632"W	3.21	
5015.00	35.110	8.140	4796.77	520.80	592.10	387.00	40°27'58.382"N	104°45'57.521"W	1.84	
5105.00	36.370	4.210	4869.83	539.11	644.34	392.62	40°27'58.898"N	104°45'57.448"W	2.91	



# Actual Wellpath Report

TROUDT 41N-23C-M AWP

Page 4 of 10



## REFERENCE WELLPATH IDENTIFICATION

Operator	SRC ENERGY	Slot	SLOT#06 TROUDT 41N-23C-M (760'FNL & 1669'FWL, SEC.27)
Area	COLORADO	Well	TROUDT 41N-23C-M
Field	WELD COUNTY (NAD83,TRUE NORTH)	Wellbore	TROUDT 41N-23C-M AWB
Facility	SEC.27-T06N-R66W		

## WELLPATH DATA (177 stations)

MD [ft]	Inclination [°]	Azimuth [°]	TVD [ft]	Vert Sect [ft]	North [ft]	East [ft]	Latitude	Longitude	DLS [°/100ft]	Comments
5194.00	36.240	358.690	4941.57	553.35	696.97	393.96	40°27'59.418"N	104°45'57.431"W	3.67	
5284.00	36.150	357.250	5014.21	564.60	750.08	392.08	40°27'59.943"N	104°45'57.455"W	0.95	
5373.00	35.880	358.430	5086.19	575.55	802.37	390.11	40°28'00.460"N	104°45'57.481"W	0.84	
5462.00	31.930	359.070	5160.05	586.70	852.00	389.01	40°28'00.950"N	104°45'57.495"W	4.46	
5552.00	32.500	3.120	5236.20	599.40	899.94	389.94	40°28'01.424"N	104°45'57.483"W	2.48	
5641.00	35.090	9.220	5310.18	616.73	949.09	395.34	40°28'01.909"N	104°45'57.413"W	4.79	
5731.00	37.520	15.490	5382.73	640.64	1001.06	406.81	40°28'02.423"N	104°45'57.265"W	4.93	
5820.00	37.300	20.760	5453.44	669.56	1052.41	423.61	40°28'02.930"N	104°45'57.047"W	3.60	
5910.00	37.870	21.510	5524.76	701.34	1103.61	443.41	40°28'03.436"N	104°45'56.791"W	0.81	
5999.00	37.730	19.470	5595.09	732.42	1154.70	462.50	40°28'03.941"N	104°45'56.544"W	1.41	
6088.00	37.760	14.520	5665.48	760.66	1206.77	478.41	40°28'04.456"N	104°45'56.338"W	3.40	
6178.00	37.580	7.110	5736.75	783.92	1260.70	488.72	40°28'04.989"N	104°45'56.205"W	5.03	
6267.00	37.770	0.040	5807.23	800.54	1314.91	492.10	40°28'05.524"N	104°45'56.161"W	4.86	
6357.00	37.660	356.610	5878.43	812.52	1369.93	490.50	40°28'06.068"N	104°45'56.182"W	2.33	
6446.00	37.110	355.260	5949.15	822.07	1423.83	486.67	40°28'06.601"N	104°45'56.231"W	1.11	
6535.00	36.960	357.490	6020.20	831.95	1477.32	483.28	40°28'07.129"N	104°45'56.275"W	1.52	
6625.00	36.980	1.460	6092.12	844.78	1531.42	482.78	40°28'07.664"N	104°45'56.281"W	2.65	
6714.00	37.140	2.370	6163.14	859.71	1585.02	484.58	40°28'08.193"N	104°45'56.258"W	0.64	
6804.00	37.700	1.600	6234.62	874.99	1639.68	486.47	40°28'08.733"N	104°45'56.234"W	0.81	
6893.00	37.260	359.060	6305.25	888.62	1693.82	486.79	40°28'09.268"N	104°45'56.230"W	1.81	
6983.00	35.130	357.310	6377.88	900.08	1746.93	485.12	40°28'09.793"N	104°45'56.251"W	2.63	
7072.00	34.030	359.210	6451.16	911.01	1797.42	483.58	40°28'10.292"N	104°45'56.271"W	1.73	
7162.00	37.600	1.690	6524.13	924.41	1850.06	484.04	40°28'10.812"N	104°45'56.265"W	4.28	
7251.00	37.350	9.750	6594.81	942.85	1903.84	489.42	40°28'11.344"N	104°45'56.196"W	5.51	
7341.00	37.430	31.270	6666.62	973.60	1954.34	508.32	40°28'11.843"N	104°45'55.951"W	14.47	
7430.00	47.550	41.900	6732.25	1020.35	2002.09	544.43	40°28'12.315"N	104°45'55.484"W	13.91	
7519.00	53.060	51.420	6789.15	1080.15	2048.81	594.27	40°28'12.776"N	104°45'54.839"W	10.29	
7609.00	52.970	57.680	6843.33	1147.12	2090.47	652.78	40°28'13.188"N	104°45'54.082"W	5.56	
7698.00	52.780	59.120	6897.05	1214.84	2127.65	713.22	40°28'13.555"N	104°45'53.300"W	1.31	
7788.00	59.240	68.990	6947.42	1287.78	2160.00	780.25	40°28'13.875"N	104°45'52.432"W	11.57	



# Actual Wellpath Report

TROUDT 41N-23C-M AWP

Page 5 of 10



## REFERENCE WELLPATH IDENTIFICATION

Operator	SRC ENERGY	Slot	SLOT#06 TROUDT 41N-23C-M (760'FNL & 1669'FWL, SEC.27)
Area	COLORADO	Well	TROUDT 41N-23C-M
Field	WELD COUNTY (NAD83,TRUE NORTH)	Wellbore	TROUDT 41N-23C-M AWB
Facility	SEC.27-T06N-R66W		

## WELLPATH DATA (177 stations) † = interpolated/extrapolated station

MD [ft]	Inclination [°]	Azimuth [°]	TVD [ft]	Vert Sect [ft]	North [ft]	East [ft]	Latitude	Longitude	DLS [°/100ft]	Comments
7878.00	66.000	77.050	6988.84	1367.48	2183.13	856.60	40°28'14.103"N	104°45'51.444"W	10.93	
7967.00	70.050	83.920	7022.17	1449.64	2196.69	937.93	40°28'14.237"N	104°45'50.392"W	8.48	
8057.00	74.770	86.410	7049.37	1534.24	2203.89	1023.39	40°28'14.309"N	104°45'49.286"W	5.87	
8146.00	87.290	85.040	7063.22	1620.66	2210.45	1110.88	40°28'14.373"N	104°45'48.154"W	14.15	
8191.00†	88.690	84.760	7064.79	1665.06	2214.45	1155.67	40°28'14.413"N	104°45'47.575"W	3.17	LANDING POINT (1461'FSL & 2533'FEL, SEC.22)
8236.00	90.090	84.480	7065.27	1709.51	2218.67	1200.47	40°28'14.455"N	104°45'46.995"W	3.17	
8325.00	89.780	85.710	7065.37	1797.33	2226.28	1289.14	40°28'14.530"N	104°45'45.848"W	1.43	
8414.00	90.000	87.220	7065.54	1884.78	2231.77	1377.97	40°28'14.584"N	104°45'44.699"W	1.71	
8504.00	90.150	90.300	7065.43	1972.46	2233.71	1467.94	40°28'14.603"N	104°45'43.534"W	3.43	
8594.00	89.660	91.000	7065.58	2059.44	2232.69	1557.93	40°28'14.593"N	104°45'42.370"W	0.95	
8683.00	89.880	89.920	7065.93	2145.52	2231.98	1646.93	40°28'14.586"N	104°45'41.219"W	1.24	
8773.00	89.780	89.070	7066.20	2232.94	2232.77	1736.92	40°28'14.594"N	104°45'40.054"W	0.95	
8862.00	89.660	88.800	7066.63	2319.60	2234.43	1825.91	40°28'14.610"N	104°45'38.903"W	0.33	
8952.00	89.880	88.630	7067.00	2407.30	2236.44	1915.88	40°28'14.630"N	104°45'37.739"W	0.31	
9041.00	89.910	89.350	7067.16	2493.94	2238.01	2004.87	40°28'14.645"N	104°45'36.587"W	0.81	
9130.00	89.780	89.080	7067.40	2580.49	2239.23	2093.86	40°28'14.657"N	104°45'35.436"W	0.34	
9220.00	89.850	88.940	7067.69	2668.09	2240.79	2183.85	40°28'14.672"N	104°45'34.271"W	0.17	
9309.00	89.720	88.830	7068.02	2754.77	2242.52	2272.83	40°28'14.689"N	104°45'33.120"W	0.19	
9399.00	90.150	88.290	7068.13	2842.53	2244.78	2362.80	40°28'14.712"N	104°45'31.956"W	0.77	
9488.00	90.180	88.460	7067.87	2929.38	2247.30	2451.76	40°28'14.737"N	104°45'30.805"W	0.19	
9578.00	89.940	88.860	7067.78	3017.10	2249.41	2541.74	40°28'14.757"N	104°45'29.641"W	0.52	
9667.00	89.690	89.940	7068.06	3103.59	2250.34	2630.73	40°28'14.766"N	104°45'28.489"W	1.25	
9756.00	89.780	91.710	7068.48	3189.52	2249.06	2719.72	40°28'14.754"N	104°45'27.338"W	1.99	
9846.00	89.880	92.780	7068.74	3275.82	2245.53	2809.65	40°28'14.719"N	104°45'26.174"W	1.19	
9935.00	90.060	93.060	7068.79	3360.86	2241.00	2898.53	40°28'14.674"N	104°45'25.024"W	0.37	
10024.00	89.600	93.670	7069.05	3445.68	2235.78	2987.38	40°28'14.622"N	104°45'23.875"W	0.86	
10114.00	88.950	92.790	7070.19	3531.52	2230.71	3077.23	40°28'14.572"N	104°45'22.712"W	1.22	
10204.00	89.320	91.510	7071.55	3617.85	2227.33	3167.15	40°28'14.538"N	104°45'21.549"W	1.48	
10293.00	89.020	90.870	7072.84	3703.63	2225.48	3256.12	40°28'14.520"N	104°45'20.397"W	0.79	
10383.00	88.920	90.850	7074.46	3790.51	2224.13	3346.10	40°28'14.507"N	104°45'19.233"W	0.11	





# Actual Wellpath Report

TROUDT 41N-23C-M AWP

Page 6 of 10



## REFERENCE WELLPATH IDENTIFICATION

Operator	SRC ENERGY	Slot	SLOT#06 TROUDT 41N-23C-M (760'FNL & 1669'FWL, SEC.27)
Area	COLORADO	Well	TROUDT 41N-23C-M
Field	WELD COUNTY (NAD83,TRUE NORTH)	Wellbore	TROUDT 41N-23C-M AWB
Facility	SEC.27-T06N-R66W		

## WELLPATH DATA (177 stations)

MD [ft]	Inclination [°]	Azimuth [°]	TVD [ft]	Vert Sect [ft]	North [ft]	East [ft]	Latitude	Longitude	DLS [°/100ft]	Comments
10561.00	88.610	91.020	7078.29	3962.26	2221.23	3524.03	40°28'14.478"N	104°45'16.931"W	0.20	
10651.00	90.120	91.380	7079.29	4049.00	2219.34	3614.00	40°28'14.459"N	104°45'15.767"W	1.72	
10740.00	89.970	91.510	7079.22	4134.68	2217.10	3702.97	40°28'14.437"N	104°45'14.616"W	0.22	
10830.00	91.320	92.460	7078.21	4221.09	2213.98	3792.91	40°28'14.406"N	104°45'13.452"W	1.83	
10919.00	91.320	92.060	7076.16	4306.40	2210.47	3881.82	40°28'14.371"N	104°45'12.302"W	0.45	
11009.00	91.420	91.600	7074.01	4392.85	2207.60	3971.75	40°28'14.342"N	104°45'11.138"W	0.52	
11098.00	91.510	91.060	7071.73	4478.56	2205.53	4060.69	40°28'14.322"N	104°45'09.987"W	0.61	
11187.00	90.090	90.250	7070.49	4564.55	2204.52	4149.68	40°28'14.312"N	104°45'08.836"W	1.84	
11277.00	89.850	90.020	7070.54	4651.73	2204.30	4239.68	40°28'14.309"N	104°45'07.671"W	0.37	
11366.00	89.820	89.700	7070.79	4738.05	2204.52	4328.67	40°28'14.311"N	104°45'06.520"W	0.36	
11456.00	90.550	90.840	7070.50	4825.17	2204.10	4418.67	40°28'14.307"N	104°45'05.355"W	1.50	
11545.00	90.650	90.940	7069.57	4911.08	2202.72	4507.66	40°28'14.293"N	104°45'04.204"W	0.16	
11634.00	90.370	91.110	7068.78	4996.93	2201.12	4596.64	40°28'14.277"N	104°45'03.053"W	0.37	
11724.00	90.460	91.380	7068.13	5083.66	2199.17	4686.61	40°28'14.258"N	104°45'01.888"W	0.32	
11813.00	90.620	90.600	7067.29	5169.53	2197.63	4775.60	40°28'14.242"N	104°45'00.737"W	0.89	
11903.00	90.400	90.550	7066.49	5256.53	2196.73	4865.59	40°28'14.233"N	104°44'59.573"W	0.25	
11992.00	90.250	89.630	7065.98	5342.76	2196.59	4954.58	40°28'14.232"N	104°44'58.421"W	1.05	
12081.00	90.430	89.100	7065.45	5429.26	2197.57	5043.58	40°28'14.241"N	104°44'57.270"W	0.63	
12171.00	90.340	90.460	7064.85	5516.57	2197.92	5133.57	40°28'14.245"N	104°44'56.105"W	1.51	
12260.00	90.150	90.800	7064.47	5602.59	2196.94	5222.57	40°28'14.235"N	104°44'54.954"W	0.44	
12350.00	90.280	90.590	7064.13	5689.54	2195.85	5312.56	40°28'14.224"N	104°44'53.789"W	0.27	
12439.00	90.220	89.610	7063.74	5775.77	2195.69	5401.56	40°28'14.222"N	104°44'52.638"W	1.10	
12529.00	90.370	88.870	7063.28	5863.28	2196.89	5491.55	40°28'14.234"N	104°44'51.473"W	0.84	
12618.00	89.780	87.410	7063.16	5950.21	2199.78	5580.50	40°28'14.262"N	104°44'50.323"W	1.77	
12708.00	90.650	87.540	7062.82	6038.33	2203.74	5670.41	40°28'14.301"N	104°44'49.159"W	0.98	
12798.00	90.680	90.540	7061.78	6125.91	2205.25	5760.38	40°28'14.316"N	104°44'47.995"W	3.33	
12888.00	90.770	91.910	7060.64	6212.64	2203.32	5850.35	40°28'14.296"N	104°44'46.831"W	1.53	
12978.00	90.370	91.500	7059.74	6299.17	2200.65	5940.30	40°28'14.270"N	104°44'45.667"W	0.64	
13067.00	90.520	91.050	7059.05	6384.92	2198.67	6029.28	40°28'14.250"N	104°44'44.516"W	0.53	
13157.00	90.150	90.320	7058.53	6471.88	2197.59	6119.27	40°28'14.239"N	104°44'43.351"W	0.91	



# Actual Wellpath Report

TROUDT 41N-23C-M AWP

Page 7 of 10



## REFERENCE WELLPATH IDENTIFICATION

Operator	SRC ENERGY	Slot	SLOT#06 TROUDT 41N-23C-M (760'FNL & 1669'FWL, SEC.27)
Area	COLORADO	Well	TROUDT 41N-23C-M
Field	WELD COUNTY (NAD83,TRUE NORTH)	Wellbore	TROUDT 41N-23C-M AWB
Facility	SEC.27-T06N-R66W		

## WELLPATH DATA (177 stations)

MD [ft]	Inclination [°]	Azimuth [°]	TVD [ft]	Vert Sect [ft]	North [ft]	East [ft]	Latitude	Longitude	DLS [°/100ft]	Comments
13246.00	90.430	90.070	7058.08	6558.07	2197.29	6208.27	40°28'14.236"N	104°44'42.200"W	0.42	
13336.00	90.520	91.130	7057.33	6645.06	2196.35	6298.26	40°28'14.226"N	104°44'41.035"W	1.18	
13425.00	90.460	90.870	7056.57	6730.92	2194.79	6387.24	40°28'14.211"N	104°44'39.884"W	0.30	
13604.00	90.150	92.810	7055.62	6902.90	2189.05	6566.14	40°28'14.153"N	104°44'37.569"W	1.10	
13694.00	90.800	93.120	7054.87	6988.87	2184.39	6656.02	40°28'14.107"N	104°44'36.407"W	0.80	
13783.00	90.550	92.740	7053.82	7073.90	2179.84	6744.89	40°28'14.062"N	104°44'35.257"W	0.51	
13873.00	90.490	91.360	7053.00	7160.28	2176.62	6834.83	40°28'14.030"N	104°44'34.093"W	1.53	
13962.00	90.710	91.170	7052.07	7246.03	2174.66	6923.80	40°28'14.010"N	104°44'32.942"W	0.33	
14052.00	90.800	91.360	7050.89	7332.74	2172.67	7013.77	40°28'13.990"N	104°44'31.778"W	0.23	
14141.00	90.650	91.090	7049.76	7418.51	2170.77	7102.75	40°28'13.971"N	104°44'30.626"W	0.35	
14230.00	90.650	90.850	7048.75	7504.39	2169.26	7191.73	40°28'13.956"N	104°44'29.475"W	0.27	
14320.00	90.710	90.060	7047.68	7591.43	2168.55	7281.72	40°28'13.949"N	104°44'28.311"W	0.88	
14409.00	90.620	90.120	7046.65	7677.66	2168.41	7370.71	40°28'13.947"N	104°44'27.159"W	0.12	
14499.00	90.580	89.390	7045.71	7764.98	2168.79	7460.70	40°28'13.951"N	104°44'25.995"W	0.81	
14588.00	90.430	88.960	7044.92	7851.54	2170.07	7549.69	40°28'13.963"N	104°44'24.843"W	0.51	
14677.00	90.740	87.630	7044.01	7938.41	2172.72	7638.65	40°28'13.989"N	104°44'23.692"W	1.53	
14767.00	90.830	83.830	7042.78	8027.03	2179.42	7728.37	40°28'14.055"N	104°44'22.531"W	4.22	
14856.00	90.800	87.270	7041.51	8114.71	2186.32	7817.08	40°28'14.123"N	104°44'21.384"W	3.86	
14946.00	90.740	91.430	7040.30	8202.16	2187.34	7907.05	40°28'14.133"N	104°44'20.220"W	4.62	
15035.00	90.710	93.500	7039.18	8287.39	2183.52	7995.95	40°28'14.095"N	104°44'19.069"W	2.33	
15125.00	90.250	93.700	7038.42	8373.06	2177.87	8085.77	40°28'14.039"N	104°44'17.907"W	0.56	
15214.00	90.650	94.370	7037.73	8457.56	2171.60	8174.55	40°28'13.976"N	104°44'16.759"W	0.88	
15304.00	90.520	94.720	7036.81	8542.76	2164.47	8264.26	40°28'13.906"N	104°44'15.598"W	0.41	
15393.00	90.430	92.560	7036.07	8627.45	2158.82	8353.07	40°28'13.849"N	104°44'14.449"W	2.43	
15482.00	90.370	89.670	7035.45	8713.26	2157.09	8442.04	40°28'13.832"N	104°44'13.297"W	3.25	
15571.00	90.620	89.620	7034.68	8799.66	2157.64	8531.04	40°28'13.837"N	104°44'12.146"W	0.29	LAST BHI SURVEY (1430'FSL & 498'FEL, SEC.23)
15595.00	90.620	89.620	7034.42	8822.96	2157.80	8555.04	40°28'13.839"N	104°44'11.835"W	0.00	PROJ TO BIT (1430'FSL & 474'FEL, SEC.23)





# Actual Wellpath Report

TROUDT 41N-23C-M AWP

Page 8 of 10



## REFERENCE WELLPATH IDENTIFICATION

Operator	SRC ENERGY	Slot	SLOT#06 TROUDT 41N-23C-M (760'FNL & 1669'FWL, SEC.27)
Area	COLORADO	Well	TROUDT 41N-23C-M
Field	WELD COUNTY (NAD83,TRUE NORTH)	Wellbore	TROUDT 41N-23C-M AWB
Facility	SEC.27-T06N-R66W		

## HOLE & CASING SECTIONS - Ref Wellbore: TROUDT 41N-23C-M AWB Ref Wellpath: TROUDT 41N-23C-M AWP

String/Diameter	Start MD [ft]	End MD [ft]	Interval [ft]	Start TVD [ft]	End TVD [ft]	Start N/S [ft]	Start E/W [ft]	End N/S [ft]	End E/W [ft]
9.625in Casing Surface	25.00	1816.00	1791.00	25.00	1814.04	0.00	0.00	-73.14	-12.07

## TARGETS

Name	TVD [ft]	North [ft]	East [ft]	Grid East [US ft]	Grid North [US ft]	Latitude	Longitude	Shape
SEC.23-T06N-R66W	-8.00	4231.31	-1942.20	3201871.60	1417148.27	40°28'34.342"N	104°46'27.660"W	polygon
SEC.22-T06N-R66W	6.00	1412.75	-8084.02	3195753.51	1414279.17	40°28'06.478"N	104°47'47.123"W	polygon
SEC.27-T06N-R66W	19.00	-4766.34	1000.52	3204888.45	1408175.58	40°27'05.432"N	104°45'49.586"W	polygon
SEC.28-T06N-R66W	19.00	-4766.34	1000.52	3204888.45	1408175.58	40°27'05.432"N	104°45'49.586"W	polygon
SEC.26-T06N-R66W	38.00	-4763.01	600.30	3204488.23	1408175.60	40°27'05.465"N	104°45'54.763"W	polygon
SEC.29-T06N-R66W EAST HALF	50.00	0.02	-74.88	3203773.74	1412932.71	40°27'52.531"N	104°46'03.497"W	polygon
TROUDT 41N-23C-M BHL ON PLAT (1435'FSL & 510'FEL, SEC.23)	7021.00	2162.25	8516.91	3212347.05	1415165.77	40°28'13.883"N	104°44'12.329"W	circle
TROUDT 41N-23C-M BHL REV-2 (1435'FSL & 510'FEL, SEC.23)	7035.85	2162.27	8516.89	3212347.03	1415165.79	40°28'13.883"N	104°44'12.329"W	circle
TROUDT 41N-23C-M TOP OF PROD ON PLAT (1428'FSL & 2523'FEL, SEC.22)	7054.00	2181.21	1166.04	3204996.55	1415123.99	40°28'14.084"N	104°45'47.441"W	circle
TROUDT 41N-23C-M TOP OF PROD REV-2 (1485'FSL & 2523'FEL, SEC.22)	7065.15	2238.21	1166.02	3204996.07	1415180.99	40°28'14.648"N	104°45'47.441"W	circle



# Actual Wellpath Report

TROUDT 41N-23C-M AWP

Page 9 of 10



## REFERENCE WELLPATH IDENTIFICATION

Operator	SRC ENERGY	Slot	SLOT#06 TROUDT 41N-23C-M (760'FNL & 1669'FWL, SEC.27)
Area	COLORADO	Well	TROUDT 41N-23C-M
Field	WELD COUNTY (NAD83,TRUE NORTH)	Wellbore	TROUDT 41N-23C-M AWB
Facility	SEC.27-T06N-R66W		

## WELLPATH COMPOSITION - Ref Wellbore: TROUDT 41N-23C-M AWB      Ref Wellpath: TROUDT 41N-23C-M AWP

Start MD [ft]	End MD [ft]	Positional Uncertainty Model	Log Name/Comment	Wellbore
25.00	1765.00	BHI NaviTrak (Standard)	13 1/2" SURFACE SURVEYS <88-1744>	TROUDT 41N-23C-M AWB
1765.00	15571.00	BHI AutoTrak Curve (MagCAD+IFR1, Short spacing)	8 1/2" ATC MONOBORE SURVEYS <1840-15571>	TROUDT 41N-23C-M AWB
15571.00	15595.00	Blind Drilling (std)	Projection to bit	TROUDT 41N-23C-M AWB



# Actual Wellpath Report

TROUDT 41N-23C-M AWP

Page 10 of 10



## REFERENCE WELLPATH IDENTIFICATION

Operator	SRC ENERGY	Slot	SLOT#06 TROUDT 41N-23C-M (760'FNL & 1669'FWL, SEC.27)
Area	COLORADO	Well	TROUDT 41N-23C-M
Field	WELD COUNTY (NAD83,TRUE NORTH)	Wellbore	TROUDT 41N-23C-M AWB
Facility	SEC.27-T06N-R66W		

## WELLPATH COMMENTS

MD [ft]	Inclination [°]	Azimuth [°]	TVD [ft]	Comment
8191.00	88.690	84.760	7064.79	LANDING POINT (1461'FSL & 2533'FEL, SEC.22)
15571.00	90.620	89.620	7034.68	LAST BHI SURVEY (1430'FSL & 498'FEL, SEC.23)
15595.00	90.620	89.620	7034.42	PROJ TO BIT (1430'FSL & 474'FEL, SEC.23)