

# SRC ENERGY

Location: COLORADO Slot: SLOT#04 TROUDT 1N-23B-M (760'FNL & 1640'FWL, SEC.27)  
 Field: WELD COUNTY (NAD83, TRUE NORTH) Well: TROUDT 1N-23B-M  
 Facility: SEC.27-T06N-R66W Wellbore: TROUDT 1N-23B-M PWB

Plot reference wellpath is TROUDT 1N-23B-M (REV-C.0) PWP	Grid System: NAD83 / Lambert Colorado SP, Northern Zone (501), US feet
True vertical depths are referenced to PD 562 (25) (RKB)	North Reference: True north
Measured depths are referenced to PD 562 (25) (RKB)	Scale: True distance
PD 562 (25) (RKB) to Mean Sea Level: 4744 feet	Depths are in feet
Mean Sea Level to Mud line (At Slot: SLOT#04 TROUDT 1N-23B-M (760'FNL & 1640'FWL, SEC.27)): 0 feet	Created by: robale01 on 2018-10-25
Coordinates are in feet referenced to Slot	Database: WA DENVER



SRC ENERGY

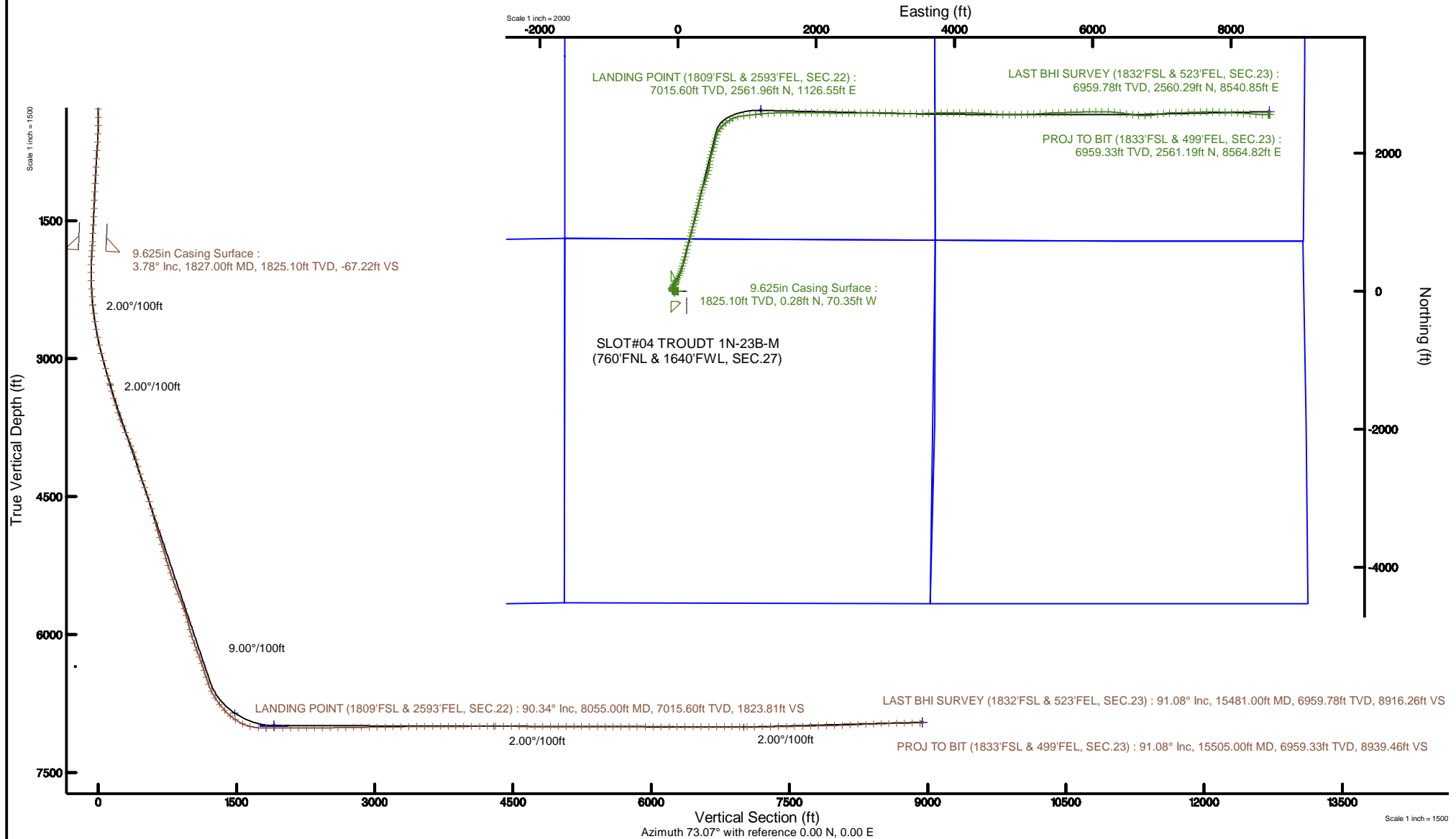



# Actual Wellpath Report

TROUDT 1N-23B-M AWP

Page 1 of 10



## REFERENCE WELLPATH IDENTIFICATION

Operator	SRC ENERGY	Slot	SLOT#04 TROUDT 1N-23B-M (760'FNL & 1640'FWL, SEC.27)
Area	COLORADO	Well	TROUDT 1N-23B-M
Field	WELD COUNTY (NAD83,TRUE NORTH)	Wellbore	TROUDT 1N-23B-M AWB
Facility	SEC.27-T06N-R66W		

## REPORT SETUP INFORMATION

Projection System	NAD83 / Lambert Colorado SP, Northern Zone (501), US feet	Software System	WellArchitect® 5.1
North Reference	True	User	Hanisab
Scale	0.999964	Report Generated	10/29/2018 at 10:35:59 PM
Convergence at slot	0.47° East	Database/Source file	WA DENVER/TROUDT_1N-23B-M_AWP.xml

## WELLPATH LOCATION

	Local coordinates		Grid coordinates		Geographic coordinates	
	North[ft]	East[ft]	Easting[US ft]	Northing[US ft]	Latitude	Longitude
Slot Location	-0.02	45.05	3203818.79	1412933.06	40°27'52.531"N	104°46'02.914"W
Facility Reference Pt			3203773.74	1412932.71	40°27'52.531"N	104°46'03.497"W
Field Reference Pt			3171284.48	1426358.81	40°30'07.643"N	104°53'02.634"W

## WELLPATH DATUM

Calculation method	Minimum curvature	PD 562 (25') (RKB) to Facility Vertical Datum	4744.00ft
Horizontal Reference Pt	Slot	PD 562 (25') (RKB) to Mean Sea Level	4744.00ft
Vertical Reference Pt	PD 562 (25') (RKB)	PD 562 (25') (RKB) to Mud Line at Slot (SLOT#04 TROUDT 1N-23B-M (760'FNL & 1640'FWL, SEC.27))	4744.00ft
MD Reference Pt	PD 562 (25') (RKB)	Section Origin	N 0.00, E 0.00 ft
Field Vertical Reference	Mean Sea Level	Section Azimuth	73.07°



# Actual Wellpath Report

TROUDT 1N-23B-M AWP

Page 2 of 10



## REFERENCE WELLPATH IDENTIFICATION

Operator	SRC ENERGY	Slot	SLOT#04 TROUDT 1N-23B-M (760'FNL & 1640'FWL, SEC.27)
Area	COLORADO	Well	TROUDT 1N-23B-M
Field	WELD COUNTY (NAD83,TRUE NORTH)	Wellbore	TROUDT 1N-23B-M AWP
Facility	SEC.27-T06N-R66W		

## WELLPATH DATA (176 stations) † = interpolated/extrapolated station

MD [ft]	Inclination [°]	Azimuth [°]	TVD [ft]	Vert Sect [ft]	North [ft]	East [ft]	Latitude	Longitude	DLS [°/100ft]	Comments
0.00†	0.000	153.760	0.00	0.00	0.00	0.00	40°27'52.531"N	104°46'02.914"W	0.00	
25.00	0.000	153.760	25.00	0.00	0.00	0.00	40°27'52.531"N	104°46'02.914"W	0.00	
109.00	0.120	153.760	109.00	0.01	-0.08	0.04	40°27'52.530"N	104°46'02.913"W	0.14	
197.00	0.170	161.480	197.00	0.03	-0.29	0.12	40°27'52.528"N	104°46'02.912"W	0.06	
287.00	0.240	167.120	287.00	0.02	-0.60	0.21	40°27'52.525"N	104°46'02.911"W	0.08	
377.00	0.250	99.440	377.00	0.19	-0.81	0.44	40°27'52.523"N	104°46'02.908"W	0.30	
467.00	1.000	282.520	466.99	-0.32	-0.67	-0.13	40°27'52.524"N	104°46'02.916"W	1.39	
557.00	2.510	273.000	556.95	-2.86	-0.40	-2.87	40°27'52.527"N	104°46'02.951"W	1.70	
647.00	3.140	270.600	646.84	-7.06	-0.27	-7.30	40°27'52.528"N	104°46'03.008"W	0.71	
737.00	4.190	271.180	736.65	-12.54	-0.18	-13.05	40°27'52.529"N	104°46'03.083"W	1.17	
827.00	3.920	275.900	826.43	-18.50	0.21	-19.40	40°27'52.533"N	104°46'03.165"W	0.48	
917.00	3.560	267.890	916.24	-24.03	0.42	-25.25	40°27'52.535"N	104°46'03.241"W	0.70	
1007.00	2.990	271.340	1006.09	-28.96	0.37	-30.39	40°27'52.535"N	104°46'03.307"W	0.67	
1097.00	2.830	275.210	1095.98	-33.25	0.63	-34.95	40°27'52.537"N	104°46'03.366"W	0.28	
1187.00	2.720	275.870	1185.87	-37.28	1.05	-39.29	40°27'52.541"N	104°46'03.422"W	0.13	
1277.00	2.870	259.130	1275.76	-41.49	0.84	-43.62	40°27'52.539"N	104°46'03.478"W	0.92	
1367.00	2.780	261.910	1365.65	-45.88	0.11	-48.00	40°27'52.532"N	104°46'03.535"W	0.18	
1457.00	2.610	274.860	1455.56	-49.94	-0.02	-52.20	40°27'52.531"N	104°46'03.589"W	0.70	
1547.00	2.540	264.520	1545.47	-53.80	-0.04	-56.23	40°27'52.531"N	104°46'03.641"W	0.52	
1637.00	2.660	268.390	1635.37	-57.77	-0.29	-60.30	40°27'52.528"N	104°46'03.694"W	0.24	
1727.00	2.530	273.080	1725.28	-61.65	-0.24	-64.37	40°27'52.529"N	104°46'03.747"W	0.28	
1776.00	3.710	275.840	1774.21	-64.13	-0.02	-67.03	40°27'52.531"N	104°46'03.781"W	2.43	
1889.00	3.870	272.930	1886.96	-71.09	0.54	-74.47	40°27'52.536"N	104°46'03.878"W	0.22	
1978.00	5.580	321.620	1975.69	-75.50	4.09	-80.16	40°27'52.571"N	104°46'03.951"W	4.71	
2067.00	7.880	343.660	2064.08	-77.02	13.34	-84.57	40°27'52.663"N	104°46'04.008"W	3.84	
2157.00	8.800	357.470	2153.14	-75.24	26.14	-86.61	40°27'52.789"N	104°46'04.034"W	2.44	
2246.00	6.270	11.200	2241.37	-71.25	37.71	-85.96	40°27'52.904"N	104°46'04.026"W	3.47	
2335.00	8.210	22.410	2329.66	-64.93	48.36	-82.59	40°27'53.009"N	104°46'03.983"W	2.69	
2425.00	8.110	29.820	2418.75	-56.23	59.80	-76.99	40°27'53.122"N	104°46'03.910"W	1.17	
2514.00	11.080	27.590	2506.50	-45.66	72.83	-69.90	40°27'53.251"N	104°46'03.818"W	3.36	



# Actual Wellpath Report

TROUDT 1N-23B-M AWP

Page 3 of 10



## REFERENCE WELLPATH IDENTIFICATION

Operator	SRC ENERGY	Slot	SLOT#04 TROUDT 1N-23B-M (760'FNL & 1640'FWL, SEC.27)
Area	COLORADO	Well	TROUDT 1N-23B-M
Field	WELD COUNTY (NAD83,TRUE NORTH)	Wellbore	TROUDT 1N-23B-M AWP
Facility	SEC.27-T06N-R66W		

## WELLPATH DATA (176 stations)

MD [ft]	Inclination [°]	Azimuth [°]	TVD [ft]	Vert Sect [ft]	North [ft]	East [ft]	Latitude	Longitude	DLS [°/100ft]	Comments
2604.00	10.490	27.340	2594.91	-33.88	87.78	-62.14	40°27'53.398"N	104°46'03.718"W	0.66	
2693.00	12.310	32.830	2682.15	-20.98	102.95	-53.27	40°27'53.548"N	104°46'03.603"W	2.38	
2783.00	15.180	27.570	2769.57	-5.39	121.46	-42.61	40°27'53.731"N	104°46'03.465"W	3.47	
2872.00	17.760	30.110	2854.91	12.71	143.53	-30.41	40°27'53.949"N	104°46'03.307"W	3.01	
2962.00	19.260	28.190	2940.25	33.28	168.49	-16.51	40°27'54.196"N	104°46'03.128"W	1.80	
3051.00	21.980	30.070	3023.54	55.86	195.85	-1.23	40°27'54.466"N	104°46'02.930"W	3.15	
3140.00	23.450	25.490	3105.64	79.99	226.25	14.74	40°27'54.767"N	104°46'02.723"W	2.58	
3230.00	23.050	20.120	3188.35	102.69	258.96	28.51	40°27'55.090"N	104°46'02.545"W	2.40	
3320.00	24.510	19.040	3270.70	124.27	293.16	40.66	40°27'55.428"N	104°46'02.388"W	1.69	
3409.00	25.720	17.000	3351.29	145.90	329.08	52.33	40°27'55.783"N	104°46'02.237"W	1.67	
3498.00	27.770	18.340	3430.76	168.65	367.23	64.50	40°27'56.160"N	104°46'02.079"W	2.40	
3588.00	29.890	14.290	3509.61	192.39	408.87	76.64	40°27'56.571"N	104°46'01.922"W	3.20	
3677.00	31.340	13.250	3586.20	215.52	452.89	87.42	40°27'57.006"N	104°46'01.783"W	1.73	
3767.00	36.730	14.960	3660.76	241.53	501.71	99.74	40°27'57.489"N	104°46'01.624"W	6.08	
3856.00	37.590	14.130	3731.69	269.59	553.75	113.24	40°27'58.003"N	104°46'01.449"W	1.12	
3946.00	38.050	13.410	3802.78	297.76	607.35	126.37	40°27'58.533"N	104°46'01.279"W	0.71	
4035.00	36.850	16.330	3873.44	326.26	659.65	140.24	40°27'59.049"N	104°46'01.100"W	2.41	
4125.00	35.700	17.290	3946.00	355.83	710.62	155.63	40°27'59.553"N	104°46'00.900"W	1.43	
4214.00	31.790	16.650	4019.99	383.41	757.89	170.07	40°28'00.020"N	104°46'00.714"W	4.41	
4303.00	29.520	16.280	4096.55	408.39	801.41	182.94	40°28'00.450"N	104°46'00.547"W	2.56	
4393.00	30.470	12.910	4174.50	431.89	844.94	194.25	40°28'00.880"N	104°46'00.401"W	2.15	
4482.00	30.140	13.780	4251.34	454.53	888.63	204.61	40°28'01.312"N	104°46'00.267"W	0.62	
4572.00	31.930	14.700	4328.45	478.56	933.60	216.04	40°28'01.756"N	104°46'00.119"W	2.06	
4661.00	33.660	14.700	4403.26	503.84	980.23	228.27	40°28'02.217"N	104°45'59.961"W	1.94	
4750.00	33.020	14.200	4477.62	529.31	1027.59	240.48	40°28'02.685"N	104°45'59.803"W	0.78	
4840.00	31.110	13.480	4553.88	553.76	1073.98	251.91	40°28'03.144"N	104°45'59.655"W	2.16	
4930.00	28.660	12.770	4631.91	576.22	1117.65	262.10	40°28'03.575"N	104°45'59.523"W	2.75	
5019.00	30.440	15.020	4709.33	598.73	1160.24	272.67	40°28'03.996"N	104°45'59.386"W	2.36	
5109.00	27.970	14.880	4787.89	621.93	1202.67	284.00	40°28'04.415"N	104°45'59.240"W	2.75	
5198.00	30.220	13.030	4865.65	644.12	1244.66	294.41	40°28'04.830"N	104°45'59.105"W	2.72	



# Actual Wellpath Report

TROUDT 1N-23B-M AWP

Page 4 of 10



## REFERENCE WELLPATH IDENTIFICATION

Operator	SRC ENERGY	Slot	SLOT#04 TROUDT 1N-23B-M (760'FNL & 1640'FWL, SEC.27)
Area	COLORADO	Well	TROUDT 1N-23B-M
Field	WELD COUNTY (NAD83,TRUE NORTH)	Wellbore	TROUDT 1N-23B-M AWP
Facility	SEC.27-T06N-R66W		

## WELLPATH DATA (176 stations)

MD [ft]	Inclination [°]	Azimuth [°]	TVD [ft]	Vert Sect [ft]	North [ft]	East [ft]	Latitude	Longitude	DLS [°/100ft]	Comments
5288.00	30.350	11.730	4943.37	666.33	1288.99	304.14	40°28'05.268"N	104°45'58.979"W	0.74	
5377.00	31.850	14.340	5019.58	689.31	1333.76	314.52	40°28'05.711"N	104°45'58.845"W	2.27	
5466.00	29.200	12.750	5096.24	712.25	1377.70	325.13	40°28'06.145"N	104°45'58.707"W	3.11	
5556.00	30.040	14.870	5174.48	735.00	1420.89	335.76	40°28'06.571"N	104°45'58.570"W	1.49	
5645.00	31.600	15.490	5250.91	759.24	1464.89	347.71	40°28'07.006"N	104°45'58.415"W	1.79	
5735.00	29.340	17.550	5328.48	784.37	1508.64	360.65	40°28'07.439"N	104°45'58.248"W	2.77	
5824.00	29.850	23.090	5405.88	810.96	1549.82	375.92	40°28'07.846"N	104°45'58.050"W	3.13	
5914.00	32.250	17.300	5483.00	838.88	1593.36	391.85	40°28'08.276"N	104°45'57.844"W	4.25	
6003.00	34.190	19.570	5557.45	867.12	1639.60	407.29	40°28'08.733"N	104°45'57.644"W	2.59	
6107.00	35.100	17.250	5643.01	901.30	1695.69	425.94	40°28'09.287"N	104°45'57.403"W	1.54	
6197.00	33.050	14.230	5717.56	928.54	1744.20	439.65	40°28'09.766"N	104°45'57.225"W	2.95	
6286.00	33.600	10.180	5791.94	952.33	1791.97	449.97	40°28'10.238"N	104°45'57.092"W	2.57	
6375.00	33.280	7.900	5866.21	973.80	1840.40	457.68	40°28'10.717"N	104°45'56.992"W	1.46	
6465.00	31.920	8.120	5942.03	994.25	1888.41	464.44	40°28'11.191"N	104°45'56.905"W	1.52	
6554.00	32.010	13.440	6017.55	1016.14	1934.66	473.24	40°28'11.648"N	104°45'56.791"W	3.17	
6644.00	33.130	16.200	6093.40	1041.65	1981.48	485.65	40°28'12.111"N	104°45'56.630"W	2.07	
6733.00	34.610	16.200	6167.29	1068.75	2029.11	499.49	40°28'12.582"N	104°45'56.451"W	1.66	
6823.00	34.000	15.270	6241.64	1096.13	2077.93	513.25	40°28'13.064"N	104°45'56.273"W	0.89	
6912.00	33.530	14.610	6315.62	1122.25	2125.72	526.00	40°28'13.536"N	104°45'56.108"W	0.67	
7002.00	33.230	12.730	6390.78	1147.46	2173.83	537.70	40°28'14.012"N	104°45'55.957"W	1.20	
7091.00	33.400	12.780	6465.15	1171.67	2221.51	548.50	40°28'14.483"N	104°45'55.817"W	0.19	
7180.00	32.420	17.240	6539.88	1197.21	2268.19	560.99	40°28'14.944"N	104°45'55.655"W	2.94	
7270.00	34.330	28.110	6615.10	1228.75	2313.66	580.11	40°28'15.393"N	104°45'55.408"W	6.97	
7359.00	37.490	38.100	6687.24	1268.75	2357.16	608.68	40°28'15.823"N	104°45'55.038"W	7.47	
7449.00	39.850	44.780	6757.54	1316.61	2399.20	645.92	40°28'16.239"N	104°45'54.557"W	5.32	
7538.00	44.890	53.660	6823.33	1371.43	2438.11	691.37	40°28'16.623"N	104°45'53.968"W	8.78	
7628.00	50.960	55.760	6883.61	1434.82	2476.64	745.90	40°28'17.004"N	104°45'53.263"W	6.96	
7697.00	54.920	63.810	6925.23	1488.34	2504.22	793.45	40°28'17.276"N	104°45'52.647"W	10.93	
7787.00	65.260	77.640	6970.21	1565.92	2529.38	866.89	40°28'17.525"N	104°45'51.697"W	17.56	
7876.00	76.770	83.690	6999.14	1649.13	2542.84	949.77	40°28'17.658"N	104°45'50.625"W	14.44	



# Actual Wellpath Report

TROUDT 1N-23B-M AWP

Page 5 of 10



## REFERENCE WELLPATH IDENTIFICATION

Operator	SRC ENERGY	Slot	SLOT#04 TROUDT 1N-23B-M (760'FNL & 1640'FWL, SEC.27)
Area	COLORADO	Well	TROUDT 1N-23B-M
Field	WELD COUNTY (NAD83,TRUE NORTH)	Wellbore	TROUDT 1N-23B-M AWP
Facility	SEC.27-T06N-R66W		

## WELLPATH DATA (176 stations)

MD [ft]	Inclination [°]	Azimuth [°]	TVD [ft]	Vert Sect [ft]	North [ft]	East [ft]	Latitude	Longitude	DLS [°/100ft]	Comments
7966.00	85.900	84.010	7012.69	1736.44	2552.36	1038.14	40°28'17.752"N	104°45'49.481"W	10.15	
8055.00	90.340	83.600	7015.60	1823.81	2561.96	1126.55	40°28'17.847"N	104°45'48.337"W	5.01	LANDING POINT (1809'FSL & 2593'FEL, SEC.22)
8145.00	90.250	84.640	7015.14	1912.14	2571.18	1216.07	40°28'17.938"N	104°45'47.179"W	1.16	
8234.00	90.180	85.950	7014.81	1999.12	2578.48	1304.77	40°28'18.010"N	104°45'46.031"W	1.47	
8324.00	90.340	87.090	7014.40	2086.65	2583.94	1394.60	40°28'18.064"N	104°45'44.869"W	1.28	
8413.00	90.180	88.480	7013.99	2172.73	2587.38	1483.53	40°28'18.098"N	104°45'43.718"W	1.57	
8503.00	90.280	89.050	7013.63	2259.37	2589.32	1573.51	40°28'18.117"N	104°45'42.554"W	0.64	
8592.00	90.460	89.980	7013.06	2344.73	2590.08	1662.50	40°28'18.124"N	104°45'41.403"W	1.06	
8682.00	90.180	90.560	7012.56	2430.70	2589.65	1752.50	40°28'18.120"N	104°45'40.238"W	0.72	
8772.00	90.370	90.040	7012.12	2516.66	2589.18	1842.50	40°28'18.115"N	104°45'39.074"W	0.62	
8861.00	90.830	90.390	7011.19	2601.70	2588.85	1931.49	40°28'18.112"N	104°45'37.922"W	0.65	
8950.00	90.860	90.760	7009.88	2686.57	2587.95	2020.48	40°28'18.103"N	104°45'36.771"W	0.42	
9040.00	90.680	91.600	7008.67	2772.10	2586.10	2110.45	40°28'18.085"N	104°45'35.607"W	0.95	
9129.00	90.710	91.140	7007.59	2856.59	2583.97	2199.42	40°28'18.064"N	104°45'34.456"W	0.52	
9219.00	90.800	90.160	7006.40	2942.38	2582.95	2289.40	40°28'18.053"N	104°45'33.291"W	1.09	
9308.00	90.710	89.830	7005.23	3027.52	2582.96	2378.40	40°28'18.053"N	104°45'32.140"W	0.38	
9397.00	90.800	89.840	7004.06	3112.73	2583.22	2467.39	40°28'18.056"N	104°45'30.988"W	0.10	
9487.00	90.580	89.470	7002.98	3198.97	2583.76	2557.38	40°28'18.061"N	104°45'29.824"W	0.48	
9576.00	90.800	89.110	7001.90	3284.43	2584.86	2646.37	40°28'18.072"N	104°45'28.672"W	0.47	
9666.00	90.830	89.270	7000.62	3370.88	2586.13	2736.35	40°28'18.084"N	104°45'27.508"W	0.18	
9755.00	90.830	89.860	6999.33	3456.20	2586.81	2825.34	40°28'18.091"N	104°45'26.357"W	0.66	
9844.00	90.180	90.070	6998.55	3541.36	2586.86	2914.33	40°28'18.091"N	104°45'25.205"W	0.77	
9934.00	90.180	90.710	6998.27	3627.28	2586.25	3004.33	40°28'18.085"N	104°45'24.041"W	0.71	
10023.00	90.220	91.290	6997.96	3711.95	2584.70	3093.31	40°28'18.070"N	104°45'22.889"W	0.65	
10113.00	90.310	93.060	6997.54	3796.99	2581.28	3183.24	40°28'18.036"N	104°45'21.726"W	1.97	
10202.00	90.150	93.110	6997.18	3880.61	2576.49	3272.11	40°28'17.989"N	104°45'20.576"W	0.19	
10292.00	90.220	91.840	6996.89	3965.50	2572.61	3362.03	40°28'17.950"N	104°45'19.412"W	1.41	
10381.00	90.250	88.630	6996.53	4050.52	2572.24	3451.02	40°28'17.946"N	104°45'18.261"W	3.61	
10471.00	90.180	86.530	6996.19	4137.65	2576.04	3540.93	40°28'17.984"N	104°45'17.098"W	2.33	
10560.00	90.120	87.070	6995.96	4224.10	2581.01	3629.79	40°28'18.033"N	104°45'15.948"W	0.61	





# Actual Wellpath Report

TROUDT 1N-23B-M AWP

Page 6 of 10



## REFERENCE WELLPATH IDENTIFICATION

Operator	SRC ENERGY	Slot	SLOT#04 TROUDT 1N-23B-M (760'FNL & 1640'FWL, SEC.27)
Area	COLORADO	Well	TROUDT 1N-23B-M
Field	WELD COUNTY (NAD83,TRUE NORTH)	Wellbore	TROUDT 1N-23B-M AWP
Facility	SEC.27-T06N-R66W		

## WELLPATH DATA (176 stations)

MD [ft]	Inclination [°]	Azimuth [°]	TVD [ft]	Vert Sect [ft]	North [ft]	East [ft]	Latitude	Longitude	DLS [°/100ft]	Comments
10650.00	90.280	88.950	6995.64	4311.05	2584.13	3719.73	40°28'18.063"N	104°45'14.784"W	2.10	
10739.00	89.570	89.110	6995.76	4396.62	2585.64	3808.72	40°28'18.078"N	104°45'13.633"W	0.82	
10828.00	89.750	90.280	6996.29	4481.90	2586.11	3897.71	40°28'18.083"N	104°45'12.481"W	1.33	
10918.00	89.480	89.800	6996.89	4567.98	2586.05	3987.71	40°28'18.082"N	104°45'11.317"W	0.61	
11007.00	90.060	89.950	6997.25	4653.18	2586.25	4076.71	40°28'18.084"N	104°45'10.165"W	0.67	
11097.00	89.970	90.160	6997.22	4739.25	2586.16	4166.71	40°28'18.083"N	104°45'09.001"W	0.25	
11186.00	89.780	90.020	6997.42	4824.35	2586.02	4255.71	40°28'18.081"N	104°45'07.849"W	0.27	
11276.00	89.820	93.390	6997.73	4909.62	2583.34	4345.66	40°28'18.055"N	104°45'06.685"W	3.74	
11365.00	89.940	93.980	6997.92	4992.92	2577.62	4434.47	40°28'17.998"N	104°45'05.536"W	0.68	
11455.00	89.940	94.370	6998.01	5076.88	2571.07	4524.23	40°28'17.933"N	104°45'04.375"W	0.43	
11544.00	89.910	93.170	6998.13	5160.13	2565.22	4613.04	40°28'17.875"N	104°45'03.225"W	1.35	
11633.00	89.910	91.980	6998.27	5244.02	2561.22	4701.95	40°28'17.835"N	104°45'02.075"W	1.34	
11722.00	89.660	90.150	6998.60	5328.67	2559.56	4790.93	40°28'17.819"N	104°45'00.924"W	2.08	
11812.00	89.690	89.040	6999.11	5414.94	2560.20	4880.92	40°28'17.825"N	104°44'59.759"W	1.23	
11901.00	89.720	87.990	6999.57	5500.73	2562.51	4969.89	40°28'17.848"N	104°44'58.608"W	1.18	
11991.00	89.970	88.610	6999.82	5587.57	2565.18	5059.85	40°28'17.874"N	104°44'57.444"W	0.74	
12080.00	89.820	87.120	6999.98	5673.61	2568.49	5148.78	40°28'17.906"N	104°44'56.293"W	1.68	
12170.00	89.910	85.610	7000.19	5761.20	2574.20	5238.60	40°28'17.962"N	104°44'55.131"W	1.68	
12259.00	89.820	86.620	7000.40	5847.90	2580.23	5327.39	40°28'18.022"N	104°44'53.982"W	1.14	
12348.00	89.600	87.940	7000.85	5934.17	2584.45	5416.29	40°28'18.063"N	104°44'52.832"W	1.50	
12438.00	89.880	88.600	7001.26	6021.02	2587.17	5506.25	40°28'18.090"N	104°44'51.668"W	0.80	
12528.00	89.940	88.120	7001.40	6107.83	2589.74	5596.21	40°28'18.115"N	104°44'50.504"W	0.54	
12617.00	89.910	88.330	7001.52	6193.74	2592.50	5685.17	40°28'18.142"N	104°44'49.353"W	0.24	
12706.00	89.750	88.050	7001.78	6279.66	2595.31	5774.12	40°28'18.170"N	104°44'48.202"W	0.36	
12797.00	89.850	87.760	7002.10	6367.62	2598.64	5865.06	40°28'18.203"N	104°44'47.025"W	0.34	
12887.00	89.720	88.520	7002.44	6454.53	2601.56	5955.01	40°28'18.231"N	104°44'45.861"W	0.86	
12976.00	90.030	89.650	7002.63	6540.07	2602.98	6044.00	40°28'18.245"N	104°44'44.710"W	1.32	
13066.00	89.820	89.740	7002.75	6626.31	2603.46	6134.00	40°28'18.250"N	104°44'43.546"W	0.25	
13155.00	90.220	92.240	7002.72	6710.98	2601.92	6222.98	40°28'18.234"N	104°44'42.394"W	2.84	
13245.00	89.820	95.730	7002.69	6795.04	2595.67	6312.75	40°28'18.172"N	104°44'41.233"W	3.90	



# Actual Wellpath Report

TROUDT 1N-23B-M AWP

Page 7 of 10



## REFERENCE WELLPATH IDENTIFICATION

Operator	SRC ENERGY	Slot	SLOT#04 TROUDT 1N-23B-M (760'FNL & 1640'FWL, SEC.27)
Area	COLORADO	Well	TROUDT 1N-23B-M
Field	WELD COUNTY (NAD83,TRUE NORTH)	Wellbore	TROUDT 1N-23B-M AWP
Facility	SEC.27-T06N-R66W		

## WELLPATH DATA (176 stations)

MD [ft]	Inclination [°]	Azimuth [°]	TVD [ft]	Vert Sect [ft]	North [ft]	East [ft]	Latitude	Longitude	DLS [°/100ft]	Comments
13334.00	89.750	98.020	7003.02	6876.46	2585.02	6401.10	40°28'18.067"N	104°44'40.090"W	2.57	
13424.00	89.850	97.560	7003.34	6958.21	2572.82	6490.27	40°28'17.946"N	104°44'38.936"W	0.52	
13513.00	89.750	99.760	7003.65	7038.47	2559.42	6578.25	40°28'17.813"N	104°44'37.797"W	2.47	
13603.00	89.820	94.850	7003.98	7120.52	2547.98	6667.49	40°28'17.700"N	104°44'36.643"W	5.46	
13692.00	90.890	88.890	7003.43	7204.73	2545.08	6756.40	40°28'17.671"N	104°44'35.492"W	6.80	
13782.00	91.380	83.980	7001.65	7292.24	2550.67	6846.18	40°28'17.726"N	104°44'34.331"W	5.48	
13871.00	91.420	80.850	6999.47	7380.03	2562.41	6934.36	40°28'17.842"N	104°44'33.190"W	3.52	
13961.00	90.800	82.270	6997.73	7469.02	2575.62	7023.37	40°28'17.972"N	104°44'32.038"W	1.72	
14050.00	90.950	86.360	6996.37	7556.28	2584.43	7111.90	40°28'18.059"N	104°44'30.892"W	4.60	
14140.00	91.170	89.010	6994.70	7643.35	2588.07	7201.81	40°28'18.095"N	104°44'29.729"W	2.95	
14229.00	91.230	89.090	6992.84	7728.89	2589.54	7290.77	40°28'18.109"N	104°44'28.578"W	0.11	
14319.00	91.020	88.970	6991.07	7815.40	2591.06	7380.74	40°28'18.124"N	104°44'27.414"W	0.27	
14408.00	91.080	87.850	6989.44	7901.22	2593.53	7469.69	40°28'18.148"N	104°44'26.263"W	1.26	
14497.00	91.230	87.050	6987.65	7987.41	2597.49	7558.59	40°28'18.187"N	104°44'25.113"W	0.91	
14587.00	92.120	88.750	6985.02	8074.37	2600.79	7648.48	40°28'18.219"N	104°44'23.949"W	2.13	
14676.00	92.000	91.060	6981.82	8159.49	2600.94	7737.42	40°28'18.220"N	104°44'22.799"W	2.60	
14766.00	92.000	92.560	6978.68	8244.67	2598.10	7827.32	40°28'18.192"N	104°44'21.636"W	1.67	
14855.00	92.220	92.520	6975.40	8328.52	2594.15	7916.17	40°28'18.153"N	104°44'20.486"W	0.25	
14945.00	92.090	93.790	6972.02	8412.99	2589.20	8005.97	40°28'18.103"N	104°44'19.324"W	1.42	
15034.00	92.150	93.570	6968.72	8496.23	2583.50	8094.72	40°28'18.047"N	104°44'18.176"W	0.26	
15123.00	91.140	92.910	6966.17	8579.74	2578.47	8183.54	40°28'17.997"N	104°44'17.026"W	1.36	
15213.00	91.170	93.250	6964.35	8664.29	2573.63	8273.39	40°28'17.949"N	104°44'15.864"W	0.38	
15302.00	90.890	95.320	6962.75	8747.24	2566.98	8362.13	40°28'17.883"N	104°44'14.716"W	2.35	
15392.00	90.920	92.690	6961.33	8831.28	2560.70	8451.89	40°28'17.820"N	104°44'13.554"W	2.92	
15481.00	91.080	87.840	6959.78	8916.26	2560.29	8540.85	40°28'17.816"N	104°44'12.403"W	5.45	LAST BHI SURVEY (1832'FSL & 523'FEL, SEC.23)
15505.00	91.080	87.840	6959.33	8939.46	2561.19	8564.82	40°28'17.825"N	104°44'12.093"W	0.00	PROJ TO BIT (1833'FSL & 499'FEL, SEC.23)





# Actual Wellpath Report

TROUDT 1N-23B-M AWP

Page 8 of 10



## REFERENCE WELLPATH IDENTIFICATION

Operator	SRC ENERGY	Slot	SLOT#04 TROUDT 1N-23B-M (760'FNL & 1640'FWL, SEC.27)
Area	COLORADO	Well	TROUDT 1N-23B-M
Field	WELD COUNTY (NAD83,TRUE NORTH)	Wellbore	TROUDT 1N-23B-M AWB
Facility	SEC.27-T06N-R66W		

## HOLE & CASING SECTIONS - Ref Wellbore: TROUDT 1N-23B-M AWB Ref Wellpath: TROUDT 1N-23B-M AWP

String/Diameter	Start MD [ft]	End MD [ft]	Interval [ft]	Start TVD [ft]	End TVD [ft]	Start N/S [ft]	Start E/W [ft]	End N/S [ft]	End E/W [ft]
9.625in Casing Surface	25.00	1827.00	1802.00	25.00	1825.10	0.00	0.00	0.28	-70.35

## TARGETS

Name	TVD [ft]	North [ft]	East [ft]	Grid East [US ft]	Grid North [US ft]	Latitude	Longitude	Shape
SEC.23-T06N-R66W	-8.00	4231.31	-1912.37	3201871.60	1417148.27	40°28'34.342"N	104°46'27.660"W	polygon
SEC.22-T06N-R66W	6.00	1412.74	-8054.19	3195753.51	1414279.17	40°28'06.478"N	104°47'47.123"W	polygon
SEC.27-T06N-R66W	19.00	-4766.34	1030.36	3204888.45	1408175.58	40°27'05.432"N	104°45'49.586"W	polygon
SEC.28-T06N-R66W	19.00	-4766.34	1030.36	3204888.45	1408175.58	40°27'05.432"N	104°45'49.586"W	polygon
SEC.26-T06N-R66W	38.00	-4763.01	630.14	3204488.23	1408175.60	40°27'05.465"N	104°45'54.763"W	polygon
SEC.29-T06N-R66W EAST HALF	50.00	0.02	-45.05	3203773.74	1412932.71	40°27'52.531"N	104°46'03.497"W	polygon
TROUDT 1N-23B-M BHL ON PLAT (1876'FSL & 510'FEL, SEC.23)	6953.00	2603.82	8553.54	3212350.20	1415607.35	40°28'18.246"N	104°44'12.239"W	circle
TROUDT 1N-23B-M BHL REV-2 (1826'FSL & 510'FEL, SEC.23)	6953.00	2603.82	8553.53	3212350.19	1415607.35	40°28'18.246"N	104°44'12.239"W	circle
TROUDT 1N-23B-M TOP OF PROD (1869'FSL & 2522'FEL, SEC.22)	6989.00	2622.04	1197.52	3204994.56	1415564.80	40°28'18.440"N	104°45'47.419"W	circle
TROUDT 1N-23B-M TOP REV-2 (1803'FSL & 2522'FEL, SEC.22)	6989.00	2621.99	1197.53	3204994.57	1415564.76	40°28'18.440"N	104°45'47.419"W	circle



# Actual Wellpath Report

TROUDT 1N-23B-M AWP  
Page 9 of 10



## REFERENCE WELLPATH IDENTIFICATION

Operator	SRC ENERGY	Slot	SLOT#04 TROUDT 1N-23B-M (760'FNL & 1640'FWL, SEC.27)
Area	COLORADO	Well	TROUDT 1N-23B-M
Field	WELD COUNTY (NAD83,TRUE NORTH)	Wellbore	TROUDT 1N-23B-M AWB
Facility	SEC.27-T06N-R66W		

WELLPATH COMPOSITION - Ref Wellbore: TROUDT 1N-23B-M AWB      Ref Wellpath: TROUDT 1N-23B-M AWP				
Start MD [ft]	End MD [ft]	Positional Uncertainty Model	Log Name/Comment	Wellbore
25.00	1776.00	BHI NaviTrak (Standard)	13 1/2" SURFACE SECTION <88-1755>	TROUDT 1N-23B-M AWB
1776.00	7628.00	BHI NaviTrak (IFR1, Rotating)	8 1/2" NAVITRAK SURVEYS <1889-7628>	TROUDT 1N-23B-M AWB
7628.00	15481.00	BHI AutoTrak Curve (Standard)	8 1/2" AT-CURVE SURVEYS <7697-15481>	TROUDT 1N-23B-M AWB
15481.00	15505.00	Blind Drilling (std)	Projection to bit	TROUDT 1N-23B-M AWB



# Actual Wellpath Report

TROUDT 1N-23B-M AWP

Page 10 of 10



## REFERENCE WELLPATH IDENTIFICATION

Operator	SRC ENERGY	Slot	SLOT#04 TROUDT 1N-23B-M (760'FNL & 1640'FWL, SEC.27)
Area	COLORADO	Well	TROUDT 1N-23B-M
Field	WELD COUNTY (NAD83,TRUE NORTH)	Wellbore	TROUDT 1N-23B-M AWB
Facility	SEC.27-T06N-R66W		

## WELLPATH COMMENTS

MD [ft]	Inclination [°]	Azimuth [°]	TVD [ft]	Comment
8055.00	90.340	83.600	7015.60	LANDING POINT (1809'FSL & 2593'FEL, SEC.22)
15481.00	91.080	87.840	6959.78	LAST BHI SURVEY (1832'FSL & 523'FEL, SEC.23)
15505.00	91.080	87.840	6959.33	PROJ TO BIT (1833'FSL & 499'FEL, SEC.23)