

SRC ENERGY

Location: COLORADO Slot: SLOT#03 TROUDT 1N-23C-M (760'FNL & 1624'FWL, SEC.27)
 Field: WELD COUNTY (NAD83, TRUE NORTH) Well: TROUDT 1N-23C-M
 Facility: SEC.27-T06N-R66W Wellbore: TROUDT 1N-23C-M PWB

Plot reference wellpath is TROUDT 1N-23C-M (REV-C.0) PWP	Grid System: NAD83 / Lambert Colorado SP, Northern Zone (501), US feet
True vertical depths are referenced to PD 562 (25) (RKB)	North Reference: True north
Measured depths are referenced to PD 562 (25) (RKB)	Scale: True distance
PD 562 (25) (RKB) to Mean Sea Level: 4744 feet	Depths are in feet
Mean Sea Level to Mud line (At Slot: SLOT#03 TROUDT 1N-23C-M (760'FNL & 1624'FWL, SEC.27)): 0 feet	Created by: robale01 on 2018-10-25
Coordinates are in feet referenced to Slot	Database: WA DENVER



SRC ENERGY

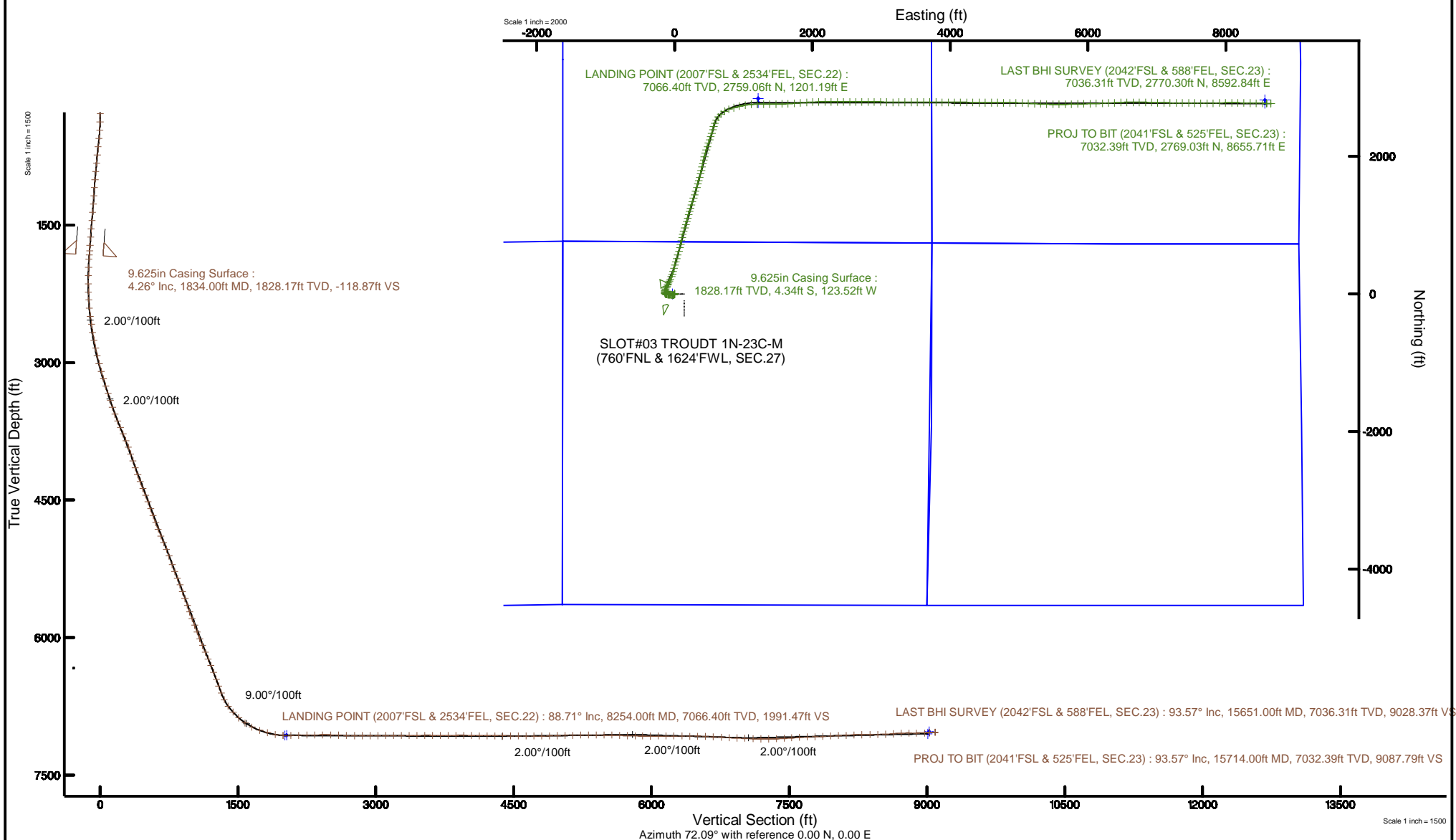



Actual Wellpath Report

TROUDT 1N-23C-M AWP

Page 1 of 10



REFERENCE WELLPATH IDENTIFICATION

Operator	SRC ENERGY	Slot	SLOT#03 TROUDT 1N-23C-M (760'FNL & 1624'FWL, SEC.27)
Area	COLORADO	Well	TROUDT 1N-23C-M
Field	WELD COUNTY (NAD83,TRUE NORTH)	Wellbore	TROUDT 1N-23C-M AWB
Facility	SEC.27-T06N-R66W		

REPORT SETUP INFORMATION

Projection System	NAD83 / Lambert Colorado SP, Northern Zone (501), US feet	Software System	WellArchitect® 5.1
North Reference	True	User	Hanisab
Scale	0.999964	Report Generated	10/29/2018 at 9:36:15 PM
Convergence at slot	0.47° East	Database/Source file	WA DENVER/TROUDT_1N-23C-M_AWP.xml

WELLPATH LOCATION

	Local coordinates		Grid coordinates		Geographic coordinates	
	North[ft]	East[ft]	Easting[US ft]	Northing[US ft]	Latitude	Longitude
Slot Location	-0.02	30.05	3203803.79	1412932.94	40°27'52.531"N	104°46'03.108"W
Facility Reference Pt			3203773.74	1412932.71	40°27'52.531"N	104°46'03.497"W
Field Reference Pt			3171284.48	1426358.81	40°30'07.643"N	104°53'02.634"W

WELLPATH DATUM

Calculation method	Minimum curvature	PD 562 (25') (RKB) to Facility Vertical Datum	4744.00ft
Horizontal Reference Pt	Slot	PD 562 (25') (RKB) to Mean Sea Level	4744.00ft
Vertical Reference Pt	PD 562 (25') (RKB)	PD 562 (25') (RKB) to Mud Line at Slot (SLOT#03 TROUDT 1N-23C-M (760'FNL & 1624'FWL, SEC.27))	4744.00ft
MD Reference Pt	PD 562 (25') (RKB)	Section Origin	N 0.00, E 0.00 ft
Field Vertical Reference	Mean Sea Level	Section Azimuth	72.09°



Actual Wellpath Report

TROUDT 1N-23C-M AWP

Page 2 of 10



REFERENCE WELLPATH IDENTIFICATION

Operator	SRC ENERGY	Slot	SLOT#03 TROUDT 1N-23C-M (760'FNL & 1624'FWL, SEC.27)
Area	COLORADO	Well	TROUDT 1N-23C-M
Field	WELD COUNTY (NAD83,TRUE NORTH)	Wellbore	TROUDT 1N-23C-M AWP
Facility	SEC.27-T06N-R66W		

WELLPATH DATA (178 stations) † = interpolated/extrapolated station

MD [ft]	Inclination [°]	Azimuth [°]	TVD [ft]	Vert Sect [ft]	North [ft]	East [ft]	Latitude	Longitude	DLS [°/100ft]	Comments
0.00†	0.000	132.030	0.00	0.00	0.00	0.00	40°27'52.531"N	104°46'03.108"W	0.00	
25.00	0.000	132.030	25.00	0.00	0.00	0.00	40°27'52.531"N	104°46'03.108"W	0.00	
109.00	0.370	132.030	109.00	0.14	-0.18	0.20	40°27'52.529"N	104°46'03.105"W	0.44	
197.00	0.780	162.690	196.99	0.27	-0.94	0.59	40°27'52.522"N	104°46'03.100"W	0.57	
287.00	1.280	175.930	286.98	0.03	-2.53	0.84	40°27'52.506"N	104°46'03.097"W	0.61	
377.00	2.450	200.570	376.93	-1.41	-5.34	0.24	40°27'52.478"N	104°46'03.105"W	1.55	
467.00	4.300	227.810	466.78	-5.69	-9.40	-2.94	40°27'52.438"N	104°46'03.146"W	2.67	
557.00	5.780	249.360	556.44	-13.29	-13.27	-9.68	40°27'52.400"N	104°46'03.233"W	2.64	
647.00	5.970	261.760	645.97	-22.43	-15.53	-18.55	40°27'52.377"N	104°46'03.348"W	1.42	
737.00	6.270	277.560	735.46	-31.48	-15.56	-28.06	40°27'52.377"N	104°46'03.471"W	1.89	
827.00	6.290	275.830	824.92	-40.43	-14.41	-37.83	40°27'52.389"N	104°46'03.597"W	0.21	
917.00	5.470	277.220	914.45	-48.83	-13.37	-46.99	40°27'52.399"N	104°46'03.716"W	0.92	
1007.00	5.510	278.610	1004.03	-56.58	-12.19	-55.52	40°27'52.411"N	104°46'03.826"W	0.15	
1097.00	4.870	282.320	1093.66	-63.75	-10.72	-63.53	40°27'52.425"N	104°46'03.930"W	0.80	
1187.00	4.220	277.960	1183.38	-70.03	-9.45	-70.54	40°27'52.438"N	104°46'04.021"W	0.82	
1277.00	4.160	275.030	1273.14	-76.01	-8.71	-77.07	40°27'52.445"N	104°46'04.105"W	0.25	
1367.00	4.990	275.590	1362.85	-82.61	-8.04	-84.22	40°27'52.452"N	104°46'04.198"W	0.92	
1457.00	5.420	273.420	1452.48	-90.16	-7.40	-92.36	40°27'52.458"N	104°46'04.303"W	0.53	
1547.00	4.990	275.760	1542.11	-97.70	-6.76	-100.49	40°27'52.464"N	104°46'04.408"W	0.53	
1637.00	4.830	275.450	1631.78	-104.76	-6.00	-108.16	40°27'52.472"N	104°46'04.507"W	0.18	
1727.00	4.470	276.010	1721.48	-111.45	-5.28	-115.42	40°27'52.479"N	104°46'04.601"W	0.40	
1785.00	4.370	277.470	1779.31	-115.51	-4.75	-119.86	40°27'52.484"N	104°46'04.659"W	0.26	
1880.00	4.170	273.230	1874.05	-122.00	-4.09	-126.89	40°27'52.491"N	104°46'04.750"W	0.39	
1969.00	5.220	324.800	1962.78	-126.23	-0.60	-132.46	40°27'52.525"N	104°46'04.822"W	4.71	
2058.00	5.160	326.420	2051.42	-128.51	6.05	-137.01	40°27'52.591"N	104°46'04.881"W	0.18	
2148.00	5.750	348.950	2141.02	-129.06	13.84	-140.11	40°27'52.668"N	104°46'04.921"W	2.45	
2237.00	5.480	350.200	2229.59	-127.93	22.41	-141.69	40°27'52.752"N	104°46'04.941"W	0.33	
2326.00	7.650	7.630	2318.01	-124.78	32.47	-141.63	40°27'52.852"N	104°46'04.940"W	3.28	
2416.00	9.040	18.100	2407.06	-118.04	45.13	-138.63	40°27'52.977"N	104°46'04.902"W	2.28	
2505.00	11.410	24.600	2494.65	-107.98	59.78	-132.80	40°27'53.122"N	104°46'04.826"W	2.96	



Actual Wellpath Report

TROUDT 1N-23C-M AWP

Page 3 of 10



REFERENCE WELLPATH IDENTIFICATION

Operator	SRC ENERGY	Slot	SLOT#03 TROUDT 1N-23C-M (760'FNL & 1624'FWL, SEC.27)
Area	COLORADO	Well	TROUDT 1N-23C-M
Field	WELD COUNTY (NAD83,TRUE NORTH)	Wellbore	TROUDT 1N-23C-M AWP
Facility	SEC.27-T06N-R66W		

WELLPATH DATA (178 stations)

MD [ft]	Inclination [°]	Azimuth [°]	TVD [ft]	Vert Sect [ft]	North [ft]	East [ft]	Latitude	Longitude	DLS [°/100ft]	Comments
2595.00	11.190	24.040	2582.90	-96.12	75.85	-125.53	40°27'53.281"N	104°46'04.732"W	0.27	
2684.00	14.240	25.140	2669.71	-82.87	93.65	-117.36	40°27'53.456"N	104°46'04.626"W	3.44	
2774.00	14.590	25.220	2756.88	-67.57	113.93	-107.83	40°27'53.657"N	104°46'04.503"W	0.39	
2863.00	16.070	27.760	2842.71	-51.09	134.97	-97.32	40°27'53.865"N	104°46'04.367"W	1.83	
2953.00	18.380	25.830	2928.67	-32.37	158.77	-85.33	40°27'54.100"N	104°46'04.212"W	2.64	
3042.00	20.910	25.700	3012.48	-11.71	185.71	-72.33	40°27'54.366"N	104°46'04.044"W	2.84	
3131.00	23.230	24.480	3094.95	11.08	216.00	-58.16	40°27'54.665"N	104°46'03.861"W	2.66	
3221.00	25.550	21.200	3176.92	35.30	250.26	-43.79	40°27'55.004"N	104°46'03.675"W	2.98	
3311.00	27.840	17.160	3257.33	59.62	288.44	-30.57	40°27'55.381"N	104°46'03.503"W	3.25	
3400.00	29.490	16.200	3335.42	83.85	329.34	-18.32	40°27'55.785"N	104°46'03.345"W	1.92	
3490.00	30.340	14.940	3413.43	108.60	372.57	-6.28	40°27'56.213"N	104°46'03.189"W	1.17	
3579.00	31.820	14.450	3489.65	133.35	417.01	5.37	40°27'56.652"N	104°46'03.039"W	1.69	
3668.00	33.770	16.530	3564.46	159.90	463.45	18.26	40°27'57.111"N	104°46'02.872"W	2.53	
3758.00	36.830	16.060	3637.91	189.13	513.37	32.85	40°27'57.604"N	104°46'02.683"W	3.41	
3847.00	37.580	15.980	3708.79	219.17	565.09	47.70	40°27'58.115"N	104°46'02.491"W	0.84	
3937.00	37.740	16.000	3780.04	249.84	617.95	62.84	40°27'58.637"N	104°46'02.295"W	0.18	
4026.00	36.990	13.630	3850.78	279.04	670.16	76.66	40°27'59.153"N	104°46'02.116"W	1.82	
4116.00	36.040	11.930	3923.11	306.38	722.38	88.52	40°27'59.669"N	104°46'01.963"W	1.54	
4205.00	33.900	12.970	3996.04	332.15	772.19	99.50	40°28'00.161"N	104°46'01.821"W	2.50	
4295.00	32.230	12.310	4071.46	357.11	820.10	110.25	40°28'00.635"N	104°46'01.682"W	1.90	
4384.00	30.790	14.770	4147.34	381.36	865.32	121.12	40°28'01.082"N	104°46'01.541"W	2.17	
4473.00	32.970	17.180	4222.91	407.58	910.49	134.08	40°28'01.528"N	104°46'01.373"W	2.84	
4563.00	32.670	17.020	4298.55	435.57	957.11	148.43	40°28'01.989"N	104°46'01.188"W	0.35	
4652.00	34.890	16.520	4372.52	463.72	1004.49	162.70	40°28'02.457"N	104°46'01.003"W	2.51	
4742.00	35.260	16.620	4446.17	493.00	1054.06	177.45	40°28'02.947"N	104°46'00.812"W	0.42	
4831.00	34.420	16.040	4519.22	521.61	1102.85	191.74	40°28'03.429"N	104°46'00.627"W	1.01	
4921.00	32.670	15.500	4594.23	549.19	1150.71	205.27	40°28'03.902"N	104°46'00.452"W	1.97	
5010.00	33.690	15.110	4668.72	575.87	1197.69	218.12	40°28'04.366"N	104°46'00.286"W	1.17	
5100.00	33.710	16.080	4743.59	603.44	1245.78	231.54	40°28'04.841"N	104°46'00.112"W	0.60	
5189.00	35.050	16.780	4817.04	631.79	1293.98	245.76	40°28'05.318"N	104°45'59.928"W	1.57	



Actual Wellpath Report

TROUDT 1N-23C-M AWP

Page 4 of 10



REFERENCE WELLPATH IDENTIFICATION

Operator	SRC ENERGY	Slot	SLOT#03 TROUDT 1N-23C-M (760'FNL & 1624'FWL, SEC.27)
Area	COLORADO	Well	TROUDT 1N-23C-M
Field	WELD COUNTY (NAD83,TRUE NORTH)	Wellbore	TROUDT 1N-23C-M AWP
Facility	SEC.27-T06N-R66W		

WELLPATH DATA (178 stations)

MD [ft]	Inclination [°]	Azimuth [°]	TVD [ft]	Vert Sect [ft]	North [ft]	East [ft]	Latitude	Longitude	DLS [°/100ft]	Comments
5279.00	34.570	16.570	4890.94	660.95	1343.20	260.51	40°28'05.804"N	104°45'59.737"W	0.55	
5368.00	36.110	17.660	4963.54	690.50	1392.39	275.66	40°28'06.290"N	104°45'59.541"W	1.87	
5457.00	35.490	17.130	5035.72	720.59	1442.07	291.23	40°28'06.781"N	104°45'59.340"W	0.78	
5547.00	33.420	16.120	5109.93	749.47	1490.86	305.81	40°28'07.263"N	104°45'59.151"W	2.39	
5660.00	32.660	16.050	5204.66	783.92	1550.05	322.88	40°28'07.848"N	104°45'58.930"W	0.67	
5749.00	34.290	15.830	5278.89	811.26	1597.26	336.36	40°28'08.314"N	104°45'58.756"W	1.84	
5839.00	35.740	15.980	5352.60	840.00	1646.92	350.51	40°28'08.805"N	104°45'58.573"W	1.61	
5928.00	34.940	14.810	5425.20	868.27	1696.55	364.18	40°28'09.295"N	104°45'58.396"W	1.18	
6018.00	33.540	13.210	5499.60	895.05	1745.67	376.45	40°28'09.781"N	104°45'58.237"W	1.85	
6107.00	35.210	14.830	5573.06	921.64	1794.42	388.64	40°28'10.263"N	104°45'58.080"W	2.14	
6197.00	34.330	13.190	5646.99	948.78	1844.21	401.07	40°28'10.755"N	104°45'57.919"W	1.43	
6286.00	35.050	10.810	5720.17	974.02	1893.75	411.59	40°28'11.244"N	104°45'57.783"W	1.72	
6375.00	36.820	12.760	5792.23	999.91	1944.87	422.27	40°28'11.749"N	104°45'57.644"W	2.37	
6465.00	35.780	14.310	5864.77	1027.70	1996.67	434.73	40°28'12.261"N	104°45'57.483"W	1.54	
6554.00	33.940	14.470	5937.79	1054.88	2045.94	447.37	40°28'12.748"N	104°45'57.319"W	2.07	
6644.00	34.860	18.340	6012.06	1083.55	2094.69	461.75	40°28'13.230"N	104°45'57.134"W	2.64	
6733.00	34.150	18.650	6085.40	1113.47	2142.50	477.74	40°28'13.702"N	104°45'56.927"W	0.82	
6823.00	35.730	18.850	6159.18	1144.24	2191.31	494.31	40°28'14.184"N	104°45'56.712"W	1.76	
6912.00	34.530	18.140	6231.97	1174.64	2239.87	510.56	40°28'14.664"N	104°45'56.502"W	1.42	
7002.00	35.620	17.660	6305.62	1204.90	2289.09	526.45	40°28'15.151"N	104°45'56.296"W	1.25	
7091.00	33.450	17.600	6378.93	1234.23	2337.17	541.73	40°28'15.626"N	104°45'56.099"W	2.44	
7180.00	34.850	15.130	6452.59	1262.34	2385.10	555.79	40°28'16.099"N	104°45'55.917"W	2.21	
7270.00	33.200	14.420	6527.18	1289.54	2433.79	568.64	40°28'16.580"N	104°45'55.750"W	1.89	
7359.00	32.210	20.230	6602.09	1317.23	2479.66	582.91	40°28'17.034"N	104°45'55.566"W	3.70	
7449.00	34.960	26.900	6677.08	1350.23	2525.19	602.88	40°28'17.484"N	104°45'55.307"W	5.11	
7538.00	41.740	37.150	6746.91	1392.58	2571.64	632.37	40°28'17.943"N	104°45'54.926"W	10.42	
7628.00	44.510	47.040	6812.67	1445.79	2617.08	673.61	40°28'18.392"N	104°45'54.392"W	8.11	
7717.00	48.420	59.200	6874.08	1506.64	2655.47	725.15	40°28'18.771"N	104°45'53.725"W	10.82	
7807.00	55.040	70.780	6929.91	1576.55	2684.94	789.10	40°28'19.062"N	104°45'52.898"W	12.48	
7896.00	63.750	74.170	6975.18	1653.06	2707.89	862.09	40°28'19.289"N	104°45'51.953"W	10.32	



Actual Wellpath Report

TROUDT 1N-23C-M AWP

Page 5 of 10



REFERENCE WELLPATH IDENTIFICATION

Operator	SRC ENERGY	Slot	SLOT#03 TROUDT 1N-23C-M (760'FNL & 1624'FWL, SEC.27)
Area	COLORADO	Well	TROUDT 1N-23C-M
Field	WELD COUNTY (NAD83,TRUE NORTH)	Wellbore	TROUDT 1N-23C-M AWP
Facility	SEC.27-T06N-R66W		

WELLPATH DATA (178 stations)

MD [ft]	Inclination [°]	Azimuth [°]	TVD [ft]	Vert Sect [ft]	North [ft]	East [ft]	Latitude	Longitude	DLS [°/100ft]	Comments
7986.00	71.460	77.250	7009.45	1736.03	2728.35	942.67	40°28'19.491"N	104°45'50.911"W	9.13	
8075.00	74.590	80.410	7035.44	1820.54	2744.81	1026.16	40°28'19.654"N	104°45'49.830"W	4.89	
8165.00	78.430	85.450	7056.45	1906.44	2755.55	1112.97	40°28'19.760"N	104°45'48.707"W	6.92	
8254.00	88.710	89.950	7066.40	1991.47	2759.06	1201.19	40°28'19.794"N	104°45'47.566"W	12.59	LANDING POINT (2007'FSL & 2534'FEL, SEC.22)
8344.00	90.890	89.990	7066.72	2077.12	2759.10	1291.19	40°28'19.795"N	104°45'46.401"W	2.42	
8433.00	91.540	89.750	7064.83	2161.85	2759.31	1380.17	40°28'19.797"N	104°45'45.250"W	0.78	
8523.00	90.400	88.840	7063.31	2247.80	2760.41	1470.15	40°28'19.808"N	104°45'44.086"W	1.62	
8612.00	90.950	88.670	7062.26	2333.06	2762.35	1559.12	40°28'19.827"N	104°45'42.934"W	0.65	
8702.00	90.580	86.530	7061.06	2419.77	2766.12	1649.03	40°28'19.864"N	104°45'41.771"W	2.41	
8792.00	88.890	85.970	7061.47	2507.03	2772.00	1738.83	40°28'19.922"N	104°45'40.609"W	1.98	
8881.00	87.540	85.710	7064.25	2593.44	2778.45	1827.55	40°28'19.986"N	104°45'39.461"W	1.54	
8970.00	88.150	86.810	7067.59	2679.66	2784.26	1916.29	40°28'20.043"N	104°45'38.313"W	1.41	
9060.00	89.820	87.970	7069.19	2766.46	2788.35	2006.18	40°28'20.083"N	104°45'37.150"W	2.26	
9149.00	90.770	87.860	7068.73	2852.08	2791.59	2095.12	40°28'20.115"N	104°45'35.999"W	1.07	
9239.00	89.320	89.850	7068.66	2938.25	2793.39	2185.10	40°28'20.133"N	104°45'34.835"W	2.74	
9328.00	90.090	90.430	7069.12	3022.87	2793.17	2274.09	40°28'20.131"N	104°45'33.683"W	1.08	
9418.00	90.830	90.770	7068.39	3108.21	2792.23	2364.08	40°28'20.121"N	104°45'32.519"W	0.90	
9507.00	89.850	89.860	7067.87	3192.74	2791.74	2453.08	40°28'20.116"N	104°45'31.367"W	1.50	
9596.00	90.890	89.340	7067.29	3277.61	2792.36	2542.07	40°28'20.122"N	104°45'30.216"W	1.31	
9686.00	89.450	90.290	7067.02	3363.34	2792.65	2632.07	40°28'20.125"N	104°45'29.051"W	1.92	
9775.00	90.250	89.960	7067.26	3447.96	2792.46	2721.07	40°28'20.123"N	104°45'27.900"W	0.97	
9865.00	90.890	88.930	7066.36	3533.86	2793.33	2811.06	40°28'20.132"N	104°45'26.735"W	1.35	
9954.00	88.680	91.110	7066.70	3618.52	2793.30	2900.05	40°28'20.131"N	104°45'25.584"W	3.49	
10043.00	89.110	91.600	7068.41	3702.52	2791.19	2989.00	40°28'20.110"N	104°45'24.433"W	0.73	
10133.00	90.890	92.740	7068.41	3787.05	2787.79	3078.94	40°28'20.077"N	104°45'23.269"W	2.35	
10222.00	91.230	89.240	7066.76	3871.22	2786.25	3167.89	40°28'20.061"N	104°45'22.118"W	3.95	
10312.00	89.320	89.210	7066.33	3957.22	2787.47	3257.88	40°28'20.073"N	104°45'20.954"W	2.12	
10401.00	88.340	90.240	7068.15	4042.02	2787.89	3346.86	40°28'20.077"N	104°45'19.802"W	1.60	
10491.00	89.450	90.250	7069.89	4127.52	2787.51	3436.84	40°28'20.073"N	104°45'18.638"W	1.23	
10580.00	89.820	89.790	7070.45	4212.20	2787.48	3525.84	40°28'20.073"N	104°45'17.486"W	0.66	



Actual Wellpath Report

TROUDT 1N-23C-M AWP

Page 6 of 10



REFERENCE WELLPATH IDENTIFICATION

Operator	SRC ENERGY	Slot	SLOT#03 TROUDT 1N-23C-M (760'FNL & 1624'FWL, SEC.27)
Area	COLORADO	Well	TROUDT 1N-23C-M
Field	WELD COUNTY (NAD83,TRUE NORTH)	Wellbore	TROUDT 1N-23C-M AWP
Facility	SEC.27-T06N-R66W		

WELLPATH DATA (178 stations)

MD [ft]	Inclination [°]	Azimuth [°]	TVD [ft]	Vert Sect [ft]	North [ft]	East [ft]	Latitude	Longitude	DLS [°/100ft]	Comments
10670.00	91.260	89.730	7069.60	4297.95	2787.85	3615.83	40°28'20.077"N	104°45'16.322"W	1.60	
10759.00	88.920	90.360	7069.46	4382.60	2787.78	3704.82	40°28'20.076"N	104°45'15.171"W	2.72	
10848.00	88.520	90.350	7071.45	4467.10	2787.23	3793.80	40°28'20.070"N	104°45'14.019"W	0.45	
10938.00	89.420	90.410	7073.07	4552.54	2786.64	3883.78	40°28'20.064"N	104°45'12.855"W	1.00	
11027.00	90.890	89.660	7072.83	4637.20	2786.58	3972.78	40°28'20.063"N	104°45'11.703"W	1.85	
11117.00	89.940	90.620	7072.18	4722.77	2786.36	4062.77	40°28'20.061"N	104°45'10.539"W	1.50	
11206.00	89.970	90.220	7072.25	4807.25	2785.71	4151.77	40°28'20.055"N	104°45'09.387"W	0.45	
11296.00	91.170	91.310	7071.35	4892.51	2784.51	4241.75	40°28'20.043"N	104°45'08.223"W	1.80	
11385.00	92.340	91.910	7068.63	4976.35	2782.01	4330.68	40°28'20.018"N	104°45'07.073"W	1.48	
11475.00	91.540	89.720	7065.58	5061.53	2780.73	4420.61	40°28'20.005"N	104°45'05.909"W	2.59	
11564.00	90.000	89.910	7064.38	5146.30	2781.02	4509.60	40°28'20.008"N	104°45'04.757"W	1.74	
11653.00	91.630	90.210	7063.12	5230.95	2780.92	4598.59	40°28'20.007"N	104°45'03.606"W	1.86	
11743.00	89.720	90.310	7062.06	5316.45	2780.52	4688.57	40°28'20.002"N	104°45'02.442"W	2.13	
11832.00	89.480	90.180	7062.68	5401.01	2780.14	4777.57	40°28'19.998"N	104°45'01.290"W	0.31	
11921.00	90.890	90.130	7062.39	5485.62	2779.89	4866.57	40°28'19.996"N	104°45'00.138"W	1.59	
12011.00	89.170	91.710	7062.34	5570.80	2778.45	4956.55	40°28'19.981"N	104°44'58.974"W	2.60	
12100.00	87.200	92.420	7065.16	5654.40	2775.24	5045.44	40°28'19.950"N	104°44'57.824"W	2.35	
12190.00	88.030	92.710	7068.91	5738.64	2771.22	5135.27	40°28'19.910"N	104°44'56.662"W	0.98	
12279.00	89.320	92.940	7070.97	5821.85	2766.84	5224.14	40°28'19.866"N	104°44'55.512"W	1.47	
12369.00	88.650	92.130	7072.56	5906.17	2762.86	5314.04	40°28'19.827"N	104°44'54.349"W	1.17	
12458.00	89.660	92.380	7073.87	5989.70	2759.35	5402.96	40°28'19.792"N	104°44'53.198"W	1.17	
12548.00	91.020	92.160	7073.34	6074.17	2755.79	5492.88	40°28'19.756"N	104°44'52.035"W	1.53	
12637.00	90.120	89.120	7072.45	6158.54	2754.80	5581.86	40°28'19.746"N	104°44'50.883"W	3.56	
12727.00	89.940	88.440	7072.41	6244.74	2756.71	5671.84	40°28'19.765"N	104°44'49.719"W	0.78	
12817.00	88.860	87.750	7073.35	6331.25	2759.70	5761.78	40°28'19.794"N	104°44'48.555"W	1.42	
12907.00	89.140	88.980	7074.92	6417.63	2762.27	5851.73	40°28'19.820"N	104°44'47.391"W	1.40	
12996.00	89.630	88.530	7075.87	6502.88	2764.20	5940.70	40°28'19.838"N	104°44'46.240"W	0.75	
13086.00	87.970	88.420	7077.76	6589.21	2766.60	6030.65	40°28'19.862"N	104°44'45.076"W	1.85	
13175.00	86.920	88.430	7081.73	6674.53	2769.04	6119.53	40°28'19.886"N	104°44'43.926"W	1.18	
13265.00	87.480	88.140	7086.12	6760.85	2771.73	6209.38	40°28'19.912"N	104°44'42.764"W	0.70	



Actual Wellpath Report

TROUDT 1N-23C-M AWP

Page 7 of 10



REFERENCE WELLPATH IDENTIFICATION

Operator	SRC ENERGY	Slot	SLOT#03 TROUDT 1N-23C-M (760'FNL & 1624'FWL, SEC.27)
Area	COLORADO	Well	TROUDT 1N-23C-M
Field	WELD COUNTY (NAD83,TRUE NORTH)	Wellbore	TROUDT 1N-23C-M AWP
Facility	SEC.27-T06N-R66W		

WELLPATH DATA (178 stations)

MD [ft]	Inclination [°]	Azimuth [°]	TVD [ft]	Vert Sect [ft]	North [ft]	East [ft]	Latitude	Longitude	DLS [°/100ft]	Comments
13354.00	87.380	87.900	7090.11	6846.35	2774.80	6298.24	40°28'19.942"N	104°44'41.614"W	0.29	
13444.00	87.480	87.450	7094.15	6932.95	2778.45	6388.07	40°28'19.978"N	104°44'40.451"W	0.51	
13533.00	87.720	87.340	7097.88	7018.72	2782.49	6476.90	40°28'20.018"N	104°44'39.302"W	0.30	
13623.00	87.380	88.350	7101.72	7105.26	2785.87	6566.75	40°28'20.051"N	104°44'38.139"W	1.18	
13712.00	89.780	90.490	7103.93	7190.18	2786.77	6655.71	40°28'20.060"N	104°44'36.988"W	3.61	
13802.00	89.910	89.900	7104.17	7275.72	2786.47	6745.71	40°28'20.056"N	104°44'35.824"W	0.67	
13892.00	92.180	92.110	7102.53	7360.84	2784.89	6835.67	40°28'20.041"N	104°44'34.660"W	3.52	
13981.00	93.010	91.450	7098.50	7444.55	2782.13	6924.53	40°28'20.013"N	104°44'33.510"W	1.19	
14070.00	93.660	91.290	7093.32	7528.41	2780.00	7013.36	40°28'19.992"N	104°44'32.361"W	0.75	
14160.00	93.730	90.710	7087.52	7613.38	2778.44	7103.16	40°28'19.976"N	104°44'31.199"W	0.65	
14249.00	91.940	90.700	7083.12	7697.61	2777.34	7192.04	40°28'19.965"N	104°44'30.049"W	2.01	
14339.00	91.510	90.590	7080.41	7782.90	2776.33	7281.99	40°28'19.955"N	104°44'28.885"W	0.49	
14428.00	92.650	90.460	7077.18	7867.27	2775.52	7370.93	40°28'19.946"N	104°44'27.734"W	1.29	
14518.00	93.290	90.140	7072.52	7952.65	2775.05	7460.80	40°28'19.942"N	104°44'26.571"W	0.79	
14607.00	92.120	91.240	7068.32	8036.90	2773.97	7549.69	40°28'19.931"N	104°44'25.421"W	1.80	
14696.00	92.830	90.430	7064.48	8121.10	2772.68	7638.60	40°28'19.918"N	104°44'24.271"W	1.21	
14786.00	91.410	90.080	7061.15	8206.56	2772.28	7728.54	40°28'19.913"N	104°44'23.107"W	1.62	
14875.00	91.110	88.010	7059.19	8291.66	2773.76	7817.50	40°28'19.928"N	104°44'21.956"W	2.35	
14965.00	90.150	88.640	7058.20	8378.07	2776.39	7907.45	40°28'19.953"N	104°44'20.792"W	1.28	
15054.00	91.570	89.390	7056.86	8463.20	2777.92	7996.43	40°28'19.968"N	104°44'19.641"W	1.80	
15144.00	92.460	90.190	7053.70	8548.88	2778.25	8086.37	40°28'19.971"N	104°44'18.477"W	1.33	
15233.00	94.120	90.340	7048.59	8633.30	2777.84	8175.22	40°28'19.967"N	104°44'17.327"W	1.87	
15322.00	92.830	91.250	7043.20	8717.44	2776.61	8264.04	40°28'19.954"N	104°44'16.178"W	1.77	
15412.00	89.540	91.320	7041.34	8802.41	2774.59	8353.99	40°28'19.934"N	104°44'15.014"W	3.66	
15501.00	90.340	90.790	7041.43	8886.58	2772.95	8442.97	40°28'19.918"N	104°44'13.863"W	1.08	
15591.00	92.280	91.090	7039.37	8971.72	2771.48	8532.93	40°28'19.903"N	104°44'12.699"W	2.18	
15651.00	93.570	91.160	7036.31	9028.37	2770.30	8592.84	40°28'19.891"N	104°44'11.924"W	2.15	LAST BHI SURVEY (2042'FSL & 588'FEL, SEC.23)
15714.00	93.570	91.160	7032.39	9087.79	2769.03	8655.71	40°28'19.878"N	104°44'11.110"W	0.00	PROJ TO BIT (2041'FSL & 525'FEL, SEC.23)



Actual Wellpath Report

TROUDT 1N-23C-M AWP

Page 8 of 10



REFERENCE WELLPATH IDENTIFICATION

Operator	SRC ENERGY	Slot	SLOT#03 TROUDT 1N-23C-M (760'FNL & 1624'FWL, SEC.27)
Area	COLORADO	Well	TROUDT 1N-23C-M
Field	WELD COUNTY (NAD83,TRUE NORTH)	Wellbore	TROUDT 1N-23C-M AWB
Facility	SEC.27-T06N-R66W		

HOLE & CASING SECTIONS - Ref Wellbore: TROUDT 1N-23C-M AWB Ref Wellpath: TROUDT 1N-23C-M AWP

String/Diameter	Start MD [ft]	End MD [ft]	Interval [ft]	Start TVD [ft]	End TVD [ft]	Start N/S [ft]	Start E/W [ft]	End N/S [ft]	End E/W [ft]
9.625in Casing Surface	25.00	1834.00	1809.00	25.00	1828.17	0.00	0.00	-4.34	-123.52

TARGETS

Name	TVD [ft]	North [ft]	East [ft]	Grid East [US ft]	Grid North [US ft]	Latitude	Longitude	Shape
SEC.23-T06N-R66W	-8.00	4231.31	-1897.38	3201871.60	1417148.27	40°28'34.342"N	104°46'27.660"W	polygon
SEC.22-T06N-R66W	6.00	1412.73	-8039.20	3195753.51	1414279.17	40°28'06.478"N	104°47'47.123"W	polygon
SEC.27-T06N-R66W	19.00	-4766.34	1045.36	3204888.45	1408175.58	40°27'05.432"N	104°45'49.586"W	polygon
SEC.28-T06N-R66W	19.00	-4766.34	1045.36	3204888.45	1408175.58	40°27'05.432"N	104°45'49.586"W	polygon
SEC.26-T06N-R66W	38.00	-4763.01	645.14	3204488.23	1408175.60	40°27'05.465"N	104°45'54.763"W	polygon
SEC.29-T06N-R66W EAST HALF	50.00	0.02	-30.05	3203773.74	1412932.71	40°27'52.531"N	104°46'03.497"W	polygon
TROUDT 1N-23C-M BHL ON PLAT (2092'FSL & 510'FEL, SEC.23)	7024.00	2819.86	8570.41	3212350.29	1415823.39	40°28'20.381"N	104°44'12.214"W	circle
TROUDT 1N-23C-M BHL REV-1 (2042'FSL & 510'FEL, SEC.23)	7047.55	2769.86	8570.38	3212350.67	1415773.39	40°28'19.887"N	104°44'12.214"W	circle
TROUDT 1N-23C-M TOP OF PROD ON PLAT (2089'FSL. & 2521'FEL, SEC.22)	7064.00	2841.35	1214.17	3204994.40	1415784.12	40°28'20.608"N	104°45'47.398"W	circle
TROUDT 1N-23C-M TOP OF PROD REV-1 (2030'FSL. & 2521'FEL, SEC.22)	7065.65	2782.40	1214.14	3204994.86	1415725.17	40°28'20.025"N	104°45'47.398"W	circle



Actual Wellpath Report

TROUDT 1N-23C-M AWP

Page 9 of 10



REFERENCE WELLPATH IDENTIFICATION

Operator	SRC ENERGY	Slot	SLOT#03 TROUDT 1N-23C-M (760'FNL & 1624'FWL, SEC.27)
Area	COLORADO	Well	TROUDT 1N-23C-M
Field	WELD COUNTY (NAD83,TRUE NORTH)	Wellbore	TROUDT 1N-23C-M AWB
Facility	SEC.27-T06N-R66W		

WELLPATH COMPOSITION - Ref Wellbore: TROUDT 1N-23C-M AWB Ref Wellpath: TROUDT 1N-23C-M AWP

Start MD [ft]	End MD [ft]	Positional Uncertainty Model	Log Name/Comment	Wellbore
25.00	1785.00	BHI NaviTrak (Standard)	13 1/2" SURFACE SECTION <88-1764>	TROUDT 1N-23C-M AWB
1785.00	15651.00	BHI NaviTrak (IFR1, Rotating)	8 1/2" BHI NAVIGAMMA SURVEYS <1880-17651>	TROUDT 1N-23C-M AWB
15651.00	15714.00	Blind Drilling (std)	Projection to bit	TROUDT 1N-23C-M AWB



Actual Wellpath Report

TROUDT 1N-23C-M AWP

Page 10 of 10



REFERENCE WELLPATH IDENTIFICATION			
Operator	SRC ENERGY	Slot	SLOT#03 TROUDT 1N-23C-M (760'FNL & 1624'FWL, SEC.27)
Area	COLORADO	Well	TROUDT 1N-23C-M
Field	WELD COUNTY (NAD83,TRUE NORTH)	Wellbore	TROUDT 1N-23C-M AWP
Facility	SEC.27-T06N-R66W		

WELLPATH COMMENTS				
MD [ft]	Inclination [°]	Azimuth [°]	TVD [ft]	Comment
8254.00	88.710	89.950	7066.40	LANDING POINT (2007'FSL & 2534'FEL, SEC.22)
15651.00	93.570	91.160	7036.31	LAST BHI SURVEY (2042'FSL & 588'FEL, SEC.23)
15714.00	93.570	91.160	7032.39	PROJ TO BIT (2041'FSL & 525'FEL, SEC.23)