

SRC ENERGY

Location: COLORADO Slot: SLOT#02 TROUDT 26C-23-M (761'FNL & 1609'FWL, SEC.27)
 Field: WELD COUNTY (NAD83, TRUE NORTH) Well: TROUDT 26C-23-M
 Facility: SEC.27-T06N-R66W Wellbore: TROUDT 26C-23-M PWB

Plot reference wellpath is TROUDT 26C-23-M (REV-E.0) PWP	Grid System: NAD83 / Lambert Colorado SP, Northern Zone (501), US feet
True vertical depths are referenced to PD 562 (25) (RKB)	North Reference: True north
Measured depths are referenced to PD 562 (25) (RKB)	Scale: True distance
PD 562 (25) (RKB) to Mean Sea Level: 4744 feet	Depths are in feet
Mean Sea Level to Mud line (At Slot: SLOT#02 TROUDT 26C-23-M (761'FNL & 1609'FWL, SEC.27)): 0 feet	Created by: robale01 on 2018-10-25
Coordinates are in feet referenced to Slot	Database: WA DENVER



SRC ENERGY

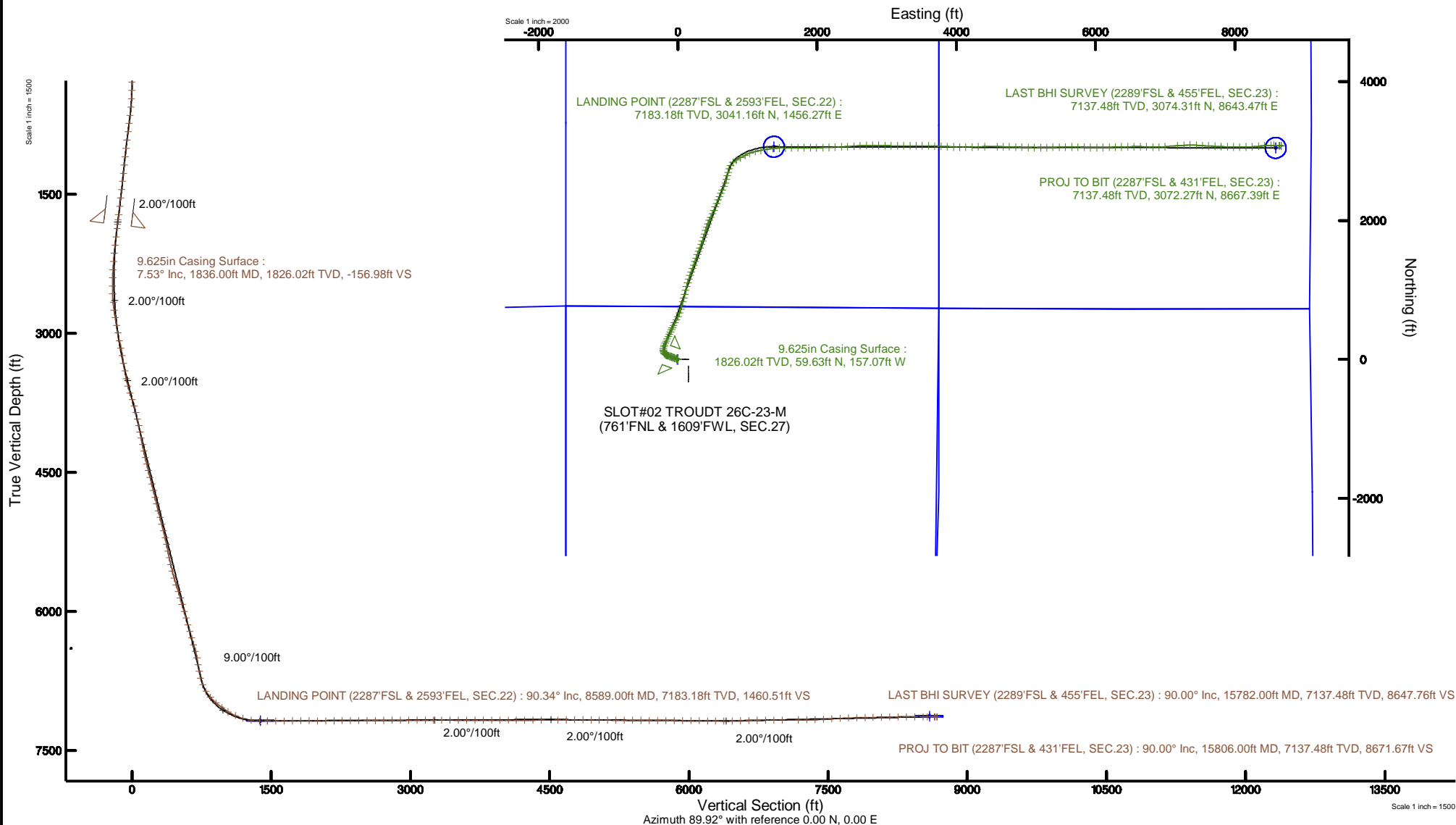



Actual Wellpath Report

TROUDT 26C-23-M AWP

Page 1 of 11



REFERENCE WELLPATH IDENTIFICATION

Operator	SRC ENERGY	Slot	SLOT#02 TROUDT 26C-23-M (761'FNL & 1609'FWL, SEC.27)
Area	COLORADO	Well	TROUDT 26C-23-M
Field	WELD COUNTY (NAD83,TRUE NORTH)	Wellbore	TROUDT 26C-23-M AWB
Facility	SEC.27-T06N-R66W		

REPORT SETUP INFORMATION

Projection System	NAD83 / Lambert Colorado SP, Northern Zone (501), US feet	Software System	WellArchitect® 5.1
North Reference	True	User	Hanisab
Scale	0.999964	Report Generated	10/29/2018 at 8:48:26 PM
Convergence at slot	0.47° East	Database/Source file	WA DENVER/TROUDT_26C-23-M_AWP.xml

WELLPATH LOCATION

	Local coordinates		Grid coordinates		Geographic coordinates	
	North[ft]	East[ft]	Easting[US ft]	Northing[US ft]	Latitude	Longitude
Slot Location	-0.02	15.06	3203788.80	1412932.82	40°27'52.531"N	104°46'03.302"W
Facility Reference Pt			3203773.74	1412932.71	40°27'52.531"N	104°46'03.497"W
Field Reference Pt			3171284.48	1426358.81	40°30'07.643"N	104°53'02.634"W

WELLPATH DATUM

Calculation method	Minimum curvature	PD 562 (25') (RKB) to Facility Vertical Datum	4744.00ft
Horizontal Reference Pt	Slot	PD 562 (25') (RKB) to Mean Sea Level	4744.00ft
Vertical Reference Pt	PD 562 (25') (RKB)	PD 562 (25') (RKB) to Mud Line at Slot (SLOT#02 TROUDT 26C-23-M (761'FNL & 1609'FWL, SEC.27))	4744.00ft
MD Reference Pt	PD 562 (25') (RKB)	Section Origin	N 0.00, E 0.00 ft
Field Vertical Reference	Mean Sea Level	Section Azimuth	89.92°



Actual Wellpath Report

TROUDT 26C-23-M AWP

Page 2 of 11



REFERENCE WELLPATH IDENTIFICATION

Operator	SRC ENERGY	Slot	SLOT#02 TROUDT 26C-23-M (761'FNL & 1609'FWL, SEC.27)
Area	COLORADO	Well	TROUDT 26C-23-M
Field	WELD COUNTY (NAD83,TRUE NORTH)	Wellbore	TROUDT 26C-23-M AWB
Facility	SEC.27-T06N-R66W		

WELLPATH DATA (178 stations) † = interpolated/extrapolated station

MD [ft]	Inclination [°]	Azimuth [°]	TVD [ft]	Vert Sect [ft]	North [ft]	East [ft]	Latitude	Longitude	DLS [°/100ft]	Comments
0.00†	0.000	71.210	0.00	0.00	0.00	0.00	40°27'52.531"N	104°46'03.302"W	0.00	
25.00	0.000	71.210	25.00	0.00	0.00	0.00	40°27'52.531"N	104°46'03.302"W	0.00	
109.00	0.420	71.210	109.00	0.29	0.10	0.29	40°27'52.532"N	104°46'03.298"W	0.50	
197.00	0.530	79.620	197.00	1.00	0.28	1.00	40°27'52.534"N	104°46'03.289"W	0.15	
287.00	0.990	288.480	286.99	0.67	0.60	0.67	40°27'52.537"N	104°46'03.293"W	1.64	
377.00	1.770	287.150	376.97	-1.39	1.25	-1.40	40°27'52.543"N	104°46'03.320"W	0.87	
467.00	3.420	291.220	466.87	-5.22	2.64	-5.23	40°27'52.557"N	104°46'03.370"W	1.84	
557.00	4.800	296.790	556.64	-11.08	5.30	-11.09	40°27'52.583"N	104°46'03.445"W	1.59	
647.00	7.540	293.730	646.11	-19.85	9.38	-19.86	40°27'52.624"N	104°46'03.559"W	3.07	
737.00	8.000	294.340	735.28	-30.95	14.34	-30.97	40°27'52.673"N	104°46'03.703"W	0.52	
827.00	7.840	291.440	824.42	-42.36	19.16	-42.39	40°27'52.720"N	104°46'03.850"W	0.48	
917.00	7.070	286.240	913.66	-53.39	22.95	-53.42	40°27'52.758"N	104°46'03.993"W	1.14	
1007.00	6.850	288.300	1003.00	-63.80	26.19	-63.84	40°27'52.790"N	104°46'04.128"W	0.37	
1097.00	6.730	288.100	1092.37	-73.90	29.51	-73.94	40°27'52.823"N	104°46'04.259"W	0.14	
1187.00	6.290	288.990	1181.79	-83.57	32.75	-83.62	40°27'52.855"N	104°46'04.384"W	0.50	
1277.00	6.030	289.240	1271.27	-92.69	35.92	-92.74	40°27'52.886"N	104°46'04.502"W	0.29	
1367.00	6.380	291.120	1360.74	-101.82	39.28	-101.87	40°27'52.919"N	104°46'04.620"W	0.45	
1457.00	6.990	291.300	1450.13	-111.58	43.07	-111.64	40°27'52.957"N	104°46'04.746"W	0.68	
1547.00	7.020	287.550	1539.46	-121.92	46.72	-121.99	40°27'52.993"N	104°46'04.880"W	0.51	
1637.00	6.890	287.110	1628.79	-132.32	49.96	-132.39	40°27'53.025"N	104°46'05.015"W	0.16	
1727.00	8.040	291.090	1718.03	-143.35	53.81	-143.42	40°27'53.063"N	104°46'05.158"W	1.40	
1785.00	7.850	293.020	1775.47	-150.77	56.82	-150.85	40°27'53.092"N	104°46'05.254"W	0.56	
1880.00	7.260	298.190	1869.65	-162.03	62.20	-162.11	40°27'53.146"N	104°46'05.399"W	0.95	
1969.00	8.020	301.570	1957.86	-172.26	68.10	-172.36	40°27'53.204"N	104°46'05.532"W	0.99	
2059.00	7.990	305.960	2046.98	-182.67	75.06	-182.77	40°27'53.273"N	104°46'05.667"W	0.68	
2148.00	8.020	320.430	2135.13	-191.62	83.48	-191.73	40°27'53.356"N	104°46'05.783"W	2.26	
2237.00	8.930	333.700	2223.16	-198.62	94.46	-198.75	40°27'53.464"N	104°46'05.873"W	2.42	
2327.00	9.220	339.150	2312.04	-204.26	107.46	-204.41	40°27'53.593"N	104°46'05.947"W	1.01	
2416.00	9.850	346.520	2399.81	-208.55	121.53	-208.72	40°27'53.732"N	104°46'06.002"W	1.54	
2506.00	11.650	358.960	2488.24	-210.49	138.10	-210.68	40°27'53.896"N	104°46'06.028"W	3.25	



Actual Wellpath Report

TROUDT 26C-23-M AWP

Page 3 of 11



REFERENCE WELLPATH IDENTIFICATION

Operator	SRC ENERGY	Slot	SLOT#02 TROUDT 26C-23-M (761'FNL & 1609'FWL, SEC.27)
Area	COLORADO	Well	TROUDT 26C-23-M
Field	WELD COUNTY (NAD83,TRUE NORTH)	Wellbore	TROUDT 26C-23-M AWB
Facility	SEC.27-T06N-R66W		

WELLPATH DATA (178 stations)

MD [ft]	Inclination [°]	Azimuth [°]	TVD [ft]	Vert Sect [ft]	North [ft]	East [ft]	Latitude	Longitude	DLS [°/100ft]	Comments
2595.00	13.750	9.910	2575.07	-208.81	157.51	-209.03	40°27'54.087"N	104°46'06.006"W	3.58	
2685.00	15.660	18.400	2662.13	-203.10	179.58	-203.35	40°27'54.306"N	104°46'05.933"W	3.19	
2774.00	18.960	24.320	2747.09	-193.32	204.16	-193.60	40°27'54.548"N	104°46'05.807"W	4.20	
2863.00	22.150	23.730	2830.41	-180.57	232.70	-180.89	40°27'54.830"N	104°46'05.642"W	3.59	
2953.00	22.480	23.150	2913.67	-166.93	264.06	-167.30	40°27'55.140"N	104°46'05.466"W	0.44	
3042.00	23.480	24.520	2995.61	-152.84	295.83	-153.25	40°27'55.454"N	104°46'05.285"W	1.27	
3132.00	25.330	25.980	3077.57	-136.91	329.46	-137.37	40°27'55.787"N	104°46'05.079"W	2.16	
3221.00	25.210	25.350	3158.05	-120.41	363.70	-120.92	40°27'56.125"N	104°46'04.866"W	0.33	
3311.00	22.910	24.000	3240.23	-105.03	397.03	-105.59	40°27'56.454"N	104°46'04.668"W	2.63	
3400.00	21.310	23.220	3322.68	-91.57	427.72	-92.16	40°27'56.758"N	104°46'04.494"W	1.83	
3490.00	22.180	24.260	3406.27	-78.09	458.24	-78.73	40°27'57.059"N	104°46'04.321"W	1.06	
3579.00	25.040	25.190	3487.82	-63.13	490.60	-63.81	40°27'57.379"N	104°46'04.128"W	3.24	
3669.00	29.630	28.090	3567.75	-44.48	527.49	-45.22	40°27'57.743"N	104°46'03.887"W	5.31	
3758.00	32.840	28.880	3643.84	-22.41	568.04	-23.20	40°27'58.144"N	104°46'03.602"W	3.64	
3848.00	39.080	26.060	3716.66	1.93	614.94	1.07	40°27'58.608"N	104°46'03.288"W	7.17	
3937.00	39.340	20.890	3785.63	24.39	666.51	23.46	40°27'59.117"N	104°46'02.998"W	3.68	
4027.00	39.320	16.510	3855.26	42.75	720.51	41.74	40°27'59.651"N	104°46'02.762"W	3.08	
4116.00	39.090	14.400	3924.23	57.82	774.73	56.73	40°28'00.186"N	104°46'02.568"W	1.52	
4205.00	39.200	14.680	3993.26	72.00	829.11	70.84	40°28'00.724"N	104°46'02.385"W	0.23	
4295.00	39.250	14.040	4062.98	86.19	884.24	84.95	40°28'01.269"N	104°46'02.203"W	0.45	
4384.00	38.930	12.990	4132.05	99.38	938.81	98.07	40°28'01.808"N	104°46'02.033"W	0.83	
4474.00	38.660	13.540	4202.20	112.40	993.69	111.01	40°28'02.350"N	104°46'01.866"W	0.49	
4563.00	39.290	15.760	4271.39	126.63	1047.84	125.17	40°28'02.885"N	104°46'01.682"W	1.72	
4653.00	38.970	16.810	4341.21	142.64	1102.36	141.10	40°28'03.424"N	104°46'01.476"W	0.82	
4742.00	38.550	17.590	4410.61	159.18	1155.58	157.57	40°28'03.950"N	104°46'01.263"W	0.72	
4831.00	36.850	18.810	4481.03	176.24	1207.29	174.56	40°28'04.461"N	104°46'01.044"W	2.09	
4921.00	37.030	20.480	4552.96	194.50	1258.22	192.74	40°28'04.964"N	104°46'00.808"W	1.13	
5010.00	36.130	20.340	4624.43	213.07	1307.93	211.24	40°28'05.455"N	104°46'00.569"W	1.02	
5100.00	36.300	19.170	4697.04	231.11	1357.97	229.21	40°28'05.950"N	104°46'00.336"W	0.79	
5190.00	35.880	18.580	4769.77	248.33	1408.14	246.36	40°28'06.446"N	104°46'00.114"W	0.61	



Actual Wellpath Report

TROUDT 26C-23-M AWP

Page 4 of 11



REFERENCE WELLPATH IDENTIFICATION

Operator	SRC ENERGY	Slot	SLOT#02 TROUDT 26C-23-M (761'FNL & 1609'FWL, SEC.27)
Area	COLORADO	Well	TROUDT 26C-23-M
Field	WELD COUNTY (NAD83,TRUE NORTH)	Wellbore	TROUDT 26C-23-M AWB
Facility	SEC.27-T06N-R66W		

WELLPATH DATA (178 stations)

MD [ft]	Inclination [°]	Azimuth [°]	TVD [ft]	Vert Sect [ft]	North [ft]	East [ft]	Latitude	Longitude	DLS [°/100ft]	Comments
5279.00	36.030	19.040	4841.82	265.25	1457.60	263.21	40°28'06.934"N	104°45'59.896"W	0.35	
5368.00	36.130	20.420	4913.75	283.01	1506.93	280.90	40°28'07.422"N	104°45'59.668"W	0.92	
5458.00	36.230	21.500	4986.39	302.08	1556.55	299.91	40°28'07.912"N	104°45'59.422"W	0.72	
5547.00	35.590	20.230	5058.48	320.75	1605.32	318.50	40°28'08.394"N	104°45'59.181"W	1.10	
5637.00	35.920	20.200	5131.51	338.99	1654.67	336.68	40°28'08.882"N	104°45'58.946"W	0.37	
5726.00	35.980	18.380	5203.56	356.31	1703.98	353.94	40°28'09.369"N	104°45'58.723"W	1.20	
5816.00	36.090	17.180	5276.34	372.55	1754.39	370.10	40°28'09.867"N	104°45'58.513"W	0.79	
5905.00	35.810	16.140	5348.39	387.60	1804.45	385.08	40°28'10.362"N	104°45'58.320"W	0.75	
5994.00	35.450	16.520	5420.73	402.25	1854.20	399.66	40°28'10.853"N	104°45'58.131"W	0.47	
6084.00	35.750	18.110	5493.91	417.91	1904.22	415.25	40°28'11.348"N	104°45'57.929"W	1.08	
6173.00	35.320	20.040	5566.34	434.88	1953.10	432.15	40°28'11.831"N	104°45'57.710"W	1.35	
6263.00	33.790	23.590	5640.47	453.88	2000.48	451.09	40°28'12.299"N	104°45'57.466"W	2.81	
6352.00	35.850	26.580	5713.53	475.51	2046.48	472.65	40°28'12.753"N	104°45'57.186"W	3.01	
6442.00	37.750	24.470	5785.60	498.79	2095.13	495.86	40°28'13.234"N	104°45'56.886"W	2.54	
6531.00	36.990	22.130	5856.33	520.23	2144.73	517.23	40°28'13.724"N	104°45'56.610"W	1.81	
6620.00	37.320	22.450	5927.27	540.69	2194.47	537.62	40°28'14.216"N	104°45'56.346"W	0.43	
6710.00	37.540	22.700	5998.74	561.76	2244.98	558.62	40°28'14.715"N	104°45'56.074"W	0.30	
6800.00	35.930	22.420	6070.86	582.48	2294.69	579.28	40°28'15.206"N	104°45'55.807"W	1.80	
6889.00	34.470	21.790	6143.58	601.86	2342.21	598.59	40°28'15.676"N	104°45'55.557"W	1.69	
6978.00	36.390	22.630	6216.10	621.43	2389.97	618.10	40°28'16.147"N	104°45'55.304"W	2.23	
7068.00	37.340	23.870	6288.11	642.82	2439.58	639.41	40°28'16.638"N	104°45'55.029"W	1.34	
7157.00	36.630	24.080	6359.20	664.64	2488.50	661.17	40°28'17.121"N	104°45'54.747"W	0.81	
7246.00	36.470	19.340	6430.71	684.31	2537.71	680.77	40°28'17.607"N	104°45'54.494"W	3.18	
7336.00	36.530	14.440	6503.07	699.92	2588.90	696.31	40°28'18.113"N	104°45'54.292"W	3.24	
7426.00	35.880	12.960	6575.69	712.59	2640.54	708.90	40°28'18.623"N	104°45'54.129"W	1.21	
7515.00	36.080	14.160	6647.72	724.92	2691.37	721.16	40°28'19.126"N	104°45'53.971"W	0.82	
7604.00	34.760	18.790	6720.26	739.57	2740.81	735.75	40°28'19.614"N	104°45'53.782"W	3.36	
7694.00	38.020	28.180	6792.75	761.02	2789.58	757.12	40°28'20.096"N	104°45'53.505"W	7.16	
7784.00	40.890	47.190	6862.49	795.92	2834.21	791.96	40°28'20.537"N	104°45'53.055"W	13.75	
7873.00	45.350	61.260	6927.59	845.23	2869.33	841.23	40°28'20.884"N	104°45'52.417"W	11.89	



Actual Wellpath Report

TROUDT 26C-23-M AWP

Page 5 of 11



REFERENCE WELLPATH IDENTIFICATION

Operator	SRC ENERGY	Slot	SLOT#02 TROUDT 26C-23-M (761'FNL & 1609'FWL, SEC.27)
Area	COLORADO	Well	TROUDT 26C-23-M
Field	WELD COUNTY (NAD83,TRUE NORTH)	Wellbore	TROUDT 26C-23-M AWB
Facility	SEC.27-T06N-R66W		

WELLPATH DATA (178 stations)

MD [ft]	Inclination [°]	Azimuth [°]	TVD [ft]	Vert Sect [ft]	North [ft]	East [ft]	Latitude	Longitude	DLS [°/100ft]	Comments
7963.00	52.690	61.360	6986.57	904.84	2901.92	900.79	40°28'21.206"N	104°45'51.646"W	8.16	
8052.00	55.170	61.600	7038.97	968.10	2936.26	964.00	40°28'21.546"N	104°45'50.829"W	2.80	
8141.00	60.940	69.680	7086.10	1036.89	2967.21	1032.75	40°28'21.851"N	104°45'49.939"W	10.06	
8231.00	67.440	75.000	7125.28	1114.08	2991.66	1109.90	40°28'22.093"N	104°45'48.941"W	8.97	
8320.00	73.840	80.160	7154.79	1196.04	3009.63	1191.84	40°28'22.270"N	104°45'47.880"W	9.03	
8410.00	81.810	81.710	7173.76	1282.87	3023.46	1278.65	40°28'22.407"N	104°45'46.757"W	9.01	
8500.00	87.910	83.980	7181.82	1371.78	3034.61	1367.54	40°28'22.517"N	104°45'45.607"W	7.23	
8589.00	90.340	87.580	7183.18	1460.51	3041.16	1456.27	40°28'22.582"N	104°45'44.459"W	4.88	LANDING POINT (2287'FSL & 2593'FEL, SEC.22)
8679.00	90.460	88.910	7182.55	1550.47	3043.92	1546.22	40°28'22.609"N	104°45'43.295"W	1.48	
8768.00	90.490	88.840	7181.81	1639.45	3045.66	1635.20	40°28'22.626"N	104°45'42.144"W	0.09	
8858.00	90.430	89.780	7181.09	1729.45	3046.75	1725.19	40°28'22.637"N	104°45'40.979"W	1.05	
8947.00	90.620	90.150	7180.27	1818.44	3046.80	1814.19	40°28'22.637"N	104°45'39.828"W	0.47	
9036.00	89.140	91.140	7180.46	1907.43	3045.80	1903.18	40°28'22.627"N	104°45'38.676"W	2.00	
9126.00	88.860	89.390	7182.03	1997.41	3045.38	1993.16	40°28'22.623"N	104°45'37.512"W	1.97	
9215.00	90.680	88.160	7182.39	2086.39	3047.29	2082.13	40°28'22.642"N	104°45'36.361"W	2.47	
9305.00	90.590	87.520	7181.39	2176.32	3050.68	2172.06	40°28'22.675"N	104°45'35.197"W	0.72	
9394.00	90.370	87.730	7180.64	2265.25	3054.37	2260.98	40°28'22.712"N	104°45'34.046"W	0.34	
9484.00	90.590	87.380	7179.89	2355.17	3058.21	2350.90	40°28'22.750"N	104°45'32.883"W	0.46	
9573.00	90.650	86.490	7178.93	2444.04	3062.96	2439.77	40°28'22.797"N	104°45'31.733"W	1.00	
9662.00	90.490	85.690	7178.04	2532.84	3069.03	2528.55	40°28'22.856"N	104°45'30.584"W	0.92	
9752.00	90.520	86.520	7177.25	2622.63	3075.15	2618.34	40°28'22.917"N	104°45'29.422"W	0.92	
9841.00	90.490	88.560	7176.46	2711.55	3078.96	2707.25	40°28'22.954"N	104°45'28.272"W	2.29	
9931.00	90.490	90.970	7175.69	2801.54	3079.33	2797.24	40°28'22.958"N	104°45'27.107"W	2.68	
10020.00	90.460	91.460	7174.96	2890.51	3077.45	2886.22	40°28'22.939"N	104°45'25.956"W	0.55	
10110.00	90.150	91.130	7174.48	2980.48	3075.41	2976.19	40°28'22.919"N	104°45'24.792"W	0.50	
10199.00	90.180	91.130	7174.22	3069.46	3073.66	3065.18	40°28'22.902"N	104°45'23.641"W	0.03	
10289.00	90.030	90.620	7174.06	3159.45	3072.28	3155.16	40°28'22.888"N	104°45'22.476"W	0.59	
10378.00	90.370	90.450	7173.75	3248.45	3071.45	3244.16	40°28'22.879"N	104°45'21.325"W	0.43	
10467.00	90.400	89.570	7173.15	3337.44	3071.44	3333.16	40°28'22.879"N	104°45'20.173"W	0.99	
10557.00	89.380	89.240	7173.32	3427.44	3072.37	3423.15	40°28'22.888"N	104°45'19.009"W	1.19	



Actual Wellpath Report

TROUDT 26C-23-M AWP

Page 6 of 11



REFERENCE WELLPATH IDENTIFICATION

Operator	SRC ENERGY	Slot	SLOT#02 TROUDT 26C-23-M (761'FNL & 1609'FWL, SEC.27)
Area	COLORADO	Well	TROUDT 26C-23-M
Field	WELD COUNTY (NAD83,TRUE NORTH)	Wellbore	TROUDT 26C-23-M AWB
Facility	SEC.27-T06N-R66W		

WELLPATH DATA (178 stations)

MD [ft]	Inclination [°]	Azimuth [°]	TVD [ft]	Vert Sect [ft]	North [ft]	East [ft]	Latitude	Longitude	DLS [°/100ft]	Comments
10646.00	89.510	90.310	7174.18	3516.43	3072.72	3512.14	40°28'22.892"N	104°45'17.857"W	1.21	
10736.00	89.510	90.720	7174.95	3606.42	3071.91	3602.14	40°28'22.884"N	104°45'16.693"W	0.46	
10825.00	90.460	91.660	7174.98	3695.40	3070.06	3691.12	40°28'22.865"N	104°45'15.541"W	1.50	
10915.00	90.340	92.440	7174.35	3785.33	3066.84	3781.06	40°28'22.833"N	104°45'14.378"W	0.88	
11004.00	89.850	93.760	7174.20	3874.19	3062.03	3869.92	40°28'22.786"N	104°45'13.228"W	1.58	
11093.00	89.880	92.650	7174.41	3963.05	3057.06	3958.78	40°28'22.736"N	104°45'12.078"W	1.25	
11183.00	89.780	90.530	7174.68	4053.00	3054.56	4048.74	40°28'22.711"N	104°45'10.914"W	2.36	
11272.00	90.120	90.210	7174.75	4142.00	3053.98	4137.74	40°28'22.706"N	104°45'09.762"W	0.52	
11362.00	90.340	87.990	7174.39	4231.98	3055.40	4227.72	40°28'22.719"N	104°45'08.598"W	2.48	
11451.00	90.340	88.090	7173.86	4320.93	3058.44	4316.67	40°28'22.749"N	104°45'07.447"W	0.11	
11541.00	90.280	88.460	7173.38	4410.90	3061.15	4406.63	40°28'22.776"N	104°45'06.283"W	0.42	
11719.00	90.520	91.030	7172.13	4588.88	3061.94	4584.61	40°28'22.783"N	104°45'03.980"W	1.45	
11809.00	90.550	91.440	7171.29	4678.85	3060.00	4674.58	40°28'22.764"N	104°45'02.816"W	0.46	
11898.00	90.460	91.350	7170.51	4767.82	3057.84	4763.55	40°28'22.743"N	104°45'01.665"W	0.14	
11987.00	89.510	90.900	7170.53	4856.79	3056.09	4852.53	40°28'22.725"N	104°45'00.513"W	1.18	
12077.00	89.320	92.800	7171.45	4946.73	3053.18	4942.48	40°28'22.696"N	104°44'59.350"W	2.12	
12166.00	89.410	92.390	7172.44	5035.63	3049.15	5031.38	40°28'22.656"N	104°44'58.199"W	0.47	
12256.00	89.420	90.140	7173.36	5125.60	3047.17	5121.35	40°28'22.636"N	104°44'57.035"W	2.50	
12345.00	89.540	88.960	7174.17	5214.59	3047.87	5210.34	40°28'22.643"N	104°44'55.884"W	1.33	
12435.00	89.410	88.850	7174.99	5304.57	3049.59	5300.32	40°28'22.660"N	104°44'54.719"W	0.19	
12524.00	89.600	88.420	7175.76	5393.55	3051.71	5389.29	40°28'22.681"N	104°44'53.568"W	0.53	
12614.00	89.690	88.590	7176.32	5483.52	3054.05	5479.26	40°28'22.704"N	104°44'52.404"W	0.21	
12703.00	89.690	88.760	7176.80	5572.49	3056.11	5568.23	40°28'22.724"N	104°44'51.253"W	0.19	
12794.00	89.510	89.700	7177.43	5663.48	3057.34	5659.22	40°28'22.736"N	104°44'50.075"W	1.05	
12883.00	89.750	91.180	7178.01	5752.48	3056.65	5748.21	40°28'22.729"N	104°44'48.924"W	1.68	
12973.00	89.510	92.550	7178.59	5842.42	3053.72	5838.16	40°28'22.700"N	104°44'47.760"W	1.55	
13063.00	89.540	91.800	7179.34	5932.35	3050.31	5928.09	40°28'22.666"N	104°44'46.596"W	0.83	
13152.00	89.600	89.570	7180.00	6021.33	3049.24	6017.08	40°28'22.655"N	104°44'45.445"W	2.51	
13242.00	89.510	88.960	7180.70	6111.32	3050.40	6107.07	40°28'22.666"N	104°44'44.281"W	0.69	
13331.00	89.320	88.510	7181.61	6200.30	3052.36	6196.04	40°28'22.685"N	104°44'43.129"W	0.55	



Actual Wellpath Report

TROUDT 26C-23-M AWP

Page 7 of 11



REFERENCE WELLPATH IDENTIFICATION

Operator	SRC ENERGY	Slot	SLOT#02 TROUDT 26C-23-M (761'FNL & 1609'FWL, SEC.27)
Area	COLORADO	Well	TROUDT 26C-23-M
Field	WELD COUNTY (NAD83,TRUE NORTH)	Wellbore	TROUDT 26C-23-M AWB
Facility	SEC.27-T06N-R66W		

WELLPATH DATA (178 stations)

MD [ft]	Inclination [°]	Azimuth [°]	TVD [ft]	Vert Sect [ft]	North [ft]	East [ft]	Latitude	Longitude	DLS [°/100ft]	Comments
13420.00	89.200	88.480	7182.76	6289.26	3054.70	6285.00	40°28'22.708"N	104°44'41.978"W	0.14	
13510.00	89.380	88.160	7183.88	6379.22	3057.34	6374.96	40°28'22.734"N	104°44'40.814"W	0.41	
13600.00	91.510	88.880	7183.18	6469.19	3059.66	6464.92	40°28'22.757"N	104°44'39.650"W	2.50	
13689.00	91.480	89.730	7180.85	6558.15	3060.74	6553.88	40°28'22.767"N	104°44'38.499"W	0.96	
13779.00	91.630	90.350	7178.41	6648.12	3060.68	6643.85	40°28'22.766"N	104°44'37.335"W	0.71	
13868.00	91.570	91.870	7175.93	6737.06	3058.96	6732.79	40°28'22.749"N	104°44'36.184"W	1.71	
13958.00	91.390	91.640	7173.60	6826.98	3056.20	6822.72	40°28'22.722"N	104°44'35.020"W	0.32	
14047.00	90.220	89.510	7172.35	6915.96	3055.31	6911.70	40°28'22.713"N	104°44'33.869"W	2.73	
14136.00	90.030	83.740	7172.16	7004.78	3060.55	7000.51	40°28'22.764"N	104°44'32.720"W	6.49	
14315.00	90.580	86.710	7171.20	7183.15	3075.44	7178.87	40°28'22.911"N	104°44'30.412"W	1.69	
14405.00	90.120	86.890	7170.66	7273.02	3080.47	7268.72	40°28'22.960"N	104°44'29.249"W	0.55	
14494.00	91.510	89.020	7169.39	7361.95	3083.64	7357.65	40°28'22.991"N	104°44'28.099"W	2.86	
14584.00	93.260	94.090	7165.64	7451.80	3081.21	7447.51	40°28'22.967"N	104°44'26.936"W	5.95	
14673.00	93.360	93.540	7160.50	7540.45	3075.29	7536.16	40°28'22.908"N	104°44'25.789"W	0.63	
14762.00	93.360	92.430	7155.29	7629.17	3070.67	7624.89	40°28'22.862"N	104°44'24.641"W	1.25	
14852.00	92.520	92.890	7150.67	7718.94	3066.50	7714.67	40°28'22.821"N	104°44'23.479"W	1.06	
14941.00	91.050	92.910	7147.90	7807.78	3062.00	7803.51	40°28'22.776"N	104°44'22.330"W	1.65	
15031.00	91.260	91.300	7146.08	7897.69	3058.69	7893.43	40°28'22.743"N	104°44'21.166"W	1.80	
15120.00	91.140	91.070	7144.22	7986.65	3056.85	7982.39	40°28'22.725"N	104°44'20.015"W	0.29	
15210.00	91.200	89.770	7142.38	8076.63	3056.19	8072.37	40°28'22.718"N	104°44'18.851"W	1.45	
15299.00	91.140	88.960	7140.56	8165.60	3057.18	8161.34	40°28'22.727"N	104°44'17.700"W	0.91	
15389.00	91.020	87.150	7138.87	8255.53	3060.23	8251.27	40°28'22.757"N	104°44'16.536"W	2.02	
15478.00	90.060	84.470	7138.03	8344.29	3066.73	8340.02	40°28'22.821"N	104°44'15.388"W	3.20	
15567.00	90.060	85.780	7137.94	8432.98	3074.30	8428.69	40°28'22.895"N	104°44'14.240"W	1.47	
15657.00	90.120	89.120	7137.79	8522.88	3078.30	8518.59	40°28'22.935"N	104°44'13.077"W	3.71	
15701.00	90.250	90.810	7137.65	8566.88	3078.33	8562.59	40°28'22.935"N	104°44'12.508"W	3.85	
15782.00	90.000	94.880	7137.48	8647.76	3074.31	8643.47	40°28'22.895"N	104°44'11.461"W	5.03	LAST BHI SURVEY (2289'FSL & 455'FEL, SEC.23)
15806.00	90.000	94.880	7137.48	8671.67	3072.27	8667.39	40°28'22.875"N	104°44'11.152"W	0.00	PROJ TO BIT (2287'FSL & 431'FEL, SEC.23)



Actual Wellpath Report

TROUDT 26C-23-M AWP

Page 8 of 11



REFERENCE WELLPATH IDENTIFICATION			
Operator	SRC ENERGY	Slot	SLOT#02 TROUDT 26C-23-M (761'FNL & 1609'FWL, SEC.27)
Area	COLORADO	Well	TROUDT 26C-23-M
Field	WELD COUNTY (NAD83,TRUE NORTH)	Wellbore	TROUDT 26C-23-M AWB
Facility	SEC.27-T06N-R66W		

HOLE & CASING SECTIONS - Ref Wellbore: TROUDT 26C-23-M AWB Ref Wellpath: TROUDT 26C-23-M AWP									
String/Diameter	Start MD [ft]	End MD [ft]	Interval [ft]	Start TVD [ft]	End TVD [ft]	Start N/S [ft]	Start E/W [ft]	End N/S [ft]	End E/W [ft]
9.625in Casing Surface	25.00	1836.00	1811.00	25.00	1826.02	0.00	0.00	59.63	-157.07



Actual Wellpath Report

TROUDT 26C-23-M AWP

Page 9 of 11



REFERENCE WELLPATH IDENTIFICATION

Operator	SRC ENERGY	Slot	SLOT#02 TROUDT 26C-23-M (761'FNL & 1609'FWL, SEC.27)
Area	COLORADO	Well	TROUDT 26C-23-M
Field	WELD COUNTY (NAD83,TRUE NORTH)	Wellbore	TROUDT 26C-23-M AWB
Facility	SEC.27-T06N-R66W		

TARGETS

Name	TVD [ft]	North [ft]	East [ft]	Grid East [US ft]	Grid North [US ft]	Latitude	Longitude	Shape
SEC.23-T06N-R66W	-8.00	4231.31	-1882.39	3201871.60	1417148.27	40°28'34.342"N	104°46'27.660"W	polygon
TROUDT 26N-23B-M HDL	0.00	0.00	0.00	3203788.80	1412932.81	40°27'52.531"N	104°46'03.302"W	polygon
SEC.22-T06N-R66W	6.00	1412.73	-8024.20	3195753.51	1414279.17	40°28'06.478"N	104°47'47.123"W	polygon
SEC.27-T06N-R66W	19.00	-4766.34	1060.36	3204888.45	1408175.58	40°27'05.432"N	104°45'49.586"W	polygon
SEC.28-T06N-R66W	19.00	-4766.34	1060.36	3204888.45	1408175.58	40°27'05.432"N	104°45'49.586"W	polygon
SEC.26-T06N-R66W	38.00	-4763.01	660.13	3204488.23	1408175.60	40°27'05.465"N	104°45'54.763"W	polygon
SEC.29-T06N-R66W EAST HALF	50.00	0.02	-15.06	3203773.74	1412932.71	40°27'52.531"N	104°46'03.497"W	polygon
TROUDT 26C-23-M BHL REV-1 (2316'FSL & 510'FEL, SEC.23)	7126.02	3043.54	8587.84	3212350.88	1416047.06	40°28'22.591"N	104°44'12.181"W	circle
TROUDT 26C-23-M BHL REV-2 (2316'FSL & 510'FEL, SEC.23)	7136.62	3043.54	8587.84	3212350.88	1416047.06	40°28'22.591"N	104°44'12.181"W	circle
TROUDT 26C-23-M TOP OF PROD REV-2 (2307'FSL & 2670'FEL, SEC.22)	7177.32	3060.66	1379.18	3205142.60	1416004.64	40°28'22.775"N	104°45'45.456"W	circle
TROUDT 26C-23-M TOP OF PROD REV-3 (2307'FSL & 2670'FEL, SEC.22)	7182.73	3060.66	1379.18	3205142.60	1416004.64	40°28'22.775"N	104°45'45.456"W	circle



Actual Wellpath Report

TROUDT 26C-23-M AWP

Page 10 of 11



REFERENCE WELLPATH IDENTIFICATION

Operator	SRC ENERGY	Slot	SLOT#02 TROUDT 26C-23-M (761'FNL & 1609'FWL, SEC.27)
Area	COLORADO	Well	TROUDT 26C-23-M
Field	WELD COUNTY (NAD83,TRUE NORTH)	Wellbore	TROUDT 26C-23-M AWB
Facility	SEC.27-T06N-R66W		

WELLPATH COMPOSITION - Ref Wellbore: TROUDT 26C-23-M AWB Ref Wellpath: TROUDT 26C-23-M AWP

Start MD [ft]	End MD [ft]	Positional Uncertainty Model	Log Name/Comment	Wellbore
25.00	1785.00	BHI NaviTrak (Standard)	13 1/2" SURFACE SECTION <88-1764>	TROUDT 26C-23-M AWB
1785.00	15782.00	BHI AutoTrak Curve (MagCAD+IFR1, Short spacing)	8 1/2" ATC MONOBORE SURVEYS <1880-15782>	TROUDT 26C-23-M AWB
15782.00	15806.00	Blind Drilling (std)	Projection to bit	TROUDT 26C-23-M AWB



Actual Wellpath Report

TROUDT 26C-23-M AWP

Page 11 of 11



REFERENCE WELLPATH IDENTIFICATION

Operator	SRC ENERGY	Slot	SLOT#02 TROUDT 26C-23-M (761'FNL & 1609'FWL, SEC.27)
Area	COLORADO	Well	TROUDT 26C-23-M
Field	WELD COUNTY (NAD83,TRUE NORTH)	Wellbore	TROUDT 26C-23-M AWB
Facility	SEC.27-T06N-R66W		

WELLPATH COMMENTS

MD [ft]	Inclination [°]	Azimuth [°]	TVD [ft]	Comment
8589.00	90.340	87.580	7183.18	LANDING POINT (2287'FSL & 2593'FEL, SEC.22)
15782.00	90.000	94.880	7137.48	LAST BHI SURVEY (2289'FSL & 455'FEL, SEC.23)
15806.00	90.000	94.880	7137.48	PROJ TO BIT (2287'FSL & 431'FEL, SEC.23)