

SRC ENERGY

Location: COLORADO Slot: SLOT#01 TROUDT 26N-23B-M (761'FNL & 1594'FWL, SEC.27)
Field: WELD COUNTY (NAD83,TRUE NORTH) Well: TROUDT 26N-23B-M
Facility: SEC.27-T06N-R66W Wellbore: TROUDT 26N-23B-M PWB

Plot reference wellpath is TROUDT 26N-23B-M PWP (REV-C.0)	Grid System: NAD83 / Lambert Colorado SP, Northern Zone (501), US feet
True vertical depths are referenced to PD 562 (25) (RKB)	North Reference: True north
Measured depths are referenced to PD 562 (25) (RKB)	Scale: True distance
PD 562 (25) (RKB) to Mean Sea Level: 4744 feet	Depths are in feet
Mean Sea Level to Mud line (At Slot: SLOT#01 TROUDT 26N-23B-M (761'FNL & 1594'FWL, SEC.27)): 0 feet	Created by: robale01 on 2018-10-25
Coordinates are in feet referenced to Slot	Database: WA DENVER

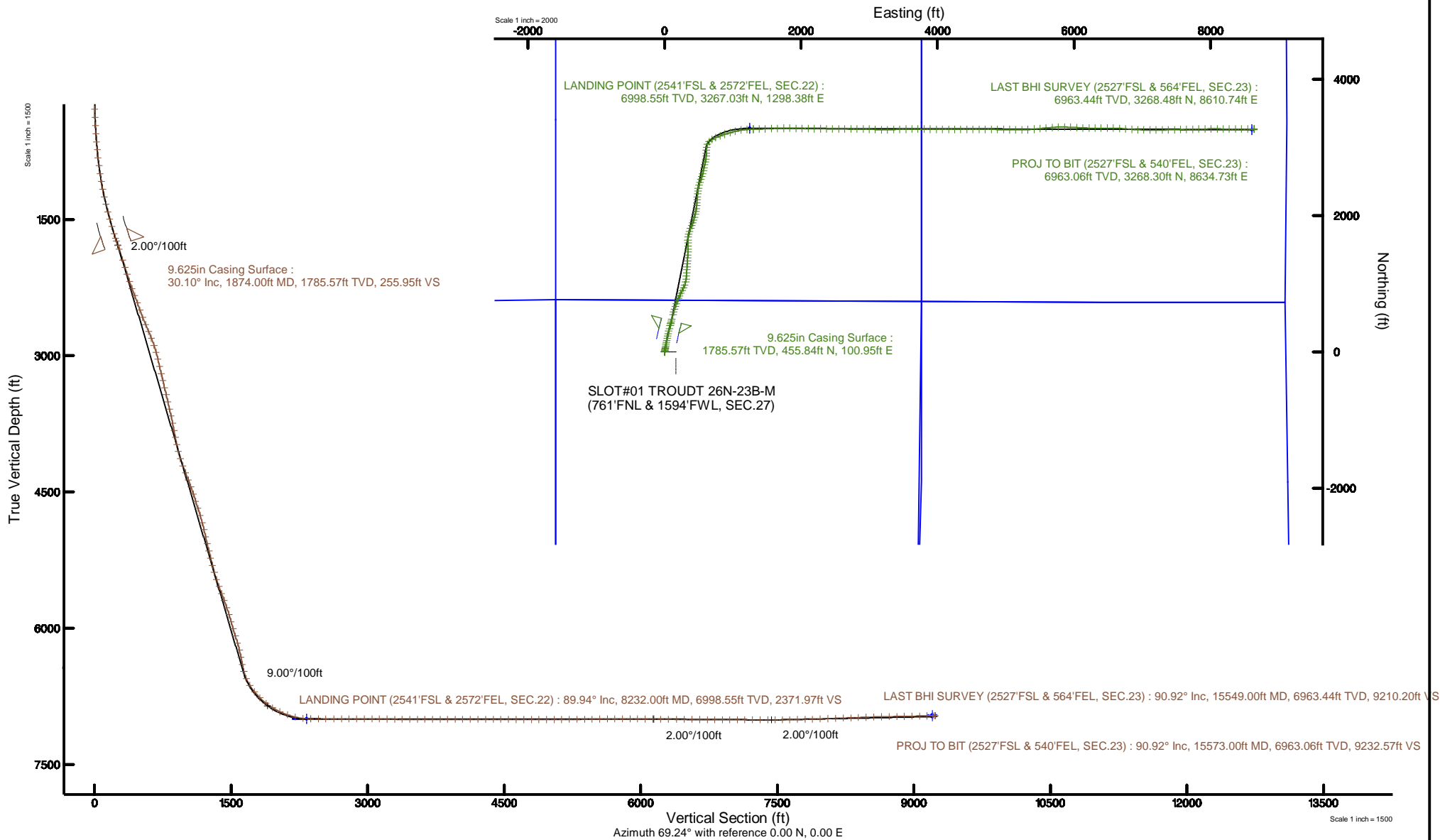



Actual Wellpath Report

TROUDT 26N-23B-M AWP

Page 1 of 10



REFERENCE WELLPATH IDENTIFICATION

Operator	SRC ENERGY	Slot	SLOT#01 TROUDT 26N-23B-M (761'FNL & 1594'FWL, SEC.27)
Area	COLORADO	Well	TROUDT 26N-23B-M
Field	WELD COUNTY (NAD83,TRUE NORTH)	Wellbore	TROUDT 26N-23B-M AWB
Facility	SEC.27-T06N-R66W		

REPORT SETUP INFORMATION

Projection System	NAD83 / Lambert Colorado SP, Northern Zone (501), US feet	Software System	WellArchitect® 5.1
North Reference	True	User	Hanisab
Scale	0.999964	Report Generated	10/29/2018 at 6:55:15 PM
Convergence at slot	0.47° East	Database/Source file	WA DENVER/TROUDT_26N-23B-M_AWP.xml

WELLPATH LOCATION

	Local coordinates		Grid coordinates		Geographic coordinates	
	North[ft]	East[ft]	Easting[US ft]	Northing[US ft]	Latitude	Longitude
Slot Location	-0.02	-0.02	3203773.73	1412932.69	40°27'52.531"N	104°46'03.497"W
Facility Reference Pt			3203773.74	1412932.71	40°27'52.531"N	104°46'03.497"W
Field Reference Pt			3171284.48	1426358.81	40°30'07.643"N	104°53'02.634"W

WELLPATH DATUM

Calculation method	Minimum curvature	PD 562 (25') (RKB) to Facility Vertical Datum	4744.00ft
Horizontal Reference Pt	Slot	PD 562 (25') (RKB) to Mean Sea Level	4744.00ft
Vertical Reference Pt	PD 562 (25') (RKB)	PD 562 (25') (RKB) to Mud Line at Slot (SLOT#01 TROUDT 26N-23B-M (761'FNL & 1594'FWL, SEC.27))	4744.00ft
MD Reference Pt	PD 562 (25') (RKB)	Section Origin	N 0.00, E 0.00 ft
Field Vertical Reference	Mean Sea Level	Section Azimuth	89.86°



Actual Wellpath Report

TROUDT 26N-23B-M AWP

Page 2 of 10



REFERENCE WELLPATH IDENTIFICATION

Operator	SRC ENERGY	Slot	SLOT#01 TROUDT 26N-23B-M (761'FNL & 1594'FWL, SEC.27)
Area	COLORADO	Well	TROUDT 26N-23B-M
Field	WELD COUNTY (NAD83,TRUE NORTH)	Wellbore	TROUDT 26N-23B-M AWB
Facility	SEC.27-T06N-R66W		

WELLPATH DATA (177 stations) † = interpolated/extrapolated station

MD [ft]	Inclination [°]	Azimuth [°]	TVD [ft]	Vert Sect [ft]	North [ft]	East [ft]	Latitude	Longitude	DLS [°/100ft]	Comments
0.00†	0.000	170.460	0.00	0.00	0.00	0.00	40°27'52.531"N	104°46'03.497"W	0.00	
25.00	0.000	170.460	25.00	0.00	0.00	0.00	40°27'52.531"N	104°46'03.497"W	0.00	
109.00	0.830	170.460	109.00	0.10	-0.60	0.10	40°27'52.525"N	104°46'03.496"W	0.99	
197.00	0.570	105.540	196.99	0.62	-1.35	0.63	40°27'52.518"N	104°46'03.489"W	0.89	
287.00	2.140	17.800	286.97	1.57	0.13	1.57	40°27'52.532"N	104°46'03.477"W	2.44	
377.00	5.000	9.160	376.79	2.73	5.61	2.71	40°27'52.586"N	104°46'03.462"W	3.22	
467.00	6.210	7.890	466.35	4.04	14.30	4.00	40°27'52.672"N	104°46'03.445"W	1.35	
557.00	7.760	9.610	555.68	5.75	25.11	5.69	40°27'52.779"N	104°46'03.423"W	1.74	
647.00	8.460	11.020	644.78	8.06	37.60	7.97	40°27'52.903"N	104°46'03.394"W	0.81	
737.00	9.970	10.390	733.62	10.76	51.77	10.64	40°27'53.043"N	104°46'03.359"W	1.68	
827.00	12.390	10.870	821.90	14.03	68.91	13.86	40°27'53.212"N	104°46'03.318"W	2.69	
917.00	14.060	10.670	909.51	17.93	89.14	17.71	40°27'53.412"N	104°46'03.268"W	1.86	
1007.00	16.340	10.400	996.36	22.29	112.34	22.02	40°27'53.641"N	104°46'03.212"W	2.53	
1097.00	16.950	11.250	1082.59	27.20	137.66	26.86	40°27'53.891"N	104°46'03.149"W	0.73	
1187.00	18.950	11.700	1168.20	32.79	164.84	32.39	40°27'54.160"N	104°46'03.078"W	2.23	
1277.00	23.130	11.860	1252.18	39.47	196.46	38.99	40°27'54.472"N	104°46'02.993"W	4.64	
1367.00	24.250	11.870	1334.60	46.99	231.85	46.42	40°27'54.822"N	104°46'02.896"W	1.24	
1457.00	23.540	12.110	1416.88	54.65	267.51	53.99	40°27'55.174"N	104°46'02.798"W	0.80	
1547.00	25.330	13.530	1498.82	63.01	303.80	62.27	40°27'55.533"N	104°46'02.691"W	2.09	
1637.00	27.320	14.740	1579.48	72.87	342.50	72.03	40°27'55.915"N	104°46'02.565"W	2.29	
1727.00	29.840	14.200	1658.51	83.72	384.19	82.78	40°27'56.327"N	104°46'02.426"W	2.81	
1784.00	30.330	14.140	1707.83	90.78	411.89	89.77	40°27'56.601"N	104°46'02.336"W	0.86	
1820.00	30.320	14.160	1738.91	95.27	429.52	94.22	40°27'56.775"N	104°46'02.278"W	0.04	
1925.00	29.900	14.870	1829.74	108.59	480.51	107.42	40°27'57.279"N	104°46'02.107"W	0.52	
2059.00	29.290	13.350	1946.26	124.89	544.68	123.56	40°27'57.913"N	104°46'01.898"W	0.72	
2149.00	28.210	14.470	2025.16	135.39	586.70	133.96	40°27'58.329"N	104°46'01.764"W	1.34	
2238.00	27.280	15.710	2103.93	146.27	626.71	144.73	40°27'58.724"N	104°46'01.624"W	1.23	
2327.00	28.190	19.160	2182.71	158.78	666.20	157.16	40°27'59.114"N	104°46'01.464"W	2.07	
2417.00	28.850	22.110	2261.79	174.03	706.40	172.31	40°27'59.511"N	104°46'01.268"W	1.73	
2506.00	28.510	22.660	2339.87	190.39	745.89	188.57	40°27'59.902"N	104°46'01.057"W	0.48	



Actual Wellpath Report

TROUDT 26N-23B-M AWP

Page 3 of 10



REFERENCE WELLPATH IDENTIFICATION

Operator	SRC ENERGY	Slot	SLOT#01 TROUDT 26N-23B-M (761'FNL & 1594'FWL, SEC.27)
Area	COLORADO	Well	TROUDT 26N-23B-M
Field	WELD COUNTY (NAD83,TRUE NORTH)	Wellbore	TROUDT 26N-23B-M AWB
Facility	SEC.27-T06N-R66W		

WELLPATH DATA (177 stations)

MD [ft]	Inclination [°]	Azimuth [°]	TVD [ft]	Vert Sect [ft]	North [ft]	East [ft]	Latitude	Longitude	DLS [°/100ft]	Comments
2596.00	27.370	23.230	2419.38	206.93	784.73	205.01	40°28'00.285"N	104°46'00.845"W	1.30	
2685.00	27.020	24.540	2498.54	223.48	821.92	221.47	40°28'00.653"N	104°46'00.632"W	0.78	
2775.00	28.090	26.370	2578.33	241.48	859.50	239.38	40°28'01.024"N	104°46'00.400"W	1.52	
2864.00	30.530	28.270	2655.94	261.59	898.19	259.39	40°28'01.406"N	104°46'00.141"W	2.93	
2954.00	30.990	22.880	2733.29	281.53	939.68	279.23	40°28'01.816"N	104°45'59.884"W	3.10	
3041.00	30.610	20.030	2808.02	297.93	981.12	295.53	40°28'02.226"N	104°45'59.673"W	1.73	
3131.00	30.550	14.070	2885.52	311.44	1024.85	308.94	40°28'02.658"N	104°45'59.500"W	3.37	
3220.00	30.660	6.770	2962.15	319.73	1069.34	317.12	40°28'03.098"N	104°45'59.394"W	4.18	
3310.00	30.480	3.580	3039.65	323.97	1114.91	321.25	40°28'03.548"N	104°45'59.341"W	1.81	
3399.00	29.310	3.170	3116.80	326.69	1159.19	323.86	40°28'03.986"N	104°45'59.307"W	1.33	
3490.00	29.410	3.950	3196.12	329.57	1203.72	326.63	40°28'04.426"N	104°45'59.271"W	0.43	
3579.00	29.160	3.810	3273.74	332.63	1247.16	329.58	40°28'04.855"N	104°45'59.233"W	0.29	
3669.00	29.120	4.480	3352.35	335.90	1290.87	332.75	40°28'05.287"N	104°45'59.192"W	0.37	
3758.00	28.950	4.150	3430.17	339.26	1333.94	336.00	40°28'05.712"N	104°45'59.150"W	0.26	
3847.00	29.160	4.340	3507.97	342.56	1377.04	339.20	40°28'06.138"N	104°45'59.108"W	0.26	
3937.00	29.070	3.250	3586.59	345.57	1420.74	342.10	40°28'06.570"N	104°45'59.071"W	0.60	
4027.00	29.280	1.810	3665.18	347.61	1464.56	344.03	40°28'07.003"N	104°45'59.046"W	0.81	
4116.00	29.750	359.450	3742.63	348.19	1508.40	344.51	40°28'07.436"N	104°45'59.040"W	1.41	
4207.00	29.500	359.110	3821.73	347.74	1553.38	343.94	40°28'07.881"N	104°45'59.047"W	0.33	
4296.00	29.000	359.140	3899.39	347.18	1596.86	343.28	40°28'08.310"N	104°45'59.055"W	0.56	
4386.00	29.200	359.380	3978.03	346.72	1640.63	342.71	40°28'08.743"N	104°45'59.063"W	0.26	
4475.00	29.580	6.440	4055.59	349.06	1684.18	344.94	40°28'09.173"N	104°45'59.034"W	3.91	
4565.00	29.670	15.530	4133.87	357.62	1727.74	353.40	40°28'09.604"N	104°45'58.924"W	4.99	
4654.00	29.730	19.510	4211.19	370.99	1769.76	366.67	40°28'10.019"N	104°45'58.753"W	2.22	
4743.00	29.970	22.160	4288.38	386.85	1811.15	382.43	40°28'10.428"N	104°45'58.549"W	1.51	
4833.00	28.840	23.060	4366.79	403.93	1851.95	399.41	40°28'10.831"N	104°45'58.329"W	1.35	
4922.00	29.220	18.780	4444.61	419.43	1892.27	414.81	40°28'11.229"N	104°45'58.130"W	2.37	
5012.00	28.970	15.260	4523.26	432.35	1934.10	427.62	40°28'11.643"N	104°45'57.964"W	1.92	
5102.00	28.860	14.550	4602.04	443.64	1976.15	438.81	40°28'12.058"N	104°45'57.819"W	0.40	
5191.00	29.050	14.190	4679.92	454.44	2017.89	449.51	40°28'12.471"N	104°45'57.681"W	0.29	



Actual Wellpath Report

TROUDT 26N-23B-M AWP

Page 4 of 10



REFERENCE WELLPATH IDENTIFICATION

Operator	SRC ENERGY	Slot	SLOT#01 TROUDT 26N-23B-M (761'FNL & 1594'FWL, SEC.27)
Area	COLORADO	Well	TROUDT 26N-23B-M
Field	WELD COUNTY (NAD83,TRUE NORTH)	Wellbore	TROUDT 26N-23B-M AWB
Facility	SEC.27-T06N-R66W		

WELLPATH DATA (177 stations)

MD [ft]	Inclination [°]	Azimuth [°]	TVD [ft]	Vert Sect [ft]	North [ft]	East [ft]	Latitude	Longitude	DLS [°/100ft]	Comments
5281.00	28.880	11.240	4758.66	464.13	2060.39	459.10	40°28'12.891"N	104°45'57.557"W	1.60	
5370.00	29.020	9.240	4836.54	471.89	2102.78	466.76	40°28'13.310"N	104°45'57.458"W	1.10	
5459.00	28.870	4.890	4914.44	477.30	2145.50	472.06	40°28'13.732"N	104°45'57.389"W	2.37	
5549.00	28.840	2.540	4993.26	480.22	2188.83	474.87	40°28'14.160"N	104°45'57.353"W	1.26	
5638.00	28.680	3.700	5071.29	482.65	2231.59	477.20	40°28'14.582"N	104°45'57.323"W	0.65	
5727.00	28.940	6.020	5149.27	486.39	2274.32	480.84	40°28'15.005"N	104°45'57.275"W	1.29	
5817.00	28.960	6.310	5228.03	491.18	2317.63	485.51	40°28'15.433"N	104°45'57.215"W	0.16	
5907.00	28.930	6.030	5306.78	495.96	2360.93	490.20	40°28'15.861"N	104°45'57.154"W	0.15	
5996.00	28.110	10.060	5384.99	501.99	2402.99	496.12	40°28'16.276"N	104°45'57.078"W	2.35	
6085.00	29.830	15.750	5462.87	511.77	2444.95	505.79	40°28'16.691"N	104°45'56.953"W	3.65	
6175.00	30.300	17.530	5540.76	524.79	2488.15	518.71	40°28'17.118"N	104°45'56.785"W	1.12	
6264.00	30.250	19.290	5617.62	539.06	2530.71	532.88	40°28'17.538"N	104°45'56.602"W	1.00	
6353.00	30.270	18.690	5694.50	553.76	2573.12	547.47	40°28'17.957"N	104°45'56.413"W	0.34	
6443.00	30.300	15.040	5772.22	567.02	2616.54	560.63	40°28'18.386"N	104°45'56.243"W	2.05	
6532.00	30.240	10.950	5849.09	577.21	2660.23	570.72	40°28'18.818"N	104°45'56.112"W	2.32	
6622.00	28.250	9.220	5927.62	585.04	2703.51	578.44	40°28'19.246"N	104°45'56.013"W	2.40	
6711.00	28.340	13.260	6005.99	593.36	2744.86	586.66	40°28'19.654"N	104°45'55.906"W	2.15	
6801.00	29.500	14.070	6084.77	603.75	2787.15	596.94	40°28'20.072"N	104°45'55.773"W	1.36	
6890.00	29.550	9.780	6162.22	612.91	2830.04	606.00	40°28'20.496"N	104°45'55.656"W	2.38	
6980.00	29.630	5.280	6240.49	618.84	2874.07	611.82	40°28'20.931"N	104°45'55.581"W	2.47	
7069.00	28.260	0.470	6318.38	621.14	2917.05	614.01	40°28'21.356"N	104°45'55.552"W	3.03	
7159.00	28.390	0.590	6397.61	621.64	2959.76	614.41	40°28'21.778"N	104°45'55.547"W	0.16	
7248.00	28.730	4.260	6475.78	623.55	3002.25	616.22	40°28'22.198"N	104°45'55.524"W	2.01	
7337.00	31.390	23.750	6552.99	634.61	3044.90	627.17	40°28'22.619"N	104°45'55.382"W	11.32	
7427.00	34.700	44.280	6628.66	662.12	3084.84	654.59	40°28'23.014"N	104°45'55.027"W	12.91	
7516.00	39.610	60.270	6699.74	704.65	3117.14	697.04	40°28'23.333"N	104°45'54.478"W	12.13	
7606.00	45.600	65.170	6765.97	758.88	3144.90	751.19	40°28'23.607"N	104°45'53.777"W	7.60	
7695.00	51.240	68.980	6825.03	820.25	3170.72	812.50	40°28'23.862"N	104°45'52.984"W	7.10	
7785.00	58.790	73.940	6876.61	890.17	3194.00	882.37	40°28'24.092"N	104°45'52.080"W	9.52	
7875.00	64.220	74.600	6919.54	966.34	3215.43	958.48	40°28'24.304"N	104°45'51.095"W	6.07	



Actual Wellpath Report

TROUDT 26N-23B-M AWP

Page 5 of 10



REFERENCE WELLPATH IDENTIFICATION

Operator	SRC ENERGY	Slot	SLOT#01 TROUDT 26N-23B-M (761'FNL & 1594'FWL, SEC.27)
Area	COLORADO	Well	TROUDT 26N-23B-M
Field	WELD COUNTY (NAD83,TRUE NORTH)	Wellbore	TROUDT 26N-23B-M AWB
Facility	SEC.27-T06N-R66W		

WELLPATH DATA (177 stations)

MD [ft]	Inclination [°]	Azimuth [°]	TVD [ft]	Vert Sect [ft]	North [ft]	East [ft]	Latitude	Longitude	DLS [°/100ft]	Comments
7964.00	71.020	74.450	6953.40	1045.66	3237.37	1037.75	40°28'24.521"N	104°45'50.069"W	7.64	
8053.00	77.650	81.740	6977.45	1129.46	3254.94	1121.51	40°28'24.694"N	104°45'48.985"W	10.84	
8143.00	82.680	86.820	6992.83	1217.66	3263.74	1209.69	40°28'24.781"N	104°45'47.844"W	7.88	
8232.00	89.940	88.920	6998.55	1306.35	3267.03	1298.38	40°28'24.814"N	104°45'46.697"W	8.49	LANDING POINT (2541'FSL & 2572'FEL, SEC.22)
8322.00	89.970	88.520	6998.62	1396.34	3269.05	1388.35	40°28'24.834"N	104°45'45.532"W	0.45	
8411.00	90.000	87.490	6998.65	1485.29	3272.14	1477.30	40°28'24.864"N	104°45'44.382"W	1.16	
8501.00	90.000	87.570	6998.65	1575.21	3276.02	1567.21	40°28'24.903"N	104°45'43.218"W	0.09	
8591.00	90.000	88.460	6998.65	1665.17	3279.14	1657.16	40°28'24.933"N	104°45'42.054"W	0.99	
8680.00	90.030	89.190	6998.62	1754.15	3280.96	1746.14	40°28'24.951"N	104°45'40.903"W	0.82	
8770.00	89.970	90.280	6998.62	1844.15	3281.38	1836.14	40°28'24.955"N	104°45'39.738"W	1.21	
8859.00	89.970	91.240	6998.67	1933.14	3280.20	1925.13	40°28'24.944"N	104°45'38.587"W	1.08	
8949.00	90.090	91.330	6998.62	2023.11	3278.18	2015.11	40°28'24.924"N	104°45'37.423"W	0.17	
9038.00	90.120	91.430	6998.46	2112.08	3276.04	2104.08	40°28'24.902"N	104°45'36.271"W	0.12	
9127.00	88.490	90.470	6999.54	2201.05	3274.56	2193.06	40°28'24.888"N	104°45'35.120"W	2.13	
9217.00	88.520	90.390	7001.89	2291.02	3273.89	2283.02	40°28'24.881"N	104°45'33.956"W	0.09	
9306.00	89.750	90.440	7003.23	2380.00	3273.24	2372.01	40°28'24.874"N	104°45'32.804"W	1.38	
9396.00	89.940	89.920	7003.47	2470.00	3272.96	2462.01	40°28'24.872"N	104°45'31.640"W	0.62	
9485.00	89.850	90.470	7003.64	2559.00	3272.66	2551.01	40°28'24.869"N	104°45'30.488"W	0.63	
9575.00	89.820	91.020	7003.90	2648.99	3271.49	2641.00	40°28'24.857"N	104°45'29.324"W	0.61	
9664.00	89.910	90.570	7004.11	2737.97	3270.25	2729.99	40°28'24.845"N	104°45'28.172"W	0.52	
9753.00	90.060	90.760	7004.13	2826.96	3269.22	2818.98	40°28'24.834"N	104°45'27.021"W	0.27	
9843.00	90.220	90.490	7003.91	2916.96	3268.24	2908.98	40°28'24.824"N	104°45'25.856"W	0.35	
9932.00	90.370	90.350	7003.45	3005.95	3267.59	2997.98	40°28'24.818"N	104°45'24.705"W	0.23	
10021.00	90.250	94.550	7002.97	3094.84	3263.78	3086.87	40°28'24.780"N	104°45'23.555"W	4.72	
10111.00	90.000	91.630	7002.77	3184.69	3258.93	3176.73	40°28'24.732"N	104°45'22.392"W	3.26	
10201.00	89.780	87.470	7002.95	3274.66	3259.64	3266.71	40°28'24.739"N	104°45'21.228"W	4.63	
10290.00	89.600	87.900	7003.43	3363.60	3263.23	3355.63	40°28'24.774"N	104°45'20.077"W	0.52	
10380.00	89.970	88.650	7003.77	3453.56	3265.94	3445.59	40°28'24.801"N	104°45'18.913"W	0.93	
10469.00	89.940	89.540	7003.84	3542.55	3267.35	3534.58	40°28'24.815"N	104°45'17.761"W	1.00	
10558.00	89.780	89.570	7004.05	3631.55	3268.04	3623.58	40°28'24.822"N	104°45'16.610"W	0.18	



Actual Wellpath Report

TROUDT 26N-23B-M AWP

Page 6 of 10



REFERENCE WELLPATH IDENTIFICATION

Operator	SRC ENERGY	Slot	SLOT#01 TROUDT 26N-23B-M (761'FNL & 1594'FWL, SEC.27)
Area	COLORADO	Well	TROUDT 26N-23B-M
Field	WELD COUNTY (NAD83,TRUE NORTH)	Wellbore	TROUDT 26N-23B-M AWB
Facility	SEC.27-T06N-R66W		

WELLPATH DATA (177 stations)

MD [ft]	Inclination [°]	Azimuth [°]	TVD [ft]	Vert Sect [ft]	North [ft]	East [ft]	Latitude	Longitude	DLS [°/100ft]	Comments
10648.00	89.780	89.970	7004.40	3721.55	3268.40	3713.58	40°28'24.825"N	104°45'15.445"W	0.44	
10737.00	89.820	90.140	7004.71	3810.55	3268.31	3802.58	40°28'24.824"N	104°45'14.294"W	0.20	
10827.00	89.940	90.810	7004.90	3900.54	3267.57	3892.57	40°28'24.816"N	104°45'13.129"W	0.76	
10916.00	90.150	91.180	7004.83	3989.53	3266.02	3981.56	40°28'24.801"N	104°45'11.978"W	0.48	
11006.00	90.090	90.190	7004.64	4079.52	3264.95	4071.55	40°28'24.790"N	104°45'10.813"W	1.10	
11095.00	90.030	89.550	7004.55	4168.52	3265.15	4160.55	40°28'24.792"N	104°45'09.662"W	0.72	
11184.00	89.970	89.610	7004.55	4257.51	3265.80	4249.55	40°28'24.798"N	104°45'08.510"W	0.10	
11274.00	90.770	90.030	7003.97	4347.51	3266.08	4339.54	40°28'24.801"N	104°45'07.346"W	1.00	
11363.00	90.740	89.620	7002.79	4436.50	3266.36	4428.54	40°28'24.804"N	104°45'06.194"W	0.46	
11453.00	90.740	90.110	7001.63	4526.50	3266.57	4518.53	40°28'24.806"N	104°45'05.030"W	0.54	
11542.00	90.710	89.940	7000.50	4615.49	3266.53	4607.52	40°28'24.805"N	104°45'03.878"W	0.19	
11631.00	90.740	90.350	6999.38	4704.48	3266.30	4696.51	40°28'24.803"N	104°45'02.727"W	0.46	
11721.00	90.000	90.900	6998.80	4794.47	3265.32	4786.50	40°28'24.793"N	104°45'01.562"W	1.02	
11810.00	90.090	91.100	6998.73	4883.45	3263.77	4875.49	40°28'24.777"N	104°45'00.411"W	0.25	
11900.00	89.880	90.730	6998.75	4973.44	3262.33	4965.48	40°28'24.763"N	104°44'59.246"W	0.47	
11989.00	89.970	91.080	6998.87	5062.42	3260.93	5054.47	40°28'24.749"N	104°44'58.095"W	0.41	
12078.00	89.780	91.190	6999.06	5151.40	3259.16	5143.45	40°28'24.731"N	104°44'56.944"W	0.25	
12168.00	89.690	89.650	6999.48	5241.39	3258.50	5233.44	40°28'24.724"N	104°44'55.779"W	1.71	
12257.00	89.690	86.910	6999.96	5330.35	3261.17	5322.39	40°28'24.751"N	104°44'54.628"W	3.08	
12347.00	89.380	84.960	7000.69	5420.13	3267.55	5412.16	40°28'24.814"N	104°44'53.467"W	2.19	
12436.00	89.510	84.330	7001.55	5508.76	3275.86	5500.77	40°28'24.895"N	104°44'52.320"W	0.72	
12526.00	89.320	84.100	7002.47	5598.31	3284.93	5590.30	40°28'24.985"N	104°44'51.161"W	0.33	
12615.00	89.540	85.000	7003.36	5686.93	3293.38	5678.90	40°28'25.068"N	104°44'50.015"W	1.04	
12705.00	89.510	88.300	7004.10	5776.77	3298.64	5768.73	40°28'25.120"N	104°44'48.853"W	3.67	
12795.00	89.600	91.210	7004.80	5866.76	3299.03	5858.71	40°28'25.124"N	104°44'47.688"W	3.23	
12885.00	89.750	93.250	7005.31	5956.67	3295.52	5948.64	40°28'25.089"N	104°44'46.525"W	2.27	
12975.00	89.780	92.700	7005.68	6046.54	3290.85	6038.52	40°28'25.042"N	104°44'45.362"W	0.61	
13064.00	89.820	92.470	7005.99	6135.44	3286.84	6127.43	40°28'25.002"N	104°44'44.211"W	0.26	
13154.00	89.750	91.540	7006.33	6225.37	3283.69	6217.37	40°28'24.971"N	104°44'43.048"W	1.04	
13243.00	89.850	90.190	7006.64	6314.36	3282.35	6306.36	40°28'24.958"N	104°44'41.896"W	1.52	



Actual Wellpath Report

TROUDT 26N-23B-M AWP

Page 7 of 10



REFERENCE WELLPATH IDENTIFICATION

Operator	SRC ENERGY	Slot	SLOT#01 TROUDT 26N-23B-M (761'FNL & 1594'FWL, SEC.27)
Area	COLORADO	Well	TROUDT 26N-23B-M
Field	WELD COUNTY (NAD83,TRUE NORTH)	Wellbore	TROUDT 26N-23B-M AWB
Facility	SEC.27-T06N-R66W		

WELLPATH DATA (177 stations)

MD [ft]	Inclination [°]	Azimuth [°]	TVD [ft]	Vert Sect [ft]	North [ft]	East [ft]	Latitude	Longitude	DLS [°/100ft]	Comments
13332.00	89.540	90.010	7007.11	6403.36	3282.19	6395.35	40°28'24.956"N	104°44'40.745"W	0.40	
13422.00	89.600	89.640	7007.79	6493.35	3282.47	6485.35	40°28'24.958"N	104°44'39.580"W	0.42	
13511.00	89.570	90.990	7008.43	6582.35	3281.98	6574.35	40°28'24.953"N	104°44'38.428"W	1.52	
13601.00	89.410	92.870	7009.24	6672.28	3278.95	6664.29	40°28'24.923"N	104°44'37.265"W	2.10	
13691.00	91.020	94.930	7008.90	6762.05	3272.83	6754.07	40°28'24.862"N	104°44'36.103"W	2.90	
13780.00	90.860	94.420	7007.44	6850.72	3265.57	6842.76	40°28'24.790"N	104°44'34.955"W	0.60	
13870.00	91.110	92.950	7005.89	6940.50	3259.79	6932.56	40°28'24.733"N	104°44'33.793"W	1.66	
13959.00	91.230	90.980	7004.07	7029.42	3256.74	7021.48	40°28'24.703"N	104°44'32.643"W	2.22	
14049.00	91.140	90.310	7002.21	7119.39	3255.73	7111.46	40°28'24.692"N	104°44'31.479"W	0.75	
14138.00	91.170	89.680	7000.42	7208.37	3255.73	7200.44	40°28'24.692"N	104°44'30.327"W	0.71	
14227.00	92.030	89.320	6997.93	7297.34	3256.51	7289.40	40°28'24.700"N	104°44'29.176"W	1.05	
14317.00	92.030	89.060	6994.74	7387.27	3257.78	7379.34	40°28'24.712"N	104°44'28.012"W	0.29	
14406.00	91.850	89.010	6991.73	7476.21	3259.28	7468.27	40°28'24.726"N	104°44'26.862"W	0.21	
14496.00	92.000	88.170	6988.71	7566.14	3261.49	7558.19	40°28'24.748"N	104°44'25.698"W	0.95	
14585.00	92.030	88.010	6985.58	7655.04	3264.46	7647.09	40°28'24.777"N	104°44'24.548"W	0.18	
14674.00	91.790	88.730	6982.61	7743.96	3266.99	7736.00	40°28'24.802"N	104°44'23.397"W	0.85	
14764.00	91.750	88.760	6979.83	7833.90	3268.96	7825.94	40°28'24.821"N	104°44'22.234"W	0.06	
14853.00	92.000	89.380	6976.92	7922.85	3270.40	7914.88	40°28'24.835"N	104°44'21.083"W	0.75	
14943.00	90.890	89.850	6974.65	8012.82	3271.01	8004.85	40°28'24.841"N	104°44'19.919"W	1.34	
15032.00	90.990	90.100	6973.19	8101.80	3271.04	8093.83	40°28'24.841"N	104°44'18.767"W	0.30	
15122.00	91.020	90.360	6971.61	8191.79	3270.68	8183.82	40°28'24.837"N	104°44'17.603"W	0.29	
15211.00	91.110	90.310	6969.96	8280.77	3270.16	8272.80	40°28'24.831"N	104°44'16.451"W	0.12	
15301.00	91.200	90.330	6968.14	8370.75	3269.66	8362.78	40°28'24.826"N	104°44'15.287"W	0.10	
15390.00	91.020	90.210	6966.42	8459.73	3269.24	8451.77	40°28'24.822"N	104°44'14.136"W	0.24	
15479.00	91.170	90.240	6964.72	8548.71	3268.89	8540.75	40°28'24.818"N	104°44'12.984"W	0.17	
15549.00	90.920	90.430	6963.44	8618.70	3268.48	8610.74	40°28'24.814"N	104°44'12.079"W	0.45	LAST BHI SURVEY (2527'FSL & 564'FEL, SEC.23)
15573.00	90.920	90.430	6963.06	8642.69	3268.30	8634.73	40°28'24.812"N	104°44'11.768"W	0.00	PROJ TO BIT (2527'FSL & 540'FEL, SEC.23)



Actual Wellpath Report

TROUDT 26N-23B-M AWP

Page 8 of 10



REFERENCE WELLPATH IDENTIFICATION

Operator	SRC ENERGY	Slot	SLOT#01 TROUDT 26N-23B-M (761'FNL & 1594'FWL, SEC.27)
Area	COLORADO	Well	TROUDT 26N-23B-M
Field	WELD COUNTY (NAD83,TRUE NORTH)	Wellbore	TROUDT 26N-23B-M AWB
Facility	SEC.27-T06N-R66W		

HOLE & CASING SECTIONS - Ref Wellbore: TROUDT 26N-23B-M AWB Ref Wellpath: TROUDT 26N-23B-M AWP

String/Diameter	Start MD [ft]	End MD [ft]	Interval [ft]	Start TVD [ft]	End TVD [ft]	Start N/S [ft]	Start E/W [ft]	End N/S [ft]	End E/W [ft]
9.625in Casing Surface	25.00	1874.00	1849.00	25.00	1785.57	0.00	0.00	455.84	100.95

TARGETS

Name	TVD [ft]	North [ft]	East [ft]	Grid East [US ft]	Grid North [US ft]	Latitude	Longitude	Shape
SEC.23-T06N-R66W	-8.00	4231.31	-1867.32	3201871.60	1417148.27	40°28'34.342"N	104°46'27.660"W	polygon
SEC.22-T06N-R66W	6.00	1412.72	-8009.13	3195753.51	1414279.17	40°28'06.478"N	104°47'47.123"W	polygon
SEC.27-T06N-R66W	19.00	-4766.34	1075.43	3204888.45	1408175.58	40°27'05.432"N	104°45'49.586"W	polygon
SEC.28-T06N-R66W	19.00	-4766.34	1075.43	3204888.45	1408175.58	40°27'05.432"N	104°45'49.586"W	polygon
SEC.26-T06N-R66W	38.00	-4763.01	675.21	3204488.23	1408175.60	40°27'05.465"N	104°45'54.763"W	polygon
TROUDT 26N-23B-M BHL ON PLAT (2534'FSL & 510'FEL, SEC.23)	6952.00	3261.43	8605.05	3212351.22	1416264.95	40°28'24.744"N	104°44'12.152"W	circle
TROUDT 26N-23B-M BHL REV-3 (2534'FSL & 510'FEL, SEC.23)	6973.03	3261.43	8605.08	3212351.25	1416264.95	40°28'24.744"N	104°44'12.152"W	circle
TROUDT 26N-23B-M TOP OF PROD ON PLAT (2528'FSL & 2519'FEL, SEC.22)	6994.00	3280.36	1245.04	3204991.59	1416223.09	40°28'24.946"N	104°45'47.387"W	circle
TROUDT 26N-23B-M TOP OF PROD REV-3 (2528'FSL & 2519'FEL, SEC.22)	6998.52	3280.40	1245.03	3204991.58	1416223.13	40°28'24.946"N	104°45'47.387"W	circle



Actual Wellpath Report

TROUDT 26N-23B-M AWP

Page 9 of 10



REFERENCE WELLPATH IDENTIFICATION

Operator	SRC ENERGY	Slot	SLOT#01 TROUDT 26N-23B-M (761'FNL & 1594'FWL, SEC.27)
Area	COLORADO	Well	TROUDT 26N-23B-M
Field	WELD COUNTY (NAD83,TRUE NORTH)	Wellbore	TROUDT 26N-23B-M AWB
Facility	SEC.27-T06N-R66W		

WELLPATH COMPOSITION - Ref Wellbore: TROUDT 26N-23B-M AWB Ref Wellpath: TROUDT 26N-23B-M AWP

Start MD [ft]	End MD [ft]	Positional Uncertainty Model	Log Name/Comment	Wellbore
25.00	1820.00	BHI NaviTrak (Standard)	13 1/2" SURFACE SECTION <88-1799>	TROUDT 26N-23B-M AWB
1820.00	15549.00	BHI AutoTrak Curve (MagCAD+IFR1, Short spacing)	BHI ATC 8.5" 3RD PARTY CORRECTIONS (MAGCAD & IFR & SHORT)<1925-15573>	TROUDT 26N-23B-M AWB
15549.00	15573.00	Blind Drilling (std)	Projection to bit	TROUDT 26N-23B-M AWB



Actual Wellpath Report

TROUDT 26N-23B-M AWP

Page 10 of 10



REFERENCE WELLPATH IDENTIFICATION

Operator	SRC ENERGY	Slot	SLOT#01 TROUDT 26N-23B-M (761'FNL & 1594'FWL, SEC.27)
Area	COLORADO	Well	TROUDT 26N-23B-M
Field	WELD COUNTY (NAD83,TRUE NORTH)	Wellbore	TROUDT 26N-23B-M AWB
Facility	SEC.27-T06N-R66W		

WELLPATH COMMENTS

MD [ft]	Inclination [°]	Azimuth [°]	TVD [ft]	Comment
8232.00	89.940	88.920	6998.55	LANDING POINT (2541'FSL & 2572'FEL, SEC.22)
15549.00	90.920	90.430	6963.44	LAST BHI SURVEY (2527'FSL & 564'FEL, SEC.23)
15573.00	90.920	90.430	6963.06	PROJ TO BIT (2527'FSL & 540'FEL, SEC.23)