

ACCESS ROAD MAP
BUFFALO CS PAD
NE1/4 SEC. 30, T1N, R67W, 6TH P.M.

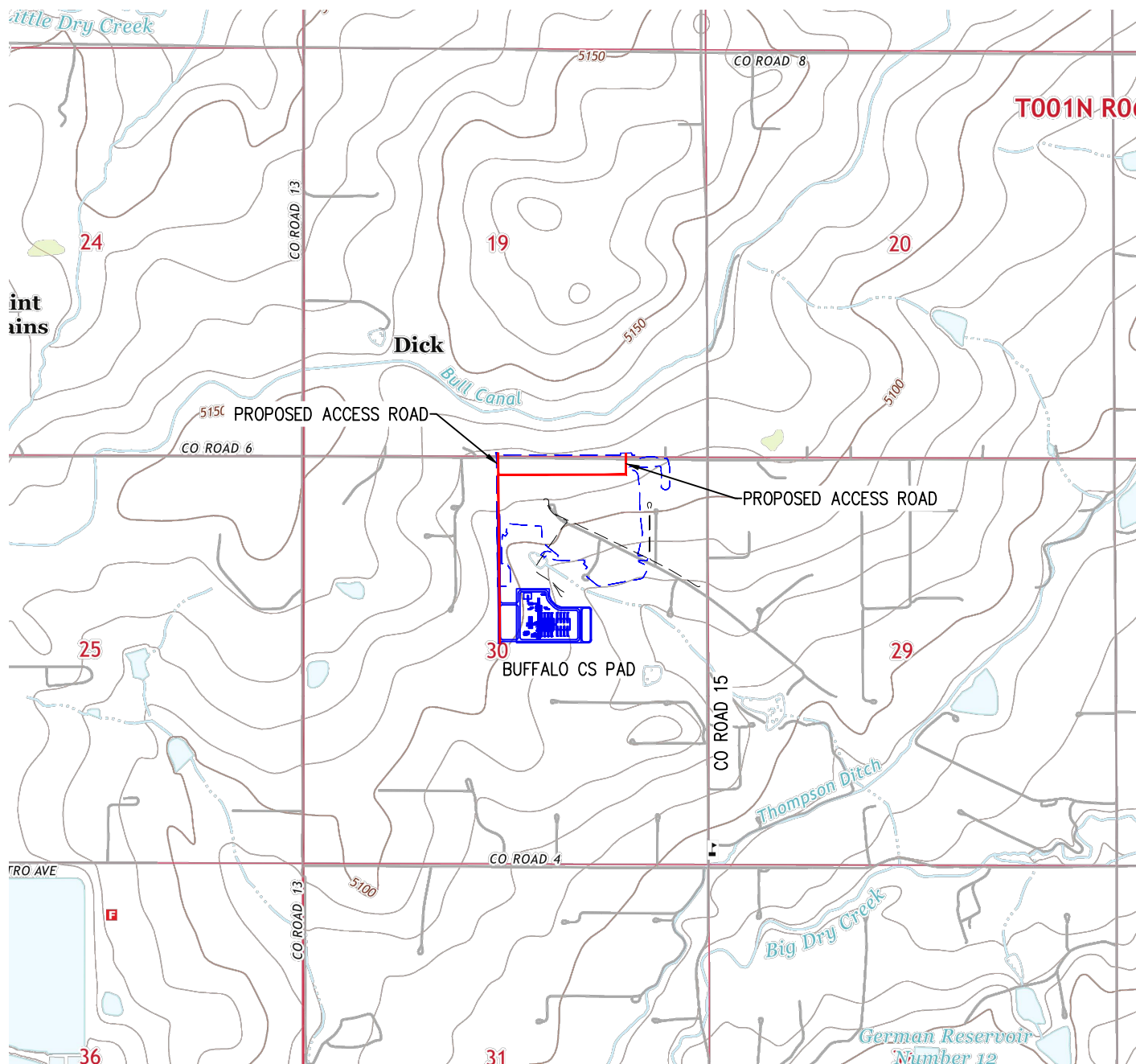

FROM LAFAYETTE, CO: FROM THE INTERSECTION OF US-287 AND CO RD 7,
DRIVE EAST ON CO RD 7 E FOR ± 6.7 MILES TO E 168TH AVE AND TURN LEFT.
DRIVE EAST ON 168TH AVE FOR ± 1.9 MILES TO CO RD 13 AND TURN LEFT.
DRIVE NORTH ON CO RD 13 ± 2.0 MILES TO CO RD 6 AND TURN RIGHT.
DRIVE EAST ON CO RD 6 ± 0.6 MILES AND TURN RIGHT ONTO PROPOSED ACCESS ROAD.
DRIVE SOUTH ON PROPOSED ACCESS ROAD FOR ± 500 FEET TO PROPOSED FACILITY LOCATION.

TOTAL DISTANCE FROM LAFAYETTE, CO TO PROPOSED FACILITY LOCATION IS ± 11.3 MILES

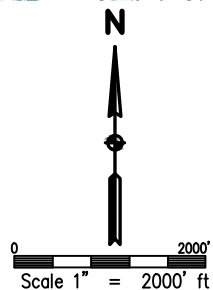

DRAWN BY	CHECKED BY
RPM	AAD
INITIAL SUBMITTAL	8/8/2017
REVISED	10/12/2018
DRAWING SIZE	8.5" X 11"
JOB NO.	EXTIN67W30-01
SHEET	1 OF 1

BASLINE
Engineering - Planning - Surveying
4007 S. LINCOLN AVENUE, SUITE 405 • LOVELAND, COLORADO 80537
P: 970.353.7600 • F: 970.353.7601 • www.baselinecorp.com