

FRANE SURVEYING INC.

Physical Address: 34834 Annie Cir.
Mail to: Box 2372, Elizabeth, CO 80107
Ph. 303-243-0037
www.franesurveying.com
Job # 18-236-Dado 1-21

Frane Surveying, in accordance with a request from **Grand Mesa Operating** has determined the location of **Dado 1-21** to be **1872 Feet FNL**, and **614 Feet FEL**, (90° off Section lines) of Section **21**, Township **7s**, Range **55w** of the 6th Principal Meridian, **Lincoln County**, Colorado.

Date: Staked on 11/01/18 drawn on 11/02/18.

Re: Staked by Elijah Frane
Drawn: Drawn by Elijah Frane

1000' HYDROLOGY MAP

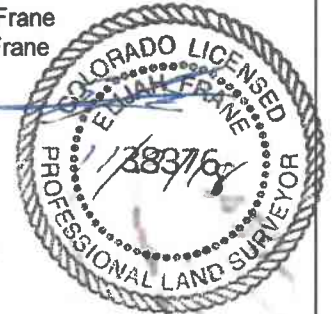

An apparent surface water area exists approx. 355' West of proposed well pad at it's closest point. A windmill exists approx. 1975' Northwest of proposed well head.

WINDMILL NO PERMIT
ON RECORD

GRAND MESA OPERATING
NE 1/4 SEC. 21-7s-55w
DADO 1-21
LINCOLN, Co. COLORADO

21

C.R. 28

