



FRANE SURVEYING INC.

Physical Address: 34834 Annie Cir.
Mail to: Box 2372, Elizabeth, CO 80107
Ph. 303-243-0037
www.franesurveying.com
Job # 18-038-Betty Tank Batt

Frane Surveying, in accordance with a request from Grand Mesa Operating has determined the location of the Center of the Betty Production Facility to be 698 Feet FSL, and 105 Feet FWL, (90° off Section lines) of Section 15, Township 7s, Range 55w of the 6th Principal Meridian, Lincoln County, Colorado.

Date: Staked on 04/18/18 drawn on 04/19/18.

Re: Staked by Elijah Frane
Drawn: Drawn by Elijah Frane

ACCESS ROAD MAP

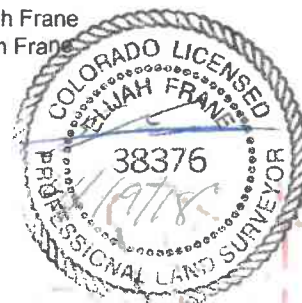

GRAND MESA OPERATING
SW 1/4 SEC. 15-7s-55w
BETTY PRODUCTION FACILITY
LINCOLN, Co. COLORADO

C.R. 28

