



Lat40°, Inc. 6250 W. 10th Street, Unit 2, Greeley, CO 970-515-5294

# PROPOSED SCALED FACILITY DRAWING

JAGGED 4N64W08 1-12 PAD

SECTION: 8  
TOWNSHIP: 4N  
RANGE: 64W  
6TH. P.M.  
WELD COUNTY, CO

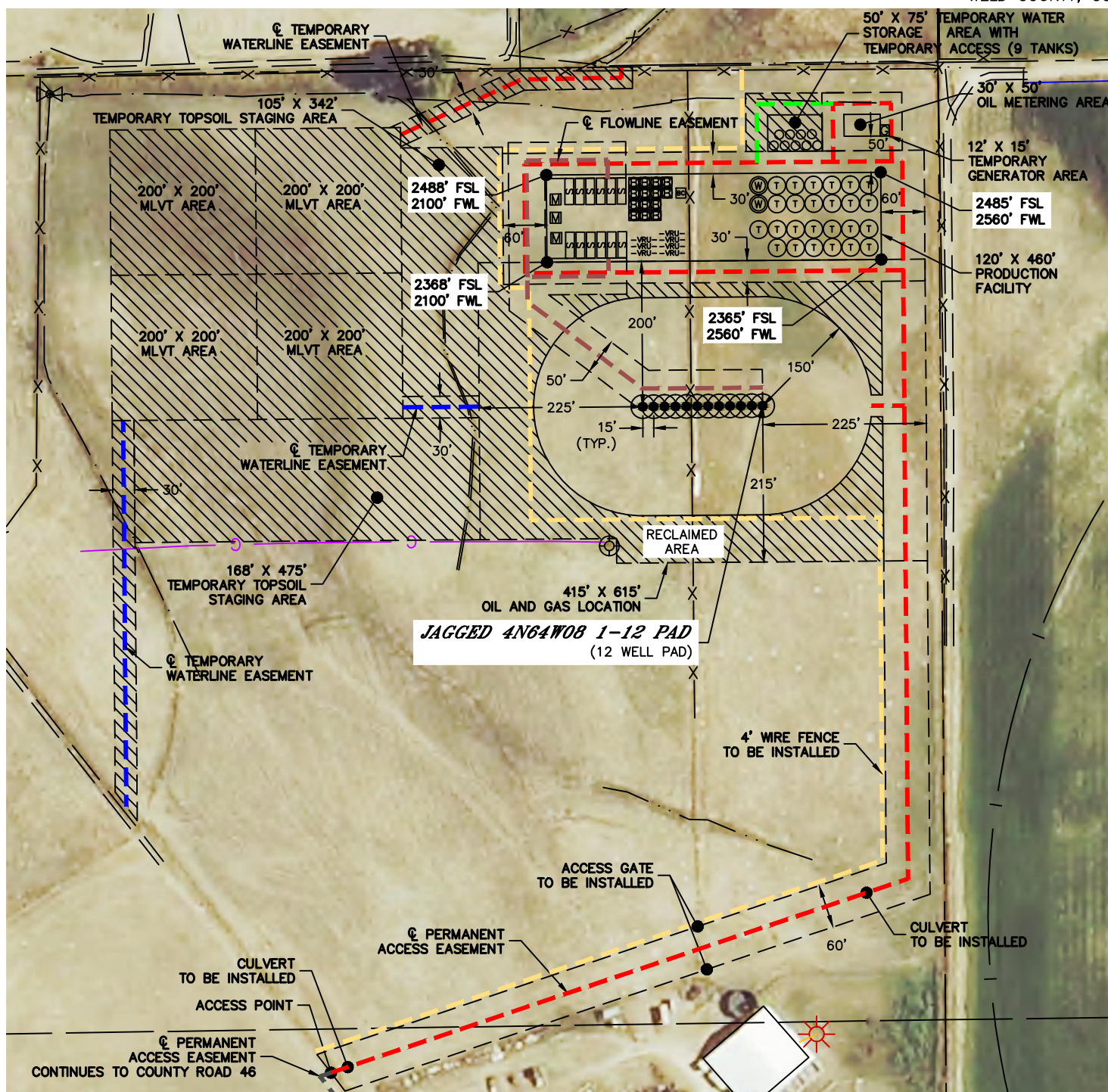

TOTAL DISTURBED AREA OF LOCATION: ±17.0 ACRES  
TOTAL SIZE OF LOCATION AFTER RECLAMATION: ±7.9 ACRES

## LEGEND

●	PROPOSED WELL HEAD	□	SEPARATOR
(T)	TANK BATTERY	□	ECD
(W)	WATER TANK	□	METER
(W)	WATER VAULT	□	BLOW CASE
		-VRU-	VAPOR RECOVERY UNIT
		□	TEMPORARY GENERATOR AREA

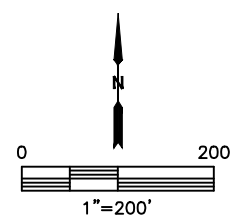

DATE: 8/13/2018  
PROJECT#: 2016123