



Lat40°, Inc. 6250 W. 10th Street, Unit 2, Greeley, CO 970-515-5294

HYDROLOGY MAP

THUNDER 5N64W3 1-10 PAD

SECTION: 3
TOWNSHIP: 5N
RANGE: 64W
6TH. P.M.
WELD COUNTY, CO

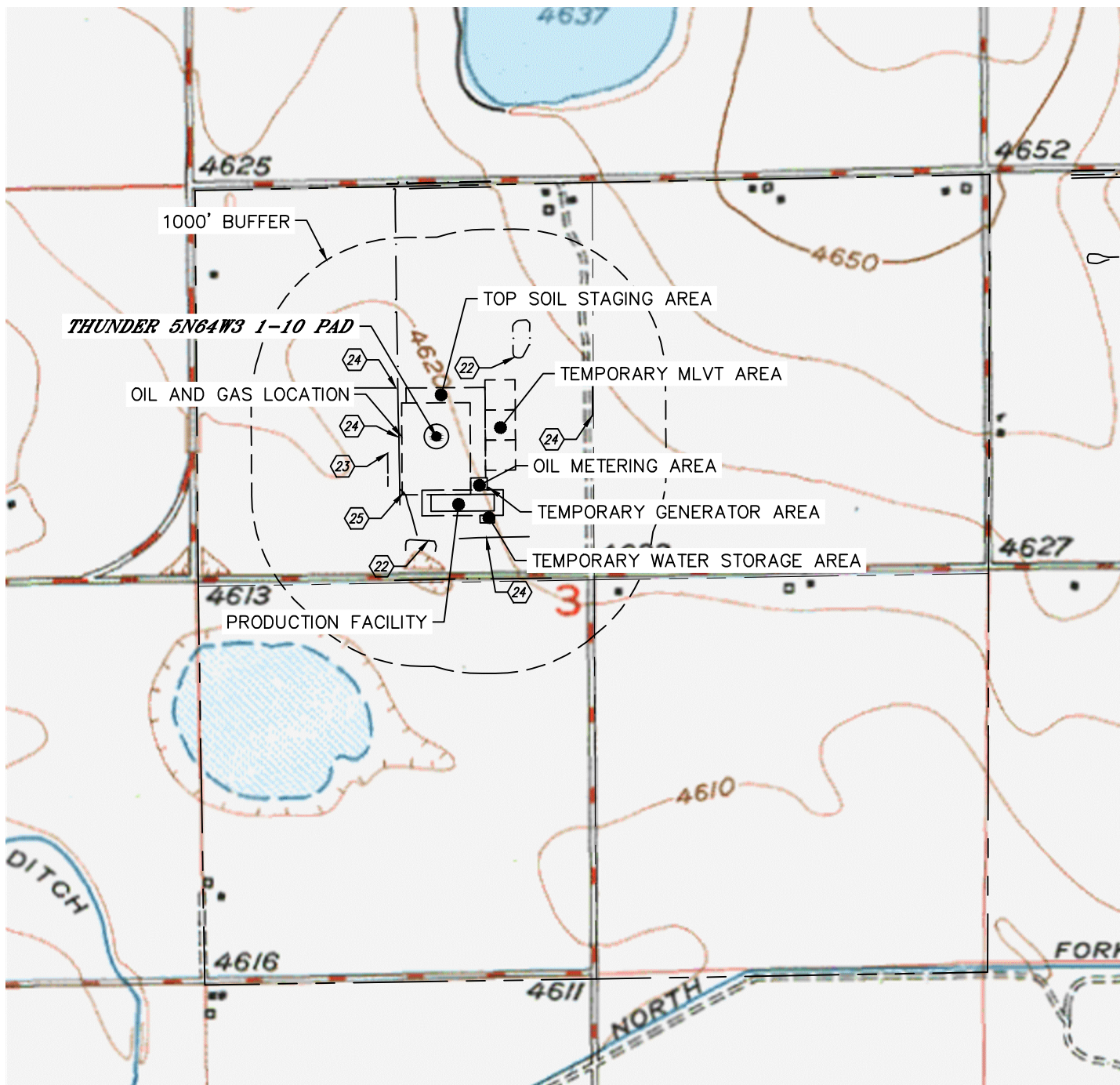

DISTANCES MEASURED FROM THE EDGE OF THE OIL AND GAS LOCATION.

- ② POND 147' NE & 165' S
- ③ BORROW DITCH 95' W
- ④ DITCH 20' W, 66' NW, 97' S, 511' E
- ⑤ LOW AREA 1-INSIDE LOCATION

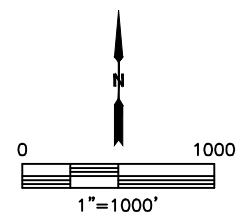

NEAREST DOWN GRADIENT SURFACE WATER: LOW AREA 1-INSIDE LOCATION

DATE: 10/23/2018
PROJECT#: 2017073