

T5N
T4N

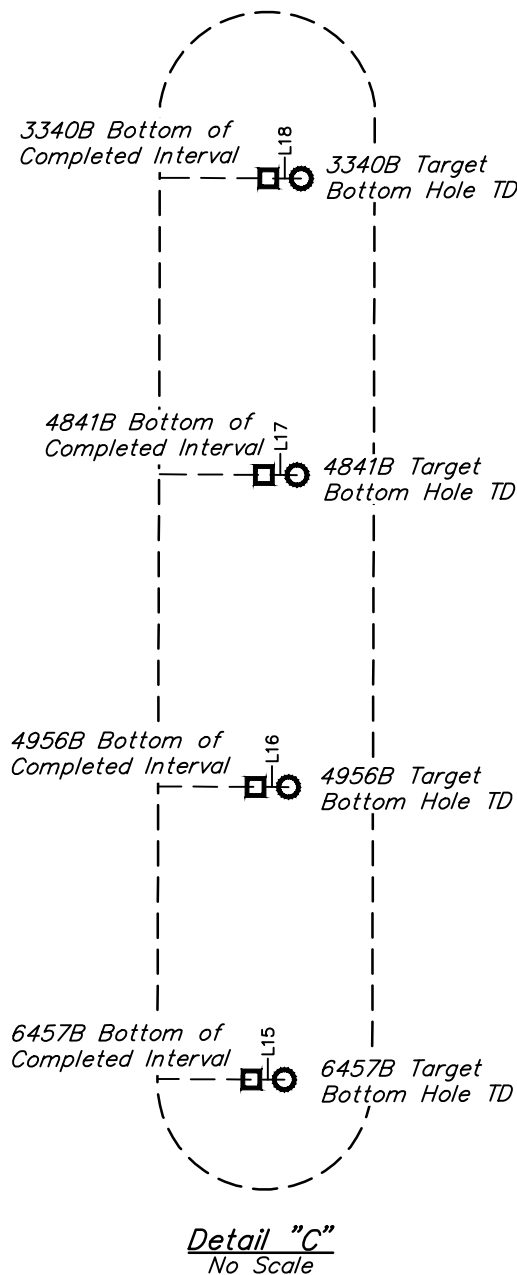

LINE TABLE		
LINE	DIRECTION	LENGTH
L1	S34°56'20"E	1452.41'
L2	S54°47'23"E	1001.74'
L3	N87°28'37"E	805.90'
L4	N50°40'48"E	1023.48'
L5	N08°17'07"W	988.43'
L6	N19°46'33"W	469.21'
L7	S62°43'46"W	197.11'
L8	S17°07'18"W	651.26'
L9	S10°13'07"W	1173.04'

LINE TABLE		
LINE	DIRECTION	LENGTH
L10	S89°40'04"W	60.00'
L11	S89°43'36"W	60.00'
L12	S89°43'36"W	60.00'
L13	S89°43'36"W	60.00'
L14	S89°43'36"W	60.00'
L15	S89°45'18"E	60.00'
L16	S89°45'18"E	60.00'
L17	S89°45'18"E	60.00'
L18	S89°45'18"E	60.00'

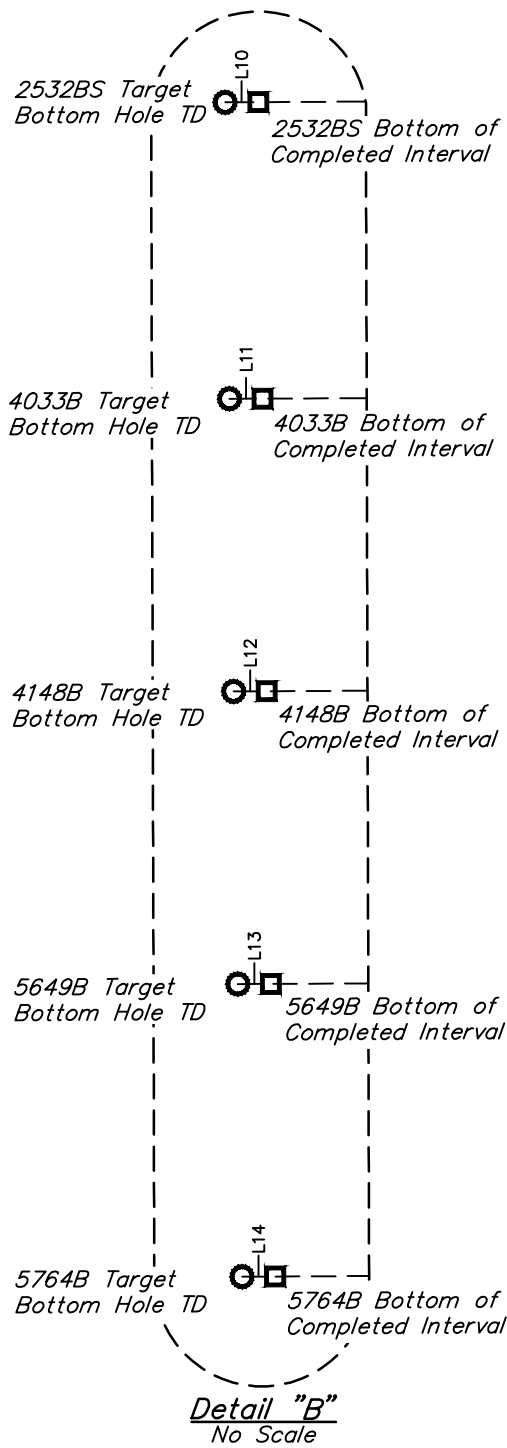
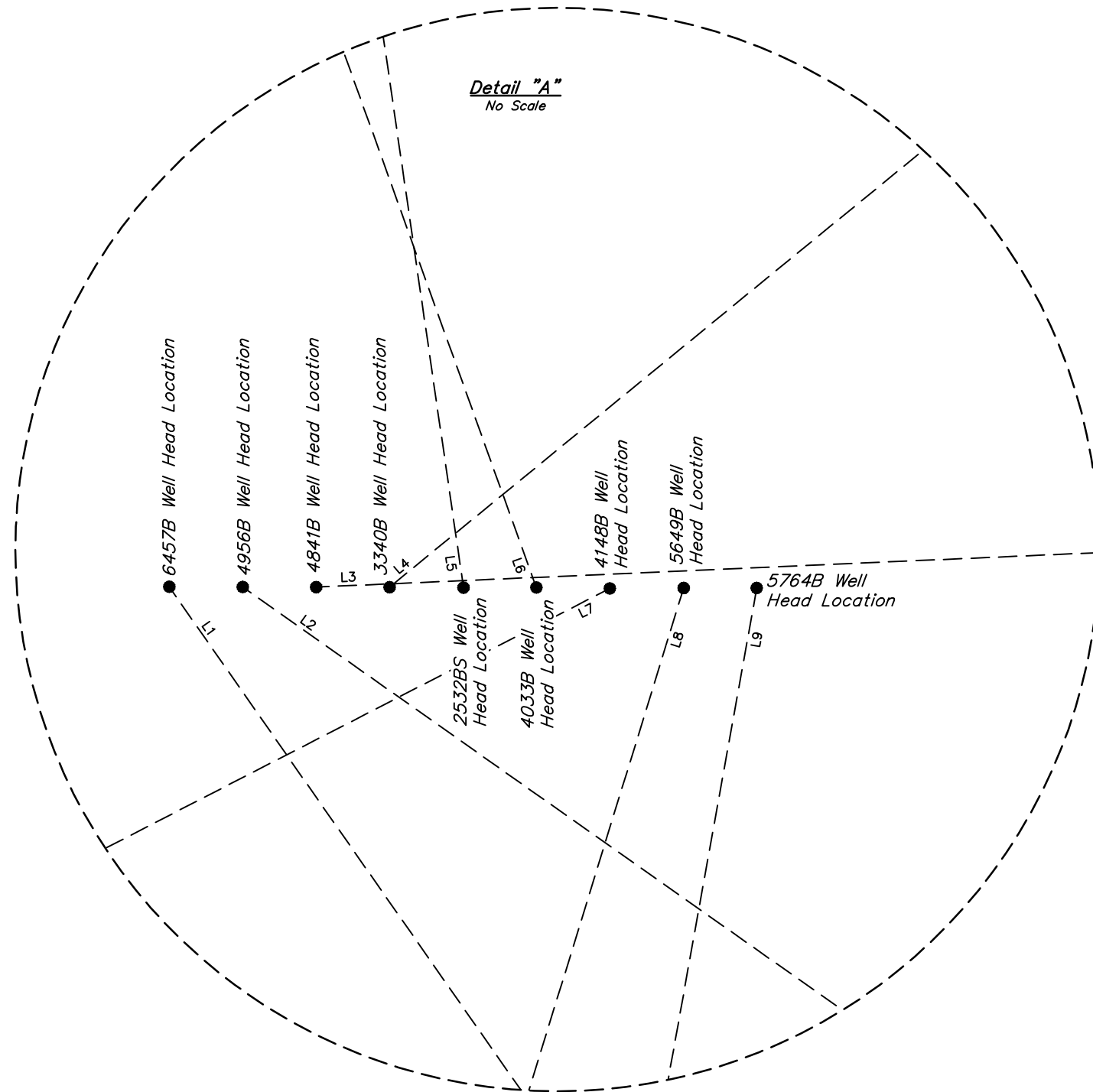

LEGEND:

- = PROPOSED WELLHEAD.
- ◆ = LANDING POINT.
- = BOTTOM OF COMPLETED INTERVAL.
- = TARGET BOTTOM HOLE TD.

REV: 3 09-19-18 K.B. (WELL ADD & COMPANY NAME CHANGE)

HIGHPOINT OPERATING CORPORATION

ANSCHUTZ EQUUS FARMS FED 5-61-34 NESE
NE 1/4 SE 1/4, SECTION 34, T5N, R61W, 6th P.M.
WELD COUNTY, COLORADO

SURVEYED BY	JARED CHRISTOPHER, T.M.	05-22-17	SCALE
DRAWN BY	J.J.	08-10-17	1" = 1000'
MULTI-WELL PLAN		FIGURE #5	



UELS, LLC
Corporate Office * 85 South 200 East
Vernal, UT 84078 * (435) 789-1017