

2115 117th Avenue
Greeley, CO 80634

Tel: 970.304.5000
Fax: 970.304.5099

www.nobleenergyinc.com



Land Department

October 31, 2018

Ms. Julie Murphy, Director
Colorado Oil and Gas Conservation Commission
1120 Lincoln Street, Suite 801
Denver, Colorado 80203

RE: **COGCC Rule 318A.e.: Proposed Spacing Unit**
D02-03 Pad: Lot 2 Section 2, Township 3 North, Range 64 West
Proposed Wells: Booth D11-785 (Doc #401798370), Booth D11-775 (Doc #401798371), Booth D11-770 (Doc #401798372), Booth D11-765 (Doc #401798373), Booth D11-755 (Doc #401798374)
D02-02 Multi: Lot 1 Section 2, Township 3 North, Range 64 West
Proposed Wells: Booth D11-745 (Doc #401798380), Booth D11-735 (Doc #401798381), Booth D11-730 (Doc #401798382), Booth D11-725 (Doc #401798383), Booth D11-715 (Doc #401798385)
Weld County, Colorado

Dear Director Murphy,

Noble Energy, Inc. (Noble) is planning to drill the above referenced wells in accordance with the provisions set out in Colorado Oil and Gas Conservation Commission (COGCC) Rule 318A.e. and Noble's Final Comprehensive Drilling Plan. Noble's Proposed Spacing Unit consists of:

All of Section 2 & 11, Township 3 North, Range 64 West
Containing 1,280 acres, more or less

Noble is not the only owner within the Proposed Spacing Unit and has provided notice to the remaining owners, as required by COGCC Rule 318A.e.(6). Copies of the required notification letters are on file at Noble's office. The required thirty (30) day notice period has lapsed absent the receipt by Noble of any objection to their proposal by the owners within the Proposed Spacing Unit for the subject wells.

If you have any questions or issues, please do not hesitate to contact me at (303) 228-4209 or Matthew.Otness@nblenergy.com should you have any questions.

Very truly yours,

NOBLE ENERGY, INC.

A handwritten signature in blue ink, appearing to read 'Matthew Otness'.

Matthew Otness
Land Supervisor

D02-03 PAD & D02-02 PAD
PROPOSED 318A.a.(4)D. SPACING UNIT
T3N R64W SEC. 2 & 11

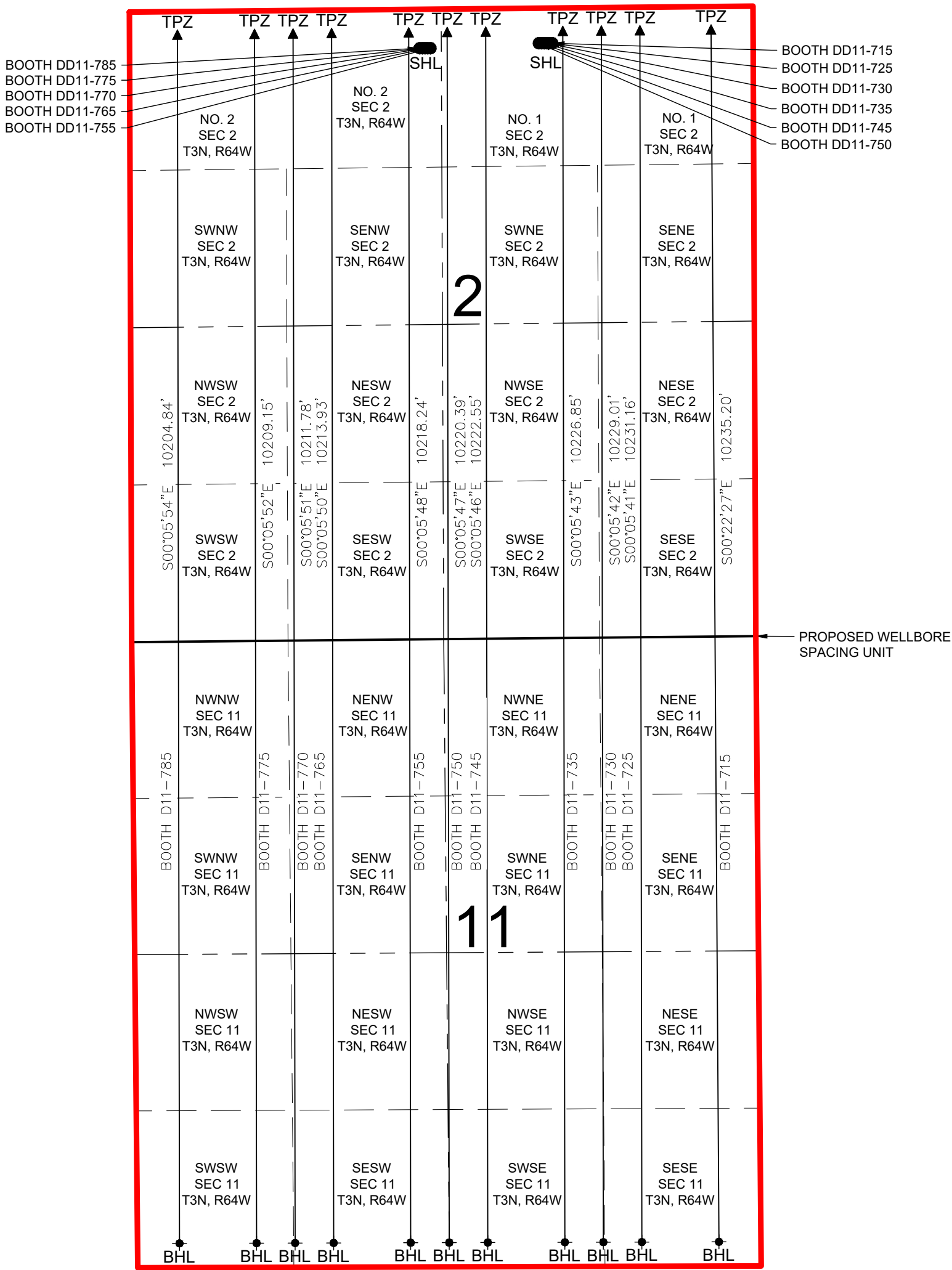

BOOTH D11-785 SHL TO BE LOCATED 323' FNL AND 2448' FWL
BOOTH D11-775 SHL TO BE LOCATED 324' FNL AND 2471' FWL
BOOTH D11-770 SHL TO BE LOCATED 324' FNL AND 2493' FWL
BOOTH D11-765 SHL TO BE LOCATED 324' FNL AND 2516' FWL
BOOTH D11-755 SHL TO BE LOCATED 324' FNL AND 2538' FWL
BOOTH D11-750 SHL TO BE LOCATED 291' FNL AND 1805' FEL

BOOTH D11-745 SHL TO BE LOCATED 291' FNL AND 1783' FEL
BOOTH D11-735 SHL TO BE LOCATED 291' FNL AND 1760' FEL
BOOTH D11-730 SHL TO BE LOCATED 292' FNL AND 1738' FEL
BOOTH D11-725 SHL TO BE LOCATED 292' FNL AND 1715' FEL
BOOTH D11-715 SHL TO BE LOCATED 292' FNL AND 1693' FEL

LEGEND

- = PROPOSED WELL
 - ◆ = BOTTOM HOLE
 - ▲ = TOP OF PRODUCTION ZONE
- SHL = SURFACE HOLE LOCATION
BHL = BOTTOM HOLE LOCATION
TPZ = TOP OF PRODUCTION ZONE

DISCLAIMER:
THIS PLOT DOES NOT REPRESENT A MONUMENTED LAND SURVEY AND SHOULD NOT BE
RELIED UPON TO DETERMINE BOUNDARY LINES, PROPERTY OWNERSHIP OR OTHER
PROPERTY INTERESTS, PARCEL LINES, IF DEPICTED HAVE NOT BEEN FIELD VERIFIED AND
MAY BE BASED UPON PUBLICLY AVAILABLE DATA THAT ALSO HAS NOT BEEN
INDEPENDENTLY VERIFIED.

