

H01-13 PAD, H01-14 PAD, H01-16 PAD  
LOCATION DRAWING

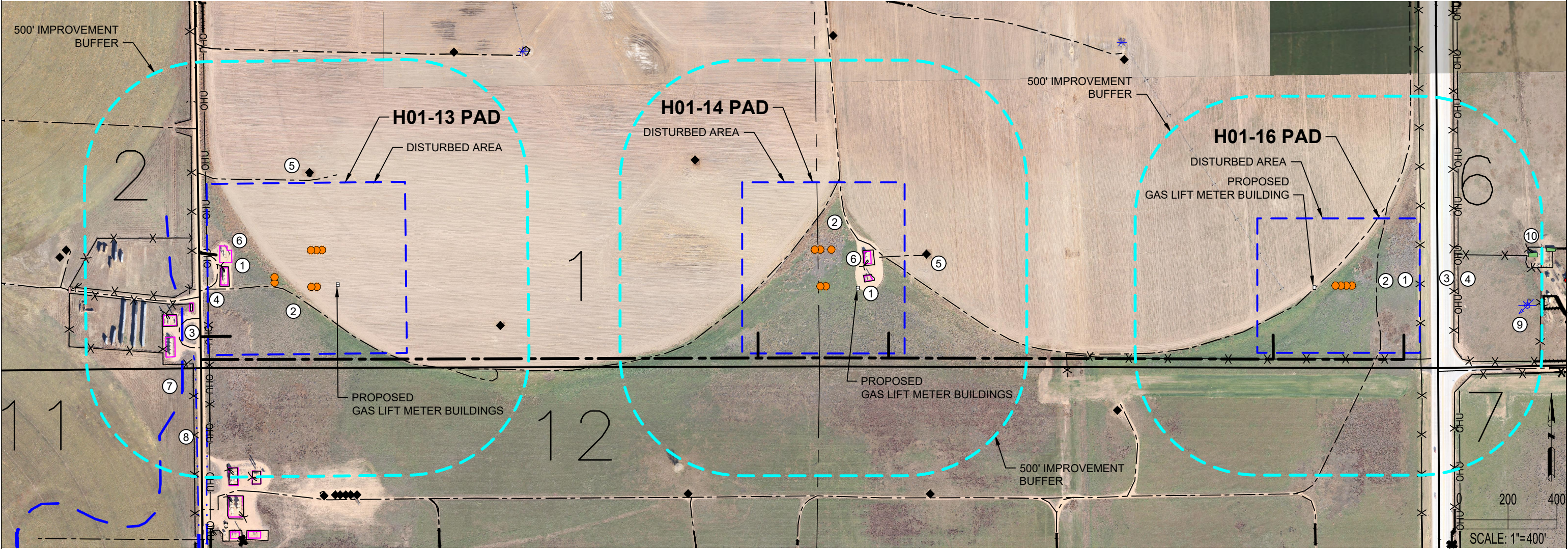

H01-13 PAD				H01-14 PAD				H01-16 PAD			
IMPROVEMENTS: (AS MEASURED FROM THE PROPOSED EDGE OF DISTURBANCE)				IMPROVEMENTS: (AS MEASURED FROM THE PROPOSED EDGE OF DISTURBANCE)				IMPROVEMENTS: (AS MEASURED FROM THE PROPOSED EDGE OF DISTURBANCE)			
1. FENCE:		0', 0', ±26' N, ±62' W, ±63' W, ±126' W, ±186' W, ±271' NW, ±381' W, ±462' S, ±477' S		1. FENCE:		0', 0'		1. FENCE:		±2' E, ±26' S, ±139' E, ±141' E, ±214' SE, ±446' E, ±480' E	
2. PRIVATE ROAD:		0', 0', ±10' N, ±30' W, ±31' W, ±178' SE, ±229' NW		2. PRIVATE ROAD:		0', 0', 0'		2. PRIVATE ROAD:		0', 0'	
3. PUBLIC ROAD:		±18' W		3. PUBLIC ROAD:		N/A		3. PUBLIC ROAD:		±60' E, ±107' SE	
4. OVERHEAD UTILITY:		0'		4. OVERHEAD UTILITY:		N/A		4. OVERHEAD UTILITY:		±159' E, ±226' SE	
5. OIL/GAS WELL:		±42' N, ±384' E		5. OIL/GAS WELL:		±89' E, ±214' NW		5. OIL/GAS WELL:		N/A	
6. EXISTING PRODUCTION EQUIPMENT (NOBLE):		0', 0', ±60' W, ±130' W, ±136' W, ±462' S, ±475' S		6. EXISTING PRODUCTION EQUIPMENT (NOBLE):		0', 0'		6. EXISTING PRODUCTION EQUIPMENT (NOBLE):		N/A	
7. CANAL (NOT VISIBLE UPON FIELD OBSERVATION):		±105' W		7. CANAL:		N/A		7. CANAL:		N/A	
8. DITCH:		±61' W, ±298' SW		8. DITCH:		N/A		8. DITCH:		N/A	
9. WATER WELL:		N/A		9. WATER WELL:		N/A		9. WATER WELL:		±440' E	
10. BUILDING:		N/A		10. BUILDING:		N/A		10. BUILDING:		±446' E	
PROPERTY LINE:		±31' W, ±54' S		PROPERTY LINE:		±54' S		PROPERTY LINE:		±60' S, ±75' E	
DISCLAIMER: THIS PLOT DOES NOT REPRESENT A MONUMENTED LAND SURVEY AND SHOULD NOT BE RELIED UPON TO DETERMINE BOUNDARY LINES, PROPERTY OWNERSHIP OR OTHER PROPERTY INTERESTS. PARCEL LINES, IF DEPICTED HAVE NOT BEEN FIELD VERIFIED AND MAY BE BASED UPON PUBLICLY AVAILABLE DATA THAT ALSO HAS NOT BEEN INDEPENDENTLY VERIFIED.										CURRENT SURFACE USE: IRRIGATED CROP FUTURE SURFACE USE: IRRIGATED CROP	
<div><div><div><div><div></div><div>7535 Hilltop Circle Denver, CO 80221 (303) 928-7128 www.ascentgeomatics.com</div></div><div>ASCENT GEOMATICS SOLUTIONS</div></div><div><div>FIELD DATE: 09-15-18</div><div>DRAWN BY: MJE</div></div><div><div>DRAWING DATE: 10-19-18</div><div>CHECKED BY: RMC</div></div><div><div>SITE NAME: H01-13 PAD, H01-14 PAD &amp; H01-16 PAD</div><div>SURFACE LOCATION: SEC. 1, T3N, R65W, 6TH P.M. WELD COUNTY, COLORADO</div></div></div></div>		<div>DATA SOURCE: AERIAL IMAGERY: ASCENT 11/2017, NAIP 2017 WATER WELLS: COLORADO DWR NHD: USGS  PUBLICLY AVAILABLE DATA SOURCES HAVE NOT BEEN INDEPENDENTLY VERIFIED BY ASCENT.</div>		<div>LEGEND:<div><div><div><div></div><div></div><div></div><div></div><div></div></div><div><div>= PROPOSED WELL</div><div>= EXISTING WELL</div><div>= WATER WELL</div><div>= PIVOT POINT</div></div></div><div><div><div><div></div><div></div><div></div><div></div><div></div></div><div><div>= CENTER SECTION LINE</div><div>= EXISTING ROAD</div><div>= FENCE</div><div>= OVERHEAD UTILITY</div><div>= PROPOSED ACCESS ROAD</div></div></div><div><div><div><div></div><div></div><div></div><div></div></div><div><div>= DISTURBANCE AREA</div><div>= 500' RADIUS</div><div>= EXISTING FACILITY</div><div>= BUILDING</div></div></div><div><div><div><div></div><div></div><div></div><div></div></div><div><div>= SECTION LINE</div><div>= CANAL</div><div>= DITCH</div></div></div></div></div></div></div></div>		<div><div><div></div><div>noble energy</div></div></div>					