

2115 117th Avenue
Greeley, CO 80634

Tel: 970.304.5000
Fax: 970.304.5099
www.nobleenergyinc.com



Land Department

October 28, 2018

Ms. Julie Murphy, Director
Colorado Oil and Gas Conservation Commission
1120 Lincoln Street, Suite 801
Denver, Colorado 80203

RE: **COGCC Rule 318A.e.: Proposed Spacing Unit**
C33-14 Pad: SESW Section 33, Township 4 North, Range 64 West
Proposed Wells: Guttersen D09-785 (Doc #401795633), Guttersen D09-775 (Doc #401795632), Guttersen D09-770 (Doc #401795631), Guttersen D09-765 (Doc #401795630), Guttersen D09-755 (Doc #401795629).
C33-15 Multi: SWSE Section 33, Township 4 North, Range 64 West
Proposed Wells: Guttersen D09-750 (Doc #401795623), Guttersen D09-745 (Doc #401795622), Guttersen D09-721 (Doc #401795621).
Weld County, Colorado

Dear Director Murphy,

Noble Energy, Inc. (Noble) is planning to drill the above referenced wells in accordance with the provisions set out in Colorado Oil and Gas Conservation Commission (COGCC) Rule 318A.e. and Noble's Final Comprehensive Drilling Plan. Noble's Proposed Spacing Unit consists of:

Township 3 North, Range 64 West
Section 4: All
Section 9: All
Containing 1,280 acres, more or less

Noble is not the only owner within the Proposed Spacing Unit and has provided notice to the remaining owners, as required by COGCC Rule 318A.e.(6). Copies of the required notification letters are on file at Noble's office. The required thirty (30) day notice period has lapsed absent the receipt by Noble of any objection to their proposal by the owners within the Proposed Spacing Unit for the subject wells.

If you have any questions or issues, please do not hesitate to contact me at (303) 228-4209 or Matthew.Otness@nblenergy.com should you have any questions.

Very truly yours,

NOBLE ENERGY, INC.

A handwritten signature in blue ink, appearing to read 'Matthew Otness'.

Matthew Otness
Land Supervisor

C33-14 PAD & C33-15 PAD
PROPOSED 318A.a.(4)D. SPACING UNIT
T3N R64W SEC. 4 & 9

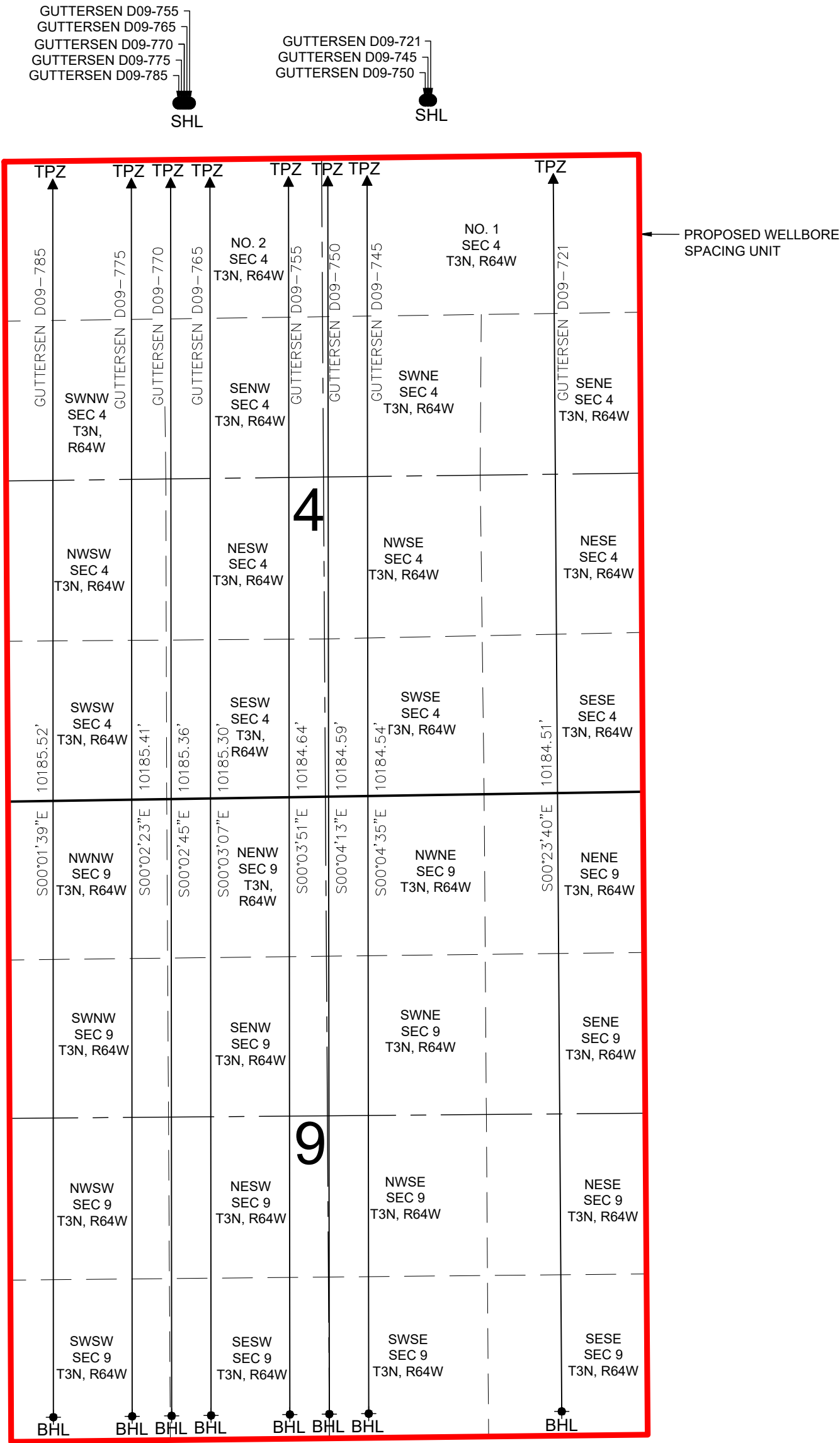

GUTTERSEN D09-785 SHL TO BE LOCATED 468' FSL AND 1449' FWL
GUTTERSEN D09-775 SHL TO BE LOCATED 468' FSL AND 1472' FWL
GUTTERSEN D09-770 SHL TO BE LOCATED 468' FSL AND 1494' FWL
GUTTERSEN D09-765 SHL TO BE LOCATED 467' FSL AND 1517' FWL

GUTTERSEN D09-755 SHL TO BE LOCATED 467' FSL AND 1539' FWL
GUTTERSEN D09-750 SHL TO BE LOCATED 468' FSL AND 1764' FEL
GUTTERSEN D09-745 SHL TO BE LOCATED 468' FSL AND 1742' FEL
GUTTERSEN D09-721 SHL TO BE LOCATED 468' FSL AND 1719' FEL

LEGEND

● = PROPOSED WELL
● = BOTTOM HOLE
▲ = TOP OF PRODUCTION ZONE

SHL = SURFACE HOLE LOCATION
BHL = BOTTOM HOLE LOCATION
TPZ = TOP OF PRODUCTION ZONE

DISCLAIMER:
THIS PLOT DOES NOT REPRESENT A MONUMENTED LAND SURVEY AND SHOULD NOT BE
RELIED UPON TO DETERMINE BOUNDARY LINES, PROPERTY OWNERSHIP OR OTHER
PROPERTY INTERESTS, PARCEL LINES, IF DEPICTED HAVE NOT BEEN FIELD VERIFIED AND
MAY BE BASED UPON PUBLICLY AVAILABLE DATA THAT ALSO HAS NOT BEEN
INDEPENDENTLY VERIFIED.

