

2115 117th Avenue
Greeley, CO 80634

Tel: 970.304.5000
Fax: 970.304.5099

www.nobleenergyinc.com



Land Department

October 30, 2018

Ms. Julie Murphy, Director
Colorado Oil and Gas Conservation Commission
1120 Lincoln Street, Suite 801
Denver, Colorado 80203

RE: **COGCC Rule 318A.e.: Proposed Spacing Unit**
D05-12 Pad: NWSW Section 5, Township 3 North, Range 64 West
Proposed Wells: Becker D17-785 (Doc # 401794958), Becker D17-775 (Doc # 401794961), Becker D17-770 (Doc # 401794963), Becker D17-765 (Doc # 401794965), Becker D17-755 (Doc # 401794967),
D05-10 Pad: NWSE Section 5, Township 3 North, Range 64 West
Proposed Wells: Becker D17-750 (Doc # 401794970), Becker D17-745 (Doc # 401794971), Becker D17-735 (Doc # 401794972), Becker D17-730 (Doc # 401794974), Becker D17-725 (Doc # 401794975),
Becker D17-715 (Doc # 401794976),
Weld County, Colorado

Dear Director Murphy,

Noble Energy, Inc. (Noble) is planning to drill the above referenced wells in accordance with the provisions set out in Colorado Oil and Gas Conservation Commission (COGCC) Rule 318A.e. and Noble's Final Comprehensive Drilling Plan. Noble's Proposed Spacing Unit consists of:

Township 3 North, Range 64 West
Section 8: All and
Section 17: N2
Containing 960 acres, more or less

Noble is the only owner within the Proposed Spacing Unit.

If you have any questions or issues, please do not hesitate to contact me at (303) 228-4209 or Matthew.Otness@nblenergy.com should you have any questions.

Very truly yours,

NOBLE ENERGY, INC.

A handwritten signature in blue ink, appearing to read 'Matthew Otness'.

Matthew Otness
Land Supervisor

D05-12 PAD & D05-10 PAD
PROPOSED 318A.a.(4)D. SPACING UNIT
T3N R64W SEC. 8
T3N R64W SEC. 17: N2

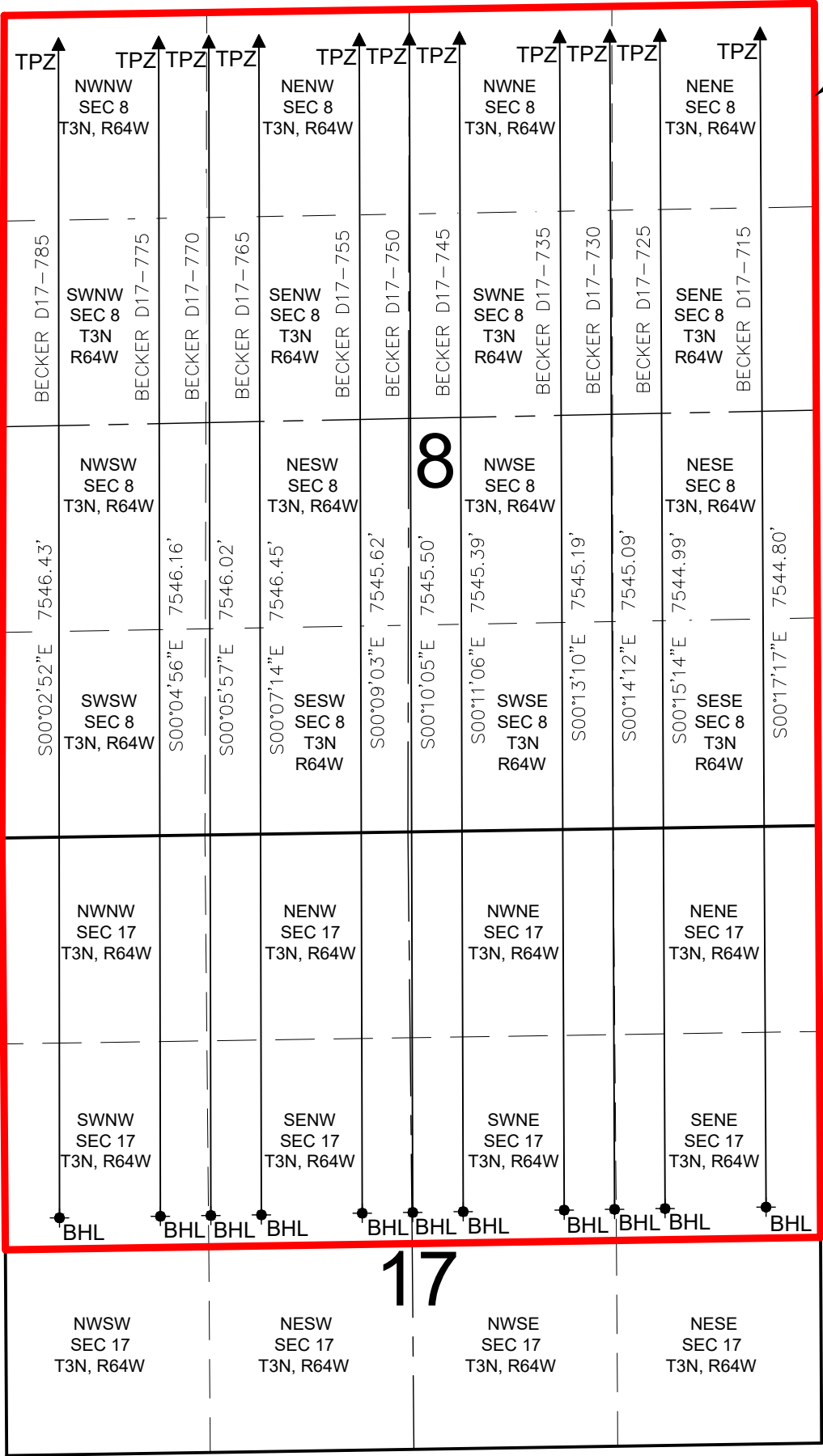
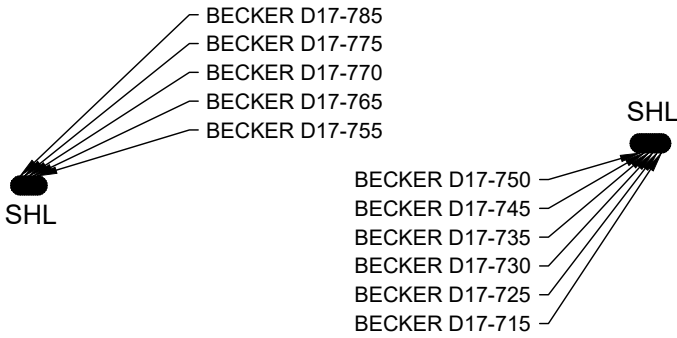

BECKER D17-785 SHL TO BE LOCATED 1646' FSL AND 598' FWL
BECKER D17-775 SHL TO BE LOCATED 1646' FSL AND 621' FWL
BECKER D17-770 SHL TO BE LOCATED 1645' FSL AND 643' FWL
BECKER D17-765 SHL TO BE LOCATED 1645' FSL AND 666' FWL
BECKER D17-755 SHL TO BE LOCATED 1645' FSL AND 688' FWL

BECKER D17-750 SHL TO BE LOCATED 1817' FSL AND 1404' FEL
BECKER D17-745 SHL TO BE LOCATED 1816' FSL AND 1382' FEL
BECKER D17-735 SHL TO BE LOCATED 1816' FSL AND 1359' FEL
BECKER D17-730 SHL TO BE LOCATED 1816' FSL AND 1337' FEL
BECKER D17-725 SHL TO BE LOCATED 1815' FSL AND 1314' FEL
BECKER D17-715 SHL TO BE LOCATED 1815' FSL AND 1292' FEL

LEGEND

- = PROPOSED WELL
- = BOTTOM HOLE
- ▲ = TOP OF PRODUCTION ZONE

SHL = SURFACE HOLE LOCATION
BHL = BOTTOM HOLE LOCATION
TPZ = TOP OF PRODUCTION ZONE

DISCLAIMER:
THIS PLOT DOES NOT REPRESENT A MONUMENTED LAND SURVEY AND SHOULD NOT BE
RELIED UPON TO DETERMINE BOUNDARY LINES, PROPERTY OWNERSHIP OR OTHER
PROPERTY INTERESTS, PARCEL LINES, IF DEPICTED HAVE NOT BEEN FIELD VERIFIED AND
MAY BE BASED UPON PUBLICLY AVAILABLE DATA THAT ALSO HAS NOT BEEN
INDEPENDENTLY VERIFIED.

