

LINE TABLE		
LINE	DIRECTION	LENGTH
L1	WEST	127'
L2	NORTH	516'
L3	NORTH	532'
L4	N02°E	539'
L5	N01°E	552'

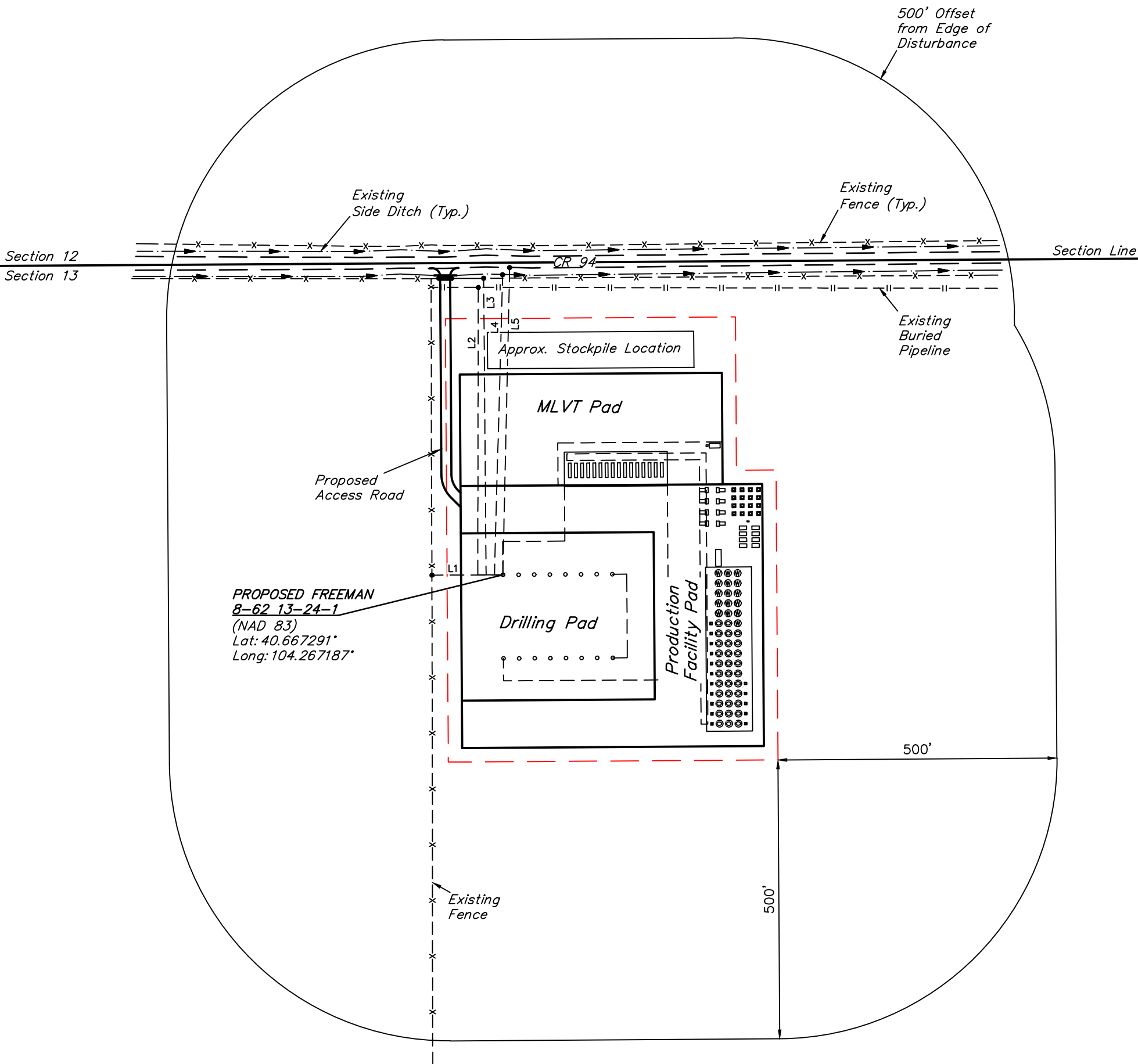

REV: 2    10-30-18    C.IVIE    (EQUIPMENT UPDATE)

PLANT COMMUNITY
<input type="checkbox"/> DISTURBED GRASSLAND
<input checked="" type="checkbox"/> NATIVE GRASSLAND
<input type="checkbox"/> SHRUB LAND
<input type="checkbox"/> PLAINS RIPARIAN
<input type="checkbox"/> MOUNTAIN RIPARIAN
<input type="checkbox"/> FOREST LAND
<input type="checkbox"/> WETLANDS AQUATIC
<input type="checkbox"/> ALPINE
<input type="checkbox"/> OTHER (Describe): _____

CURRENT LAND USE					
CROP LAND:	<input type="checkbox"/> IRRIGATED	<input type="checkbox"/> DRY LAND	<input type="checkbox"/> IMPROVED PASTURE	<input type="checkbox"/> HAY MEADOW	<input type="checkbox"/> CRP
NON-CROP LAND:	<input checked="" type="checkbox"/> RANGELAND	<input type="checkbox"/> TIMBER	<input type="checkbox"/> RECREATIONAL	<input type="checkbox"/> OTHER (Describe) _____	
SUBDIVIDED:	<input type="checkbox"/> INDUSTRIAL	<input type="checkbox"/> COMMERCIAL	<input type="checkbox"/> RESIDENTIAL	_____	

FUTURE LAND USE					
CROP LAND:	<input type="checkbox"/> IRRIGATED	<input type="checkbox"/> DRY LAND	<input type="checkbox"/> IMPROVED PASTURE	<input type="checkbox"/> HAY MEADOW	<input type="checkbox"/> CRP
NON-CROP LAND:	<input checked="" type="checkbox"/> RANGELAND	<input type="checkbox"/> TIMBER	<input type="checkbox"/> RECREATIONAL	<input type="checkbox"/> OTHER (Describe) _____	
SUBDIVIDED:	<input type="checkbox"/> INDUSTRIAL	<input type="checkbox"/> COMMERCIAL	<input type="checkbox"/> RESIDENTIAL	_____	

BISON OIL & GAS II

FREEMAN 8-62 13 PAD  
NW 1/4 NE 1/4, SECTION 13, T8N, R62W, 6th P.M.  
WELD COUNTY, COLORADO



UELS, LLC  
Corporate Office \* 85 South 200 East  
Vernal, UT 84078 \* (435) 789-1017

SURVEYED BY	JARED CHRISTOPHER, O.R.	08-20-18	SCALE
DRAWN BY	C.IVIE	08-23-18	1" = 200'
LOCATION DRAWING		FIGURE #2	