

HIGHPOINT OPERATING CORPORATION
ANSCHUTZ EQUUS FARMS FED 5-61-34 NESE PAD
#5-61-35-6457B
NE 1/4 SE 1/4, SECTION 34, T5N, R61W, 6th P.M.
WELD COUNTY, COLORADO

SPOT ELEVATION LOCATED AT THE NORTHEAST CORNER OF SECTION 24, T5N, R62W, 6th P.M. TAKEN FROM THE POINT OF ROCKS, QUADRANGLE, COLORADO, WELD COUNTY, 7.5 MINUTE QUAD (TOPOGRAPHIC MAP) PUBLISHED BY THE UNITED STATES DEPARTMENT OF THE INTERIOR, GEOLOGICAL SURVEY. SAID ELEVATION IS MARKED AS BEING 4530 FEET.

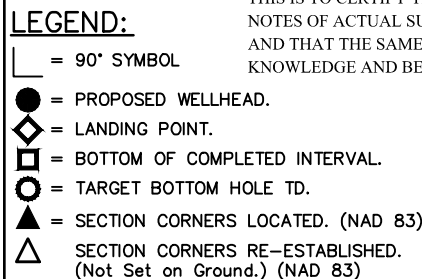
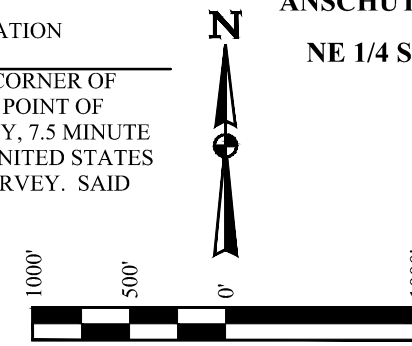

REGISTERED LAND SURVEYOR
REGISTRATION NO. 28285
STATE OF COLORADO

NAD 83 (SURFACE LOCATION)	NAD 83 (LANDING POINT)	NAD 83 (BTM OF COMPLETED INT.)	NAD 83 (TARGET BOTTOM HOLE)
LATITUDE = 40°21'17.06" (40.354739)	LATITUDE = 40°21'05.29" (40.351469)	LATITUDE = 40°21'05.58" (40.351549)	LATITUDE = 40°21'05.57" (40.351548)
LONGITUDE = 104°11'12.76" (104.186878)	LONGITUDE = 104°11'02.03" (104.183898)	LONGITUDE = 104°08'57.05" (104.149182)	LONGITUDE = 104°08'56.28" (104.148967)
NAD 27 (SURFACE LOCATION)	NAD 27 (LANDING POINT)	NAD 27 (BTM OF COMPLETED INT.)	NAD 27 (TARGET BOTTOM HOLE)
LATITUDE = 40°21'17.12" (40.354757)	LATITUDE = 40°21'05.35" (40.351487)	LATITUDE = 40°21'05.64" (40.351566)	LATITUDE = 40°21'05.64" (40.351566)
LONGITUDE = 104°11'10.94" (104.186372)	LONGITUDE = 104°11'00.21" (104.183392)	LONGITUDE = 104°08'55.23" (104.148676)	LONGITUDE = 104°08'54.46" (104.148461)
STATE PLANE NAD 83 (CO. NORTH)	STATE PLANE NAD 83 (CO. NORTH)	STATE PLANE NAD 83 (CO. NORTH)	STATE PLANE NAD 83 (CO. NORTH)
N: 1374781.49 E: 3365948.91	N: 1373602.89 E: 3366797.03	N: 1373777.34 E: 3376471.15	N: 1373777.92 E: 3376531.13
STATE PLANE NAD 27 (CO. NORTH)	STATE PLANE NAD 27 (CO. NORTH)	STATE PLANE NAD 27 (CO. NORTH)	STATE PLANE NAD 27 (CO. NORTH)
N: 374783.48 E: 2366099.50	N: 373604.92 E: 2366947.65	N: 373779.35 E: 2376622.01	N: 373779.93 E: 2376682.00

PDOP = 1.4



UELS, LLC
Corporate Office * 85 South 200 East
Vernal, UT 84078 * (435) 789-1017

SURVEYED BY	JAMES FRESHWATER, N.W.	09-17-18	SCALE
DRAWN BY	K.B.	09-20-18	1" = 1000'

WELL LOCATION PLAT