

Ground Elevation:: 4936.70
RKB Elevation: KB=25 @ 4961.70ft (Patterson #346)
Rig Name: Patterson #346

Northing	Easting	Latitude	Longitude
1291283.11	3129103.16	40.13204	-105.03827

Extraction Oil & Gas
Project: Weld County, CO (NAD83)
Site: Rinn Valley East Pad (Sec.18-T2N-R68W)
Well: Rinn Valley East N17-20-10C
Wellbore: Wellbore #1
Plan: Plan #4 (Rinn Valley East N17-20-10C/Wellbore #1)
Patterson #346



Sec	MD	Inc	Azi	TVD	+N/-S	+E/-W	Dleg	TFace	VSect
1	1603.00	27.94	95.20	1549.39	-39.21	330.11	0.00	0.00	53.54
2	1755.00	27.94	95.20	1683.67	-45.66	401.03	0.00	0.00	66.93
3	1965.47	32.12	96.13	1865.85	-56.12	505.82	2.00	6.79	85.84
4	5571.73	32.12	96.13	4920.00	-261.05	2412.45	0.00	0.00	415.75
5	7177.90	0.00	0.00	6443.34	-307.92	2848.53	2.00	-180.00	491.20
6	7682.60	0.00	0.00	6948.04	-307.92	2848.53	0.00	0.00	491.20
7	8582.60	90.00	0.04	7521.00	265.04	2848.91	10.00	0.04	1041.96
8	8613.77	90.62	0.04	7520.83	296.21	2848.93	2.00	0.00	1071.92
9	18248.97	90.62	0.04	7416.00	9930.83	2855.37	0.00	0.00	10333.18

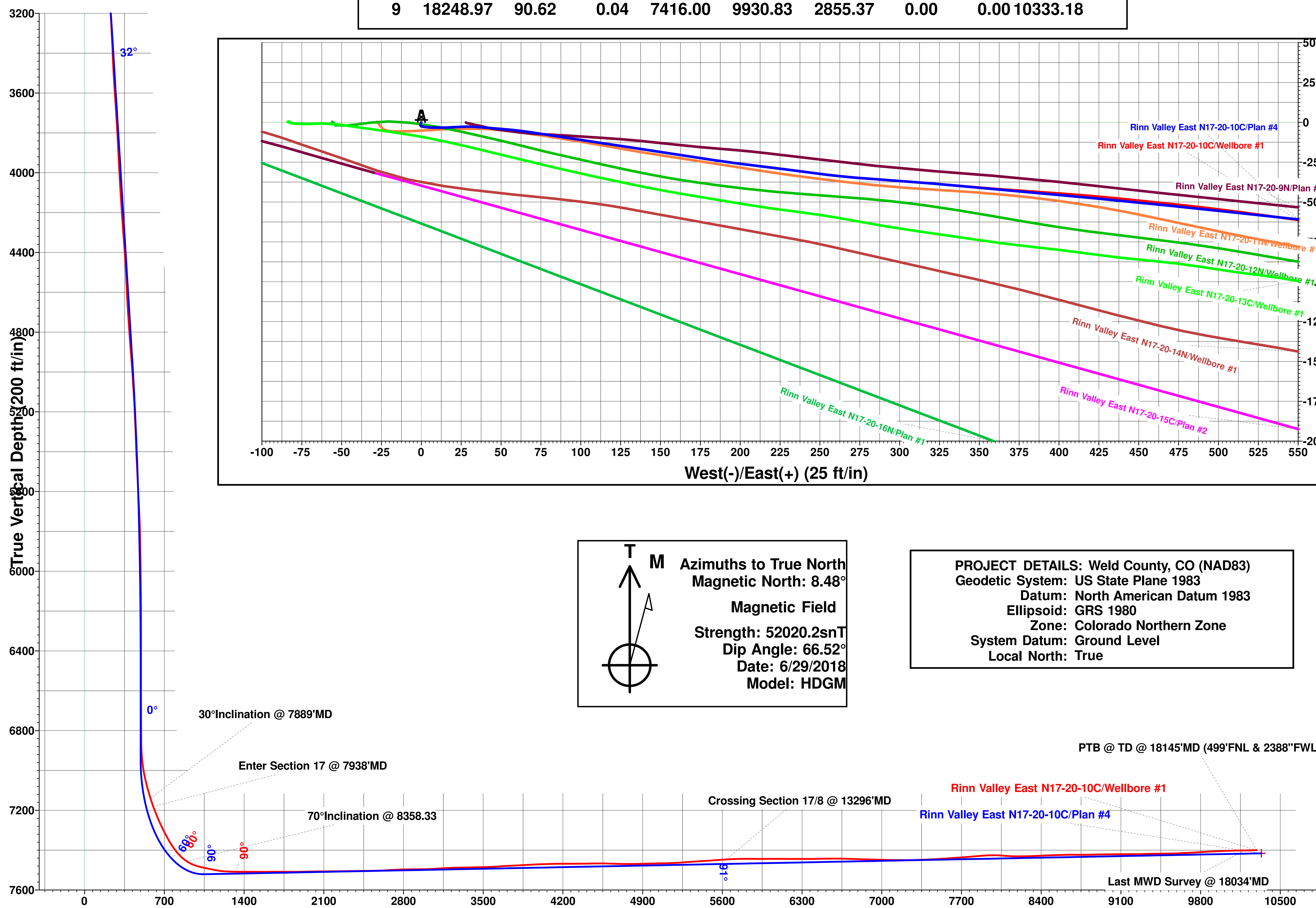
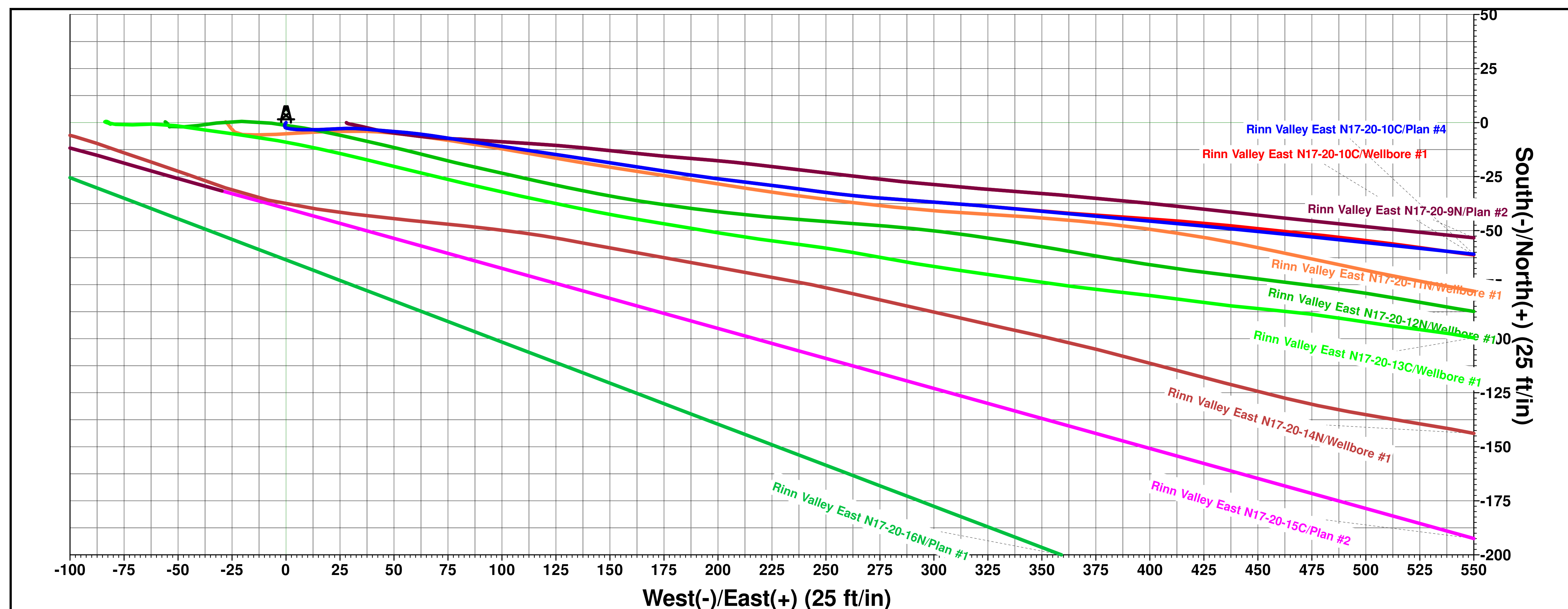

Vertical Section at 16.04° (350 ft/in)

