

K:\AMERICAN\2018\2016_183_LANDON_T1N_R67W_SEC_6\DWG\LONDON.dwg, 6/5/2018, 10:13:26 AM, seven

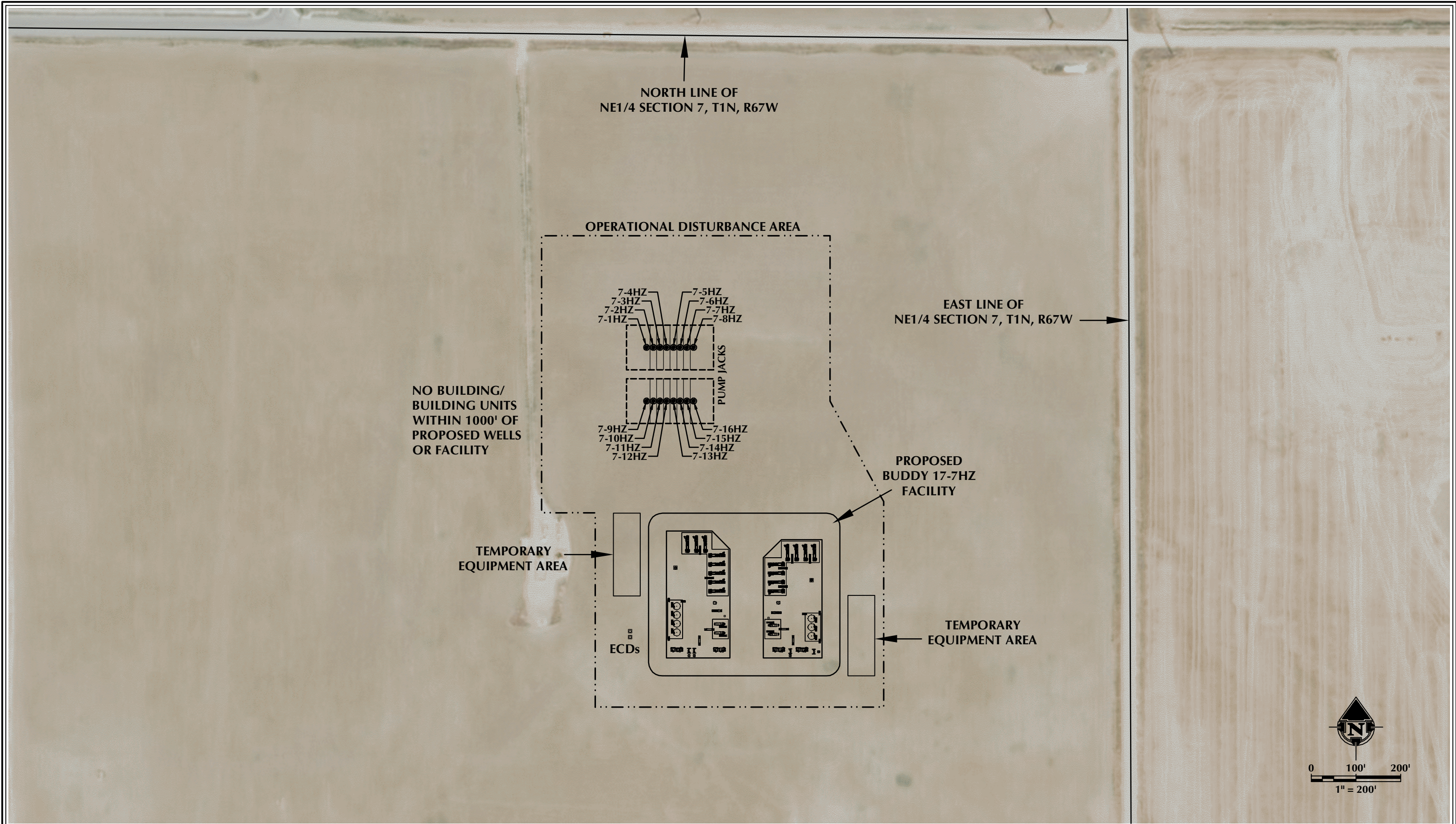

NOTES:
1. EQUIPMENT PLACEMENT IS APPROXIMATE AND SUBJECT TO MINOR MODIFICATION DUE TO SPECIFIC CIRCUMSTANCES.

DATA SOURCES:
- AERIAL COURTESY OF ESRI, INC.



609
CONSULTING, LLC

LOVELAND OFFICE
6706 North Franklin Avenue
Loveland, Colorado 80538
Phone 970-776-4331

SHERIDAN OFFICE
1095 Saberton Avenue
Sheridan, Wyoming 82801
Phone 307-674-0609



Anadarko
Petroleum Corporation
1099 18th Street
Denver, CO 80202

SCALE: 1" = 200'
DATE SURVEYED: 5/7/18
DATE: 6/5/18
DRAFTER: DD
REVISED:

FACILITY LAYOUT AERIAL
BUDDY 17-7HZ
LOCATED IN SECTION 7, T1N, R67W, 6TH P.M.
WELD COUNTY, COLORADO



SHEET No.
- OF -



NOTES:

[illegible]

<h1 style="text-align: center;">PERMIT PLOT PLAN</h1> <h2 style="text-align: center;">PRODUCTION FACILITIES</h2> <h3 style="text-align: center;">W/ EQUIPMENT DIMENSIONS</h3>			
DRAWN BY: ACP		CREATION DATE: 03/21/17	
APPROVED: JTK		APPR. DATE: 03/21/17	
SCALE: NONE		DWG. No.: X22118-STOR-01-PP-2020 Rev 1	
		SHEET No. - OF -	

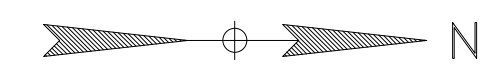
[illegible]