



October 1, 2018

Ms. Julie Murphy, Director
Colorado Oil and Gas Conservation Commission
1120 Lincoln Street, Suite 801
Denver, Colorado 80203

RE: COGCC Rule 318A.e.: Proposed Spacing Unit
Herbers 20H-B167 Pad: NWNE Section 20, T1N, R67W
Proposed Wells: [Herbers 1B-20H-B167, 401742215; Herbers 1C-20H-B167, 401742216;
Herbers 1D-20H-B167, 401742218; Herbers 1E-20H-B167, 401742219; Herbers 1F-20H-B167,
401742220; Herbers 1G-20H-B167, 401742222; Herbers 1H-20H-B167, 401742223; Herbers 1I-
20H-B167, 401742227]
Weld County, Colorado

Dear Director Murphy:

Crestone Peak Resources Operating LLC (CPR) is planning to drill the above referenced well(s) in accordance with the provisions of COGCC Rule 318A.e(6). CPR's proposed spacing unit configuration consists of:

Township 1 North, Range 67 West
SEC 20: E2
SEC 29: NE4

Containing 480 acres, more or less for the Niobrara and Codell formations

CPR is not the only owner within the proposed spacing unit, and as such provided notice to the remaining owner(s) within said proposed spacing unit as required under COGCC Rule 318A.e(6). The required thirty (30) day notice period has elapsed absent the receipt by CPR of an objection to said proposal by the owner(s) within the Proposed Spacing Unit for the subject well.

Enclosed is a copy of the map illustrating the proposed wellbore spacing unit to assist you in your review of the proposed Application for Permit to Drill for the **Herbers** Well(s).

Crestone Peak Resources respectfully requests that the COGCC review the enclosed information and approve the Application for Permit to Drill the captioned well. Many thanks for your time and attention to this matter.

Respectfully,

Toby Sachen
Contract Regulatory Specialist



Enclosure: Proposed Spacing Unit Exhibit

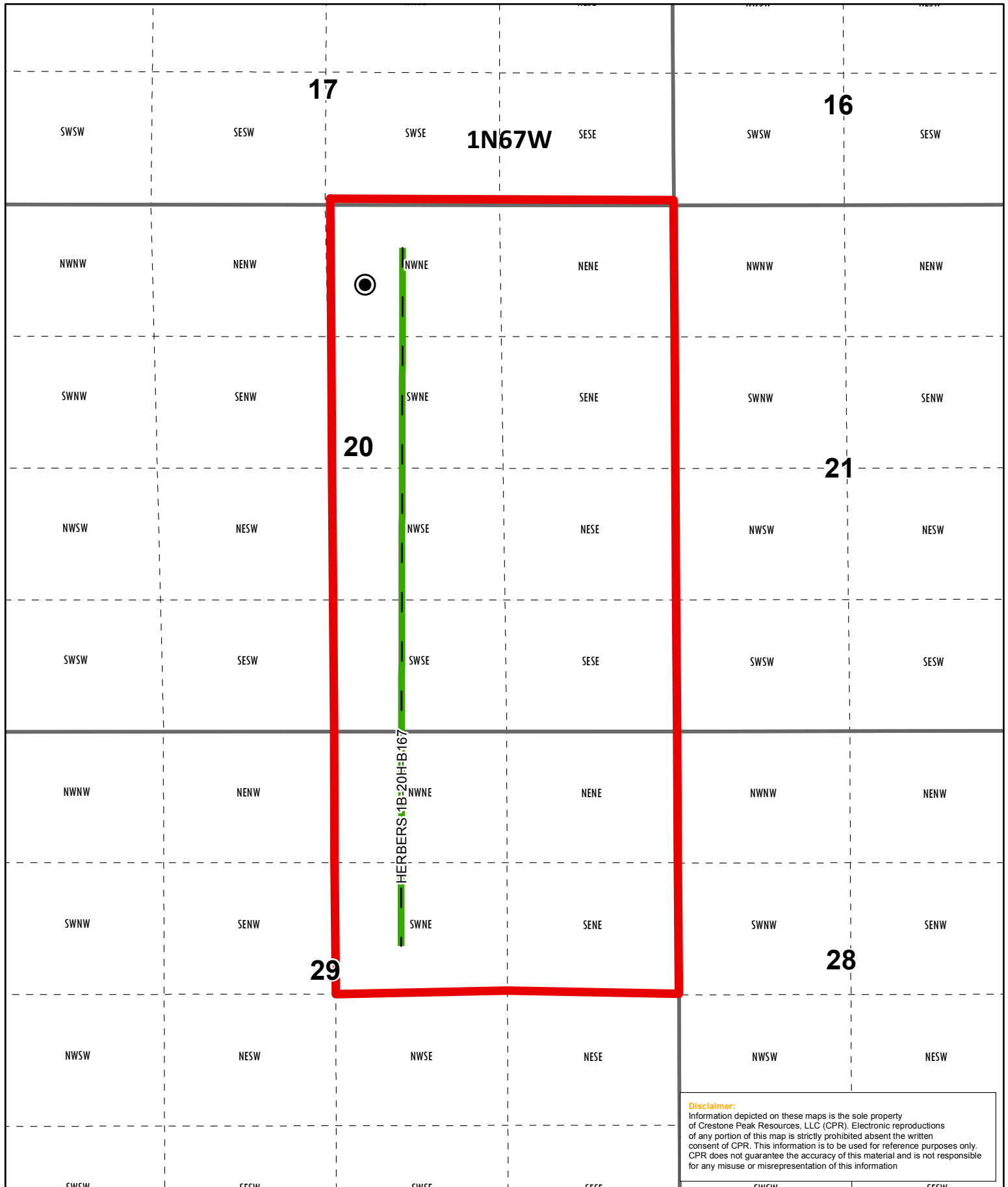

Disclaimer:
 Information depicted on these maps is the sole property of Crestone Peak Resources, LLC (CPR). Electronic reproductions of any portion of this map is strictly prohibited absent the written consent of CPR. This information is to be used for reference purposes only. CPR does not guarantee the accuracy of this material and is not responsible for any misuse or misrepresentation of this information

- Section QQ
- Crestone Well (Petra)
- CO Township
- Spaced Wellbore
- CO Section
- Preliminary Proposed Spacing Unit

Proposed Spacing Unit HERBERS 1B-20H-B167

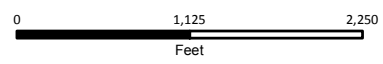

9/4/2018
 ©Crestone Peak Resources GIS
 Created by Julie Long

Coordinate System: GCS North American 1983