

# SRC ENERGY

Location: COLORADO Slot: SLOT#23 GREELEY-ROTHER 34N-2B-L (963'FSL & 294'FEL, SEC.01)  
 Field: WELD COUNTY (NAD83, TRUE NORTH) Well: GREELEY-ROTHER 34N-2B-L  
 Facility: SEC.01-T05N-R67W Wellbore: GREELEY-ROTHER 34N-2B-L PWB

Plot reference wellpath is GREELEY-ROTHER 34N-2B-L (REV-D.0) PWP	Grid System: NAD83 / Lambert Colorado SP, Northern Zone (501), US feet
True vertical depths are referenced to PRECISION 462 (20) (RKB)	* = Wellpath was transformed from a different geodetic datum
Measured depths are referenced to PRECISION 462 (20) (RKB)	North Reference: True north
PRECISION 462 (20) (RKB) to Mean Sea Level: 4893 feet	Scale: True distance
Mean Sea Level to Mud line (At Slot: SLOT#23 GREELEY-ROTHER 34N-2B-L (963'FSL & 294'FEL, SEC.01)): 0 feet	Depths are in feet
Coordinates are in feet referenced to Slot	Created by: doddanna on 2018-08-27
	Database: WellArchitectDB2

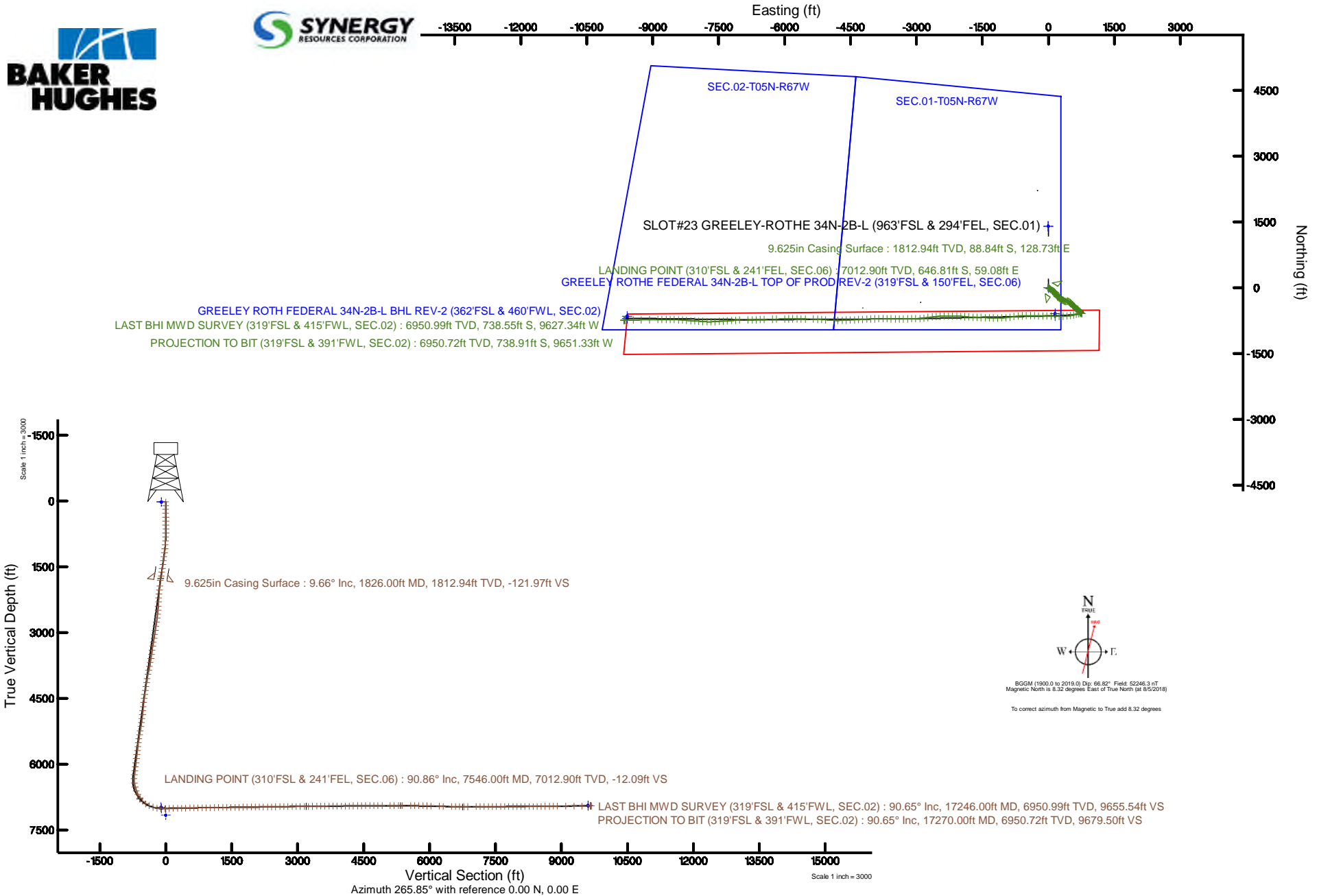



# Actual Wellpath Report

## GREELEY-ROTHER 34N-2B-L AWP

Page 1 of 9



### REFERENCE WELLPATH IDENTIFICATION

Operator	SRC ENERGY	Slot	SLOT#23 GREELEY-ROTHER 34N-2B-L (963'FSL & 294'FEL, SEC.01)
Area	COLORADO	Well	GREELEY-ROTHER 34N-2B-L
Field	WELD COUNTY (NAD83, TRUE NORTH)	Wellbore	GREELEY-ROTHER 34N-2B-L AWP
Facility	SEC.01-T05N-R67W		

### REPORT SETUP INFORMATION

Projection System	NAD83 / Lambert Colorado SP, Northern Zone (501), US feet	Software System	WellArchitect® 5.0
North Reference	True	User	Doddanna
Scale	0.999961	Report Generated	8/27/2018 at 12:02:06 PM
Convergence at slot	0.43° East	Database/Source file	WellArchitectDB2/GREELEY-ROTHER_34N-2B-L_AWP.xml

### WELLPATH LOCATION

	Local coordinates		Grid coordinates		Geographic coordinates	
	North[ft]	East[ft]	Easting[US ft]	Northing[US ft]	Latitude	Longitude
Slot Location	-1404.83	2.24	3185558.30	1398072.63	40°25'27.109"N	104°50'00.611"W
Facility Reference Pt			3185545.50	1399477.36	40°25'40.991"N	104°50'00.640"W
Field Reference Pt			3171284.48	1426358.81	40°30'07.643"N	104°53'02.634"W

### WELLPATH DATUM

Calculation method	Minimum curvature	PRECISION 462 (20') (RKB) to Facility Vertical Datum	4893.00ft
Horizontal Reference Pt	Slot	PRECISION 462 (20') (RKB) to Mean Sea Level	4893.00ft
Vertical Reference Pt	PRECISION 462 (20') (RKB)	PRECISION 462 (20') (RKB) to Mud Line at Slot (SLOT#23 GREELEY-ROTHER 34N-2B-L (963'FSL & 294'FEL, SEC.01))	4893.00ft
MD Reference Pt	PRECISION 462 (20') (RKB)	Section Origin	N 0.00, E 0.00 ft
Field Vertical Reference	Mean Sea Level	Section Azimuth	265.85°



# Actual Wellpath Report

## GREELEY-ROTHER 34N-2B-L AWP

Page 2 of 9



REFERENCE WELLPATH IDENTIFICATION			
Operator	SRC ENERGY	Slot	SLOT#23 GREELEY-ROTHER 34N-2B-L (963'FSL & 294'FEL, SEC.01)
Area	COLORADO	Well	GREELEY-ROTHER 34N-2B-L
Field	WELD COUNTY (NAD83,TRUE NORTH)	Wellbore	GREELEY-ROTHER 34N-2B-L AWP
Facility	SEC.01-T05N-R67W		

### WELLPATH DATA (179 stations) † = interpolated/extrapolated station

MD [ft]	Inclination [°]	Azimuth [°]	TVD [ft]	Vert Sect [ft]	North [ft]	East [ft]	DLS [°/100ft]	Comments
0.00†	0.000	248.280	0.00	0.00	0.00	0.00	0.00	
20.00	0.000	248.280	20.00	0.00	0.00	0.00	0.00	
104.00	0.100	248.280	104.00	0.07	-0.03	-0.07	0.12	
192.00	0.400	338.460	192.00	0.23	0.23	-0.25	0.47	
282.00	0.120	190.350	282.00	0.35	0.43	-0.38	0.56	
372.00	0.120	305.910	372.00	0.45	0.39	-0.48	0.23	
462.00	0.620	229.580	462.00	0.91	0.13	-0.92	0.67	
552.00	0.450	213.870	551.99	1.52	-0.48	-1.49	0.25	
642.00	0.300	220.850	641.99	1.91	-0.95	-1.84	0.17	
732.00	0.880	150.510	731.99	1.78	-1.73	-1.66	0.92	
822.00	2.510	122.250	821.95	-0.10	-3.38	0.35	1.98	
912.00	3.900	116.740	911.80	-4.32	-5.81	4.75	1.58	
1002.00	5.800	122.470	1001.48	-10.59	-9.63	11.32	2.18	
1092.00	7.380	122.880	1090.88	-18.86	-15.21	20.01	1.76	
1182.00	9.810	127.900	1179.86	-29.17	-23.06	30.92	2.82	
1272.00	10.150	125.730	1268.50	-40.95	-32.40	43.41	0.56	
1362.00	10.430	127.340	1357.05	-53.13	-41.97	56.32	0.45	
1452.00	10.340	122.450	1445.58	-65.72	-51.25	69.61	0.98	
1542.00	10.910	122.800	1534.04	-79.01	-60.19	83.59	0.64	
1632.00	11.890	121.880	1622.26	-93.32	-69.71	98.62	1.11	
1722.00	10.670	121.480	1710.52	-107.59	-78.95	113.60	1.36	
1775.00	9.850	123.170	1762.67	-115.18	-84.00	121.58	1.65	
1951.00	9.230	129.790	1936.24	-137.32	-101.27	145.03	0.72	
2043.00	9.280	144.390	2027.06	-146.50	-112.02	155.02	2.55	
2138.00	10.050	153.390	2120.71	-153.67	-125.66	163.19	1.78	
2230.00	10.070	151.030	2211.30	-160.11	-139.87	170.68	0.45	
2324.00	10.210	159.040	2303.84	-165.97	-154.84	177.64	1.51	
2418.00	10.740	157.990	2396.27	-171.06	-170.74	183.91	0.60	
2512.00	10.550	154.910	2488.65	-176.82	-186.66	190.84	0.64	
2605.00	10.640	141.770	2580.08	-184.68	-201.12	199.76	2.59	



# Actual Wellpath Report

## GREELEY-ROTHER 34N-2B-L AWP

Page 3 of 9



REFERENCE WELLPATH IDENTIFICATION			
Operator	SRC ENERGY	Slot	SLOT#23 GREELEY-ROTHER 34N-2B-L (963'FSL & 294'FEL, SEC.01)
Area	COLORADO	Well	GREELEY-ROTHER 34N-2B-L
Field	WELD COUNTY (NAD83,TRUE NORTH)	Wellbore	GREELEY-ROTHER 34N-2B-L AWP
Facility	SEC.01-T05N-R67W		

### WELLPATH DATA (179 stations)

MD [ft]	Inclination [°]	Azimuth [°]	TVD [ft]	Vert Sect [ft]	North [ft]	East [ft]	DLS [°/100ft]	Comments
2699.00	10.650	121.230	2672.50	-196.63	-212.44	212.56	4.02	
2792.00	10.440	112.880	2763.93	-211.14	-220.17	227.68	1.66	
2885.00	10.450	123.130	2855.40	-225.36	-228.06	242.50	2.00	
2978.00	11.250	129.360	2946.74	-238.65	-238.42	256.58	1.53	
3072.00	11.100	122.420	3038.96	-252.56	-249.09	271.31	1.44	
3164.00	11.130	126.320	3129.24	-266.43	-259.10	285.94	0.82	
3257.00	11.040	119.720	3220.50	-280.65	-268.83	300.91	1.37	
3350.00	11.080	119.070	3311.78	-295.52	-277.58	316.45	0.14	
3443.00	10.630	118.320	3403.11	-310.24	-285.99	331.81	0.51	
3538.00	11.070	127.010	3496.42	-324.50	-295.64	346.81	1.78	
3631.00	10.860	127.910	3587.72	-337.72	-306.40	360.85	0.29	
3725.00	11.430	110.950	3679.98	-352.73	-315.17	376.54	3.53	
3818.00	11.350	76.870	3771.25	-370.14	-316.39	394.08	7.14	
3911.00	11.190	67.680	3862.46	-387.75	-310.88	411.34	1.94	
4004.00	11.080	76.610	3953.72	-405.15	-305.39	428.38	1.86	
4097.00	10.100	99.400	4045.17	-421.90	-304.65	445.13	4.59	
4190.00	11.220	119.110	4136.59	-437.40	-310.38	461.08	4.08	
4283.00	10.990	128.060	4227.86	-451.54	-320.25	475.97	1.87	
4375.00	11.240	129.380	4318.13	-464.53	-331.35	489.80	0.39	
4470.00	11.240	128.110	4411.31	-478.10	-342.94	504.25	0.26	
4562.00	11.180	132.440	4501.56	-490.86	-354.49	517.88	0.92	
4656.00	11.140	142.910	4593.79	-502.06	-367.88	530.09	2.15	
4750.00	11.150	150.470	4686.02	-510.90	-383.04	540.04	1.55	
4844.00	11.110	147.230	4778.26	-519.13	-398.56	549.42	0.67	
4936.00	11.160	140.310	4868.53	-528.55	-412.86	559.91	1.45	
5030.00	11.120	132.720	4960.76	-540.03	-426.01	572.38	1.56	
5123.00	11.100	131.200	5052.02	-552.46	-437.99	585.70	0.32	
5217.00	11.050	128.050	5144.27	-565.49	-449.51	599.60	0.65	
5311.00	11.180	124.930	5236.51	-579.24	-460.28	614.17	0.65	
5405.00	11.070	118.680	5328.74	-593.89	-469.83	629.56	1.29	



# Actual Wellpath Report

## GREELEY-ROTHE 34N-2B-L AWP

Page 4 of 9



REFERENCE WELLPATH IDENTIFICATION			
Operator	SRC ENERGY	Slot	SLOT#23 GREELEY-ROTHE 34N-2B-L (963'FSL & 294'FEL, SEC.01)
Area	COLORADO	Well	GREELEY-ROTHE 34N-2B-L
Field	WELD COUNTY (NAD83,TRUE NORTH)	Wellbore	GREELEY-ROTHE 34N-2B-L AWB
Facility	SEC.01-T05N-R67W		

### WELLPATH DATA (179 stations)

MD [ft]	Inclination [°]	Azimuth [°]	TVD [ft]	Vert Sect [ft]	North [ft]	East [ft]	DLS [°/100ft]	Comments
5498.00	10.950	116.470	5420.03	-609.00	-478.05	645.30	0.47	
5590.00	10.890	124.100	5510.37	-623.34	-486.82	660.32	1.57	
5684.00	10.850	137.970	5602.70	-635.75	-498.37	673.60	2.78	
5777.00	10.960	136.350	5694.02	-646.75	-511.27	685.56	0.35	
5869.00	10.910	141.580	5784.35	-657.21	-524.42	697.01	1.08	
5962.00	10.920	138.670	5875.67	-667.49	-537.93	708.29	0.59	
6055.00	10.980	135.620	5966.98	-678.53	-550.87	720.30	0.63	
6149.00	10.980	135.790	6059.26	-690.08	-563.69	732.81	0.03	
6241.00	11.010	130.560	6149.57	-701.96	-575.68	745.59	1.08	
6335.00	8.360	109.950	6242.25	-714.58	-583.85	758.84	4.60	
6428.00	0.500	20.410	6334.92	-720.93	-585.78	765.35	9.00	
6520.00	6.970	267.390	6426.70	-715.51	-585.66	759.91	7.80	
6613.00	14.620	276.490	6517.99	-698.31	-584.59	742.58	8.40	
6706.00	20.440	262.600	6606.67	-670.53	-585.35	714.78	7.67	
6800.00	26.430	253.770	6692.91	-633.64	-593.32	678.37	7.37	
6894.00	34.570	254.420	6773.83	-586.96	-606.36	632.52	8.67	
6989.00	45.680	256.710	6846.36	-526.80	-621.45	573.29	11.80	
7081.00	57.260	261.310	6903.59	-455.47	-634.92	502.75	13.17	
7174.00	65.510	265.590	6948.11	-373.99	-644.10	421.73	9.74	
7267.00	72.880	268.520	6981.13	-287.15	-648.51	334.98	8.45	
7360.00	80.880	269.840	7002.22	-196.81	-649.79	244.49	8.71	
7453.00	87.540	270.850	7011.60	-104.62	-649.22	152.02	7.24	
7546.00	90.860	272.120	7012.90	-12.09	-646.81	59.08	3.82	LANDING POINT (310'FSL & 241'FEL, SEC.06)
7641.00	90.800	271.510	7011.52	82.38	-643.81	-35.87	0.65	
7734.00	91.630	270.910	7009.55	174.95	-641.84	-128.82	1.10	
7827.00	91.630	271.940	7006.90	267.47	-639.53	-221.76	1.11	
7920.00	91.320	272.170	7004.51	359.90	-636.20	-314.67	0.42	
8013.00	91.450	271.040	7002.26	452.40	-633.59	-407.60	1.22	
8107.00	91.290	268.240	7000.01	546.16	-634.18	-501.56	2.98	
8201.00	91.230	266.350	6997.95	640.10	-638.62	-595.43	2.01	



# Actual Wellpath Report

## GREELEY-ROTHE 34N-2B-L AWP

Page 5 of 9



REFERENCE WELLPATH IDENTIFICATION			
Operator	SRC ENERGY	Slot	SLOT#23 GREELEY-ROTHE 34N-2B-L (963'FSL & 294'FEL, SEC.01)
Area	COLORADO	Well	GREELEY-ROTHE 34N-2B-L
Field	WELD COUNTY (NAD83,TRUE NORTH)	Wellbore	GREELEY-ROTHE 34N-2B-L AWB
Facility	SEC.01-T05N-R67W		

### WELLPATH DATA (179 stations)

MD [ft]	Inclination [°]	Azimuth [°]	TVD [ft]	Vert Sect [ft]	North [ft]	East [ft]	DLS [°/100ft]	Comments
8293.00	90.830	264.370	6996.29	732.08	-646.06	-687.11	2.20	
8387.00	90.860	262.360	6994.90	825.97	-656.92	-780.46	2.14	
8482.00	90.710	262.730	6993.60	920.81	-669.24	-874.65	0.42	
8575.00	90.860	264.370	6992.33	1013.72	-679.69	-967.05	1.77	
8670.00	90.770	266.890	6990.98	1108.70	-686.93	-1061.76	2.65	
8764.00	90.770	270.060	6989.71	1202.58	-689.43	-1155.71	3.37	
8858.00	90.770	272.100	6988.45	1296.18	-687.66	-1249.68	2.17	
8952.00	90.830	272.010	6987.14	1389.62	-684.29	-1343.61	0.12	
9045.00	90.770	271.950	6985.84	1482.08	-681.07	-1436.54	0.09	
9138.00	90.890	271.990	6984.49	1574.54	-677.88	-1529.48	0.14	
9232.00	90.890	272.860	6983.03	1667.91	-673.90	-1623.38	0.93	
9325.00	91.020	272.920	6981.48	1760.19	-669.21	-1716.25	0.15	
9418.00	90.950	273.090	6979.88	1852.45	-664.34	-1809.11	0.20	
9511.00	90.740	274.640	6978.51	1944.53	-658.07	-1901.88	1.68	
9603.00	90.800	275.170	6977.28	2035.38	-650.20	-1993.54	0.58	
9697.00	90.770	271.710	6975.99	2128.53	-644.56	-2087.34	3.68	
9791.00	90.740	269.850	6974.75	2222.17	-643.28	-2181.32	1.98	
9883.00	90.800	269.740	6973.51	2313.94	-643.61	-2273.31	0.14	
9978.00	90.950	268.290	6972.06	2408.79	-645.25	-2368.29	1.53	
10071.00	90.800	267.610	6970.64	2501.71	-648.57	-2461.22	0.75	
10164.00	90.650	263.560	6969.46	2594.68	-655.73	-2553.91	4.36	
10256.00	90.740	262.910	6968.35	2686.58	-666.57	-2645.27	0.71	
10350.00	90.710	262.280	6967.16	2780.42	-678.68	-2738.47	0.67	
10444.00	90.000	263.090	6966.58	2874.27	-690.65	-2831.71	1.15	
10537.00	90.920	265.930	6965.83	2967.24	-699.54	-2924.27	3.21	
10631.00	90.740	267.960	6964.47	3061.20	-704.55	-3018.12	2.17	
10724.00	90.710	269.400	6963.29	3154.08	-706.70	-3111.08	1.55	
10817.00	90.800	269.450	6962.07	3246.89	-707.63	-3204.07	0.11	
10911.00	90.740	268.840	6960.80	3340.73	-709.03	-3298.05	0.65	
11005.00	90.740	269.870	6959.59	3434.54	-710.09	-3392.03	1.10	



# Actual Wellpath Report

## GREELEY-ROTHER 34N-2B-L AWP

Page 6 of 9



REFERENCE WELLPATH IDENTIFICATION			
Operator	SRC ENERGY	Slot	SLOT#23 GREELEY-ROTHER 34N-2B-L (963'FSL & 294'FEL, SEC.01)
Area	COLORADO	Well	GREELEY-ROTHER 34N-2B-L
Field	WELD COUNTY (NAD83,TRUE NORTH)	Wellbore	GREELEY-ROTHER 34N-2B-L AWP
Facility	SEC.01-T05N-R67W		

### WELLPATH DATA (179 stations)

MD [ft]	Inclination [°]	Azimuth [°]	TVD [ft]	Vert Sect [ft]	North [ft]	East [ft]	DLS [°/100ft]	Comments
11097.00	90.950	270.840	6958.23	3526.25	-709.52	-3484.02	1.08	
11189.00	90.680	271.550	6956.92	3617.84	-707.60	-3575.99	0.83	
11283.00	90.460	271.360	6955.99	3711.38	-705.21	-3669.96	0.31	
11376.00	90.550	270.080	6955.17	3804.04	-704.05	-3762.94	1.38	
11470.00	90.520	268.740	6954.29	3897.85	-705.01	-3856.93	1.43	
11563.00	90.340	268.000	6953.59	3990.76	-707.66	-3949.89	0.82	
11655.00	90.430	267.180	6952.97	4082.71	-711.53	-4041.81	0.90	
11747.00	90.280	267.050	6952.40	4174.69	-716.16	-4133.69	0.22	
11840.00	90.310	266.980	6951.93	4267.67	-721.00	-4226.56	0.08	
11933.00	90.340	267.650	6951.40	4360.64	-725.36	-4319.46	0.72	
12026.00	90.250	267.240	6950.92	4453.60	-729.50	-4412.36	0.45	
12120.00	90.220	267.250	6950.53	4547.57	-734.02	-4506.25	0.03	
12212.00	90.060	267.130	6950.31	4639.54	-738.53	-4598.14	0.22	
12306.00	90.400	268.490	6949.93	4733.49	-742.12	-4692.07	1.49	
12399.00	90.250	269.790	6949.40	4826.33	-743.52	-4785.06	1.41	
12493.00	90.370	271.660	6948.89	4919.98	-742.33	-4879.04	1.99	
12679.00	90.400	275.040	6947.64	5104.36	-731.46	-5064.70	1.82	
12772.00	90.340	273.870	6947.04	5196.31	-724.24	-5157.41	1.26	
12866.00	90.400	272.850	6946.44	5289.50	-718.73	-5251.25	1.09	
12961.00	90.370	270.490	6945.80	5384.00	-715.96	-5346.20	2.48	
13146.00	90.280	271.290	6944.75	5568.28	-713.09	-5531.17	0.44	
13240.00	89.570	271.640	6944.87	5661.83	-710.68	-5625.14	0.84	
13333.00	88.460	270.550	6946.47	5754.42	-708.91	-5718.11	1.67	
13427.00	88.490	270.230	6948.97	5848.09	-708.27	-5812.07	0.34	
13519.00	88.430	269.770	6951.45	5939.82	-708.27	-5904.04	0.50	
13612.00	88.430	269.070	6953.99	6032.60	-709.21	-5997.00	0.75	
13798.00	88.400	267.480	6959.14	6218.36	-714.81	-6182.83	0.85	
13893.00	87.910	267.680	6962.20	6313.27	-718.82	-6277.70	0.56	
14079.00	88.980	268.930	6967.24	6499.02	-724.31	-6463.54	0.88	
14171.00	88.980	267.590	6968.88	6590.92	-727.11	-6555.48	1.46	





# Actual Wellpath Report

## GREELEY-ROTHER 34N-2B-L AWP

Page 7 of 9



REFERENCE WELLPATH IDENTIFICATION			
Operator	SRC ENERGY	Slot	SLOT#23 GREELEY-ROTHER 34N-2B-L (963'FSL & 294'FEL, SEC.01)
Area	COLORADO	Well	GREELEY-ROTHER 34N-2B-L
Field	WELD COUNTY (NAD83,TRUE NORTH)	Wellbore	GREELEY-ROTHER 34N-2B-L AWP
Facility	SEC.01-T05N-R67W		

### WELLPATH DATA (179 stations)

MD [ft]	Inclination [°]	Azimuth [°]	TVD [ft]	Vert Sect [ft]	North [ft]	East [ft]	DLS [°/100ft]	Comments
14263.00	89.020	267.270	6970.49	6682.87	-731.23	-6647.38	0.35	
14356.00	90.280	268.500	6971.06	6775.81	-734.66	-6740.31	1.89	
14448.00	90.150	270.270	6970.71	6867.63	-735.65	-6832.30	1.93	
14636.00	90.120	269.330	6970.27	7055.18	-736.31	-7020.30	0.50	
14730.00	90.000	266.340	6970.17	7149.11	-739.86	-7114.22	3.18	
14824.00	89.940	264.990	6970.22	7243.11	-746.96	-7207.95	1.44	
14917.00	90.250	265.810	6970.06	7336.11	-754.42	-7300.65	0.94	
15010.00	90.150	267.900	6969.74	7429.09	-759.52	-7393.50	2.25	
15103.00	90.090	265.920	6969.54	7522.07	-764.54	-7486.36	2.13	
15197.00	90.180	266.940	6969.32	7616.06	-770.39	-7580.18	1.09	
15290.00	90.220	268.680	6969.00	7709.00	-773.94	-7673.10	1.87	
15383.00	90.180	272.020	6968.67	7801.70	-773.38	-7766.09	3.59	
15476.00	90.430	274.480	6968.18	7893.92	-768.10	-7858.93	2.66	
15568.00	90.310	273.250	6967.58	7985.01	-761.90	-7950.72	1.34	
15663.00	90.310	273.660	6967.07	8079.18	-756.18	-8045.54	0.43	
15755.00	90.430	274.740	6966.48	8170.20	-749.44	-8137.29	1.18	
15849.00	90.550	274.710	6965.67	8263.07	-741.70	-8230.97	0.13	
15941.00	90.580	273.920	6964.77	8354.06	-734.77	-8322.70	0.86	
16034.00	90.680	272.330	6963.74	8446.30	-729.71	-8415.56	1.71	
16127.00	90.580	270.940	6962.72	8538.82	-727.05	-8508.51	1.50	
16220.00	90.650	269.970	6961.72	8631.51	-726.31	-8601.50	1.05	
16312.00	90.650	270.220	6960.68	8723.26	-726.16	-8693.50	0.27	
16406.00	90.430	269.870	6959.79	8817.00	-726.09	-8787.49	0.44	
16500.00	90.770	269.800	6958.81	8910.77	-726.36	-8881.49	0.37	
16687.00	90.550	268.820	6956.65	9097.41	-728.61	-9068.46	0.54	
16875.00	90.650	268.810	6954.69	9285.15	-732.50	-9256.41	0.05	
17060.00	90.490	269.160	6952.84	9469.86	-735.77	-9441.37	0.21	
17246.00	90.650	269.130	6950.99	9655.54	-738.55	-9627.34	0.09	LAST BHI MWD SURVEY (319'FSL & 415'FWL, SEC.02)
17270.00	90.650	269.130	6950.72	9679.50	-738.91	-9651.33	0.00	PROJECTION TO BIT (319'FSL & 391'FWL, SEC.02)



<b>HOLE &amp; CASING SECTIONS - Ref Wellbore: GREELEY-ROTHER 34N-2B-L AWP      Ref Wellpath: GREELEY-ROTHER 34N-2B-L AWP</b>									
String/Diameter	Start MD [ft]	End MD [ft]	Interval [ft]	Start TVD [ft]	End TVD [ft]	Start N/S [ft]	Start E/W [ft]	End N/S [ft]	End E/W [ft]
13.5in Open Hole	20.00	1826.00	1806.00	20.00	1812.94	0.00	0.00	-88.84	128.73
9.625in Casing Surface	20.00	1826.00	1806.00	20.00	1812.94	0.00	0.00	-88.84	128.73
8.5in Open Hole	1826.00	17270.00	15444.00	1812.94	6950.72	-88.84	128.73	-738.91	-9651.33

<b>TARGETS</b>								
Name	TVD [ft]	North [ft]	East [ft]	Grid East [US ft]	Grid North [US ft]	Latitude	Longitude	Shape
SEC.01-T05N-R67W	23.00	1404.83	-2.24	3185545.50	1399477.36	40°25'40.991"N	104°50'00.640"W	polygon
SEC.02-T05N-R67W	23.00	1404.83	-2.24	3185545.50	1399477.36	40°25'40.991"N	104°50'00.640"W	polygon
GREELEY ROTH FEDERAL 34N-2B-L BHL ON PLAT (412'FSL & 460'FWL, SEC.02)	6937.00	-645.51	-9581.86	3175981.95	1397355.16	40°25'20.712"N	104°52'04.501"W	point
GREELEY ROTH FEDERAL 34N-2B-L BHL REV-2 (362'FSL & 460'FWL, SEC.02)	6953.84	-695.51	-9581.86	3175982.33	1397305.16	40°25'20.218"N	104°52'04.501"W	point
GREELEY ROTH FEDERAL 334N-2B-L TOP OF PROD ON PLAT (369'FSL & 150'FEL, SEC.01)	6978.00	-588.35	149.53	3185712.24	1397485.45	40°25'21.295"N	104°49'58.678"W	point
GREELEY ROTHE FEDERAL 34N-2B-L TOP OF PROD REV-2 (319'FSL & 150'FEL, SEC.06)	7008.49	-638.35	149.53	3185712.62	1397435.46	40°25'20.801"N	104°49'58.678"W	point
HARDLINE BOX 3	7164.00	0.00	0.00	3185558.30	1398072.63	40°25'27.109"N	104°50'00.611"W	polygon



# Actual Wellpath Report

## GREELEY-ROTHER 34N-2B-L AWP

Page 8 of 9



REFERENCE WELLPATH IDENTIFICATION			
Operator	SRC ENERGY	Slot	SLOT#23 GREELEY-ROTHER 34N-2B-L (963'FSL & 294'FEL, SEC.01)
Area	COLORADO	Well	GREELEY-ROTHER 34N-2B-L
Field	WELD COUNTY (NAD83,TRUE NORTH)	Wellbore	GREELEY-ROTHER 34N-2B-L AWP
Facility	SEC.01-T05N-R67W		

WELLPATH COMPOSITION - Ref Wellbore: GREELEY-ROTHER 34N-2B-L AWP      Ref Wellpath: GREELEY-ROTHER 34N-2B-L AWP				
Start MD [ft]	End MD [ft]	Positional Uncertainty Model	Log Name/Comment	Wellbore
20.00	1775.00	BHI NaviTrak (Standard)	13 1/2" SURFACE SURVEYS <88-1759>	GREELEY-ROTHER 34N-2B-L AWP
1775.00	17246.00	BHI AutoTrak Curve (MagCAD+IFR1, Short spacing)	8 1/2" BHI MONOBORE SURVEYS <1951- 17246>	GREELEY-ROTHER 34N-2B-L AWP
17246.00	17270.00	Blind Drilling (std)	Projection to bit	GREELEY-ROTHER 34N-2B-L AWP



# Actual Wellpath Report

## GREELEY-ROTHER 34N-2B-L AWP

Page 9 of 9



REFERENCE WELLPATH IDENTIFICATION			
Operator	SRC ENERGY	Slot	SLOT#23 GREELEY-ROTHER 34N-2B-L (963'FSL & 294'FEL, SEC.01)
Area	COLORADO	Well	GREELEY-ROTHER 34N-2B-L
Field	WELD COUNTY (NAD83,TRUE NORTH)	Wellbore	GREELEY-ROTHER 34N-2B-L AWP
Facility	SEC.01-T05N-R67W		

WELLPATH COMMENTS				
MD [ft]	Inclination [°]	Azimuth [°]	TVD [ft]	Comment
7546.00	90.860	272.120	7012.90	LANDING POINT (310'FSL & 241'FEL, SEC.06)
17246.00	90.650	269.130	6950.99	LAST BHI MWD SURVEY (319'FSL & 415'FWL, SEC.02)
17270.00	90.650	269.130	6950.72	PROJECTION TO BIT (319'FSL & 391'FWL, SEC.02)