

LOCATION DRAWING
JDB 16-15HZ
HORIZONTAL MULTI-WELL PAD

S1/2 SE1/4 SECTION 15, TOWNSHIP 1 NORTH, RANGE 66 WEST, 6TH P.M.

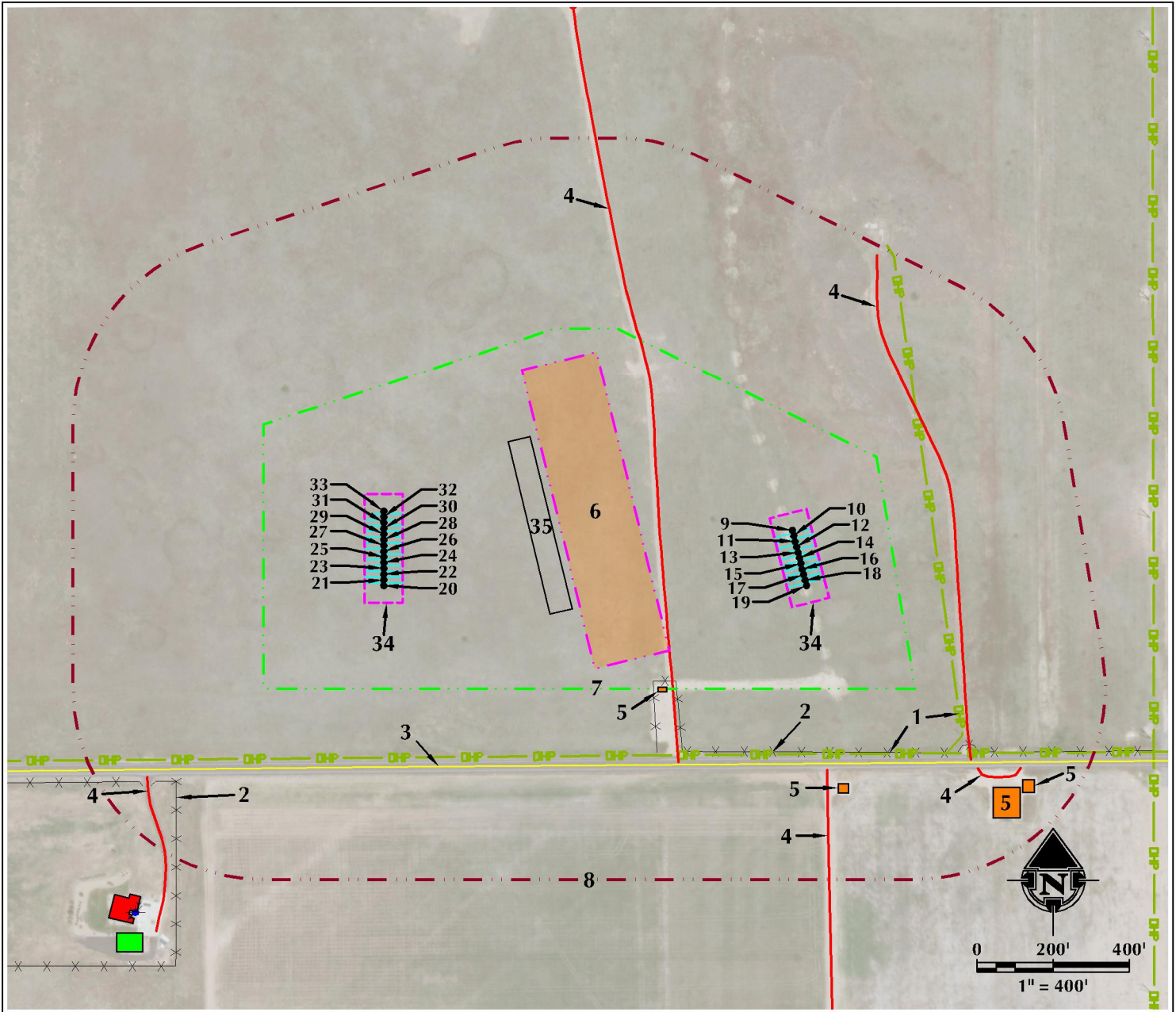

- OVERHEAD POWER LINES ARE $\pm 367'$ E AND $\pm 587'$ S.
- EXISTING FENCES ARE $\pm 500'$ SW AND $\pm 1746'$ SW.
- COUNTY ROAD 8 IS $\pm 605'$ S.
- EXISTING PRIVATE ROADS ARE $\pm 347'$ W, $\pm 425'$ E, $\pm 635'$ S $\pm 792'$ SE AND $\pm 1813'$ SW.
- EXISTING FACILITIES ARE $\pm 527'$ SW, $\pm 675'$ S, $\pm 856'$ SE AND $\pm 891'$ SE.
- PROPOSED JDB 16-15HZ FACILITY PAD IS $\pm 388'$ W.
- OPERATIONAL DISTURBANCE AREA
- 500' BUFFER
- PROPOSED WELL: JDB 15-1HZ
- PROPOSED WELL: JDB 15-2HZ
- PROPOSED WELL: JDB 15-3HZ

- PROPOSED WELL: JDB 15-4HZ
- PROPOSED WELL: JDB 15-5HZ
- PROPOSED WELL: JDB 15-6HZ
- PROPOSED WELL: JDB 15-7HZ
- PROPOSED WELL: JDB 15-8HZ
- PROPOSED WELL: JDB 15-9HZ
- PROPOSED WELL: JDB 15-10HZ
- PROPOSED WELL: JDB 15-11HZ
- PROPOSED WELL: MAB 15-1HZ
- PROPOSED WELL: MAB 15-2HZ
- PROPOSED WELL: MAB 15-3HZ
- PROPOSED WELL: MAB 15-4HZ

- PROPOSED WELL: MAB 15-5HZ
- PROPOSED WELL: MAB 15-6HZ
- PROPOSED WELL: MAB 15-7HZ
- PROPOSED WELL: MAB 15-8HZ
- PROPOSED WELL: MAB 15-9HZ
- PROPOSED WELL: MAB 15-10HZ
- PROPOSED WELL: MAB 15-11HZ
- PROPOSED WELL: MAB 15-12HZ
- PROPOSED WELL: MAB 15-13HZ
- PROPOSED WELL: MAB 15-14HZ
- PUMP JACK OPERATIONS AREA
- TEMPORARY EQUIPMENT AREA

LEGEND

- EXISTING WELL
- PROPOSED WELL
- WATER WELL
- EXISTING FENCE
- PUBLIC ROAD
- PRIVATE ROAD
- 500' BUFFER
- DISTURBANCE AREA
- PUMP JACK AREA
- PROPOSED FACILITY
- DITCH/CANAL/DRAINAGE
- OVERHEAD POWER LINE
- EXISTING FACILITY
- EXISTING BUILDINGS
- RESIDENCE/BUILDING UNIT
- TEMPORARY EQUIPMENT AREA

* REFERENCE LOCATION *

ALL MEASUREMENTS ARE MADE FROM
REFERENCE WELL: JDB 15-1HZ
LAT: 40.045725° LONG: -104.757817° (NAD83)
EXISTING GROUND ELEVATION = 5156.0'
WELL FOOTAGES: 625' FSL & 1098' FEL

SURFACE USE: RANGELAND

NEAREST BUILDING UNIT: $\pm 1435'$ E

PREPARED FOR:
Kerr-McGee Oil & Gas Onshore L.P.



609 CONSULTING, LLC
LOVELAND OFFICE
6706 North Franklin Avenue
Loveland, Colorado 80538
Phone: 970-776-4331

SHERIDAN OFFICE
1095 Saberton Avenue
Sheridan, Wyoming 82801
Phone: 307-674-0609

DATE SURVEYED: 6/25/18
DATE: 7/24/18
DRAFTER: HJL
REVISED:

DATA SOURCES:
- AERIAL COURTESY OF ESRI, INC.
- WATER WELLS COURTESY OF
COLORADO DIVISION OF WATER
RESOURCES