



August 29, 2018

Mr. Paul Herring
Top Operating Co.
3609 Wadsworth Blvd., Ste 340
Lakewood, CO 80235

**Soil Assessment and Analytical Report
Kintz #1, 2
Water Vault Removal
40.242650 / -105.020890
SE¼ NE¼ SEC.8 T3N R68W 6PM
Weld County, Colorado
Remediation # 10962**

Dear Mr. Herring,

Eagle Environmental Consulting, Inc. (EAGLE) is pleased to present the results from the water vault removal at the Kintz #1, 2 site (site).

On July 31, 2018, EAGLE collected soil samples following the removal of two water vaults at the site. Per the approved Form 27 (Document No. 401507629), a soil sample was collected from each sidewall and the floor of each vault for laboratory analysis. Additionally, three (3) background soil samples were collected adjacent to the water vault locations. All soil samples were submitted for benzene, toluene, ethylbenzene, total xylenes (BTEX), and total petroleum hydrocarbons – gasoline range organics (TPH-GRO) following modified Environmental Protection Agency (EPA) Method 8260c, and total petroleum hydrocarbons – diesel range organics (TPH-DRO) following EPA Method 8015.

In addition, each soil sample was analyzed for Sodium Adsorption Ratio (SAR) following United States Department of Agriculture (USDA) Method 20B, Specific Conductance (EC) following USDA Method 3, and pH following EPA Method 9045D.

Based on laboratory analytical results:

- Excavation soil samples SS-01@3', SS-02@3', SS-03@3', SS-04@3', SS-05@6', SS-06@3', SS-07@3', SS-08@3', SS-09@3', and SS-10@6', and background soil samples SS-11@3', SS-12@3', and SS-13@3' did not contain concentrations of BTEX or total petroleum hydrocarbons (TPH) exceeding applicable Colorado Oil and Gas Conservation Commission (COGCC) Table 910-1 regulatory limits.
- Soil samples SS-01@3', SS-02@3', SS-03@3', SS-04@3', SS-05@6', SS-06@3', SS-07@3', SS-08@3', SS-09@3', and SS-10@6', SS-11@3', SS-12@3', and SS-13@3' had specific conductance, and sodium adsorption ratio (SAR) values within COGCC Table 910-1 regulatory limits.
- Soil samples SS-02@3', SS-03@3', SS-05@6', SS-06@3', and SS-08@3' had pH values (9.07, 9.26, 9.07, 9.09, and 9.07 pH units, respectively) outside the COGCC Table 910-1 regulatory limit of 6-9 pH units.



EAGLE sincerely appreciates the opportunity to provide our services. If you have any questions or require further information, please contact us at (303) 433-0479.

Sincerely,

EAGLE ENVIRONMENTAL CONSULTING, INC.

A handwritten signature in blue ink, appearing to read "Andrew Newberry", written in a cursive style.

Andrew Newberry
Project Geologist

A handwritten signature in blue ink, appearing to read "Robin Lockwood", written in a cursive style.

Robin Lockwood
Project Scientist

TABLES

Table 1: Soil Analytical Results Summary

TABLE 1
SOIL ANALYTICAL RESULTS SUMMARY
KINTZ #1, 2
WATER VAULT REMOVAL
40.242650 / -105.020890
SE¼ NE¼ SEC.8 T3N R68W 6PM
WELD COUNTY, COLORADO
REMEDATION #10962

Sample Location (Latitude/Longitude)	Date	Approximate Depth (feet)	Benzene (mg/kg)	Toluene (mg/kg)	Ethylbenzene (mg/kg)	Total Xylenes (mg/kg)	TPH-GRO (mg/kg)	TPH-DRO (mg/kg)	Specific Conductance (mmhos/cm)	pH (pH units)	SAR
COGCC - Regulatory Limits (Table 910-1) (mg/kg)			0.17	85	100	175	500		<4	6 to 9	<12
SS-01 @ 3' (40.243059 / -105.020685)	07/31/18	3	<0.002	<0.002	<0.002	<0.002	<0.200	<50.0	0.215	8.99	2.31
SS-02 @ 3' (40.243007 / -105.020686)	07/31/18	3	<0.002	<0.002	<0.002	<0.002	<0.200	<50.0	0.124	9.07	0.78
SS-03 @ 3' (40.243030 / -105.020657)	07/31/18	3	<0.002	<0.002	<0.002	<0.002	<0.200	<50.0	0.221	9.26	3.52
SS-04 @ 3' (40.243025 / -105.020712)	07/31/18	3	<0.002	<0.002	<0.002	<0.002	<0.200	<50.0	0.137	8.98	0.65
SS-05 @ 6' (40.243027 / -105.020684)	07/31/18	6	<0.002	<0.002	<0.002	<0.002	<0.200	<50.0	0.150	9.07	1.67
SS-06 @ 3' (40.243060 / -105.020622)	07/31/18	3	<0.002	<0.002	<0.002	<0.002	<0.200	<50.0	0.167	9.09	0.71
SS-07 @ 3' (40.243006 / -105.020620)	07/31/18	3	<0.002	<0.002	<0.002	<0.002	<0.200	<50.0	0.111	8.81	1.47
SS-08 @ 3' (40.243029 / -105.020588)	07/31/18	3	<0.002	<0.002	<0.002	<0.002	<0.200	<50.0	0.0704	9.07	0.34
SS-09 @ 3' (40.243027 / -105.020652)	07/31/18	3	<0.002	<0.002	<0.002	<0.002	<0.200	<50.0	0.126	8.83	1.35
SS-10 @ 6' (40.243028 / -105.020620)	07/31/18	6	<0.002	<0.002	<0.002	<0.002	<0.200	<50.0	0.243	8.69	2.04
SS-11 @ 3' (40.242806 / -105.020634)	07/31/18	3	<0.002	<0.002	<0.002	<0.002	<0.200	<50.0	0.220	8.68	1.38
SS-12 @ 3' (40.242923 / -105.020802)	07/31/18	3	<0.002	<0.002	<0.002	<0.002	<0.200	<50.0	0.633	8.49	6.45
SS-13 @ 3' (40.243088 / -105.020747)	07/31/18	3	<0.002	<0.002	<0.002	<0.002	<0.200	<50.0	0.450	8.86	7.47
COGCC = Colorado Oil and Gas Conservation Commission mg/kg = milligrams per kilogram TPH-GRO = Total Petroleum Hydrocarbons - Gasoline Range Organics mmhos/cm = millimhos per centimeter TPH-DRO = Total Petroleum Hydrocarbons - Diesel Range Organics SAR = Sodium Adsorption Ratio Values presented in bold indicate concentrations exceeded COGCC Table 910-1 regulatory limits. Values presented with a "<" symbol indicate concentrations were not observed above the laboratory reporting limit.											



FIGURES

Figure 1: Topographic Site Location Map

Figure 2: Aerial Site Location Map

Figure 3: Soil Analytical Map

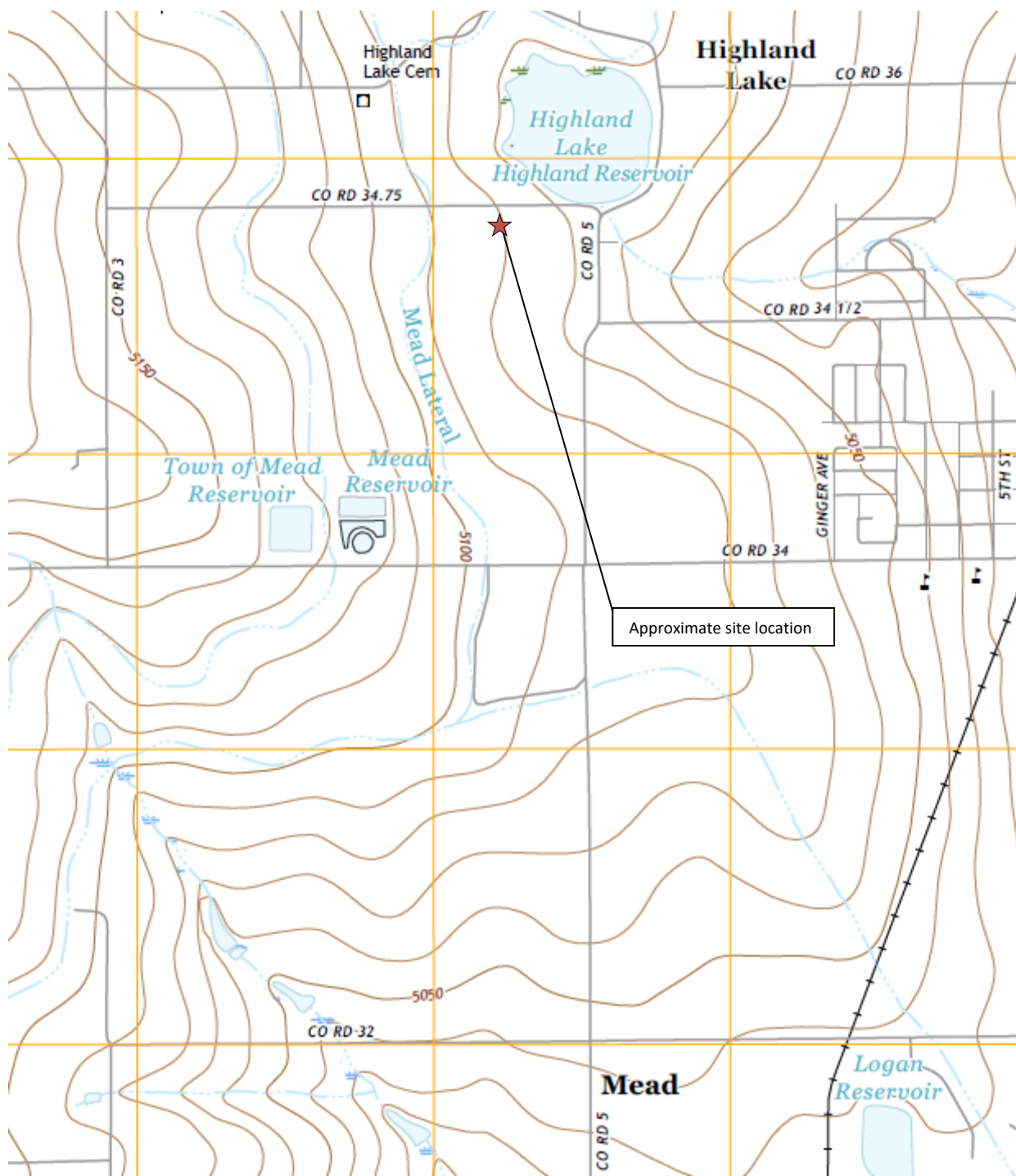

Topographic Site Location Map

Kintz #1, 2
 Water Vault Removal
 40.242650 / -105.020890
 SE¼ NE¼ SEC.8 T3N R68W 6PM
 Weld County, Colorado
 Remediation # 10962



EAGLE
 ENVIRONMENTAL
 CONSULTING, INC.



Source: USGS 7.5 Minute Topographic Map, Longmont, CO Quadrangle 2016

Figure 1



LEGEND

- KINTZ #1, 2 TANK BATTERY
- KINTZ #1 WELL HEAD
- KINTZ #2 WELL HEAD
- APPROXIMATE WATER VAULT LOCATIONS

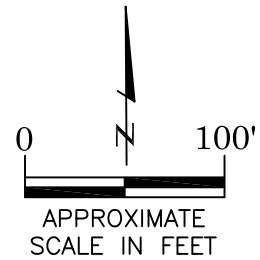

AERIAL SITE LOCATION MAP
 KINTZ #1, 2
 WATER VAULT REMOVAL
 40.242650 / -105.020890
 SE1/4 NE1/4 SEC.8 T3N R68W 6PM
 WELD COUNTY, COLORADO
 REMEDIATION # 10962

DATE:
08/13/18

FIG. NO.
2

DRAWN BY:
ar



EAGLE
 ENVIRONMENTAL
 CONSULTING, INC.
 4101 INCA STREET, DENVER, CO 80211
 Ph: 303-433-0479 • F: 303-325-5449

SS-13@3'
07/31/18
3'
B = <0.002
T = <0.002
E = <0.002
X = <0.002
G = <0.200
D = <50.0
EC = 0.450
SAR= 7.47
pH = 8.86

SS-01@3'
07/31/18
3'
B = <0.002
T = <0.002
E = <0.002
X = <0.002
G = <0.200
D = <50.0
EC = 0.215
SAR= 2.31
pH = 8.99

SS-06@3'
07/31/18
3'
B = <0.002
T = <0.002
E = <0.002
X = <0.002
G = <0.200
D = <50.0
EC = 0.167
SAR= 0.71
pH = **9.09**

SS-03@3'
07/31/18
3'
B = <0.002
T = <0.002
E = <0.002
X = <0.002
G = <0.200
D = <50.0
EC = 0.221
SAR= 3.52
pH = **9.26**

SS-10@6'
07/31/18
6'
B = <0.002
T = <0.002
E = <0.002
X = <0.002
G = <0.200
D = <50.0
EC = 0.243
SAR= 2.04
pH = 8.69

SS-08@3'
07/31/18
3'
B = <0.002
T = <0.002
E = <0.002
X = <0.002
G = <0.200
D = <50.0
EC = 0.0704
SAR= 0.34
pH = **9.07**

SS-05@6'
07/31/18
6'
B = <0.002
T = <0.002
E = <0.002
X = <0.002
G = <0.200
D = <50.0
EC = 0.150
SAR= 1.67
pH = **9.07**

SS-04@3'
07/31/18
3'
B = <0.002
T = <0.002
E = <0.002
X = <0.002
G = <0.200
D = <50.0
EC = 0.137
SAR= 0.65
pH = 8.98

SS-02@3'
07/31/18
3'
B = <0.002
T = <0.002
E = <0.002
X = <0.002
G = <0.200
D = <50.0
EC = 0.124
SAR= 0.78
pH = **9.07**

SS-09@3'
07/31/18
3'
B = <0.002
T = <0.002
E = <0.002
X = <0.002
G = <0.200
D = <50.0
EC = 0.126
SAR= 1.35
pH = 8.83

SS-07@3'
07/31/18
3'
B = <0.002
T = <0.002
E = <0.002
X = <0.002
G = <0.200
D = <50.0
EC = 0.111
SAR= 1.47
pH = 8.81

SS-11@3'
07/31/18
3'
B = <0.002
T = <0.002
E = <0.002
X = <0.002
G = <0.200
D = <50.0
EC = 0.220
SAR= 1.38
pH = 8.68

SS-12@3'
07/31/18
3'
B = <0.002
T = <0.002
E = <0.002
X = <0.002
G = <0.200
D = <50.0
EC = 0.633
SAR= 6.45
pH = 8.49

LEGEND

--- APPROXIMATE EXCAVATION BOUNDARIES

● SS-01 APPROXIMATE LOCATION OF SOIL SAMPLES SUBMITTED FOR LABORATORY ANALYSIS

● SS-01 APPROXIMATE LOCATION OF BACKGROUND SOIL SAMPLES SUBMITTED FOR LABORATORY ANALYSIS

PARAMETERS

SOIL SAMPLE LOCATION
DATE
DEPTH (FEET)
B = BENZENE (mg/kg)
T = TOLUENE (mg/kg)
E = ETHYLBENZENE (mg/kg)
X = TOTAL XYLENES (mg/kg)
N = NAPHTHALENE (mg/kg)
G = TPH-GRO (mg/kg)
D = TPH-DRO (mg/kg)
EC = SPECIFIC CONDUCTANCE (mmhos/cm)
SAR= SODIUM ADSORPTION RATIO
pH = pH (pH UNITS)

mg/kg = MILLIGRAMS PER KILOGRAM

mmhos/cm = MILLIMHOS PER CENTIMETER

TPH-GRO = TOTAL PETROLEUM HYDROCARBONS - GASOLINE RANGE ORGANICS

TPH-DRO = TOTAL PETROLEUM HYDROCARBONS - DIESEL RANGE ORGANICS

NOTE: VALUES PRESENTED WITH A LESS THAN SYMBOL (<) DID NOT CONTAIN CONCENTRATIONS AT OR ABOVE LABORATORY DETECTION LIMITS

VALUES PRESENTED IN **BOLD** TYPEFACE EXCEED COGCC TABLE 910-1 REGULATORY LIMITS FOR THE COMPOUND

COGCC - COLORADO OIL AND GAS CONSERVATION COMMISSION

0' 20'

APPROXIMATE SCALE IN FEET

SOIL ANALYTICAL MAP
KINTZ #1, 2
WATER VAULT REMOVAL
40.242650 / -105.020890
SE1/4 NE1/4 SEC.8 T3N R68W 6PM
WELD COUNTY, COLORADO
REMEDIAL # 10962

DATE: 08/13/18
DRAWN BY: or
FIG. NO. 3



EAGLE
ENVIRONMENTAL
CONSULTING, INC.
4101 INCA STREET, DENVER, CO 80211
Ph: 303-433-0479 • F: 303-325-5449

ATTACHMENT A

Laboratory Analytical Report



August 08, 2018

Eagle Environmental Consulting, Inc.

Martin C Eckert III

4101 Inca Street

Denver

CO 80211

Project Name - Kintz #1,2

Project Number - [none]

Attached are your analytical results for Kintz #1,2 received by Origins Laboratory, Inc. July 31, 2018. This project is associated with Origins project number Y808001-01.

The analytical results in the following report were analyzed under the guidelines of EPA Methods. These methods are identified as follows; "SW" are defined in SW-846, "EPA" are defined in 40CFR part 136 and "SM" are defined in the most current revision of Standard Methods For the Examination of Water and Wastewater.

The analytical results apply specifically to the samples and analyses specified per the attached Chain of Custody. As such, this report shall not be reproduced except in full, without the written approval of Origin's laboratory.

Unless otherwise noted, the analytical results for all soil samples are reported on a wet weight basis. All analytical analyses were performed under NELAP guidelines unless noted by a data qualifier.

Any holding time exceedances, deviations from the method specifications or deviations from Origins Laboratory's Standard Operating Procedures are outlined in the case narrative.

Thank you for selecting Origins for your analytical needs. Please contact us with any questions concerning this report, or if we can help with anything at all.

Origins Laboratory, Inc.
303.433.1322
o-squad@oelabinc.com



1725 Elk Place, Denver, CO 80211 | Phone: 303.433.1322 | Fax: 303.265.9645

Eagle Environmental Consulting, Inc.

4101 Inca Street

Denver CO 80211

Martin C Eckert III

Project Number: [none]

Project: Kintz #1,2

CROSS REFERENCE REPORT

Sample ID	Laboratory ID	Matrix	Date Sampled	Date Received
SS-01@3'	Y808001-01	Soil	July 31, 2018 14:10	07/31/2018 16:35
SS-02@3'	Y808001-02	Soil	July 31, 2018 14:15	07/31/2018 16:35
SS-03@3'	Y808001-03	Soil	July 31, 2018 14:20	07/31/2018 16:35
SS-04@3'	Y808001-04	Soil	July 31, 2018 14:25	07/31/2018 16:35
SS-05@6'	Y808001-05	Soil	July 31, 2018 14:30	07/31/2018 16:35
SS-06@3'	Y808001-06	Soil	July 31, 2018 14:55	07/31/2018 16:35
SS-07@3'	Y808001-07	Soil	July 31, 2018 15:00	07/31/2018 16:35
SS-08@3'	Y808001-08	Soil	July 31, 2018 15:05	07/31/2018 16:35
SS-09@3'	Y808001-09	Soil	July 31, 2018 15:10	07/31/2018 16:35
SS-10@6'	Y808001-10	Soil	July 31, 2018 15:15	07/31/2018 16:35
SS-11@3'	Y808001-11	Soil	July 31, 2018 15:20	07/31/2018 16:35
SS-12@3'	Y808001-12	Soil	July 31, 2018 15:25	07/31/2018 16:35
SS-13@3'	Y808001-13	Soil	July 31, 2018 15:30	07/31/2018 16:35

Origins Laboratory, Inc.



The results in this report apply to the samples analyzed in accordance with the chain of custody document. This analytical report must be reproduced in its entirety.

Eagle Environmental Consulting, Inc.
4101 Inca Street
Denver CO 80211

Martin C Eckert III
Project Number: [none]
Project: Kintz #1,2

198001

page 1 of 2

Client: EAGLE ENV CONSULT
Address: 4101 INCA ST
Telephone Number: 303 433 0479
Email Address: NICK@eagle-enviro.com

Project Manager: MARTIN ECKERT III
Project Name: KINTZ #1,2
Project Number: 198001
Samples Collected By: ME

Fax: 303.265.9645 | Phone: 303.433.1322 | Denver, CO 80211 | 1725 Elk Place

Sample ID Description	Date Sampled	Time Sampled	# of Containers	Preservative				Matrix			Analysis			Sample Instructions
				Unpreserved	HCl	HNO ₃	Other	Groundwater	Soil	Air Summa	Other	GC/MS	DE	
SS-01 (S)	7/31/18	1410	2	X					X					1
SS-02 (S)		1415												2
SS-03 (S)		1420												3
SS-04 (S)		1425												4
SS-05 (S)		1430												5
SS-06 (S)		1455												6
SS-07 (S)		1500												7
SS-08 (S)		1505												8
SS-09 (S)		1510												9
SS-10 (S)		1515												10
Relinquished By: <u>[Signature]</u>	Date: <u>7/31/18</u>	Time: <u>1635</u>	Received By: <u>[Signature]</u>	Date: <u>7/31/18</u>	Time: <u>1635</u>	Turnaround Time: <input checked="" type="checkbox"/> Same Day <input type="checkbox"/> 24 Hr <input type="checkbox"/> 48 Hr <input checked="" type="checkbox"/> 72 Hr			Standard <input checked="" type="checkbox"/>					

REPORT TO: MARGO, ROBERT, ANDREW, ALEX Temp Received: 2.3 Date Results Needed

Origins Laboratory, Inc.

Jefe Pellegrini

The results in this report apply to the samples analyzed in accordance with the chain of custody document. This analytical report must be reproduced in its entirety.

Eagle Environmental Consulting, Inc.
4101 Inca Street
Denver CO 80211

Martin C Eckert III
Project Number: [none]
Project: Kintz #1,2

ORIGINS
LABORATORY, INC

www.originslaboratory.com

Y400001

page 2 of 2

Client: EAGLE ENV CONSULTING
Address: 4101 INCA ST
PO BOX 10
Telephone Number: 303 433 0479
Email Address: MCE3@eagle-env.com

Project Manager: MARTIN ECKERT III
Project Name: KINTZ #1,2
Project Number: 9
Samples Collected By: AK

Sample ID Description	Date Sampled	Time Sampled	# of Containers	Preservative				Matrix			Analysis	Sample Instructions
				Unpreserved	HCl	HNO ₃	Other	Groundwater	Soil	Air Summa #		
SS-1103	7/31/18	1520	2	X				X			GRITEX DGL DGL DGL DGL	1
SS-1203	↓	1535	↓								X X X X	2
SS-1503	↓	1530	↓								X X X X	3
												4
												5
												6
												7
												8
												9
												10

Relinquished By:	Date:	Time:	Received By:	Date:	Time:	Turnaround Time:
<u>[Signature]</u>	7/31/18	1635	<u>[Signature]</u>	7/31/18	1635	Same Day <input checked="" type="checkbox"/> 24 Hr <input type="checkbox"/>
Relinquished By:	Date:	Time:	Received By:	Date:	Time:	48 Hr <input type="checkbox"/> 72 Hr <input type="checkbox"/> Standard <input checked="" type="checkbox"/>

Refer to: MARTIN, ROBERT, ALEX Temp Received: 2.3 Date Results Needed

1725 Elk Place | Denver, CO 80211 | Phone: 303.433.1322 | Fax: 303.265.9645

Origins Laboratory, Inc.

Jefe Pellegrini

The results in this report apply to the samples analyzed in accordance with the chain of custody document. This analytical report must be reproduced in its entirety.

Eagle Environmental Consulting, Inc.
4101 Inca Street
Denver CO 80211

Martin C Eckert III
Project Number: [none]
Project: Kintz #1,2

Origins Laboratory

F-012207-01-R1
Effective Date: 01/09/12

Sample Receipt Checklist

Origins Work Order: Y80001

Client: Eagle

Client Project ID: Noelle - Kintz 1, 2

Checklist Completed by: JG

Shipped Via: HD

(UPS, FedEx, Hand Delivered, Pick-up, etc.)

Date/time completed: 8/01/2018

Airbill #: N/A

Matrix(s) Received: (Check all that apply): ☒ Soil/Solid ☐ Water ☐ Other: _____

Cooler Number/Temperature: 1 / 2.3 °C _____ / _____ °C _____ / _____ °C (Describe)

Thermometer ID: T003

Requirement Description	Yes	No	N/A	Comments (if any)
If samples require cooling, was the temperature between 0°C to ≤ 6°C ⁽¹⁾ ?	<input checked="" type="checkbox"/>	<input type="checkbox"/>	<input type="checkbox"/>	
Is there ice present (document if blue ice is used)	<input checked="" type="checkbox"/>	<input type="checkbox"/>	<input type="checkbox"/>	
Are custody seals present on cooler? (if so, document in comments if they are signed and dated, broken or intact)	<input checked="" type="checkbox"/>	<input checked="" type="checkbox"/>	<input type="checkbox"/>	
Are custody seals present on each sample container? (if so, document in comments if they are signed and dated, broken or intact)	<input checked="" type="checkbox"/>	<input checked="" type="checkbox"/>	<input type="checkbox"/>	
Were all samples received intact ⁽¹⁾ ?	<input checked="" type="checkbox"/>	<input type="checkbox"/>	<input type="checkbox"/>	
Was adequate sample volume provided ⁽¹⁾ ?	<input checked="" type="checkbox"/>	<input type="checkbox"/>	<input type="checkbox"/>	
Are short holding time analytes or samples with HTs due within 48 hours present ⁽¹⁾ ?	<input checked="" type="checkbox"/>	<input checked="" type="checkbox"/>	<input type="checkbox"/>	
Is a chain-of-custody (COC) present and filled out completely ⁽¹⁾ ?	<input checked="" type="checkbox"/>	<input checked="" type="checkbox"/>	<input type="checkbox"/>	
Does the COC agree with the number and type of sample bottles received ⁽¹⁾ ?	<input checked="" type="checkbox"/>	<input checked="" type="checkbox"/>	<input type="checkbox"/>	
Do the sample IDs on the bottle labels match the COC ⁽¹⁾ ?	<input checked="" type="checkbox"/>	<input checked="" type="checkbox"/>	<input type="checkbox"/>	
Is the COC properly relinquished by the client with date and time recorded ⁽¹⁾ ?	<input checked="" type="checkbox"/>	<input checked="" type="checkbox"/>	<input type="checkbox"/>	
For volatiles in water — is there headspace (> ¼ inch bubble) present? If yes, contact client and note in narrative.	<input type="checkbox"/>	<input checked="" type="checkbox"/>	<input type="checkbox"/>	
Are samples preserved that require preservation and was it checked ⁽¹⁾ ? (note ID of confirmation instrument used in comments) / (preservation is not confirmed for subcontracted analyses in order to insure sample integrity) / (pH < 2 for samples preserved with HNO ₃ , HCL, H ₂ SO ₄) / (pH > 10 for samples preserved with NaAsO ₂ +NaOH, ZnAc+NaOH)	<input type="checkbox"/>	<input checked="" type="checkbox"/>	<input type="checkbox"/>	
Additional Comments (if any):				

⁽¹⁾If NO, then contact the client before proceeding with analysis and note date/time and person contacted as well as the corrective action to in the additional comments (above) and the case narrative.

Reviewed by (Project Manager) JP

Date/Time Reviewed 8/2/18

Origins Laboratory, Inc.

Jefe Pellegrini

The results in this report apply to the samples analyzed in accordance with the chain of custody document. This analytical report must be reproduced in its entirety.

Eagle Environmental Consulting, Inc.
4101 Inca Street
Denver CO 80211

Martin C Eckert III
Project Number: [none]
Project: Kintz #1,2

SS-01@3'

7/31/2018 2:10:00PM

Analyte	Result	Reporting Limit	Units	Dilution	Batch	Analyst	Prepared	Analyzed	Notes
---------	--------	-----------------	-------	----------	-------	---------	----------	----------	-------

Origins Laboratory, Inc.
Y808001-01 (Soil)

Diesel Range Organics (DRO/TEPH) by EPA 8015C

Diesel (C10-C28)	ND	50.0	mg/kg	1	B8H0106	JTD	08/01/2018	08/02/2018	U
------------------	----	------	-------	---	---------	-----	------------	------------	---

Surrogate: o-Terphenyl	70.2 %	59-131			"	"	"		
------------------------	--------	--------	--	--	---	---	---	--	--

GBTEX by EPA 8260C

Gasoline Range Hydrocarbons	ND	0.200	mg/kg	1	B8H0105	JTD	08/01/2018	08/01/2018	U
Benzene	ND	0.002	"	"	"	JTD	"	"	U
Toluene	ND	0.002	"	"	"	JTD	"	"	U
Ethylbenzene	ND	0.002	"	"	"	JTD	"	"	U
Xylenes, total	ND	0.002	"	"	"	JTD	"	"	U

Surrogate: 1,2-Dichloroethane-d4	111 %	70-130			"	"	"		
Surrogate: Toluene-d8	98.9 %	70-130			"	"	"		
Surrogate: 4-Bromofluorobenzene	94.7 %	70-130			"	"	"		

Metals (Saturated Paste Prep)

Calcium	2.02	me/L	1	'[none]'		08/02/2018	08/07/2018
Magnesium	1.65	"	"	"		"	"
Sodium	3.13	"	"	"		"	"

pH in Soil by EPA 9045D

pH	8.99	pH Units	1	B8H0109	OLAB	08/01/2018	08/01/2018
----	------	----------	---	---------	------	------------	------------

Origins Laboratory, Inc.



The results in this report apply to the samples analyzed in accordance with the chain of custody document. This analytical report must be reproduced in its entirety.

Eagle Environmental Consulting, Inc.
4101 Inca Street
Denver CO 80211

Martin C Eckert III
Project Number: [none]
Project: Kintz #1,2

SS-01@3'

7/31/2018 2:10:00PM

Analyte	Result	Reporting	Units	Dilution	Batch	Analyst	Prepared	Analyzed	Notes
		Limit							

Origins Laboratory, Inc.
Y808001-01 (Soil)

SAR by 20B Saturated Paste

SAR	2.31		1		'[none]'		08/02/2018	08/07/2018	
-----	------	--	---	--	----------	--	------------	------------	--

Specific Conductance by Modified 9050A

Specific Conductance (EC)	0.215	0.00500	mmhos/cm	1	B8H0110	OLAB	08/01/2018	08/01/2018	
---------------------------	-------	---------	----------	---	---------	------	------------	------------	--

Origins Laboratory, Inc.



The results in this report apply to the samples analyzed in accordance with the chain of custody document. This analytical report must be reproduced in its entirety.

Eagle Environmental Consulting, Inc.
4101 Inca Street
Denver CO 80211

Martin C Eckert III
Project Number: [none]
Project: Kintz #1,2

SS-02@3'

7/31/2018 2:15:00PM

Analyte	Result	Reporting Limit	Units	Dilution	Batch	Analyst	Prepared	Analyzed	Notes
---------	--------	-----------------	-------	----------	-------	---------	----------	----------	-------

Origins Laboratory, Inc.
Y808001-02 (Soil)

Diesel Range Organics (DRO/TEPH) by EPA 8015C

Diesel (C10-C28)	ND	50.0	mg/kg	1	B8H0106	JMH	08/01/2018	08/02/2018	U
------------------	----	------	-------	---	---------	-----	------------	------------	---

Surrogate: o-Terphenyl	71.2 %	59-131			"	"	"		
------------------------	--------	--------	--	--	---	---	---	--	--

GBTEX by EPA 8260C

Gasoline Range Hydrocarbons	ND	0.200	mg/kg	1	B8H0105	ZZZ	08/01/2018	08/02/2018	U
Benzene	ND	0.002	"	"	"	ZZZ	"	"	U
Toluene	ND	0.002	"	"	"	ZZZ	"	"	U
Ethylbenzene	ND	0.002	"	"	"	ZZZ	"	"	U
Xylenes, total	ND	0.002	"	"	"	ZZZ	"	"	U

Surrogate: 1,2-Dichloroethane-d4	111 %	70-130			"	"	"		
Surrogate: Toluene-d8	99.1 %	70-130			"	"	"		
Surrogate: 4-Bromofluorobenzene	95.0 %	70-130			"	"	"		

Metals (Saturated Paste Prep)

Calcium	1.13	me/L	1	'[none]'		08/02/2018	08/07/2018		
Magnesium	0.80	"	"	"		"	"		
Sodium	0.77	"	"	"		"	"		

pH in Soil by EPA 9045D

pH	9.07	pH Units	1	B8H0109	JTD	08/01/2018	08/01/2018		
----	------	----------	---	---------	-----	------------	------------	--	--

Origins Laboratory, Inc.



The results in this report apply to the samples analyzed in accordance with the chain of custody document. This analytical report must be reproduced in its entirety.

Eagle Environmental Consulting, Inc.

4101 Inca Street

Denver CO 80211

Martin C Eckert III

Project Number: [none]

Project: Kintz #1,2

SS-02@3'

7/31/2018 2:15:00PM

Analyte	Result	Reporting	Units	Dilution	Batch	Analyst	Prepared	Analyzed	Notes
		Limit							

Origins Laboratory, Inc.

Y808001-02 (Soil)

SAR by 20B Saturated Paste

SAR	0.78		1		'[none]'		08/02/2018	08/07/2018	
-----	------	--	---	--	----------	--	------------	------------	--

Specific Conductance by Modified 9050A

Specific Conductance (EC)	0.124	0.00509	mmhos/cm	1	B8H0110	JTD	08/01/2018	08/01/2018	
---------------------------	-------	---------	----------	---	---------	-----	------------	------------	--

Origins Laboratory, Inc.



The results in this report apply to the samples analyzed in accordance with the chain of custody document. This analytical report must be reproduced in its entirety.

Eagle Environmental Consulting, Inc.
4101 Inca Street
Denver CO 80211

Martin C Eckert III
Project Number: [none]
Project: Kintz #1,2

SS-03@3'

7/31/2018 2:20:00PM

Analyte	Result	Reporting Limit	Units	Dilution	Batch	Analyst	Prepared	Analyzed	Notes
---------	--------	-----------------	-------	----------	-------	---------	----------	----------	-------

Origins Laboratory, Inc.
Y808001-03 (Soil)

Diesel Range Organics (DRO/TEPH) by EPA 8015C

Diesel (C10-C28)	ND	50.0	mg/kg	1	B8H0106	JMH	08/01/2018	08/02/2018	U
------------------	----	------	-------	---	---------	-----	------------	------------	---

Surrogate: o-Terphenyl	70.9 %	59-131			"	"	"		
------------------------	--------	--------	--	--	---	---	---	--	--

GBTEX by EPA 8260C

Gasoline Range Hydrocarbons	ND	0.200	mg/kg	1	B8H0105	ZZZ	08/01/2018	08/02/2018	U
Benzene	ND	0.002	"	"	"	ZZZ	"	"	U
Toluene	ND	0.002	"	"	"	ZZZ	"	"	U
Ethylbenzene	ND	0.002	"	"	"	ZZZ	"	"	U
Xylenes, total	ND	0.002	"	"	"	ZZZ	"	"	U

Surrogate: 1,2-Dichloroethane-d4	111 %	70-130			"	"	"		
Surrogate: Toluene-d8	99.6 %	70-130			"	"	"		
Surrogate: 4-Bromofluorobenzene	95.6 %	70-130			"	"	"		

Metals (Saturated Paste Prep)

Calcium	1.27	me/L	1	'[none]'		08/02/2018	08/07/2018
Magnesium	0.98	"	"	"		"	"
Sodium	3.73	"	"	"		"	"

pH in Soil by EPA 9045D

pH	9.26	pH Units	1	B8H0109	OLAB	08/01/2018	08/01/2018
----	------	----------	---	---------	------	------------	------------

Origins Laboratory, Inc.



The results in this report apply to the samples analyzed in accordance with the chain of custody document. This analytical report must be reproduced in its entirety.

Eagle Environmental Consulting, Inc.
4101 Inca Street
Denver CO 80211

Martin C Eckert III
Project Number: [none]
Project: Kintz #1,2

SS-03@3'

7/31/2018 2:20:00PM

Analyte	Result	Reporting Limit	Units	Dilution	Batch	Analyst	Prepared	Analyzed	Notes
---------	--------	--------------------	-------	----------	-------	---------	----------	----------	-------

Origins Laboratory, Inc.
Y808001-03 (Soil)

SAR by 20B Saturated Paste

SAR	3.52			1	'[none]'		08/02/2018	08/07/2018	
-----	------	--	--	---	----------	--	------------	------------	--

Specific Conductance by Modified 9050A

Specific Conductance (EC)	0.221	0.00501	mmhos/cm	1	B8H0110	OLAB	08/01/2018	08/01/2018	
---------------------------	-------	---------	----------	---	---------	------	------------	------------	--

Origins Laboratory, Inc.



The results in this report apply to the samples analyzed in accordance with the chain of custody document. This analytical report must be reproduced in its entirety.

Eagle Environmental Consulting, Inc.
4101 Inca Street
Denver CO 80211

Martin C Eckert III
Project Number: [none]
Project: Kintz #1,2

SS-04@3'

7/31/2018 2:25:00PM

Analyte	Result	Reporting Limit	Units	Dilution	Batch	Analyst	Prepared	Analyzed	Notes
---------	--------	-----------------	-------	----------	-------	---------	----------	----------	-------

Origins Laboratory, Inc.
Y808001-04 (Soil)

Diesel Range Organics (DRO/TEPH) by EPA 8015C

Diesel (C10-C28)	ND	50.0	mg/kg	1	B8H0106	JMH	08/01/2018	08/02/2018	U
------------------	----	------	-------	---	---------	-----	------------	------------	---

Surrogate: o-Terphenyl	68.2 %	59-131			"	"	"		
------------------------	--------	--------	--	--	---	---	---	--	--

GBTEX by EPA 8260C

Gasoline Range Hydrocarbons	ND	0.200	mg/kg	1	B8H0105	ZZZ	08/01/2018	08/02/2018	U
Benzene	ND	0.002	"	"	"	ZZZ	"	"	U
Toluene	ND	0.002	"	"	"	ZZZ	"	"	U
Ethylbenzene	ND	0.002	"	"	"	ZZZ	"	"	U
Xylenes, total	ND	0.002	"	"	"	ZZZ	"	"	U

Surrogate: 1,2-Dichloroethane-d4	109 %	70-130			"	"	"		
Surrogate: Toluene-d8	100 %	70-130			"	"	"		
Surrogate: 4-Bromofluorobenzene	96.0 %	70-130			"	"	"		

Metals (Saturated Paste Prep)

Calcium	1.22	me/L	1		'[none]'		08/02/2018	08/07/2018	
Magnesium	0.93	"	"		"		"	"	
Sodium	0.67	"	"		"		"	"	

pH in Soil by EPA 9045D

pH	8.98	pH Units	1		B8H0109	OLAB	08/01/2018	08/01/2018	
----	------	----------	---	--	---------	------	------------	------------	--

Origins Laboratory, Inc.



The results in this report apply to the samples analyzed in accordance with the chain of custody document. This analytical report must be reproduced in its entirety.

Eagle Environmental Consulting, Inc.
4101 Inca Street
Denver CO 80211

Martin C Eckert III
Project Number: [none]
Project: Kintz #1,2

SS-04@3'

7/31/2018 2:25:00PM

Analyte	Result	Reporting Limit	Units	Dilution	Batch	Analyst	Prepared	Analyzed	Notes
---------	--------	--------------------	-------	----------	-------	---------	----------	----------	-------

Origins Laboratory, Inc.
Y808001-04 (Soil)

SAR by 20B Saturated Paste

SAR	0.65			1	'[none]'		08/02/2018	08/07/2018	
-----	------	--	--	---	----------	--	------------	------------	--

Specific Conductance by Modified 9050A

Specific Conductance (EC)	0.137	0.00500	mmhos/cm	1	B8H0110	OLAB	08/01/2018	08/01/2018	
---------------------------	-------	---------	----------	---	---------	------	------------	------------	--

Origins Laboratory, Inc.



The results in this report apply to the samples analyzed in accordance with the chain of custody document. This analytical report must be reproduced in its entirety.

Eagle Environmental Consulting, Inc.
4101 Inca Street
Denver CO 80211

Martin C Eckert III
Project Number: [none]
Project: Kintz #1,2

SS-05@6'

7/31/2018 2:30:00PM

Analyte	Result	Reporting Limit	Units	Dilution	Batch	Analyst	Prepared	Analyzed	Notes
---------	--------	-----------------	-------	----------	-------	---------	----------	----------	-------

Origins Laboratory, Inc.
Y808001-05 (Soil)

Diesel Range Organics (DRO/TEPH) by EPA 8015C

Diesel (C10-C28)	ND	50.0	mg/kg	1	B8H0106	JMH	08/01/2018	08/02/2018	U
------------------	----	------	-------	---	---------	-----	------------	------------	---

Surrogate: o-Terphenyl	67.5 %	59-131			"	"	"		
------------------------	--------	--------	--	--	---	---	---	--	--

GBTEX by EPA 8260C

Gasoline Range Hydrocarbons	ND	0.200	mg/kg	1	B8H0105	ZZZ	08/01/2018	08/02/2018	U
Benzene	ND	0.002	"	"	"	ZZZ	"	"	U
Toluene	ND	0.002	"	"	"	ZZZ	"	"	U
Ethylbenzene	ND	0.002	"	"	"	ZZZ	"	"	U
Xylenes, total	ND	0.002	"	"	"	ZZZ	"	"	U

Surrogate: 1,2-Dichloroethane-d4	113 %	70-130			"	"	"		
Surrogate: Toluene-d8	99.1 %	70-130			"	"	"		
Surrogate: 4-Bromofluorobenzene	95.4 %	70-130			"	"	"		

Metals (Saturated Paste Prep)

Calcium	1.20	me/L	1	'[none]'		08/02/2018	08/07/2018
Magnesium	1.02	"	"	"		"	"
Sodium	1.76	"	"	"		"	"

pH in Soil by EPA 9045D

pH	9.07	pH Units	1	B8H0109	OLAB	08/01/2018	08/01/2018
----	------	----------	---	---------	------	------------	------------

Origins Laboratory, Inc.



The results in this report apply to the samples analyzed in accordance with the chain of custody document. This analytical report must be reproduced in its entirety.

Eagle Environmental Consulting, Inc.
4101 Inca Street
Denver CO 80211

Martin C Eckert III
Project Number: [none]
Project: Kintz #1,2

SS-05@6'

7/31/2018 2:30:00PM

Analyte	Result	Reporting		Units	Dilution	Batch	Analyst	Prepared	Analyzed	Notes
		Limit								

Origins Laboratory, Inc.
Y808001-05 (Soil)

SAR by 20B Saturated Paste

SAR	1.67			1		'[none]'		08/02/2018	08/07/2018	
-----	------	--	--	---	--	----------	--	------------	------------	--

Specific Conductance by Modified 9050A

Specific Conductance (EC)	0.150	0.00500	mmhos/cm	1		B8H0110	OLAB	08/01/2018	08/01/2018	
---------------------------	-------	---------	----------	---	--	---------	------	------------	------------	--

Origins Laboratory, Inc.



The results in this report apply to the samples analyzed in accordance with the chain of custody document. This analytical report must be reproduced in its entirety.

Eagle Environmental Consulting, Inc.
4101 Inca Street
Denver CO 80211

Martin C Eckert III
Project Number: [none]
Project: Kintz #1,2

SS-06@3'

7/31/2018 2:55:00PM

Analyte	Result	Reporting Limit	Units	Dilution	Batch	Analyst	Prepared	Analyzed	Notes
---------	--------	-----------------	-------	----------	-------	---------	----------	----------	-------

Origins Laboratory, Inc.
Y808001-06 (Soil)

Diesel Range Organics (DRO/TEPH) by EPA 8015C

Diesel (C10-C28)	ND	50.0	mg/kg	1	B8H0106	JMH	08/01/2018	08/02/2018	U
------------------	----	------	-------	---	---------	-----	------------	------------	---

Surrogate: o-Terphenyl	75.7 %	59-131			"	"	"		
------------------------	--------	--------	--	--	---	---	---	--	--

GBTEX by EPA 8260C

Gasoline Range Hydrocarbons	ND	0.200	mg/kg	1	B8H0105	ZZZ	08/01/2018	08/02/2018	U
Benzene	ND	0.002	"	"	"	ZZZ	"	"	U
Toluene	ND	0.002	"	"	"	ZZZ	"	"	U
Ethylbenzene	ND	0.002	"	"	"	ZZZ	"	"	U
Xylenes, total	ND	0.002	"	"	"	ZZZ	"	"	U

Surrogate: 1,2-Dichloroethane-d4	112 %	70-130			"	"	"		
Surrogate: Toluene-d8	100 %	70-130			"	"	"		
Surrogate: 4-Bromofluorobenzene	96.2 %	70-130			"	"	"		

Metals (Saturated Paste Prep)

Calcium	1.04	me/L	1		'[none]'		08/02/2018	08/07/2018	
Magnesium	0.75	"	"		"		"	"	
Sodium	0.67	"	"		"		"	"	

pH in Soil by EPA 9045D

pH	9.09	pH Units	1		B8H0109	OLAB	08/01/2018	08/01/2018	
----	------	----------	---	--	---------	------	------------	------------	--

Origins Laboratory, Inc.



The results in this report apply to the samples analyzed in accordance with the chain of custody document. This analytical report must be reproduced in its entirety.

Eagle Environmental Consulting, Inc.
4101 Inca Street
Denver CO 80211

Martin C Eckert III
Project Number: [none]
Project: Kintz #1,2

SS-06@3'

7/31/2018 2:55:00PM

Analyte	Result	Reporting	Units	Dilution	Batch	Analyst	Prepared	Analyzed	Notes
		Limit							

Origins Laboratory, Inc.
Y808001-06 (Soil)

SAR by 20B Saturated Paste

SAR	0.71		1		'[none]'		08/02/2018	08/07/2018	
-----	------	--	---	--	----------	--	------------	------------	--

Specific Conductance by Modified 9050A

Specific Conductance (EC)	0.167	0.00500	mmhos/cm	1	B8H0110	OLAB	08/01/2018	08/01/2018	
---------------------------	-------	---------	----------	---	---------	------	------------	------------	--

Origins Laboratory, Inc.



The results in this report apply to the samples analyzed in accordance with the chain of custody document. This analytical report must be reproduced in its entirety.

Eagle Environmental Consulting, Inc.
4101 Inca Street
Denver CO 80211

Martin C Eckert III
Project Number: [none]
Project: Kintz #1,2

SS-07@3'

7/31/2018 3:00:00PM

Analyte	Result	Reporting Limit	Units	Dilution	Batch	Analyst	Prepared	Analyzed	Notes
---------	--------	-----------------	-------	----------	-------	---------	----------	----------	-------

Origins Laboratory, Inc.
Y808001-07 (Soil)

Diesel Range Organics (DRO/TEPH) by EPA 8015C

Diesel (C10-C28)	ND	50.0	mg/kg	1	B8H0106	JMH	08/01/2018	08/02/2018	U
------------------	----	------	-------	---	---------	-----	------------	------------	---

Surrogate: o-Terphenyl	66.6 %	59-131			"	"	"		
------------------------	--------	--------	--	--	---	---	---	--	--

GBTEX by EPA 8260C

Gasoline Range Hydrocarbons	ND	0.200	mg/kg	1	B8H0105	ZZZ	08/01/2018	08/02/2018	U
Benzene	ND	0.002	"	"	"	ZZZ	"	"	U
Toluene	ND	0.002	"	"	"	ZZZ	"	"	U
Ethylbenzene	ND	0.002	"	"	"	ZZZ	"	"	U
Xylenes, total	ND	0.002	"	"	"	ZZZ	"	"	U

Surrogate: 1,2-Dichloroethane-d4	114 %	70-130			"	"	"		
Surrogate: Toluene-d8	99.8 %	70-130			"	"	"		
Surrogate: 4-Bromofluorobenzene	96.8 %	70-130			"	"	"		

Metals (Saturated Paste Prep)

Calcium	0.87	me/L	1		'[none]'		08/02/2018	08/07/2018	
Magnesium	0.57	"	"		"		"	"	
Sodium	1.25	"	"		"		"	"	

pH in Soil by EPA 9045D

pH	8.81	pH Units	1		B8H0109	OLAB	08/01/2018	08/01/2018	
----	------	----------	---	--	---------	------	------------	------------	--

Origins Laboratory, Inc.



The results in this report apply to the samples analyzed in accordance with the chain of custody document. This analytical report must be reproduced in its entirety.

Eagle Environmental Consulting, Inc.
4101 Inca Street
Denver CO 80211

Martin C Eckert III
Project Number: [none]
Project: Kintz #1,2

SS-07@3'

7/31/2018 3:00:00PM

Analyte	Result	Reporting Limit	Units	Dilution	Batch	Analyst	Prepared	Analyzed	Notes
---------	--------	--------------------	-------	----------	-------	---------	----------	----------	-------

Origins Laboratory, Inc.
Y808001-07 (Soil)

SAR by 20B Saturated Paste

SAR	1.47			1	'[none]'		08/02/2018	08/07/2018	
-----	------	--	--	---	----------	--	------------	------------	--

Specific Conductance by Modified 9050A

Specific Conductance (EC)	0.111	0.00502	mmhos/cm	1	B8H0110	OLAB	08/01/2018	08/01/2018	
---------------------------	-------	---------	----------	---	---------	------	------------	------------	--

Origins Laboratory, Inc.



The results in this report apply to the samples analyzed in accordance with the chain of custody document. This analytical report must be reproduced in its entirety.

Eagle Environmental Consulting, Inc.
4101 Inca Street
Denver CO 80211

Martin C Eckert III
Project Number: [none]
Project: Kintz #1,2

SS-08@3'

7/31/2018 3:05:00PM

Analyte	Result	Reporting Limit	Units	Dilution	Batch	Analyst	Prepared	Analyzed	Notes
---------	--------	-----------------	-------	----------	-------	---------	----------	----------	-------

Origins Laboratory, Inc.
Y808001-08 (Soil)

Diesel Range Organics (DRO/TEPH) by EPA 8015C

Diesel (C10-C28)	ND	50.0	mg/kg	1	B8H0106	JMH	08/01/2018	08/02/2018	U
------------------	----	------	-------	---	---------	-----	------------	------------	---

Surrogate: o-Terphenyl	65.9 %	59-131			"	"	"		
------------------------	--------	--------	--	--	---	---	---	--	--

GBTEX by EPA 8260C

Gasoline Range Hydrocarbons	ND	0.200	mg/kg	1	B8H0105	ZZZ	08/01/2018	08/02/2018	U
Benzene	ND	0.002	"	"	"	ZZZ	"	"	U
Toluene	ND	0.002	"	"	"	ZZZ	"	"	U
Ethylbenzene	ND	0.002	"	"	"	ZZZ	"	"	U
Xylenes, total	ND	0.002	"	"	"	ZZZ	"	"	U

Surrogate: 1,2-Dichloroethane-d4	117 %	70-130			"	"	"		
Surrogate: Toluene-d8	99.0 %	70-130			"	"	"		
Surrogate: 4-Bromofluorobenzene	97.4 %	70-130			"	"	"		

Metals (Saturated Paste Prep)

Calcium	1.49	me/L	1		'[none]'		08/02/2018	08/07/2018	
Magnesium	0.63	"	"		"		"	"	
Sodium	0.35	"	"		"		"	"	

pH in Soil by EPA 9045D

pH	9.07	pH Units	1		B8H0109	OLAB	08/01/2018	08/01/2018	
----	------	----------	---	--	---------	------	------------	------------	--

Origins Laboratory, Inc.



The results in this report apply to the samples analyzed in accordance with the chain of custody document. This analytical report must be reproduced in its entirety.

Eagle Environmental Consulting, Inc.
4101 Inca Street
Denver CO 80211

Martin C Eckert III
Project Number: [none]
Project: Kintz #1,2

SS-08@3'

7/31/2018 3:05:00PM

Analyte	Result	Reporting Limit	Units	Dilution	Batch	Analyst	Prepared	Analyzed	Notes
---------	--------	--------------------	-------	----------	-------	---------	----------	----------	-------

Origins Laboratory, Inc.
Y808001-08 (Soil)

SAR by 20B Saturated Paste

SAR	0.34			1	'[none]'		08/02/2018	08/07/2018	
-----	------	--	--	---	----------	--	------------	------------	--

Specific Conductance by Modified 9050A

Specific Conductance (EC)	0.0704	0.00500	mmhos/cm	1	B8H0110	OLAB	08/01/2018	08/01/2018	
---------------------------	--------	---------	----------	---	---------	------	------------	------------	--

Origins Laboratory, Inc.



The results in this report apply to the samples analyzed in accordance with the chain of custody document. This analytical report must be reproduced in its entirety.

Eagle Environmental Consulting, Inc.
4101 Inca Street
Denver CO 80211

Martin C Eckert III
Project Number: [none]
Project: Kintz #1,2

SS-09@3'

7/31/2018 3:10:00PM

Analyte	Result	Reporting Limit	Units	Dilution	Batch	Analyst	Prepared	Analyzed	Notes
---------	--------	-----------------	-------	----------	-------	---------	----------	----------	-------

Origins Laboratory, Inc.
Y808001-09 (Soil)

Diesel Range Organics (DRO/TEPH) by EPA 8015C

Diesel (C10-C28)	ND	50.0	mg/kg	1	B8H0106	JMH	08/01/2018	08/02/2018	U
------------------	----	------	-------	---	---------	-----	------------	------------	---

Surrogate: o-Terphenyl	67.4 %	59-131			"	"	"		
------------------------	--------	--------	--	--	---	---	---	--	--

GBTEX by EPA 8260C

Gasoline Range Hydrocarbons	ND	0.200	mg/kg	1	B8H0105	ZZZ	08/01/2018	08/02/2018	U
Benzene	ND	0.002	"	"	"	ZZZ	"	"	U
Toluene	ND	0.002	"	"	"	ZZZ	"	"	U
Ethylbenzene	ND	0.002	"	"	"	ZZZ	"	"	U
Xylenes, total	ND	0.002	"	"	"	ZZZ	"	"	U

Surrogate: 1,2-Dichloroethane-d4	104 %	70-130			"	"	"		
Surrogate: Toluene-d8	102 %	70-130			"	"	"		
Surrogate: 4-Bromofluorobenzene	101 %	70-130			"	"	"		

Metals (Saturated Paste Prep)

Calcium	0.96	me/L	1	'[none]'		08/02/2018	08/07/2018		
Magnesium	0.75	"	"	"		"	"		
Sodium	1.25	"	"	"		"	"		

pH in Soil by EPA 9045D

pH	8.83	pH Units	1	B8H0109	OLAB	08/01/2018	08/01/2018		
----	------	----------	---	---------	------	------------	------------	--	--

Origins Laboratory, Inc.



The results in this report apply to the samples analyzed in accordance with the chain of custody document. This analytical report must be reproduced in its entirety.

Eagle Environmental Consulting, Inc.
4101 Inca Street
Denver CO 80211

Martin C Eckert III
Project Number: [none]
Project: Kintz #1,2

SS-09@3'

7/31/2018 3:10:00PM

Analyte	Result	Reporting Limit	Units	Dilution	Batch	Analyst	Prepared	Analyzed	Notes
---------	--------	--------------------	-------	----------	-------	---------	----------	----------	-------

Origins Laboratory, Inc.
Y808001-09 (Soil)

SAR by 20B Saturated Paste

SAR	1.35			1	'[none]'		08/02/2018	08/07/2018	
-----	------	--	--	---	----------	--	------------	------------	--

Specific Conductance by Modified 9050A

Specific Conductance (EC)	0.126	0.00501	mmhos/cm	1	B8H0110	OLAB	08/01/2018	08/01/2018	
---------------------------	-------	---------	----------	---	---------	------	------------	------------	--

Origins Laboratory, Inc.



The results in this report apply to the samples analyzed in accordance with the chain of custody document. This analytical report must be reproduced in its entirety.

Eagle Environmental Consulting, Inc.
4101 Inca Street
Denver CO 80211

Martin C Eckert III
Project Number: [none]
Project: Kintz #1,2

SS-10@6'

7/31/2018 3:15:00PM

Analyte	Result	Reporting Limit	Units	Dilution	Batch	Analyst	Prepared	Analyzed	Notes
---------	--------	-----------------	-------	----------	-------	---------	----------	----------	-------

Origins Laboratory, Inc.
Y808001-10 (Soil)

Diesel Range Organics (DRO/TEPH) by EPA 8015C

Diesel (C10-C28)	ND	50.0	mg/kg	1	B8H0106	JMH	08/01/2018	08/02/2018	U
------------------	----	------	-------	---	---------	-----	------------	------------	---

Surrogate: o-Terphenyl	73.2 %	59-131			"	"	"		
------------------------	--------	--------	--	--	---	---	---	--	--

GBTEX by EPA 8260C

Gasoline Range Hydrocarbons	ND	0.200	mg/kg	1	B8H0105	ZZZ	08/01/2018	08/02/2018	U
Benzene	ND	0.002	"	"	"	ZZZ	"	"	U
Toluene	ND	0.002	"	"	"	ZZZ	"	"	U
Ethylbenzene	ND	0.002	"	"	"	ZZZ	"	"	U
Xylenes, total	ND	0.002	"	"	"	ZZZ	"	"	U

Surrogate: 1,2-Dichloroethane-d4	109 %	70-130			"	"	"		
Surrogate: Toluene-d8	102 %	70-130			"	"	"		
Surrogate: 4-Bromofluorobenzene	105 %	70-130			"	"	"		

Metals (Saturated Paste Prep)

Calcium	2.77	me/L	1	'[none]'		08/02/2018	08/07/2018
Magnesium	2.85	"	"	"		"	"
Sodium	3.42	"	"	"		"	"

pH in Soil by EPA 9045D

pH	8.69	pH Units	1	B8H0109	OLAB	08/01/2018	08/01/2018
----	------	----------	---	---------	------	------------	------------

Origins Laboratory, Inc.



The results in this report apply to the samples analyzed in accordance with the chain of custody document. This analytical report must be reproduced in its entirety.

Eagle Environmental Consulting, Inc.
4101 Inca Street
Denver CO 80211

Martin C Eckert III
Project Number: [none]
Project: Kintz #1,2

SS-10@6'

7/31/2018 3:15:00PM

Analyte	Result	Reporting Limit	Units	Dilution	Batch	Analyst	Prepared	Analyzed	Notes
---------	--------	--------------------	-------	----------	-------	---------	----------	----------	-------

Origins Laboratory, Inc.
Y808001-10 (Soil)

SAR by 20B Saturated Paste

SAR	2.04			1	'[none]'		08/02/2018	08/07/2018	
-----	------	--	--	---	----------	--	------------	------------	--

Specific Conductance by Modified 9050A

Specific Conductance (EC)	0.243	0.00509	mmhos/cm	1	B8H0110	OLAB	08/01/2018	08/01/2018	
---------------------------	-------	---------	----------	---	---------	------	------------	------------	--

Origins Laboratory, Inc.



The results in this report apply to the samples analyzed in accordance with the chain of custody document. This analytical report must be reproduced in its entirety.

Eagle Environmental Consulting, Inc.
4101 Inca Street
Denver CO 80211

Martin C Eckert III
Project Number: [none]
Project: Kintz #1,2

SS-11@3'
7/31/2018 3:20:00PM

Analyte	Result	Reporting Limit	Units	Dilution	Batch	Analyst	Prepared	Analyzed	Notes
---------	--------	-----------------	-------	----------	-------	---------	----------	----------	-------

Origins Laboratory, Inc.
Y808001-11 (Soil)

Diesel Range Organics (DRO/TEPH) by EPA 8015C

Diesel (C10-C28)	ND	50.0	mg/kg	1	B8H0106	JMH	08/01/2018	08/02/2018	U
------------------	----	------	-------	---	---------	-----	------------	------------	---

Surrogate: o-Terphenyl	71.5 %	59-131			"	"	"		
------------------------	--------	--------	--	--	---	---	---	--	--

GBTEX by EPA 8260C

Gasoline Range Hydrocarbons	ND	0.200	mg/kg	1	B8H0105	ZZZ	08/01/2018	08/02/2018	U
Benzene	ND	0.002	"	"	"	ZZZ	"	"	U
Toluene	ND	0.002	"	"	"	ZZZ	"	"	U
Ethylbenzene	ND	0.002	"	"	"	ZZZ	"	"	U
Xylenes, total	ND	0.002	"	"	"	ZZZ	"	"	U

Surrogate: 1,2-Dichloroethane-d4	103 %	70-130			"	"	"		
Surrogate: Toluene-d8	99.5 %	70-130			"	"	"		
Surrogate: 4-Bromofluorobenzene	104 %	70-130			"	"	"		

Metals (Saturated Paste Prep)

Calcium	7.76	me/L	1	'[none]'		08/02/2018	08/07/2018
Magnesium	17.09	"	"	"		"	"
Sodium	4.86	"	"	"		"	"

pH in Soil by EPA 9045D

pH	8.68	pH Units	1	B8H0109	OLAB	08/01/2018	08/01/2018
----	------	----------	---	---------	------	------------	------------

Origins Laboratory, Inc.



The results in this report apply to the samples analyzed in accordance with the chain of custody document. This analytical report must be reproduced in its entirety.

Eagle Environmental Consulting, Inc.
4101 Inca Street
Denver CO 80211

Martin C Eckert III
Project Number: [none]
Project: Kintz #1,2

SS-11@3'

7/31/2018 3:20:00PM

Analyte	Result	Reporting Limit	Units	Dilution	Batch	Analyst	Prepared	Analyzed	Notes
---------	--------	--------------------	-------	----------	-------	---------	----------	----------	-------

Origins Laboratory, Inc.
Y808001-11 (Soil)

SAR by 20B Saturated Paste

SAR	1.38			1	'[none]'		08/02/2018	08/07/2018	
-----	------	--	--	---	----------	--	------------	------------	--

Specific Conductance by Modified 9050A

Specific Conductance (EC)	0.220	0.00500	mmhos/cm	1	B8H0110	OLAB	08/01/2018	08/01/2018	
---------------------------	-------	---------	----------	---	---------	------	------------	------------	--

Origins Laboratory, Inc.



The results in this report apply to the samples analyzed in accordance with the chain of custody document. This analytical report must be reproduced in its entirety.

Eagle Environmental Consulting, Inc.
4101 Inca Street
Denver CO 80211

Martin C Eckert III
Project Number: [none]
Project: Kintz #1,2

SS-12@3'

7/31/2018 3:25:00PM

Analyte	Result	Reporting Limit	Units	Dilution	Batch	Analyst	Prepared	Analyzed	Notes
---------	--------	-----------------	-------	----------	-------	---------	----------	----------	-------

Origins Laboratory, Inc.
Y808001-12 (Soil)

Diesel Range Organics (DRO/TEPH) by EPA 8015C

Diesel (C10-C28)	ND	50.0	mg/kg	1	B8H0106	JMH	08/01/2018	08/02/2018	U
------------------	----	------	-------	---	---------	-----	------------	------------	---

Surrogate: o-Terphenyl	70.6 %	59-131			"	"	"		
------------------------	--------	--------	--	--	---	---	---	--	--

GBTEX by EPA 8260C

Gasoline Range Hydrocarbons	ND	0.200	mg/kg	1	B8H0105	ZZZ	08/01/2018	08/02/2018	U
Benzene	ND	0.002	"	"	"	ZZZ	"	"	U
Toluene	ND	0.002	"	"	"	ZZZ	"	"	U
Ethylbenzene	ND	0.002	"	"	"	ZZZ	"	"	U
Xylenes, total	ND	0.002	"	"	"	ZZZ	"	"	U

Surrogate: 1,2-Dichloroethane-d4	107 %	70-130			"	"	"		
Surrogate: Toluene-d8	99.8 %	70-130			"	"	"		
Surrogate: 4-Bromofluorobenzene	102 %	70-130			"	"	"		

Metals (Saturated Paste Prep)

Calcium	5.19	me/L	1	'[none]'		08/02/2018	08/07/2018
Magnesium	12.86	"	"	"		"	"
Sodium	19.37	"	"	"		"	"

pH in Soil by EPA 9045D

pH	8.49	pH Units	1	B8H0109	OLAB	08/01/2018	08/01/2018
----	------	----------	---	---------	------	------------	------------

Origins Laboratory, Inc.



The results in this report apply to the samples analyzed in accordance with the chain of custody document. This analytical report must be reproduced in its entirety.

Eagle Environmental Consulting, Inc.

4101 Inca Street

Denver CO 80211

Martin C Eckert III

Project Number: [none]

Project: Kintz #1,2

SS-12@3'

7/31/2018 3:25:00PM

Analyte	Result	Reporting	Units	Dilution	Batch	Analyst	Prepared	Analyzed	Notes
		Limit							

Origins Laboratory, Inc.

Y808001-12 (Soil)

SAR by 20B Saturated Paste

SAR	6.45		1		'[none]'		08/02/2018	08/07/2018	
-----	------	--	---	--	----------	--	------------	------------	--

Specific Conductance by Modified 9050A

Specific Conductance (EC)	0.633	0.00502	mmhos/cm	1	B8H0110	OLAB	08/01/2018	08/01/2018	
---------------------------	-------	---------	----------	---	---------	------	------------	------------	--

Origins Laboratory, Inc.



The results in this report apply to the samples analyzed in accordance with the chain of custody document. This analytical report must be reproduced in its entirety.

Eagle Environmental Consulting, Inc.
4101 Inca Street
Denver CO 80211

Martin C Eckert III
Project Number: [none]
Project: Kintz #1,2

SS-13@3'

7/31/2018 3:30:00PM

Analyte	Result	Reporting Limit	Units	Dilution	Batch	Analyst	Prepared	Analyzed	Notes
---------	--------	-----------------	-------	----------	-------	---------	----------	----------	-------

Origins Laboratory, Inc.
Y808001-13 (Soil)

Diesel Range Organics (DRO/TEPH) by EPA 8015C

Diesel (C10-C28)	ND	50.0	mg/kg	1	B8H0106	JMH	08/01/2018	08/02/2018	U
------------------	----	------	-------	---	---------	-----	------------	------------	---

Surrogate: o-Terphenyl	67.1 %	59-131			"	"	"		
------------------------	--------	--------	--	--	---	---	---	--	--

GBTEX by EPA 8260C

Gasoline Range Hydrocarbons	ND	0.200	mg/kg	1	B8H0108	JTD	08/01/2018	08/02/2018	U
Benzene	ND	0.002	"	"	"	JTD	"	"	U
Toluene	ND	0.002	"	"	"	JTD	"	"	U
Ethylbenzene	ND	0.002	"	"	"	JTD	"	"	U
Xylenes, total	ND	0.002	"	"	"	JTD	"	"	U

Surrogate: 1,2-Dichloroethane-d4	106 %	70-130			"	"	"		
Surrogate: Toluene-d8	102 %	70-130			"	"	"		
Surrogate: 4-Bromofluorobenzene	102 %	70-130			"	"	"		

Metals (Saturated Paste Prep)

Calcium	1.85	me/L	1	'[none]'		08/02/2018	08/07/2018		
Magnesium	2.46	"	"	"		"	"		
Sodium	10.96	"	"	"		"	"		

pH in Soil by EPA 9045D

pH	8.86	pH Units	1	B8H0109	OLAB	08/01/2018	08/01/2018		
----	------	----------	---	---------	------	------------	------------	--	--

Origins Laboratory, Inc.



The results in this report apply to the samples analyzed in accordance with the chain of custody document. This analytical report must be reproduced in its entirety.

Eagle Environmental Consulting, Inc.
4101 Inca Street
Denver CO 80211

Martin C Eckert III
Project Number: [none]
Project: Kintz #1,2

SS-13@3'

7/31/2018 3:30:00PM

Analyte	Result	Reporting	Units	Dilution	Batch	Analyst	Prepared	Analyzed	Notes
		Limit							

Origins Laboratory, Inc.
Y808001-13 (Soil)

SAR by 20B Saturated Paste

SAR	7.47		1		'[none]'		08/02/2018	08/07/2018	
-----	------	--	---	--	----------	--	------------	------------	--

Specific Conductance by Modified 9050A

Specific Conductance (EC)	0.450	0.00500	mmhos/cm	1	B8H0110	OLAB	08/01/2018	08/01/2018	
---------------------------	-------	---------	----------	---	---------	------	------------	------------	--

Origins Laboratory, Inc.



The results in this report apply to the samples analyzed in accordance with the chain of custody document. This analytical report must be reproduced in its entirety.

Eagle Environmental Consulting, Inc.
4101 Inca Street
Denver CO 80211

Martin C Eckert III
Project Number: [none]
Project: Kintz #1,2

Volatile Organic Compounds by GC/MS SW846 8260C - Quality Control
Origins Laboratory, Inc.

Analyte	Result	Reporting Limit	Units	Spike Level	Source Result	%REC	%REC Limits	RPD	RPD Limit	Notes
Batch B8H0105 - EPA 5030 (soil)										
Blank (B8H0105-BLK1)					Prepared: 08/01/2018 Analyzed: 08/01/2018					
Gasoline Range Hydrocarbons	ND	0.200	mg/kg							U
Benzene	ND	0.002	"							U
Toluene	ND	0.002	"							U
Ethylbenzene	ND	0.002	"							U
Xylenes, total	ND	0.002	"							U
Surrogate: 1,2-Dichloroethane-d4	64		ug/kg	62.5		102	70-130			
Surrogate: Toluene-d8	63		"	62.5		101	70-130			
Surrogate: 4-Bromofluorobenzene	60		"	62.5		96.4	70-130			

Origins Laboratory, Inc.



The results in this report apply to the samples analyzed in accordance with the chain of custody document. This analytical report must be reproduced in its entirety.

Eagle Environmental Consulting, Inc.
4101 Inca Street
Denver CO 80211

Martin C Eckert III
Project Number: [none]
Project: Kintz #1,2

Volatile Organic Compounds by GC/MS SW846 8260C - Quality Control
Origins Laboratory, Inc.

Analyte	Result	Reporting Limit	Units	Spike Level	Source Result	%REC	%REC Limits	RPD	RPD Limit	Notes
Batch B8H0105 - EPA 5030 (soil)										
Blank (B8H0105-BLK2)					Prepared: 08/01/2018 Analyzed: 08/01/2018					
Gasoline Range Hydrocarbons	ND	0.200	mg/kg							U
Benzene	ND	0.002	"							U
Toluene	ND	0.002	"							U
Ethylbenzene	ND	0.002	"							U
Xylenes, total	ND	0.002	"							U
Surrogate: 1,2-Dichloroethane-d4	65		ug/kg	62.5		104	70-130			
Surrogate: Toluene-d8	62		"	62.5		99.5	70-130			
Surrogate: 4-Bromofluorobenzene	60		"	62.5		95.4	70-130			

Origins Laboratory, Inc.



The results in this report apply to the samples analyzed in accordance with the chain of custody document. This analytical report must be reproduced in its entirety.

Eagle Environmental Consulting, Inc.

4101 Inca Street

Denver CO 80211

Martin C Eckert III

Project Number: [none]

Project: Kintz #1,2

Volatile Organic Compounds by GC/MS SW846 8260C - Quality Control
Origins Laboratory, Inc.

Analyte	Result	Reporting Limit	Units	Spike Level	Source Result	%REC	%REC Limits	RPD	RPD Limit	Notes
---------	--------	-----------------	-------	-------------	---------------	------	-------------	-----	-----------	-------

Batch B8H0105 - EPA 5030 (soil)

LCS (B8H0105-BS1)

Prepared: 08/01/2018 Analyzed: 08/01/2018

Benzene	0.093	0.002	mg/kg	0.100		92.8	77.1-124			
Toluene	0.109	0.002	"	0.100		109	74.5-128			
Ethylbenzene	0.110	0.002	"	0.100		110	66.4-127			
m,p-Xylene	0.231	0.004	"	0.200		116	76.6-124			
o-Xylene	0.100	0.002	"	0.100		100	76.6-124			
Surrogate: 1,2-Dichloroethane-d4	64		ug/kg	62.5		103	70-130			
Surrogate: Toluene-d8	63		"	62.5		101	70-130			
Surrogate: 4-Bromofluorobenzene	66		"	62.5		105	70-130			

Origins Laboratory, Inc.



The results in this report apply to the samples analyzed in accordance with the chain of custody document. This analytical report must be reproduced in its entirety.

Jen Pellegrini For Noelle Doyle Mathis, President

Eagle Environmental Consulting, Inc.

4101 Inca Street

Denver CO 80211

Martin C Eckert III

Project Number: [none]

Project: Kintz #1,2

Volatile Organic Compounds by GC/MS SW846 8260C - Quality Control
Origins Laboratory, Inc.

Analyte	Result	Reporting Limit	Units	Spike Level	Source Result	%REC	%REC Limits	RPD	RPD Limit	Notes
---------	--------	-----------------	-------	-------------	---------------	------	-------------	-----	-----------	-------

Batch B8H0105 - EPA 5030 (soil)

LCS (B8H0105-BS2)

Prepared: 08/01/2018 Analyzed: 08/01/2018

Benzene	0.093	0.002	mg/kg	0.100		92.6	77.1-124			
Toluene	0.106	0.002	"	0.100		106	74.5-128			
Ethylbenzene	0.104	0.002	"	0.100		104	66.4-127			
m,p-Xylene	0.219	0.004	"	0.200		109	76.6-124			
o-Xylene	0.095	0.002	"	0.100		95.3	76.6-124			
Surrogate: 1,2-Dichloroethane-d4	63		ug/kg	62.5		101	70-130			
Surrogate: Toluene-d8	62		"	62.5		99.3	70-130			
Surrogate: 4-Bromofluorobenzene	64		"	62.5		102	70-130			

Origins Laboratory, Inc.



The results in this report apply to the samples analyzed in accordance with the chain of custody document. This analytical report must be reproduced in its entirety.

Jen Pellegrini For Noelle Doyle Mathis, President

Eagle Environmental Consulting, Inc.
4101 Inca Street
Denver CO 80211

Martin C Eckert III
Project Number: [none]
Project: Kintz #1,2

Volatile Organic Compounds by GC/MS SW846 8260C - Quality Control
Origins Laboratory, Inc.

Analyte	Result	Reporting Limit	Units	Spike Level	Source Result	%REC	%REC Limits	RPD	RPD Limit	Notes
---------	--------	-----------------	-------	-------------	---------------	------	-------------	-----	-----------	-------

Batch B8H0105 - EPA 5030 (soil)

Matrix Spike (B8H0105-MS1)		Source: Y808001-01			Prepared: 08/01/2018 Analyzed: 08/01/2018					
Benzene	0.092	0.002	mg/kg	0.100	ND	91.9	71.8-126			
Toluene	0.102	0.002	"	0.100	ND	102	65.1-130			
Ethylbenzene	0.100	0.002	"	0.100	ND	100	62.2-130			
m,p-Xylene	0.212	0.004	"	0.200	ND	106	46.5-137			
o-Xylene	0.094	0.002	"	0.100	ND	93.6	54.2-134			
Surrogate: 1,2-Dichloroethane-d4	67		ug/kg	62.5		107	70-130			
Surrogate: Toluene-d8	61		"	62.5		97.2	70-130			
Surrogate: 4-Bromofluorobenzene	64		"	62.5		103	70-130			

Origins Laboratory, Inc.



The results in this report apply to the samples analyzed in accordance with the chain of custody document. This analytical report must be reproduced in its entirety.

Eagle Environmental Consulting, Inc.
4101 Inca Street
Denver CO 80211

Martin C Eckert III
Project Number: [none]
Project: Kintz #1,2

Volatile Organic Compounds by GC/MS SW846 8260C - Quality Control
Origins Laboratory, Inc.

Analyte	Result	Reporting Limit	Units	Spike Level	Source Result	%REC	%REC Limits	RPD	RPD Limit	Notes
---------	--------	-----------------	-------	-------------	---------------	------	-------------	-----	-----------	-------

Batch B8H0105 - EPA 5030 (soil)

Matrix Spike (B8H0105-MS2)		Source: Y807438-06			Prepared: 08/01/2018 Analyzed: 08/01/2018					
Benzene	0.089	0.002	mg/kg	0.100	ND	89.1	71.8-126			
Toluene	0.087	0.002	"	0.100	ND	87.1	65.1-130			
Ethylbenzene	0.090	0.002	"	0.100	ND	89.6	62.2-130			
m,p-Xylene	0.177	0.004	"	0.200	ND	88.5	46.5-137			
o-Xylene	0.092	0.002	"	0.100	ND	92.4	54.2-134			
Surrogate: 1,2-Dichloroethane-d4	60		ug/kg	62.5		96.1	70-130			
Surrogate: Toluene-d8	61		"	62.5		97.5	70-130			
Surrogate: 4-Bromofluorobenzene	63		"	62.5		101	70-130			

Origins Laboratory, Inc.



The results in this report apply to the samples analyzed in accordance with the chain of custody document. This analytical report must be reproduced in its entirety.

Eagle Environmental Consulting, Inc.
4101 Inca Street
Denver CO 80211

Martin C Eckert III
Project Number: [none]
Project: Kintz #1,2

Volatile Organic Compounds by GC/MS SW846 8260C - Quality Control
Origins Laboratory, Inc.

Analyte	Result	Reporting Limit	Units	Spike Level	Source Result	%REC	%REC Limits	RPD	RPD Limit	Notes
---------	--------	-----------------	-------	-------------	---------------	------	-------------	-----	-----------	-------

Batch B8H0105 - EPA 5030 (soil)

Matrix Spike Dup (B8H0105-MSD1)		Source: Y808001-01			Prepared: 08/01/2018 Analyzed: 08/01/2018					
Benzene	0.093	0.002	mg/kg	0.100	ND	92.6	71.8-126	0.780	11.3	
Toluene	0.103	0.002	"	0.100	ND	103	65.1-130	0.914	15.4	
Ethylbenzene	0.100	0.002	"	0.100	ND	100	62.2-130	0.120	19.6	
m,p-Xylene	0.212	0.004	"	0.200	ND	106	46.5-137	0.208	19.2	
o-Xylene	0.093	0.002	"	0.100	ND	93.3	54.2-134	0.364	17.9	
Surrogate: 1,2-Dichloroethane-d4	66		ug/kg	62.5		105	70-130			
Surrogate: Toluene-d8	61		"	62.5		97.8	70-130			
Surrogate: 4-Bromofluorobenzene	65		"	62.5		103	70-130			

Origins Laboratory, Inc.



The results in this report apply to the samples analyzed in accordance with the chain of custody document. This analytical report must be reproduced in its entirety.

Eagle Environmental Consulting, Inc.
4101 Inca Street
Denver CO 80211

Martin C Eckert III
Project Number: [none]
Project: Kintz #1,2

Volatile Organic Compounds by GC/MS SW846 8260C - Quality Control
Origins Laboratory, Inc.

Analyte	Result	Reporting Limit	Units	Spike Level	Source Result	%REC	%REC Limits	RPD	RPD Limit	Notes
Batch B8H0105 - EPA 5030 (soil)										
Matrix Spike Dup (B8H0105-MSD2)		Source: Y807438-06			Prepared: 08/01/2018 Analyzed: 08/01/2018					
Benzene	0.074	0.002	mg/kg	0.100	ND	73.7	71.8-126	18.8	11.3	QR-02
Toluene	0.082	0.002	"	0.100	ND	81.7	65.1-130	6.33	15.4	
Ethylbenzene	0.079	0.002	"	0.100	ND	79.2	62.2-130	12.3	19.6	
m,p-Xylene	0.170	0.004	"	0.200	ND	85.0	46.5-137	4.06	19.2	
o-Xylene	0.075	0.002	"	0.100	ND	75.4	54.2-134	20.3	17.9	QR-02
Surrogate: 1,2-Dichloroethane-d4	65		ug/kg	62.5		105	70-130			
Surrogate: Toluene-d8	61		"	62.5		97.6	70-130			
Surrogate: 4-Bromofluorobenzene	64		"	62.5		102	70-130			

Origins Laboratory, Inc.



The results in this report apply to the samples analyzed in accordance with the chain of custody document. This analytical report must be reproduced in its entirety.

Eagle Environmental Consulting, Inc.
4101 Inca Street
Denver CO 80211

Martin C Eckert III
Project Number: [none]
Project: Kintz #1,2

Volatile Organic Compounds by GC/MS SW846 8260C - Quality Control
Origins Laboratory, Inc.

Analyte	Result	Reporting Limit	Units	Spike Level	Source Result	%REC	%REC Limits	RPD	RPD Limit	Notes
Batch B8H0108 - EPA 5030 (soil)										
Blank (B8H0108-BLK1)					Prepared: 08/01/2018 Analyzed: 08/01/2018					
Gasoline Range Hydrocarbons	ND	0.200	mg/kg							U
Benzene	ND	0.002	"							U
Toluene	ND	0.002	"							U
Ethylbenzene	ND	0.002	"							U
m,p-Xylene	ND	0.004	"							U
o-Xylene	ND	0.002	"							U
Xylenes, total	ND	0.002	"							U
Surrogate: 1,2-Dichloroethane-d4	61		ug/kg	62.5		97.6	70-130			
Surrogate: Toluene-d8	64		"	62.5		103	70-130			
Surrogate: 4-Bromofluorobenzene	63		"	62.5		101	70-130			

Origins Laboratory, Inc.



The results in this report apply to the samples analyzed in accordance with the chain of custody document. This analytical report must be reproduced in its entirety.

Eagle Environmental Consulting, Inc.
4101 Inca Street
Denver CO 80211

Martin C Eckert III
Project Number: [none]
Project: Kintz #1,2

Volatile Organic Compounds by GC/MS SW846 8260C - Quality Control
Origins Laboratory, Inc.

Analyte	Result	Reporting Limit	Units	Spike Level	Source Result	%REC	%REC Limits	RPD	RPD Limit	Notes
Batch B8H0108 - EPA 5030 (soil)										
LCS (B8H0108-BS1)					Prepared: 08/01/2018 Analyzed: 08/01/2018					
Benzene	0.084	0.002	mg/kg	0.100		83.9	77.1-124			
Toluene	0.090	0.002	"	0.100		89.6	74.5-128			
Ethylbenzene	0.089	0.002	"	0.100		88.6	66.4-127			
m,p-Xylene	0.179	0.004	"	0.200		89.4	76.6-124			
o-Xylene	0.091	0.002	"	0.100		90.8	76.6-124			
Surrogate: 1,2-Dichloroethane-d4	57		ug/kg	62.5		90.4	70-130			
Surrogate: Toluene-d8	65		"	62.5		103	70-130			
Surrogate: 4-Bromofluorobenzene	62		"	62.5		99.3	70-130			

Origins Laboratory, Inc.



The results in this report apply to the samples analyzed in accordance with the chain of custody document. This analytical report must be reproduced in its entirety.

Eagle Environmental Consulting, Inc.
4101 Inca Street
Denver CO 80211

Martin C Eckert III
Project Number: [none]
Project: Kintz #1,2

Volatile Organic Compounds by GC/MS SW846 8260C - Quality Control
Origins Laboratory, Inc.

Analyte	Result	Reporting Limit	Units	Spike Level	Source Result	%REC	%REC Limits	RPD	RPD Limit	Notes
---------	--------	-----------------	-------	-------------	---------------	------	-------------	-----	-----------	-------

Batch B8H0108 - EPA 5030 (soil)

Matrix Spike (B8H0108-MS1)		Source: Y808001-13			Prepared: 08/01/2018 Analyzed: 08/02/2018					
Benzene	0.080	0.002	mg/kg	0.100	ND	80.4	71.8-126			
Toluene	0.084	0.002	"	0.100	ND	84.4	65.1-130			
Ethylbenzene	0.084	0.002	"	0.100	ND	83.6	62.2-130			
m,p-Xylene	0.167	0.004	"	0.200	ND	83.5	46.5-137			
o-Xylene	0.084	0.002	"	0.100	ND	84.4	54.2-134			
Surrogate: 1,2-Dichloroethane-d4	64		ug/kg	62.5		103	70-130			
Surrogate: Toluene-d8	63		"	62.5		101	70-130			
Surrogate: 4-Bromofluorobenzene	63		"	62.5		101	70-130			

Origins Laboratory, Inc.



The results in this report apply to the samples analyzed in accordance with the chain of custody document. This analytical report must be reproduced in its entirety.

Eagle Environmental Consulting, Inc.
4101 Inca Street
Denver CO 80211

Martin C Eckert III
Project Number: [none]
Project: Kintz #1,2

Volatile Organic Compounds by GC/MS SW846 8260C - Quality Control
Origins Laboratory, Inc.

Analyte	Result	Reporting Limit	Units	Spike Level	Source Result	%REC	%REC Limits	RPD	RPD Limit	Notes
---------	--------	-----------------	-------	-------------	---------------	------	-------------	-----	-----------	-------

Batch B8H0108 - EPA 5030 (soil)

Matrix Spike Dup (B8H0108-MSD1)		Source: Y808001-13			Prepared: 08/01/2018 Analyzed: 08/02/2018					
Benzene	0.079	0.002	mg/kg	0.100	ND	79.1	71.8-126	1.58	11.3	
Toluene	0.083	0.002	"	0.100	ND	82.5	65.1-130	2.28	15.4	
Ethylbenzene	0.084	0.002	"	0.100	ND	84.1	62.2-130	0.572	19.6	
m,p-Xylene	0.168	0.004	"	0.200	ND	84.1	46.5-137	0.740	19.2	
o-Xylene	0.084	0.002	"	0.100	ND	83.9	54.2-134	0.547	17.9	
Surrogate: 1,2-Dichloroethane-d4	64		ug/kg	62.5		102	70-130			
Surrogate: Toluene-d8	63		"	62.5		101	70-130			
Surrogate: 4-Bromofluorobenzene	63		"	62.5		101	70-130			

Origins Laboratory, Inc.



The results in this report apply to the samples analyzed in accordance with the chain of custody document. This analytical report must be reproduced in its entirety.

Eagle Environmental Consulting, Inc.
4101 Inca Street
Denver CO 80211

Martin C Eckert III
Project Number: [none]
Project: Kintz #1,2

Volatile Organic Compounds by GC/MS SW846 8260C - Quality Control

Origins Laboratory, Inc.

Analyte	Result	Reporting Limit	Units	Spike Level	Source Result	%REC	%REC Limits	RPD	RPD Limit	Notes
---------	--------	-----------------	-------	-------------	---------------	------	-------------	-----	-----------	-------

Extractable Petroleum Hydrocarbons by 8015C - Quality Control

Origins Laboratory, Inc.

Analyte	Result	Reporting Limit	Units	Spike Level	Source Result	%REC	%REC Limits	RPD	RPD Limit	Notes
---------	--------	-----------------	-------	-------------	---------------	------	-------------	-----	-----------	-------

Batch B8H0106 - EPA 3580

Blank (B8H0106-BLK1)

Prepared: 08/01/2018 Analyzed: 08/01/2018

Diesel (C10-C28)	ND	50.0	mg/kg							U
------------------	----	------	-------	--	--	--	--	--	--	---

Surrogate: o-Terphenyl

60

"

50.0

120

59-131

Blank (B8H0106-BLK2)

Prepared: 08/01/2018 Analyzed: 08/01/2018

Diesel (C10-C28)	ND	50.0	mg/kg							U
------------------	----	------	-------	--	--	--	--	--	--	---

Surrogate: o-Terphenyl

41

"

50.0

81.8

59-131

LCS (B8H0106-BS1)

Prepared: 08/01/2018 Analyzed: 08/01/2018

Diesel (C10-C28)	867	50.0	mg/kg	1000		86.7	64-121			
------------------	-----	------	-------	------	--	------	--------	--	--	--

Surrogate: o-Terphenyl

44

"

50.0

88.6

59-131

LCS (B8H0106-BS2)

Prepared: 08/01/2018 Analyzed: 08/01/2018

Diesel (C10-C28)	885	50.0	mg/kg	1000		88.5	64-121			
------------------	-----	------	-------	------	--	------	--------	--	--	--

Surrogate: o-Terphenyl

45

"

50.0

90.3

59-131

Matrix Spike (B8H0106-MS1)

Source: Y808007-02

Prepared: 08/01/2018 Analyzed: 08/01/2018

Diesel (C10-C28)	828	50.0	mg/kg	1000	17.0	81.1	53-125			
------------------	-----	------	-------	------	------	------	--------	--	--	--

Surrogate: o-Terphenyl

44

"

50.0

87.2

59-131

Matrix Spike (B8H0106-MS2)

Source: Y808001-01

Prepared: 08/01/2018 Analyzed: 08/01/2018

Diesel (C10-C28)	908	50.0	mg/kg	1000	13.8	89.4	53-125			
------------------	-----	------	-------	------	------	------	--------	--	--	--

Surrogate: o-Terphenyl

45

"

50.0

90.7

59-131

Origins Laboratory, Inc.



The results in this report apply to the samples analyzed in accordance with the chain of custody document. This analytical report must be reproduced in its entirety.

Eagle Environmental Consulting, Inc.
4101 Inca Street
Denver CO 80211

Martin C Eckert III
Project Number: [none]
Project: Kintz #1,2

Extractable Petroleum Hydrocarbons by 8015C - Quality Control Origins Laboratory, Inc.

Analyte	Result	Reporting Limit	Units	Spike Level	Source Result	%REC	%REC Limits	RPD	RPD Limit	Notes
Batch B8H0106 - EPA 3580										
Matrix Spike Dup (B8H0106-MSD1)			Source: Y808007-02		Prepared: 08/01/2018 Analyzed: 08/01/2018					
Diesel (C10-C28)	834	50.0	mg/kg	1000	17.0	81.7	53-125	0.732	20	
Surrogate: o-Terphenyl	45		"	50.0		89.8	59-131			
Matrix Spike Dup (B8H0106-MSD2)			Source: Y808001-01		Prepared: 08/01/2018 Analyzed: 08/02/2018					
Diesel (C10-C28)	852	50.0	mg/kg	1000	13.8	83.8	53-125	6.41	20	
Surrogate: o-Terphenyl	44		"	50.0		87.3	59-131			

Origins Laboratory, Inc.



The results in this report apply to the samples analyzed in accordance with the chain of custody document. This analytical report must be reproduced in its entirety.

Eagle Environmental Consulting, Inc.
4101 Inca Street
Denver CO 80211

Martin C Eckert III
Project Number: [none]
Project: Kintz #1,2

Classical Chemistry Parameters - Quality Control Origins Laboratory, Inc.

Analyte	Result	Reporting Limit	Units	Spike Level	Source Result	%REC	%REC Limits	RPD	RPD Limit	Notes
Batch B8H0109 - NO PREP										
Duplicate (B8H0109-DUP1)		Source: Y808001-02			Prepared: 08/01/2018 Analyzed: 08/01/2018					
pH	8.40		pH Units		9.07			7.67	25	
Batch B8H0110 - NO PREP										
Blank (B8H0110-BLK1)		Prepared: 08/01/2018 Analyzed: 08/01/2018								
Specific Conductance (EC)	0.00140	0.00500	mmhos/cm							
Duplicate (B8H0110-DUP1)		Source: Y808001-02			Prepared: 08/01/2018 Analyzed: 08/01/2018					
Specific Conductance (EC)	0.112	0.00500	mmhos/cm		0.124			10.6	25	

Origins Laboratory, Inc.



The results in this report apply to the samples analyzed in accordance with the chain of custody document. This analytical report must be reproduced in its entirety.

Eagle Environmental Consulting, Inc.

4101 Inca Street

Denver CO 80211

Martin C Eckert III

Project Number: [none]

Project: Kintz #1,2

Notes and Definitions

U Sample is Non-Detect.

QR-02 The RPD result exceeded the QC control limits; however, both percent recoveries were acceptable. Sample results for the QC batch were accepted based on percent recoveries and completeness of QC data.

ND Analyte NOT DETECTED at or above the reporting limit

RPD Relative Percent Difference

All soil results are reported at a wet weight basis.

Origins Laboratory, Inc.



The results in this report apply to the samples analyzed in accordance with the chain of custody document. This analytical report must be reproduced in its entirety.